

HUMBLE OIL & REFINING COMPANY

MIDLAND, TEXAS 79701

PRODUCTION DEPARTMENT
MIDCONTINENT DIVISION
R. E. HAMMOND
OPERATIONS MANAGER

June 30, 1972

POST OFFICE BOX 1600

JUL 5 1972

File No. 22-3

Request for Reallocation of
Acreage to F. F. Hardison B No. 4
Blinebry Gas Well

*NS P-888
issue 8-2-72
check to see if there is
an NSP TO
acquire \$34*

New Mexico Oil Conservation Commission
P. O. Box 2088
Santa Fe, New Mexico 87501

Attention: Mr. A. L. Porter, Secretary Director

Dear Sir:

Humble Oil & Refining Company respectfully requests reallocation of acreage dedicated to its F. F. Hardison B, Well No. 4, Blinebry Gas Well, located in Unit B, Section 34, T-21-S, R-37-E, Lea County, New Mexico to include the W/2 and the SE/4 of the NE/4 of Section 34, a total of 120 acres.

Reallocation is necessary due to F. F. Hardison B, Well No. 2, Unit A, Section 34, T-21-S, R-37-E, being placed on production as a Blinebry oil well effective July 1, 1972.

Yours very truly,

R. E. Hammond
R. E. Hammond

DFL:mej

cc: NMOCC, Hobbs, New Mexico 88240
cc: Continental Oil Co., Box 460, Hobbs, N. M. 88240
cc: Gulf Oil Corporation, Box 670, Hobbs, N. M. 88240
cc: Marathon Oil Co., Box 2409, Hobbs, N. M. 88240
cc: Mobil Oil Co., Box 1800, Hobbs, N. M. 88240
cc: Amoco Production Co., Box 68, Hobbs, N. M. 88240
cc: File

Humble Lse.No. _____ NEW MEXICO OIL CONSERVATION COMMISSION
State Lse.No. _____ WELL LOCATION AND ACREAGE DEDICATION PLAT
Federal Lse.No. _____ All distances must be from the outer boundaries of the Section

JUL 3 - 1972

Form C-102
Supersedes C-128
Effective 1-1-65

Operator Humble Oil & Refining Co.		Lease F. F. Hardison "B"		Well No. 4
Unit Letter B	Section 34	Township 21-S	Range 37-E	County Lea
Actual Footage Location of Well: 660 feet from the North line and 1980 feet from the East line				
Ground Level Elev: 3402	Producing Formation Lower Clearfork	Pool Blinebry Gas	Dedicated Acreage: 120 Acres	

1. Outline the acreage dedicated to the subject well by colored pencil or hachure marks on the plat below.
2. If more than one lease is dedicated to the well, outline each and identify the ownership thereof (both as to working interest and royalty).
3. If more than one lease of different ownership is dedicated to the well, have the interests of all owners been consolidated by communitization, unitization, force-pooling, etc?

☐ Yes ☐ No If answer is "yes," type of consolidation _____

If answer is "no," list the owners and tract descriptions which have actually been consolidated. (Use reverse side of this form if necessary.) _____

No allowable will be assigned to the well until all interests have been consolidated (by communitization, unitization, forced-pooling, or otherwise) or until a non-standard unit, eliminating such interests, has been approved by the Commission.

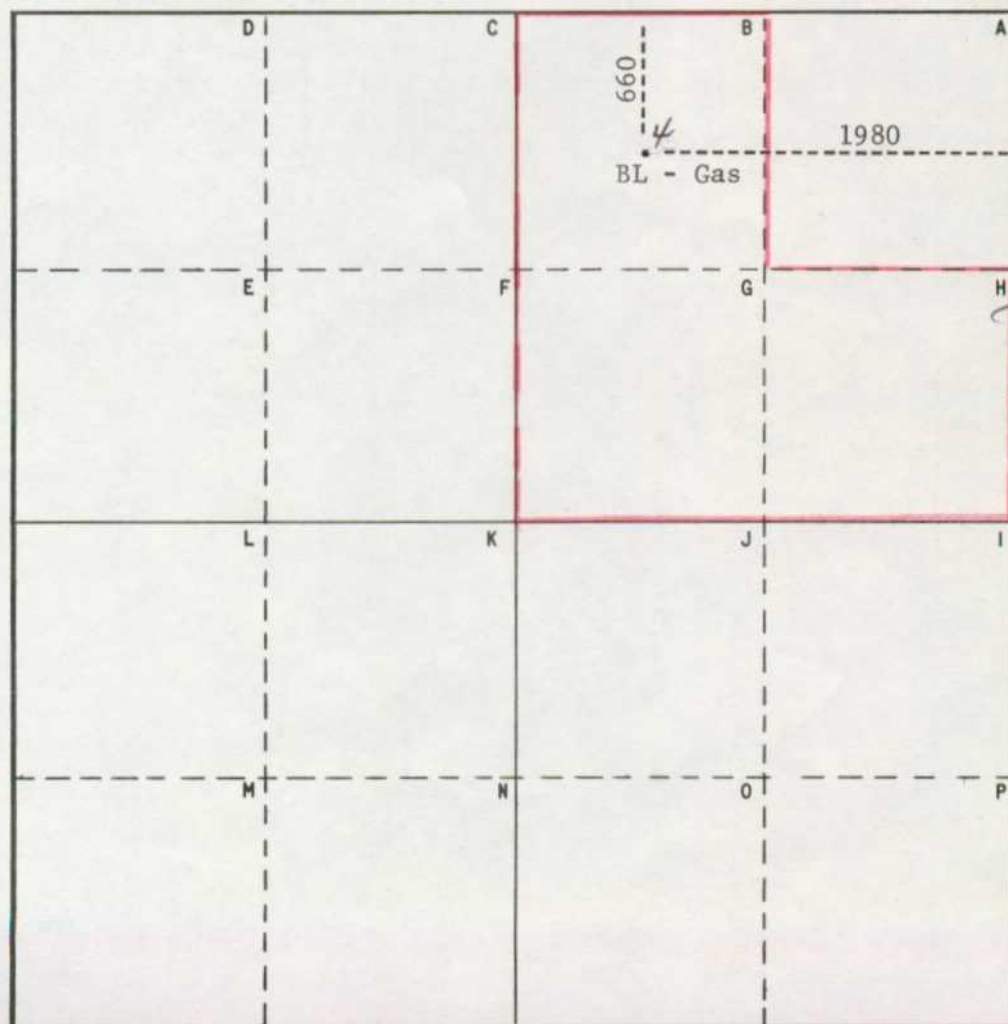

CERTIFICATION

I hereby certify that the information contained herein is true and complete to the best of my knowledge and belief.

Name _____
Position _____
Agent _____
Company Humble Oil & Refining Co.
Box 1600 Midland, Texas
Date 6-28-72

I hereby certify that the well location shown on this plat was plotted from field notes of actual surveys made by me or under my supervision, and that the same is true and correct to the best of my knowledge and belief.

Date Surveyed _____

Registered Professional Engineer
and/or Land Surveyor

Certificate No. _____

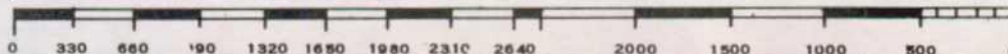

Miles _____ of _____, New Mexico

C.E. Sec. File No. _____

No. 528787

RECEIPT FOR CERTIFIED MAIL—30¢ (plus postage)

SENT TO Continental Oil Company		POSTMARK OR DATE MIDLAND, TX ANNEX 30 1972 USPO
STREET AND NO. Box 460		
P.O., STATE AND ZIP CODE Hobbs, New Mexico 88240		
OPTIONAL SERVICES FOR ADDITIONAL FEES		
RETURN RECEIPT SERVICES	1. Shows to whom and date delivered 15¢ With delivery to addressee only 65¢ 2. Shows to whom, date and where delivered 35¢ With delivery to addressee only 85¢	
DELIVER TO ADDRESSEE ONLY 50¢		
SPECIAL DELIVERY (2 pounds or less) 45¢		
POD Form 3800 July 1969		NO INSURANCE COVERAGE PROVIDED— NOT FOR INTERNATIONAL MAIL (See other side) * GPO : 1969 O—358-312

No. 528783

RECEIPT FOR CERTIFIED MAIL—30¢ (plus postage)

SENT TO Amoco Production Company		POSTMARK OR DATE MIDLAND, TX ANNEX 30 1972 USPO
STREET AND NO. Box 68		
P.O., STATE AND ZIP CODE Hobbs, New Mexico 88240		
OPTIONAL SERVICES FOR ADDITIONAL FEES		
RETURN RECEIPT SERVICES	1. Shows to whom and date delivered 15¢ With delivery to addressee only 65¢ 2. Shows to whom, date and where delivered 35¢ With delivery to addressee only 85¢	
DELIVER TO ADDRESSEE ONLY 50¢		
SPECIAL DELIVERY (2 pounds or less) 45¢		
POD Form 3800 July 1969		NO INSURANCE COVERAGE PROVIDED— NOT FOR INTERNATIONAL MAIL (See other side) * GPO : 1969 O—358-312

No. 528784

RECEIPT FOR CERTIFIED MAIL—30¢ (plus postage)

SENT TO Mobil OilCo.		POSTMARK OR DATE MIDLAND, TX ANNEX 30 1972 USPO
STREET AND NO. P. O. Box 1800		
P.O., STATE AND ZIP CODE Hobbs, New Mexico 88240		
OPTIONAL SERVICES FOR ADDITIONAL FEES		
RETURN RECEIPT SERVICES	1. Shows to whom and date delivered 15¢ With delivery to addressee only 65¢ 2. Shows to whom, date and where delivered 35¢ With delivery to addressee only 85¢	
DELIVER TO ADDRESSEE ONLY 50¢		
SPECIAL DELIVERY (2 pounds or less) 45¢		
POD Form 3800 July 1969		NO INSURANCE COVERAGE PROVIDED— NOT FOR INTERNATIONAL MAIL (See other side) * GPO : 1969 O—358-312

RECEIPT FOR CERTIFIED MAIL—30¢ (plus postage)

SENT TO Gulf Oil Corporation		POSTMARK OR DATE MIDLAND, TX ANNEX 30 1972 USPO
STREET AND NO. Box 670		
P.O., STATE AND ZIP CODE Hobbs, New Mexico 88240		
OPTIONAL SERVICES FOR ADDITIONAL FEES		
RETURN RECEIPT SERVICES	1. Shows to whom and date delivered 15¢ With delivery to addressee only 65¢ 2. Shows to whom, date and where delivered 35¢ With delivery to addressee only 85¢	
DELIVER TO ADDRESSEE ONLY 50¢		
SPECIAL DELIVERY (2 pounds or less) 45¢		
POD Form 3800 July 1969		NO INSURANCE COVERAGE PROVIDED— NOT FOR INTERNATIONAL MAIL (See other side) * GPO : 1969 O—358-312

No. 528786

No. 528785

RECEIPT FOR CERTIFIED MAIL—30¢ (plus postage)

SENT TO Marathon Oil Company		POSTMARK OR DATE MIDLAND, TX ANNEX 30 1972 USPO
STREET AND NO. Box 2409		
P.O., STATE AND ZIP CODE Hobbs, New Mexico 88240		
OPTIONAL SERVICES FOR ADDITIONAL FEES		
RETURN RECEIPT SERVICES	1. Shows to whom and date delivered 15¢ With delivery to addressee only 65¢ 2. Shows to whom, date and where delivered 35¢ With delivery to addressee only 85¢	
DELIVER TO ADDRESSEE ONLY 50¢		
SPECIAL DELIVERY (2 pounds or less) 45¢		
POD Form 3800 July 1969		NO INSURANCE COVERAGE PROVIDED— NOT FOR INTERNATIONAL MAIL (See other side) * GPO : 1969 O—358-312

OIL CONSERVATION COMMISSION

P. O. BOX 2088

SANTA FE, NEW MEXICO 87501

August 2, 1972

C
O
P
Y
Humble Oil & Refining Company
P. O. Box 1600
Midland, Texas 79701

Attention: Mr. R. E. Hammond

Administrative Order NSP-888

Gentlemen:

Reference is made to your application for approval of a 120-acre non-standard gas proration unit in the Blinebry Gas Pool consisting of the following acreage:

LEA COUNTY, NEW MEXICO
TOWNSHIP 21 SOUTH, RANGE 37 EAST, NMPM
Section 34: W/2 and SE/4 NE/4

It is understood that this unit is to be dedicated to your F. F. Hardison B Well No. 4, located 660 feet from the North line and 1980 feet from the East line of said Section 34.

By authority granted me under the provisions of Rule 5(C) of Order No. R-1670, as amended, you are hereby authorized to operate the above-described acreage as a non-standard gas proration unit.

Administrative Order NSP-834 is hereby superseded.

Very truly yours,

A. L. PORTER, Jr.
Secretary-Director

ALP/GMH/dr

cc: Oil Conservation Commission - Hobbs
Oil & Gas Engineering Committee - Hobbs
Proration Department, OCC - Santa Fe