

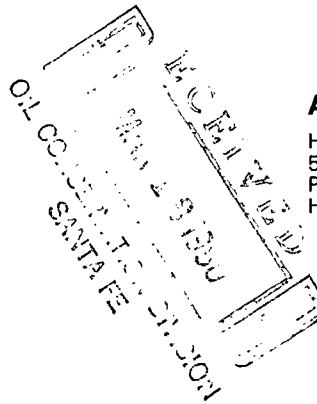

J. R. Barnett
Regional Engineering
Manager

March 4, 1980



Amoco Production Company

Houston Region
500 Jefferson Building
Post Office Box 3092
Houston, Texas 77001

MESA-PBD

File

HSP-1183

File: JCA-986.51NM-332

Re: Non-Standard Gas Proration Unit
Mesa Petroleum Co.
Depco Federal No. 1
2160' FNL & 1980' FWL
Sec. 5 T-16-S, R-28-E
Eddy County, New Mexico

Mr. Joe D. Ramey, Director
New Mexico Oil Conservation Division
P. O. Box 2088
Santa Fe, New Mexico 87501

Dear Mr. Ramey:

Mesa Petroleum Co. intends to file for an administrative approval for a non-standard gas proration unit for the subject well. The well location itself may or may not be unorthodox being 2160' from the north and 1980' from the south end lines and 1980' from the nearest side boundary and 330' from section quarter/quarter lines. 270.5 acres are being dedicated to this well from the northwest part of the section.

As an offset operator, Amoco Production Company has no objections to the location of non standard unit and hereby waives notice and hearing.

Yours very truly,

J. R. Barnett
J. R. Barnett
MLC/cf
319/I

cc: Mesa Petroleum Co.
~~GILS Tower West, Suite 904~~ 1000 Vaughn Building
Midland, Texas 79701

*NSP-1183
Rule 104DII
Immediate*

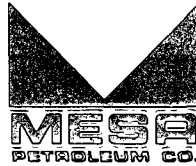

NSP-1183

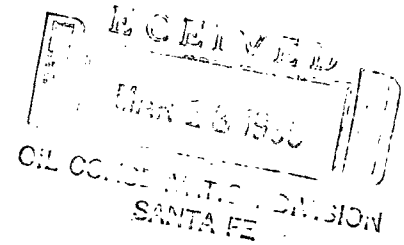

March 11, 1980

Mr. Joe D. Ramey, Director
Oil Conservation Division
P. O. Box 2088
Santa Fe, New Mexico 87501

RE: Mesa Petroleum Co
Depco Federal #1
2160' FNL & 1980' FWL
Sec 4, T16S, R28E
Eddy County, New Mexico

Dear Mr. Ramey:

Application is hereby made for an administrative approval of a 270.5 acre non-standard gas proration unit under Rule 104DII for the above captioned well. Application is necessitated by the unorthodox survey lines pertaining to the north third of subject section, namely lots 1 thru 4 which only contain 15.25 acres each as outlined on the attached diagram. It should be noted that this location may or may not be orthodox due to these survey anomalies. This is a similar application to those approved for the Mesa Petroleum Co Derrick Federal Com #1 and Derrick Federal #2.

All off-set operators to the proposed unit have been notified and Tenneco Oil Company's response is enclosed. Amoco has responded directly to you on past applications and is assumed to have done so regarding this proposal.

Expeditious handling of this request and issuance of appropriate administrative order is appreciated.

Yours very truly,

A handwritten signature in cursive script, reading 'R. E. Mathis'.

R. E. MATHIS
Regulatory Coordinator

Attch (2)
Encl (1)

*Col 1/2 of Sec 4
Partial*

NEW MEXICO OIL CONSERVATION COMMISSION WELL LOCATION AND ACREAGE DEDICATION PLAT

Form C-102
Supersedes C-128
Effective 1-1-65

All distances must be from the outer boundaries of the Section

Operator Mesa Petroleum Co.			Lease Depco Federal		Well No. 1
Unit Letter K	Section 4	Township 16 South	Range 28 East	County Eddy	
Actual Footage Location of Well:					
2160 feet from the North line and		1960 feet from the West line			
Ground Level Elev. 3622.0	Producing Formation Atoka-Morrow	Pool Undesignated		Dedicated Acreage W/2 270.5	

1. Outline the acreage dedicated to the subject well by colored pencil or hachure marks on the plat below.
2. If more than one lease is dedicated to the well, outline each and identify the ownership thereof (both as to working interest and royalty).
3. If more than one lease of different ownership is dedicated to the well, have the interests of all owners been consolidated by communitization, unitization, force-pooling, etc?

☐ Yes ☐ No If answer is "yes," type of consolidation _____

If answer is "no," list the owners and tract descriptions which have actually been consolidated. (Use reverse side of this form if necessary.) _____

No allowable will be assigned to the well until all interests have been consolidated (by communitization, unitization, forced-pooling, or otherwise) or until a non-standard unit, eliminating such interests, has been approved by the Commission.

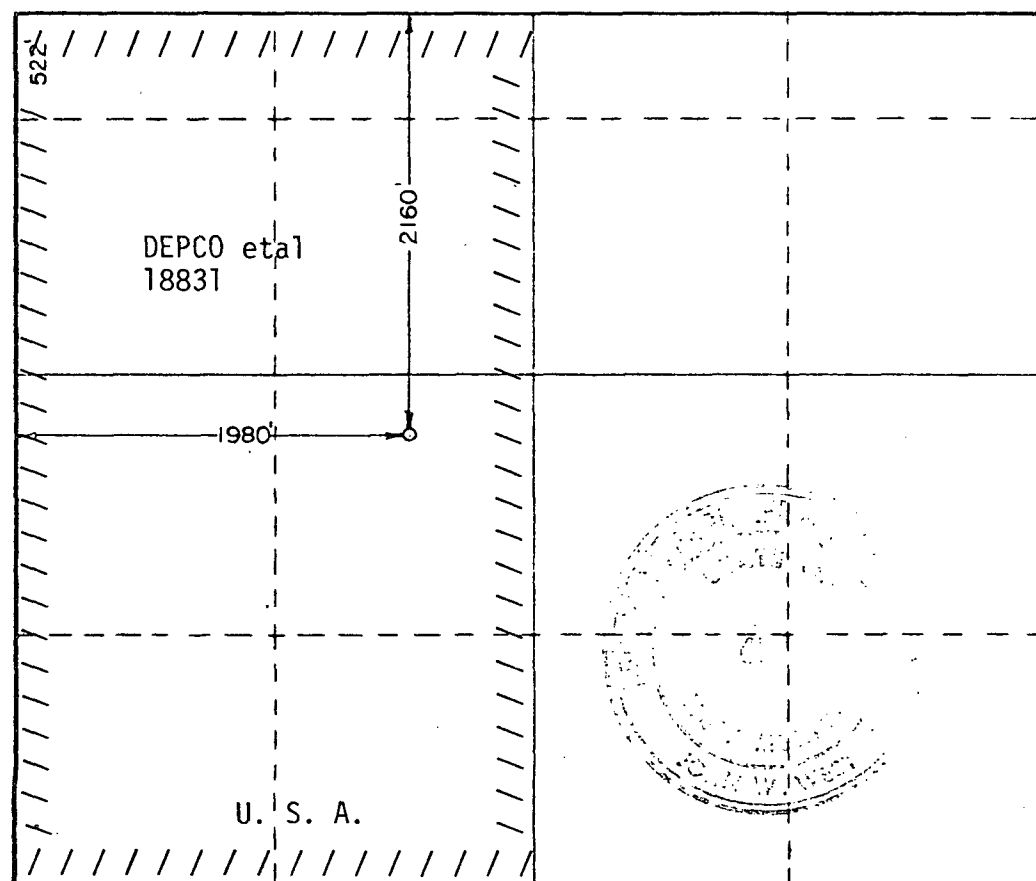

CERTIFICATION

I hereby certify that the information contained herein is true and complete to the best of my knowledge and belief.

R. E. Mathis

Name R. E. MATHIS
Position Regulatory Coordinator
Company Mesa Petroleum Co
Date February 21, 1980

I hereby certify that the well location shown on this plat was plotted from field notes of actual surveys made by me or under my supervision, and that the same is true and correct to the best of my knowledge and belief.

Date Surveyed February 14, 1980
Registered Professional Engineer and/or Land Surveyor <i>John W. West</i>
Certificate No. JOHN W. WEST 676 PATRICK A. ROMERO 6868 Ronald J. Eidson 3239

ATTACHMENT (1)

R 27 E

R 28 E

AMOCO

TENNECO

36

31

T
15
S

T
16
S

MESA

5

4

CHAVES CO.
EDDY CO. DEPCO

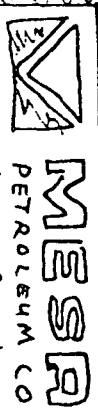
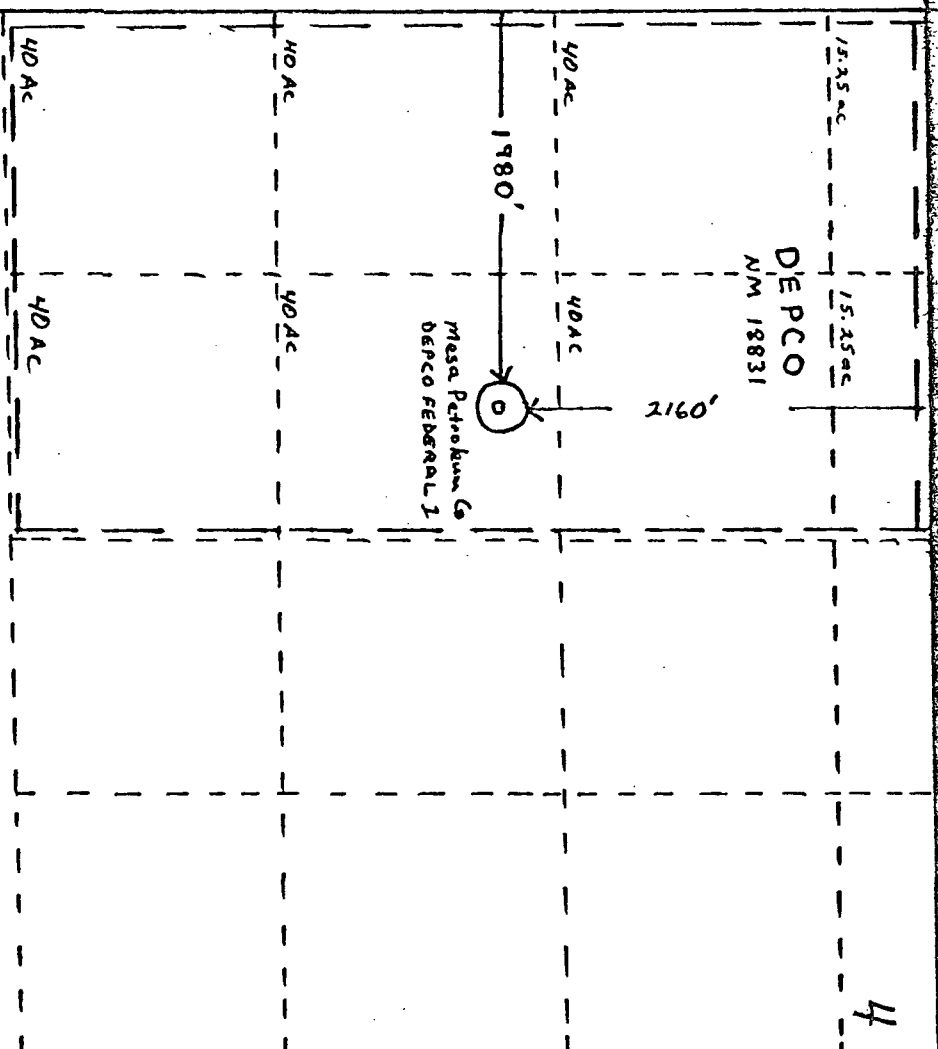

MESA
PETROLEUM CO
New Mexico Division

Acreage Allocation Plat
For Proposed

DEPCO FEDERAL # 1
2160' FWL & 1980 FWL
SEC 4, T16S, R28E
Eddy County, New Mexico

BY NEM

DATE 2-15-80

February 18, 1980

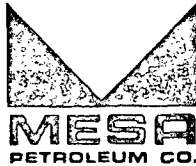

RECEIVED

MAR 4 1980

MESA-PBD

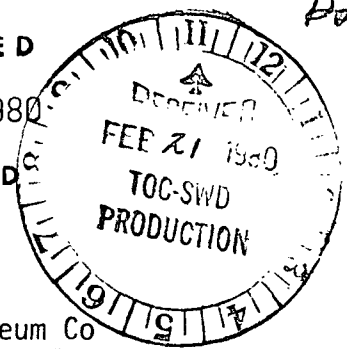

TENNECO Oil Company
Southwestern Division
Suite 200 North
6800 Park Ten Blvd.
San Antonio, Texas 78213

RE: Mesa Petroleum Co
Depco Federal #1
2160' FNL & 1980' FWL
Sec 5, T16S, R28E
Eddy County, New Mexico

Gentlemen:

Mesa Petroleum Co intends to file for an administrative approval for a non-standard gas proration unit for subject captioned well. The well location itself may or may not be orthodox being 2160' from the north and 1980' from the south end lines and 1980' from the nearest side boundary and 330' from section quarter/quarter lines as far as can be determined as illustrated by the attached diagram. 270.5 acres are being dedicated to this well from the northwest part of the section due to survey anomalies.

It is requested that you signify having no objections to approval of the unit or location by signing this letter and returning same to Mesa Petroleum Co in the envelope provided.

Thank you for your kind assistance.

Yours truly,

R. E. MATHIS
Regulatory Coordinator

The undersigned has no objections to the proposal outlined above.

Division Production Manager
Name/Title

February 22, 1980

Date

Tenneco Oil Company Exploration & Production
Company