

El Paso EXPLORATION OIL CONSERVATION DIVISION
COMPANY SANTA FE

P. O. BOX 289
FARMINGTON, NEW MEXICO 87401
PHONE: 505-325-2841

April 20, 1983

Mr. Joe Ramey
New Mexico Oil Conservation Division
Post Office Box 2088
Santa Fe, New Mexico 87501

Re: Mobil Federal 34 #1
Unit ~~M~~ Section 34-24-3
Rio Arriba County, New Mexico
Chacon Dakota Associated Pool

Dear Mr. Ramey:

This is a request by El Paso Exploration Company for administrative approval for a non-standard proration unit for the subject gas well located in the Chacon Dakota Associated Pool.

Reference is made to the special rules and regulations for the Chacon Dakota Associated Pool which states a standard oil proration unit shall be 160 acres and a standard gas proration unit shall be 320 acres.

The Mobil Federal 34 #1 is currently classified as a gas well which would require the 320 acres of W/2 of Section 34-24-3 to be dedicated to this well. However, the Mobil Federal 34 #2, located in the NW/4 Section 34-24-3 is classified as an oil well, which requires 160 acre dedication. Since simultaneous dedication of acreage is prohibited, it is impossible to operate the Mobil Federal 34 #1 on a standard proration unit.

A copy of this application is being submitted to all offset operators by certified mail with a request that they furnish your Santa Fe office with a waiver of objection.

Plats showing the well location and offset ownership are attached.

Sincerely yours,

G. W. Brink
Project Drilling Engineer

GWB:pb

cc: Frank Chavez, New Mexico Oil Conservation Division

NSP 1375
Rule 46 R3353
5-25-83

EL PASO EXPLORATION COMPANY

Well Name Mobil Federal 34 #1 Chacon Dakota

Footage---- 790' FSL, 790' FWL

APPLICATION FOR NON-STANDARD PRORATION UNIT

County Rio Arriba State New Mexico Section 34 Township 24N Range 3W

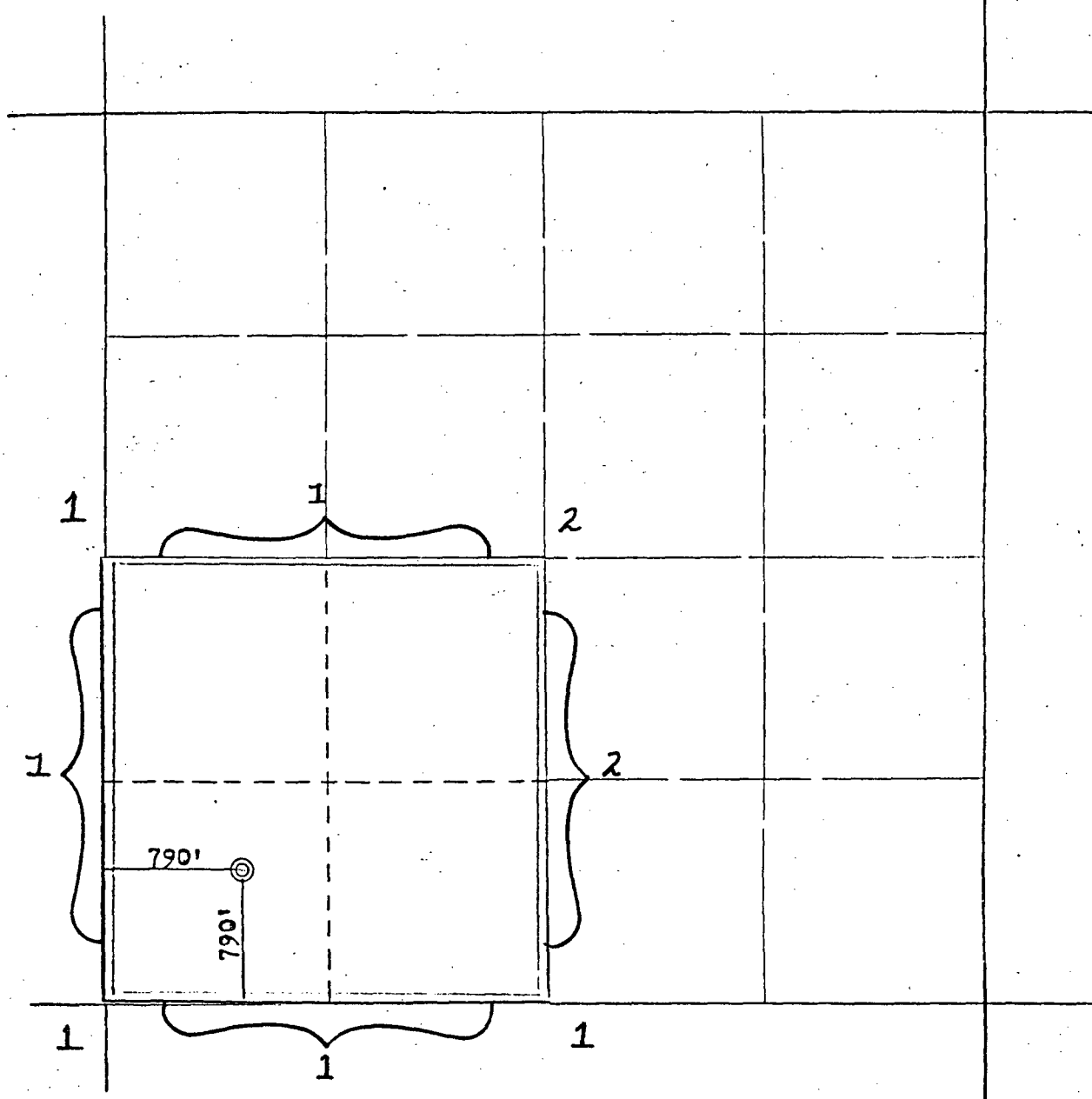

REMARKS: (1) El Paso Exploration Company

(2) Mobil Oil Company

NEW MEXICO OIL CONSERVATION COMMISSION
WELL LOCATION AND ACREAGE DEDICATION PLAT

RECEIVED
APR 25 1983

Form C-102
Supersedes C-128
Effective 1-1-81

All distances must be from the outer boundaries of the Section

Operator ODESSA NATURAL CORPORATION			Lease MOBIL-FEDERAL 34		Well No. OIL CONSERVATION DIVISION SANTA FE	
Unit Letter M	Section 34	Township 24N	Range 3W	County Rio Arriba		
Actual Footage Location of Well: 790 feet from the South line and 790 feet from the West line						
Ground Level Elev. 7092	Producing Formation Dakota		Pool Chacon Dakota Associated		Dedicated Acreage: 160 Acres	

1. Outline the acreage dedicated to the subject well by colored pencil or hachure marks on the plat below.
2. If more than one lease is dedicated to the well, outline each and identify the ownership thereof (both as to working interest and royalty).
3. If more than one lease of different ownership is dedicated to the well, have the interests of all owners been consolidated by communitization, unitization, force-pooling, etc?

☐ Yes ☐ No If answer is "yes," type of consolidation _____

If answer is "no," list the owners and tract descriptions which have actually been consolidated. (Use reverse side of this form if necessary.) _____

No allowable will be assigned to the well until all interests have been consolidated (by communitization, unitization, forced-pooling, or otherwise) or until a non-standard unit, eliminating such interests, has been approved by the Commission.

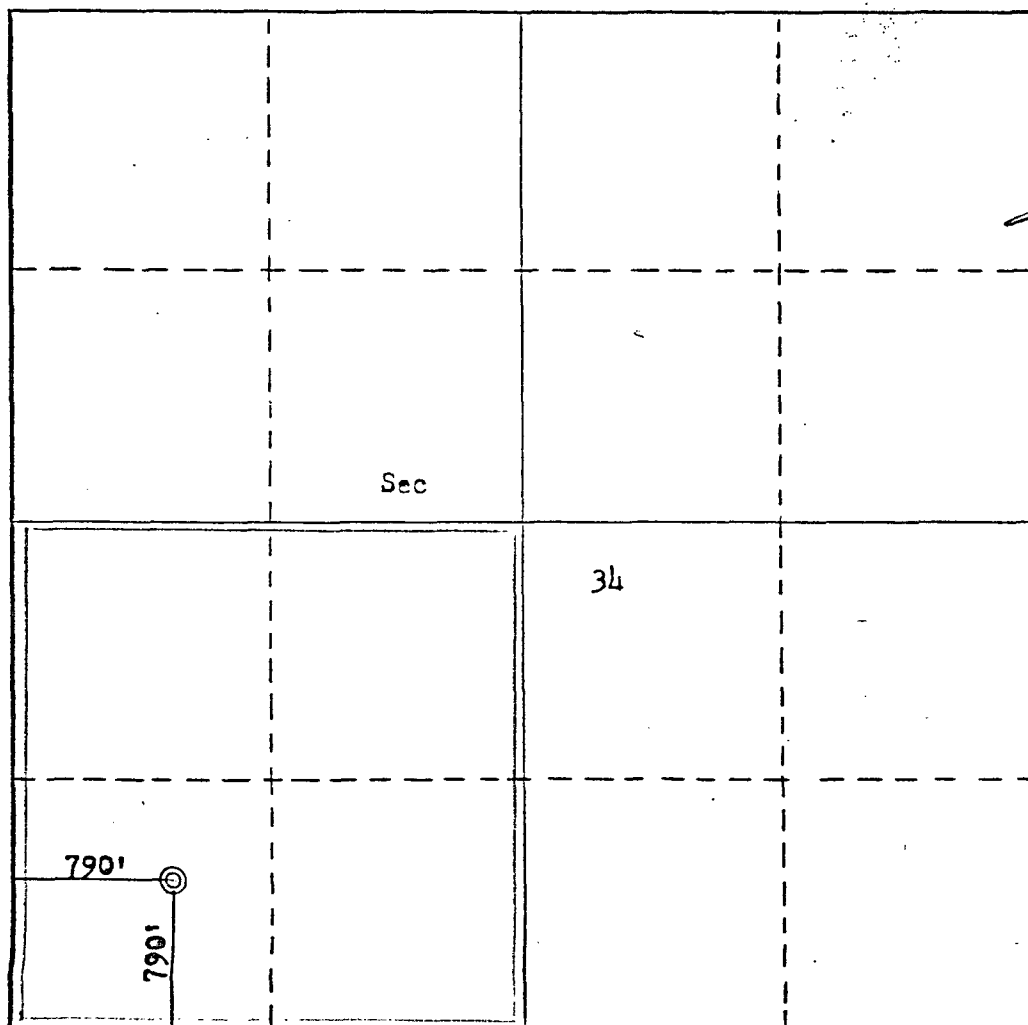

CERTIFICATION

I hereby certify that the information contained herein is true and complete to the best of my knowledge and belief.

Name **Ewell N. Walsh, P.E.**
President

Position
Walsh Engineering &

Company **Production Corp.**
October 20, 1978

Date

I hereby certify that the well location shown on this plat was plotted from field notes of actual surveys made by me or under my supervision, and that the same is true and correct to the best of my knowledge and belief.

Date Surveyed
October 19, 1978

Registered Professional Engineer
and/or Land Surveyor
Fred R. Kerr, Jr.
Certificate No.
3950

0 330 660 990 1320 1650 1980 2310 2640 2970 3300 3630 3960 4290 4620 4950 5280 5610 5940 6270 6600

El Paso EXPLORATION
COMPANY

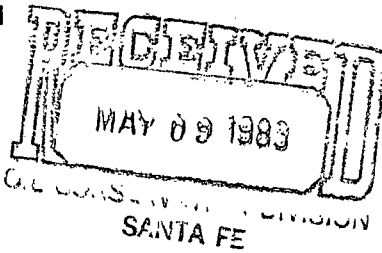

P. O. BOX 289
FARMINGTON, NEW MEXICO 87401
PHONE: 505-325-2841

April 21, 1983

Mobil Oil Company

Re: Non-Standard Proration Unit
Chacon Dakota Associated Pool

Gentlemen:

El Paso Exploration Company has requested administrative approval for a non-standard proration unit in the Chacon Dakota Associated Pool for its Mobil Federal 34 #1 well located in the SW/4 Section 34, T-24-N, R-3-W, Rio Arriba County, New Mexico.

The Mobil Federal 34 #1 is currently classified as a gas well which would require the 320 acres of the W/2 of Section 34, T-24-N, R-3-W to be dedicated to this well. However, the Mobil Federal 34 #2, located in the NW/4 of Section 34, T-24-N, R-3-W, is classified as an oil well which requires a 160 acre dedication. Since pool rules state that simultaneous dedication of acreage is prohibited, it is impossible to operate the Mobil Federal 34 #1 on a standard proration unit.

In compliance with New Mexico Oil Conservation Division rules, we are notifying you, as operator of an offsetting proration unit, of our application for administrative approval for a non-standard proration unit on this well. Enclosed are three copies of this letter. If there is no objection to this application, please sign and return one copy to the New Mexico Oil Conservation Division, P.O. Box 2088, Santa Fe, New Mexico 87501; one copy to El Paso Exploration Company; and keep one copy for your files.

Plats showing the well location and offset ownership are attached.

Yours truly,

G. W. Brink

G. W. Brink
Project Drilling Engineer

GWB:pb

MOBIL PRODUCING TX & NM INC.

WAIVER

_____ hereby waives objection to El Paso Exploration Company's application for the non-standard proration unit for their abovementioned well.

by: *W.B. Simmons*

date: _____

for J. A. Morris
Regulatory Engineering Supervisor