

EXXON COMPANY, U.S.A.

POST OFFICE BOX 1600 • MIDLAND, TEXAS 79702-1600

December 19, 1985

PRODUCTION DEPARTMENT
SOUTHWEST/ROCKY MOUNTAIN DIVISION

Judy Basswell
915-696-4472

F. F. Hardison "B"
Well Nos. 7 and 8
Section 27, T21S, R37E
Lea County, New Mexico

Mr. Richard L. Stamets, Director
State of New Mexico
Oil Conservation Commission
Energy and Minerals Department
P. O. Box 2088
Santa Fe, New Mexico 87501

The F. F. Hardison "B" Well No. 6 was recently recompleted as an oil well in the Blinebry (Blinebry) Pool, which requires a 40 acre proration unit. Since special rules for the Blinebry Oil and Gas Pool prohibit dual dedication of acreage to oil and gas, it will be necessary to reduce the gas proration unit dedicated to the F. F. Hardison "B" Well Nos. 7 and 8.

Exxon Corporation respectfully requests administrative approval for the present 160 acre proration unit shared by F. F. Hardison "B" Well Nos. 7 and 8 to be reduced to a non-standard 120 acre proration unit as shown on the attached plats. Form C-102 is attached for each well. Both wells are dually completed in the Blinebry and Drinkard pools as gas wells.

As required by Rule 104.II., the non-standard unit consists of contiguous quarter-quarter sections and lies within a single governmental quarter section.

Exxon Corporation is notifying all offset operators of our application for a non-standard proration unit by copy of this letter. The following offset operators have been notified by certified mail:

Conoco, Inc., Director of Regulatory Affairs, 5 Greenway Plaza East, Houston, TX 77046
Marathon Oil Company, P. O. Box 552, Midland, Texas 79702
Mobil Producing Texas and N. Mexico, Inc., 9 Greenway Plaza, Suite 2700
Houston, Texas 77046
Texaco Producing, Inc. (Getty) P. O. Box 1231, Midland, Texas 79702
Arco Oil and Gas Company, P. O. Box 521, Tulsa, OK 74102

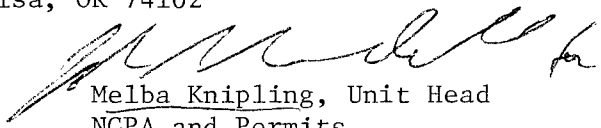
Melba Knipling, Unit Head
NGPA and Permits

MCK:dc
Attachment: Form C-102
Ownership Map
cc: NMOCC District Office, Hobbs, NM

Exxon-Lse No. 52267

NEW MEXICO OIL CONSERVATION COMMISSION
WELL LOCATION AND ACREAGE DEDICATION PLATForm C-102
Supersedes C-128
Effective 1-1-65

Federal Lse. No. All distances must be from the outer boundaries of the Section.

Operator Exxon Corporation		Lease F. F. Hardison "B"		Well No. 7
Unit Letter P	Section 27	Township 21-S	Range 37-E	County Lea
Actual Footage Location of Well: 660 feet from the South line and 660 feet from the East line				
Ground Level Elev. 3393	Producing Formation Upper Clearfork	Pool Blinebry	Dedicated Acreage: 120 Acres	

1. Outline the acreage dedicated to the subject well by colored pencil or hachure marks on the plat below. Well No. 7 and Well No. 8 to share 120 acre proration unit.
2. If more than one lease is dedicated to the well, outline each and identify the ownership thereof (both as to working interest and royalty).
3. If more than one lease of different ownership is dedicated to the well, have the interests of all owners been consolidated by communitization, unitization, force-pooling, etc?

☐ Yes ☐ No If answer is "yes," type of consolidation _____

If answer is "no," list the owners and tract descriptions which have actually been consolidated. (Use reverse side of this form if necessary.) _____

No allowable will be assigned to the well until all interests have been consolidated (by communitization, unitization, forced-pooling, or otherwise) or until a non-standard unit, eliminating such interests, has been approved by the Commission.

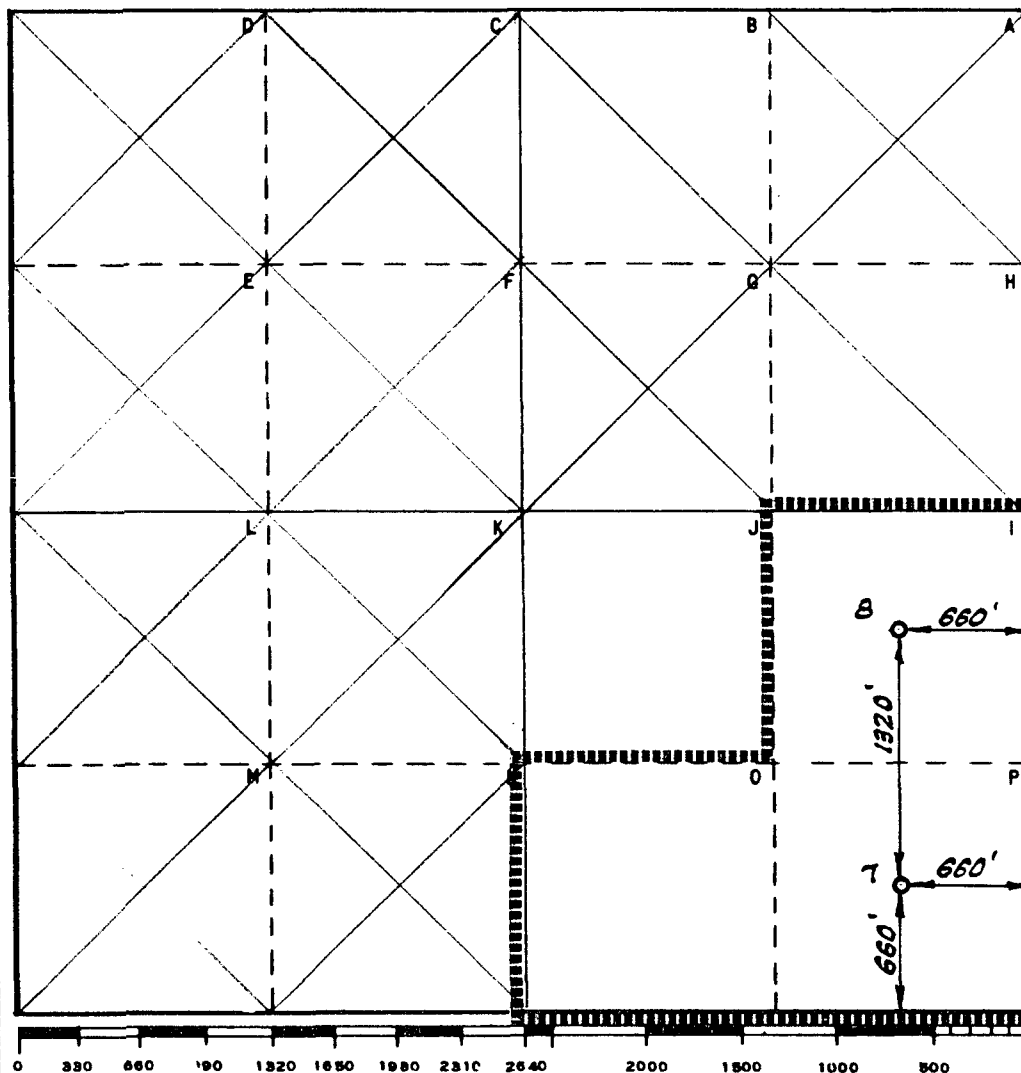

CERTIFICATION

I hereby certify that the information contained herein is true and complete to the best of my knowledge and belief.

Name
Melba Kripling
Position
Proration Specialist
Company Exxon Corporation
Box 1600 Midland, Texas
Date
11-2-76

I hereby certify that the well location shown on this plat was plotted from field notes of actual surveys made by me or under my supervision, and that the same is true and correct to the best of my knowledge and belief.

Date Surveyed
June 5, 1974
Registered Professional Engineer
and/or Land Surveyor
H. S. Westerfeld
Certificate No.
1382

4 Miles SW of Eunice, New Mexico

C.E. Sec. File No. A-436 B

Exxon Use No. 52267

NEW MEXICO OIL CONSERVATION COMMISSION

State Use No. _____

WELL LOCATION AND ACREAGE DEDICATION PLAT

Form C-102
Supersedes C-128
Effective 1-1-65

Federal Use No. _____

All distances must be from the outer boundaries of the Section.

Operator Exxon Corporation		Lease F. F. Hardison "B"		Well No. 8
Unit Letter I	Section 27	Township 21-S	Range 37-E	County Lea
Actual Footage Location of Well: 1980 feet from the South line and 660 feet from the East line				
Ground Level Elev. 3393	Producing Formation Upper Clearfork	Pool Blinebry	Dedicated Acreage: 120 Acres	

1. Outline the acreage dedicated to the subject well by colored pencil or hatchure marks on the plat below. Well No. 7 and Well No. 8 to share 120 acre proration unit.
2. If more than one lease is dedicated to the well, outline each and identify the ownership thereof (both as to working interest and royalty).
3. If more than one lease of different ownership is dedicated to the well, have the interests of all owners been consolidated by communitization, unitization, force-pooling, etc?

☐ Yes ☐ No If answer is "yes," type of consolidation _____

If answer is "no," list the owners and tract descriptions which have actually been consolidated. (Use reverse side of this form if necessary.) _____

No allowable will be assigned to the well until all interests have been consolidated (by communitization, unitization, forced-pooling, or otherwise) or until a non-standard unit, eliminating such interests, has been approved by the Commission.

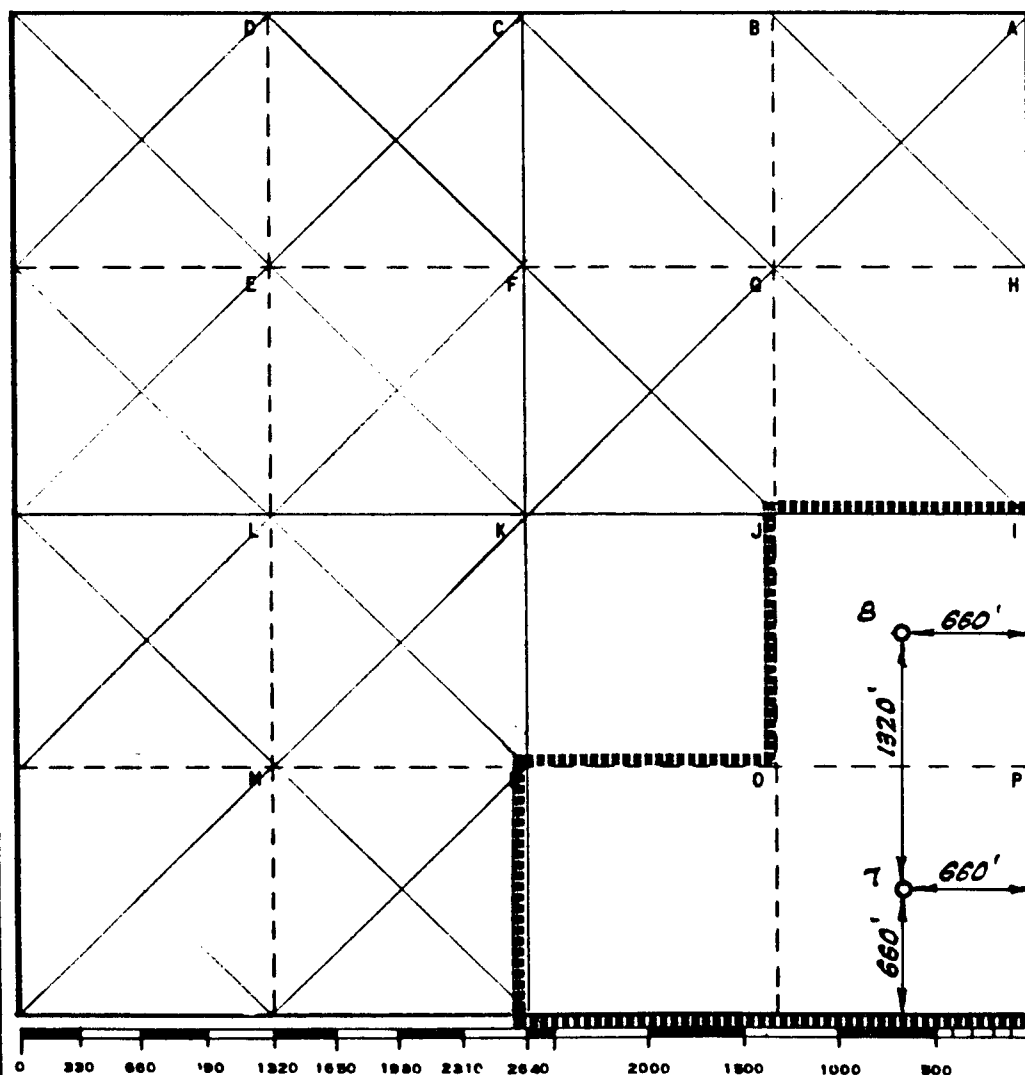

CERTIFICATION

I hereby certify that the information contained herein is true and complete to the best of my knowledge and belief.

Name

Melba Knippling

Position

*Proration Specialist*Company **Exxon Corporation****Box 1600 Midland, Texas**

Date

11-2-76

I hereby certify that the well location shown on this plat was plotted from field notes of actual surveys made by me or under my supervision, and that the same is true and correct to the best of my knowledge and belief.

Date Surveyed

June 5, 1974Registered Professional Engineer
and/or Land Surveyor*H. S. Wenterfeld*

Certificate No.

1382

[illegible]