

T. H. McELVAIN OIL & GAS PROPERTIES

T. H. McELVAIN, JR., MANAGER

220 SHELBY STREET

P. O. Box 2148

CATHERINE B. McELVAIN

CATHERINE M. HARVEY

T. H. McELVAIN, JR.

SANTA FE, NEW MEXICO 87504-2148

January 21, 1988

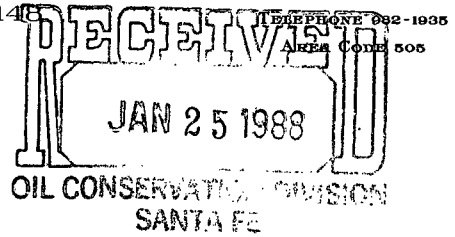

Mr. William J. LeMay, Director
New Mexico Oil Conservation Division
Post Office Box 2088
Santa Fe, New Mexico 87504-2088

Re: Application for Non-Standard Proration Unit
T. H. McElvain Oil & Gas Properties
FD #1 Gallup Dakota
SE/4 NE/4 Section 1-T25N-R3W NMPM
Rio Arriba County, New Mexico

Dear Mr. LeMay:

Pursuant to Oil Conservation Division Order #R-8544, effective December 1, 1987, which abolished the Ojito Gallup-Dakota Pool and extended the West Lindrith Gallup-Dakota Pool, T. H. McElvain Oil & Gas Properties hereby requests approval of a 40-acre Non-Standard Oil Proration Unit consisting of the SE/4 NE/4 of Section 1, T25N, R3W, NMPM, Rio Arriba County, New Mexico, in the West Lindrith Gallup-Dakota Oil Pool to be dedicated to the FD #1 well drilled at a standard location thereon.

We believe the entire proration unit is productive of oil from the West Lindrith Gallup-Dakota Oil Pool.

A copy of this application is being sent this day by certified mail to the operators offsetting the proposed unit as shown on the enclosed plat and list.

Should you require any further information, please advise.

Very truly yours,

T. H. McELVAIN OIL & GAS PROPERTIES

George B. Broome
Geological Engineer

:rrw

Enclosures

xc: Oil Conservation Division, District III (2)
Offset Operators (as listed in application) (1)

R 3 W

R 2 W

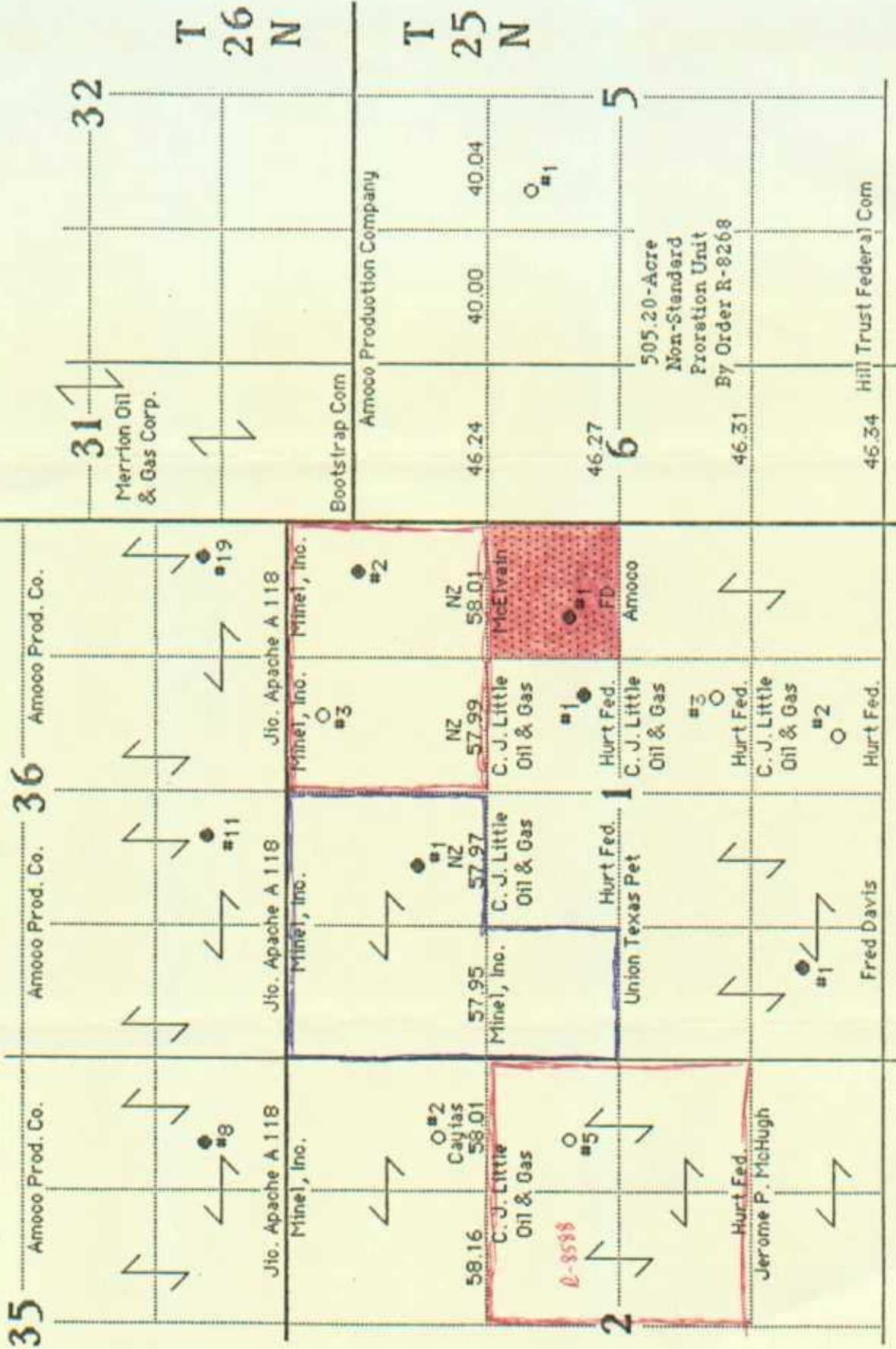

T. H. McElvain Oil & Gas Properties
FD #1 Gallup Dakota
SE/4 NE/4 Section 1-T25N-R3W NMPM
Rio Arriba County, New Mexico

OFFSET OPERATORS

AMOCO PRODUCTION COMPANY
Post Office Box 800
Denver, Colorado 80202

✓ CURTIS J LITTLE OIL & GAS
Post Office Box 1258
Farmington, New Mexico 87499

✓ MERRION OIL & GAS PROPERTIES
Post Office Box 840
Farmington, New Mexico 87499

↓ MINEL, INC.
308 Washington, S.E.
Albuquerque, New Mexico 87108

✓ UNION TEXAS PETROLEUM CORPORATION
375 U.S. Highway 64
Farmington, New Mexico 87401

OIL CONSERVATION DIVISION

P. O. BOX 2088

SANTA FE, NEW MEXICO 87501

WELL COMPLETION OR RECOMPLETION REPORT AND LOG

NO. OF COPIES RECEIVED	
DISTRIBUTION	
SANTA FE	
FILE	
U.S.G.S.	
LAND OFFICE	
OPERATOR	

5a. Indicate Type of Lease	
State <input type="checkbox"/>	Fee <input checked="" type="checkbox"/>
5. State Oil & Gas Lease No.	

1a. TYPE OF WELL OIL WELL <input checked="" type="checkbox"/> GAS WELL <input type="checkbox"/> DRY <input type="checkbox"/> OTHER <input type="checkbox"/>		7. Unit Agreement Name	
b. TYPE OF COMPLETION NEW WELL <input checked="" type="checkbox"/> WORK OVER <input type="checkbox"/> DEEPEN <input type="checkbox"/>		8. Farm or Lease Name FD	
2. Name of Operator T. H. McElvain Oil & Gas Properties		9. Well No. 1	
3. Address of Operator P. O. Box 2148, Santa Fe, NM 87504-2148		10. Field and Pool, or Wildcat Ojito Gallup-Dakota	
4. Location of Well UNIT LETTER <u>H</u> LOCATED <u>2840</u> FEET FROM THE <u>North</u> LINE AND <u>950</u> FEET FROM THE <u>East</u> LINE OF SEC. <u>1</u> TWP. <u>25N</u> RGE. <u>3W</u> NMPM		12. County Rio Arriba	
15. Date Spudded 5-22-87	16. Date T.D. Reached 6-3-87	17. Date Compl. (Ready to Prod.) 7-25-87	18. Elevations (DF, RKB, RT, GR, etc.) 7347 KB
19. Elev. Casinghead 7336		20. Total Depth 8350	
21. Plug Back T.D. 8330		22. If Multiple Compl., How Many N/A	
23. Intervals Drilled By Rotary Tools 0-8350		24. Producing Interval(s), of this completion - Top, Bottom, Name Gallup 6820-7504 Dakota 8065-8227	
25. Was Directional Survey Made Yes		26. Type Electric and Other Logs Run DIL-SFL-CAL-GR-SP, FDC-CNL, BHTV, GR-CBL-CCL	
27. Was Well Cored No		28. CASING RECORD (Report all strings set in well)	
CASING SIZE	WEIGHT LB./FT.	DEPTH SET	HOLE SIZE
9 5/8"	36#, K-55	210	12 1/4"
5 1/2"	17# N-80	8342	8 3/4"-5521
	17# K-55		7 7/8" to TD
	15.5# J-55		
29. LINER RECORD		30. TUBING RECORD	
SIZE	TOP	BOTTOM	SACKS CEMENT
			SCREEN
			2 7/8"
			7508
			Cast iron bridge plug-7600'
31. Perforation Record (Interval, size and number) 8065, 8067, 8076, 8078, 8127, 8129, 8169, 8170, 8214-27, .42" dia, 22 holes total for Dakota. See Attachment for Gallup perfs.		32. ACID, SHOT, FRACTURE, CEMENT SQUEEZE, ETC. DEPTH INTERVAL 8065-8227 AMOUNT AND KIND MATERIAL USED 1100 gal 15% HCL + 30 balls Frac w/89964 gal x-link 30 lb gelled 2% KCL wtr+87,172# 20/40 sd.(see attachment for Gallup)	
33. PRODUCTION			
Date First Production 8-5-87	Production Method (Flowing, gas lift, pumping - Size and type pump) Pumping 2 1/2" x 1 1/2" x 16' x 18' x 20' RHAC		Well Status (Prod. or Shut-in) Prod.
Date of Test 8-6-87	Hours Tested 12	Choke Size 64/64th	Prod'n. For Test Period Oil - Bbl. 30
Flow Tubing Press. 150 psi	Casing Pressure 150 psi	Calculated 24-Hour Rate Oil - Bbl. 60	Gas - MCF 25
			Water - Bbl. *75
			Gas - Oil Ratio
			Oil Gravity - API (Corr.)
34. Disposition of Gas (Sold, used for fuel, vented, etc.) Vented-will be sold			Test Witnessed By Joe Elledge
35. List of Attachments Supplement for Sections 28, 31 & 32 *frac water			
36. I hereby certify that the information shown on both sides of this form is true and complete to the best of my knowledge and belief.			
SIGNED <u>George B. Broome</u>		TITLE <u>Geological Engineer</u>	
		DATE <u>8-6-87</u>	

STATE OF NEW MEXICO
ENERGY AND MINERALS DEPARTMENT

OIL CONSERVATION DIVISION

P. O. BOX 2088

SANTA FE, NEW MEXICO 87502 1987

APPROVAL EXPIRES 10-4-87
UNLESS DRILLING IS COMMENCED.
SPUD NOTICE MUST BE SUBMITTED
WITHIN 10 DAYS

OIL CON. DIV.
DIST. 3

Form C-101
Revised 10-1-78

NO. OF COPIES RECEIVED	
DISTRIBUTION	
SANTA FE	
FILE	
U.S.G.S.	
LAND OFFICE	
OPERATOR	

5A. Indicate Type of Lease
STATE ☐ FEE ☒

5. State Oil & Gas Lease No.

APPLICATION FOR PERMIT TO DRILL, DEEPEN, OR PLUG BACK

a. Type of Work

b. Type of Well

DRILL ☒

DEEPEN ☐

PLUG BACK ☐

OIL WELL ☒ GAS WELL ☐ OTHER ☐

SINGLE ZONE ☒

MULTIPLE ZONE ☐

Name of Operator

T. H. McElvain Oil & Gas Properties

APR 10 1987

Address of Operator

P. O. Box 2148, Santa Fe, NM 87504-2148

Location of Well

UNIT LETTER H

LOCATED 2840

FEET FROM THE

North

LINE

950'

FEET FROM THE East

LINE OF SEC. 1

TWP. 25N

RGE. 3W

NMSPM

7. Unit Agreement Name

8. Farm or Lease Name

FD

9. Well No.

#1

10. Field and Pool, or Wildcat

Ojito Gallup-Dakota

12. County

Rio Arriba

19. Proposed Depth

8400'±

19A. Formation

Dakota

20. Rotary or C.T.

Rotary

Elevations (show whether DF, RT, etc.)

7335 GL

21A. Kind & Status Plug. Bond

One Well

21B. Drilling Contractor

22. Approx. Date Work will start

4-15-87

PROPOSED CASING AND CEMENT PROGRAM

SIZE OF HOLE	SIZE OF CASING	WEIGHT PER FOOT	SETTING DEPTH	SACKS OF CEMENT	EST. TOP
12 1/4"	8 5/8" K-55	24#	200'	150 sks ClB+2%CaCl	Circulated
7 7/8"	4 1/2" K-55	11.60#	8400'	2168 sks 3 stgs.	Circulated

Propose to drill 12 1/4" hole to approximately 200' using natural mud as a circulating medium. Run new 7/8", 24#, K-55 casing to TD & cement with approx 150 sks of Class B+2%CaCl circulated to the surface

BOP to be installed after surface casing is cemented. Prior to drilling out of surface casing, BOP casing to be tested to OCD specifications. All subsequent work will be conducted through BOP. Drill 7 7/8" hole to TD of approx 8400' using a low solid, non-dispersed mud as a circulating med-

Run Dual Induction SFL Log and Compensated Neutron Formation Density Log prior to running 4 1/2", 11.6# casing to TD with DV tools at approx 3600' and 6400'.

Cement 4 1/2" csg to surface in three stages as follows: 1st stage-590 cu. ft. 50/50 Poz w/ 2%gel, 10% salt & 6 1/2 #/sk. gilsonite. 2nd stage-760 cu ft 65/35 Poz w/3% gel, 10% salt, 10% cal seal and 12 1/2 # gilsonite/sk. Tail in with 70 cu ft of Class B neat. 3rd stage-1525 cu ft 65/35 Poz w/6% gel and 1 1/2 # of flake/sk. Tail in w/ 70 cu ft Class B neat circulated to the surface.

Drill out DV tools & pressure test casing

Perforate and fracture Gallup & Dakota zones. Clean up well. Run new 2 3/8" EUE, 4.7# J-55 tubing in the Dakota. Run pump & rods if necessary. Set pumping unit and tanks.

Test the well and connect to a gathering system.

Gas from this well is dedicated to a transporter.

ABOVE SPACE DESCRIBE PROPOSED PROGRAM; IF PROPOSAL IS TO DEEPEN OR PLUG BACK, GIVE DATA ON PRESENT PRODUCTIVE ZONE AND PROPOSED NEW PRODUCTION ZONE. GIVE BLOWOUT PREVENTER PROGRAM, IF ANY.

I hereby certify that the information above is true and complete to the best of my knowledge and belief.

George B. Broome

Title Geological Engineer

Date 4-1-87

(This space for State Use)

APPROVED BY Emilio Burch

TITLE DEPUTY OIL & GAS INSPECTOR, DIST. #3

DATE APR 07 1987

CONDITIONS OF APPROVAL, IF ANY:

All distances must be from the outer boundaries of the Section.

Owner T. H. McElvain Oil & Gas Properties			Lease FD		Well No. 1
Letter H	Section 1	Township 25 North	Range 3 West	County Rio Arriba	
Well Footage Location of Well					
2840 feet from the North line and		950 feet from the East line			
and Level Elev. 7335	Producing Formation Gallup-Dakota		Pool Ojito Gallup-Dakota		Dedicated Acreage 40 Acres

1. Outline the acreage dedicated to the subject well by colored pencil or hatchure marks on the plat below.
2. If more than one lease is dedicated to the well, outline each and identify the ownership thereof (both as to working interest and royalty).
3. If more than one lease of different ownership is dedicated to the well, have the interests of all owners been consolidated by communitization, unitization, force-pooling, etc? NA

☐ Yes ☐ No If answer is "yes," type of consolidation _____

If answer is "no," list the owners and tract descriptions which have actually been consolidated. (Use reverse side of this form if necessary.) _____

No allowable will be assigned to the well until all interests have been consolidated (by communitization, unitization, forced-pooling, or otherwise) or until a non-standard unit, eliminating such interests, has been approved by the Division.

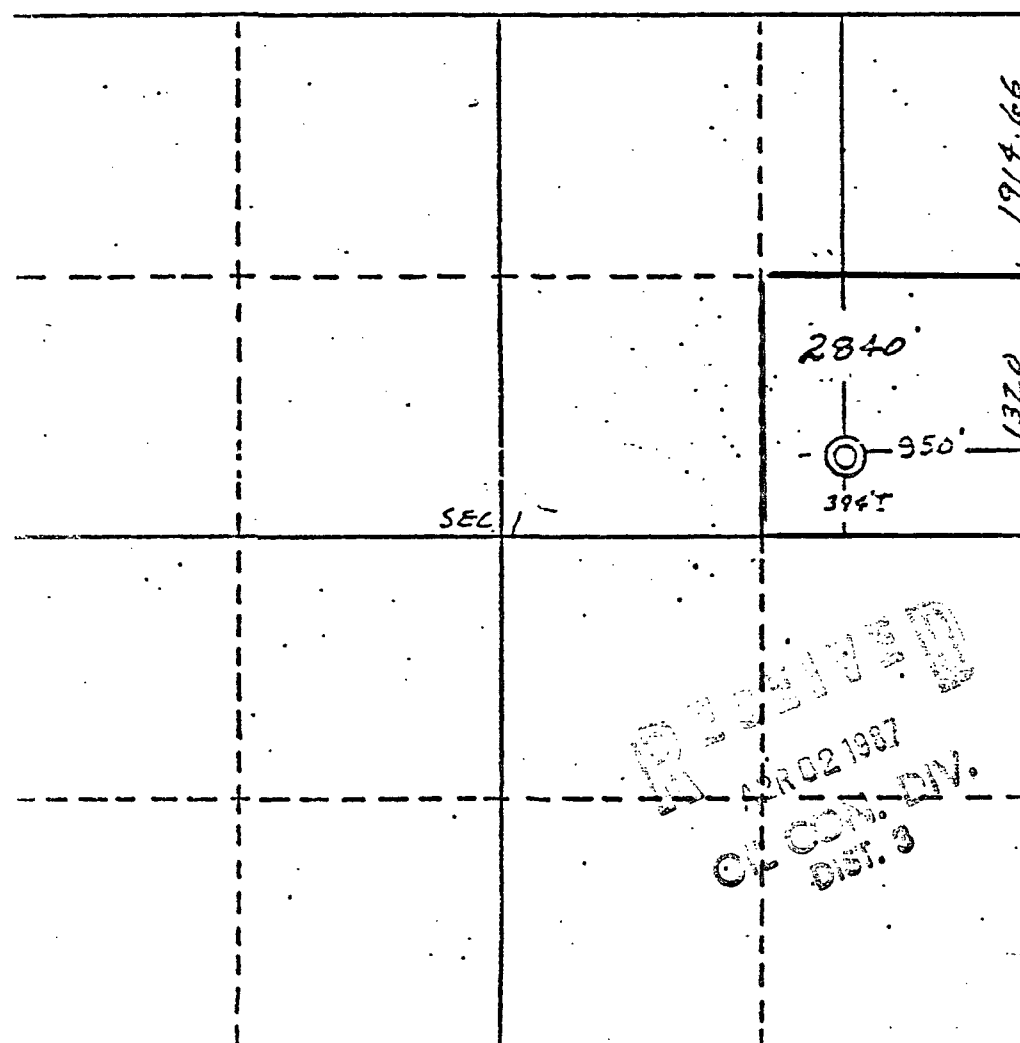

CERTIFICATION

I hereby certify that the information contained herein is true and complete to the best of my knowledge and belief.

George B. Broome
George B. Broome

Name

Geological Engineer

Position

T. H. McElvain Oil & Gas

Company Properties

April 1, 1987

Date

I hereby certify that the well location shown on this plat was obtained from field notes of actual surveys made by me or under my supervision, and that the same is true and correct to the best of my knowledge and belief.

Date Surveyed

January 13, 1987

Registered Professional Engineer
and/or Land Surveyor

Edgar L. Risenhoover
Edgar L. Risenhoover

Certificate No. 5979

Edgar L. Risenhoover, L.S.

Mr. William J. LeMay
Oil Conservation Division
Post Office Box 2088
Santa Fe, New Mexico 87504-2088

Re: Waiver of Objection
Application for Non-Standard Proration Unit
T. H. McElvain Oil & Gas Properties
FD #1 Gallup Dakota
SE/4 NE/4 Section 1-T25N-R3W NMPM
Rio Arriba County, New Mexico

Dear Mr. LeMay

We, as an offset owner, hereby waive objection to the application filed on behalf of T. H. McElvain Oil & Gas Properties for a 40-acre non-standard proration unit as set out in the caption above, lying within the West Lindrith Gallup-Dakota Oil Pool.

Very truly yours,

Company:

UNION TEXAS PETROLEUM

By: W K Cooper

Date: 1/25/87

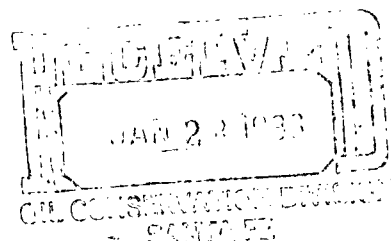

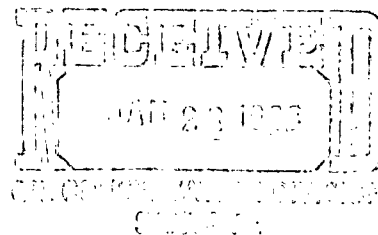

Mr. William J. LeMay
Oil Conservation Division
Post Office Box 2088
Santa Fe, New Mexico 87504-2088

Re: Waiver of Objection
Application for Non-Standard Proration Unit
T. H. McElvain Oil & Gas Properties
FD #1 Gallup Dakota
SE/4 NE/4 Section 1-T25N-R3W NMPM
Rio Arriba County, New Mexico

Dear Mr. LeMay

We, as an offset owner, hereby waive objection to the application filed on behalf of T. H. McElvain Oil & Gas Properties for a 40-acre non-standard proration unit as set out in the caption above, lying within the West Lindrith Gallup-Dakota Oil Pool.

Very truly yours,

Company:

Merrion Oil & Gas Corp.

By: 

Date: January 26, 1988

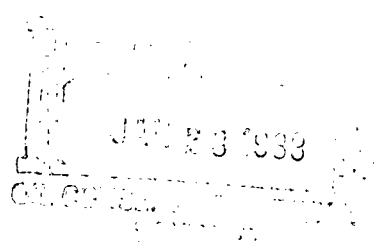

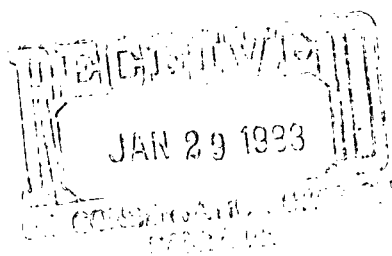

Mr. William J. LeMay
Oil Conservation Division
Post Office Box 2088
Santa Fe, New Mexico 87504-2088

Re: Waiver of Objection
Application for Non-Standard Proration Unit
T. H. McElvain Oil & Gas Properties
FD #1 Gallup Dakota
SE/4 NE/4 Section 1-T25N-R3W NMPM
Rio Arriba County, New Mexico

Dear Mr. LeMay

We, as an offset owner, hereby waive objection to the application filed on behalf of T. H. McElvain Oil & Gas Properties for a 40-acre non-standard proration unit as set out in the caption above, lying within the West Lindrith Gallup-Dakota Oil Pool.

Very truly yours,

Company:

Mend Inc

By: J. L. Cayser

Date: 1/25/33

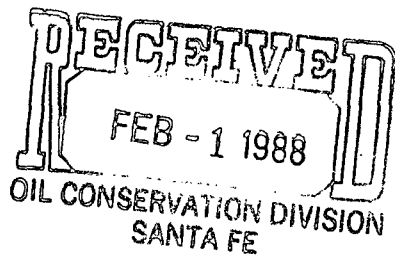

Mr. William J. LeMay
Oil Conservation Division
Post Office Box 2088
Santa Fe, New Mexico 87504-2088

Re: Waiver of Objection
Application for Non-Standard Proration Unit
T. H. McElvain Oil & Gas Properties
FD #1 Gallup Dakota
SE/4 NE/4 Section 1-T25N-R3W NMPM
Rio Arriba County, New Mexico

Dear Mr. LeMay

We, as an offset owner, hereby waive objection to the application filed on behalf of T. H. McElvain Oil & Gas Properties for a 40-acre non-standard proration unit as set out in the caption above, lying within the West Lindrith Gallup-Dakota Oil Pool.

Very truly yours,

Company:

CURTIS J. LITTLE OIL & GAS

By: 

Date: 1-28-88