

ARCO Oil and Gas Company  
Central District  
Post Office Box 1610  
Midland, Texas 79702  
Telephone 915 688 5200



March 7, 1989

Mr. William J. LeMay  
New Mexico Oil Conservation Division  
P. O. Box 2088  
Santa Fe, New Mexico 87501



RE: Application for Non-Standard Proration  
W. C. Roach #1, #6, and #7  
W/2 Section 21, T20S, R37E  
Eumont Gas Pool

Dear Mr. LeMay:

ARCO Oil and Gas Company respectfully requests administrative approval to form a non-standard 320-acre gas proration unit consisting of the west half of Section 21, T20S, R37E as per the provisions of Rule 2 (a) 4 of Division Order No. R-8170, as amended. The attached Forms C-102 identify both the current and the proposed acreage dedication.

ARCO Oil and Gas Company also respectfully requests administrative approval of the unorthodox locations of the W. C. Roach #1 and #6. The W. C. Roach #1 was drilled in 1936 as a Grayburg oil producer. It was recompleted in 1954 as a dual producer from the Eunice Monument oil and Eumont gas. The dual completion of this well was approved in June 1954 as DC-127. At that time, the Eumont pool rules concerning orthodox locations were not established. The W. C. Roach #6 was drilled in 1980 as a Eumont gas producer. For a non-standard 160-acre gas proration unit, this well is at an orthodox location. However, due to the change to a 320-acre gas proration unit, it will be at an unorthodox location.

ARCO Oil and Gas Company believes approval of this request will be in the interest of conservation, will protect correlative rights, and will allow for a more complete recovery of Eumont gas reserves from the subject acreage.

ARCO Oil and Gas Company is notifying the offset operators of this application by certified mail. Copies of the return receipts will be forwarded to you when they are received. If you need further information, please call me at (915) 688-5734.

Thank you for your consideration.

Josh C. Fu  
Engineer

JCF:ls

attachments

New Mexico Oil Conservation Division  
P. O. Box 1980  
Hobbs, New Mexico 88240

Amerada Hess Corp.  
P. O. Box 2040  
Tulsa, Oklahoma 74102  
Attn: R. W. Mullins

Amoco Production Company  
P. O. Box 3092  
Houston, Texas 77001  
Attn: S. A. Reinert

Chevron U.S.A., Inc.  
P. O. Box 1150  
Midland, Texas 79702  
Attn: M. C. Gullledge

Conoco, Inc.  
P. O. Box 1959  
Midland, Texas 79702  
Attn: Alex Yarsa

Doyle Hartman  
P. O. Box 10426  
Midland, Texas 79702

John H. Hendrix Corporation  
525 Midland Tower  
Midland, Texas 79701

Marathon Oil Company  
P. O. Box 552  
Midland, Texas 79701  
Attn: Jim Nichols

Mobil Prod. Tx & NM, Inc.  
P. O. Box 633  
Midland, Texas 79702  
Attn: Jt. Int. Sec.

Sun Exploration & Production Co.  
P. O. Box 1861  
Midland, Texas 79702  
Attn: Joint Operations

Texaco Producing Inc.  
P. O. Box 3109  
Midland, Texas 79702  
Attn: Joint Operations Manager

Estoril Producing Corp.  
400 Illinois, #16  
Midland, Texas 79701

R. B. Honeyman  
P. O. Box 1683  
Hobbs, New Mexico 88240

MKA Oil Properties  
One First City  
Suite 505  
Midland, Texas 79701

## Lea County, New Mexico

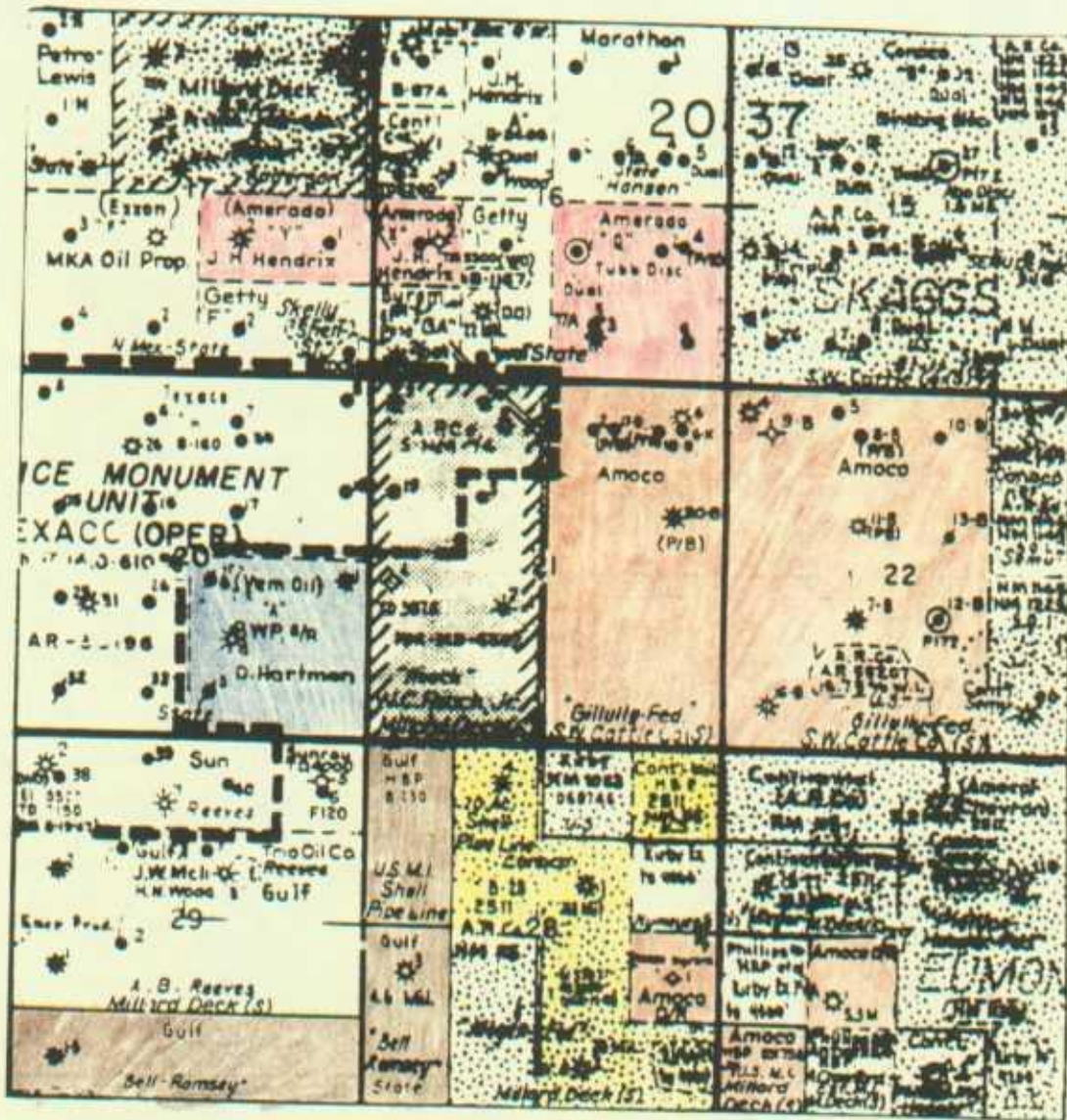

## OFFSET OPERATORS

Amerada Hess

Amoco

Chevron

Conoco

Estoril Producing Corp.

Doyle Hartman

John H. Hendrix

R. B. Honeyman, Jr.

MKA Oil Properties

Marathon Oil Co.

Mobil Producing Tx & N M

Sun Expl. & Prod. Co.

Texaco Producing



Submit to Appropriate  
District Office  
State Lease - 4 copies  
Fee Lease - 3 copies

State of New Mexico  
Energy, Minerals and Natural Resources Department

Form C-102  
Revised 1-1-89

OIL CONSERVATION DIVISION

P.O. Box 2088  
Santa Fe, New Mexico 87504-2088

DISTRICT I  
P.O. Box 1980, Hobbs, NM 88240

DISTRICT II  
P.O. Drawer DD, Artesia, NM 88210

DISTRICT III  
1000 Rio Brazos Rd., Aztec, NM 87410

WELL LOCATION AND ACREAGE DEDICATION PLAT

All Distances must be from the outer boundaries of the section

Operator <b>ARCO OIL AND GAS COMPANY</b>			Lease <b>W. C. Roach</b>		Well No. <b>1, 6, &amp; 7</b>
Unit Letter <b>D, C, K</b>	Section <b>21</b>	Township <b>20S</b>	Range <b>37E</b>	County <b>NMPM</b>	Lea
Actual Footage Location of Well: <b>330, 660, 1980 feet from the North, North, South line and 330, 1980, 1980 feet from the West, West, line</b>					
Ground level Elev. <b>3530, 3509.7, 3508.7</b>		Producing Formation <b>Yates 7R Queen Gas</b>		Pool <b>Eumont Gas</b>	Dedicated Acreage: <b>320 Acres</b>

- Outline the acreage dedicated to the subject well by colored pencil or hatchure marks on the plat below.
- If more than one lease is dedicated to the well, outline each and identify the ownership thereof (both as to working interest and royalty).
- If more than one lease of different ownership is dedicated to the well, have the interest of all owners been consolidated by communitization, unitization, force-pooling, etc.?  
☐ Yes ☐ No If answer is "yes" type of consolidation \_\_\_\_\_  
If answer is "no" list the owners and tract descriptions which have actually been consolidated. (Use reverse side of this form if necessary.)  
No allowable will be assigned to the well until all interests have been consolidated (by communitization, unitization, forced-pooling, or otherwise) or until a non-standard unit, eliminating such interest, has been approved by the Division.

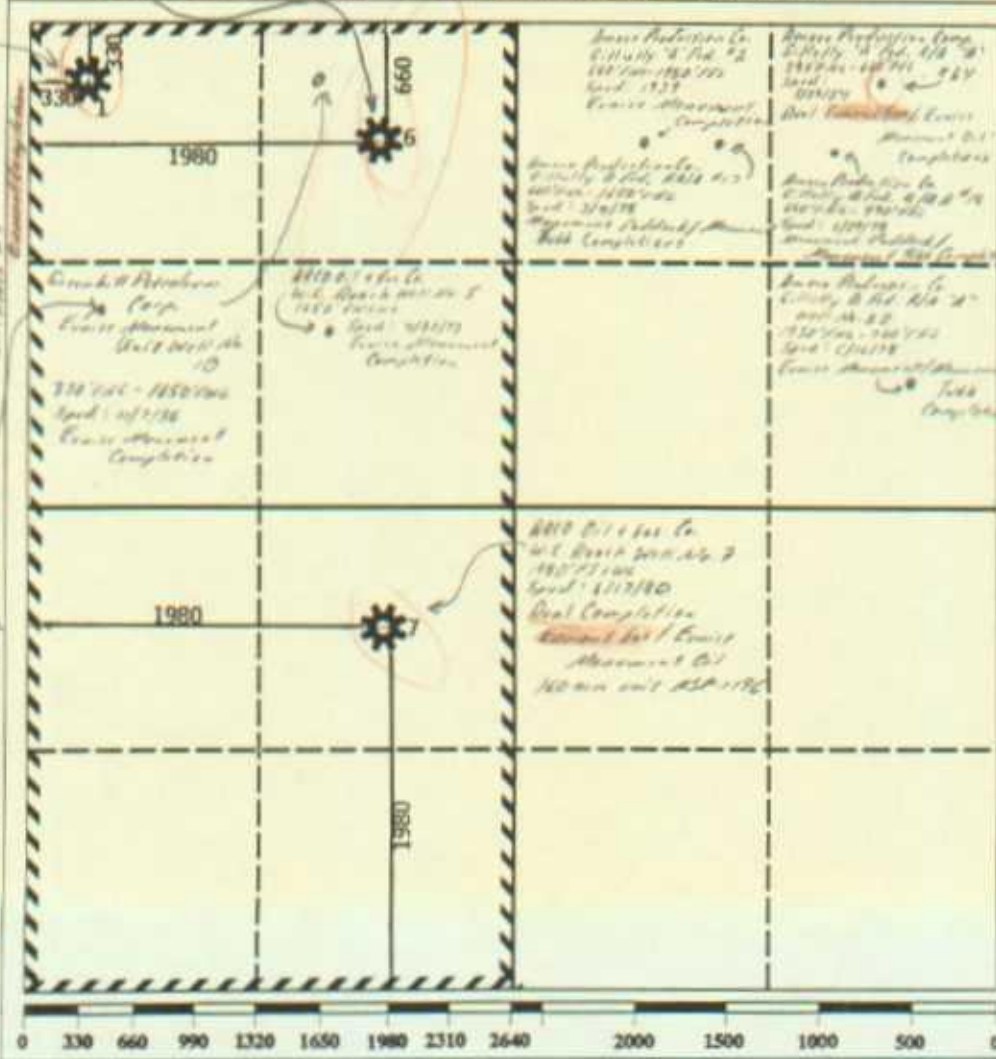

OPERATOR CERTIFICATION

I hereby certify that the information contained herein is true and complete to the best of my knowledge and belief.

Signature  
*Evelyn E. Gilson*

Printed Name  
**Evelyn E. Gilson**

Engr. Tech.

Position

**ARCO Oil and Gas Company**

Company

**February 23, 1989**

Date

SURVEYOR CERTIFICATION

I hereby certify that the well location shown on this plat was plotted from field notes of actual surveys made by me or under my supervision, and that the same is true and correct to the best of my knowledge and belief.

Date Surveyed

Signature & Seal of Professional Surveyor

Certificate No.

**N MEXICO OIL CONSERVATION COMMISSION**  
**WELL LOCATION AND ACREAGE DEDICATION PLAT**

Form C-102  
 Supersedes C-10  
 Effective 1-1-55

All distances must be from the outer boundaries of the Section.

Operator <b>Division of Atlantic Richfield Co.</b>		Lease <b>W.C. Rouch</b>		Well No. <b>6</b>
ARCO Oil & Gas Co.				
Section <b>C</b>	Section <b>21</b>	Range <b>20 South</b>	Range <b>37 East</b>	Lea <b>1</b>
Actual Well Location of Well:				
<b>660</b>	feet from the <b>North</b>	line and	<b>1980</b>	feet from the <b>West</b>
Ground Level Elev. <b>3509.7</b>	Producing Formation <b>Yates 7R Queen Gas</b>	Foot <b>Eumont Gas</b>	 <b>160 320</b>	

1. Outline the acreage dedicated to the subject well by colored pencil or hatchure marks on the plat below.
2. If more than one lease is dedicated to the well, outline each lease and state the ownership interest and its working interest had reports.
3. If more than one lease of different ownership is dedicated to the well, have the interests of all owners been consolidated by communitization, unitization, force-pooling, etc?

☐ Yes ☐ No If answer is "yes," type of consolidation \_\_\_\_\_

If answer is "no," list the owners and tract descriptions which have actually been consolidated (Use reverse side of this form if necessary.) \_\_\_\_\_

No allowable will be assigned to the well until all interests have been consolidated (by communitization, unitization, forced-pooling, or otherwise) or until a non-standard unit, eliminating such interests, has been approved by the Commission.

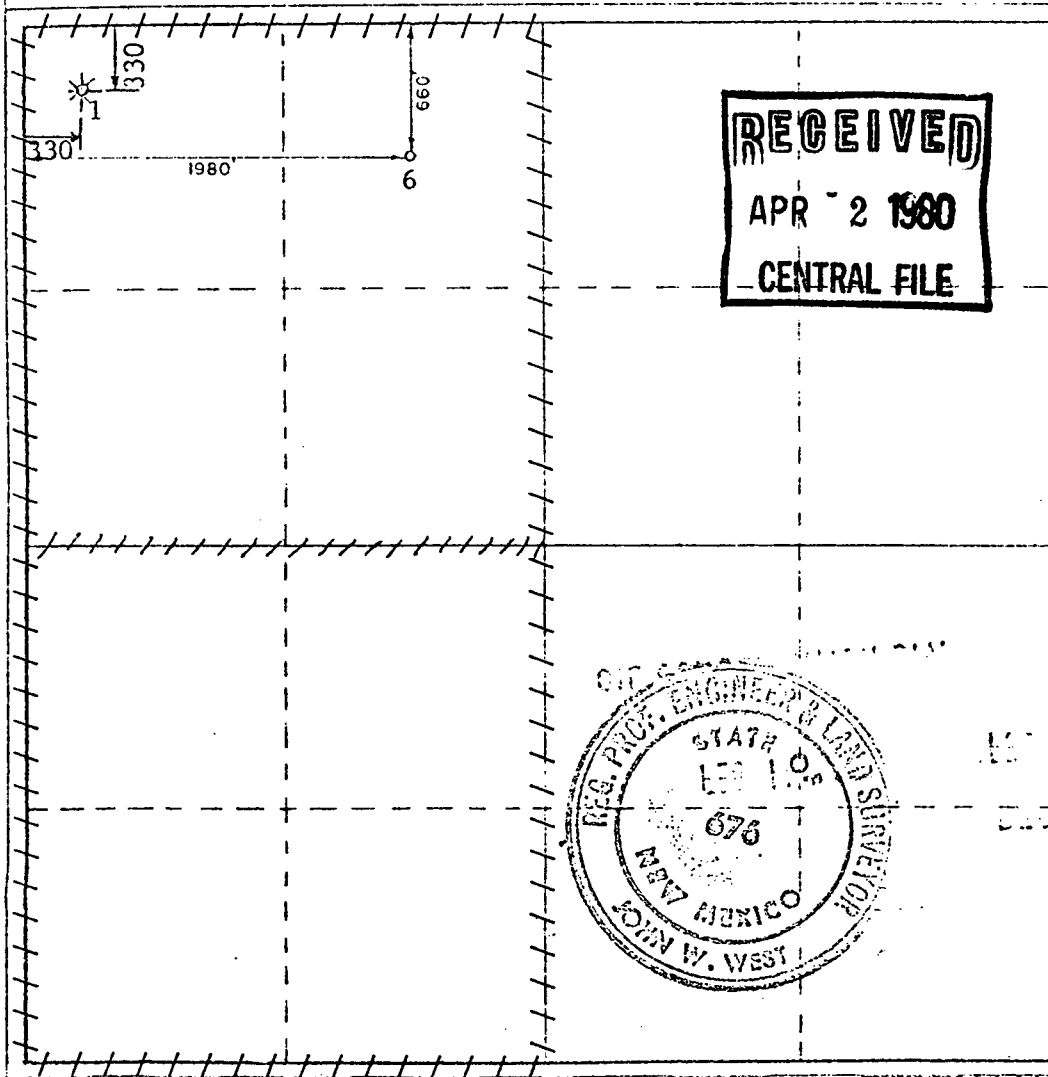

**CERTIFICATION**

I hereby certify that the information to be hereon is true and complete to the best of my knowledge and belief.

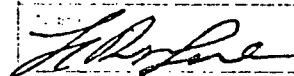

**Dist Drlg Supt.**  
**ARCO Oil and Gas Company**  
 Division of Atlantic Richfield Company

Date **2/11/80**

I hereby certify that the well location shown on this plat was plotted from field notes of actual surveys made by me or under my supervision, and that the same is true and correct to the best of my knowledge and belief.

**2-5-1980**

Registered Professional Engineer  
 and Licensed Surveyor

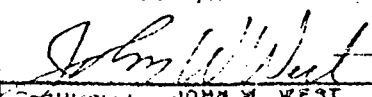

Certificate No. **JOHN W. WEST** **876**  
**PATRICK A. ROMERO** **8862**

NE, MEXICO OIL CONSERVATION COMMISSION  
WELL LOCATION AND ACREAGE DEDICATION PLAT

Form C-102  
Supersedes C-128  
Effective 1-1-65

All distances must be from the outer boundaries of the Section.

Operator ARCO Oil & Gas Company Division of Atlantic Richfield Company			Lease W. C. Roach		Well No. 1
Unit Letter D	Section 21	Township 20S	Range 37E	County Lea	
Actual Footage Location of Well: 330 feet from the North line and 330 feet from the West line					
Ground Level Elev. 3530'	Producing Formation Queen Gas		Pool Eumont Queen Gas		Dedicated Acreage: 160 Acres

1. Outline the acreage dedicated to the subject well by colored pencil or hachure marks on the plat below.
2. If more than one lease is dedicated to the well, outline each and identify the ownership thereof (both as to working interest and royalty).
3. If more than one lease of different ownership is dedicated to the well, have the interests of all owners been consolidated by communitization, unitization, force-pooling, etc?

☐ Yes ☐ No If answer is "yes," type of consolidation \_\_\_\_\_

If answer is "no," list the owners and tract descriptions which have actually been consolidated. (Use reverse side of this form if necessary.) \_\_\_\_\_

No allowable will be assigned to the well until all interests have been consolidated (by communitization, unitization, forced-pooling, or otherwise) or until a non-standard unit, eliminating such interests, has been approved by the Commission.

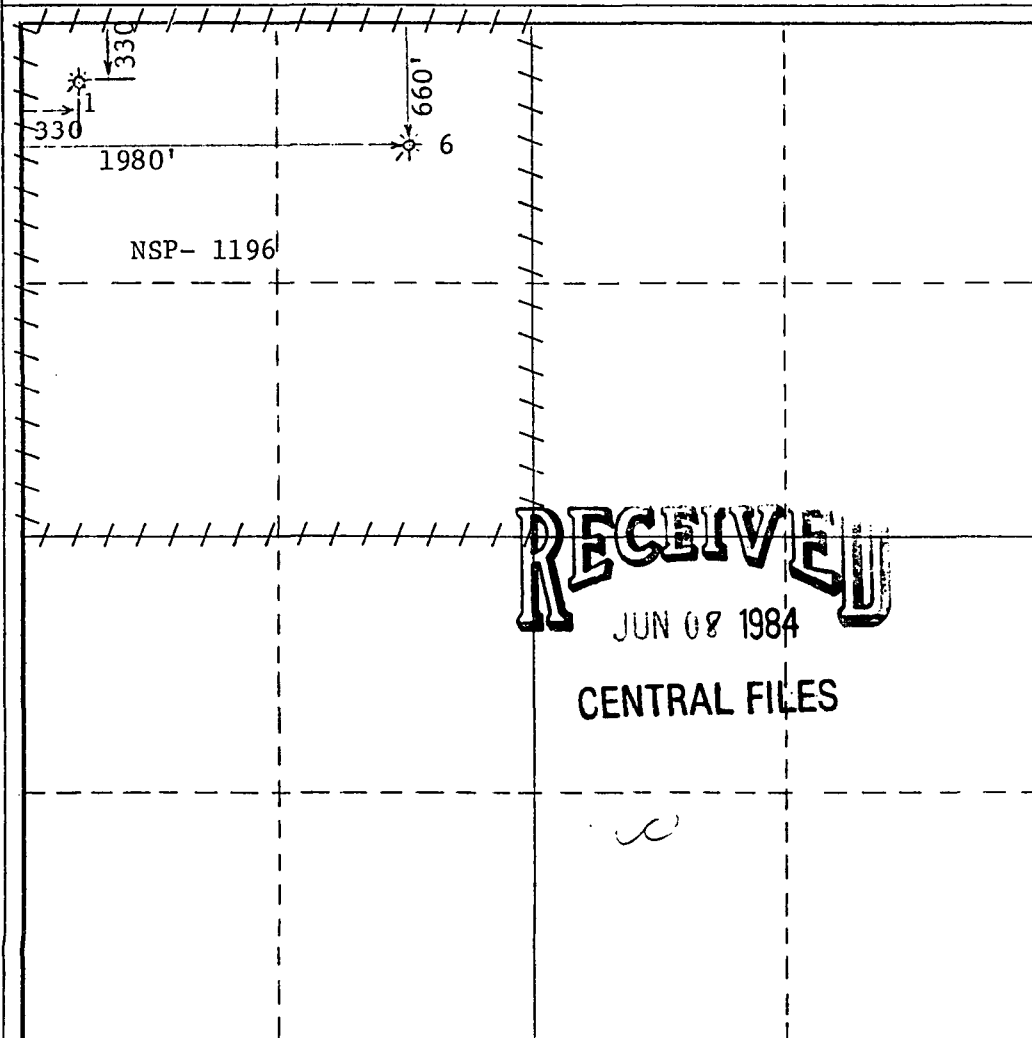

CERTIFICATION

I hereby certify that the information contained herein is true and complete to the best of my knowledge and belief.

Name  
*W.D. McDaniel*  
Position  
Dist. Drlg. Supt.  
Company ARCO Oil & Gas Company  
Division of Atlantic Richfield  
Date  
7/23/80

I hereby certify that the well location shown on this plat was plotted from field notes of actual surveys made by me or under my supervision, and that the same is true and correct to the best of my knowledge and belief.

Date Surveyed

Registered Professional Engineer  
and/or Land Surveyor

Certificate No.

NEW MEXICO OIL CONSERVATION COMMISSION  
WELL LOCATION AND ACREAGE DEDICATION PLAT

Form C-100  
Superseded C-120  
Effective 1-1-55

All distances must be from the outer boundaries of the Section.

Applicant <b>ARCO Oil &amp; Gas Co.</b>			Lessee <b>W.C. Roach</b>		Well No. <b>7</b>
Section Letter <b>K</b>	Section <b>21</b>	Township <b>20 South</b>	Range <b>37 East</b>	County <b>Lea</b>	

Actual Well Location of Well:

1200 feet from the South line and		1200 feet from the West line	
Surface Elevation <b>3503.7</b>	Producing Formation <b>Queen Gas</b>	Pool <b>Eumont Queen Gas</b>	Dedicated Acreage <b>40 Oil</b>
<b>Grayburg-SA-Oil</b>		<b>160 Gas</b>	

1. Outline the acreage dedicated to the subject well by colored pencil or hatchure marks on the plat below.
2. If more than one lease is dedicated to the well, outline each and identify the ownership thereof (both as to working interest and royalty).
3. If more than one lease of different ownership is dedicated to the well, have the interests of all owners been consolidated by communitization, unitization, force-pooling, etc?

☐ Yes ☐ No If answer is "yes" type of consolidation \_\_\_\_\_

If answer is "no," list the owners and tract descriptions which have actually been consolidated. (Use reverse side of this form if necessary.) \_\_\_\_\_

No allowable will be assigned to the well until all interests have been consolidated (by communitization, unitization, forced-pooling, or otherwise) or until a non-standard unit, eliminating such interests, has been approved by the Commission.

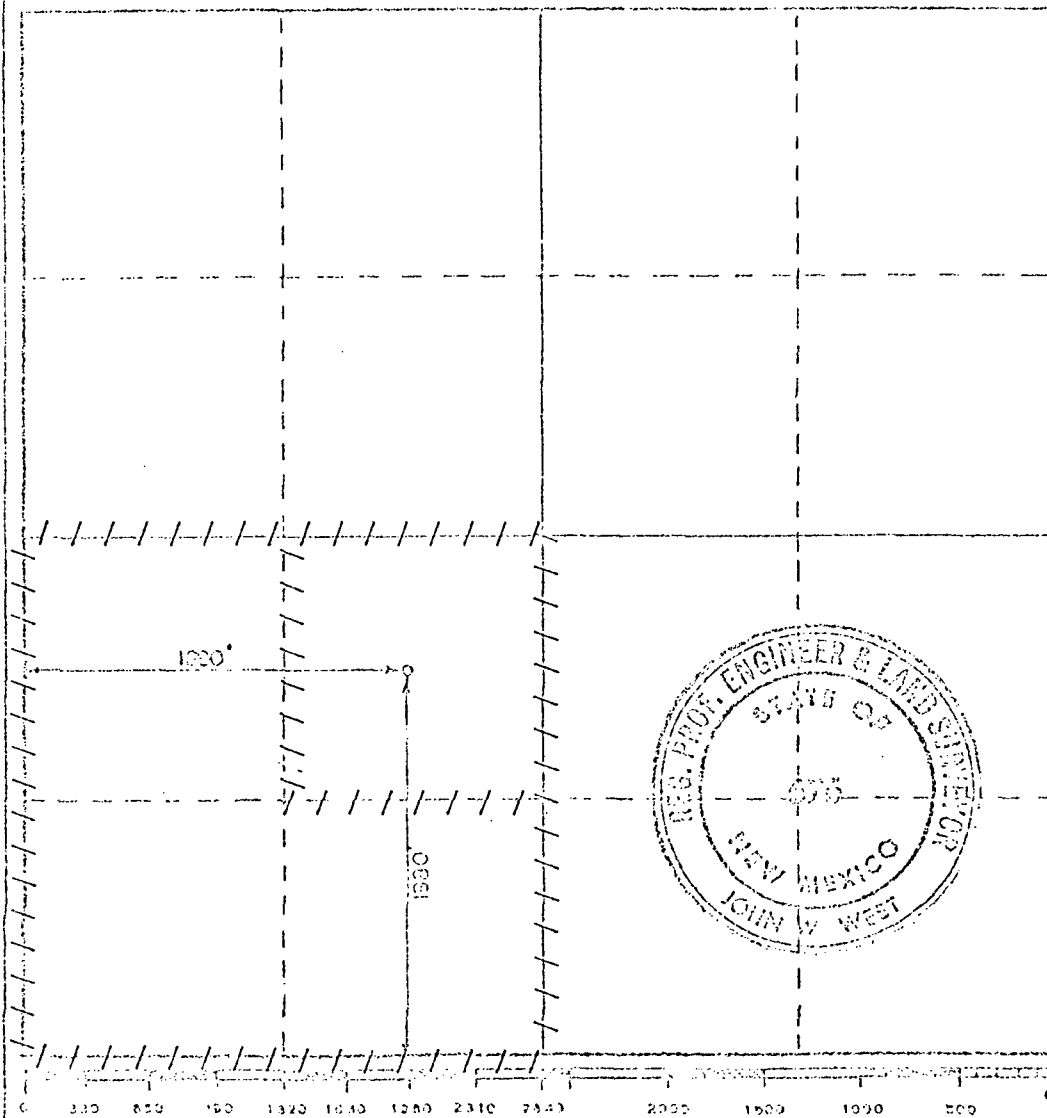

CERTIFICATION

I hereby certify that the information contained herein is true and complete to the best of my knowledge and belief.

By *John W. West*  
For **LEROY LANE**  
District Engineer  
Company **ARCO Oil & Gas Co.**  
Division of Atlantic Richfield  
Date  
**6/13/80**

I hereby certify that the well location shown on this plat was plotted from field notes of actual surveys made by me or under my supervision, and that the same is true and correct to the best of my knowledge and belief.

Date Surveyed  
**6-6-1980**  
Registered Professional Engineer and/or Land Surveyor  
*Patrick A. Romero*  
Engineer No. **JOHN W. WEST** STS  
**PATRICK A. ROMERO** 8345  
**RONALD J. EIDSON** 3239



Production Department  
Hobbs Division  
North American Production

Conoco Inc.  
726 East Michigan  
P.O. Box 460  
Hobbs, NM 88241  
(505) 397-5800

March 29, 1989

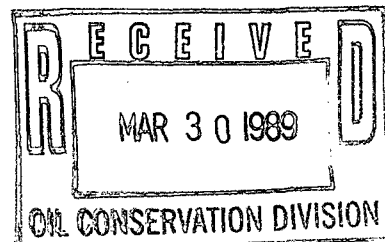

Arco Oil & Gas Company  
P. O. Box 1610  
Midland, Texas 79702

Attention Mr. Josh C. Fu

Gentlemen:

Request for Waiver, W. C. Roach #1, #6 and #7  
Eumont Gas Pool, Lea county, New Mexico

Conoco Inc. is returning your waiver unsigned. We are not disapproving your application because it does not adversely effect Conoco, however, we do not wish to support it because of its potential effect on the offset operations to the Well No. 1. If Texaco and Byrum both approve, then we would be willing to approve, also.

Because Well No. 1 is only 330' from the north and west lines, and because under simultaneous dedication, it would have the right to produce a 320-acre allowable, we are withholding our approval. We believe that Well #1 should have its own proration unit and that it should be small enough to provide an allowable that would not drain offsetting acreage.

Yours very truly,

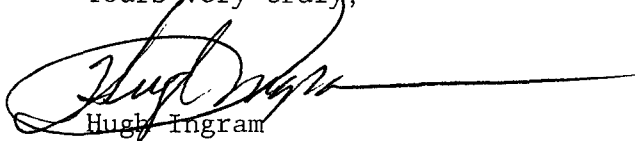
  
Hugh Ingram  
Conservation Coordinator

dw

cc:  
NMOCD - SF



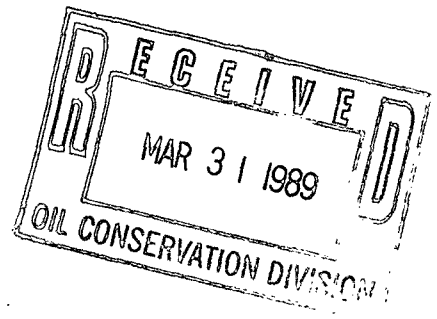

**WAIVER TO OBJECTION**

**ARCO Oil and Gas Company**

**Non-Standard Proration Unit Request  
W. C. Roach #1, #6, and #7**

**Unorthodox Locations Request  
W. C. Roach #1 and #6**

**Eumont Gas Pool  
W/2 Section 21, T20S, R37E  
Lea County, New Mexico**

I/We do hereby waive any objection to ARCO Oil and Gas Company's request for NMOCD approval of a 320-acre non-standard proration unit for the W. C. Roach #1, #6, and #7, and the unorthodox locations for the W. C. Roach #1 and #6.

Signed: Alan W. Bohling

Company: Chevron U.S.A. Inc.

Date: March 27, 1989



Texaco USA

PO Box 728  
Hobbs NM 88240  
505 393 7191

April 14, 1989

State of New Mexico  
Energy & Minerals Department  
Oil Conservation Commission  
P. O. Box 1980  
Hobbs, New Mexico 88240

Attention: Mr. Jerry Sexton  
District Supervisor

Gentlemen:

Texaco Producing Inc. protests ARCO's application for simultaneous dedication, non-standard proration unit and unorthodox locations on their W. C. Roach Well Nos. 1, 6, and 7, W/2 Section 21, T-20-S, R-37-E, Lea County, New Mexico. The subject application, if approved, will not protect Texaco's correlative rights on the offsetting acreage.

Yours very truly,

J. A. Schaffer  
District Operations Manager

DBW:JRB

cc: Mr. W. J. LeMay  
OCC - Santa Fe



STATE OF NEW MEXICO

ENERGY, MINERALS AND NATURAL RESOURCES DEPARTMENT

OIL CONSERVATION DIVISION

GARREY CARRUTHERS  
GOVERNOR

POST OFFICE BOX 2088  
STATE LAND OFFICE BUILDING  
SANTA FE, NEW MEXICO 87504  
(505) 827-5800

April 17, 1989

Texaco Producing, Inc.  
P.O. Box 728  
Hobbs, NM 88240

Attention: J.A. Schaffer,  
District Operations Manager

RE: Division Administrative Order  
NSP-1570(L)(SD), ARCO Oil &  
Gas Company, W.C. Roach Lease,  
W/2-2-20S-37E, Eumont Gas Pool,  
Lea County, New Mexico.

Dear Mr. Schaffer:

On April 17, 1989, the Oil Conservation Division office in Santa Fe received your letter of objection to the subject filing dated April 14, 1989, see attached. Said application from ARCO was received on March 15, 1989 and Administrative Order NSP-1570(L)(SD), also attached, was issued on April 6, 1989. This application met all of the requirements in Rules 2(c) and 2(a)4 of Division Order R-8170, as amended, and was therefore approved subsequent to the required 20-day waiting period. Since your letter of objection was not filed with the Division within the prescribed waiting period, the Administrative Order will not be affected. However, if you still wish to follow through with your objection, an application by Texaco for a hearing to review and rescind said Order NSP-1570(L)(SD) will be required.

If you should have any questions concerning this matter, please contact me.

Sincerely,

Michael E. Stogner  
Administrative Application Reviewer

MES/ag

cc: ARCO Oil & Gas Co.  
Oil Conservation Division - Hobbs  
File: NSP-1197, NSP-1570(L)(SD)



Texaco USA

PO Box 718  
Hobbs NM 88240  
505 783 7101

April 14, 1989

State of New Mexico  
Energy & Minerals Department  
Oil Conservation Commission  
P. O. Box 1980  
Hobbs, New Mexico 88240

Attention: Mr. Jerry Sexton  
District Supervisor

Gentlemen:

Texaco Producing Inc. protests ARCO's application for simultaneous dedication, non-standard proration unit and unorthodox locations on their W. C. Roach Well Nos. 1, 6, and 7, W/2 Section 21, T-20-S, R-37-E, Lea County, New Mexico. The subject application, if approved, will not protect Texaco's correlative rights on the offsetting acreage.

Yours very truly,

J. A. Schaffer  
District Operations Manager

DBW:JRB

cc: Mr. W. J. LeMay  
OCC - Santa Fe



STATE OF NEW MEXICO  
ENERGY, MINERALS AND NATURAL RESOURCES DEPARTMENT  
OIL CONSERVATION DIVISION

GARREY CARRUTHERS  
GOVERNOR

POST OFFICE BOX 2088  
STATE LAND OFFICE BUILDING  
SANTA FE, NEW MEXICO 87504  
(505) 827-5800

April 6, 1989

ARCO Oil & Gas Company  
P.O. Box 1610  
Midland, TX 79702

Attention: Josh C. Fu

Administrative Order NSP-1570(L)(SD)

Dear Mr. Fu:

Reference is made to your application of March 13, 1989, for a 320-acre non-standard gas proration unit consisting of the following acreage in the Eumont Gas Pool:

LEA COUNTY, NEW MEXICO  
TOWNSHIP 20 SOUTH, RANGE 37 EAST, NMPM  
Section 21: W/2

Said unit is to be simultaneously dedicated to the following three existing wells all on the W.C. Roach Lease in the W/2 of said Section 21:

Well No. 1 located 330 feet from the North and West lines (Unit D);

Well No. 6 located 660 feet from the North and 1980 feet from the West line (Unit C); and,

Well No. 7 located at a standard gas well location for the proposed unit, 1980 feet from the South and West lines (Unit K).

It is my understanding that the Eumont Gas Pool underlying the W/2 of said Section 21 is presently developed by two 160-acre non-standard gas spacing and proration units, both authorized by Division Administrative Order NSP-1196. The NW/4 being simultaneously dedicated to the W.C. Roach Wells No. 1 and 6 and the SW/4 being dedicated to the W.C. Roach Well No. 7.

The W.C. Roach Wells No. 1 and 6 are located at unorthodox gas well locations for the proposed 320-acre unit (Rule 2(b)4 of the Special Rules and Regulations for the Eumont Gas Pool, as promulgated by Division Order No. R-8170, as amended); however the No. 1 well was drilled and completed prior to the creation of the Eumont Gas Pool and its location is therefore authorized under the provisions of Rule 2(b)2 of the Eumont Special Rules. At this time the location of the Well No. 6 is hereby approved pursuant to Rule 2(c) of said Order No. R-8170, as amended.



Administrative Order NSP-1570(L)(SD)  
ARCO Oil and Gas Company  
April 5, 1989  
Page 2

Furthermore, by authority granted me under the provisions of Rule 2(a)4 of said Order No. R-8170, the above-described 320-acre gas proration unit is hereby approved.

Sincerely,



for William J. LeMay  
Director

WJL/MES/ag

cc: Oil Conservation Division - Hobbs  
NM Oil and Gas Engineering Committee - Hobbs  
File: NSP-1196

REMARKS: Division Administrative Order NSP-1196 is hereby placed in abeyance until further notice.



STATE OF NEW MEXICO  
ENERGY AND MINERALS DEPARTMENT  
OIL CONSERVATION DIVISION

BRUCE KING  
GOVERNOR  
LARRY KEHOE  
SECRETARY

May 8, 1980

POST OFFICE BOX 2088  
STATE LAND OFFICE BUILDING  
SANTA FE, NEW MEXICO 87501  
(505) 827-2434

ARCO Oil and Gas Company  
P. O. Box 1610  
Midland, Texas 79702

Attention: Ms. Carolyn Dawson

Administrative Order NSP-1196

Gentlemen:

Reference is made to your application for two non-standard proration units consisting of the following acreage in the Eumont Gas Pool:

LEA COUNTY, NEW MEXICO  
TOWNSHIP 20 SOUTH, RANGE 37 EAST, NMPM  
Section 21: NW/4  
Section 21: SW/4

It is my understanding that the unit consisting of the SW/4 is to be dedicated to a well to be drilled at a standard location thereon, and the NW/4 is to be simultaneously dedicated to your W. C. Roach Well No. 6 located 660 feet from the North line and 1980 feet from the West line and your W. C. Roach Well No. 1 located 330 feet from the North line and 330 feet from the West line of said Section 21. Further, you are hereby permitted to produce the allowable from any of the wells on the proration unit in any proportion.

That Order No. R-612 is hereby put in abeyance.

By authority granted me under the provisions of Rule 5(C)3 of Order No. R-1670, the above non-standard proration units are hereby approved.

Sincerely,

  
JOE D. RAMEY,  
Director

JDR/dr

cc: Oil Conservation Division - Hobbs  
Oil & Gas Engineering Committee - Hobbs

**WAIVER TO OBJECTION**

**ARCO Oil and Gas Company**

**Non-Standard Proration Unit Request  
W. C. Roach #1, #6, and #7**

**Unorthodox Locations Request  
W. C. Roach #1 and #6**

**Eumont Gas Pool  
W/2 Section 21, T20S, R37E  
Lea County, New Mexico**

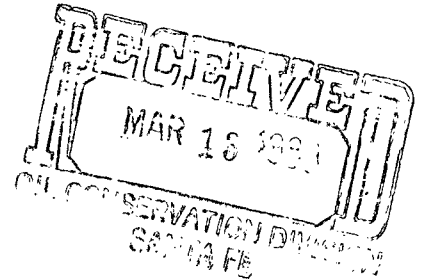

I/We do hereby waive any objection to ARCO Oil and Gas Company's request for NMOCD approval of a 320-acre non-standard proration unit for the W. C. Roach #1, #6, and #7, and the unorthodox locations for the W. C. Roach #1 and #6.

Signed: *Cliff Sueda*

Company: *Estoril Producing Corp*

Date: *3-10-89*

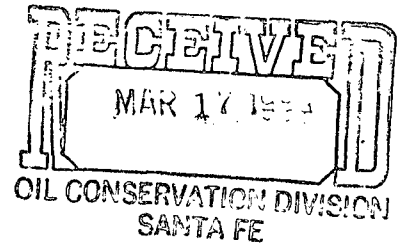

**WAIVER TO OBJECTION**

**ARCO Oil and Gas Company**

**Non-Standard Proration Unit Request  
W. C. Roach #1, #6, and #7**

**Unorthodox Locations Request  
W. C. Roach #1 and #6**

**Eumont Gas Pool  
W/2 Section 21, T20S, R37E  
Lea County, New Mexico**

I/We do hereby waive any objection to ARCO Oil and Gas Company's request for NMOCD approval of a 320-acre non-standard proration unit for the W. C. Roach #1, #6, and #7, and the unorthodox locations for the W. C. Roach #1 and #6.

Signed: Jenni J. Hryzak

Company: Sun Exploration & Production Company

Date: 14 March 1989



STATE OF NEW MEXICO  
ENERGY AND MINERALS DEPARTMENT  
OIL CONSERVATION DIVISION  
HOBBS DISTRICT OFFICE

3-10-89

GARREY CARRUTHERS  
GOVERNOR

POST OFFICE BOX 1980  
HOBBS, NEW MEXICO 88241-1980  
(505) 393-6161

OIL CONSERVATION DIVISION  
P. O. BOX 2088  
SANTA FE, NEW MEXICO 87501

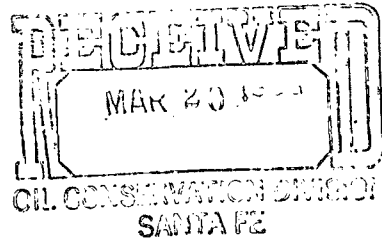

RE: Proposed:

MC \_\_\_\_\_  
DHC \_\_\_\_\_  
NSL \_\_\_\_\_  
NSP ☒ \_\_\_\_\_  
SWD \_\_\_\_\_  
WFX \_\_\_\_\_  
PMX \_\_\_\_\_

Gentlemen:

I have examined the application for the:

Arco Oil & Gas Co. W.C. Roach #1-D #6-C #7-K 21-20-37  
Operator Lease & Well No. Unit S-T-R

and my recommendations are as follows:

OK

Yours very truly,

Jerry Sexton  
Supervisor, District 1

/ed



**WAIVER TO OBJECTION**  
**ARCO Oil and Gas Company**  
**Non-Standard Proration Unit Request**  
**W. C. Roach #1, #6, and #7**  
**Unorthodox Locations Request**  
**W. C. Roach #1 and #6**  
**Eumont Gas Pool**  
**W/2 Section 21, T20S, R37E**  
**Lea County, New Mexico**



I/We do hereby waive any objection to ARCO Oil and Gas Company's request for NMOCD approval of a 320-acre non-standard proration unit for the W. C. Roach #1, #6, and #7, and the unorthodox locations for the W. C. Roach #1 and #6.

Signed: *M. E. Sweeney*  
M. E. Sweeney  
Environmental & Regulatory Manager  
Company: Mobil Exploration & Producing U.S. Inc.  
as Agent for  
Mobil Producing Texas & New Mexico Inc.  
Date: 3/27/89

*Mike Stogner*

WAIVER TO OBJECTION

ARCO Oil and Gas Company

Non-Standard Proration Unit Request  
W. C. Roach #1, #6, and #7

Unorthodox Locations Request  
W. C. Roach #1 and #6

Eumont Gas Pool  
W/2 Section 21, T20S, R37E  
Lea County, New Mexico

I/We do hereby waive any objection to ARCO Oil and Gas Company's request for NMOCD approval of a 320-acre non-standard proration unit for the W. C. Roach #1, #6, and #7, and the unorthodox locations for the W. C. Roach #1 and #6.

Signed: *Alan W. Bohling*

Company: *Chevron U.S.A. Inc.*

Date: *March 27, 1989*



STATE OF NEW MEXICO

ENERGY, MINERALS AND NATURAL RESOURCES DEPARTMENT

OIL CONSERVATION DIVISION



BRUCE KING  
GOVERNOR

ANITA LOCKWOOD  
CABINET SECRETARY

November 24, 1992

POST OFFICE BOX 2088  
STATE LAND OFFICE BUILDING  
SANTA FE, NEW MEXICO 87504  
(505) 827-5800

ARCO Oil and Gas Company  
P.O. Box 1610  
Midland, TX 79702

Attention: Kevin D. Renfro

*Administrative Order SD-92-6*

Dear Mr. Renfro:

Per your application dated September 28, 1992, you are hereby authorized to simultaneously dedicate Eumont Gas Pool production to the previously approved non-standard 320-acre gas spacing and proration unit comprising the W/2 of Section 21, Township 20 South, Range 37 East, NMPM, Lea County, New Mexico [Division Order NSP-1570(L)(SD)], dated April 6, 1989), from the existing W.C. Roach Well No. 6 located at a previously approved unorthodox gas well location 660 feet from the North line and 1980 feet from the West line (Unit C) and W.C. Roach Well No. 7 located at a standard location 1980 feet from the South and West lines (Unit K) of said Section 21 with the proposed W.C. Roach Well No. 5, to be recompleted from the Eunice Monument Grayburg San Andres Pool and located 1650 from the North and West lines (Unit F) which is a standard location for the Eumont Gas Pool.

Further, you are permitted to produce the allowable assigned said 320-acre unit from all three wells in any proportion.

Sincerely,

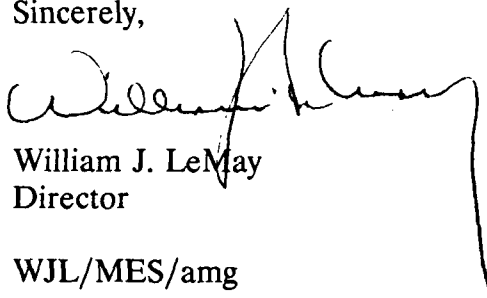

William J. LeMay  
Director

WJL/MES/amg

cc: Oil Conservation Division - Hobbs  
File: NSP-1570(L)(SD)