

ARCO Oil and Gas Company  
Western District  
Post Office Box 1610  
Midland, TX 79702  
Telephone (915) 688-5200

OIL CONSERVATION DIVISION  
RECEIVED



JAN 29 1993

January 29, 1993

Mr. William J. LeMay  
New Mexico Oil Conservation Division  
P. O. Box 2088  
Santa Fe, New Mexico 87501

Mr. J. T. Sexton  
New Mexico Oil Conservation Division  
P. O. Box 1980  
Hobbs, New Mexico 88240

Dear Mr. LeMay:

ARCO Oil and Gas Company respectfully requests administrative approval to amend an existing non-standard 320-acre Eumont gas spacing and proration unit (consisting of the W/2 of Section 21, T-20S, R-37E) by deleting 40-acres (the SE/4 NW/4) to form a non-standard 280-acre Eumont gas spacing and proration unit. The existing 320-acre spacing and proration unit was approved by Division Order NSP-1570(L)(SD), dated April 6, 1989 for the W. C. Roach #6 and the W. C. Roach #7 wells. On November 24, 1992, by Administrative Order SD-92-6, the W. C. Roach #5 was simultaneously dedicated to this 320-acre spacing and proration unit in anticipation of recompleting this well to the Eumont Gas Pool from the Eunice Monument Grayburg San Andres Pool. However, the recompletion of the W. C. Roach #5 has resulted in an oil well rather than a gas well (see attached C-105). Thus, ARCO is requesting to remove the 40-acres where the W. C. Roach #5 is located from the existing 320-acre spacing and proration unit in order to form a 40-acre spacing and proration unit for the W. C. Roach #5 in the Eumont Oil Pool.

Attached are C-102 forms identifying the proposed configuration of the 280-acre Eumont gas proration unit for the W. C. Roach #6 and the W. C. Roach #7 wells and the 40-acre Eumont oil proration unit for the W. C. Roach #5. Also attached is a list of offset operators for this unit, and a land plat map of the surrounding area.

ARCO Oil and Gas Company believes approval of this request will be in the interest of conservation, will protect correlative rights, and will allow for a more complete recovery of Eumont gas and Eumont oil reserves from the subject acreage.

ARCO Oil and Gas Company is notifying the offset operators of this application by sending a copy of this application package, along with waiver to objection forms, by certified mail. If you need further information, please call me at (915) 688-5446.

Sincerely,

David K. Newell  
Senior Operations/Analytical Engineer  
DKN:lrh

Attachments

Offset Operators:

Please indicate your approval for our request as detailed in the attached package by signing the waiver form below. Please return the signed waiver in the enclosed stamped, self-addressed envelope.

Thank you for your cooperation in this matter.

### **WAIVER TO OBJECTION**

#### **ARCO OIL AND GAS COMPANY**

**Application to amend an existing 320-acre Eumont gas proration unit by deleting 40-acres to form a 280-acre Eumont gas proration unit and a 40-acre Eumont oil proration unit**

**Eumont Gas Pool and Eumont Oil Pool  
W/2, Section 21, T-20S, R-37E  
Lea County, New Mexico**

I/We do hereby waive any objection to ARCO Oil and Gas Company's request for NMOCD Administrative Approval to amend an existing 320-acre Eumont gas proration unit by deleting 40-acres to form a 280-acre Eumont gas proration unit and a 40-acre Eumont oil proration unit.

Signed: \_\_\_\_\_  
Title: \_\_\_\_\_  
Company: \_\_\_\_\_  
Date: \_\_\_\_\_

# ARCO OIL AND GAS COMPANY

Application to ammend an existing 320-acre Eumont gas proration unit  
by deleting 40-acres to form a 280-acre Eumont gas proration unit  
and a 40-acre Eumont oil proration unit

Eumont Gas Pool and Eumont Oil Pool  
W/2, Section 21, T-20S, R-37E  
Lea County, New Mexico

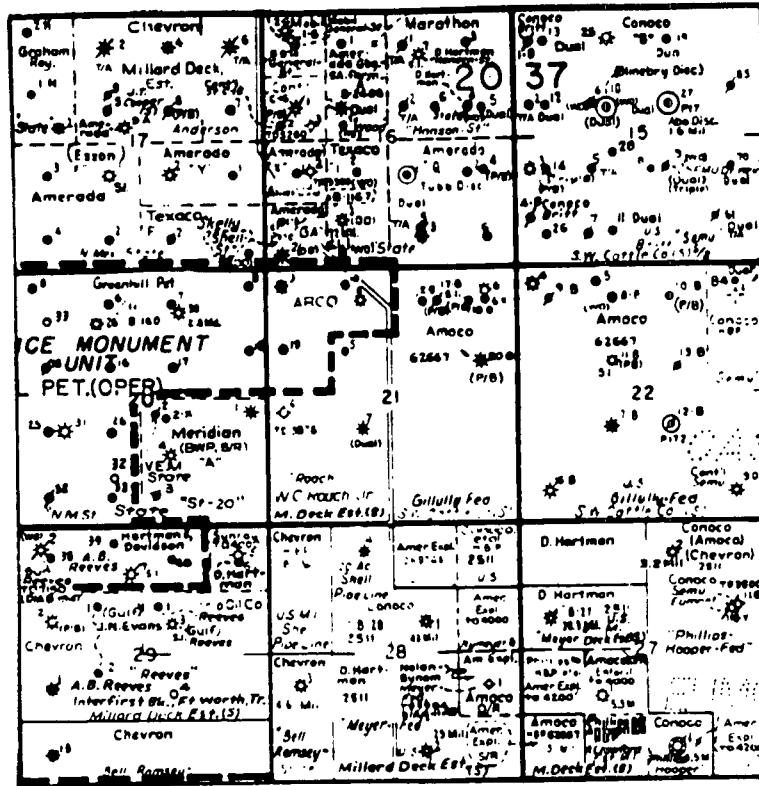

## OFFSET OPERATORS

Conoco, Inc.  
Texaco Expl. & Prod.  
Doyle Hartman  
Amerada Hess Corp.  
Chevron, USA  
Meridian Oil, Inc.  
R. B. Honeyman, Jr.  
John H. Hendrix  
Mobil Prod. TX & NM  
Amoco Prod. Co.  
Estoril Prod. Corp.

Submit to Appropriate  
District Office  
State Lease - 4 copies  
Fee Lease - 3 copies

State of New Mexico  
Energy, Minerals and Natural Resources Department

Form C-102  
Revised 1-1-89

OIL CONSERVATION DIVISION

P.O. Box 2088  
Santa Fe, New Mexico 87504-2088

DISTRICT I  
P.O. Box 1980, Hobbs, NM 88240

DISTRICT II  
P.O. Drawer DD, Artesia, NM 88210

DISTRICT III  
1000 Rio Brazos Rd., Aztec, NM 87410

WELL LOCATION AND ACREAGE DEDICATION PLAT

All Distances must be from the outer boundaries of the section

Operator ARCO OIL AND GAS COMPANY			Lease W. C. ROACH		Well No. 5
Unit Letter F	Section 21	Township T-20-S	Range R-37-E	County LEA	
Actual Footage Location of Well: 1650 feet from the NORTH line and 1650 feet from the WEST line					
Ground level Elev. 3512	Producing Formation YATES / 7-RIVERS / QUEEN		Pool EUMONT OIL	Dedicated Acreage: 40 Acres	

1. Outline the acreage dedicated to the subject well by colored pencil or hatchure marks on the plat below.
2. If more than one lease is dedicated to the well, outline each and identify the ownership thereof (both as to working interest and royalty).
3. If more than one lease of different ownership is dedicated to the well, have the interest of all owners been consolidated by communitization, unitization, force-pooling, etc.?  
☐ Yes ☐ No If answer is "yes" type of consolidation \_\_\_\_\_  
If answer is "no" list the owners and tract descriptions which have actually been consolidated. (Use reverse side of this form if necessary.)  
No allowable will be assigned to the well until all interests have been consolidated (by communitization, unitization, forced-pooling, or otherwise) or until a non-standard unit, eliminating such interest, has been approved by the Division.

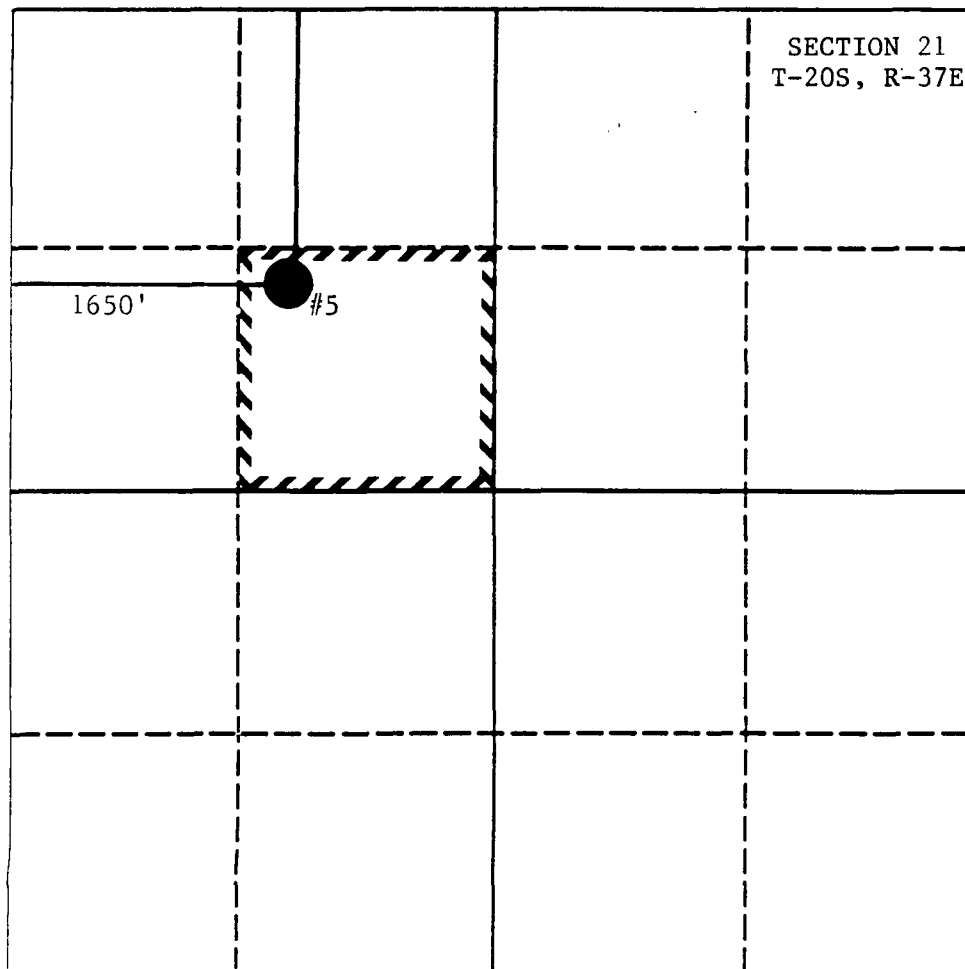

OPERATOR CERTIFICATION

I hereby certify that the information contained herein is true and complete to the best of my knowledge and belief.

Signature

*Evelyn E. Gilson*

Printed Name

EVELYN GILSON

Position

ENGINEERING TECHNICIAN

Company

ARCO OIL AND GAS COMPANY

Date

JANUARY 29, 1993

SURVEYOR CERTIFICATION

I hereby certify that the well location shown on this plat was plotted from field notes of actual surveys made by me or under my supervision, and that the same is true and correct to the best of my knowledge and belief.

Date Surveyed

Signature & Seal of  
Professional Surveyor

Certificate No.

0 330 660 990 1320 1650 1980 2310 2640 2000 1500 1000 500 0

Submit to Appropriate  
District Office  
State Lease - 4 copies  
Fee Lease - 3 copies

State of New Mexico  
Energy, Minerals and Natural Resources Department

Form C-102  
Revised 1-1-89

OIL CONSERVATION DIVISION

P.O. Box 2088  
Santa Fe, New Mexico 87504-2088

DISTRICT I

P.O. Box 1980, Hobbs, NM 88240

DISTRICT II

P.O. Drawer DD, Artesia, NM 88210

DISTRICT III

1000 Rio Brazos Rd., Aztec, NM 87410

WELL LOCATION AND ACREAGE DEDICATION PLAT

All Distances must be from the outer boundaries of the section

Operator ARCO OIL AND GAS COMPANY			Lease W. C. ROACH		Well No. 7
Unit Letter K	Section 21	Township T-20-S	Range R-37-E	County LEA	
Actual Footage Location of Well:					
1980 feet from the SOUTH line and		1980 feet from the WEST line			
Ground level Elev. 3509	Producing Formation YATES/7-RIVERS/QUEEN		Pool EUMONT GAS	Dedicated Acreage: 280 Acres	

1. Outline the acreage dedicated to the subject well by colored pencil or hatchure marks on the plat below.

2. If more than one lease is dedicated to the well, outline each and identify the ownership thereof (both as to working interest and royalty).

3. If more than one lease of different ownership is dedicated to the well, have the interest of all owners been consolidated by communitization, unitization, force-pooling, etc.?

☐ Yes

☐ No

If answer is "yes" type of consolidation

If answer is "no" list the owners and tract descriptions which have actually been consolidated. (Use reverse side of this form if necessary.)

No allowable will be assigned to the well until all interests have been consolidated (by communitization, unitization, forced-pooling, or otherwise) or until a non-standard unit, eliminating such interest, has been approved by the Division.

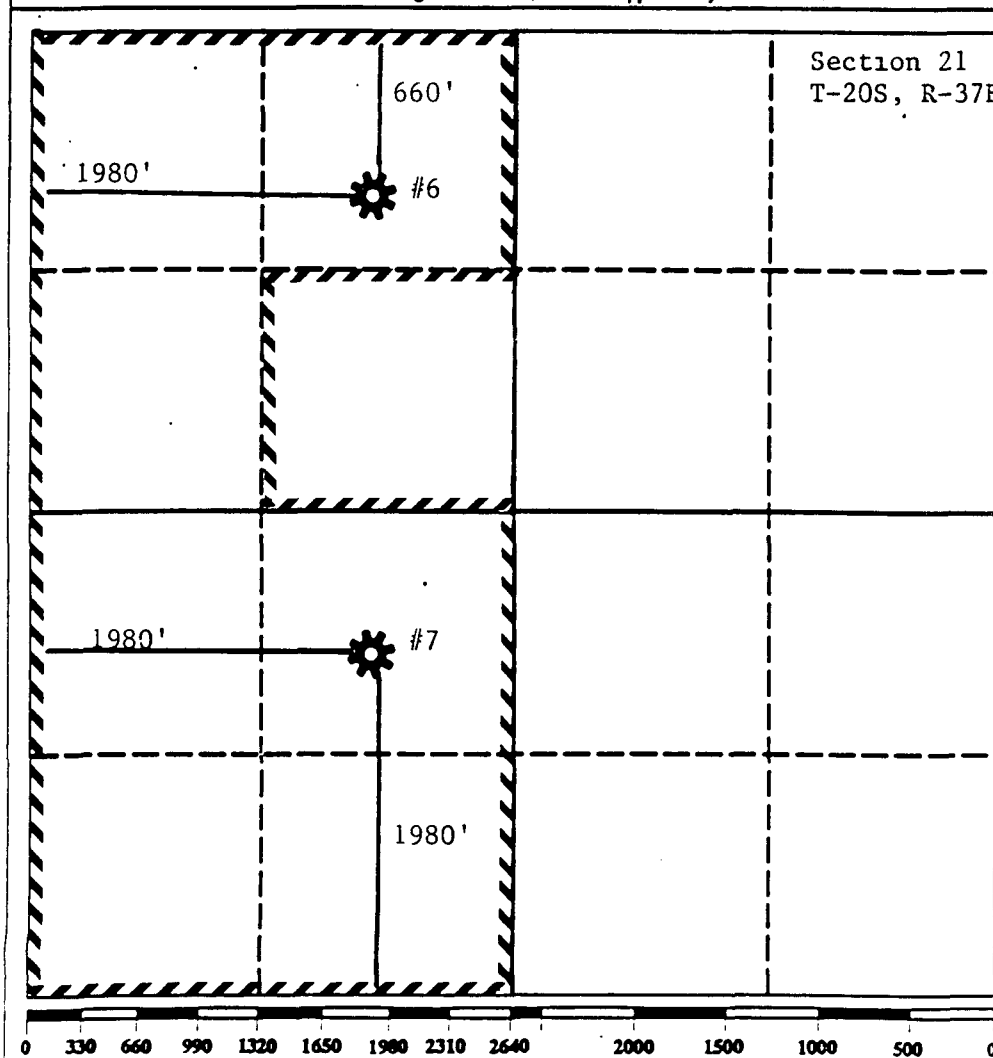

OPERATOR CERTIFICATION

I hereby certify that the information contained herein is true and complete to the best of my knowledge and belief.

Signature

Evelyn E. Gilson

Printed Name

EVELYN GILSON

Position

ENGINEERING TECHNICIAN

Company

ARCO OIL AND GAS COMPANY

Date

JANUARY 28, 1993

SURVEYOR CERTIFICATION

I hereby certify that the well location shown on this plat was plotted from field notes of actual surveys made by me or under my supervision, and that the same is true and correct to the best of my knowledge and belief.

Date Surveyed

Signature & Seal of  
Professional Surveyor

Certificate No.

Submit to Appropriate  
District Office  
State Lease - 4 copies  
Fee Lease - 3 copies

State of New Mexico  
Energy, Minerals and Natural Resources Department

Form C-102  
Revised 1-1-89

OIL CONSERVATION DIVISION

DISTRICT I  
P.O. Box 1980, Hobbs, NM 88240

P.O. Box 2088  
Santa Fe, New Mexico 87504-2088

DISTRICT II  
P.O. Drawer DD, Artesia, NM 88210

DISTRICT III  
1000 Rio Brazos Rd., Aztec, NM 87410

WELL LOCATION AND ACREAGE DEDICATION PLAT

All Distances must be from the outer boundaries of the section

Operator ARCO OIL AND GAS COMPANY			Lease W. C. ROACH		Well No. 6
Unit Letter C	Section 21	Township T-20-S	Range R-37-E	County NMPM	LEA
Actual Footage Location of Well: 660 feet from the NORTH line and 1980 feet from the WEST line					
Ground level Elev. 3513	Producing Formation YATES/7-RIVERS/QUEEN		Pool EUMONT GAS		Dedicated Acreage: 280 Acres

1. Outline the acreage dedicated to the subject well by colored pencil or hatchure marks on the plat below.
2. If more than one lease is dedicated to the well, outline each and identify the ownership thereof (both as to working interest and royalty).
3. If more than one lease of different ownership is dedicated to the well, have the interest of all owners been consolidated by communitization, unitization, force-pooling, etc.?  
☐ Yes ☐ No If answer is "yes" type of consolidation \_\_\_\_\_  
If answer is "no" list the owners and tract descriptions which have actually been consolidated. (Use reverse side of this form if necessary.)  
No allowable will be assigned to the well until all interests have been consolidated (by communitization, unitization, forced-pooling, or otherwise) or until a non-standard unit, eliminating such interest, has been approved by the Division.

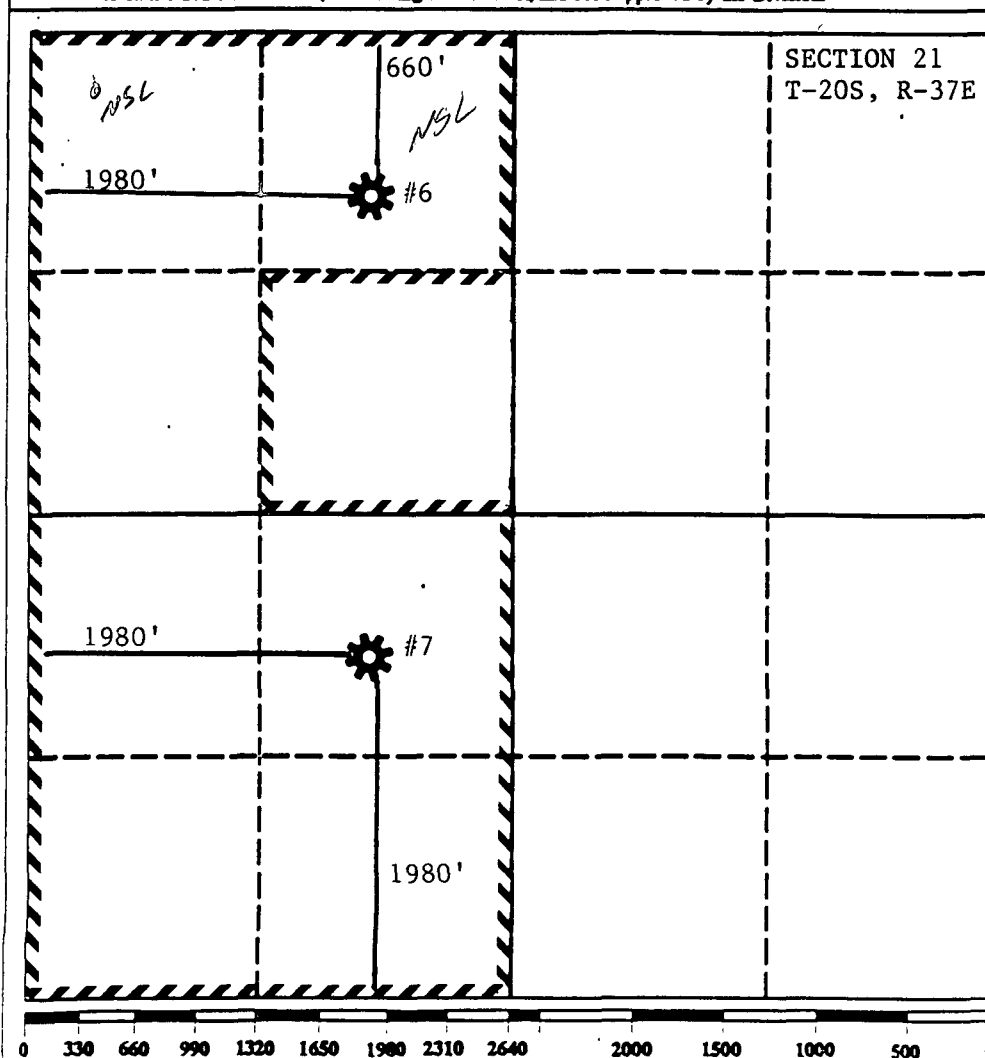

OPERATOR CERTIFICATION

I hereby certify that the information contained herein is true and complete to the best of my knowledge and belief.

Signature

*Evelyn E. Gilson*

Printed Name ( )

EVELYN GILSON

Position

ENGINEERING TECHNICIAN

Company

ARCO OIL AND GAS COMPANY

Date

JANUARY 28, 1993

SURVEYOR CERTIFICATION

I hereby certify that the well location shown on this plat was plotted from field notes of actual surveys made by me or under my supervision, and that the same is true and correct to the best of my knowledge and belief.

Date Surveyed

Signature & Seal of  
Professional Surveyor

Certificate No.

Submit to Appropriate  
District Office  
State Lease - 6 copies  
Fee Lease - 5 copies  
**DISTRICT I**  
P.O. Box 1980, Hobbs, NM 88240

**DISTRICT II**  
P.O. Drawer DD, Artesia, NM 88210

**DISTRICT III**  
1000 Rio Brazos Rd., Aztec, NM 87410

State of New Mexico  
Energy, Minerals and Natural Resources Department

**OIL CONSERVATION DIVISION**  
P.O. Box 2088  
Santa Fe, New Mexico 87504-2088

Form C-105  
Revised 1-1-89

WELL API NO. 30-025-24418
5. Indicate Type of Lease STATE <input type="checkbox"/> FEE <input checked="" type="checkbox"/>
6. State Oil & Gas Lease No.

WELL COMPLETION OR RECOMPLETION REPORT AND LOG					
1a. Type of Well: OIL WELL <input checked="" type="checkbox"/> GAS WELL <input type="checkbox"/> DRY <input type="checkbox"/> OTHER <input type="checkbox"/>			7. Lease Name or Unit Agreement Name W. C. ROACH		
b. Type of Completion: NEW WELL <input type="checkbox"/> WORK OVER <input type="checkbox"/> DEEPEN <input type="checkbox"/> PLUG BACK <input type="checkbox"/> DEEP RESER <input type="checkbox"/> OTHER <input type="checkbox"/>			8. Well No. 5		
2. Name of Operator ARCO OIL & GAS COMPANY			9. Pool name or Wildcat EUMONT YATES 7RQ		
3. Address of Operator P O BOX 1710 HOBBS, NEW MEXICO 88240					
4. Well Location Unit Letter <u>F</u> : <u>1650</u> Feet From The <u>North</u> Line and <u>1650</u> Feet From The <u>WEST</u> Line Section <u>21</u> Township <u>20 S</u> Range <u>37 E</u> NMPM LEA County					
10. Date Spudded 12/14/92	11. Date T.D. Reached	12. Date Compl. (Ready to Prod.) 1/7/93	13. Elevations (DF & RKB, RT, GR, etc.) 3512 GR	14. Elev. Casinghead	
15. Total Depth 3808	16. Plug Back T.D. 3608	17. If Multiple Compl. How Many Zones?	18. Intervals Drilled By Rotary Tools	Cable Tools	
19. Producing Interval(s), of this completion - Top, Bottom, Name 3266-3593/ .37 1JSPF/ 35 SHOTS				20. Was Directional Survey Made NO	
21. Type Electric and Other Logs Run CBL / CCL				22. Was Well Cored NO	

**CASING RECORD (Report all strings set in well)**

CASING SIZE	WEIGHT LB/FT.	DEPTH SET	HOLE SIZE	CEMENTING RECORD	AMOUNT PULLED
8 5/8	24	426		325	0
4 1/2	9.5	3808		550 ORG + 403 SX	0

24. LINER RECORD					25. TUBING RECORD		
SIZE	TOP	BOTTOM	SACKS CEMENT	SCREEN	SIZE	DEPTH SET	PACKER SET
					2 3/8	3555	NO

26. Perforation record (interval, size, and number) 3266-3593 / .37 1JSPF/ 35 SHOTS	27. ACID, SHOT, FRACTURE, CEMENT, SQUEEZE, ETC.	
	DEPTH INTERVAL	AMOUNT AND KIND MATERIAL USED
	3266-3593	4200 GAL HCL. FRAC W/229
		TONS CO2 & 274,000# 12/20 SAND

28. PRODUCTION							
Date First Production 1/7/93		Production Method (Flowing, gas lift, pumping - Size and type pump) PUMPING, 2 X 1 1/4X 3 X 12 RWTC				Well Status (Prod. or Shut-in) PROD.	
Date of Test 1/15/93	Hours Tested 24	Choke Size	Prod'n For Test Period	Oil - Bbl. 8	Gas - MCF 400	Water - Bbl. 1	Gas - Oil Ratio 50.000
Flow Tubing Press.	Casing Pressure 115	Calculated 24-Hour Rate	Oil - Bbl.	Gas - MCF	Water - Bbl.	Oil Gravity - API - (Corr.)	

29. Disposition of Gas (Sold, used for fuel, vented, etc.) SOLD	Test Witnessed By
--	-------------------

30. List Attachments
----------------------

31. I hereby certify that the information shown on both sides of this form is true and complete to the best of my knowledge and belief

Signature James Cogburn Printed Name James Cogburn Title Operations Coordinator Date 1/20/93



STATE OF NEW MEXICO  
ENERGY, MINERALS AND NATURAL RESOURCES DEPARTMENT

OIL CONSERVATION DIVISION  
HOBBS DISTRICT OFFICE

2-4-93

BRUCE KING  
GOVERNOR

POST OFFICE BOX 1980  
HOBBS, NEW MEXICO 88241-1980  
(505) 393-6161

OIL CONSERVATION DIVISION  
P. O. BOX 2088  
SANTA FE, NEW MEXICO 87501

RE: Proposed:

MC \_\_\_\_\_  
DHC \_\_\_\_\_  
NSL \_\_\_\_\_  
NSP *X amend* \_\_\_\_\_  
SWD \_\_\_\_\_  
WFX \_\_\_\_\_  
PMX \_\_\_\_\_

Gentlemen:

I have examined the application for the:

*Arco oil & Gas Co. W.C. Roach #6-C & #7-K 21-20-37*  
Operator Lease & Well No. Unit S-T-R

and my recommendations are as follows:

*OK*

Yours very truly,

*Jerry Sexton*  
Jerry Sexton  
Supervisor, District 1

/ed



OIL CONSERVATION DIVISION  
RECEIVED

'93 FEB 12 AM 8 46

## WAIVER TO OBJECTION

### ARCO OIL AND GAS COMPANY

**Application to amend an existing 320-acre Eumont gas  
proration unit by deleting 40-acres to form a 280-acre  
Eumont Gas Proration Unit and a 40-acre Eumont  
Oil Proration Unit**

**Eumont Gas Pool and Eumont Oil Pool  
W/2, Section 21, T20S, R37E  
Lea County, New Mexico**

I/We do hereby waive any objection to ARCO Oil and Gas Company's request for NMOCD Administrative Approval to amend an existing 320-acre Eumont gas proration unit by deleting 40-acres to form a 280-acre Eumont Gas proration unit and a 40-acre Eumont oil proration unit.

It is our understanding that the new Eumont gas proration unit of 280 acres will comprise the N/2 NW/4, SW/4 NW/4 and all of the SW/4 of Section 21, T20S, R37E, Lea County, New Mexico. Also that this 280 acres will continue to be simultaneously dedicated to the W. C. Roach Well Nos. 6 and 7.

Signed: JB Godbold  
Title: Engr. Supv.  
Company: Chevron U.S.A. Prod. Co.  
Date: 2/9/93