

**EXXON COMPANY, U.S.A.**

POST OFFICE BOX 1600 • MIDLAND, TEXAS 79702-1600

OIL CONSERVATION DIVISION  
RECEIVED

AUG 16 1994 8 50

PRODUCTION DEPARTMENT  
SOUTHWESTERN DIVISION

ENVIRONMENTAL AND REGULATORY AFFAIRS

August 16, 1994

Non-Standard Gas Spacing and Proration Unit  
Simultaneous Dedication  
Exxon - Eumont Gas Com 2 Wells 1, 2, 3, 4, 5, 6  
Unorthodox Locations  
Exxon - Eumont Gas Com 2 Wells 1 and 4  
Eumont Yates 7 Rvrs. Qn. (Pro Gas) Pool  
Section 29, T21S-R36E  
Lea County, New Mexico

Mr. William J. Le May  
New Mexico Oil Conservation Division  
P.O. Box 2088  
Santa Fe, New Mexico 87504-2088

Exxon Corporation is requesting administrative approval of a 320 acre (S2 Sec. 29, T21S-R36E, Lea County) Non-Standard Gas Spacing and Proration Unit and Simultaneous Dedication for the Eumont Gas Com 2 Well Nos. 1, 2, 3, 4, 5, and 6 in the Eumont Yates 7 Rvrs. Qn. (Pro Gas) Pool. Administrative approval of unorthodox locations for Well Nos. 1 and 4 is also being requested. Due to recent recompletions, these wells have or will become gas wells, therefore, these wells will go from New Mexico "B" St. lease wells (oil wells) to Eumont Gas Com 2 lease wells (gas wells).

New Well Name	Acres in Proration Unit	NSP#
Eumont Gas Com 2 #1	200	NSP-1688 (A) (SD) (L) Approved 06/14/94
Eumont Gas Com 2 #2 (was NM "B" St. #9)	200	NSP-1688 (A) (SD) (L) Approved 06/14/94
Eumont Gas Com 2 #3 (was NM "B" St. #10)	200	NSP-1688 (A) (SD) (L) Approved 06/14/94
Eumont Gas Com 2 #4 (was NM "B" St. #8)	40	Oil Well
Eumont Gas Com 2 #5 (was NM "B" St. #11)	40	Oil Well
Eumont Gas Com 2 #6 (was NM "B" St. #6)	40	Oil Well

This 320 acre gas spacing and proration unit and simultaneous dedication will provide simplified lease operations. Enclosed is a copy of the cover letter, C-102 and C-103's that were sent to the Offset Operators and the District Office. Also, enclosed is a copy of the certified return receipts.

If you have any questions, please call me at (915) 688-6782.

Sincerely,

  
Alex M. Correa

AMC:mds  
Enclosures  
8\eumont8.ltr

c: NMOCD  
District Office - Hobbs  
Attn: J. Sexton

A DIVISION OF EXXON CORPORATION



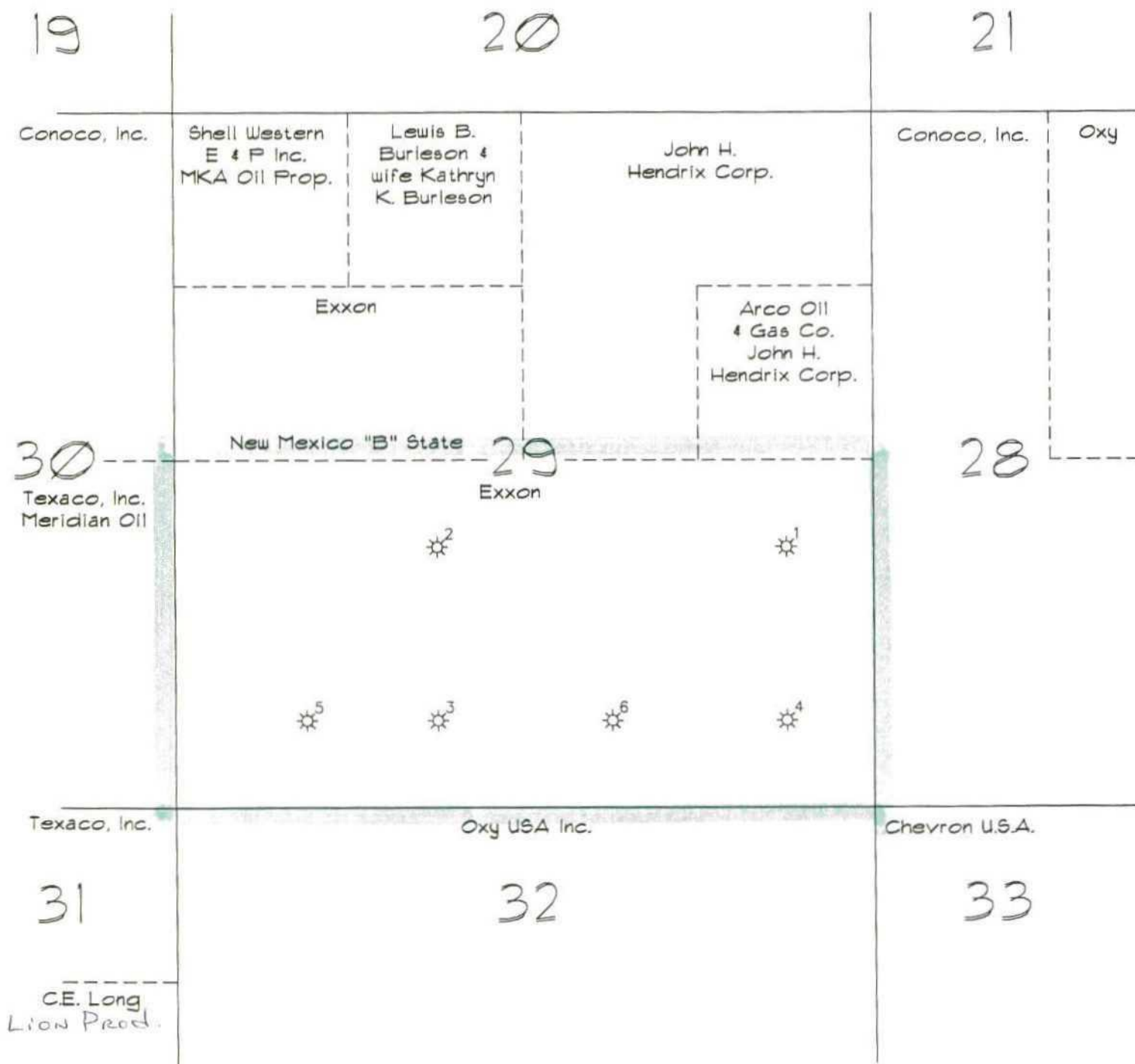

Eumont Gas Unit Com 2  
A01970A

**OFFSET OPERATORS**

Exxon Corp.  
Eumont Gas Com 2  
Wells #1, 2, 3, 4, 5 and 6  
Section 29, T21S-R36E  
Lea County, New Mexico

ARCO Oil & Gas Company  
P.O. Box 600  
Dallas, Texas 75221-9884  
Attn: R. Zinn, Rm. 7020-DAB

Lion Production Inc.  
P.O. Box 2086  
Midland, Texas 79702

Conoco, Inc.  
10 Desta Dr., Suite 100W  
Midland, Texas 79705  
Attn: J. W. Hoover

John H. Hendrix Corporation  
223 W. Wall, Suite 525  
Midland, Texas 79701

Lewis B. Burleson &  
wife Kathryn K. Burleson  
P.O. Box 2479  
Midland, Texas 79702

MKA Oil Properties  
C/O Michael L. Klein  
505 Midland National Bank Tower  
Midland, Texas 79701

Meridian Oil Inc.  
P.O. Box 51810  
Midland, Texas 79710  
Attn: Land Department

Oxy USA Incorporated  
P.O. Box 50250  
Midland, Texas 79705  
Attn: Land Department

Texaco, Inc.  
P.O. Box 3109  
Midland, Texas 79702  
Attn: Land Department

Chevron U.S.A.  
P.O. Box 1150  
Midland, Texas 79705  
Attn: Land Department

Exxon Corp.  
P.O. Box 1600, ML-14  
Midland, Texas 79702  
Attn: C. H. Harper

Shell Western E&P Inc.  
P.O. Box 576  
Houston, Texas 77001  
Attn: Land Department

C. E. Long  
P.O. Box 1943  
Midland, Texas 79702-1943

AUG 03 1994  
NGPA Permits

# WAIVER

New Mexico Oil Conservation Commission  
P.O. Box 2088  
Santa Fe, New Mexico 87504-2088

Dear Sir:

This is to advise that the undersigned has been given due notice that Exxon Corp. has made application for a 320 acre (S2 Section 29, T21S-R36E, Lea County, New Mexico) Non-Standard Gas Spacing and Proration Unit and Simultaneous Dedication for the Eumont Gas Com 2 Well Nos. 1, 2, 3, 4, 5 and 6 in the Eumont Yates 7 Rvrs. Qn. (Pro Gas) Pool. Also, Well Nos. 1 and 4 are at Unorthodox Locations.

We, the undersigned, hereby waive any objection to the granting of this application for a 320 acre (S2, Section 29, T21S-R36E) Non-Standard Gas Spacing and Proration Unit, Simultaneous Dedication (Nos. 1, 2, 3, 4, 5 and 6) and Unorthodox Locations (Nos. 1 and 4) in the Eumont Yates 7 Rvrs. Qn. (Pro Gas) Pool for the Exxon Corp. Eumont Gas Com 2 Well Nos. 1, 2, 3, 4, 5 and 6.

The location of these wells in Section 29, T21S-R36E, Lea County, New Mexico is as follows:

Well No.	Unit Letter	Location
1	I	1980' FSL & 660' FEL
2	K	1980' FSL & 1980' FWL
3	N	660' FSL & 1980' FWL
4	P	660' FSL & 660' FEL
5	M	660' FSL & 990' FWL
6	O	660' FSL & 1980' FEL

Executed this 2 day of Aug, 1994.

Company: John H. Hendrix Corp  
By: Kenmi H. Westphal

OIL CONSERVATION DIVISION  
RECEIVED

'94 AUG 10 AM 8 50

# WAIVER

New Mexico Oil Conservation Commission  
P.O. Box 2088  
Santa Fe, New Mexico 87504-2088

Dear Sir:

This is to advise that the undersigned has been given due notice that Exxon Corp. has made application for a 320 acre (S2 Section 29, T21S-R36E, Lea County, New Mexico) Non-Standard Gas Spacing and Proration Unit and Simultaneous Dedication for the Eumont Gas Com 2 Well Nos. 1, 2, 3, 4, 5 and 6 in the Eumont Yates 7 Rvrs. Qn. (Pro Gas) Pool. Also, Well Nos. 1 and 4 are at Unorthodox Locations.

We, the undersigned, hereby waive any objection to the granting of this application for a 320 acre (S2, Section 29, T21S-R36E) Non-Standard Gas Spacing and Proration Unit, Simultaneous Dedication (Nos. 1, 2, 3, 4, 5 and 6) and Unorthodox Locations (Nos. 1 and 4) in the Eumont Yates 7 Rvrs. Qn. (Pro Gas) Pool for the Exxon Corp. Eumont Gas Com 2 Well Nos. 1, 2, 3, 4, 5 and 6.

The location of these wells in Section 29, T21S-R36E, Lea County, New Mexico is as follows:

Well No.	Unit Letter	Location
1	I	1980' FSL & 660' FEL
2	K	1980' FSL & 1980' FWL
3	N	660' FSL & 1980' FWL
4	P	660' FSL & 660' FEL
5	M	660' FSL & 990' FWL
6	O	660' FSL & 1980' FEL

Executed this 3<sup>rd</sup> day of August, 1994.

Company: Texaco Inc  
By: Charles A. Hart

OIL CONSERVATION DIVISION  
RECEIVED

'94 AUG 10 AM 8 50

# WAIVER

New Mexico Oil Conservation Commission  
P.O. Box 2088  
Santa Fe, New Mexico 87504-2088

Dear Sir:

This is to advise that the undersigned has been given due notice that Exxon Corp. has made application for a 320 acre (S2 Section 29, T21S-R36E, Lea County, New Mexico) Non-Standard Gas Spacing and Proration Unit and Simultaneous Dedication for the Eumont Gas Com 2 Well Nos. 1, 2, 3, 4, 5 and 6 in the Eumont Yates 7 Rvrs. Qn. (Pro Gas) Pool. Also, Well Nos. 1 and 4 are at Unorthodox Locations.

We, the undersigned, hereby waive any objection to the granting of this application for a 320 acre (S2, Section 29, T21S-R36E) Non-Standard Gas Spacing and Proration Unit, Simultaneous Dedication (Nos. 1, 2, 3, 4, 5 and 6) and Unorthodox Locations (Nos. 1 and 4) in the Eumont Yates 7 Rvrs. Qn. (Pro Gas) Pool for the Exxon Corp. Eumont Gas Com 2 Well Nos. 1, 2, 3, 4, 5 and 6.

The location of these wells in Section 29, T21S-R36E, Lea County, New Mexico is as follows:

Well No.	Unit Letter	Location
1	I	1980' FSL & 660' FEL
2	K	1980' FSL & 1980' FWL
3	N	660' FSL & 1980' FWL
4	P	660' FSL & 660' FEL
5	M	660' FSL & 990' FWL
6	O	660' FSL & 1980' FEL

Executed this 2nd day of August, 1994.

Company: Chevron U.S.A, Inc.

By: J. S. Godbold For F.S. Godbold

OIL CONSERVATION DIVISION  
RECEIVED  
'94 AUG 1 AM 8 50

WAIVER

New Mexico Oil Conservation Commission  
P.O. Box 2088  
Santa Fe, New Mexico 87504-2088

Dear Sir:

This is to advise that the undersigned has been given due notice that Exxon Corp. has made application for a 320 acre (S2 Section 29, T21S-R36E, Lea County, New Mexico) Non-Standard Gas Spacing and Proration Unit and Simultaneous Dedication for the Eumont Gas Com 2 Well Nos. 1, 2, 3, 4, 5 and 6 in the Eumont Yates 7 Rvrs. Qn. (Pro Gas) Pool. Also, Well Nos. 1 and 4 are at Unorthodox Locations.

We, the undersigned, hereby waive any objection to the granting of this application for a 320 acre (S2, Section 29, T21S-R36E) Non-Standard Gas Spacing and Proration Unit, Simultaneous Dedication (Nos. 1, 2, 3, 4, 5 and 6) and Unorthodox Locations (Nos. 1 and 4) in the Eumont Yates 7 Rvrs. Qn. (Pro Gas) Pool for the Exxon Corp. Eumont Gas Com 2 Well Nos. 1, 2, 3, 4, 5 and 6.

The location of these wells in Section 29, T21S-R36E, Lea County, New Mexico is as follows:

Well No.	Unit Letter	Location
1	I	1980' FSL & 660' FEL
2	K	1980' FSL & 1980' FWL
3	N	660' FSL & 1980' FWL
4	P	660' FSL & 660' FEL
5	M	660' FSL & 990' FWL
6	O	660' FSL & 1980' FEL

Executed this 26 day of July, 1994.

Company: Lewis Berlemon, Inc.  
By: [Signature]

'94 AUG 22 AM 8 50

**WAIVER**

New Mexico Oil Conservation Commission  
P.O. Box 2088  
Santa Fe, New Mexico 87504-2088

Dear Sir:

This is to advise that the undersigned has been given due notice that Exxon Corp. has made application for a 320 acre (S2 Section 29, T21S-R36E, Lea County, New Mexico) Non-Standard Gas Spacing and Proration Unit and Simultaneous Dedication for the Eumont Gas Com 2 Well Nos. 1, 2, 3, 4, 5 and 6 in the Eumont Yates 7 Rvrs. Qn. (Pro Gas) Pool. Also, Well Nos. 1 and 4 are at Unorthodox Locations.

We, the undersigned, hereby waive any objection to the granting of this application for a 320 acre (S2, Section 29, T21S-R36E) Non-Standard Gas Spacing and Proration Unit, Simultaneous Dedication (Nos. 1, 2, 3, 4, 5 and 6) and Unorthodox Locations (Nos. 1 and 4) in the Eumont Yates 7 Rvrs. Qn. (Pro Gas) Pool for the Exxon Corp. Eumont Gas Com 2 Well Nos. 1, 2, 3, 4, 5 and 6.

The location of these wells in Section 29, T21S-R36E, Lea County, New Mexico is as follows:

Well No.	Unit Letter	Location
1	I	1980' FSL & 660' FEL
2	K	1980' FSL & 1980' FWL
3	N	660' FSL & 1980' FWL
4	P	660' FSL & 660' FEL
5	M	660' FSL & 990' FWL
6	O	660' FSL & 1980' FEL

Executed this 15<sup>th</sup> day of August, 1994.

Company: LION PRODUCTION, INC  
By: [Signature]  
PRESIDENT



OIL CONSERV. DIVISION  
RECEIVED  
'94 AUG 26 AM 8 50

# **WAIVER**

New Mexico Oil Conservation Commission  
P.O. Box 2088  
Santa Fe, New Mexico 87504-2088

Dear Sir:

This is to advise that the undersigned has been given due notice that Exxon Corp. has made application for a 320 acre (S2 Section 29, T21S-R36E, Lea County, New Mexico) Non-Standard Gas Spacing and Proration Unit and Simultaneous Dedication for the Eumont Gas Com 2 Well Nos. 1, 2, 3, 4, 5 and 6 in the Eumont Yates 7 Rvrs. Qn. (Pro Gas) Pool. Also, Well Nos. 1 and 4 are at Unorthodox Locations.

We, the undersigned, hereby waive any objection to the granting of this application for a 320 acre (S2, Section 29, T21S-R36E) Non-Standard Gas Spacing and Proration Unit, Simultaneous Dedication (Nos. 1, 2, 3, 4, 5 and 6) and Unorthodox Locations (Nos. 1 and 4) in the Eumont Yates 7 Rvrs. Qn. (Pro Gas) Pool for the Exxon Corp. Eumont Gas Com 2 Well Nos. 1, 2, 3, 4, 5 and 6.

The location of these wells in Section 29, T21S-R36E, Lea County, New Mexico is as follows:

Well No.	Unit Letter	Location
1	I	1980' FSL & 660' FEL
2	K	1980' FSL & 1980' FWL
3	N	660' FSL & 1980' FWL
4	P	660' FSL & 660' FEL
5	M	660' FSL & 990' FWL
6	O	660' FSL & 1980' FEL

Executed this 23rd day of August, 1994.

Company: Meridian Oil Inc.

By: Leslyn Swierc

Leslyn Swierc

*Eumont Las Com 2 #1-6*

SENDER: Complete items 1 and 2 when additional services are desired, and complete items 3 and 4.  
Put your address in the "RETURN TO" Space on the reverse side. Failure to do this will prevent this card from being returned to you. The return receipt fee will provide you the name of the person delivered to and the date of delivery. For additional fees the following services are available. Consult postmaster for fees and check boxes for additional services requested.  
1. ☐ Show to whom delivered, date, and addressee's address. 2. ☐ Restricted Delivery (Extra charge)

3. Article Addressed to:  
Chevron U.S.A.  
P.O. Box 1150  
Midland, TX 79705  
Attn: Land Department

4. Article Number  
P322579881  
Type of Service: ☐ Registered ☐ Insured  
☒ Certified ☐ COD  
☐ Express Mail ☐ Return Receipt for Merchandise  
Always obtain signature of addressee or agent and DATE DELIVERED.

5. Signature - Addressee  
X  
6. Signature - Agent  
X *John Hamm*  
7. Date of Delivery  
JUL 26 1994

PS Form 3811, Apr. 1989 \*U.S.G.P.O. 1989-238-815 DOMESTIC RETURN RECEIPT

*Eumont Las Com 2 #1-6*

SENDER: Complete items 1 and 2 when additional services are desired, and complete items 3 and 4.  
Put your address in the "RETURN TO" Space on the reverse side. Failure to do this will prevent this card from being returned to you. The return receipt fee will provide you the name of the person delivered to and the date of delivery. For additional fees the following services are available. Consult postmaster for fees and check boxes for additional services requested.  
1. ☐ Show to whom delivered, date, and addressee's address. 2. ☐ Restricted Delivery (Extra charge)

3. Article Addressed to:  
Texaco, Inc.  
P.O. Box 3109  
Midland, TX 79702

4. Article Number  
P322579883  
Type of Service: ☐ Registered ☐ Insured  
☒ Certified ☐ COD  
☐ Express Mail ☐ Return Receipt for Merchandise  
Always obtain signature of addressee or agent and DATE DELIVERED.

5. Signature - Addressee  
X  
6. Signature - Agent  
X *John Hamm*  
7. Date of Delivery  
JUL 26 1994

PS Form 3811, Apr. 1989 \*U.S.G.P.O. 1989-238-815 DOMESTIC RETURN RECEIPT

*Eumont Las Com 2 #1-6*

SENDER: Complete items 1 and 2 when additional services are desired, and complete items 3 and 4.  
Put your address in the "RETURN TO" Space on the reverse side. Failure to do this will prevent this card from being returned to you. The return receipt fee will provide you the name of the person delivered to and the date of delivery. For additional fees the following services are available. Consult postmaster for fees and check boxes for additional services requested.  
1. ☐ Show to whom delivered, date, and addressee's address. 2. ☐ Restricted Delivery (Extra charge)

3. Article Addressed to:  
ARCO Oil & Gas Company  
P.O. Box 600  
Dallas, TX 75221-9884  
Attn: R. Zimm

4. Article Number  
P322579891  
Type of Service: ☐ Registered ☐ Insured  
☒ Certified ☐ COD  
☐ Express Mail ☐ Return Receipt for Merchandise  
Always obtain signature of addressee or agent and DATE DELIVERED.

5. Signature - Addressee  
X  
6. Signature - Agent  
X *John Hamm*  
7. Date of Delivery  
JUL 27 1994

PS Form 3811, Apr. 1989 \*U.S.G.P.O. 1989-238-815 NGPA Permits DOMESTIC RETURN RECEIPT

*Eumont Las Com 2 #1-6*

SENDER: Complete items 1 and 2 when additional services are desired, and complete items 3 and 4.  
Put your address in the "RETURN TO" Space on the reverse side. Failure to do this will prevent this card from being returned to you. The return receipt fee will provide you the name of the person delivered to and the date of delivery. For additional fees the following services are available. Consult postmaster for fees and check boxes for additional services requested.  
1. ☐ Show to whom delivered, date, and addressee's address. 2. ☐ Restricted Delivery (Extra charge)

3. Article Addressed to:  
Lewis B. Burleson &  
wife Kathryn K. Burleson  
P.O. Box 2479  
Midland, TX 79702

4. Article Number  
P322579888  
Type of Service: ☐ Registered ☐ Insured  
☒ Certified ☐ COD  
☐ Express Mail ☐ Return Receipt for Merchandise  
Always obtain signature of addressee or agent and DATE DELIVERED.

5. Signature - Addressee  
X  
6. Signature - Agent  
X *Donna Thurston*  
7. Date of Delivery  
7-26-94

PS Form 3811, Apr. 1989 \*U.S.G.P.O. 1989-238-815 NGPA Permits DOMESTIC RETURN RECEIPT

*Exxon-Exxon Gas Com 2 #1-6*

**SENDER:** Complete items 1 and 2 when additional services are desired, and complete items 3 and 4.

Put your address in the "RETURN TO" Space on the reverse side. Failure to do this will prevent this card from being returned to you. The return receipt fee will provide you the name of the person delivered to and the date of delivery. For additional fees the following services are available. Consult postmaster for fees and check boxes for additional services requested.

1. ☐ Show to whom delivered, date, and addressee's address. 2. ☐ Restricted Delivery (Extra charge)

3. Article Addressed to:

John H. Hendrix Corporation  
223 W. Wall, Suite 525  
Midland, TX 79701

4. Article Number: **P3822 579 889**

Type of Service: ☐ Registered ☐ Insured ☒ Certified ☐ COD ☐ Return Receipt for Merchandise ☐ Express Mail

Always obtain signature of addressee or agent and DATE DELIVERED.

8. Addressee's Address (ONLY if requested and fee paid)

Signature - Addressee: *[Signature]*

Signature - Agent: *[Signature]*

Date of Delivery: *7-26-94*

JUL 27 1994

NGPA Permits

PS Form 3811, Apr. 1989 \*U.S.G.P.O. 1989-238-815 DOMESTIC RETURN RECEIPT

*Exxon-Exxon Gas Com 2*

**SENDER:** Complete items 1 and 2 when additional services are desired, and complete items 3 and 4.

Put your address in the "RETURN TO" Space on the reverse side. Failure to do this will prevent this card from being returned to you. The return receipt fee will provide you the name of the person delivered to and the date of delivery. For additional fees the following services are available. Consult postmaster for fees and check boxes for additional services requested.

1. ☐ Show to whom delivered, date, and addressee's address. 2. ☐ Restricted Delivery (Extra charge)

3. Article Addressed to:

Lion Production Inc.  
P.O. Box 2086  
Midland, TX 79702

4. Article Number: **P3822 579 893**

Type of Service: ☐ Registered ☐ Insured ☒ Certified ☐ COD ☐ Return Receipt for Merchandise ☐ Express Mail

Always obtain signature of addressee or agent and DATE DELIVERED.

8. Addressee's Address (ONLY if requested and fee paid)

Signature - Addressee: *[Signature]*

Signature - Agent: *[Signature]*

Date of Delivery: *8-3-94*

PS Form 3811, Apr. 1989 \*U.S.G.P.O. 1989-238-815 DOMESTIC RETURN RECEIPT

*Exxon-Exxon Gas Com 2 #1-6*

**SENDER:** Complete items 1 and 2 when additional services are desired, and complete items 3 and 4.

Put your address in the "RETURN TO" Space on the reverse side. Failure to do this will prevent this card from being returned to you. The return receipt fee will provide you the name of the person delivered to and the date of delivery. For additional fees the following services are available. Consult postmaster for fees and check boxes for additional services requested.

1. ☐ Show to whom delivered, date, and addressee's address. 2. ☐ Restricted Delivery (Extra charge)

3. Article Addressed to:

Conoco, Inc.  
10 Desta Dr., Suite 100W  
Midland, TX 79705  
Attn: J. W. Hoover

4. Article Number: **P3822 579 890**

Type of Service: ☐ Registered ☐ Insured ☒ Certified ☐ COD ☐ Return Receipt for Merchandise ☐ Express Mail

Always obtain signature of addressee or agent and DATE DELIVERED.

8. Addressee's Address (ONLY if requested and fee paid)

Signature - Addressee: *[Signature]*

Signature - Agent: *[Signature]*

Date of Delivery: *7-26-94*

PS Form 3811, Apr. 1989 \*U.S.G.P.O. 1989-238-815 DOMESTIC RETURN RECEIPT

*Exxon-Exxon Gas Com 2 #1-6*

**SENDER:** Complete items 1 and 2 when additional services are desired, and complete items 3 and 4.

Put your address in the "RETURN TO" Space on the reverse side. Failure to do this will prevent this card from being returned to you. The return receipt fee will provide you the name of the person delivered to and the date of delivery. For additional fees the following services are available. Consult postmaster for fees and check boxes for additional services requested.

1. ☐ Show to whom delivered, date, and addressee's address. 2. ☐ Restricted Delivery (Extra charge)

3. Article Addressed to:

Exxon Corp.  
P.O. Box 1600, ML-14  
Midland, TX 79702  
Attn: C. H. Harper

4. Article Number: **P3822 579 882**

Type of Service: ☐ Registered ☐ Insured ☒ Certified ☐ COD ☐ Return Receipt for Merchandise ☐ Express Mail

Always obtain signature of addressee or agent and DATE DELIVERED.

8. Addressee's Address (ONLY if requested and fee paid)

Signature - Addressee: *[Signature]*

Signature - Agent: *[Signature]*

Date of Delivery: *JUL 26 1994*

JUL 27 1994

NGPA Permits

PS Form 3811, Apr. 1989 \*U.S.G.P.O. 1989-238-815 DOMESTIC RETURN RECEIPT

Enron Gas Com 2 #1-6

**SENDER:** Complete items 1 and 2 when additional services are desired, and complete items 3 and 4.  
Put your address in the "RETURN TO" Space on the reverse side. Failure to do this will prevent this card from being returned to you. The return receipt fee will provide you the name of the person delivered to and the date of delivery. For additional fees the following services are available. Consult postmaster for fees and check boxes for additional service(s) requested.  
1. ☐ Show to whom delivered, date, and addressee's address. 2. ☐ Restricted Delivery (Extra charge)

3. Article Addressed to:

Oxy USA Incorporated  
P.O. Box 50250  
Midland, TX 79705  
Attn: Land Department

4. Article Number

P 322 579 885

Type of Service:

☐ Registered ☐ Insured  
☒ Certified ☐ COD  
☐ Express Mail ☐ Return Receipt for Merchandise

Always obtain signature of addressee or agent and DATE DELIVERED.

8. Addressee's Address (ONLY if requested and fee paid)

JUL 27 1994

NGPA Permits

PS Form 3811, Apr. 1989

\* U.S.G.P.O. 1989-238-815

DOMESTIC RETURN RECEIPT

Enron Gas Com 2 #1-6

**SENDER:** Complete items 1 and 2 when additional services are desired, and complete items 3 and 4.  
Put your address in the "RETURN TO" Space on the reverse side. Failure to do this will prevent this card from being returned to you. The return receipt fee will provide you the name of the person delivered to and the date of delivery. For additional fees the following services are available. Consult postmaster for fees and check boxes for additional service(s) requested.  
1. ☐ Show to whom delivered, date, and addressee's address. 2. ☐ Restricted Delivery (Extra charge)

3. Article Addressed to:

Shell Western E&P Inc.  
P.O. Box 576  
Houston, TX 77001  
Attn: Land Department

4. Article Number

P 322 579 884

Type of Service:

☐ Registered ☐ Insured  
☒ Certified ☐ COD  
☐ Express Mail ☐ Return Receipt for Merchandise

Always obtain signature of addressee or agent and DATE DELIVERED.

8. Addressee's Address (ONLY if requested and fee paid)

AUG 01 1994

NGPA Permits

PS Form 3811, Apr. 1989

\* U.S.G.P.O. 1989-238-815

DOMESTIC RETURN RECEIPT

Enron Gas Com 2 #1-6

**SENDER:** Complete items 1 and 2 when additional services are desired, and complete items 3 and 4.  
Put your address in the "RETURN TO" Space on the reverse side. Failure to do this will prevent this card from being returned to you. The return receipt fee will provide you the name of the person delivered to and the date of delivery. For additional fees the following services are available. Consult postmaster for fees and check boxes for additional service(s) requested.  
1. ☐ Show to whom delivered, date, and addressee's address. 2. ☐ Restricted Delivery (Extra charge)

3. Article Addressed to:

MKA Oil Properties  
C/O Michael L. Klein  
505 Midland National Bank Tower  
Midland, TX 79701

4. Article Number

P 322 579 881

Type of Service:

☐ Registered ☐ Insured  
☒ Certified ☐ COD  
☐ Express Mail ☐ Return Receipt for Merchandise

Always obtain signature of addressee or agent and DATE DELIVERED.

8. Addressee's Address (ONLY if requested and fee paid)

JUL 29 1994

NGPA Permits

PS Form 3811, Apr. 1989

\* U.S.G.P.O. 1989-238-815

DOMESTIC RETURN RECEIPT

Enron Gas Com 2 #1-6

**SENDER:** Complete items 1 and 2 when additional services are desired, and complete items 3 and 4.  
Put your address in the "RETURN TO" Space on the reverse side. Failure to do this will prevent this card from being returned to you. The return receipt fee will provide you the name of the person delivered to and the date of delivery. For additional fees the following services are available. Consult postmaster for fees and check boxes for additional service(s) requested.  
1. ☐ Show to whom delivered, date, and addressee's address. 2. ☐ Restricted Delivery (Extra charge)

3. Article Addressed to:

Meridian Oil Inc.  
P.O. Box 51810  
Midland, TX 79710  
Attn: Land Department

4. Article Number

P 322 579 886

Type of Service:

☐ Registered ☐ Insured  
☒ Certified ☐ COD  
☐ Express Mail ☐ Return Receipt for Merchandise

Always obtain signature of addressee or agent and DATE DELIVERED.

8. Addressee's Address (ONLY if requested and fee paid)

JUL 28 1994

NGPA Permits

PS Form 3811, Apr. 1989

\* U.S.G.P.O. 1989-238-815

DOMESTIC RETURN RECEIPT

*Environ Gas Conn 2 #1-6*

<p>● <b>SENDER:</b> Complete items 1 and 2 when additional services are desired, and complete items 3 and 4.</p> <p>Put your address in the "RETURN TO" Space on the reverse side. Failure to do this will prevent this card from being returned to you. The return receipt fee will provide you the name of the person delivered to and the date of delivery. For additional fees the following services are available. Consult postmaster for fees and check box(es) for additional service(s) requested.</p> <p>1. <input type="checkbox"/> Show to whom delivered, date, and addressee's address. (Extra charge)      2. <input type="checkbox"/> Restricted Delivery (Extra charge)</p>	
3. Article Addressed to:  C. E. Long P.O. Box 1943 Midland, TX 79702-1943	4. Article Number <b>P 322 579 892</b>
	Type of Service: <input type="checkbox"/> Registered <input type="checkbox"/> Insured <input checked="" type="checkbox"/> Certified <input type="checkbox"/> COD <input type="checkbox"/> Express Mail <input type="checkbox"/> Return Receipt for Merchandise
	Always obtain signature of addressee or agent and <u>DATE DELIVERED</u> .
5. Signature — Addressee <b>X</b> <i>Has C.E. Long</i>	8. Addressee's Address (ONLY if requested and fee paid)  <b>JUL 29 1994</b>  <b>NGPA Permits</b>
6. Signature — Agent <b>X</b>	
7. Date of Delivery <b>7-28-94</b>	

**EXXON** COMPANY, U.S.A.

POST OFFICE BOX 1600 • MIDLAND, TEXAS 79702-1600

PRODUCTION DEPARTMENT  
SOUTHWESTERN DIVISION

ENVIRONMENTAL AND REGULATORY AFFAIRS

July 22, 1994

Non-Standard Gas Spacing and Proration Unit  
Simultaneous Dedication  
Exxon-Eumont Gas Com 2 Wells 1, 2, 3, 4, 5, 6  
Unorthodox Locations  
Exxon-Eumont Gas Com 2 Wells 1, 4  
Eumont Yates 7 Rvrs. Qn. (Pro Gas) Pool  
Section 29, T21S-R36E  
Lea County, New Mexico

Offset Operators:

Exxon Corp. is requesting administrative approval of a 320 acre (S2 Section 29, T21S-R36E, Lea County) Non-Standard Gas Spacing and Proration Unit and Simultaneous Dedication for the Eumont Gas Com 2 Well Nos. 1, 2, 3, 4, 5 and 6. Administrative approval of unorthodox locations for Well Nos. 1 and 4 is also being requested. Due to recent recompletions, these wells have or will become gas wells. These wells are being recompleted in the Eumont Yates 7 Rvrs. Qn. (Pro Gas) Pool.

If you have no objections to this 320 acre, Non-Standard Gas Spacing and Proration Unit, Simultaneous Dedication and Unorthodox Locations, please sign and return one copy of the enclosed waiver to the NMOCD office in Santa Fe and one copy to me. Return envelopes and copies of the C-102s and C-103s for each well are enclosed.

Sincerely,



Alex M. Correa

AMC:mym

7/eumont.ltr

Enclosures

Certified Mail Receipt No. P 322 579 890

DISTRICT I  
P.O. Box 1980, Hobbs, NM 88240

DISTRICT II  
P.O. Drawer DD, Artesia, NM 88210

DISTRICT III  
1000 Rio Brazos Rd., Aztec, NM 87410

**OIL CONSERVATION DIVISION**  
**P O. Box 2088**  
**Santa Fe, New Mexico 87504-2088**

WELL API NO. <b>3002504823</b>
5. Indicate Type of Lease STATE <input checked="" type="checkbox"/> FEE <input type="checkbox"/>
6. State Oil & Gas Lease No. <b>B-935</b>
7. Lease Name or Unit Agreement Name <b>EUMONT GAS COM 2</b>
8. Well No. <b>1</b>
9. Pool name or Wildcat <b>EUMONT YATES 7 RVRS QN (PRO GAS)</b>

<b>SUNDRY NOTICES AND REPORTS ON WELLS</b> (DO NOT USE THIS FORM FOR PROPOSALS TO DRILL OR TO DEEPEN OR PLUG BACK TO A DIFFERENT RESERVOIR. USE "APPLICATION FOR PERMIT" (FORMC-101) FOR SUCH PROPOSALS.)	
1. Type of Well: OIL <input type="checkbox"/> GAS <input checked="" type="checkbox"/> OTHER	
2. Name of Operator <b>EXXON CORPORATION</b>	
3. Address of Operator <b>ATTN: REGULATORY AFFAIRS ML#14 P. O. BOX 1600 MIDLAND, TX 79702</b>	
4. Well Location Unit Letter <b>I</b> : <b>1980</b> Feet From The <b>SOUTH</b> Line and <b>660</b> Feet From The <b>EAST</b> Line Section <b>29</b> Township <b>21S</b> Range <b>36E</b> NMPM <b>LEA</b> County	
10. Elevation (Show whether DF, RKB, RT, GR, etc.) <b>3637 GR</b>	

Check Appropriate Box to Indicate Nature of Notice, Report, or Other Data

**NOTICE OF INTENTION TO:**

PERFORM REMEDIAL WORK ☐ PLUG AND ABANDON ☐  
TEMPORARILY ABANDON ☐ CHANGE PLANS ☐  
PULL OR ALTER CASING ☐  
OTHER: **EXPAND PRORATION UNIT/SIMO DED** ☒

**SUBSEQUENT REPORT OF:**

REMEDIAL WORK ☐ ALTERING CASING ☐  
COMMENCE DRILLING OPNS. ☐ PLUG & ABANDONMENT ☐  
CASING TEST AND CEMENT JOB ☐  
OTHER: ☐

12. Describe Proposed or Completed Operations (Clearly state all pertinent details, and give pertinent dates, including estimated date of starting any proposed work) SEE RULE 1103.

**ADMINISTRATIVE APPROVAL IS BEING REQUESTED TO:**

- EXPAND PRESENT 200 AC. NON-STANDARD GAS SPACING AND PRORATION UNIT (NSP-1688-A(SD)(L) APPROVED JUN 14, 1994) TO A 320 AC. (S2 SEC. 29) NON-STANDARD GAS SPACING AND PRORATION UNIT IN THE EUMONT YATES 7 RVRS QN (PRO GAS) POOL.
- SIMULTANEOUSLY DEDICATE WELLS 1, 2 (WAS NM B ST. #9), 3 (WAS NM B ST. #10), 4 (WAS NM B ST. #8), 5 (WAS NM B ST. #11) AND 6 (WAS NM B ST. #6).
- UNORTHODOX LOCATION.

**C-102 IS ATTACHED. OFFSET OPERATORS HAVE BEEN NOTIFIED AND C-102'S AND C-103'S FOR #'S 2, 3, 4, 5 AND 6 HAVE ALSO BEEN DONE.**

I hereby certify that the information above is true and complete to the best of my knowledge and belief.

SIGNATURE *Alex M. Correa* TITLE **Sr. Regulatory Specialist** DATE **07/18/94**

TYPE OR PRINT NAME **Alex M. Correa** (915) 688-6782 TELEPHONE NO.

(This space for State Use)

APPROVED BY \_\_\_\_\_ TITLE \_\_\_\_\_ DATE \_\_\_\_\_

CONDITIONS OF APPROVAL, IF ANY:

Submit to Appropriate  
District Office  
State Lease-4 copies  
Fee Lease-3 copies

State of New Mexico  
Energy, Minerals and Natural Resources Department

Form C-102  
Revised 1-1-89

OIL CONSERVATION DIVISION

P.O. Box 2088  
Santa Fe, New Mexico 87504-2088

DISTRICT I  
P.O. Box 1980, Hobbs, NM 88240

DISTRICT II  
P.O. Drawer DD, Artesia, NM 88210

DISTRICT III  
1000 Rio Brazos Rd., Aztec, NM 87410

WELL LOCATION AND ACREAGE DEDICATION PLAT

All distances must be from the outer boundaries of the Section.

Operator Exxon Corporation			Lease EUMONT GAS COM 2		Well No. 1
Unit Letter I	Section 29	Township 21	Range 36	NMPM	County LEA
Actual Footage Location of Well: 1980 feet from the SOUTH line and 660 feet from the EAST line.					
Ground level Elev. 3637 DF	Producing Formation YATES 7 RIVERS QN		Pool EUMONT YATES 7 RVRS QN (PRO GAS)		Dedicated Acreage: 320 Acres

- Outline the acreage dedicated to the subject well by colored pencil or hachure marks on the plat below.
- If more than one lease is dedicated to the well, outline each and identify the ownership thereof (both as to working interest and royalty).
- If more than one lease of different ownership is dedicated to the well, have the interest of all owners been consolidated by communitization, unitization, force-pooling, etc.?  
☐ Yes ☐ No If answer is "yes", type of consolidation \_\_\_\_\_  
If answer is "no", list the owners and tract descriptions which have actually been consolidated. (Use reverse side of this form if necessary.) \_\_\_\_\_

No allowable will be assigned to the well until all interests have been consolidated (by communitization, unitization, forced-pooling, or otherwise) or until a non-standard unit, eliminating such interest, has been approved by the Division.

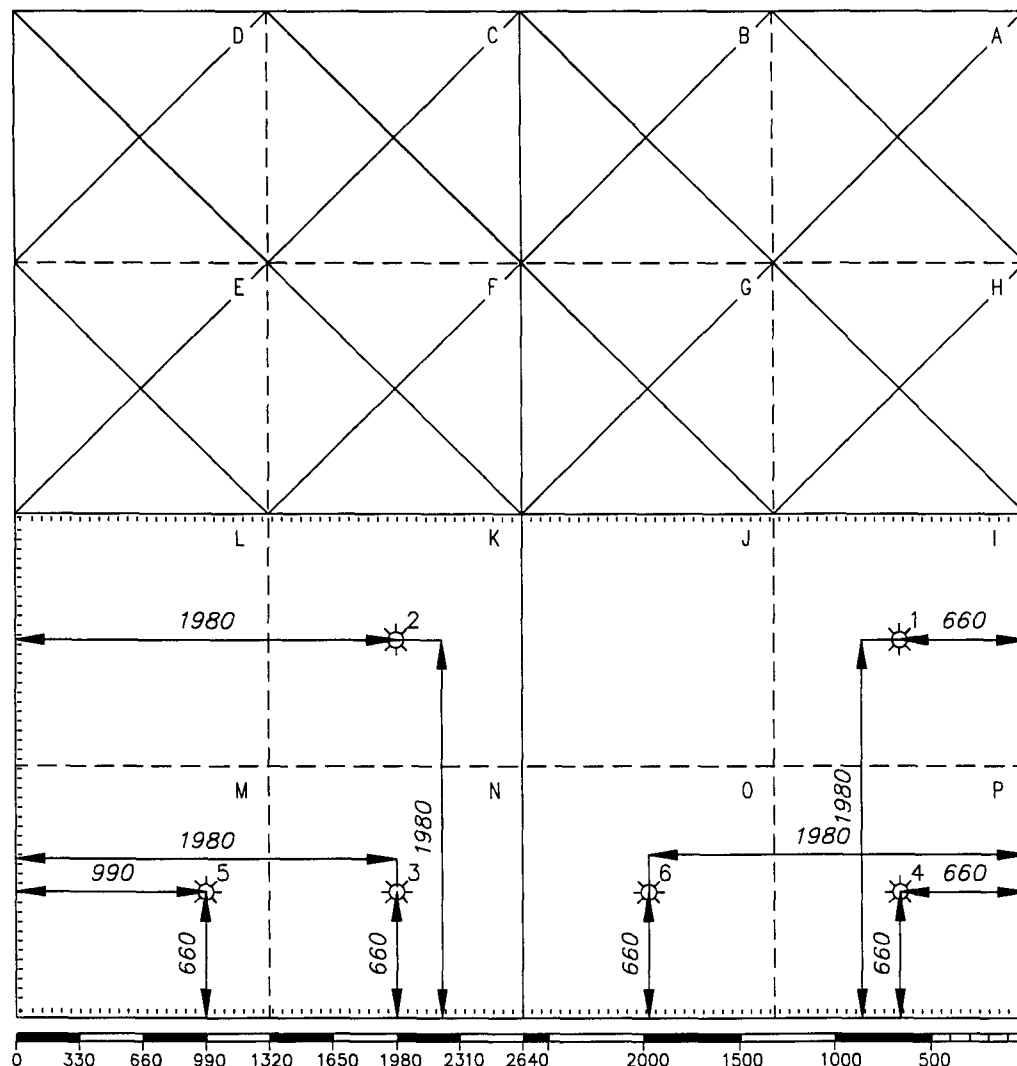

OPERATOR CERTIFICATION

I hereby certify that the information  
contained herein is true and complete to the  
best of my knowledge and belief.

Signature  
C. H. Harper

Printed Name  
C. H. HARPER

Position  
PERMITS SUPERVISOR

Company Exxon Corporation  
P.O. Box 1600-Midland, Tx.-79702

Date  
7/15/94

SURVEYOR CERTIFICATION

I hereby certify that the well location  
shown on this plat was plotted from field  
notes of actual surveys made by me or  
under my supervision, and that the same  
is true and correct to the best of my  
knowledge and belief.

Date Surveyed  
12/9/35

Signature & Seal of  
Professional Surveyor

Certificate No.

4 Miles SSW of OIL CENTER, New Mexico.

C.E. File No. A01970



**DISTRICT I**  
P.O. Box 1980, Hobbs, NM 88240

**DISTRICT II**  
P.O. Drawer DD, Artesia, NM 88210

**DISTRICT III**  
1000 Rio Brazos Rd., Aztec, NM 87410

## OIL CONSERVATION DIVISION

P O. Box 2088  
Santa Fe, New Mexico 87504-2088

WELL API NO. <b>3002504825</b>
5. Indicate Type of Lease STATE <input checked="" type="checkbox"/> FEE <input type="checkbox"/>
6. State Oil & Gas Lease No. <b>B-935</b>
7. Lease Name or Unit Agreement Name <b>EUMONT GAS COM 2</b>
8. Well No. <b>2</b>
9. Pool name or Wildcat <b>EUMONT YATES 7 RVRS QN (PRO GAS)</b>
10. Elevation (Show whether DF, RKB, RT, GR, etc.) <b>3639 DF</b>

**SUNDRY NOTICES AND REPORTS ON WELLS**  
(DO NOT USE THIS FORM FOR PROPOSALS TO DRILL OR TO DEEPEN OR PLUG BACK TO A DIFFERENT RESERVOIR. USE "APPLICATION FOR PERMIT" (FORMC-101) FOR SUCH PROPOSALS.)

1. Type of Well:  
OIL WELL ☐ GAS WELL ☒ OTHER

2. Name of Operator  
**EXXON CORPORATION**

3. Address of Operator  
**ATTN: REGULATORY AFFAIRS ML#14  
P. O. BOX 1600  
MIDLAND, TX 79702**

4. Well Location  
Unit Letter **K** : **1980** Feet From The **SOUTH** Line and **1980** Feet From The **WEST** Line  
Section **29** Township **21S** Range **36E** NMPM **LEA** County

Check Appropriate Box to Indicate Nature of Notice, Report, or Other Data

### NOTICE OF INTENTION TO:

PERFORM REMEDIAL WORK ☐ PLUG AND ABANDON ☐  
TEMPORARILY ABANDON ☐ CHANGE PLANS ☐  
PULL OR ALTER CASING ☐  
OTHER: **EXPAND PRORATION UNIT/SIMO DED** ☒

### SUBSEQUENT REPORT OF:

REMEDIAL WORK ☐ ALTERING CASING ☐  
COMMENCE DRILLING OPNS. ☐ PLUG & ABANDONMENT ☐  
CASING TEST AND CEMENT JOB ☐  
OTHER: ☐

12. Describe Proposed or Completed Operations (Clearly state all pertinent details, and give pertinent dates, including estimated date of starting any proposed work) SEE RULE 1103.

#### ADMINISTRATIVE APPROVAL IS BEING REQUESTED TO:

- EXPAND PRESENT 200 AC. NON-STANDARD GAS SPACING AND PRORATION UNIT (NSP-1688-A(SD)(L) APPROVED JUNE 14, 1994) TO A 320 AC. (S2 SEC. 29) NON-STANDARD GAS SPACING AND PRORATION UNIT IN THE EUMONT YATES 7 RVRS QN (PRO GAS) POOL.
- SIMULTANEOUSLY DEDICATE WELLS 1, 2 (WAS NM B ST. #9), 3 (WAS NM E ST. #10), 4 (WAS NM B ST. #8), 5 (WAS NM B ST. #11) AND 6 (WAS NM B ST. #6).

**C-102 IS ATTACHED. OFFSET OPERATORS HAVE BEEN NOTIFIED AND C-102'S AND C-103'S FOR #'S 1, 3, 4, 5 AND 6 HAVE ALSO BEEN DONE.**

I hereby certify that the information above is true and complete to the best of my knowledge and belief.

SIGNATURE Alex M. Correa TITLE Sr. Regulatory Specialist DATE 07/18/94

TYPE OR PRINT NAME Alex M. Correa (915) 688-6782 TELEPHONE NO.

(This space for State Use)

APPROVED BY \_\_\_\_\_ TITLE \_\_\_\_\_ DATE \_\_\_\_\_

CONDITIONS OF APPROVAL, IF ANY:

Submit to Appropriate  
District Office  
State Lease-4 copies  
Fee Lease-3 copies

State of New Mexico  
Energy, Minerals and Natural Resources Department

Form C-102  
Revised 1-1-89

OIL CONSERVATION DIVISION

P.O. Box 2088  
Santa Fe, New Mexico 87504-2088

DISTRICT I  
P.O. Box 1980, Hobbs, NM 88240

DISTRICT II  
P.O. Drawer DD, Artesia, NM 88210

DISTRICT III  
1000 Rio Brazos Rd., Aztec, NM 87410

WELL LOCATION AND ACREAGE DEDICATION PLAT

All distances must be from the outer boundaries of the Section.

Operator Exxon Corporation			Lease EUMONT GAS COM 2		Well No. 2
Unit Letter K	Section 29	Township 21	Range 36	County NMPM	LEA
Actual Footage Location of Well: 1980 feet from the SOUTH line and 1980 feet from the WEST line.					
Ground level Elev. 3639 DF	Producing Formation YATES 7 RIVERS QN	Pool EUMONT YATES 7 RVRS QN (PRO GAS)		Dedicated Acreage: 320 Acres	

- Outline the acreage dedicated to the subject well by colored pencil or hatchure marks on the plat below.
- If more than one lease is dedicated to the well, outline each and identify the ownership thereof (both as to working interest and royalty).
- If more than one lease of different ownership is dedicated to the well, have the interest of all owners been consolidated by communitization, unitization, force-pooling, etc.?

☐ Yes

☐ No

If answer is "yes", type of consolidation \_\_\_\_\_

If answer is "no", list the owners and tract descriptions which have actually been consolidated. (Use reverse side of this form if necessary.) \_\_\_\_\_

No allowable will be assigned to the well until all interests have been consolidated (by communitization, unitization, forced-pooling, or otherwise) or until a non-standard unit, eliminating such interest, has been approved by the Division.

OPERATOR CERTIFICATION

I hereby certify that the information contained herein is true and complete to the best of my knowledge and belief.

Signature  
*C. H. Harper*

Printed Name  
C. H. HARPER

Position  
PERMITS SUPERVISOR

Company Exxon Corporation  
P.O. Box 1600-Midland, Tx.-79702

Date  
7/15/94

SURVEYOR CERTIFICATION

I hereby certify that the well location shown on this plat was plotted from field notes of actual surveys made by me or under my supervision, and that the same is true and correct to the best of my knowledge and belief.

Date Surveyed

Signature & Seal of  
Professional Surveyor

Certificate No.

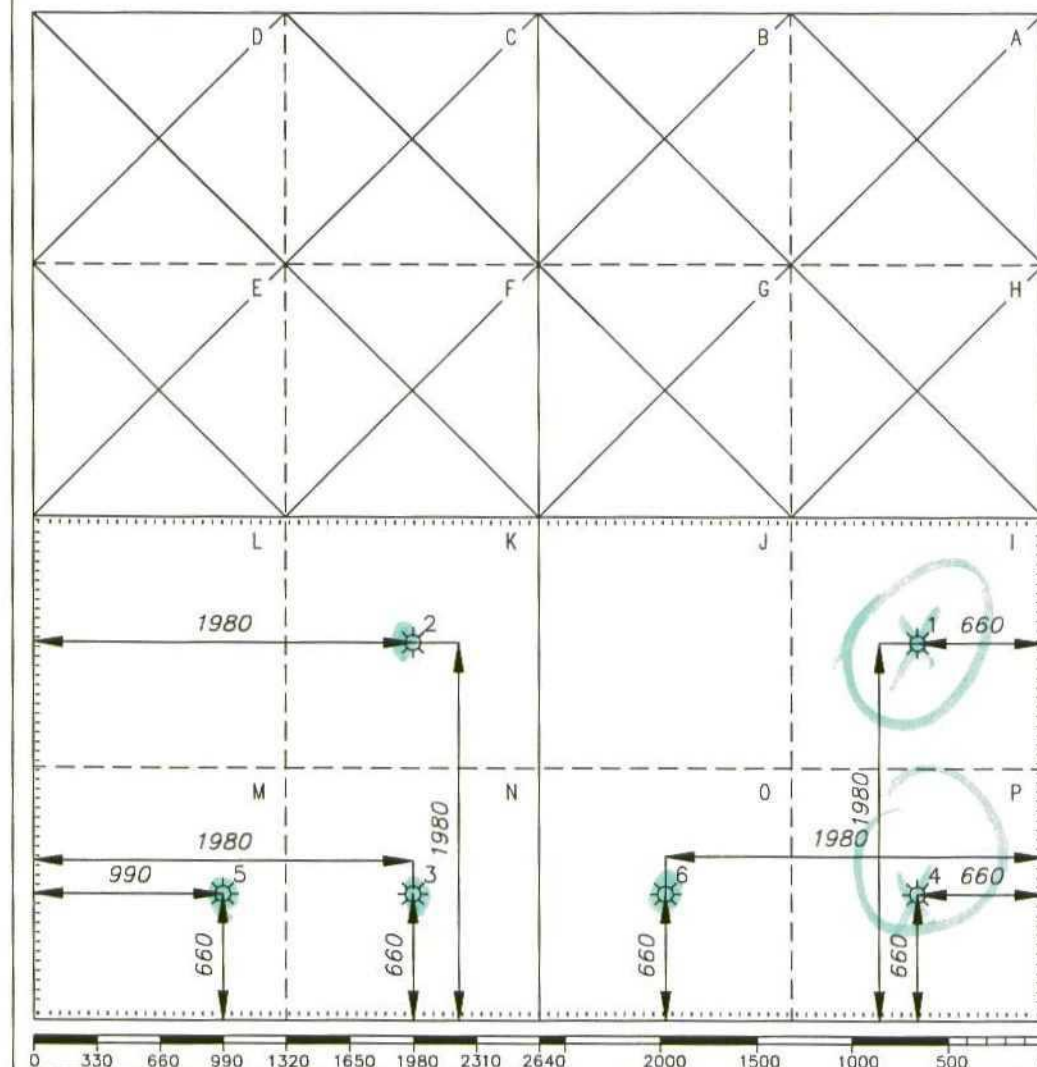

4 Miles SSW of OIL CENTER, New Mexico.

C.E. File No. A01970

DISTRICT I  
P.O. Box 1980, Hobbs, NM 88240

DISTRICT II  
P.O. Drawer DD, Artesia, NM 88210

DISTRICT III  
1000 Rio Brazos Rd., Aztec, NM 87410

**OIL CONSERVATION DIVISION**  
**P O. Box 2088**  
**Santa Fe, New Mexico 87504-2088**

WELL API NO. <b>3002504826</b>
5. Indicate Type of Lease STATE <input checked="" type="checkbox"/> FEE <input type="checkbox"/>
6. State Oil & Gas Lease No. <b>B 935</b>
7. Lease Name or Unit Agreement Name <b>EUMONT GAS COM 2</b>
8. Well No. <b>3</b>
9. Pool name or Wildcat <b>EUMONT YATES 7 RVRS QN (PRO GAS)</b>
10. Elevation (Show whether DF, RKB, RT, GR, etc.) <b>3620</b>

<b>SUNDRY NOTICES AND REPORTS ON WELLS</b> (DO NOT USE THIS FORM FOR PROPOSALS TO DRILL OR TO DEEPEN OR PLUG BACK TO A DIFFERENT RESERVOIR. USE "APPLICATION FOR PERMIT" (FORMC-101) FOR SUCH PROPOSALS.)	
1. Type of Well: OIL <input type="checkbox"/> GAS <input checked="" type="checkbox"/> OTHER	2. Name of Operator <b>EXXON CORPORATION</b>
3. Address of Operator <b>ATTN: REGULATORY AFFAIRS ML#14 P. O. BOX 1600 MIDLAND, TX 79702</b>	4. Well Location Unit Letter <b>N</b> : <b>660</b> Feet From The <b>SOUTH</b> Line and <b>1980</b> Feet From The <b>WEST</b> Line Section <b>29</b> Township <b>21S</b> Range <b>36E</b> NMPM <b>LEA</b> County

Check Appropriate Box to Indicate Nature of Notice, Report, or Other Data

**NOTICE OF INTENTION TO:**

PERFORM REMEDIAL WORK ☐ PLUG AND ABANDON ☐  
TEMPORARILY ABANDON ☐ CHANGE PLANS ☐  
PULL OR ALTER CASING ☐  
OTHER: **EXPAND PRORATION UNIT/SIMO DED** ☒

**SUBSEQUENT REPORT OF:**

REMEDIAL WORK ☐ ALTERING CASING ☐  
COMMENCE DRILLING OPNS. ☐ PLUG & ABANDONMENT ☐  
CASING TEST AND CEMENT JOB ☐  
OTHER: ☐

12. Describe Proposed or Completed Operations (Clearly state all pertinent details, and give pertinent dates, including estimated date of starting any proposed work) SEE RULE 1103.

**ADMINISTRATIVE APPROVAL IS BEING REQUESTED TO:**

- EXPAND PRESENT 200 AC. NON-STANDARD GAS SPACING AND PRORATION UNIT (NSP-1688-A(SD)(L) APPROVED JUNE 14, 1994) TO A 320 AC. (S2 SEC. 29) NON-STANDARD GAS SPACING AND PRORATION UNIT IN THE EUMONT YATES 7 RVRS QN (PRO GAS) POOL.
- SIMULTANEOUSLY DEDICATE WELLS 1, 2 (WAS NM B ST. #9), 3 (WAS NM B ST. #10), 4 (WAS NM B ST. #8), 5 (WAS NM B ST. #11) AND 6 (WAS NM B ST. #6).

**C-102 IS ATTACHED. OFFSET OPERATORS HAVE BEEN NOTIFIED AND C-102'S AND C-103'S FOR #'S 1, 2, 4, 5 AND 6 HAVE ALSO BEEN DONE.**

I hereby certify that the information above is true and complete to the best of my knowledge and belief.

SIGNATURE Alex M. Correa TITLE Sr. Regulatory Specialist DATE 07/18/94

TYPE OR PRINT NAME Alex M. Correa (915) 688-6782 TELEPHONE NO.

(This space for State Use)

APPROVED BY \_\_\_\_\_ TITLE \_\_\_\_\_ DATE \_\_\_\_\_

CONDITIONS OF APPROVAL, IF ANY:

Submit to Appropriate  
District Office  
State Lease-4 copies  
Fee Lease-3 copies

State of New Mexico  
Energy, Minerals and Natural Resources Department

Form C-102  
Revised 1-1-89

OIL CONSERVATION DIVISION

P.O. Box 2088  
Santa Fe, New Mexico 87504-2088

DISTRICT I  
P.O. Box 1980, Hobbs, NM 88240

DISTRICT II  
P.O. Drawer DD, Artesia, NM 88210

DISTRICT III  
1000 Rio Brazos Rd., Aztec, NM 87410

WELL LOCATION AND ACREAGE DEDICATION PLAT

All distances must be from the outer boundaries of the Section.

Operator Exxon Corporation			Lease EUMONT GAS COM 2		Well No. 3
Unit Letter N	Section 29	Township 21	Range 36	County NMPM	LEA
Actual Footage Location of Well: 660 feet from the SOUTH line and 1980 feet from the WEST line.					
Ground level Elev. -	Producing Formation YATES 7 RIVERS QN		Pool EUMONT YATES 7 RVRS QN (PRO GAS)		Dedicated Acreage: 320 Acres

- Outline the acreage dedicated to the subject well by colored pencil or hachure marks on the plat below.
- If more than one lease is dedicated to the well, outline each and identify the ownership thereof (both as to working interest and royalty).
- If more than one lease of different ownership is dedicated to the well, have the interest of all owners been consolidated by communitization, unitization, force-pooling, etc.?

☐ Yes

☐ No

If answer is "yes", type of consolidation

If answer is "no", list the owners and tract descriptions which have actually been consolidated. (Use reverse side of this form if necessary.)

No allowable will be assigned to the well until all interests have been consolidated (by communitization, unitization, forced-pooling, or otherwise) or until a non-standard unit, eliminating such interest, has been approved by the Division.

OPERATOR CERTIFICATION

I hereby certify that the information contained herein is true and complete to the best of my knowledge and belief.

Signature

Printed Name

C. H. HARPER

Position

PERMITS SUPERVISOR

Company Exxon Corporation

P.O. Box 1600-Midland, Tx.-79702

Date

7/15/94

SURVEYOR CERTIFICATION

I hereby certify that the well location shown on this plat was plotted from field notes of actual surveys made by me or under my supervision, and that the same is true and correct to the best of my knowledge and belief.

Date Surveyed

Signature & Seal of  
Professional Surveyor

Certificate No.

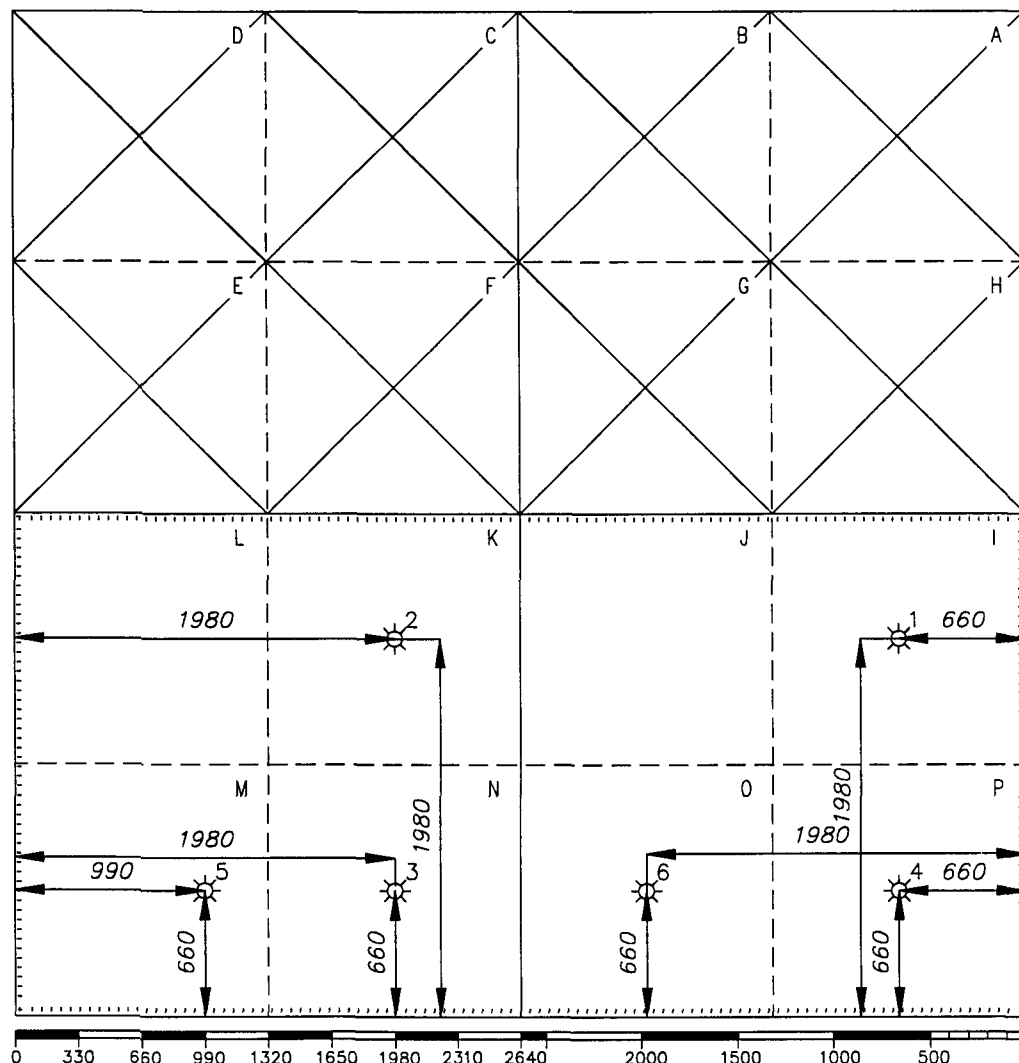

4 Miles SSW of OIL CENTER, New Mexico.

C.E. File No. A01970

DISTRICT I  
P.O. Box 1980, Hobbs, NM 88240

DISTRICT II  
P.O. Drawer DD, Artesia, NM 88210

DISTRICT III  
1000 Rio Brazos Rd., Aztec, NM 87410

**OIL CONSERVATION DIVISION**  
**P O. Box 2088**  
**Santa Fe, New Mexico 87504-2088**

WELL API NO. <b>3002504824</b>
5. Indicate Type of Lease STATE <input checked="" type="checkbox"/> FEE <input type="checkbox"/>
6. State Oil & Gas Lease No. <b>B-935</b>
7. Lease Name or Unit Agreement Name <b>EUMONT GAS COM 2</b>
8. Well No. <b>4</b>
9. Pool name or Wildcat <b>EUMONT YATES 7 RVRS QN (PRO GAS)</b>
10. Elevation (Show whether DF, RKB, RT, GR, etc.) <b>3625 RT</b>

<b>SUNDRY NOTICES AND REPORTS ON WELLS</b> (DO NOT USE THIS FORM FOR PROPOSALS TO DRILL OR TO DEEPEN OR PLUG BACK TO A DIFFERENT RESERVOIR. USE "APPLICATION FOR PERMIT" (FORMC-101) FOR SUCH PROPOSALS.)	
1. Type of Well: OIL WELL <input type="checkbox"/> GAS WELL <input checked="" type="checkbox"/> OTHER	2. Name of Operator <b>EXXON CORPORATION</b>
3. Address of Operator <b>ATTN: REGULATORY AFFAIRS ML#14 P. O. BOX 1600 MIDLAND, TX 79702</b>	4. Well Location Unit Letter <b>P</b> : <b>660</b> Feet From The <b>SOUTH</b> Line and <b>660</b> Feet From The <b>EAST</b> Line Section <b>29</b> Township <b>21S</b> Range <b>36E</b> NMPM <b>LEA</b> County 10. Elevation (Show whether DF, RKB, RT, GR, etc.) <b>3625 RT</b>

Check Appropriate Box to Indicate Nature of Notice, Report, or Other Data

**NOTICE OF INTENTION TO:**

PERFORM REMEDIAL WORK ☐ PLUG AND ABANDON ☐  
TEMPORARILY ABANDON ☐ CHANGE PLANS ☐  
PULL OR ALTER CASING ☐  
OTHER: **CONVERT TO GAS WELL** ☒

**SUBSEQUENT REPORT OF:**

REMEDIAL WORK ☐ ALTERING CASING ☐  
COMMENCE DRILLING OPNS. ☐ PLUG & ABANDONMENT ☐  
CASING TEST AND CEMENT JOB ☐  
OTHER: ☐

12. Describe Proposed or Completed Operations (Clearly state all pertinent details, and give pertinent dates, including estimated date of starting any proposed work) SEE RULE 1103.

**WELL WAS NM B ST. #8. A RECENT WORKOVER CAUSED WELL TO GO FROM AN OIL WELL TO A GAS WELL. ADMINISTRATIVE APPROVAL IS BEING REQUESTED TO:**  
- EXPAND 40 AC. OIL PRORATION UNIT TO A 320 AC. (S2 SEC. 29) NON-STANDARD GAS SPACING AND PRORATION UNIT IN THE EUMONT YATES 7 RVRS QN (PRO GAS) POOL.  
- SIMULTANEOUSLY DEDICATE WELLS 1, 2 (WAS NM B ST. #9), 3 (WAS NM E ST. #10), 4 (WAS NM B ST. #8), 5 (WAS NM B ST. #11) AND 6 (WAS NM B ST. #6).  
- UNORTHODOX LOCATION.

**C-102 IS ATTACHED. OFFSET OPERATORS HAVE BEEN NOTIFIED AND C-102'S AND C-103'S FOR #'S 1, 2, 3, 5 AND 6 HAVE ALSO BEEN DONE.**

I hereby certify that the information above is true and complete to the best of my knowledge and belief.

SIGNATURE *Alex M. Cornea* TITLE **Sr. Regulatory Specialist** DATE **07/18/94**  
TYPE OR PRINT NAME **Alex M. Cornea** **(915) 688-6782** TELEPHONE NO.

(This space for State Use)

APPROVED BY \_\_\_\_\_ TITLE \_\_\_\_\_ DATE \_\_\_\_\_

CONDITIONS OF APPROVAL, IF ANY:

OIL CONSERVATION DIVISION

P.O. Box 2088  
Santa Fe, New Mexico 87504-2088

DISTRICT I  
P.O. Box 1980, Hobbs, NM 88240

DISTRICT II  
P.O. Drawer DD, Artesia, NM 88210

DISTRICT III  
1000 Rio Brazos Rd., Aztec, NM 87410

WELL LOCATION AND ACREAGE DEDICATION PLAT

All distances must be from the outer boundaries of the Section.

Operator Exxon Corporation			Lease EUMONT GAS COM 2		Well No. 4
Unit Letter P	Section 29	Township 21	Range 36	County NMPM	LEA

Actual Footage Location of Well:

660 feet from the SOUTH line and 660 feet from the EAST line.

Ground level Elev. 3625 RT	Producing Formation YATES 7 RIVERS QN	Pool EUMONT YATES 7 RVRS QN (PRO GAS)	Dedicated Acreage: 320 Acres
-------------------------------	--	--	---------------------------------

- Outline the acreage dedicated to the subject well by colored pencil or hatchure marks on the plat below.
- If more than one lease is dedicated to the well, outline each and identify the ownership thereof (both as to working interest and royalty).
- If more than one lease of different ownership is dedicated to the well, have the interest of all owners been consolidated by communitization, unitization, force-pooling, etc.?

☐ Yes ☐ No If answer is "yes", type of consolidation \_\_\_\_\_

If answer is "no", list the owners and tract descriptions which have actually been consolidated. (Use reverse side of this form if necessary.) \_\_\_\_\_

No allowable will be assigned to the well until all interests have been consolidated (by communitization, unitization, forced-pooling, or otherwise) or until a non-standard unit, eliminating such interest, has been approved by the Division.

	<b>OPERATOR CERTIFICATION</b> <i>I hereby certify that the information contained herein is true and complete to the best of my knowledge and belief.</i> Signature <u>C. H. Harper</u> Printed Name <u>C. H. HARPER</u> Position <u>PERMITS SUPERVISOR</u> Company <u>Exxon Corporation</u> <u>P.O. Box 1600-Midland, Tx.-79702</u> Date <u>7/15/94</u>
	<b>SURVEYOR CERTIFICATION</b> <i>I hereby certify that the well location shown on this plat was plotted from field notes of actual surveys made by me or under my supervision, and that the same is true and correct to the best of my knowledge and belief.</i> Date Surveyed _____ Signature & Seal of Professional Surveyor _____
	Certificate No. _____

4 Miles SSW of OIL CENTER, New Mexico.

C.E. File No. A01970

DISTRICT I  
P.O. Box 1980, Hobbs, NM 88240

DISTRICT II  
P.O. Drawer DD, Artesia, NM 88210

DISTRICT III  
1000 Rio Brazos Rd., Aztec, NM 87410

## OIL CONSERVATION DIVISION

P O. Box 2088  
Santa Fe, New Mexico 87504-2088

WELL API NO. <b>3002504827</b>
5. Indicate Type of Lease STATE <input checked="" type="checkbox"/> FEE <input type="checkbox"/>
6. State Oil & Gas Lease No. <b>B-935</b>
7. Lease Name or Unit Agreement Name <b>EUMONT GAS COM 2</b>
8. Well No. <b>5</b>
9. Pool name or Wildcat <b>EUMONT YATES 7 RVRS QN (PRO GAS)</b>

SUNDRY NOTICES AND REPORTS ON WELLS (DO NOT USE THIS FORM FOR PROPOSALS TO DRILL OR TO DEEPEN OR PLUG BACK TO A DIFFERENT RESERVOIR. USE "APPLICATION FOR PERMIT" (FORMC-101) FOR SUCH PROPOSALS.)	
1. Type of Well: OIL <input type="checkbox"/> GAS <input checked="" type="checkbox"/> OTHER	
2. Name of Operator <b>EXXON CORPORATION</b>	
3. Address of Operator <b>ATTN: REGULATORY AFFAIRS ML#14 P. O. BOX 1600 MIDLAND, TX 79702</b>	
4. Well Location Unit Letter <b>M</b> : <b>660</b> Feet From The <b>SOUTH</b> Line and <b>990</b> Feet From The <b>WEST</b> Line Section <b>29</b> Township <b>21S</b> Range <b>36E</b> NMPM <b>LEA</b> County	
10. Elevation (Show whether DF, RKB, RT, GR, etc.)	

Check Appropriate Box to Indicate Nature of Notice, Report, or Other Data

### NOTICE OF INTENTION TO:

PERFORM REMEDIAL WORK ☐ PLUG AND ABANDON ☐  
TEMPORARILY ABANDON ☐ CHANGE PLANS ☐  
PULL OR ALTER CASING ☐  
OTHER: ADD PERFS, CONVERT TO GAS WELL ☒

### SUBSEQUENT REPORT OF:

REMEDIAL WORK ☐ ALTERING CASING ☐  
COMMENCE DRILLING OPNS. ☐ PLUG & ABANDONMENT ☐  
CASING TEST AND CEMENT JOB ☐  
OTHER: ☐

12. Describe Proposed or Completed Operations (Clearly state all pertinent details, and give pertinent dates, including estimated date of starting any proposed work) SEE RULE 1103.

WELL WAS THE NM B ST. #11. ADD YATES PERFS. 3255'-3450', FRAC. APPROX. 40,000 GAL. + 162,000 # SD. AND ADD 7 RVRS. PERFS. 3566'-3745', FRAC. APPROX. 38,000 GAL. + 145,000 # SD. ADDING PERFS. WILL CAUSE WELL TO BECOME A GAS WELL, THEREFORE, ADMINISTRATIVE APPROVAL IS BEING REQUESTED TO:

- EXPAND 40 AC. OIL PRORATION UNIT TO A 320 AC. (S2 SEC. 29) NON-STANDARD GAS SPACING AND PRORATION UNIT IN THE EUMONT YATES 7 RVRS QN (PRO GAS) POOL.
- SIMULTANEOUSLY DECICATE WELLS 1, 2 (WAS NM B ST. #9), 3 (WAS NM B ST. #10), 4 (WAS NM B ST. #8), 5 (WAS NM B ST. #11) AND 6 (WAS NM B ST. #6)

C-102 IS ATTACHED. OFFSET OPERATORS HAVE BEEN NOTIFIED.

I hereby certify that the information above is true and complete to the best of my knowledge and belief.

SIGNATURE Alex M. Correa TITLE Sr. Regulatory Specialist DATE 07/20/94  
TYPE OR PRINT NAME Alex M. Correa (915) 688-6782 TELEPHONE NO.

(This space for State Use)

APPROVED BY \_\_\_\_\_ TITLE \_\_\_\_\_ DATE \_\_\_\_\_

CONDITIONS OF APPROVAL, IF ANY:

State of New Mexico  
Energy, Minerals and Natural Resources Department

Form C-102  
Revised 1-1-89

OIL CONSERVATION DIVISION

P.O. Box 2088  
Santa Fe, New Mexico 87504-2088

WELL LOCATION AND ACREAGE DEDICATION PLAT

All distances must be from the outer boundaries of the Section.

Submit to Appropriate  
District Office  
State Lease-4 copies  
Fee Lease-3 copies

DISTRICT I  
P.O. Box 1980, Hobbs, NM 88240

DISTRICT II  
P.O. Drawer DD, Artesia, NM 88210

DISTRICT III  
1000 Rio Brazos Rd., Aztec, NM 87410

Operator Exxon Corporation			Lease EUMONT GAS COM 2		Well No. 5
Unit Letter M	Section 29	Township 21	Range 36	County NMPM	LEA
Actual Footage Location of Well: 660 feet from the SOUTH line and 990 feet from the WEST line.					
Ground level Elev. 3620 DF	Producing Formation YATES 7 RIVERS QN	Pool EUMONT YATES 7 RVRS QN (PRO GAS)		Dedicated Acreage: 320 Acres	

- Outline the acreage dedicated to the subject well by colored pencil or hatchure marks on the plat below.
- If more than one lease is dedicated to the well, outline each and identify the ownership thereof (both as to working interest and royalty).
- If more than one lease of different ownership is dedicated to the well, have the interest of all owners been consolidated by communitization, unitization, force-pooling, etc.?

☐ Yes ☐ No If answer is "yes", type of consolidation \_\_\_\_\_

If answer is "no", list the owners and tract descriptions which have actually been consolidated. (Use reverse side of this form if necessary.) \_\_\_\_\_

No allowable will be assigned to the well until all interests have been consolidated (by communitization, unitization, forced-pooling, or otherwise) or until a non-standard unit, eliminating such interest, has been approved by the Division.

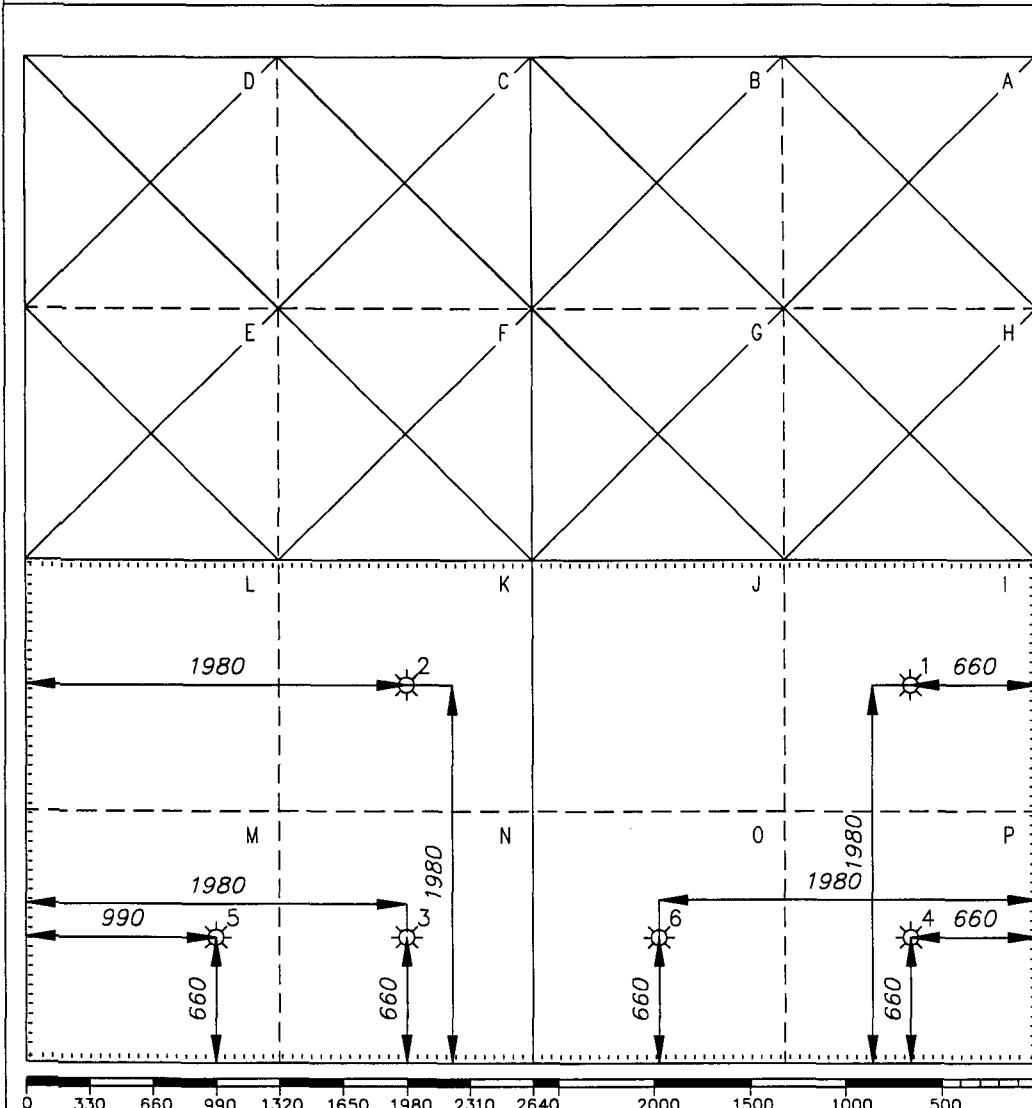

OPERATOR CERTIFICATION

I hereby certify that the information contained herein is true and complete to the best of my knowledge and belief.

Signature  
C. H. Harper

Printed Name  
C. H. HARPER

Position  
PERMITS SUPERVISOR

Company Exxon Corporation  
P.O. Box 1600-Midland, Tx.-79702

Date  
7/15/94

SURVEYOR CERTIFICATION

I hereby certify that the well location shown on this plat was plotted from field notes of actual surveys made by me or under my supervision, and that the same is true and correct to the best of my knowledge and belief.

Date Surveyed

Signature & Seal of  
Professional Surveyor

Certificate No.

4 Miles SSW of OIL CENTER, New Mexico.

C.E. File No. A01970



DISTRICT I  
P.O. Box 1980, Hobbs, NM 88240

DISTRICT II  
P.O. Drawer DD, Artesia, NM 88210

DISTRICT III  
1000 Rio Brazos Rd., Aztec, NM 87410

**OIL CONSERVATION DIVISION**  
**P O. Box 2088**  
**Santa Fe, New Mexico 87504-2088**

WELL API NO. <b>3002504822</b>	
5. Indicate Type of Lease STATE <input checked="" type="checkbox"/> FEE <input type="checkbox"/>	
6. State Oil & Gas Lease No. <b>B-935</b>	
7. Lease Name or Unit Agreement Name <b>EUMONT GAS COM 2</b>	
8. Well No. <b>6</b>	
9. Pool name or Wildcat <b>EUMONT YATES 7 RVRS QN (PRO GAS)</b>	

<b>SUNDRY NOTICES AND REPORTS ON WELLS</b> (DO NOT USE THIS FORM FOR PROPOSALS TO DRILL OR TO DEEPEN OR PLUG BACK TO A DIFFERENT RESERVOIR. USE "APPLICATION FOR PERMIT" (FORMC-101) FOR SUCH PROPOSALS.)	
1. Type of Well: OIL WELL <input type="checkbox"/> GAS WELL <input checked="" type="checkbox"/> OTHER	
2. Name of Operator <b>EXXON CORPORATION</b>	
3. Address of Operator <b>ATTN: REGULATORY AFFAIRS ML#14</b> <b>P. O. BOX 1600</b> <b>MIDLAND, TX 79702</b>	
4. Well Location Unit Letter <b>O</b> : <b>660</b> Feet From The <b>SOUTH</b> Line and <b>1980</b> Feet From The <b>EAST</b> Line Section <b>29</b> Township <b>21S</b> Range <b>36E</b> NMPM <b>LEA</b> County	
10. Elevation (Show whether DF, RKB, RT, GR, etc.) <b>3632 DF</b>	

Check Appropriate Box to Indicate Nature of Notice, Report, or Other Data

**NOTICE OF INTENTION TO:**

PERFORM REMEDIAL WORK ☐ PLUG AND ABANDON ☐  
TEMPORARILY ABANDON ☐ CHANGE PLANS ☐  
PULL OR ALTER CASING ☐  
OTHER: **CONVERT TO GAS WELL/SIMO DED** ☒

**SUBSEQUENT REPORT OF:**

REMEDIAL WORK ☐ ALTERING CASING ☐  
COMMENCE DRILLING OPNS. ☐ PLUG & ABANDONMENT ☐  
CASING TEST AND CEMENT JOB ☐  
OTHER: ☐

12. Describe Proposed or Completed Operations (Clearly state all pertinent details, and give pertinent dates, including estimated date of starting any proposed work) SEE RULE 1103.

**WELL WAS THE NM B ST. #6. ADDING PERFS. ACCORDING TO C-103 APPROVED 03-15-94 WILL CAUSE WELL TO BECOME A GAS WELL, THEREFORE, ADMINISTRATIVE APPROVAL IS BEING REQUESTED TO:**  
-EXPAND 40 AC. OIL PRORATION UNIT TO A 320 AC. (S2 SEC. 29) NON-STANDARD GAS SPACING AND PRORATION UNIT IN THE EUMONT YATES 7 RVRS QN (PRO GAS) POOL.  
- SIMULTANEOUSLY DEDICATE WELLS 1, 2 (WAS NM B ST. #9), 3 (WAS NM B ST. #10), 4 (WAS NM B ST. #8), 5 (WAS NM B ST. #11) AND 6 (WAS NM B ST. #6).

**C-102 IS ATTACHED. OFFSET OPERATORS HAVE BEEN NOTIFIED AND C-102'S AND C-103'S FOR #'S 1, 2, 3, 4 AND 5 HAVE ALSO BEEN DONE.**

I hereby certify that the information above is true and complete to the best of my knowledge and belief.

SIGNATURE *Alex M. Correa* TITLE **Sr. Regulatory Specialist** DATE **07/20/94**  
TYPE OR PRINT NAME **Alex M. Correa** **(915) 688-6782** TELEPHONE NO.

(This space for State Use)

APPROVED BY \_\_\_\_\_ TITLE \_\_\_\_\_ DATE \_\_\_\_\_

CONDITIONS OF APPROVAL, IF ANY:

OIL CONSERVATION DIVISION

P.O. Box 2088  
Santa Fe, New Mexico 87504-2088

DISTRICT I  
P.O. Box 1980, Hobbs, NM 88240

DISTRICT II  
P.O. Drawer DD, Artesia, NM 88210

DISTRICT III  
1000 Rio Brazos Rd., Aztec, NM 87410

WELL LOCATION AND ACREAGE DEDICATION PLAT

All distances must be from the outer boundaries of the Section.

Operator Exxon Corporation			Lease EUMONT GAS COM 2		Well No. 6
Unit Letter 0	Section 29	Township 21	Range 36	County NMPM	LEA
Actual Footage Location of Well: 660 feet from the SOUTH line and 1980 feet from the EAST line.					
Ground level Elev. 3632 DF	Producing Formation YATES 7 RIVERS QN	Pool EUMONT YATES 7 RVRS QN (PRO GAS)		Dedicated Acreage: 320 Acres	

- Outline the acreage dedicated to the subject well by colored pencil or hatchure marks on the plat below.
- If more than one lease is dedicated to the well, outline each and identify the ownership thereof (both as to working interest and royalty).
- If more than one lease of different ownership is dedicated to the well, have the interest of all owners been consolidated by communitization, unitization, force-pooling, etc.?  
☐ Yes ☐ No If answer is "yes", type of consolidation \_\_\_\_\_  
If answer is "no", list the owners and tract descriptions which have actually been consolidated. (Use reverse side of this form if necessary.) \_\_\_\_\_  
No allowable will be assigned to the well until all interests have been consolidated (by communitization, unitization, forced-pooling, or otherwise) or until a non-standard unit, eliminating such interest, has been approved by the Division.

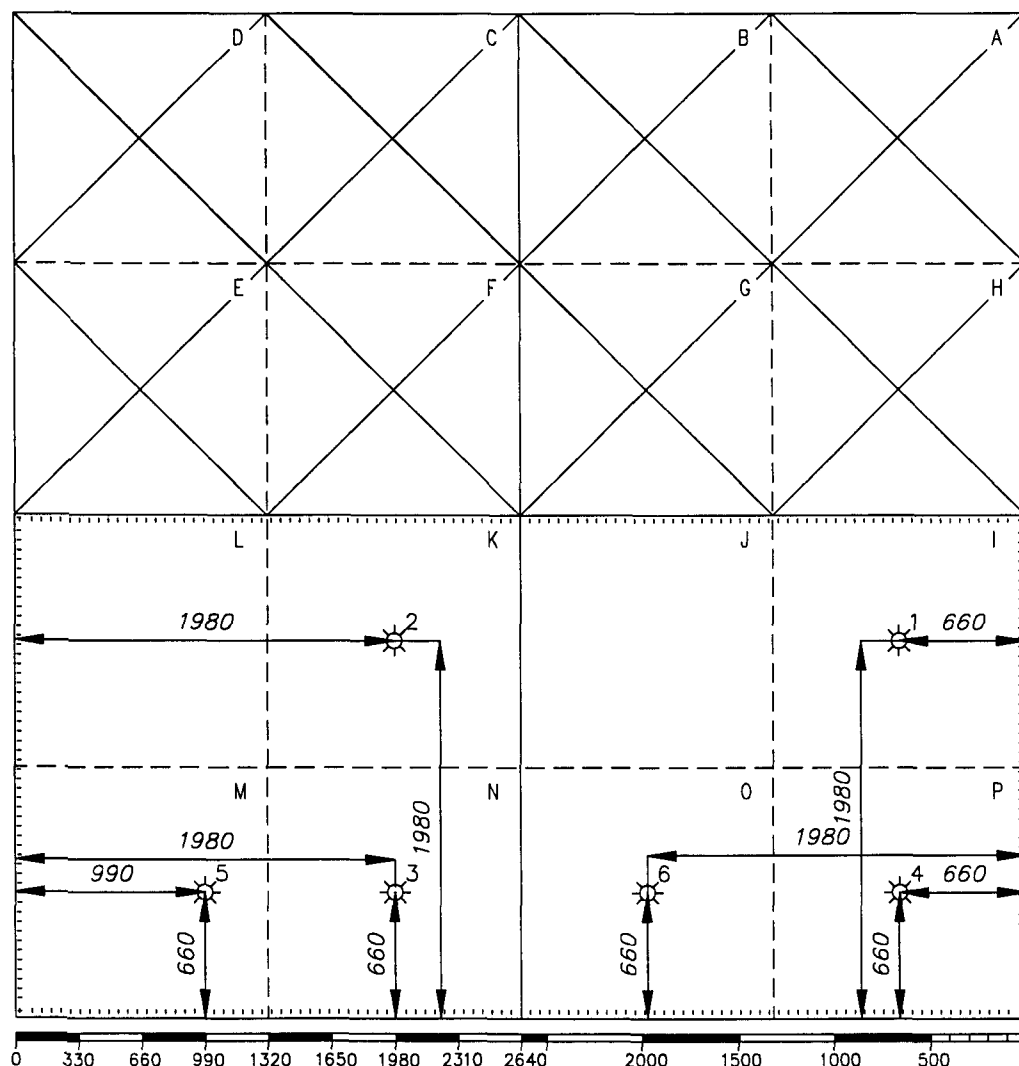

OPERATOR CERTIFICATION

I hereby certify that the information contained herein is true and complete to the best of my knowledge and belief.

Signature C. H. Harper  
Printed Name  
C. H. HARPER  
Position PERMITS SUPERVISOR  
Company Exxon Corporation  
P.O. Box 1600-Midland, Tx.-79702  
Date  
7/15/94

SURVEYOR CERTIFICATION

I hereby certify that the well location shown on this plat was plotted from field notes of actual surveys made by me or under my supervision, and that the same is true and correct to the best of my knowledge and belief.

Date Surveyed \_\_\_\_\_  
Signature & Seal of Professional Surveyor \_\_\_\_\_  
Certificate No. \_\_\_\_\_