



Midland Division  
Exploration Production

OIL CONSERVATION DIVISION  
RECEIVED

Conoco Inc.  
10 Desta Drive, Suite 100W  
Midland, TX 79705-4500  
(915) 686-5400

94 MAR 8 AM 8 50

April 29, 1994

Mr. William J. LeMay, Director  
Oil Conservation Division  
P.O. Box 2088  
Santa Fe, New Mexico 87504

**RE: Application for 160-acre Non-Standard Proration Unit  
for Eumont Gas Production from the Sanderson A #18  
1980' FSL & 1920' FEL, Section 11, T-20S, R-36E  
Lea County, New Mexico**

Dear Mr. LeMay:

As shown by EXHIBIT A, a current 240-acre non-standard proration unit for Eumont gas production was established by order NSP 415 for the SE/4 and S/2 SW/4 of section 11. Since there are no longer any active Eumont gas wells dedicated to this NSPU, Conoco requests that this order be set aside so that a new NSPU may be formed for a proposed drilling well, the Sanderson A No. 18.

Conoco requests that an administrative order be issued to establish a new 160-acre NSPU consisting of the SE/4 section 11 as shown in EXHIBIT B and that the proposed Sanderson A No. 18 be dedicated to it. This new well will be drilled at a standard location for a 160-acre NSPU.

All offset operators to this proposed NSPU, as shown on EXHIBITS A and B, have been notified by certified mail of the filing of this application. Copies of these mail receipts are also attached as EXHIBIT C.

If there are any further questions concerning this application, please contact me at (915) 686-6548. Thank you.

Very truly yours,

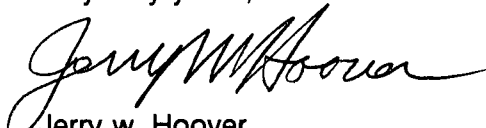
  
Jerry W. Hoover  
Sr. Conservation Coordinator

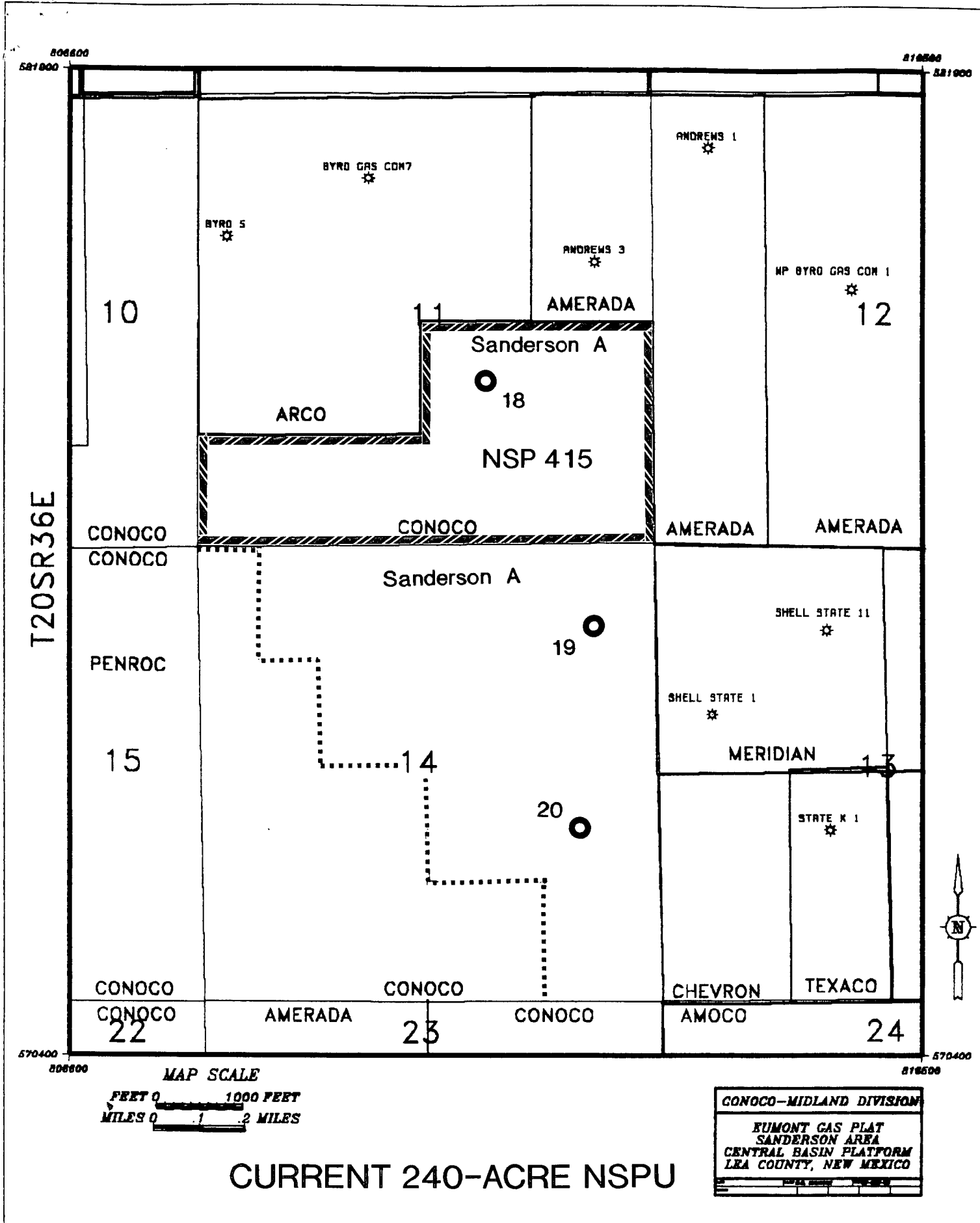

CURRENT 240-ACRE NSPU

CONOCO-MIDLAND DIVISION  
 FUMONT GAS PLAT  
 SANDERSON AREA  
 CENTRAL BASIN PLATFORM  
 LEA COUNTY, NEW MEXICO

EXHIBIT A

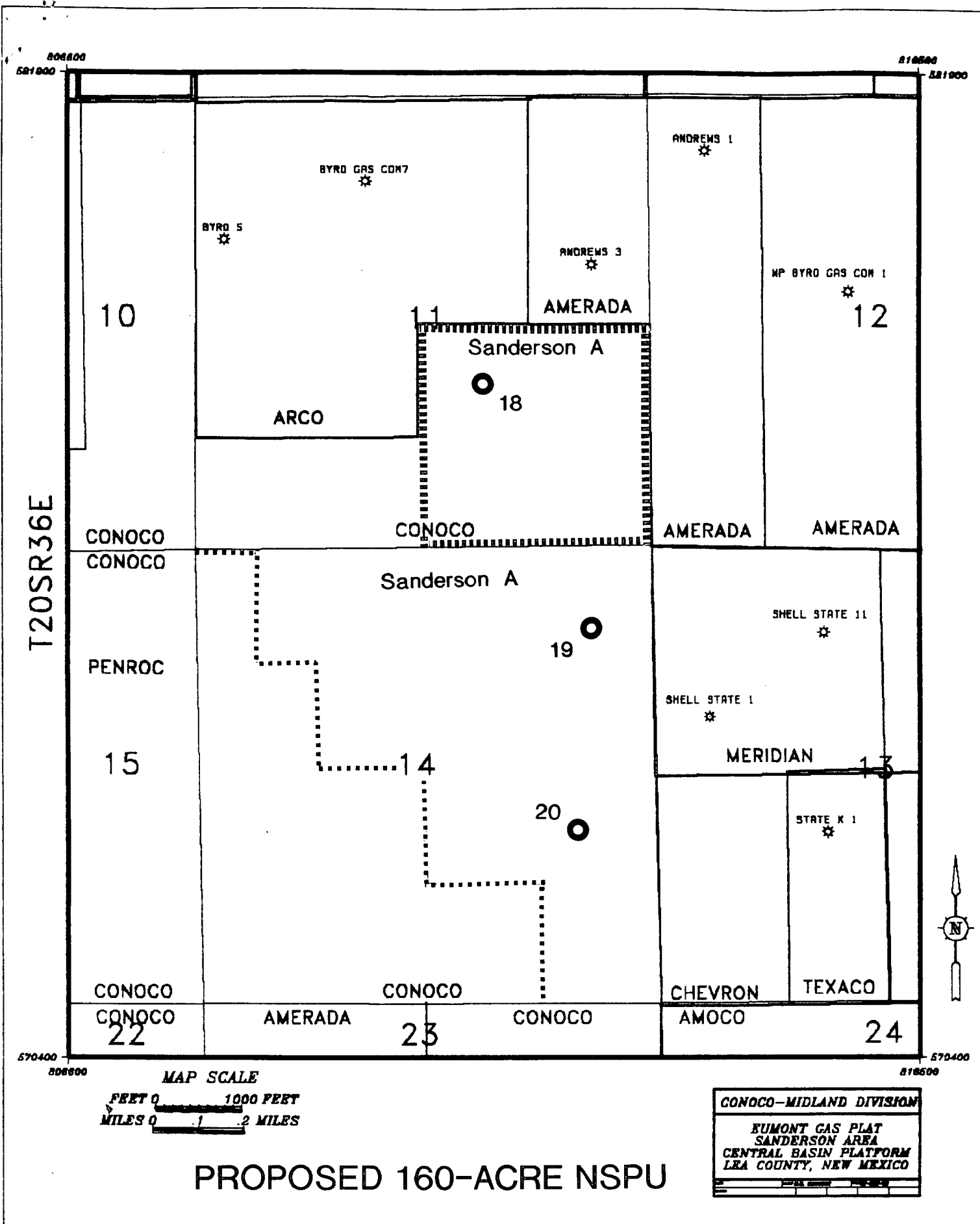

PROPOSED 160-ACRE NSPU

CONOCO-MIDLAND DIVISION  
 EUMONT GAS PLAT  
 SANDERSON AREA  
 CENTRAL BASIN PLATFORM  
 LEA COUNTY, NEW MEXICO

EXHIBIT B

P 885 448 193

**RECEIPT FOR CERTIFIED MAIL**

NO INSURANCE COVERAGE PROVIDED  
NOT FOR INTERNATIONAL MAIL  
(See Reverse)

Sent to	
<b>Amerada</b>	
<b>P.O. Box 840</b>	
<b>Seminole, TX 79360</b>	
Postage	\$
Certified Fee	
Special Delivery Fee	
Restricted Delivery Fee	
Return Receipt showing to whom and Date Delivered	
Return Receipt showing to whom, Date, and Address of Delivery	
TOTAL Postage and Fees	\$
Postmark or Date	
4/28/94	

PS Form 3800, June 1985

P 885 448 192

**RECEIPT FOR CERTIFIED MAIL**

NO INSURANCE COVERAGE PROVIDED  
NOT FOR INTERNATIONAL MAIL  
(See Reverse)

Sent to	
<b>ARCO</b>	
<b>P. O. Box 1610</b>	
<b>Midland, Texas 77701</b>	
Postage	\$
Certified Fee	
Special Delivery Fee	
Restricted Delivery Fee	
Return Receipt showing to whom and Date Delivered	
Return Receipt showing to whom, Date, and Address of Delivery	
TOTAL Postage and Fees	\$
Postmark or Date	
4/28/94	

PS Form 3800, June 1985

P 885 448 194

**RECEIPT FOR CERTIFIED MAIL**

NO INSURANCE COVERAGE PROVIDED  
NOT FOR INTERNATIONAL MAIL  
(See Reverse)

Sent to	
<b>Meridian</b>	
<b>3300 N. "A" Street</b>	
<b>Midland, Texas 79705</b>	
Postage	\$
Certified Fee	
Special Delivery Fee	
Restricted Delivery Fee	
Return Receipt showing to whom and Date Delivered	
Return Receipt showing to whom, Date, and Address of Delivery	
TOTAL Postage and Fees	\$
Postmark or Date	
4/28/94	

PS Form 3800, June 1985

EXHIBIT C



STATE OF NEW MEXICO

ENERGY, MINERALS AND NATURAL RESOURCES DEPARTMENT

OIL CONSERVATION DIVISION

RECEIVED

OIL CONSERVATION DIVISION

HOBBS DISTRICT OFFICE

'94 MAR 6 AM 8 50

May 2, 1994

BRUCE KING  
GOVERNOR

POST OFFICE BOX 1980  
HOBBS, NEW MEXICO 88241-1980  
(505) 393-6161

OIL CONSERVATION DIVISION  
P. O. BOX 2088  
SANTA FE, NEW MEXICO 87501

RE: Proposed:

MC \_\_\_\_\_  
DHC \_\_\_\_\_  
NSL \_\_\_\_\_  
NSP X \_\_\_\_\_  
SWD \_\_\_\_\_  
WFX \_\_\_\_\_  
PMX \_\_\_\_\_

Gentlemen:

I have examined the application for the:

<u>Conoco Inc</u>	<u>Sanderson A</u>	<u>#18-J</u>	<u>11-20-36</u>
Operator	Lease & Well No.	Unit	S-T-R

and my recommendations are as follows:

OK

Yours very truly,

Jerry Sexton  
Jerry Sexton  
Supervisor, District 1

/ed