

DISTRICT I

P.O. Box 1980, Hobbs, NM 88241-1980

DISTRICT II

P.O. Box Drawer DD, Artesia, NM 88211-0719

DISTRICT III

1000 Rio Brazos Rd., Aztec, NM 87410

DISTRICT IV

P.O. Box 2088, Santa Fe, NM 87504-2088

State of New Mexico
Energy, Minerals and Natural Resources Department

Form C-102

Revised February 10, 1994

Instructions on back

Submit to Appropriate District Office

State Lease - 4 Copies

Fee Lease - 3 Copies

AMENDED REPORT

OIL CONSERVATION DIVISION

P.O. Box 2088

Santa Fe, New Mexico 87504-2088

WELL LOCATION AND ACREAGE DEDICATION PLAT

¹ API Number 30 025 32498	² Pool Code 96314	³ Pool Name North Teague Lower Paddock-Blaineby Associated
⁴ Property Code 10960	⁵ Property Name Harrison B. F. "B"	⁶ Well No. 23
⁷ OGRID Number 022351	⁸ Operator Name TEXACO EXPLORATION & PRODUCTION INC.	⁹ Elevation 3313'

¹⁰ Surface Location

Ul or lot no. F	Section 9	Township 23S	Range 37E	Lot.Idn	Feet From The 1815	North/South Line NORTH	Feet From The 1815	East/West Line WEST	County LEA
--------------------	--------------	-----------------	--------------	---------	-----------------------	---------------------------	-----------------------	------------------------	---------------

¹¹ Bottom Hole Location If Different From Surface

Ul or lot no.	Section	Township	Range	Lot.Idn	Feet From The	North/South Line	Feet From The	East/West Line	County
---------------	---------	----------	-------	---------	---------------	------------------	---------------	----------------	--------

¹² Dedicated Acres 40	¹³ Joint or Infill No	¹⁴ Consolidation Code	¹⁵ Order No.
-------------------------------------	-------------------------------------	----------------------------------	-------------------------

NO ALLOWABLE WILL BE ASSIGNED TO THIS COMPLETION UNTIL ALL INTERESTS HAVE BEEN CONSOLIDATED
OR A NON-STANDARD UNIT HAS BEEN APPROVED BY THE DIVISION

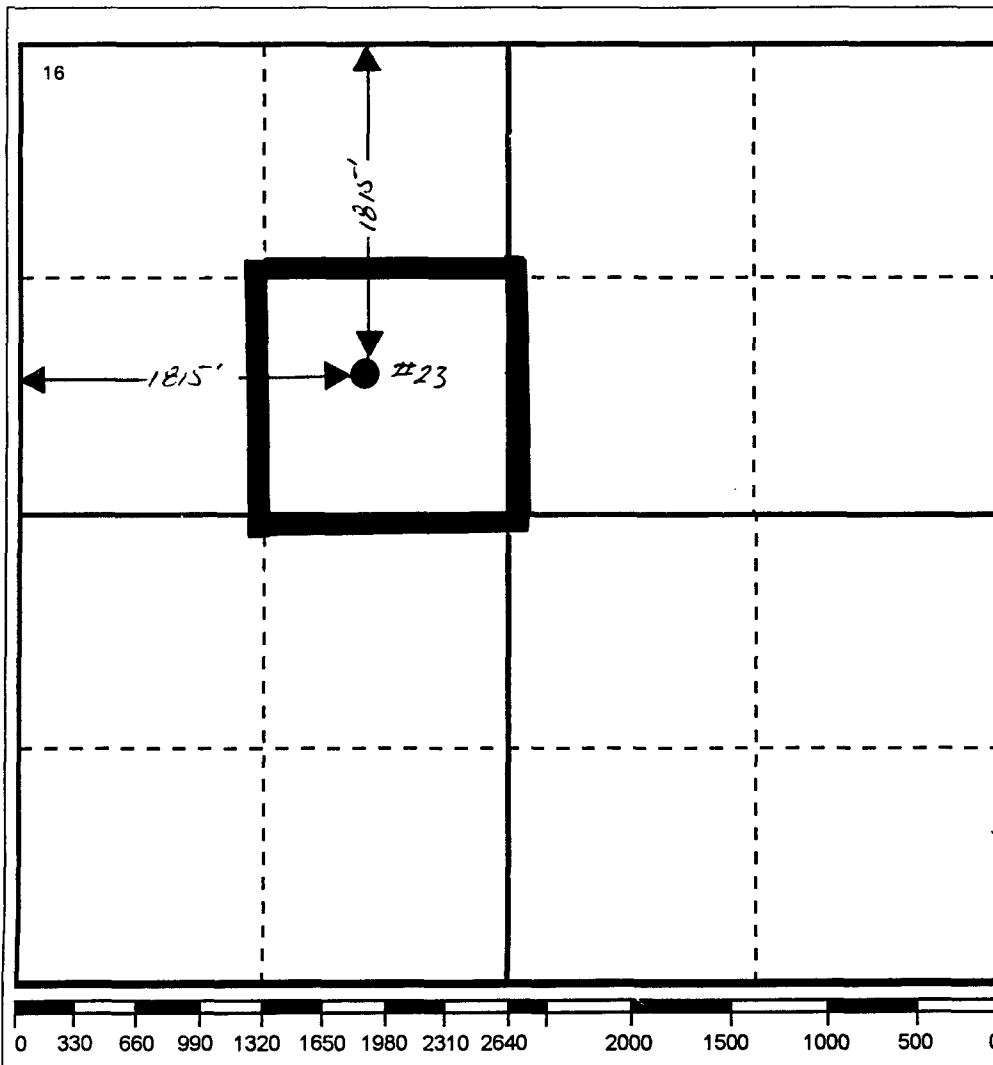

17 OPERATOR CERTIFICATION

I hereby certify that the information
contained herein is true and complete to the
best of my knowledge and belief

Signature

Printed Name

Darrell J. Carriger

Position

Engineering Assistant

Date

2/19/96

18 SURVEYOR CERTIFICATION

I hereby certify that the well location shown
on this plat was plotted from field notes of
actual surveys made by me or under my
supervision, and that the same is true and
correct to the best of my knowledge and
belief.

Date Surveyed

Signature & Seal of
Professional Surveyor

Certificate No.

DISTRICT I
P.O. Box 1980, Hobbs, NM 88241-1980
DISTRICT II
P.O. Box Drawer DD, Artesia, NM 88211-0719
DISTRICT III
1000 Rio Brazos Rd., Aztec, NM 87410
DISTRICT IV
P.O. Box 2088, Santa Fe, NM 87504-2088

State of New Mexico
Energy, Minerals and Natural Resources Department

OIL CONSERVATION DIVISION

P.O. Box 2088
Santa Fe, New Mexico 87504-2088

Form C-104
Revised February 10, 1994
Instructions on back
Submit to Appropriate District Office
5 Copies

AMENDED REPORT

REQUEST FOR ALLOWABLE AND AUTHORIZATION TO TRANSPORT

¹ Operator Name and Address TEXACO EXPLORATION & PRODUCTION INC. P.O. BOX 730, HOBBS, NM 88240		² OGRID Number 022351
		³ Reason for Filing Code Corrected POD's
⁴ API Number 30 025 32498	⁵ Pool Name N. Teague Drinkard - Abo	⁶ Pool Code 96313
⁷ Property Code 10960	⁸ Property Name HARRISON, B. F. 'B'	⁹ Well No. 23

II. ¹⁰ Surface Location

Ul or lot no. F	Section 9	Township 23-S	Range 37-E	Lot.Idn	Feet From The 1815	North/South Line NORTH	Feet From The 1815	East/West Line WEST	County LEA
--------------------	--------------	------------------	---------------	---------	-----------------------	---------------------------	-----------------------	------------------------	---------------

¹¹ Bottom Hole Location

Ul or lot no.	Section	Township	Range	Lot.Idn	Feet From The	North/South Line	Feet From The	East/West Line	County
---------------	---------	----------	-------	---------	---------------	------------------	---------------	----------------	--------

¹² Lse Code P	¹³ Producing Method Code P	¹⁴ Gas Connection Date 10/6/94	¹⁵ C-129 Permit Number	¹⁶ C-129 Effective Date	¹⁷ C-129 Expiration Date
-----------------------------	--	--	-----------------------------------	------------------------------------	-------------------------------------

III. Oil and Gas Transporters

¹⁸ Transporter OGRID	¹⁹ Transporter Name and Address	²⁰ POD	²¹ O/G	²² POD ULSTR Location and Description
022628	TEXAS NEW MEXICO PIPELINE BOX 2528 HOBBS, NM 88241	2470110	O	C-9-23S-37E (BATTERY)
022345	TEXACO E & P BOX 4325 HOUSTON, TX 77210-4325	2814201	G	F 9 23S 37E (METER)
022345	TEXACO E & P BOX 4325 HOUSTON, TX 77210-4325	2807198	G	C 9 23S 37E (VAPOR RECOVERY UNIT)

IV. Produced Water

²³ POD 2470150	²⁴ POD ULSTR Location and Description D 9 23S 37E
------------------------------	---

V. Well Completion Data

²⁵ Spud Date	²⁶ Ready Date	²⁷ Total Depth	²⁸ PBDT	²⁹ Perforations
³⁰ HOLE SIZE	³¹ CASING & TUBING SIZE	³² DEPTH SET	³³ SACKS CEMENT	

VI. Well Test Data

³⁴ Date New Oil	³⁵ Gas Delivery Date	³⁶ Date of Test	³⁷ Length of Test	³⁸ Tubing Pressure	³⁹ Casing Pressure
⁴⁰ Choke Size	⁴¹ Oil - Bbls.	⁴² Water - Bbls.	⁴³ Gas - MCF	⁴⁴ AOF	⁴⁵ Test Method

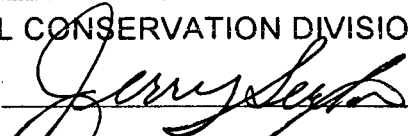
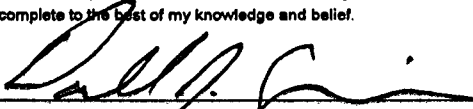
⁴⁶ I hereby certify that the rules and regulations of the Oil Conservation Division have been complied with and that the information given above is true and complete to the best of my knowledge and belief.		<div>OIL CONSERVATION DIVISION</div> <div>Approved By: </div> <div>Title: DISTRICT 1 SUPERVISOR</div> <div>Approval Date: MAR 13 1995</div>	
Signature 			
Printed Name Darrell J. Carriger			
Title Engineering Assistant			
Date 3/9/95	Telephone 397-0426		

⁴⁷ If this is a change of operator fill in the OGRID number and name of the previous operator			
Previous Operator Signature	Printed Name	Title	Date

Box 1980, Hobbs, NM 88241-1980
DISTRICT II
P.O. Box Drawer DD, Artesia, NM 88211-0719
DISTRICT III
1000 Rio Brazos Rd., Aztec, NM 87410
DISTRICT IV
P.O. Box 2088, Santa Fe, NM 87504-2088

State of New Mexico
Energy, Minerals and Natural Resources Department

OIL CONSERVATION DIVISION

P.O. Box 2088
Santa Fe, New Mexico 87504-2088

Form C-104
Revised February 10, 1994
Instructions on back
Submit to Appropriate District Office
5 Copies
RECEIVED
'95 MAR 16 PM 8 52
AMENDED REPORT

I. REQUEST FOR ALLOWABLE AND AUTHORIZATION TO TRANSPORT

¹ Operator Name and Address TEXACO EXPLORATION & PRODUCTION INC. P.O. BOX 730, HOBBS, NM 88240		² OGRID Number 022351
		³ Reason for Filing Code Corrected POD's
⁴ API Number 30 025 32498	⁵ Pool Name N. Teague Lower Paddock - Blinebry Associated	⁶ Pool Code 96314
⁷ Property Code 10960	⁸ Property Name HARRISON, B. F. 'B'	⁹ Well No. 23

II. ¹⁰ Surface Location

Ul or lot no.	Section	Township	Range	Lot.Idn	Feet From The	North/South Line	Feet From The	East/West Line	County
F	9	23-S	37-E		1815	NORTH	1815	WEST	LEA

¹¹ Bottom Hole Location

Ul or lot no.	Section	Township	Range	Lot.Idn	Feet From The	North/South Line	Feet From The	East/West Line	County
¹² Lse Code P	¹³ Producing Method Code P	¹⁴ Gas Connection Date 12/17/94	¹⁵ C-129 Permit Number	¹⁶ C-129 Effective Date	¹⁷ C-129 Expiration Date				

III. Oil and Gas Transporters

¹⁸ Transporter OGRID	¹⁹ Transporter Name and Address	²⁰ POD	²¹ O/G	²² POD ULSTR Location and Description
022628	TEXAS NEW MEXICO PIPELINE BOX 2528 HOBBS, NM 88241	2470110	O	C-9-23S-37E (BATTERY)
022345	TEXACO E & P BOX 4325 HOUSTON, TX 77210-4325	2470130	G	C 9 23S 37E (METER)
022345	TEXACO E & P BOX 4325 HOUSTON, TX 77210-4325	2807198	G	C 9 23S 37E (VAPOR RECOVERY UNIT)

IV. Produced Water

²³ POD 2470150	²⁴ POD ULSTR Location and Description D 9 23S 37E
------------------------------	---

V. Well Completion Data

²⁵ Spud Date	²⁶ Ready Date	²⁷ Total Depth	²⁸ PBSD	²⁹ Perforations
³⁰ HOLE SIZE	³¹ CASING & TUBING SIZE	³² DEPTH SET	³³ SACKS CEMENT	

VI. Well Test Data

³⁴ Date New Oil	³⁵ Gas Delivery Date	³⁶ Date of Test	³⁷ Length of Test	³⁸ Tubing Pressure	³⁹ Casing Pressure
⁴⁰ Choke Size	⁴¹ Oil - Bbls.	⁴² Water - Bbls.	⁴³ Gas - MCF	⁴⁴ AOF	⁴⁵ Test Method

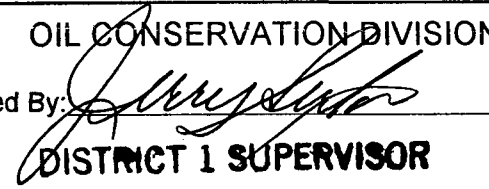
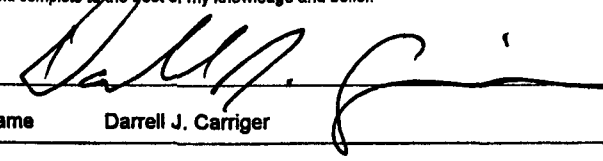
⁴⁶ I hereby certify that the rules and regulations of the Oil Conservation Division have been complied with and that the information given above is true and complete to the best of my knowledge and belief.		<div>OIL CONSERVATION DIVISION</div> <div>Approved By: </div> <div>Title: DISTRICT 1 SUPERVISOR</div> <div>Approval Date: MAR 13 1995</div>	
Signature 			
Printed Name Darrell J. Carriger			
Title Engineering Assistant			
Date 3/9/95	Telephone 397-0426		
⁴⁷ If this is a change of operator fill in the OGRID number and name of the previous operator			
Previous Operator Signature		Printed Name	Title
			Date

DISTRICT I
P.O. Box 1980, Hobbs, NM 88241-1980
DISTRICT II
P.O. Box Drawer DD, Artesia, NM 88211-0719
DISTRICT III
1000 Rio Brazos Rd., Aztec, NM 87410
DISTRICT IV
P.O. Box 2088, Santa Fe, NM 87504-2088

State of New Mexico
Energy, Minerals and Natural Resources Department

OIL CONSERVATION DIVISION

P.O. Box 2088
Santa Fe, New Mexico 87504-2088

Form C-104
Revised February 10, 1994
Instructions on back
Submit to Appropriate District Office
5 Copies
AMENDED REPORT

I. REQUEST FOR ALLOWABLE AND AUTHORIZATION TO TRANSPORT

¹ Operator Name and Address TEXACO EXPLORATION & PRODUCTION INC. P.O. BOX 730, HOBBS, NM 88240		² OGRID Number 022351
		³ Reason for Filing Code NW
⁴ API Number 30 025 32498	⁵ Pool Name NORTH TEAGUE LOWER PADDOCK - BLINEBRY ASSOCIATED	⁶ Pool Code 96314
⁷ Property Code 10960	⁸ Property Name HARRISON, B. F. 'B'	⁹ Well No. 23

II. ¹⁰ Surface Location

UI or lot no. F	Section 9	Township 23-S	Range 37-E	Lot.Idn	Feet From The 1815	North/South Line NORTH	Feet From The 1815	East/West Line WEST	County LEA
--------------------	--------------	------------------	---------------	---------	-----------------------	---------------------------	-----------------------	------------------------	---------------

¹¹ Bottom Hole Location

UI or lot no.	Section	Township	Range	Lot.Idn	Feet From The	North/South Line	Feet From The	East/West Line	County
¹² Lse Code P	¹³ Producing Method Code F	¹⁴ Gas Connection Date 12/17/94	¹⁵ C-129 Permit Number	¹⁶ C-129 Effective Date	¹⁷ C-129 Expiration Date				

III. Oil and Gas Transporters

¹⁸ Transporter OGRID	¹⁹ Transporter Name and Address	²⁰ POD	²¹ O/G	²² POD ULSTR Location and Description
022628	TEXAS NEW MEXICO PIPELINE BOX 2528 HOBBS, NM 88241	24035510 2470110	O	C-9-23S-37E (BATTERY)
022345	TEXACO E & P BOX 3000 TULSA, OK 74102	2814202	G	C-9-23S-37E (METER)

IV. Produced Water

²³ POD 2470150	²⁴ POD ULSTR Location and Description D-9-23S-37E
------------------------------	---

V. Well Completion Data

²⁵ Spud Date 7/19/94	²⁶ Ready Date 12/7/94	²⁷ Total Depth 7150'	²⁸ PBDT 7083'	²⁹ Perforations 5606'-5816'
³⁰ HOLE SIZE	³¹ CASING & TUBING SIZE	³² DEPTH SET	³³ SACKS CEMENT	
12 1/4	9 5/8	1180'	550	
8 3/4	7	7150'	3050	

VI. Well Test Data

³⁴ Date New Oil 11/2/94	³⁵ Gas Delivery Date 12/17/94	³⁶ Date of Test 12/19/94	³⁷ Length of Test 24	³⁸ Tubing Pressure 32/64 650#	³⁹ Casing Pressure
⁴⁰ Choke Size 32/64	⁴¹ Oil - Bbls. 50	⁴² Water - Bbls. 3	⁴³ Gas - MCF 73	⁴⁴ AOF	⁴⁵ Test Method

⁴⁶ I hereby certify that the rules and regulations of the Oil Conservation Division have been complied with and that the information given above is true and complete to the best of my knowledge and belief.

Signature _____

Printed Name Darrell J. Carriger

Title Engineering Assistant

Date 1/27/95 Telephone 397-0426

OIL CONSERVATION DIVISION

Approved By: _____

Title: DISTRICT 1 SUPERVISOR

Approval Date: FEB 09 1995

⁴⁷ If this is a change of operator fill in the OGRID number and name of the previous operator

Previous Operator Signature	Printed Name	Title	Date
-----------------------------	--------------	-------	------

DISTRICT I
P.O. Box 1980, Hobbs, NM 88241-1980
DISTRICT II
P.O. Box Drawer DD, Artesia, NM 88211-0719
DISTRICT III
1000 Rio Brazos Rd., Aztec, NM 87410
DISTRICT IV
P.O. Box 2088, Santa Fe, NM 87504-2088

State of New Mexico
Energy, Minerals and Natural Resources Department

OIL CONSERVATION DIVISION

P.O. Box 2088
Santa Fe, New Mexico 87504-2088

Form C-104
Revised February 10, 1994
Instructions on back
Submit to Appropriate District Office
5 Copies

95 FEB 13 PM 8 52
AMENDED REPORT

REQUEST FOR ALLOWABLE AND AUTHORIZATION TO TRANSPORT

¹ Operator Name and Address TEXACO EXPLORATION & PRODUCTION INC. P.O. BOX 730, HOBBS, NM 88240		² OGRID Number 022351
⁴ API Number 30 025 32498		³ Reason for Filing Code NW
⁵ Pool Name NORTH TEAGUE DRINKARD - ABO		⁶ Pool Code 96313
⁷ Property Code 10960	⁸ Property Name HARRISON, B. F. 'B'	⁹ Well No. 23

¹⁰ Surface Location									
UI or lot no. F	Section 9	Township 23-S	Range 37-E	Lot.Idn	Feet From The 1815	North/South Line NORTH	Feet From The 1815	East/West Line WEST	County LEA

¹¹ Bottom Hole Location									
UI or lot no.	Section	Township	Range	Lot.Idn	Feet From The	North/South Line	Feet From The	East/West Line	County
¹² Lse Code P	¹³ Producing Method Code F	¹⁴ Gas Connection Date 10/6/94	¹⁵ C-129 Permit Number	¹⁶ C-129 Effective Date	¹⁷ C-129 Expiration Date				

¹⁸ Oil and Gas Transporters				
¹⁸ Transporter OGRID	¹⁹ Transporter Name and Address	²⁰ POD	²¹ O/G	²² POD ULSTR Location and Description
022628	TEXAS NEW MEXICO PIPELINE BOX 2528 HOBBS, NM 88241	24855510 2470110	O	C-9-23S-37E (BATTERY)
022345	TEXACO E & P BOX 3000 TULSA, OK 74102	2814201	G	F-9-23S-37E (METER)

^{IV} Produced Water	
²³ POD 2470150	²⁴ POD ULSTR Location and Description D-9-23S-37E

^V Well Completion Data				
²⁵ Spud Date 7/19/94	²⁶ Ready Date 12/7/94	²⁷ Total Depth 7150'	²⁸ PBTD 7083'	²⁹ Perforations 6389'-7001'
³⁰ HOLE SIZE	³¹ CASING & TUBING SIZE	³² DEPTH SET	³³ SACKS CEMENT	
12 1/4	9 5/8	1180'	550	
8 3/4	7	7150'	3050	

^{VI} Well Test Data					
³⁴ Date New Oil 8/12/94	³⁵ Gas Delivery Date 8/15/94	³⁶ Date of Test 10/26/94	³⁷ Length of Test 24	³⁸ Tubing Pressure 256 1/2 30/64"	³⁹ Casing Pressure
⁴⁰ Choke Size 30/64	⁴¹ Oil - Bbls. 111	⁴² Water - Bbls. 1	⁴³ Gas - MCF 470	⁴⁴ AOF	⁴⁵ Test Method

⁴⁶ I hereby certify that the rules and regulations of the Oil Conservation Division have been complied with and that the information given above is true and complete to the best of my knowledge and belief.		OIL CONSERVATION DIVISION	
Signature 		Approved By:	
Printed Name Darrell J. Carriger		Title: DISTRICT 1 SUPERVISOR	
Title Engineering Assistant		Approval Date: FEB 09 1995	
Date 1/27/95	Telephone 397-0426		

⁴⁷ If this is a change of operator fill in the OGRID number and name of the previous operator			
Previous Operator Signature	Printed Name	Title	Date

DISTRICT I

P.O. Box 1980, Hobbs, NM 88240

DISTRICT II

P.O. Box Drawer DD, Artesia, NM 88210 Santa Fe, New Mexico 87504-2088

DISTRICT III

1000 Rio Brazos Rd., Aztec, NM 87410

OIL CONSERVATION DIVISION
RECEIVED
FEB 13 1995

OIL CONSERVATION DIVISION

P.O. Box 2088

WELL API NO.	30 025 32498
5. Indicate Type of Lease	STATE <input type="checkbox"/> FEE <input checked="" type="checkbox"/>
6. State Oil / Gas Lease	

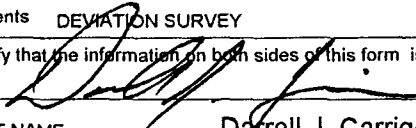
WELL COMPLETION OR RECOMPLETION REPORT AND LOG															
1a. Type of Well: OIL WELL <input checked="" type="checkbox"/> GAS WELL <input type="checkbox"/> DRY <input type="checkbox"/> OTHER <input type="checkbox"/>					7. Lease Name or Unit Agreement Name HARRISON, B. F. 'B'										
b. Type of Completion: NEW WELL <input checked="" type="checkbox"/> WORKOVER <input type="checkbox"/> DEEPEN <input type="checkbox"/> PLUG BACK <input type="checkbox"/> DIFF RES. <input type="checkbox"/> OTHER <input type="checkbox"/>															
2. Name of Operator TEXACO EXPLORATION & PRODUCTION INC.					8. Well No. 23										
3. Address of Operator P.O. BOX 730, HOBBS, NM 88240					9. Pool Name or Wildcat N. Teague (Drinkard-Abo; Lower Pad.-Blin. Ass.)										
4. Well Location Unit Letter F : 1815 Feet From The NORTH Line and 1815 Feet From The WEST Line Section 9 Township 23-S Range 37-E NMPM LEA COUNTY															
10. Date Spudded 7/19/94		11. Date T.D. Reached 8/1/94		12. Date Compl. (Ready to Prod.) 12/7/94		13. Elevations (DF & RKB, RT, GR, etc.) GR-3313', KB-3325'		14. Elev. Csghead							
15. Total Depth 7150'		16. Plug Back T.D. 7083'		17. If Mult. Compl. How Many Zones? 2		18. Intervals Drilled By Rotary Tools 0'-7150'		Cable Tools							
19. Producing Interval(s), of this completion - Top, Bottom, Name 6389'-7001', DRINKARD -ABO; 5606'-5816', BLINEBRY								20. Was Directional Survey Made YES							
21. Type Electric and Other Logs Run GR-DLL-MSFL, GR-CSNG-SDL-DSN								22. Was Well Cored NO							
23. CASING RECORD (Report all Strings set in well)															
CASING SIZE		WEIGHT LB./FT.		DEPTH SET		HOLE SIZE		CEMENT RECORD		AMOUNT PULLED					
9 5/8		36#		1180'		12 1/4		550							
7		23# & 26#		7150'		8 3/4		3050							
24. LINER RECORD										25. TUBING RECORD					
SIZE		TOP		BOTTOM		SACKS CEMENT		SCREEN		SIZE		DEPTH SET		PACKER SET	
NONE										2-3/8"		6360'		6360'	
										2-1/16"		5576'			
26. Perforation record (interval, size, and number) 5606'-5816', 104 HOLES, 2 JSPF; North Teague Lower Paddock-Blinebry Ass. 6389'-6545', 102 HOLES, 2 JSPF; DRINKARD 6612'-7001', 88 HOLES, 1 JSPF; ABO The North Teague Lower Paddock-Blinebry Associated pool is dually completed with the North Teague Drinkard-Abo pool.										27. ACID, SHOT, FRACTURE, CEMENT, SQUEEZE, ETC.					
										DEPTH INTERVAL		AMOUNT AND KIND MATERIAL USED			
										5606'-5816'		2500g 15%HCL, 148100g+148000#gel snd			
										6389'-6545'		2500g15%HCL, 51051g+121357# gel snd			
										6612'-7001'		15000gCO2 foamed 20%HCL			
28. PRODUCTION															
Date First Production 8/13/94		Production Method (Flowing, gas lift, pumping - size and type pump) FLOW - FLOW (BLINEBRY - DRINKARD ABO)								Well Status (Prod. or Shut-in) PRODUCING					
Date of Test 12/19, 10/26/94		Hours tested 24		Choke Size 32/64-30/64		Prod'n For Test Period		Oil - Bbl. 50-111		Gas - MCF 73-470		Water - Bbl. 3-1		Gas - Oil Ratio 1460-4234	
Flow Tubing Press. 32/64-30/64		Casing Pressure		Calculated 24-Hour Rate		Oil - Bbl. 50-111		Gas - MCF 73-470		Water - Bbl. 3-1		Oil Gravity - API -(Corr.) 43.5-40.1			
29. Disposition of Gas (Sold, used for fuel, vented, etc.) SOLD										Test Witnessed By					
30. List Attachments DEVIATION SURVEY															
31. I hereby certify that the information on both sides of this form is true and complete to the best of my knowledge and belief.															
SIGNATURE 										TITLE Engineering Assistant		DATE 2/3/95			
TYPE OR PRINT NAME Darrell J. Carriger										Telephone No.		397-0426			

INSTRUCTIONS

This form is to be filed with the appropriate District Office of the Division not later than 20 days after the completion of any newly-drilled or deepened well. It shall be accompanied by one copy of all electrical and radio-activity logs run on the well and a summary of all special tests conducted, including drill stem tests. All depths reported shall be measured depths. In the case of directionally drilled wells, true verticle depths shall be reported. For multiple completions, Items 25 through 29 shall be reported for each zone. The form is to be filed in quintuplicate except on state land, where six copies are required. See Rule 1105.

INDICATE FORMATION TOPS IN CONFORMANCE WITH GEOGRAPHICAL SECTION OF STATE

Southeastern New Mexico

T. Anhy	1112	T. Canyon
T. Salt	1211	T. Strawn
B. Salt	2449	T. Atoka
T. Yates	2600	T. Miss
T. 7 Rivers	2940	T. Devonian
T. Queen	3316	T. Silurian
T. Grayburg	3657	T. Montoya
T. San Andres	4010	T. Simpson
T. Glorieta	5030	T. McKee
T. Paddock	5239	T. Ellenburger
T. Blinebry	5558	T. Gr. Wash
T. Tubb	6076	T. Delaware Sand
T. Drinkard	6328	T. Bone Springs
T. Abo	6590	T.
T. Wolfcamp		T.
T. Penn		T.
T. Cisco (Bough C)		T.

Northwestern New Mexico

T. Ojo Alamo	T. Penn "B"
T. Kirtland-Fruitland	T. Penn "C"
T. Pictured Cliffs	T. Penn "D"
T. Cliff House	T. Leadville
T. Menefee	T. Madison
T. Point Lookout	T. Elbert
T. Mancos	T. McCracken
T. Gallup	T. Ignacio Otzte
T. Base Greenhorn	T. Granite
T. Dakota	T.
T. Morrison	T.
T. Todilto	T.
T. Entrada	T.
T. Wingate	T.
T. Chinle	T.
T. Permian	T.
T. Penn "A"	T.

OIL OR GAS SANDS OR ZONES

No. 1, from	6328	to	7150	No. 3, from	to
No. 2, from	5558	to	6076	No. 4, from	to

IMPORTANT WATER SANDS

Include data on rate of water inflow and elevation to which water rose in the hole.

No. 1, from	to	feet
No. 2, from	to	feet
No. 3, from	to	feet

LITHOLOGY RECORD (Attach additional sheet if necessary)

From	To	Thickness in Feet	Lithology	From	To	Thickness in Feet	Lithology
0	1112	1112	REDBEDS				
1112	1211	99	ANHYD.				
1211	2449	1238	SALT, ANHYD., SHALE				
2449	2600	151	ANHYD., SALT, DOL.				
2600	2940	340	SNDSTNE., ANHYD., DOL.				
2940	3316	376	DOL., SNDSTNE.				
3316	3657	341	SNDSTNE., DOL.				
3657	4010	353	DOL., SNDSTNE				
4010	5030	1020	DOL., ANHYD.				
5030	5239	209	DOL.				
5239	5558	319	DOL., ANHYD.				
5558	6076	518	DOL., ANHYD.				
6076	6328	252	SNDSTNE., DOL.				
6328	6590	262	DOL., ANHYD.				
6590	7150	560	DOL., ANHYD., SHALE				

RECEIVED

OFFICE

DISTRICT I

P.O. Box 1980, Hobbs, NM 88240

DISTRICT II

P.O. Box Drawer DD, Artesia, NM 88210

DISTRICT III

1000 Rio Brazos Rd., Aztec, NM 87410

OIL CONSERVATION DIVISION

OIL CONSERVATION DIVISION
P.O. Box 2088

Santa Fe, New Mexico 87504-2088

WELL API NO.	30-025-32498
5. Indicate Type of Lease	STATE <input type="checkbox"/> FEE <input checked="" type="checkbox"/>
6. State Oil / Gas Lease No.	
7. Lease Name or Unit Agreement Name	HARRISON, B. F. 'B'
8. Well No.	23
9. Pool Name or Wildcat	TEAGUE DRINKARD / WILDCAT ABO
10. Elevation (Show whether DF, RKB, RT, GR, etc.)	GR-3313', KB-3325'

SUNDY NOTICES AND REPORTS ON WELL
(DO NOT USE THIS FORM FOR PROPOSALS TO DRILL OR TO DEEPEN OR PLUG BACK TO A
DIFFERENT RESERVOIR. USE "APPLICATION FOR PERMIT
(FORM C-101) FOR SUCH PROPOSALS.)

1. Type of Well: OIL WELL ☒ GAS WELL ☐ OTHER ☐

2. Name of Operator
TEXACO EXPLORATION & PRODUCTION INC.

3. Address of Operator
P.O. Box 46510, Denver Colorado 80201-6510

4. Well Location
Unit Letter F : 1815 Feet From The NORTH Line and 1815 Feet From The WEST Line
Section 9 Township 23-S Range 37-E NMPM LEA COUNTY

11. Check Appropriate Box to Indicate Nature of Notice, Report, or Other Data

NOTICE OF INTENTION TO:

PERFORM REMEDIAL WORK ☐ PLUG AND ABANDON ☐
TEMPORARILY ABANDON ☐ CHANGE PLANS ☐
PULL OR ALTER CASING ☐
OTHER: ☐

SUBSEQUENT REPORT OF:

REMEDIAL WORK ☐ ALTERING CASING ☐
COMMENCE DRILLING OPERATION ☐ PLUG AND ABANDONMENT ☐
CASING TEST AND CEMENT JOB ☒
OTHER: ☐ COMPLETION: ABO, DRINKARD ☒

12. Describe Proposed or Completed Operations (Clearly state all pertinent details, and give pertinent dates, including estimated date of starting any proposed work) SEE RULE 1103.

- UNION PERFED: 6612-6618, 6620-6625, 6683-6693, 6698-6708, 6718-6720, 6748-6750, 6807-6809, 6816, 6823-6827, 6846-6848, 6852-6854, 6868-6871, 6882-6884, 6900-6903, 6906-6910, 6911-6914, 6917-6926, 6958-6962, 6966-6970, 6984-6987, 6990-6992, 6996-7001. 88 HOLES.
- DOWELL ACIDIZED W/ 15000 GAL 65 QUALITY CO2 FOAMED ACID 20% HCL. 08-13-94. FLOWED 71 BO, 201 BLW IN 13 HOURS.
- MIRU POOL WELL SERVICE. KILL WELL W/ 200 BBLS OF FRESH WATER. TIH W/ RBP & TBG TO 6578'. 09-18-94. PRESS TEST TO 4000 PSI.
- UNION PERFED: 6389-6392, 6399-6401, 6407-6410, 6418-6424, 6446-6451, 6469-6471, 6483-6487, 6492-6496, 6505-6512, 6515-6522, 6425-6528, 6533-6536, 6543-6545. 102 HOLES.
- DOWELL ACIDIZED STAGING JOB W/ 150 BALL SEALERS. HAD GOOD BALL ACTION. DOWELL ACIDIZED W/ 2500 GAL 15% HCL. 09-25-94. FLOWED 108 BLW IN 2.5 HOURS.
- FRAC'D W/51051 GAL AND 121357 20/40 XL GEL SAND. 09-25-94.
- TIH W/ NOTCHED COLLAR ON 2.375" TBG. TAG SD @ 6410'. CLEAN OUT SD TO 6578'. TOH & PICK UP PACKER. TIH TO 3500'. 09-28-94.
- ND 5000 PSI EQUIP. TEST PACKER TO 1000 PSI. SWABBED 108 BLW IN 2.5 HOURS. 09-27-94.
- FLOWED 74 BO, 4 BLW, 302 MCFD, 24/64" CHOKE 75 FTP IN 24 HOURS. 10-12-94.
- MIRU POOL SERVICE UNIT. RELEASE PACKER AND TOH. TIH W/ RETRIEVING TOOL & TAG FILL @ 6532'. TOH TO 6290'. 10-13-94.
- TIH & TAG SAND @ 6530'. CLEAN OUT SAND TO RBP. LATCH RBP @ 6578'. RELEASE FROM RBP & TOH W/ 2.375", 4.7#, J-55.
- TIH W/ SHOE, 4-JOINTS, 5-3/4" WASH PIPE, JARS, 4-4" DC'S ACCELERATOR, & 2-4" DC'S ON 2-7/8" TUBING. TOH TO 6230'. 10-16-94.
- RU D/S. TIH W/ 1.25" OD COILED TUBING AND TAG FILLED @ 6365'. CLEAN OUT FILL TO TOP OF FISH @ 6425'. 10-18-94.
- TIH W/ FISHING STRING. TIH W/ 5-3/4" OD X 5" ID SHOE, TOP BUSHING, X O, JARS & 8-4.25" OD DRILL COLLARS. TOH. TIH W/ SCREW IN SUB, DRAIN SUB, BUMPER SUB, JARS & 10-4.25" OD DRILL COLLARS. BEGAN JARRING DOWN.
- TIH W/ 2-7/8" TUBING, POOH LDDC'S/TBG. TIH W/ 7" UNI VI TO 6259' ON 2-3/8" TUBING. ND BOP & NU TREE. TST ANNULUS TO 1000 PSI.
- FLOWED 111 BO, 1 BLW, 470 MCFD, 30/64" CHOKE, 90 FTP IN 24 HOURS. 10-26-94.

I hereby certify that the information above is true and complete to the best of my knowledge and belief.

SIGNATURE C.P. Basham / SR TITLE Drilling Operations Mgr. DATE 1/3/95

TYPE OR PRINT NAME C. P. Basham Telephone No. (303)621-4851

(This space for State Use)

APPROVED BY [Signature] TITLE DISTRICT I SUPERVISOR DATE JAN 23 1995

CONDITIONS OF APPROVAL, IF ANY:

DISTRICT I

P.O. Box 1980, Hobbs, NM 88240

DISTRICT II

P.O. Box Drawer DD, Artesia, NM 88210

DISTRICT III

1000 Rio Brazos Rd., Aztec, NM 87410

OIL CONSERVATION DIVISION

RECEIVED

P.O. Box 2088

Santa Fe, New Mexico 87504-2088

95 JAN 27 AM 8 52

WELL API NO. 30-025-32498	
5. Indicate Type of Lease STATE <input type="checkbox"/> FEE <input checked="" type="checkbox"/>	
6. State Oil / Gas Lease No.	
7. Lease Name or Unit Agreement Name HARRISON, B. F. 'B'	
8. Well No. 23	
9. Pool Name or Wildcat TEAGUE DRINKARD / WILDCAT ABO	
10. Elevation (Show whether DF, RKB, RT, GR, etc.) GR-3313', KB-3325'	

SUNDRY NOTICES AND REPORTS ON WELL
(DO NOT USE THIS FORM FOR PROPOSALS TO DRILL OR TO DEEPEN OR PLUG BACK TO A
DIFFERENT RESERVOIR. USE "APPLICATION FOR PERMIT
(FORM C-101) FOR SUCH PROPOSALS.)

1. Type of Well: OIL WELL ☒ GAS WELL ☐ OTHER ☐

2. Name of Operator
TEXACO EXPLORATION & PRODUCTION INC.

3. Address of Operator
P.O. Box 46510, Denver Colorado 80201-6510

4. Well Location
Unit Letter F 1815 Feet From The NORTH Line and 1815 Feet From The WEST Line
Section 9 Township 23-S Range 37-E NMPM LEA COUNTY

10. Elevation (Show whether DF, RKB, RT, GR, etc.)
GR-3313', KB-3325'

11. Check Appropriate Box to Indicate Nature of Notice, Report, or Other Data

NOTICE OF INTENTION TO:

PERFORM REMEDIAL WORK ☐ PLUG AND ABANDON ☐
TEMPORARILY ABANDON ☐ CHANGE PLANS ☐
PULL OR ALTER CASING ☐
OTHER: ☐

SUBSEQUENT REPORT OF:

REMEDIAL WORK ☐ ALTERING CASING ☐
COMMENCE DRILLING OPERATION ☐ PLUG AND ABANDONMENT ☐
CASING TEST AND CEMENT JOB ☒
OTHER: ☐ COMPLETION: ABO, DRINKARD, BLINEBRY ☒

12. Describe Proposed or Completed Operations (Clearly state all pertinent details, and give pertinent dates, including estimated date of starting any proposed work) SEE RULE 1103.

- MIRU POOL SERVICE UNIT. TOH W/ TBG & PKR. TIH W/ RBP & SET SAME @ 5897'. PRES. TST CASING TO 4000 PSI. TOH. RDSU.
- UNION WL PERF: 5606-5612', 5680-5690', 5693-5696', 5707-5714', 5723-5726', 5730-5732', 5738-5743', 5750-5760', 5810-5816'. 104 HOLES.
- DOWELL ACIDIZED PERFS USING 156 BALL SEALERS. HAD LITTLE BALL CTION. DOWELL ACIDIZED W/ 2500 GAL 15% HCL. DOWELL FRAC'D W/ 48100 GAL FLUID & 148000# XL GEL SAND. 10-30-94.
- TIH W/ TBG & TAG SAND @ 4838'. WASH SAND TO 5890'. TOH TO 2900'. 11-01-94.
- TIH W/ UNI-6 PACKER, SET @ 5484'.
- SWABBED 22 BO, 15 BLW IN 7 HOURS. 11-10-94
- MIRU POOL SERVICE UNIT. TOH W/ PACKER. TIH W/ RETRIEVING TOL. RELEASE RBP & TOH TO 4000'. 11-26-94.
- TIH FROM 4000' - 4875' & TAG SAND. WASH SAND TO RBP @ 5897'. TOH. 11-27-94.
- TIH W/ 5.75" OD X 5.00" ID SHOE, XO, JARS & 12 4.5" D.C'S ON 2.875", 6.5#, N80 EUE. TAG TOF @ 5897' W/ SOFT FILL ON RBP. CIRCULATE CLEAN & TOH. 11-28-94.
- TIH W/ 5-3/4" OD W/ 3.00" GRAPPLE, DRAIN SUB, X O, HYDRAULIC JARS, X O, 12 4.5" DRILL COLLARS ON 2.875" TUBING. ENGAGE FISH & BEGIN JARRING UP.
- RU UNION WL & TIH W/ GUIBERSON 7" 17-26# "G" MAGNUM PKR TO 6360' & SET. TIH TO 1500' & SET UNI VI PKR. ND BOP. NU BOP, CLOSE RAMS & TEST TO 1500 PSI. RELEASE PACKER & TOH. TIN W/ 2-JOINTS 2-3/8" TAIL PIPE, 4' X 2-7/8" LATCH SEAL ASSEMBLY, 2 3/8" "XL" ON/OFF TOOL W/ 1.875" "F" PROFILE TO 5700'. 12-01-94.
- FIH W/ 2-3/8" TBG. LATCHED INTO PKR @ 6360'. TIH W/ 2-1/16", 3.25#, J-55, IJ 10 RD TBG TO 5576'.
- SWABBED 4 BO, 74 BLW IN 6.5 HOURS. 12-07-94. FL, LT 139 BO, 3 BLW 594 MCFD, FTP 250, 25/64 CK IN 24 HOURS. 12-07-94.
- PLUNGER LIFT UT. 50 BO, 36 BLW, 73 MCFD.

I hereby certify that the information above is true and complete to the best of my knowledge and belief.

SIGNATURE C.P. Basham / SPT TITLE Drilling Operations Mgr. DATE 1/3/95

TYPE OR PRINT NAME C. P. Basham Telephone No. (303)621-4851

(This space for State Use)

APPROVED BY [Signature] TITLE DISTRICT 1 SUPERVISOR DATE JAN 23 1995

CONDITIONS OF APPROVAL IF ANY:

Texaco Expl. & Prod. Co.

Harrison 'B' #23

Lea County, NM

OIL CONSERVATION DIVISION
RECEIVED

'95 FEB 13 AM 8 52

Unit F

4-235-378

1815/2 & 1815/2

30-025-32498

STATE OF NEW MEXICO
DEVIATION REPORT

256	1/4
746	1/4
1,180	1-1/2
1,436	1
1,682	1
1,919	1-1/2
2,044	1-3/4
2,168	2-1/4
2,394	2
2,665	1-1/4
3,128	3/4
3,627	1/2
4,120	3/4
4,619	1-1/2
4,897	1-3/4
5,378	2-1/4
5,489	1-1/2
5,988	1-1/4
6,483	1/2
6,914	1
7,150	1/2

Ray Peterson

By: Ray Peterson

STATE OF TEXAS

COUNTY OF MIDLAND

The foregoing instrument was acknowledged before me
this 4th day of August, 1994, by RAY PETERSON
on behalf of PETERSON DRILLING COMPANY.

Alice Keel
Notary Public for Midland
County, Texas

My Commission Expires: 8/2/96

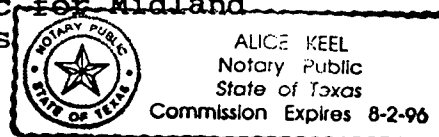

DISTRICT I

P.O. Box 1980, Hobbs, NM 88241-1980

DISTRICT II

P.O. Box Drawer DD, Artesia, NM 88211-0719

DISTRICT III

1000 Rio Brazos Rd., Aztec, NM 87410

DISTRICT IV

P.O. Box 2088, Santa Fe, NM 87504-2088

State of New Mexico
Energy, Minerals and Natural Resources Department

OIL CONSERVATION DIVISION

P.O. Box 2088
Santa Fe, New Mexico 87504-2088

Form C-101

Revised February 10, 1994

Instructions on back

Submit to Appropriate District Office

State Lease - 6 Copies

Fee Lease - 5 Copies

☒ AMENDED REPORT

APPLICATION FOR PERMIT TO DRILL, RE-ENTER, DEEPEN, PLUGBACK, OR ADD A ZONE

Operator Name and Address TEXACO EXPLORATION & PRODUCTION INC. P.O. Box 3109, Midland Texas 79702		² OGRID Number 022351
⁴ Property Code 10860	⁵ Property Name HARRISON, B. F. 'B'	³ API Number 30-025-32498
		⁶ Well No. 23

⁷ Surface Location

UI or lot no.	Section	Township	Range	Lot.Idn	Feet From The	North/South Line	Feet From The	East/West Line	County
F	9	23-S	37-E		1815	NORTH	1815	WEST	LEA

⁸ Proposed Bottom Hole Location If Different From Surface

UI or lot no.	Section	Township	Range	Lot.Idn	Feet From The	North/South Line	Feet From The	East/West Line	County

⁹ Proposed Pool 1

NORTH TEAGUE LOWER PADDOCK-BLINEBRY ASSOCIATED

¹⁰ Proposed Pool 2

¹¹ Work Type Code A	¹² WellType Code M	¹³ Rotary or C.T. R	¹⁴ Lease Type Code P	¹⁵ Ground Level Elevation GR-3313', KB-3325'
¹⁶ Multiple Yes	¹⁷ Proposed Depth 7150'	¹⁸ Formation PADDOCK-BLINEBRY	¹⁹ Contractor	²⁰ Spud Date 7/20/94

²¹ Proposed Casing and Cement Program

SIZE OF HOLE	SIZE OF CASING	WEIGHT PER FOOT	SETTING DEPTH	SACKS OF CEMENT	EST. TOP

²² Describe the proposed program. If this application is to DEEPEN or PLUG BACK give the data on the present productive zone and proposed new productive zone.
Describe the blowout prevention program, if any. Use additional sheets if necessary.

ADD FIELD TO EXISTING APD. TEXACO PLANS TO DUAL COMPLETE THIS FIELD WITH THE NORTH TEAGUE DRINKARD-ABO FIELD. FORM C-107 WILL BE FILED.

²³ I hereby certify that the rules and regulations of the Oil Conservation Division have been complied with and that the information given above is true and complete to the best of my knowledge and belief.

Signature

C. Wade Howard

Printed Name

C. Wade Howard

Title Eng. Assistant

Date 11/14/94

Telephone 688-4606

OIL CONSERVATION DIVISION

Approved By:

Gary W. Wink

Title: FIELD REPRESENTATIVE II

Approval Date: NOV 21 1994

Expiration Date:

Conditions of Approval:

Attached ☐

Box 1980, Hobbs, NM 88241-1980
DISTRICT II
P.O. Box Drawer DD, Artesia, NM 88211-0719
DISTRICT III
1000 Rio Brazos Rd., Aztec, NM 87410
DISTRICT IV
P.O. Box 2088, Santa Fe, NM 87504-2088

State of New Mexico
Energy, Minerals and Natural Resources Department

OIL CONSERVATION DIVISION

P.O. Box 2088
Santa Fe, New Mexico 87504-2088

Form C-102

Revised February 10, 1994

Instructions on back

Submit to Appropriate District Office

State Lease - 4 Copies

Fee Lease - 3 Copies

☐ AMENDED REPORT

WELL LOCATION AND ACREAGE DEDICATION PLAT

¹ API Number 30 025 32498	² Pool Code 96314	³ Pool Name NORTH TEAGUE LOWER PADDOCK - BLINEBRY ASSOCIATED
⁴ Property Code 10960	⁵ Property Name HARRISON, B. F. 'B'	⁶ Well No. 23
⁷ OGRID Number 022351	⁸ Operator Name TEXACO EXPLORATION & PRODUCTION INC.	⁹ Elevation 3313'

¹⁰ Surface Location

UI or lot no.	Section	Township	Range	Lot.Idn	Feet From The	North/South Line	Feet From The	East/West Line	County
F	9	23-S	37-E		1815	NORTH	1815	WEST	LEA

¹¹ Bottom Hole Location If Different From Surface

UI or lot no.	Section	Township	Range	Lot.Idn	Feet From The	North/South Line	Feet From The	East/West Line	County

¹² Dedicated Acres 160	¹³ Joint or Infill No	¹⁴ Consolidation Code	¹⁵ Order No.
--------------------------------------	-------------------------------------	----------------------------------	-------------------------

NO ALLOWABLE WILL BE ASSIGNED TO THIS COMPLETION UNTIL ALL INTERESTS HAVE BEEN CONSOLIDATED
OR A NON-STANDARD UNIT HAS BEEN APPROVED BY THE DIVISION

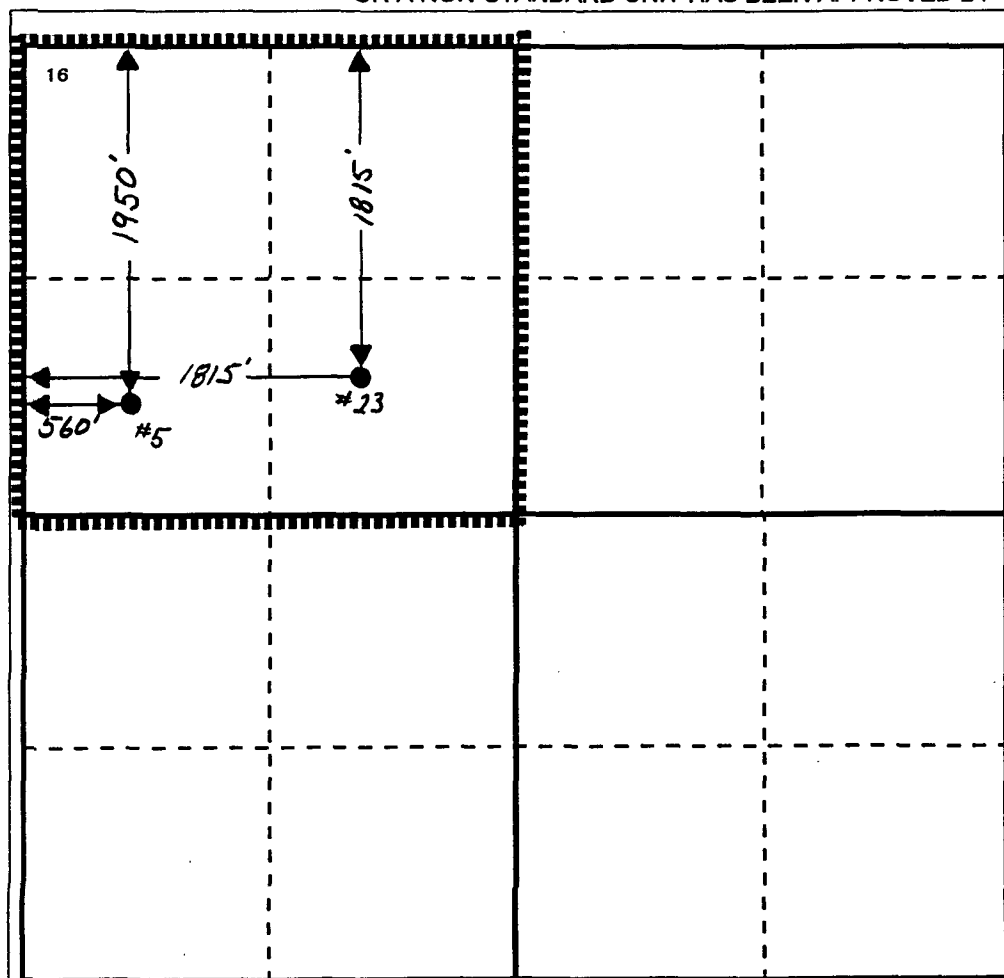

17 OPERATOR CERTIFICATION

I hereby certify that the information
contained herein is true and complete to the
best of my knowledge and belief

Signature

Printed Name

Darrell J. Carriger

Position

Engineering Assistant

Date

11/15/94

18 SURVEYOR CERTIFICATION

I hereby certify that the well location shown
on this plat was plotted from field notes of
actual surveys made by me or under my
supervision, and that the same is true and
correct to the best of my knowledge and
belief.

Date Surveyed

Signature & Seal of
Professional Surveyor

Certificate No.

DISTRICT I

P.O. Box 1980, Hobbs, NM 88240

DISTRICT II

P.O. Box Drawer DD, Artesia, NM 88210

DISTRICT III

1000 Rio Brazos Rd., Aztec, NM 87410

OIL CONSERVATION DIVISION

P.O. Box 2088

Santa Fe, New Mexico 87504-2088

WELL API NO.

30-025-32498

5. Indicate Type of Lease

STATE ☐

FEE ☒

6. State Oil / Gas Lease No.

7. Lease Name or Unit Agreement Name

HARRISON, B. F. 'B'

8. Well No.

23

9. Pool Name or Wildcat

TEAGUE DRINKARD / WILDCAT ABO

SUNDY NOTICES AND REPORTS ON WELL
(DO NOT USE THIS FORM FOR PROPOSALS TO DRILL OR TO DEEPEN OR PLUG BACK TO A
DIFFERENT RESERVOIR. USE "APPLICATION FOR PERMIT"
(FORM C-101) FOR SUCH PROPOSALS.)

1. Type of Well: OIL WELL ☒ GAS WELL ☐ OTHER ☐

2. Name of Operator
TEXACO EXPLORATION & PRODUCTION INC.

3. Address of Operator
P.O. Box 3109, Midland Texas 79702

4. Well Location

Unit Letter F : 1815 Feet From The NORTH Line and 1815 Feet From The WEST Line

Section 9 Township 23-S Range 37-E NMPM LEA COUNTY

10. Elevation (Show whether DF, RKB, RT, GR, etc.) GR-3313', KB-3325'

11. Check Appropriate Box to Indicate Nature of Notice, Report, or Other Data

NOTICE OF INTENTION TO:

PERFORM REMEDIAL WORK ☐

PLUG AND ABANDON ☐

TEMPORARILY ABANDON ☐

CHANGE PLANS ☐

PULL OR ALTER CASING ☐

OTHER: ☐

SUBSEQUENT REPORT OF:

REMEDIAL WORK ☐

ALTERING CASING ☐

COMMENCE DRILLING OPERATION ☐

PLUG AND ABANDONMENT ☐

CASING TEST AND CEMENT JOB ☒

OTHER: ☐

PRODUCTION CASING ☒

12. Describe Proposed or Completed Operations (Clearly state all pertinent details, and give pertinent dates, including estimated date of starting any proposed work) SEE RULE 1103.

1. DRILLED 8 3/4 HOLE TO 7150'. TD @ 10:30 AM 08-01-94.

2. HLS RAN GR-DLL-MSFL, GR-CSNG-SDL-DSN. PULLED GR-DSN TO SURFACE.

3. RAN 48 JOINTS OF 7, 23# J-55, 12 JOINTS OF 26# K-55, 33 JOINTS OF 23# HCL-80 AND 72 JOINTS OF 26# J-55, LTC CASING SET @ 7150'.

4. DOWELL CEMENTED WITH 2550 SACKS 35/65 POZ CLASS H W/ 6% GEL, 5% SALT, 1/4# FLOCELE (12.8 PPG, 1.94 CF/S). F/B 500 SACKS 50/50 POZ CLASS H W/ 2% GEL, 5% SALT, 1/4# FLOCELE (14.2 PPG, 1.35 CF/S). PLUG DOWN @ 5:45 PM 08-03-94. CIRCULATED 400 SACKS.

5. ND. RELEASE RIG @ 12:00 AM 08-04-94.

6. PREP TO COMPLETE.

I hereby certify that the information above is true and complete to the best of my knowledge and belief.

SIGNATURE C. P. Basham / DOH TITLE Drilling Operations Mgr.

DATE 8/5/94

TYPE OR PRINT NAME C. P. Basham

Telephone No. 688-4608

(This space for State Use)

APPROVED BY GARY W. WINK TITLE FIELD REPRESENTATIVE II

DATE AUG 20 1994

CONDITIONS OF APPROVAL, IF ANY:

DISTRICT I

P.O. Box 1980, Hobbs, NM 88240

DISTRICT II

P.O. Box Drawer DD, Artesia, NM 88210

DISTRICT III

1000 Rio Brazos Rd., Aztec, NM 87410

OIL CONSERVATION DIVISION

P.O. Box 2088
Santa Fe, New Mexico 87504-2088

WELL API NO.	30-025-32498
5. Indicate Type of Lease	STATE <input type="checkbox"/> FEE <input checked="" type="checkbox"/>
6. State Oil / Gas Lease No.	
7. Lease Name or Unit Agreement Name	HARRISON, B. F. 'B'
8. Well No.	23
9. Pool Name or Wildcat	TEAGUE DRINKARD / WILDCAT ABO
10. Elevation (Show whether DF, RKB, RT, GR, etc.)	GR-3313', KB-3325'

SUNDRY NOTICES AND REPORTS ON WELL
(DO NOT USE THIS FORM FOR PROPOSALS TO DRILL OR TO DEEPEN OR PLUG BACK TO A DIFFERENT RESERVOIR. USE "APPLICATION FOR PERMIT" (FORM C-101) FOR SUCH PROPOSALS.)

1. Type of Well: OIL WELL ☒ GAS WELL ☐ OTHER ☐

2. Name of Operator
TEXACO EXPLORATION & PRODUCTION INC.

3. Address of Operator
P.O. Box 3109, Midland Texas 79702

4. Well Location
Unit Letter F : 1815 Feet From The NORTH Line and 1815 Feet From The WEST Line
Section 9 Township 23-S Range 37-E NMPM LEA COUNTY

10. Elevation (Show whether DF, RKB, RT, GR, etc.) GR-3313', KB-3325'

11. Check Appropriate Box to Indicate Nature of Notice, Report, or Other Data

NOTICE OF INTENTION TO:

PERFORM REMEDIAL WORK ☐ PLUG AND ABANDON ☐
TEMPORARILY ABANDON ☐ CHANGE PLANS ☐
PULL OR ALTER CASING ☐
OTHER: ☐

SUBSEQUENT REPORT OF:

REMEDIAL WORK ☐ ALTERING CASING ☐
COMMENCE DRILLING OPERATION ☒ PLUG AND ABANDONMENT ☐
CASING TEST AND CEMENT JOB ☒
OTHER: ☒ SPUD & SURFACE CASING

12. Describe Proposed or Completed Operations (Clearly state all pertinent details, and give pertinent dates, including estimated date of starting any proposed work) SEE RULE 1103.

- PETERSON RIG #2 SPUD 12 1/4 INCH HOLE @ 4:00 PM 07-19-94. DRILLED TO 1180'. TD @ 2:00 PM 07-20-94.
- RAN 26 JOINTS OF 9 5/8, 36#, J-55, STC CASING SET @ 1180'. RAN 10 CENTRALIZERS.
- DOWELL CEMENTED WITH 350 SACKS CLASS C W/ 4% GEL, 2% CACL2 (13.5 PPG, 1.74 CF/S). F/B 200 SACKS CLASS C W/ 2% CACL2 (14.8 PPG, 1.34 CF/S). PLUG DOWN @ 9:00 PM 07-20-94. CIRCULATED 161 SACKS.
- NU BOP & TESTED TO 3000#. TESTED CASING TO 1000# FOR 30 MINUTES FROM 5:00 PM TO 5:30 PM 07-21-94.
- WOC TIME 20 HOURS FROM 9:00 PM 07-20-94 TO 5:00 PM 07-21-94.
- DRILLING 8 3/4 HOLE.

I hereby certify that the information above is true and complete to the best of my knowledge and belief.

SIGNATURE C. P. Basham / SDH TITLE Drilling Operations Mgr. DATE 7/26/94

TYPE OR PRINT NAME C. P. Basham Telephone No. 688-4608

(This space for State Use)

APPROVED BY [Signature] TITLE DISTRICT 1 SUPERVISOR DATE JUL 28 1994

CONDITIONS OF APPROVAL, IF ANY:

DISTRICT I

P.O. Box 1980, Hobbs, NM 88241-1980

DISTRICT II

P.O. Box Drawer DD, Artesia, NM 88211-0719

DISTRICT III

1000 Rio Brazos Rd., Aztec, NM 87410

DISTRICT IV

P.O. Box 2088, Santa Fe, NM 87504-2088

State of New Mexico

Energy, Minerals and Natural Resources Department

Form C-101

Revised February 10, 1994

Instructions on back

Submit to Appropriate District Office

State Lease - 6 Copies

Fee Lease - 5 Copies

☐ AMENDED REPORT

OIL CONSERVATION DIVISION

P.O. Box 2088

Santa Fe, New Mexico 87504-2088

APPLICATION FOR PERMIT TO DRILL, RE-ENTER, DEEPEN, PLUGBACK, OR ADD A ZONE

¹ Operator Name and Address

TEXACO EXPLORATION & PRODUCTION INC.

P.O. Box 3109, Midland Texas 79702

² OGRID Number

022351

³ API Number

31-025-22475

⁴ Property Code

10960

⁵ Property Name

HARRISON, B. F. 'B'

⁶ Well No.

23

⁷ Surface Location

Ul or lot no.	Section	Township	Range	Lot.Idn	Feet From The	North/South Line	Feet From The	East/West Line	County
F	9	23-S	37-E		1815	NORTH	1815	WEST	LEA

⁸ Proposed Bottom Hole Location If Different From Surface

Ul or lot no.	Section	Township	Range	Lot.Idn	Feet From The	North/South Line	Feet From The	East/West Line	County

⁹ Proposed Pool 1

UNDESIGNATED DRINKARD

<5838D>

¹⁰ Proposed Pool 2

UNDESIGNATED ABO

<94.034>

¹¹ Work Type Code

N

¹² WellType Code

M

¹³ Rotary or C.T.

R

¹⁴ Lease Type Code

P

¹⁵ Ground Level Elevation

3313'

¹⁶ Multiple

Yes

¹⁷ Proposed Depth

7000'

¹⁸ Formation

DRINKARD/ABO

¹⁹ Contractor²⁰ Spud Date

5/15/94

²¹ Proposed Casing and Cement Program

SIZE OF HOLE	SIZE OF CASING	WEIGHT PER FOOT	SETTING DEPTH	SACKS OF CEMENT	EST. TOP
12 1/4	9 5/8	36#	1180'	550	SURFACE
8 3/4	7	20# & 23#	7000'	2300	SURFACE

²² Describe the proposed program. If this application is to DEEPEN or PLUG BACK give the data on the present productive zone and proposed new productive zone. Describe the blowout prevention program, if any. Use additional sheets if necessary.

CEMENTING PROGRAM:

SURFACE CASING - 350 SACKS CLASS C w/ 4% GEL, 2% CACL2 (13.5 PPG, 1.74 CF/S, 9.11 GW/S). F/B 200 SACKS CLASS C w/ 2% CACL2 (14.8 PPG, 1.34 CF/S, 6.31 GW/S).

PRODUCTION CASING - 1550 SACKS 35/65 POZ CLASS H w/ 6% GEL, 5% SALT, 1/4# FLOCELE (12.8 PPG, 1.94 CF/S, 10.4 GW/S). F/B 750 SACKS 50/50 POZ CLASS H w/ 2% GEL, 5% SALT, 1/4# FLOCELE (14.2 PPG, 1.35 CF/S, 6.3 GW/S).

OXY OPERATES A WELL IN THIS QUARTER QUARTER SECTION AND HAS BEEN FURNISHED A COPY OF THIS APPLICATION.

²³ I hereby certify that the rules and regulations of the Oil Conservation Division have been complied with and that the information given above is true and complete to the best of my knowledge and belief.

Signature

C.P. Basham / SDH

Printed Name C. P. Basham

Title Drilling Operations Mgr.

Date 4/25/94

Telephone 688-4620

OIL CONSERVATION DIVISION

Approved By:

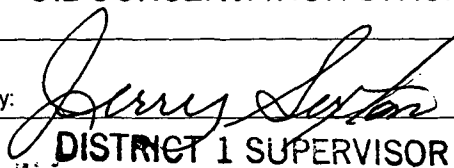

Title:

DISTRICT 1 SUPERVISOR

Approval Date: APR 27 1994

Expiration Date:

Conditions of Approval:

Attached ☐

OIL CONSERVATION DIVISION

P.O. Box 2088
Santa Fe, New Mexico 87504-2088

DISTRICT I
P.O. Box 1980, Hobbs, NM 88240

DISTRICT II
P.O. Drawer DD, Artesia, NM 88210

DISTRICT III
1000 Rio Brazos Rd., Aztec, NM 87410

WELL LOCATION AND ACREAGE DEDICATION PLAT

All Distances must be from the outer boundaries of the section

Operator TEXACO EXPL. AND PROD. Inc.			Lease B.F. Harrison "B"		Well No. 23
Unit Letter F	Section 9	Township -23-South	Range -37-East	County NMPM	Lea
Actual Footage Location of Well: 1815 feet from the North line and 1815 feet from the West line					
Ground level Elev. 3313	Producing Formation Drinkard: Abo		Pool Undesignated, Drinkard & Abo	Dedicated Acreage: 40 Acres	

- Outline the acreage dedicated to the subject well by colored pencil or hatchure marks on the plat below.
- If more than one lease is dedicated to the well, outline each and identify the ownership thereof (both as to working interest and royalty).
- If more than one lease of different ownership is dedicated to the well, have the interest of all owners been consolidated by communitization, unitization, force-pooling, etc.?
☐ Yes ☐ No If answer is "yes" type of consolidation _____
If answer is "no" list the owners and tract descriptions which have actually been consolidated. (Use reverse side of this form if necessary).
No allowable will be assigned to the well until all interests have been consolidated (by communitization, unitization, forced-pooling, or otherwise) or until a non-standard unit, eliminating such interest, has been approved by the Division.

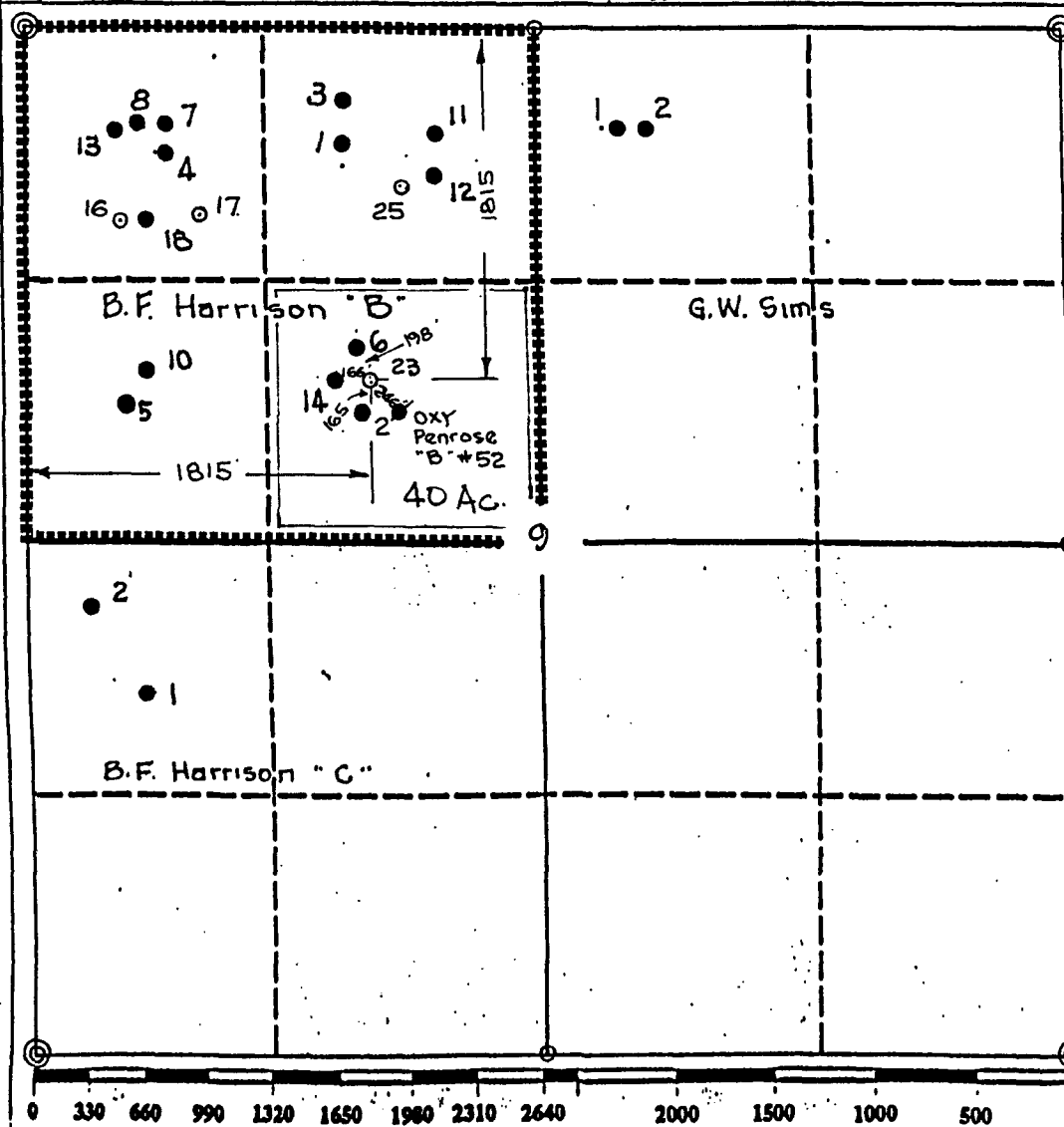

OPERATOR CERTIFICATION

I hereby certify that the information contained herein is true and complete to the best of my knowledge and belief.

Signature
Royce D. Mariott

Printed Name
Royce D. Mariott

Position
Division Surveyor

Company
Texaco Expl. & Prod.

Date
April 18, 1994

SURVEYOR CERTIFICATION

I hereby certify that the well location shown on this plat was plotted from field notes of actual surveys made by me or under my supervision, and that the same is true and correct to the best of my knowledge and belief.

Date Surveyed
April 11, 1994

Signature & Seal of
Professional Surveyor

John S. Piper

Certificate No.
7253 John S. Piper

Lea Co. FB. 10, Pg. 42

**DRILLING CONTROL
CONDITION II-B 3000 WP
FOR AIR DRILLING OR
WHERE NITROGEN OR AIR BLOWS ARE EXPECTED**

H₂S TRIM REQUIRED
YES X NO

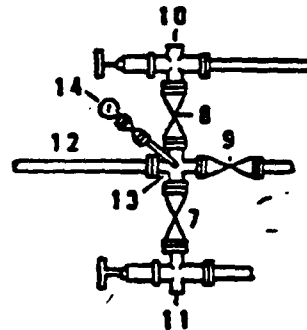
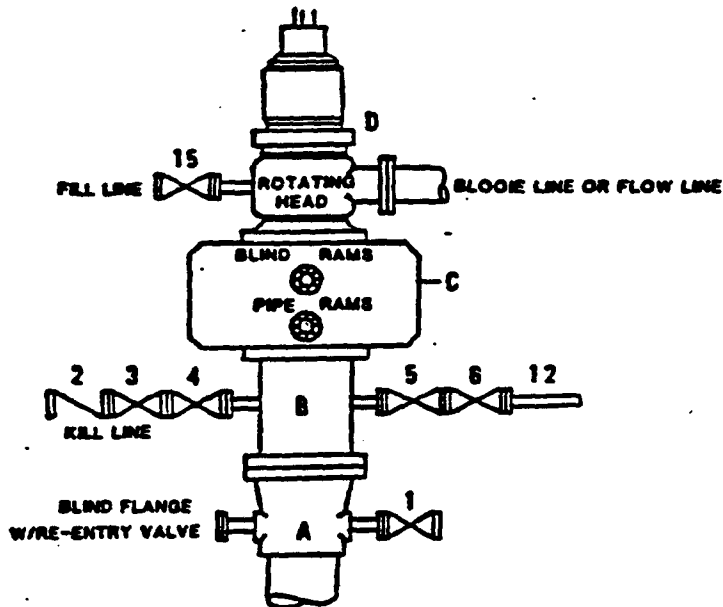

DRILLING CONTROL

MATERIAL LIST - CONDITION II - B

- A Texaco Wellhead
- B 3000# W.P. drilling spool with a 2" minimum flanged outlet for kill line and 3" minimum flanged outlet for choke line.
- C 3000# W.P. Dual ram type preventer, hydraulic operated with 1" steel, 3000# W.P. control lines (where sub-structure height is adequate, 2 - 3000# W.P. single ram type preventers may be utilized).
- D Rotating Head with fill up outlet and extended Bleed Line.
- 1,3,4, 7,8, 2" minimum 3000# W.P. flanged full opening steel gate valve, or Halliburton Lo Torc Plug valve.
- 2 2" minimum 3000# W.P. back pressure valve.
- 5,6,9 3" minimum 3000# W.P. flanged full opening steel gate valve, or Halliburton Lo Torc Plug valve.
- 12 3" minimum schedule 80, Grade "B", seamless line pipe.
- 13 2" minimum x 3" minimum 3000# W.P. flanged cross.
- 10,11 2" minimum 3000# W.P. adjustable choke bodies.
- 14 Cameron Mud Gauge or equivalent (location optional in choke line).
- 15 2" minimum 3000# W.P. flanged or threaded full opening steel gate valve, or Halliburton Lo Torc Plug valve.



TEXACO, INC.
MIDLAND DIVISION
MIDLAND, TEXAS



SCALE	DATE	EST. NO.	ORD. NO.
DRAWN BY			
CHECKED BY			
APPROVED BY			

EXHIBIT C

WRS COMPLETION REPORTCOMPLETIONS SEC 9 TWP 23S RGE 37E
PI# 30-T-0042 03/03/95 30-025-32498-0000 PAGE 1NMEX LEA * 1815FNL 1815FWL SEC SE NW
STATE COUNTY FOOTAGE SPOTTEXACO EXPL & PROD D DO
OPERATOR WELL CLASS INIT FIN

23 HARRISON B F "B"

WELL NO. LEASE NAME

3325KB 3313GR

TEAGUE N

OPER ELEV

FIELD/POOL/AREA

API 30-025-32498-0000

LEASE NO.

PERMIT OR WELL I.D. NO.

07/19/1994 12/19/1994 ROTARY VERT 2 OIL

SPUD DATE COMP. DATE TYPE TOOL HOLE TYPE STATUS

7000 ABO PETERSON DRLG 2 RIG SUB 11

PROJ. DEPTH PROJ. FORM CONTRACTOR

DTD 7150 PB 7083 FM/TD ABO

DRILLERS T.D. LOG T.D. PLUG BACK TD OLD T.D. FORM T.D.

LOCATION DESCRIPTION

8 MI S EUNICE, NM

CASING/LINER DATACSG 9 5/8 @ 1180 W/ 550 SACKS
CSG 7 @ 7150 W/ 3050 SACKS**TUBING DATA**

TBG 2 1/16 AT 5576 2 3/8 AT 6360

INITIAL POTENTIALIPF 50BOPD 73 MCFD 3BW 32/64CK 24HRS
BLINEBRY PERF W/ 104/IT 5606- 5816

TP 100

GTY 43.5 GOR 1460

FIELD

/RESERVOIR

/BLINEBRY

FLWD 10 BOPD, 373 MCFD, 180 BLW 24/64 CK, 24 HRS

FCP: PKR

IPF 111BOPD 470 MCFD 1BW 30/64CK 24HRS

DRINKARD PERF W/ 102/IT 6389- 6545 GROSS

ABO PERF W/ 88/IT 6612- 7001 GROSS

TP 250

GTY 40.1 GOR 4234

FIELD

/RESERVOIR

/ABO

CONTINUED IC# 300257019594

COPYRIGHT 1994

**Petroleum Information
Corporation**PI-WRS-GET
Form No 187

COMPLETION
PI# 30-T

COMPLETIONS SEC 9 TWP 23S RGE 37E
PI# 30-T-0042 03/03/95 30-025-32498-0000 PAGE 2

TEXACO EXPL & PROD D DO
23 HARRISON B F "B"

INITIAL POTENTIAL

FLWD 139 BOPD, 594 MCFD, 3 BLW 25/64 CK, 24 HRS
FCP: PKR
COMMINGLED

TYPE	FORMATION	LTH	TOP	DEPTH/SUB	BSE	DEPTH/SUB
LOG	RUSTLER		1112	2213		
LOG	SALT		1211	2114	2449	876
LOG	YATES		2600	725		
LOG	SVN RVRS		2940	385		
LOG	QUEEN		3316	9		
LOG	GRAYBURG		3657	-332		
LOG	SN ANDRS		4010	-685		
LOG	GLORIETA		5030	-1705		
LOG	PADDOCK		5239	-1914		
LOG	BLINEBRY		5558	-2233		
LOG	TUBB		6076	-2751		
LOG	DRINKARD		6328	-3003		
LOG	ABO		6590	-3265		

SUBSEA MEASUREMENTS FROM KB

PRODUCTION TEST DATA

PTF	71BOPD	405	MCFD		17/64CK	24HRS
ABO	PERF		W/	88/IT	6612-	7001 GROSS
PERF	6612- 6618	6620- 6625	6683- 6693	6698- 6708		
PERF	6718- 6720	6748- 6750	6807- 6809	6816- 6816		
PERF	6823- 6827	6846- 6848	6852- 6854	6868- 6871		
PERF	6882- 6884	6900- 6903	6906- 6914	6917- 6926		
PERF	6958- 6962	6966- 6970	6984- 6987	6990- 6992		
PERF	6996- 7001					
ACFR	6612- 7001	15000GALS				

ADDTVC02

20% HCL
CP 540
FLWD 71 BOPD, 405 MCFD, 39 BLW, 17/64 CK, 24 HRS

PTF	88BOPD	478	MCFD		20/64CK	24HRS
ABO	PERF			6612-	7001 GROSS	
	CP 400					

FLWD 88 BOPD, 478 MCFD, 27 BLW, 20/64 CK, 24 HRS

CONTINUED

COMPLETIONS SEC 9 TWP 23S RGE 37E
PI# 30-T-0042 03/03/95 30-025-32498-0000 PAGE 3

TEXACO EXPL & PROD D DO
23 HARRISON B F "B"

PRODUCTION TEST DATA

PTF 69BOPD 445 MCFD 20/64CK 24HRS
ABO PERF 6612- 7001 GROSS
CP 275

PTF 68BOPD 551 MCFD 20/64CK 24HRS
ABO PERF 6612- 7001 GROSS
CP 250

PTF 559 MCFD 20/64CK 24HRS
ABO PERF 6612- 7001 GROSS
CP 225

PTF 60BOPD 598 MCFD 6BW 24HRS
ABO PERF 6612- 7001 GROSS

PTS 18BO 9HRS
DRINKARD PERF W/ 102/IT 6389- 6545 GROSS
PERF 6389- 6392 6399- 6401 6407- 6410 6418- 6424
PERF 6446- 6451 6469- 6471 6483- 6487 6492- 6496
PERF 6505- 6512 6515- 6522 6525- 6528 6533- 6536
PERF 6543- 6545
ACID 6389- 6545 2500GALS
15% HCL
SWFR 6389- 6545 51051GALS 121357LBS SAND
SWBD 18 BO, 144 BLW, 9 HRS

PTF 66BO 21/64CK 21HRS
DRINKARD PERF 6389- 6545 GROSS
ABO PERF 6612- 7001 GROSS
TP 110
FLWD 66 BO, 20 BLW, 21/64 CK, 21 HRS
COMMINGLED

PTF 70BOPD 252 MCFD 21/64CK 24HRS
DRINKARD PERF 6389- 6545 GROSS
ABO PERF 6612- 7001 GROSS
TP 90
FLWD 70 BOPD, 252 MCFD, 4 BLW, 21/64 CK, 24 HRS
COMMINGLED

PTS 4BO 8HRS
BLINEBRY PERF W/ 104/IT 5606- 5816

CONTINUED

COMPLETIONS SEC 9 TWP 23S RGE 37E
PI# 30-T-0042 03/03/95 30-025-32498-0000 PAGE 4

TEXACO EXPL & PROD D DO
23 HARRISON B F "B"

PRODUCTION TEST DATA

PERF 5606- 5816
SWBD 4 BO, 8 BLW 8 HRS

PTP 36BOPD 24HRS
BLINEBRY PERF 5606- 5816
ACID 5606- 5816 2500GALS
15% HCL
SWFR 5606- 5816 148100GALS 148000LBS SAND
PPD 36 BOPD, 35 BLW 24 HRS

LOGS AND SURVEYS /INTERVAL,TYPE/

LOGS	GR	DLL	MSFL
LOGS	CSNG	SDL	DSN

DRILLING MEDIA /TYPE,DEPTH/

4615 10.0 PPG

DRILLING PROGRESS DETAILS

TEXACO EXPL & PROD
BOX 3109
MIDLAND, TX 79702
915-688-4100
04/27 LOC/1994/
07/22 1180 TD, PREP/DOC
07/27 DRLG 4615
08/05 7150 TD, PB 7083, WOCT
08/19 7150 TD, PB 7083, FLWG LD
09/01 7150 TD, PB 7083, FLWG
09/23 7150 TD, PB 7083, SI
09/30 7150 TD, PB 7083, SWBG
10/07 7150 TD, PB 7083, FLWG LD
11/18 7150 TD, PB 7083, SI
12/08 7150 TD, PB 7083, SWBG LD
12/15 7150 TD, PB 7083, PPG
12/21 7150 TD, PB 7083, WOPT
01/17 7150 TD, PB 7083, WO STATE FORMS
02/27 RIG REL 08/04/94
7150 TD, PB 7083
COMP 12/19/94, IPF 50 BO, 73 MCFGPD, 3

CONTINUED

COMPLETIONS . SEC 9 TWP 23S RGE 37E
PI# 30-T-0042 03/03/95 30-025-32498-0000 PAGE 5

TEXACO EXPL & PROD
23 HARRISON B F "B"

D DO

DRILLING PROGRESS DETAILS

BWPD, 32/64 CK, GTY 43.5,
GOR 1460, FTP 100, FCP PKR
PROD ZONE - BLINBRY 5606-5816
COMP 10/26/94, IPF 111 BO, 470 MCFGPD, 1
BWPD, 30/64 CK, GTY 40.1,
GOR 4234, FTP 250, FCP PKR
PROD ZONE - ABO 6389-7001 (GROSS)
(COMMINGLED)
(DUAL PRODUCER)
NO CORES OR TESTS RPTD

**STATE OF NEW MEXICO
ENERGY, MINERALS, AND NATURAL RESOURCES DEPARTMENT
OIL CONSERVATION DIVISION**

**IN THE MATTER OF THE HEARING
CALLED BY THE OIL CONSERVATION
DIVISION FOR THE PURPOSE OF
CONSIDERING:**

**NOMENCLATURE
CASE NO. 11017
Order No. R-5353-Q**

**APPLICATION OF TEXACO EXPLORATION
AND PRODUCTION INC. FOR POOL RE-
CLASSIFICATION, POOL EXPANSION, THE
PROMULGATION OF SPECIAL POOL RULES,
AND THE FURTHER AMENDMENT OF DIVISION
ORDER NO. R-5353, LEA COUNTY, NEW
MEXICO.**

ORDER OF THE DIVISION

BY THE DIVISION:

This cause came on for hearing at 8:15 a.m. on July 7, 1994, at Santa Fe, New Mexico, before Examiner David R. Catanach.

NOW, on this 26th day of September, 1994, the Division Director, having considered the testimony, the record, and the recommendations of the Examiner, and being fully advised in the premises,

FINDS THAT:

(1) Due public notice having been given as required by law, the Division has jurisdiction of this cause and the subject matter thereof.

(2) Division Case Nos. 11016, 11017 and 11018 were consolidated at the time of the hearing for the purpose of testimony.

(3) The applicant, Texaco Exploration and Production Inc., seeks the reclassification of the North Teague Lower Paddock-Blinbry Gas Pool, Lea County, New Mexico, as an "associated pool", and to adopt the "General Rules and Regulations for the Associated Oil and Gas Pools in Northwest and Southeast New Mexico", as promulgated by Division Order No. R-5353, as amended, as the rules governing this pool, including provisions for 40-acre oil and 160-acre gas spacing and proration units. The applicant further seeks to establish a limiting gas-oil ratio of 6,000 cubic feet of gas per barrel of oil for this pool.

(4) The applicant further seeks to expand the horizontal limits of the proposed pool to include the NE/4 of Section 8 and the SW/4 of Section 9, all in Township 23 South, Range 37 East, NMPM.

(5) The North Teague-Blinebry Gas Pool was created by Division Order No. R-9646 on March 11, 1992. The discovery well for the pool was the Texaco Exploration and Production Inc. B. F. Harrison "B" Well No. 5 located 1950 feet from the North line and 560 feet from the West line (Unit E) of Section 9, Township 23 South, Range 37 East, NMPM, which was completed in the Blinebry formation in October, 1991.

(6) By Order No. R-9937 dated August 17, 1993, the Division extended the vertical limits of the North Teague-Blinebry Gas Pool to include the Lower Paddock formation and redesignated the pool as the North Teague Lower Paddock-Blinebry Gas Pool.

(7) The North Teague Lower Paddock-Blinebry Gas Pool currently comprises the N/2 of Section 9, Township 23 South, Range 37 East, NMPM.

(8) The North Teague Lower Paddock-Blinebry Gas Pool is offset to the northeast by the West Blinebry Pool, an oil pool whose vertical limits include the Blinebry and Lower Paddock formations and whose horizontal limits include the SW/4 and N/2 of Section 3.

(9) The North Teague Lower Paddock-Blinebry Gas Pool is also offset to the south and southeast by the Teague-Blinebry Pool, an oil pool whose northern boundary comprises the NE/4 of Section 17.

(10) Texaco proposes to develop the Lower Paddock-Blinebry oil and gas reserves within this area concurrently and in conjunction with the development of the oil and gas reserves within the Tubb formation (being the subject of Division Case No. 11016), and the Drinkard-Abo formations (being the subject of Division Case No. 11018).

(11) The applicant currently has four wells producing from the Blinebry formation in this immediate area, these being:

the aforesaid B. F. Harrison "B" Well No. 5 located in Unit E of Section 9 which was completed in the Blinebry formation in October, 1991;

the B. F. Harrison "C" Well No. 1 located in Unit L of Section 9 which was completed in the Blinebry formation in July, 1993;

the F. B. Davis Well No. 3 located in Unit H of Section 8 which was completed in the Blinebry formation in January, 1994; and

the G. W. Sims Well No. 3 located in Unit B of Section 9 which was completed in the Blinebry formation in January, 1994.

(12) According to Division records, the B. F. Harrison "C" Well No. 1, the F. B. Davis Well No. 3, and the G. W. Sims Well No. 3 are currently classified as being in the Teague-Blinebry Pool, although to date the Division has not extended the pool boundaries of the Teague-Blinebry Pool to include this acreage.

(13) Texaco's proposal would place the four wells described in Finding No. (11) above within the redesignated pool.

(14) The applicant presented geologic evidence and testimony to support its request for pool reclassification and extension. This evidence indicates that the proposed Lower Paddock-Blinebry pool is:

- a) a circular shaped feature of limited extent draped over a structural high centered approximately in the NW/4 of Section 9. The trap of the reservoir is formed by a down structural limit of effective porosity within the Blinebry formation;
- b) a single structure feature geologically separated from the Teague-Blinebry Pool; and,
- c) a single common source of supply separated from and not in communication with any other Blinebry pool in this area as evidenced by bottomhole pressure buildup data which indicated original reservoir pressure following initial discovery.

(15) The geologic evidence further indicates that the B. F. Harrison "C" Well No. 1, the F. B. Davis Well No. 3, and the G. W. Sims Well No. 3 should be placed within the proposed Lower Paddock-Blinebry pool.

(16) It has become the recent practice of the Division to include the Lower Paddock formation within Blinebry pools in this area as evidenced by the recent extension of the North Teague-Blinebry Gas Pool, the Cline-Blinebry Pool and the West-Blinebry Pool to include the Lower Paddock formation (all extensions approved by Division Order No. R-9937).

(17) According to applicant's testimony, there is potential for Lower Paddock production in its wells in this area.

(18) Should the North Teague Lower Paddock-Blinebry Gas Pool be reclassified, the Lower Paddock formation should remain included within the vertical limits of the pool.

(19) Production data presented by the applicant indicates that the B. F. Harrison "C" Well No. 1, the F. B. Davis Well No. 3, and the G. W. Sims Well No. 3 exhibit production characteristics indicative of oil wells while the B. F. Harrison "B" Well No. 5 exhibits production characteristics indicative of a gas well.

(20) Although the B. F. Harrison "B" Well No. 5 is approximately 20 feet up-structure from the nearest oil well, there is no indication that a gas cap exists or is being formed up-structure to the oil wells.

(21) The applicant contends that the occurrence of increased volumes of gas production in the B. F. Harrison "B" Well No. 5 is attributed to the presence of small higher porosity stringers in the Blinebry formation which are both laterally and horizontally discontinuous.

(22) "Associated pools" have historically been defined as those pools that have a gas cap overlying an oil zone.

(23) Although the proposed pool does not exhibit the reservoir characteristics of an "associated pool", it appears to exhibit similar reservoir characteristics as found in the Blinebry Oil and Gas Pool and the Tubb Oil and Gas Pool, namely it is a complex reservoir system of interrelated gas-bearing and oil-bearing stringers.

(24) The proposed pool is located approximately 2 1/2 miles south of the southern boundary of the Blinebry Oil and Gas Pool.

(25) Although not officially classified as "associated pools", the Blinebry Oil and Gas Pool and the Tubb Oil and Gas Pool are both essentially governed by the same rules applicable to "associated pools" as contained within Division Order No. R-5353, as amended, namely 40-acre oil and 160-acre gas spacing, a gas/oil ratio cutoff point in distinguishing between gas wells and oil wells of 50,000 cubic feet of gas per barrel of oil and restricted well location requirements.

(26) The reservoir data currently available indicates that the North Teague-Blinebry Gas Pool should be reclassified as an "associated pool" and should be governed by the "General Rules and Regulations for the Associated Oil and Gas Pools of Northwest and Southeast New Mexico".

(27) The subject pool should be designated the North Teague-Lower Paddock-Blinebry Associated Pool and should initially comprise the N/2 and SW/4 of Section 9, and the NE/4 of Section 8, both in Township 23 South, Range 37 East, NMPM.

(28) The preliminary reservoir data indicates that the North Teague Lower Paddock-Blinebry Associated Pool may be efficiently and effectively developed on 40-acre oil and 160-acre gas spacing. In addition, the evidence indicates that a gas-oil ratio limitation of 6,000 cubic feet of gas per barrel of oil should be established for a temporary period of time, pending the gathering of additional reservoir data.

(29) The North Teague Lower Paddock-Blinebry Associated Pool should be governed by the "General Rules and Regulations for the Associated Oil and Gas Pools of Northwest and Southeast New Mexico", as promulgated by Division Order No. R-5353, as amended, for a temporary period of eighteen months to permit Texaco the opportunity to gather additional reservoir data. This case should be reopened at an examiner hearing in March, 1996, at which time the operators in the subject pool should be prepared to appear and show cause why the North Teague Lower Paddock-Blinebry Associated Pool should not be reclassified as an oil pool and to show cause why a gas-oil ratio limitation of 6,000 cubic feet of gas per barrel of oil is appropriate for this pool.

(30) At the hearing the applicant requested that the rules and regulations promulgated herein be made effective retroactive to March 11, 1992, being the date of the issuance of Division Order No. R-9646, which order created the North Teague-Blinebry Gas Pool.

(31) The applicant presented no evidence or testimony which would indicate that a retroactive effective date for the special rules promulgated herein is necessary, therefore this request should be denied.

IT IS THEREFORE ORDERED THAT:

(1) The North Teague Lower Paddock-Blinebry Gas Pool, which currently comprises the N/2 of Section 9, Township 23 South, Range 37 East, NMPM, Lea County, New Mexico, is hereby reclassified as an "associated pool" and redesignated the North Teague Lower Paddock-Blinebry Associated Pool.

(2) The North Teague Lower Paddock-Blinebry Associated Pool is hereby extended to include the NE/4 of Section 8, and the SW/4 of Section 9, both in Township 23 South, Range 37 East, NMPM.

(3) The North Teague Lower Paddock-Blinebry Associated Pool shall be governed by the "General Rules and Regulations for the Associated Oil and Gas Pools in Northwest and Southeast New Mexico", as promulgated by Division Order No. R-5353, as amended, insofar as said General Rules and Regulations are not inconsistent with the Special Rules and Regulations for the subject pool as hereinafter set forth, in which event the Special Rules shall apply.

**TEMPORARY SPECIAL RULES AND REGULATIONS FOR THE
NORTH TEAGUE LOWER PADDOCK-BLINEBRY ASSOCIATED POOL**

RULE 2 (a). A standard oil proration unit shall comprise 40 acres. A standard gas proration unit shall comprise 160 acres. Top oil allowable for a 40-acre oil proration unit shall be 107 barrels of oil per day.

RULE 6. The limiting gas-oil ratio for the North Teague Lower Paddock-Blinebry Associated Pool shall be 6,000 cubic feet of gas per barrel of oil.

IT IS FURTHER ORDERED THAT:

(4) The location of all wells presently drilling to or completed in the North Teague Lower Paddock-Blinebry Associated Pool or in the Lower Paddock-Blinebry formation within one mile thereof are hereby approved; the operator of any well having an unorthodox location shall notify the Hobbs District Office of the Division in writing of the name and location of the well within 30 days from the date of this order.

Pursuant to Paragraph A of Section 70-2-18, N.M.S.A. 1978 Comp., contained in Laws of 1969, Chapter 271, existing oil wells in the North Teague Lower Paddock-Blinebry Associated Pool shall have dedicated thereto 40 acres and existing gas wells shall have dedicated thereto 160 acres in accordance with the foregoing pool rules; or, pursuant to Paragraph C of said Section 70-2-18, existing wells may have non-standard spacing or proration units established by the Division and dedicated thereto.

Failure to file new Forms C-102 with the Division dedicating the appropriate acreage to a well or to obtain a non-standard unit approved by the Division within 60 days from the date of this order shall subject the well to cancellation of allowable until a non-standard spacing unit has been approved and, subject to said 60-day limitation, each well presently drilling to or completed in the North Teague Lower Paddock-Blinebry Associated Pool or in its corresponding vertical limits, or within one mile thereof, shall receive no more than a 40-acre allowable for the pool.

(5) This case shall be reopened at an examiner hearing in March, 1996, at which time the operators in the subject pool should be prepared to appear and show cause why the North Teague Lower Paddock-Blinebry Associated Pool should not be reclassified as an oil pool and to show cause why a gas-oil ratio limitation of 6,000:1 is appropriate for this pool.

(6) Jurisdiction of this cause is retained for the entry of such further orders as the Division may deem necessary.

CASE NO. 11017
ORDER NO. R-5353-Q
Page -7-

DONE at Santa Fe, New Mexico, on the day and year hereinabove designated.

STATE OF NEW MEXICO
OIL CONSERVATION DIVISION

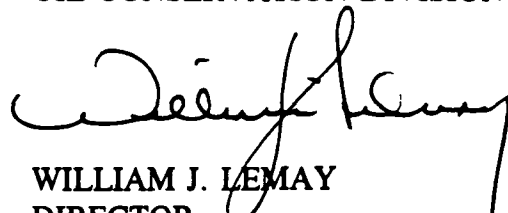

WILLIAM J. LEMAY
DIRECTOR

S E A L

**STATE OF NEW MEXICO
ENERGY, MINERALS, AND NATURAL RESOURCES DEPARTMENT
OIL CONSERVATION DIVISION**

**IN THE MATTER OF THE HEARING
CALLED BY THE OIL CONSERVATION
DIVISION FOR THE PURPOSE OF
CONSIDERING:**

**CASE NO. 11017 (Reopened)
Order No. R-5353-Q-1**

**IN THE MATTER OF CASE NO. 11017 BEING
REOPENED PURSUANT TO THE PROVISIONS
OF DIVISION ORDER NO. R-5353-Q, WHICH
ORDER RECLASSIFIED AND PROMULGATED
SPECIAL RULES AND REGULATIONS FOR THE
NORTH TEAGUE LOWER PADDOCK-BLINEBRY
ASSOCIATED POOL, LEA COUNTY, NEW MEXICO.**

ORDER OF THE DIVISION

BY THE DIVISION:

This cause came on for hearing at 8:15 a.m. on May 16, 1996, at Santa Fe, New Mexico, before Examiner David R. Catanach.

NOW, on this 30th day of May, 1996, the Division Director, having considered the testimony, the record, and the recommendations of the Examiner, and being fully advised in the premises,

FINDS THAT:

(1) Due public notice having been given as required by law, the Division has jurisdiction of this cause and the subject matter thereof.

(2) Case Nos. 11016 (Reopened), 11017 (Reopened) and 11018 (Reopened) were consolidated at the time of the hearing for the purpose of testimony.

(3) By Order No. R-5353-Q entered in Case No. 11017 on September 26, 1994, the Division, upon application of Texaco Exploration & Production Inc.:

- a) reclassified the North Teague Lower Paddock-Blinebry Gas Pool as an "associated pool" and redesignated the pool as the North Teague Lower Paddock-Blinebry Associated Pool. As an "associated pool" the North Teague Lower Paddock-Blinebry Associated Pool was to be governed by the General Rules and Regulations for the Associated Oil and Gas Pools of Northwest and Southeast New Mexico, as promulgated by Division Order No. R-5353, as amended; and,
- b) promulgated Temporary Special Rules and Regulations for the North Teague Lower Paddock-Blinebry Associated Pool including 40-acre oil spacing and 160-acre gas spacing, and a limiting gas-oil ratio of 6,000 cubic feet of gas per barrel of oil.

(4) Pursuant to the requirements of Order No. R-5353-Q, this case was reopened to allow the operators in the subject pool to appear and present evidence and testimony as to whether the North Teague Lower Paddock-Blinebry Associated Pool should remain classified as an "associated pool" and whether the limiting gas-oil ratio for the pool should remain at 6,000 cubic feet of gas per barrel of oil.

(5) Texaco Exploration & Production Inc., one of two current operators in the pool, appeared and presented evidence and testimony to support its request that the Temporary Special Rules and Regulations for the North Teague Lower Paddock-Blinebry Associated Pool be made permanent.

(6) The North Teague Lower Paddock-Blinebry Associated Pool currently comprises the following described area in Lea County, New Mexico:

TOWNSHIP 23 SOUTH, RANGE 37 EAST, NMPM

Section 4: S/2

Section 8: NE/4

Section 9: N/2, SW/4

(7) There are nine wells currently producing from the North Teague Lower Paddock-Blinebry Associated Pool, eight of which are operated by Texaco Exploration & Production Inc.

(8) The engineering evidence and testimony presented by Texaco Exploration & Production Inc. in this case indicates that:

- a) the horizontal extent of the reservoir has essentially been defined by development;
- b) although the North Teague Lower Paddock-Blinebry Associated Pool is a solution gas drive reservoir with no apparent gas cap, the producing characteristics of the pool are such that it is appropriate to permanently classify the pool as an "associated pool"; and,
- c) continued production at a gas-oil ratio limitation of 6,000 cubic feet of gas per barrel of oil should not decrease ultimate oil recovery from the pool.

(9) Samedan Oil Corporation, the only other operator in the pool, did not appear at the hearing either in support of or in opposition to the continuation of the current pool classification and limiting gas-oil ratio.

(10) The evidence and testimony presented by Texaco Exploration & Production Inc. in this case indicates that the continued classification of the North Teague Lower Paddock-Blinebry Associated Pool as an "associated pool" is appropriate and continued production at a gas-oil ratio limitation of 6,000 cubic feet of gas per barrel of oil should not decrease ultimate oil recovery and should otherwise not be detrimental to the reservoir.

(11) The Temporary Special Rules and Regulations for the North Teague Lower Paddock-Blinebry Associated Pool should be made permanent.

IT IS THEREFORE ORDERED THAT:

(1) The classification of the North Teague Lower Paddock-Blinebry Associated Pool as an "associated pool" is hereby made permanent. The North Teague Lower Paddock-Blinebry Associated Pool shall be governed by the General Rules and Regulations for the Associated Oil and Gas Pools of Northwest and Southeast New Mexico, as promulgated by Division Order No. R-5353, as amended, insofar as said General Rules and Regulations are not inconsistent with the special rules and regulations for the subject pool.

CASE NO. 11017 (Reopened)

Order No. R-5353-Q-1

Page -4-

(2) The Temporary Special Rules and Regulations for the North Teague Lower Paddock-Blinbry Associated Pool, as promulgated by Division Order No. R-5353-Q, are hereby continued in full force and effect until further order of the Division.

(3) Jurisdiction is hereby retained for the entry of such further orders as the Division may deem necessary.

DONE at Santa Fe, New Mexico, on the day and year hereinabove designated.

STATE OF NEW MEXICO
OIL CONSERVATION DIVISION

by  Deputy Director

WILLIAM J. LEMAY
Director

S E A L