

DATE IN <b>5-19-04</b>	SUSPENSE	ENGINEER <b>Jones</b>	LOGGED IN <b>5-20-04</b>	TYPE <b>SWD</b>	APP NO. <b>PSEM0414129586</b>
------------------------	----------	-----------------------	--------------------------	-----------------	-------------------------------

ABOVE THIS LINE FOR DIVISION USE ONLY

RECEIVED

**NEW MEXICO OIL CONSERVATION DIVISION**

- Engineering Bureau -

1220 South St. Francis Drive, Santa Fe, NM 87505



MAY 19 2004

OIL CONSERVATION  
DIVISION

**ADMINISTRATIVE APPLICATION CHECKLIST**

THIS CHECKLIST IS MANDATORY FOR ALL ADMINISTRATIVE APPLICATIONS FOR EXCEPTIONS TO DIVISION RULES AND REGULATIONS WHICH REQUIRE PROCESSING AT THE DIVISION LEVEL IN SANTA FE

**Application Acronyms:**

**[NSL-Non-Standard Location] [NSP-Non-Standard Proration Unit] [SD-Simultaneous Dedication]**  
**[DHC-Downhole Commingling] [CTB-Lease Commingling] [PLC-Pool/Lease Commingling]**  
**[PC-Pool Commingling] [OLS - Off-Lease Storage] [OLM-Off-Lease Measurement]**  
**[WFX-Waterflood Expansion] [PMX-Pressure Maintenance Expansion]**  
**[SWD-Salt Water Disposal] [IPI-Injection Pressure Increase]**  
**[EOR-Qualified Enhanced Oil Recovery Certification] [PPR-Positive Production Response]**

**[1] TYPE OF APPLICATION - Check Those Which Apply for [A]**

**[A] Location - Spacing Unit - Simultaneous Dedication**  
☐ NSL ☐ NSP ☐ SD

Check One Only for [B] or [C]

**[B] Commingling - Storage - Measurement**  
☐ DHC ☐ CTB ☐ PLC ☐ PC ☐ OLS ☐ OLM

**[C] Injection - Disposal - Pressure Increase - Enhanced Oil Recovery**  
☐ WFX ☐ PMX ☒ SWD ☐ IPI ☐ EOR ☐ PPR

**[D] Other: Specify \_\_\_\_\_**

**[2] NOTIFICATION REQUIRED TO: - Check Those Which Apply, or ☐ Does Not Apply**

**[A] ☐ Working, Royalty or Overriding Royalty Interest Owners**

**[B] ☒ Offset Operators, Leaseholders or Surface Owner**

**[C] ☒ Application is One Which Requires Published Legal Notice**

**[D] ☒ Notification and/or Concurrent Approval by BLM or SLO**  
U.S. Bureau of Land Management - Commissioner of Public Lands, State Land Office

**[E] ☒ For all of the above, Proof of Notification or Publication is Attached, and/or,**

**[F] ☐ Waivers are Attached**

**[3] SUBMIT ACCURATE AND COMPLETE INFORMATION REQUIRED TO PROCESS THE TYPE OF APPLICATION INDICATED ABOVE.**

**[4] CERTIFICATION:** I hereby certify that the information submitted with this application for administrative approval is accurate and complete to the best of my knowledge. I also understand that no action will be taken on this application until the required information and notifications are submitted to the Division.

Note: Statement must be completed by an individual with managerial and/or supervisory capacity.

**GREGG T. RASMUSSEN**  
 Print or Type Name

Signature

Title

Date

**Ras @T3wireless.com**  
 e-mail Address

Case 13292

OBJECTION

Case 13292

**APPLICATION FOR AUTHORIZATION TO INJECT**

- I. PURPOSE: Secondary Recovery Pressure Maintenance X Disposal Storage  
Application qualifies for administrative approval? X Yes No
- II. OPERATOR: Platinum Exploration, Inc.  
ADDRESS: 550 West Texas, Suite 200, Midland, Texas 79701  
CONTACT PARTY: Gregg T. Rasmussen PHONE: (432) 687-1664
- III. WELL DATA: Complete the data required on the reverse side of this form for each well proposed for injection.  
Additional sheets may be attached if necessary.
- IV. Is this an expansion of an existing project? Yes X No  
If yes, give the Division order number authorizing the project: \_\_\_\_\_
- V. Attach a map that identifies all wells and leases within two miles of any proposed injection well with a one-half mile radius circle drawn around each proposed injection well. This circle identifies the well's area of review.
- VI. Attach a tabulation of data on all wells of public record within the area of review which penetrate the proposed injection zone. Such data shall include a description of each well's type, construction, date drilled, location, depth, record of completion, and a schematic of any plugged well illustrating all plugging detail.
- VII. Attach data on the proposed operation, including:
1. Proposed average and maximum daily rate and volume of fluids to be injected;
  2. Whether the system is open or closed;
  3. Proposed average and maximum injection pressure;
  4. Sources and an appropriate analysis of injection fluid and compatibility with the receiving formation if other than reinjected produced water; and,
  5. If injection is for disposal purposes into a zone not productive of oil or gas at or within one mile of the proposed well, attach a chemical analysis of the disposal zone formation water (may be measured or inferred from existing literature, studies, nearby wells, etc.).
- \*VIII. Attach appropriate geologic data on the injection zone including appropriate lithologic detail, geologic name, thickness, and depth. Give the geologic name, and depth to bottom of all underground sources of drinking water (aquifers containing waters with total dissolved solids concentrations of 10,000 mg/l or less) overlying the proposed injection zone as well as any such sources known to be immediately underlying the injection interval.
- IX. Describe the proposed stimulation program, if any.
- \*X. Attach appropriate logging and test data on the well. (If well logs have been filed with the Division, they need not be resubmitted).
- \*XI. Attach a chemical analysis of fresh water from two or more fresh water wells (if available and producing) within one mile of any injection or disposal well showing location of wells and dates samples were taken.
- XII. Applicants for disposal wells must make an affirmative statement that they have examined available geologic and engineering data and find no evidence of open faults or any other hydrologic connection between the disposal zone and any underground sources of drinking water.
- XIII. Applicants must complete the "Proof of Notice" section on the reverse side of this form.
- XIV. Certification: I hereby certify that the information submitted with this application is true and correct to the best of my knowledge and belief.
- NAME: Gregg T. Rasmussen TITLE: VP OPERATIONS  
SIGNATURE: Gregg T. Rasmussen DATE: 5/31/04  
E-MAIL ADDRESS: Ras@T3 wireless.com
- \* If the information required under Sections VI, VIII, X, and XI above has been previously submitted, it need not be resubmitted. Please show the date and circumstances of the earlier submittal: \_\_\_\_\_

### III. WELL DATA

- A. The following well data must be submitted for each injection well covered by this application. The data must be both in tabular and schematic form and shall include:
- (1) Lease name; Well No.; Location by Section, Township and Range; and footage location within the section.
  - (2) Each casing string used with its size, setting depth, sacks of cement used, hole size, top of cement, and how such top was determined.
  - (3) A description of the tubing to be used including its size, lining material, and setting depth.
  - (4) The name, model, and setting depth of the packer used or a description of any other seal system or assembly used.
- Division District Offices have supplies of Well Data Sheets which may be used or which may be used as models for this purpose. Applicants for several identical wells may submit a "typical data sheet" rather than submitting the data for each well.
- B. The following must be submitted for each injection well covered by this application. All items must be addressed for the initial well. Responses for additional wells need be shown only when different. Information shown on schematics need not be repeated.
- (1) The name of the injection formation and, if applicable, the field or pool name.
  - (2) The injection interval and whether it is perforated or open-hole.
  - (3) State if the well was drilled for injection or, if not, the original purpose of the well.
  - (4) Give the depths of any other perforated intervals and detail on the sacks of cement or bridge plugs used to seal off such perforations.
  - (5) Give the depth to and the name of the next higher and next lower oil or gas zone in the area of the well, if any.

### XIV. PROOF OF NOTICE

All applicants must furnish proof that a copy of the application has been furnished, by certified or registered mail, to the owner of the surface of the land on which the well is to be located and to each leasehold operator within one-half mile of the well location.

Where an application is subject to administrative approval, a proof of publication must be submitted. Such proof shall consist of a copy of the legal advertisement which was published in the county in which the well is located. The contents of such advertisement must include:

- (1) The name, address, phone number, and contact party for the applicant;
- (2) The intended purpose of the injection well; with the exact location of single wells or the Section, Township, and Range location of multiple wells;
- (3) The formation name and depth with expected maximum injection rates and pressures; and,
- (4) A notation that interested parties must file objections or requests for hearing with the Oil Conservation Division, 1220 South St. Francis Dr., Santa Fe, New Mexico 87505, within 15 days.

**NO ACTION WILL BE TAKEN ON THE APPLICATION UNTIL PROPER PROOF OF NOTICE HAS BEEN SUBMITTED.**

---

**NOTICE:** Surface owners or offset operators must file any objections or requests for hearing of administrative applications within 15 days from the date this application was mailed to them.

## INJECTION WELL DATA SHEET

OPERATOR: Platinum Exploration, Inc.WELL NAME & NUMBER: Huber State #1WELL LOCATION: 330' FNL X 1150' FEL  
FOOTAGE LOCATIONWELLBORE SCHEMATICA 5 16S 38E  
UNIT LETTER SECTION TOWNSHIP RANGEWELL CONSTRUCTION DATA  
Surface CasingHole Size: 16" Casing Size: 12-3/4" 35#Cemented with: 350 sx. or ft<sup>3</sup>Top of Cement: Surface Method Determined: CirculatedIntermediate CasingHole Size: 11" Casing Size: 8-5/8" 24# & 32# 155Cemented with: 1650 sx. or ft<sup>3</sup>Top of Cement: 800' Method Determined: CalculatedProduction CasingHole Size: 7-7/8" Casing Size: 5-1/2" 17# N80Cemented with: 300 sx. or ft<sup>3</sup>Top of Cement: 11,240' Method Determined: CalculatedTotal Depth: 13,424Proposed Injection Interval13,300 feet to 13,600'

(Perforated or Open Hole; indicate which)

INJECTION WELL DATA SHEET

Tubing Size: 2-7/8" 6.5# L80, IPC Lining Material: Tie-back Sleeve

Type of Packer: Weatherford Packer

Packer Setting Depth: 10,500'

Other Type of Tubing/Casing Seal (if applicable): \_\_\_\_\_

Additional Data

1. Is this a new well drilled for injection? \_\_\_\_\_ Yes X No

If no, for what purpose was the well originally drilled? Oil Production

2. Name of the Injection Formation: Devonian

3. Name of Field or Pool (if applicable): Devonian, S

4. Has the well ever been perforated in any other zone(s)? List all such perforated intervals and give plugging detail, i.e. sacks of cement or plug(s) used. Open Hole perf 12,905-12,933', Plugs set Bottom 25 sx 12500-12600, Stub 50 sx 11400-11500, Abo 50 sx 8325-8425, Glorieta 50sx 6425-6525, Shoe 50 sx 4920-5021 Tag, Anhydrite 50 sx 2235- 2335 Tag, Stub 50 sx 750-850, Shoe 75 sx 232-332 Tag, Surface 10 sx 0-10.

5. Give the name and depths of any oil or gas zones underlying or overlying the proposed injection zone in this area: Wolfcamp "A" 9560

\_\_\_\_\_  
\_\_\_\_\_  
\_\_\_\_\_

C-108 Application for Authorization to Inject  
Platinum Exploration, Inc.  
Huber State #1  
330' FNL x 1150 FEL  
UL A, Section 5, T16S, R38E  
Lea County, New Mexico

1. The purpose of this application is to re-enter the Huber State #1 plugged by EnergyPro, Inc. in 2001. Drill out cement plugs to the TD of 13,424 feet. Run 5-1/2" 17# N80 casing and land at 12,902', Top of 5-1/2" casing at 11,240', Cement casing with 300 sx cement. Drill out plugs. Run 2-7/8" 6.5# L80 tubing. Set Injection packer at 10,700 feet. Displace annulus with packer fluid. Set packer at 0000 ft. Run MIT and dispose of produced water from the Devonian to the open hole from 12902' to 13424 feet.

2. Platinum Exploration, Inc.  
550 W. Texas, Suite 200  
Midland, Texas 79701  
Greg Rasmussen (432) 687-1664

3. Well Data: See Attachment A

4. This is not an expansion of existing project.

5. See attached map, Attachment B.

6. There are "NO" active wells in the area of review that penetrate the proposed injection interval. There is 1 plugged and abandoned well that penetrates the interval in the area of review. See attached list and well bore schematics. Attachment C.

7. Proposed average daily injection volumes approximately 4000 BWPD.  
Maximum daily injection volume approximately 7000 BWPD.

8. This will be a closed system.

9. Proposed average injection pressure 800 psig.  
Proposed maximum injection pressure 2000 psig.

10. Sources of disposed water would be Devonian

11. Disposal interval is 13,300' - 13,600'

12. Underground water sources of drinking water are to be determined. Will furnish samples if applicable.  
A. There are ????? water wells in the area of review.  
B. No fresh water samples were caught.

13. The disposal interval be acidized in the future with 15% NEFE

# Huber State #1

330' FNL & 1150' FEL  
 Sec 5, T-16S, R-38E  
 Lea County, NM  
 API: 30-025-27290  
**Status:TA'd**  
 Surface Owner: State of New Mexico

GL: 3754' KB: 3765'

16" HOLE  
 12 3/4" 35# @ 282' w/ 350 sx

## PROPOSED

11" HOLE

TOC @ 800'

8 5/8" 24 & 32#, J-55  
 Set @ 4971' w/ 1650 sx;

Avg. Inj. Pressure - 800 psi  
 Avg. Inj. Rate - 4,000 BPD  
 Max. Inj. Rate - 7,000 BPD  
 Max Inj. Pressure - 2,000 psi  
 Injection Tubing 2 7/8" 6.5#, L-80, IPC  
 Inj. Pkr Set @ 10,500'  
 Injection Interval 13,300' - 13,600'

Formation	Top
Yates	3,208 ft
San Andres	4,935 ft
Abo	8,375 ft
Penn	10,750 ft
Miss	12,030 ft
Woodford	12,768 ft
Devonian	12,868 ft

KO @ 10,710'  
 110sx Plug @ 10,710'

Cut & pulled csg @ 10,971'

Cmt Plug 11,051' - 10,893' w/ 50 sx

TOC @ 11,500'

5 1/2", 17 & 20#, N-80  
 @ 12,905' w/ 334 sx, (6/81)

TD:12,933' (6/81)

7 7/8" HOLE

TOC @ 11,240' calc'd

Tie-back Sleeve @ 10,500'  
 Csg Milled f/ 12,675'-745'  
 TD 13,048'

TOF @ 12,782'  
 WS @ 12,775'-754'  
 CR @ 12,782'

4" Arrow Set Injection Pkr

Sqz'd w/ 30sx ea.

Mtr backed off

TD 12,885'

5 1/2", 17#, N80 @ 12,902' MD  
 Cmt'd w/ 300sx,(10/93)  
 KOP @ 12,932' MD

TD:13,424' (9/93)

4" Liner f/ 10,500'to 13,300' w/ Tie-back Sleeve  
 Cmt'd w/ 100sx

4 3/4" OH TD @ 13,600'

4/22/04 JMR

5/7/2004

**Attachment C**

**No Active Wells in AOR**

**Plugged Wells in AOR**

**Pre-Ongard**

**Pre Ongard Well #001**

**API #30-025-25102**

**2000 FSL 660 FEL**

**Unit Letter I, Section 36, T16S, R38E**

**Lea County, New Mexico**

**Drilled and plugged in 1976**

**See attached Well Bore schematic**

**Surface owner**

**State of New Mexico**

**New Mexico State Land Office**



Attachment  
C-108 application for Authorization to inject  
Platinum Exploration, Inc.  
Huber State #1  
330 FNL x 1150 FEL  
UL A Section 5, T16S, R38E  
Lea County, New Mexico

Available engineering and geologic data have been examined and no evidence of open faults of hydrologic connection between the disposal zone and any underground sources of drinking water have been found.

*Gregory T. Rasmussen*

\_\_\_\_\_  
Name  
Platinum Exploration, Inc.

*5/7/04*

\_\_\_\_\_  
Date

NORTHEAST LEA COUNTY NEW MEXICO  
SCALE 1 IN = 4000 FT

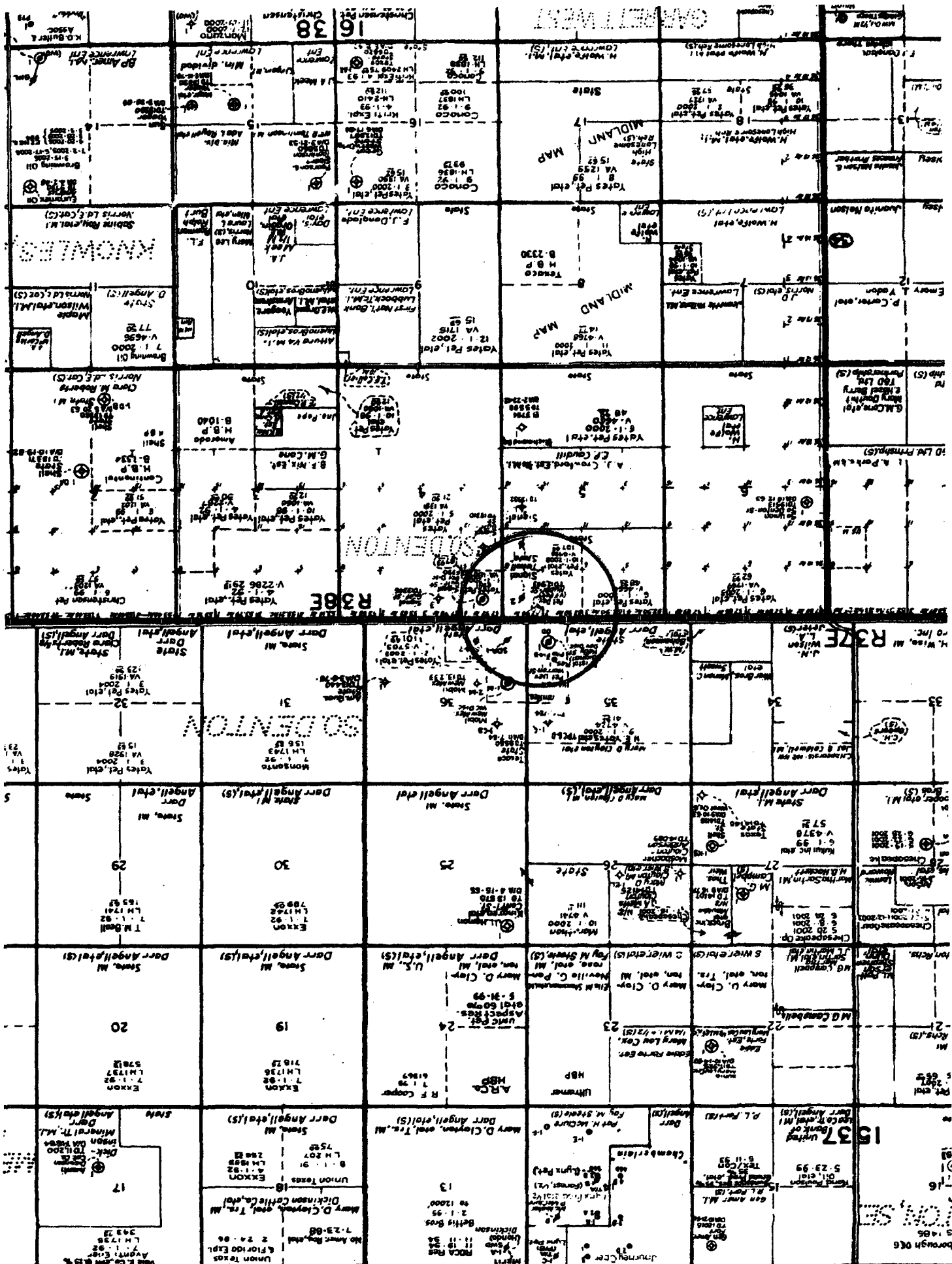

## AFFIDAVIT OF PUBLICATION

Attachment B

State of New Mexico,  
County of Lea.

I, KATHI BEARDEN

Publisher

of the Hobbs News-Sun, a newspaper published at Hobbs, New Mexico, do solemnly swear that the clipping attached hereto was published once a week in the regular and entire issue of said paper, and not a supplement thereof for a period.

of 1

weeks.

Beginning with the issue dated

April 29 2004

and ending with the issue dated

April 29 2004

Kathi Bearden

Publisher

Sworn and subscribed to before

me this 30th day of

April 2004

James M. Bearden

Notary Public.

My Commission expires  
November 27, 2004  
(Seal)

**LEGAL NOTICE**  
April 29, 2004

Platinum Exploration, Inc. 550 West Texas, Suite 200, Midland, Texas 79701 has filed form C-108 (Application for Authorization to Inject) with the New Mexico Oil Conservation Division seeking administrative approval for a salt water disposal well. The proposed well, the Huber State #1 located 330' FNL & 1150' FEL of Section 5, Township 16 South, Range 38 East of Lea County, New Mexico, will be used for salt water disposal. Produced waters from the Devonian will be disposed into the Devonian at depth of 13,300' to 13,600' with a maximum pressure of 2,000 psi and a maximum rate of 7,000BWPD. All interested parties opposing the aforementioned must file objections of requests for a hearing with the Oil Conservation Division, 1220 South Francis Drive, Santa Fe, New Mexico 87505-5472, within 15 days. Additional information can be obtained by contacting Greg Rasmussen at (432) 687-1664 #20803

This newspaper is duly qualified to publish legal notices or advertisements within the meaning of Section 3, Chapter 167, Laws of 1937, and payment of fees for said publication has been made.

02105822000 67521557  
Classie Classifieds II

7003 1680 0006 6220 2012

U.S. Postal Service<sup>TM</sup>  
**CERTIFIED MAIL<sup>TM</sup> RECEIPT**  
 (Domestic Mail Only; No Insurance Coverage Provided)

For delivery information visit our website at [www.usps.com](http://www.usps.com)

**OFFICIAL USE**

Postage	\$ 0.37	UNIT ID: 0702 
Certified Fee	2.30	
Return Receipt Fee (Endorsement Required)	1.75	
Restricted Delivery Fee (Endorsement Required)		
Total Postage & Fees	\$ 4.42	

Sent To  
 American Quasar Petroleum  
 Street, Apt. No.,  
 or PO Box No. 1000 Midland National Bank Tower  
 City, State, ZIP+4 Midland TX 79701

PS Form 3800, June 2002

See Reverse for Instructions

7003 1680 0006 6220 2005

U.S. Postal Service<sup>TM</sup>  
**CERTIFIED MAIL<sup>TM</sup> RECEIPT**  
 (Domestic Mail Only; No Insurance Coverage Provided)

For delivery information visit our website at [www.usps.com](http://www.usps.com)

**OFFICIAL USE**

Postage	\$ 0.37	UNIT ID: 0702 
Certified Fee	2.30	
Return Receipt Fee (Endorsement Required)	1.75	
Restricted Delivery Fee (Endorsement Required)		
Total Postage & Fees	\$ 4.42	

Sent To  
 Petroleum Development Corp.  
 Street, Apt. No.,  
 or PO Box No. 9720 B. Candace NE  
 City, State, ZIP+4 Albuquerque NM 87112

PS Form 3800, June 2002

See Reverse for Instructions

7003 1680 0006 6220 2029

U.S. Postal Service<sup>TM</sup>  
**CERTIFIED MAIL<sup>TM</sup> RECEIPT**  
 (Domestic Mail Only; No Insurance Coverage Provided)

For delivery information visit our website at [www.usps.com](http://www.usps.com)

**OFFICIAL USE**

Postage	\$ 0.37	UNIT ID: 0702 
Certified Fee	2.30	
Return Receipt Fee (Endorsement Required)	1.75	
Restricted Delivery Fee (Endorsement Required)		
Total Postage & Fees	\$ 4.42	

Sent To  
 Yates Petroleum  
 Street, Apt. No.,  
 or PO Box No. 500 North Main  
 City, State, ZIP+4 Roswell NM 88201

PS Form 3800, June 2002

See Reverse for Instructions