



Williams Production Company, LLC  
One Williams Center  
P.O. Box 3102  
Tulsa, Oklahoma 74101-3102  
918/573-6169

March 15, 2005

Assistant District Manager, Minerals  
Bureau of Land Management  
Farmington Resource Area  
1235 La Plata Highway  
Farmington, New Mexico 87401

State of New Mexico  
Oil Conservation Commission  
1220 South St. Francis Drive  
Santa Fe, New Mexico 87505-4000

State of New Mexico  
Commissioner of Public Lands  
310 Old Santa Fe Trail  
Santa Fe, New Mexico 87504-1148

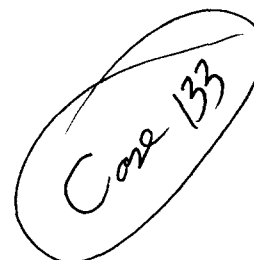

Re: Rosa Unit I, Sec.No.587  
San Juan and Rio Arriba Counties, New Mexico  
2005 Plan of Development

Gentlemen:

By letter dated March 8, 2004, Williams Production Company as Rosa Unit Operator filed the 2004 Plan of Development for the Rosa Unit. Following is a summary of the operations proposed under the 2004 Plan of Development:

<u>Well Name</u>	<u>Formation</u>	<u>Operations Status</u>
Rosa Unit #10C	Mesaverde	Carried over to 2005 P.O.D.
Rosa Unit #14B (Mesaverde/ Dakota Dual)	Mesaverde Dakota	Carried over to 2005 P.O.D. Carried over to 2005 P.O.D.
Rosa Unit #15B	Mesaverde	Carried over to 2005 P.O.D.
Rosa Unit #18B (Mesaverde/ Dakota Dual)	Mesaverde Dakota	Carried over to 2005 P.O.D. Carried over to 2005 P.O.D.
Rosa Unit #21C (Mesaverde/ Dakota Dual)	Mesaverde Dakota	Carried over to 2005 P.O.D. Carried over to 2005 P.O.D.
Rosa Unit #22B (Mesaverde/ Dakota Dual)	Mesaverde Dakota	Carried over to 2005 P.O.D. Carried over to 2005 P.O.D.
Rosa Unit #22B (Mesaverde/ Dakota Dual)	Mesaverde Dakota	Carried over to 2005 P.O.D. Carried over to 2005 P.O.D.
Rosa Unit #23C (Mesaverde/ Dakota Dual)	Mesaverde Dakota	Drilled and completed Drilled and completed
Rosa Unit #25B (Mesaverde/ Dakota Dual)	Mesaverde Dakota	Carried over to 2005 P.O.D. Carried over to 2005 P.O.D.
Rosa Unit #26C (Mesaverde/ Dakota Dual)	Mesaverde Dakota	Drilled and completed Drilled and completed

<u>Well Name</u>	<u>Formation</u>	<u>Operations Status</u>
Rosa Unit #35B	Mesaverde	Carried over to 2005 P.O.D.
Rosa Unit #40E	Dakota	Carried over to 2005 P.O.D.
Rosa Unit #44C	Mesaverde	Carried over to 2005 P.O.D.
Rosa Unit #48E	Dakota	Carried over to 2005 P.O.D.
Rosa Unit Com #60B (Mesaverde/ Dakota Dual)	Mesaverde Dakota	Carried over to 2005 P.O.D. Carried over to 2005 P.O.D.
Rosa Unit #63A	Mesaverde	Carried over to 2005 P.O.D.
Rosa Unit #75B	Mesaverde	Carried over to 2005 P.O.D.
Rosa Unit #85B (Mesaverde/ Dakota Dual)	Mesaverde Dakota	Carried over to 2005 P.O.D. Carried over to 2005 P.O.D.
Rosa Unit #88B (Mesaverde/ Dakota Dual)	Mesaverde Dakota	Drilled and completed Dropped from P.O.D.
Rosa Unit #89B (Mesaverde/ Dakota Dual)	Mesaverde Dakota	Carried over to 2005 P.O.D. Carried over to 2005 P.O.D.
Rosa Unit #100B (Mesaverde/ Dakota Dual)	Mesaverde Dakota	Carried over to 2005 P.O.D. Carried over to 2005 P.O.D.
Rosa Unit #125B	Mesaverde	Carried over to 2005 P.O.D.
Rosa Unit #125Y (Mesaverde/ Dakota Dual)	Mesaverde Dakota	Carried over to 2005 P.O.D. Carried over to 2005 P.O.D.
Rosa Unit Com #129B (Mesaverde/ Dakota Dual)	Mesaverde Dakota	Drilled and completed Dropped from P.O.D.
Rosa Unit #138B (Mesaverde/ Dakota Dual)	Mesaverde Dakota	Drilled and completed Dropped from P.O.D.
Rosa Unit #139B (Mesaverde/ Dakota Dual)	Mesaverde Dakota	Drilled and completed Drilled and completed
Rosa Unit #145B (Mesaverde/ Dakota Dual)	Mesaverde Dakota	Carried over to 2005 P.O.D. Carried over to 2005 P.O.D.
Rosa Unit #146A (Mesaverde/ Dakota Dual)	Mesaverde Dakota	Drilled and completed Dropped from P.O.D.
Rosa Unit #147B (Mesaverde/ Dakota Dual)	Mesaverde Dakota	Drilled and completed Drilled and completed
Rosa Unit #150C (Mesaverde/ Dakota Dual)	Mesaverde Dakota	Drilled and completed Drilled and completed
Rosa Unit #151B	Mesaverde	Carried over to 2005 P.O.D.
Rosa Unit #151C	Mesaverde	Drilled and completed
Rosa Unit #152C	Mesaverde	Carried over to 2005 P.O.D.
Rosa Unit #153B	Mesaverde	Drilled and completed
Rosa Unit #156B (Mesaverde/ Dakota Dual)	Mesaverde Dakota	Carried over to 2005 P.O.D. Carried over to 2005 P.O.D.
Rosa Unit #159B	Mesaverde	Carried over to 2005 P.O.D.
Rosa Unit #160B (Mesaverde/ Dakota Dual)	Mesaverde Dakota	Drilled and completed Drilled and completed
Rosa Unit #162B	Mesaverde	Carried over to 2005 P.O.D.
Rosa Unit #163B (Mesaverde/ Dakota Dual)	Mesaverde Dakota	Carried over to 2005 P.O.D. Carried over to 2005 P.O.D.
Rosa Unit Com #169B	Mesaverde	Carried over to 2005 P.O.D.
Rosa Unit Com #169C	Mesaverde	Drilled and completed
Rosa Unit #180B (Mesaverde/ Dakota Dual)	Mesaverde Dakota	Carried over to 2005 P.O.D. Carried over to 2005 P.O.D.
Rosa Unit #181B	Mesaverde	Carried over to 2005 P.O.D.
Rosa Unit #181C	Mesaverde	Drilled and completed
Rosa Unit #184B (Mesaverde/ Dakota Dual)	Mesaverde Dakota	Carried over to 2005 P.O.D. Carried over to 2005 P.O.D.
Rosa Unit #185B (Mesaverde/ Dakota Dual)	Mesaverde Dakota	Carried over to 2005 P.O.D. Carried over to 2005 P.O.D.

<u>Well Name</u>	<u>Formation</u>	<u>Operations Status</u>
Rosa Unit #186 (Mesaverde/ Dakota Dual)	Mesaverde	Carried over to 2005 P.O.D.
	Dakota	Carried over to 2005 P.O.D.
Rosa Unit #187B	Mesaverde	Carried over to 2005 P.O.D.
Rosa Unit #188B	Mesaverde	Carried over to 2005 P.O.D.
Rosa Unit #189 (Mesaverde/ Dakota Dual)	Mesaverde	Carried over to 2005 P.O.D.
	Dakota	Carried over to 2005 P.O.D.
Rosa Unit #191	Mesaverde	Carried over to 2005 P.O.D.
Rosa Unit #192	Mesaverde	Carried over to 2005 P.O.D.
Rosa Unit #200A	Fruitland Coal	Drilled and completed
Rosa Unit #201A	Fruitland Coal	Carried over to 2005 P.O.D.
Rosa Unit #202A	Fruitland Coal	Drilled and completed
Rosa Unit #206A	Fruitland Coal	Carried over to 2005 P.O.D.
Rosa Unit #209A	Fruitland Coal	Drilled and completed
Rosa Unit #212A	Fruitland Coal	Drilled and completed
Rosa Unit #213A	Fruitland Coal	Drilled and completed
Rosa Unit #222A	Fruitland Coal	Drilled and completed
Rosa Unit #223A	Fruitland Coal	Drilled and completed
Rosa Unit #226A	Fruitland Coal	Carried over to 2005 P.O.D.
Rosa Unit #229A	Fruitland Coal	Carried over to 2005 P.O.D.
Rosa Unit #233A	Fruitland Coal	Carried over to 2005 P.O.D.
Rosa Unit #234A	Fruitland Coal	Carried over to 2005 P.O.D.
Rosa Unit Com #237A	Fruitland Coal	Drilled and completed
Rosa Unit #242A	Fruitland Coal	Drilled and completed
Rosa Unit #256A	Fruitland Coal	Drilled and completed
Rosa Unit #260A	Fruitland Coal	Carried over to 2005 P.O.D.
Rosa Unit #268A	Fruitland Coal	Carried over to 2005 P.O.D.
Rosa Unit #270A	Fruitland Coal	Carried over to 2005 P.O.D.
Rosa Unit #274A	Fruitland Coal	Carried over to 2005 P.O.D.
Rosa Unit #276A	Fruitland Coal	Carried over to 2005 P.O.D.
Rosa Unit #329A	Fruitland Coal	Carried over to 2005 P.O.D.
Rosa Unit #332A	Fruitland Coal	Carried over to 2005 P.O.D.
Rosa Unit #347	Fruitland Coal	Carried over to 2005 P.O.D.
Rosa Unit #350	Fruitland Coal	Carried over to 2005 P.O.D.
Rosa Unit #351A	Fruitland Coal	Carried over to 2005 P.O.D.
Rosa Unit #354A	Fruitland Coal	Carried over to 2005 P.O.D.
Rosa Unit Com #355A	Fruitland Coal	Carried over to 2005 P.O.D.
Rosa Unit #360	Fruitland Coal	Carried over to 2005 P.O.D.
Rosa Unit #362	Fruitland Coal	Carried over to 2005 P.O.D.
Rosa Unit #364	Fruitland Coal	Carried over to 2005 P.O.D.
Rosa Unit #364A	Fruitland Coal	Carried over to 2005 P.O.D.
Rosa Unit #365	Fruitland Coal	Carried over to 2005 P.O.D.
Rosa Unit #367	Fruitland Coal	Carried over to 2005 P.O.D.
Rosa Unit #368	Fruitland Coal	Carried over to 2005 P.O.D.
Rosa Unit #369	Fruitland Coal	Carried over to 2005 P.O.D.
Rosa Unit #370	Fruitland Coal	Carried over to 2005 P.O.D.
Rosa Unit #372	Fruitland Coal	Drilled and completed
Rosa Unit #373	Fruitland Coal	Carried over to 2005 P.O.D.
Rosa Unit #374	Fruitland Coal	Carried over to 2005 P.O.D.
Rosa Unit #375	Fruitland Coal	Drilled and completed
Rosa Unit Com #376	Fruitland Coal	Carried over to 2005 P.O.D.
Rosa Unit Com #376A	Fruitland Coal	Carried over to 2005 P.O.D.
Rosa Unit Com #377	Fruitland Coal	Carried over to 2005 P.O.D.
Rosa Unit #378	Fruitland Coal	Carried over to 2005 P.O.D.
Rosa Unit #379A	Fruitland Coal	Carried over to 2005 P.O.D.
Rosa Unit #380	Fruitland Coal	Carried over to 2005 P.O.D.

<u>Well Name</u>	<u>Formation</u>	<u>Operations Status</u>
Rosa Unit #382	Fruitland Coal	Carried over to 2005 P.O.D.
Rosa Unit #383	Fruitland Coal	Carried over to 2005 P.O.D.
Rosa Unit #384	Fruitland Coal	Carried over to 2005 P.O.D.
Rosa Unit #384A	Fruitland Coal	Carried over to 2005 P.O.D.
Rosa Unit #385A	Fruitland Coal	Carried over to 2005 P.O.D.
Rosa Unit #386	Fruitland Coal	Carried over to 2005 P.O.D.
Rosa Unit #386A	Fruitland Coal	Carried over to 2005 P.O.D.
Rosa Unit #387	Fruitland Coal	Carried over to 2005 P.O.D.

The Participating Areas that have been established in the Rosa Unit are as follows:

<u>Formation</u>	<u>Revision</u>	<u>Effective</u>
Fruitland Coal	Ninth	August 1, 2002
Pictured Cliffs	Seventh	October 1, 1999
Mesaverde	Fifteenth	January 1, 1983
Dakota	Ninth	January 1, 1992

Attached are maps of the Rosa Unit showing the boundaries of the Participating Areas as applicable. There were no wells commingled within the Rosa Unit during 2004. The Rosa Unit #99Y Gallup/Dakota formation well, #100 Dakota formation well, and the #168A Mesaverde formation well were plugged and abandoned.

Pursuant to Section 9 of the Rosa Unit Agreement, Williams Production Company is submitting a Plan of Development providing for the completion of the following wells during 2005:

<u>Well Name</u>	<u>Drilling Block</u>	<u>Formation</u>
Rosa Unit #10C	W/2 Sec.13, T31N, R6W	Mesaverde
Rosa Unit #12C	E/2 Sec.15, T31N, R6W	Mesaverde
Rosa Unit #14B (Mesaverde/ Dakota Dual)	E/2 Sec.23, T31N, R6W	Mesaverde
Rosa Unit #15B	S/2 Sec.23, T31N, R6W	Dakota
Rosa Unit #18B (Mesaverde/ Dakota Dual)	E/2 Sec.29, T31N, R5W	Mesaverde
Rosa Unit #19C (Mesaverde/ Dakota Dual)	E/2 Sec.22, T31N, R6W	Mesaverde
Rosa Unit #21C (Mesaverde/ Dakota Dual)	E/2 Sec.22, T31N, R6W	Dakota
Rosa Unit #21C (Mesaverde/ Dakota Dual)	W/2 Sec.24, T31N, R6W	Mesaverde
Rosa Unit #21C (Mesaverde/ Dakota Dual)	W/2 Sec.24, T31N, R6W	Dakota
Rosa Unit #22B (Mesaverde/ Dakota Dual)	W/2 Sec.23, T31N, R6W	Mesaverde
Rosa Unit #22B (Mesaverde/ Dakota Dual)	N/2 Sec.23, T31N, R6W	Dakota
Rosa Unit #25B (Mesaverde/ Dakota Dual)	N/2 Sec.18, T31N, R5W	Mesaverde
Rosa Unit #25B (Mesaverde/ Dakota Dual)	N/2 Sec.18, T31N, R5W	Dakota
Rosa Unit #35B	W/2 Sec.15, T31N, R6W	Mesaverde
Rosa Unit #40E	W/2 Sec.15, T31N, R6W	Dakota
Rosa Unit #48E	ALL Sec.05, T31N, R6W	Mesaverde
Rosa Unit Corn #60B (Mesaverde/ Dakota Dual)	N/2 Sec.11, T31N, R5W	Dakota
Rosa Unit #63A	S/2 Sec.11, T31N, R5W	Dakota
Rosa Unit #75B	ALL Sec.04, T31N, R6W	Mesaverde
Rosa Unit #75C	ALL Sec.04, T31N, R6W	Dakota
Rosa Unit #79C	E/2 Sec.30, T31N, R4W	Fruitland Coal
Rosa Unit #80B	W/2 Sec.10, T31N, R6W	Mesaverde
Rosa Unit #80C	W/2 Sec.10, T31N, R6W	Mesaverde
	W/2 Sec.22, T31N, R6W	Mesaverde
	W/2 Sec.08, T31N, R5W	Mesaverde
	W/2 Sec.08, T31N, R5W	Mesaverde

<u>Well Name</u>	<u>Drilling Block</u>	<u>Formation</u>
Rosa Unit #85B (Mesaverde/ Dakota Dual)	N/2 Sec.20, T31N, R5W N/2 Sec.20, T31N, R5W	Mesaverde Dakota
Rosa Unit #89B (Mesaverde/ Dakota Dual)	E/2 Sec.34, T32N, R6W E/2 Sec.34, T32N, R6W	Mesaverde Dakota
Rosa Unit #100B (Mesaverde/ Dakota Dual)	S/2 Sec.21, T31N, R6W S/2 Sec.21, T31N, R6W	Mesaverde Dakota
Rosa Unit #125B	E/2 Sec.13, T31N, R6W	Mesaverde
Rosa Unit #125Y (Mesaverde/ Dakota Dual)	E/2 Sec.13, T31N, R6W E/2 Sec.13, T31N, R6W	Mesaverde Dakota
Rosa Unit #145B (Mesaverde/ Dakota Dual)	N/2 Sec.16, T31N, R6W N/2 Sec.16, T31N, R6W	Mesaverde Dakota
Rosa Unit #145C	N/2 Sec.16, T31N, R6W	Mesaverde
Rosa Unit #156B (Mesaverde/ Dakota Dual)	E/2 Sec.09, T31N, R6W E/2 Sec.09, T31N, R6W	Mesaverde Dakota
Rosa Unit #159B	S/2 Sec.19, T31N, R5W	Mesaverde
Rosa Unit #160C	S/2 Sec.25, T31N, R6W	Mesaverde
Rosa Unit #162B	S/2 Sec.30, T31N, R5W	Mesaverde
Rosa Unit #163B (Mesaverde/ Dakota Dual)	E/2 Sec.24, T31N, R6W E/2 Sec.24, T31N, R6W	Mesaverde Dakota
Rosa Unit Com #163C	E/2 Sec.24, T31N, R6W	Mesaverde
Rosa Unit Com #169B	ALL Sec.03, T31N, R6W	Mesaverde
Rosa Unit #180B (Mesaverde/ Dakota Dual)	W/2 Sec.09, T31N, R6W W/2 Sec.09, T31N, R6W	Mesaverde Dakota
Rosa Unit #180C	W/2 Sec.09, T31N, R6W	Mesaverde
Rosa Unit #181B	E/2 Sec.10, T31N, R6W	Mesaverde
Rosa Unit #184B (Mesaverde/ Dakota Dual)	E/2 Sec.34, T31N, R5W S/2 Sec.34, T31N, R5W	Mesaverde Dakota
Rosa Unit #185B (Mesaverde/ Dakota Dual)	S/2 Sec.16, T31N, R6W S/2 Sec.16, T31N, R6W	Mesaverde Dakota
Rosa Unit #186 (Mesaverde/ Dakota Dual)	N/2 Sec.27, T31N, R5W N/2 Sec.27, T31N, R5W	Mesaverde Dakota
Rosa Unit #187B	W/2 Sec.21, T31N, R5W	Mesaverde
Rosa Unit #188B (Mesaverde/ Dakota Dual)	W/2 Sec.34, T31N, R5W W/2 Sec.34, T31N, R5W	Mesaverde Dakota
Rosa Unit #189 (Mesaverde/ Dakota Dual)	E/2 Sec.21, T31N, R5W E/2 Sec.21, T31N, R5W	Mesaverde Dakota
Rosa Unit #191	S/2 Sec.26, T31N, R5W	Mesaverde
Rosa Unit #192	E/2 Sec.35, T31N, R5W	Mesaverde
Rosa Unit #201A	E/2 Sec.22, T31N, R6W	Fruitland Coal
Rosa Unit #203A	S/2 Sec.18, T31N, R5W	Fruitland Coal
Rosa Unit #206A	N/2 Sec.24, T31N, R6W	Fruitland Coal
Rosa Unit #207A	W/2 Sec.17, T31N, R5W	Fruitland Coal
Rosa Unit #208A	W/2 Sec.15, T31N, R5W	Fruitland Coal
Rosa Unit #210A	S/2 Sec.13, T31N, R6W	Fruitland Coal
Rosa Unit #214A	W/2 Sec.14, T31N, R6W	Fruitland Coal
Rosa Unit #216A	W/2 Sec.11, T31N, R6W	Fruitland Coal
Rosa Unit #219A	S/2 Sec.19, T31N, R5W	Fruitland Coal
Rosa Unit #220A	N/2 Sec.13, T31N, R6W	Fruitland Coal
Rosa Unit #221A	N/2 Sec.18, T31N, R5W	Fruitland Coal
Rosa Unit #225A	S/2 Sec.12, T31N, R6W	Fruitland Coal
Rosa Unit #227A	S/2 Sec.07, T31N, R5W	Fruitland Coal
Rosa Unit #228A	N/2 Sec.07, T31N, R5W	Fruitland Coal
Rosa Unit #229A	W/2 Sec.29, T31N, R5W	Fruitland Coal

<u>Well Name</u>	<u>Drilling Block</u>	<u>Formation</u>
Rosa Unit #232A	S/2 Sec. 20, T31N, R5W	Fruitland Coal
Rosa Unit #233A	S/2 Sec.30, T31N, R5W	Fruitland Coal
Rosa Unit #234A	W/2 Sec.09, T31N, R6W	Fruitland Coal
Rosa Unit Com #239A	ALL Sec.02, T31N, R6W	Fruitland Coal
Rosa Unit #240A	ALL Sec.01, T31N, R6W	Fruitland Coal
Rosa Unit #241A	ALL Sec.06, T31N, R5W	Fruitland Coal
Rosa Unit #243A	W/2 Sec.36, T32N, R6W	Fruitland Coal
Rosa Unit #260A	S/2 Sec.21, T31N, R6W	Fruitland Coal
Rosa Unit #263A	W/2 Sec.21, T31N, R5W	Fruitland Coal
Rosa Unit #266A	E/2 Sec.28, T31N, R5W	Fruitland Coal
Rosa Unit #267A	W/2 Sec.28, T31N, R5W	Fruitland Coal
Rosa Unit #270A	W/2 Sec.34, T31N, R5W	Fruitland Coal
Rosa Unit #271A	E/2 Sec.35, T31N, R5W	Fruitland Coal
Rosa Unit #272A	W/2 Sec.35, T31N, R5W	Fruitland Coal
Rosa Unit #274A	E/2 Sec.16, T31N, R6W	Fruitland Coal
Rosa Unit #276A	E/2 Sec.17, T31N, R6W	Fruitland Coal
Rosa Unit #279A	E/2 Sec.35, T32N, R6W	Fruitland Coal
Rosa Unit #280A	W/2 Sec.01, T31N, R4W	Fruitland Coal
Rosa Unit #283A	E/2 Sec.02, T31N, R4W	Fruitland Coal
Rosa Unit #309A	E/2 Sec.26, T31N, R4W	Fruitland Coal
Rosa Unit #310A	W/2 Sec.26, T31N, R4W	Fruitland Coal
Rosa Unit #312A	W/2 Sec.28, T31N, R4W	Fruitland Coal
Rosa Unit #313A	W/2 Sec.29, T31N, R4W	Fruitland Coal
Rosa Unit #329A	E/2 Sec.34, T32N, R6W	Fruitland Coal
Rosa Unit #331A	W/2 Sec.35, T32N, R6W	Fruitland Coal
Rosa Unit #332A	W/2 Sec.22, T31N, R6W	Fruitland Coal
Rosa Unit #336A	N/2 Sec. 08, T31N, R5W	Fruitland Coal
Rosa Unit #347	W/2 Sec.11, T31N, R4W	Fruitland Coal
Rosa Unit #347A	W/2 Sec.11, T31N, R4W	Fruitland Coal
Rosa Unit #350	E/2 Sec.10, T31N, R5W	Fruitland Coal
Rosa Unit #351A	W/2 Sec.11, T31N, R5W	Fruitland Coal
Rosa Unit #354A	E/2 Sec.19, T31N, R4W	Fruitland Coal
Rosa Unit Com #355A	E/2 Sec.33, T32N, R6W	Fruitland Coal
Rosa Unit #357A	E/2 Sec.36, T32N, R6W	Fruitland Coal
Rosa Unit #360	W/2 Sec.09, T31N, R5W	Fruitland Coal
Rosa Unit #361A	W/2 Sec.16, T31N, R5W	Fruitland Coal
Rosa Unit #362	W/2 Sec.36, T31N, R5W	Fruitland Coal
Rosa Unit #363A	E/2 Sec.17, T31N, R5W	Fruitland Coal
Rosa Unit #364	W/2 Sec.05, T31N, R4W	Fruitland Coal
Rosa Unit #364A	E/2 Sec.05, T31N, R4W	Fruitland Coal
Rosa Unit #365	E/2 Sec.07, T31N, R4W	Fruitland Coal
Rosa Unit #365A	E/2 Sec.07, T31N, R4W	Fruitland Coal
Rosa Unit #367	W/2 Sec.09, T31N, R4W	Fruitland Coal
Rosa Unit #367A	W/2 Sec.09, T31N, R4W	Fruitland Coal
Rosa Unit #368	E/2 Sec.09, T31N, R4W	Fruitland Coal
Rosa Unit #368A	E/2 Sec.09, T31N, R4W	Fruitland Coal
Rosa Unit #369	E/2 Sec.11, T31N, R4W	Fruitland Coal
Rosa Unit #369A	E/2 Sec.11, T31N, R4W	Fruitland Coal
Rosa Unit #370	W/2 Sec.19, T31N, R4W	Fruitland Coal
Rosa Unit #373	W/2 Sec.15, T31N, R5W	Fruitland Coal
Rosa Unit #374	E/2 Sec.16, T31N, R5W	Fruitland Coal
Rosa Unit #375A	W/2 Sec.24, T31N, R5W	Fruitland Coal
Rosa Unit Com #376	S/2 Sec.25, T31N, R5W	Fruitland Coal
Rosa Unit Com #376A	N/2 Sec.25, T31N, R5W	Fruitland Coal
Rosa Unit Com #377	N/2 Sec.26, T31N, R5W	Fruitland Coal

<u>Well Name</u>	<u>Drilling Block</u>	<u>Formation</u>
Rosa Unit #378	E/2 Sec.27, T31N, R5W	Fruitland Coal
Rosa Unit #379A	S/2 Sec.08, T31N, R5W	Fruitland Coal
Rosa Unit #380	W/2 Sec.20, T31N, R4W	Fruitland Coal
Rosa Unit #382	E/2 Sec.12, T31N, R5W	Fruitland Coal
Rosa Unit #382A	E/2 Sec.12, T31N, R5W	Fruitland Coal
Rosa Unit #383	E/2 Sec.29, T31N, R4W	Fruitland Coal
Rosa Unit #384	W/2 Sec.21, T31N, R4W	Fruitland Coal
Rosa Unit #384A	E/2 Sec.21, T31N, R4W	Fruitland Coal
Rosa Unit #385	E/2 Sec.21, T31N, R4W	Fruitland Coal
Rosa Unit #385A	W/2 Sec.21, T31N, R4W	Fruitland Coal
Rosa Unit #386	N/2 Sec.05, T31N, R4W	Fruitland Coal
Rosa Unit #386A	N/2 Sec.05, T31N, R4W	Fruitland Coal
Rosa Unit #387	W/2 Sec.10, T31N, R5W	Fruitland Coal
Rosa Unit #388	E/2 Sec.01, T31N, R4W	Fruitland Coal
Rosa Unit #388A	E/2 Sec.01, T31N, R4W	Fruitland Coal
Rosa Unit #389	W/2 Sec.07, T31N, R4W	Fruitland Coal
Rosa Unit #389A	W/2 Sec.07, T31N, R4W	Fruitland Coal
Rosa Unit #390	E/2 Sec.08, T31N, R4W	Fruitland Coal
Rosa Unit #390A	E/2 Sec.08, T31N, R4W	Fruitland Coal
Rosa Unit #391	W/2 Sec.08, T31N, R4W	Fruitland Coal
Rosa Unit #391A	W/2 Sec.08, T31N, R4W	Fruitland Coal
Rosa Unit #392	E/2 Sec.15, T31N, R4W	Fruitland Coal
Rosa Unit #392A	E/2 Sec.15, T31N, R4W	Fruitland Coal
Rosa Unit #393	W/2 Sec.15, T31N, R4W	Fruitland Coal
Rosa Unit #393A	W/2 Sec.15, T31N, R4W	Fruitland Coal
Rosa Unit #394	E/2 Sec.24, T31N, R5W	Fruitland Coal
Rosa Unit #394A	E/2 Sec.24, T31N, R5W	Fruitland Coal
Rosa Unit #395	N/2 Sec.06, T31N, R4W	Fruitland Coal
Rosa Unit #395A	N/2 Sec.06, T31N, R4W	Fruitland Coal
Rosa Unit #396	S/2 Sec.06, T31N, R4W	Fruitland Coal
Rosa Unit #396A	S/2 Sec.06, T31N, R4W	Fruitland Coal

Williams Production Company, as Unit Operator, will drill any offset wells that may be required to prevent drainage of unitized substances and any other wells deemed necessary or which are requested by the Unit Operator or the Working Interest Owners.

If this Plan of Development is acceptable, please signify your approval as required under Section 9 of the Unit Agreement in the space provided in the enclosed sheet and return an approved copy to Williams Production Company.

Copies of this Plan of Development are being sent to the Working Interest Owners as shown on the enclosed sheet.

Sincerely,



M. Vern Hansen, CPL  
Staff Landman

Enclosures

Rosa Unit  
2005 Plan of Development  
3/15/05

cc: Working Interest Owners  
Mike Turnbaugh  
Kris Russell  
Mitch Reeves  
Tracy Ross  
Gary Sizemore  
Ralph Hawks  
Kirk Place  
Larry Higgins



APPROVED: \_\_\_\_\_  
Assistant District Manager, Minerals  
Bureau of Land Management  
Subject to like approval by the  
Commissioner of Public Lands and  
The Oil Conservation Commission

DATE: \_\_\_\_\_

APPROVED: \_\_\_\_\_  
Commissioner of Public Lands  
Subject to like approval by the Area  
Oil and Gas Supervisor and the Oil  
Conservation Commission

DATE: \_\_\_\_\_

APPROVED: \_\_\_\_\_  
  
Oil Conservation Commission  
Subject to like approval by the Area  
Oil and Gas Supervisor and the  
Commissioner of Public Lands

DATE: 3/28/05

The foregoing approvals are for the 2005 Plan of Development for the Rosa Unit I, Section No.587.

WORKING INTEREST OWNERS  
ROSA UNIT

BP AMERICA PRODUCTION CO.  
ATTN: JOHN LARSON, WL1 RM 19.158  
501 WESTLAKE BOULEVARD  
HOUSTON, TX 77079-3092

MS. ELIZABETH T. CALLOWAY  
P.O. BOX 191767  
DALLAS, TX 75219-1767

J. GLENN TURNER, JR. LLC  
3838 OAK LAWN  
SUITE 1450  
DALLAS, TX 75219

MARY FRANCES TURNER, JR TRUST  
ATTN: IRIS GLEISER  
P O BOX 660197  
DALLAS, TX 75266-0197

PATRICIA P. SCHIEFFER TRUST, BANK OF AMERICA, N.A. AGT  
ATTN: JEFF ANDERSON  
P.O. BOX 2546  
FORT WORTH, TX 76113-2546

MS. VICTORIA WEBB  
806 CORDOVA  
DALLAS, TX 75223

SACRAMENTO MUNICIPAL UTILITIES DISTRICT  
ATTN: THOMAS INGWERS  
P. O. BOX 15830  
SACRAMENTO, CA 95852-1830

SCHULTZ MANAGEMENT, LTD.  
500 N. AKARD, SUITE 2940  
DALLAS, TX 75201

FRED E. TURNER, LLC  
ONE ENERGY SQUARE, #852  
4925 GREENVILLE AVENUE  
DALLAS, TX 75206-4079

XTO ENERGY, INC.  
ATTN: EDWIN S. RYAN, JR.  
810 HOUSTON STREET, STE 2000  
FORT WORTH, TX 76102-6298

MR. JOHN TURNER  
PMB 285  
317 SIDNEY BAKER SOUTH #400  
KERRVILLE, TX 78028

THE WISER OIL COMPANY  
C/O FOREST OIL CORPORATION  
ATTN: KEN MCPHEE  
1600 BROADWAY, SUITE 2200  
DENVER, CO 80202

HENRIETTA E. SCHULTZ, TRUSTEE  
500 NORTH AKARD, SUITE 2940  
DALLAS, TX 75201

CONOCOPHILLIPS COMPANY  
ATTN: CHIEF LANDMAN, SAN JUAN/ROCKIES  
P. O. BOX 2197  
HOUSTON, TX 77252



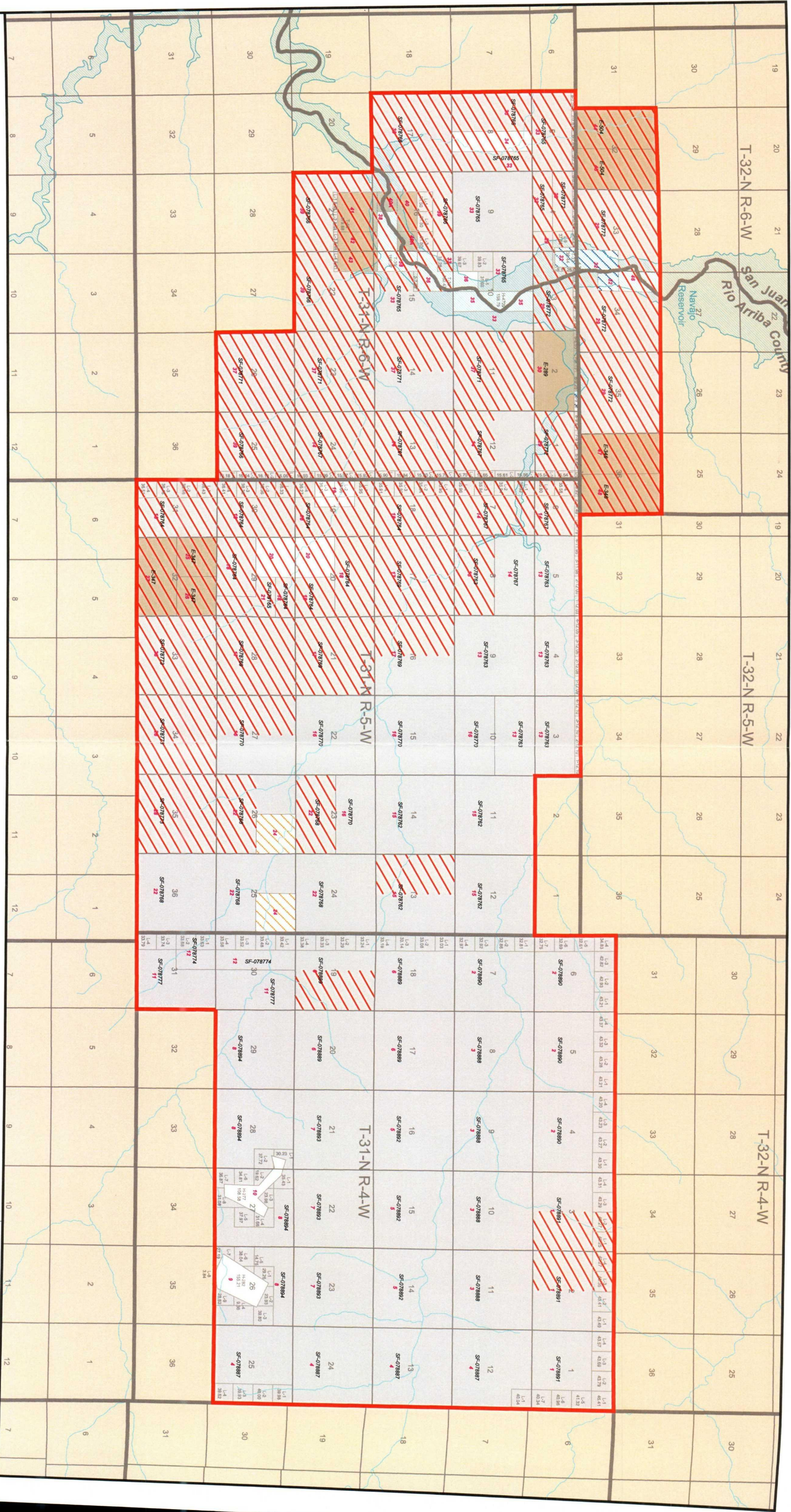

Fruitland Participating Area

Mineral Ownership

Federal

Fee

Partially Committed

State

Not Committed

Rosa Unit Tract No.: XX

Scale: 1:72000

Projection: State Plane - 1983

Date: 02/8/2005

Author: Chuck Fessler

San Juan & Rio Arriba County, NM

Williams

Exploration & Production

Williams

San Juan & Rio Arriba County, NM

Scale: 1:72000

Projection: State Plane - 1983

Date: 02/8/2005

Author: Chuck Fessler

San Juan & Rio Arriba County, NM

Williams

Exploration & Production

Williams

San Juan & Rio Arriba County, NM

Scale: 1:72000

Projection: State Plane - 1983

Date: 02/8/2005

Author: Chuck Fessler







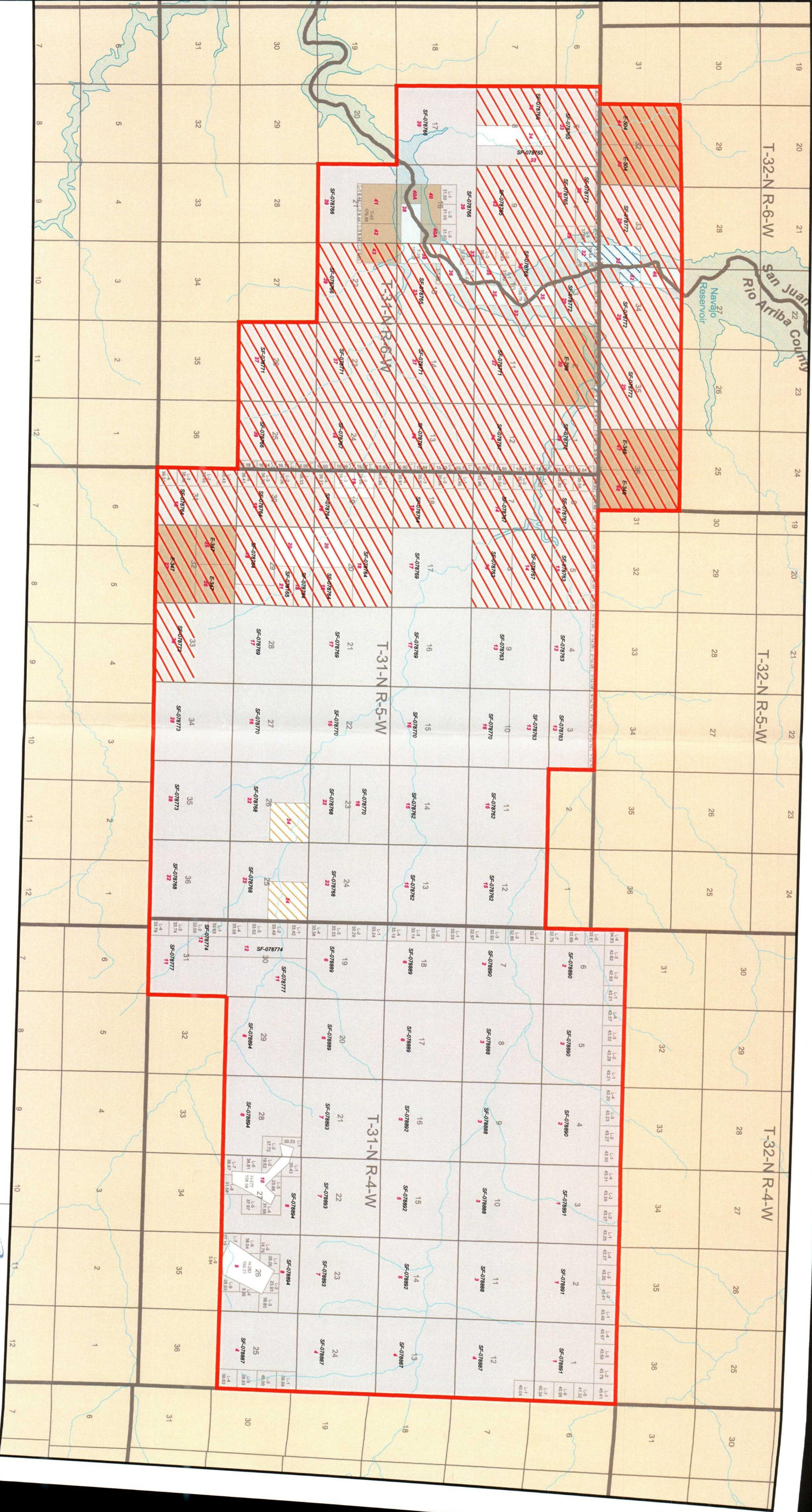

**Williams** Exploration & Production **Williams**

**Rosa Unit**  
San Juan & Rio Arriba County, NM

Scale: 1:72000  
Projection: State Plane - 1983  
Date: 02/8/2005  
Author: Chuck Fessler



