

**BEFORE THE OIL CONSERVATION COMMISSION
EXAMINER HEARING JUNE 13, 2019**

CASE No. 20484

RANDY ALLEN FEDERAL SWD 1

EDDY COUNTY, NEW MEXICO

LONGWOOD WATER MANAGEMENT COMPANY, LLC

RECEIVED:	REVIEWER:	TYPE:	APP NO:
-----------	-----------	-------	---------

ABOVE THIS TABLE FOR OCD DIVISION USE ONLY

NEW MEXICO OIL CONSERVATION DIVISION
 - Geological & Engineering Bureau -
 1220 South St. Francis Drive, Santa Fe, NM 87505



ADMINISTRATIVE APPLICATION CHECKLIST

THIS CHECKLIST IS MANDATORY FOR ALL ADMINISTRATIVE APPLICATIONS FOR EXCEPTIONS TO DIVISION RULES AND REGULATIONS WHICH REQUIRE PROCESSING AT THE DIVISION LEVEL IN SANTA FE

Applicant: Longwood Water Management Company, LLC* **OGRID Number:** 328484
Well Name: Randy Allen Fed SWD I **API:** 30-025
Pool: SWD: Devonian **Pool Code:** 96101

SUBMIT ACCURATE AND COMPLETE INFORMATION REQUIRED TO PROCESS THE TYPE OF APPLICATION INDICATED BELOW

1) TYPE OF APPLICATION: Check those which apply for [A]

A. Location – Spacing Unit – Simultaneous Dedication

☐ NSL ☐ NSP (PROJECT AREA) ☐ NSP (PRORATION UNIT) ☐ SD

B. Check one only for [I] or [II]

[I] Commingling – Storage – Measurement

☐ DHC ☐ CTB ☐ PLC ☐ PC ☐ OLS ☐ OLM

[II] Injection – Disposal – Pressure Increase – Enhanced Oil Recovery

☐ WFX ☐ PMX ☒ SWD ☐ IPI ☐ EOR ☐ PPR

2) NOTIFICATION REQUIRED TO: Check those which apply.

- A. ☒ Offset operators or lease holders
 B. ☒ Royalty, overriding royalty owners, revenue owners
 C. ☒ Application requires published notice
 D. ☐ Notification and/or concurrent approval by SLO
 E. ☒ Notification and/or concurrent approval by BLM
 F. ☒ Surface owner
 G. ☒ For all of the above, proof of notification or publication is attached, and/or,
 H. ☐ No notice required

FOR OCD ONLY

- ☐ Notice Complete
☐ Application Content Complete

3) CERTIFICATION: I hereby certify that the information submitted with this application for administrative approval is **accurate** and **complete** to the best of my knowledge. I also understand that **no action** will be taken on this application until the required information and notifications are submitted to the Division.

Note: Statement must be completed by an individual with managerial and/or supervisory capacity.

Brian Wood

Print or Type Name

Signature

4-18-19

Date

505-466-8120

Phone Number

brian@permits

e-mail Address

BEFORE THE OIL CONSERVATION DIVISION

Santa Fe, New Mexico

Exhibit No. A

Submitted by: Longwood Water Mngt Co. LLC

Hearing Date: June 13, 2019

Case No 20484

APPLICATION FOR AUTHORIZATION TO INJECT

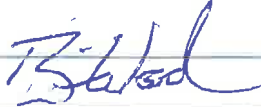
- I. PURPOSE: _____ Secondary Recovery _____ Pressure Maintenance XXX Disposal _____ Storage
Application qualifies for administrative approval? XXX Yes _____ No
- II. OPERATOR: LONGWOOD WATER MANAGEMENT COMPANY, LLC
ADDRESS: 5400 LBJ FREEWAY, SUITE 1500, DALLAS TX 75240
CONTACT PARTY: BRIAN WOOD (PERMITS WEST, INC.) PHONE: 505 466-8120
- III. WELL DATA: Complete the data required on the reverse side of this form for each well proposed for injection.
Additional sheets may be attached if necessary.
- IV. Is this an expansion of an existing project? _____ Yes XXX No
If yes, give the Division order number authorizing the project: _____
- V. Attach a map that identifies all wells and leases within two miles of any proposed injection well with a one-half mile radius circle drawn around each proposed injection well. This circle identifies the well's area of review.
- VI. Attach a tabulation of data on all wells of public record within the area of review which penetrate the proposed injection zone. Such data shall include a description of each well's type, construction, date drilled, location, depth, record of completion, and a schematic of any plugged well illustrating all plugging detail.
Randy Allen Fed SWD 1
Devonian (96101)
- VII. Attach data on the proposed operation, including:
1. Proposed average and maximum daily rate and volume of fluids to be injected;
 2. Whether the system is open or closed;
 3. Proposed average and maximum injection pressure;
 4. Sources and an appropriate analysis of injection fluid and compatibility with the receiving formation if other than reinjected produced water; and,
 5. If injection is for disposal purposes into a zone not productive of oil or gas at or within one mile of the proposed well, attach a chemical analysis of the disposal zone formation water (may be measured or inferred from existing literature, studies, nearby wells, etc.).
- *VIII. Attach appropriate geologic data on the injection zone including appropriate lithologic detail, geologic name, thickness, and depth. Give the geologic name, and depth to bottom of all underground sources of drinking water (aquifers containing waters with total dissolved solids concentrations of 10,000 mg/l or less) overlying the proposed injection zone as well as any such sources known to be immediately underlying the injection interval.
- IX. Describe the proposed stimulation program, if any.
- *X. Attach appropriate logging and test data on the well. (If well logs have been filed with the Division, they need not be resubmitted).
- *XI. Attach a chemical analysis of fresh water from two or more fresh water wells (if available and producing) within one mile of any injection or disposal well showing location of wells and dates samples were taken.
- XII. Applicants for disposal wells must make an affirmative statement that they have examined available geologic and engineering data and find no evidence of open faults or any other hydrologic connection between the disposal zone and any underground sources of drinking water.
- XIII. Applicants must complete the "Proof of Notice" section on the reverse side of this form.
- XIV. Certification: I hereby certify that the information submitted with this application is true and correct to the best of my knowledge and belief.
- NAME: BRIAN WOOD  TITLE: CONSULTANT
SIGNATURE: _____ DATE: APRIL 16, 2019
E-MAIL ADDRESS: brian@permitswest.com
- * If the information required under Sections VI, VIII, X, and XI above has been previously submitted, it need not be resubmitted. Please show the date and circumstances of the earlier submittal: _____

III. WELL DATA

- A. The following well data must be submitted for each injection well covered by this application. The data must be both in tabular and schematic form and shall include:

- (1) Lease name; Well No.; Location by Section, Township and Range; and footage location within the section.
- (2) Each casing string used with its size, setting depth, sacks of cement used, hole size, top of cement, and how such top was determined.
- (3) A description of the tubing to be used including its size, lining material, and setting depth.
- (4) The name, model, and setting depth of the packer used or a description of any other seal system or assembly used.

Division District Offices have supplies of Well Data Sheets which may be used or which may be used as models for this purpose. Applicants for several identical wells may submit a "typical data sheet" rather than submitting the data for each well.

- B. The following must be submitted for each injection well covered by this application. All items must be addressed for the initial well. Responses for additional wells need be shown only when different. Information shown on schematics need not be repeated.

- (1) The name of the injection formation and, if applicable, the field or pool name.
- (2) The injection interval and whether it is perforated or open-hole.
- (3) State if the well was drilled for injection or, if not, the original purpose of the well.
- (4) Give the depths of any other perforated intervals and detail on the sacks of cement or bridge plugs used to seal off such perforations.
- (5) Give the depth to and the name of the next higher and next lower oil or gas zone in the area of the well, if any.

XIV. PROOF OF NOTICE

All applicants must furnish proof that a copy of the application has been furnished, by certified or registered mail, to the owner of the surface of the land on which the well is to be located and to each leasehold operator within one-half mile of the well location.

Where an application is subject to administrative approval, a proof of publication must be submitted. Such proof shall consist of a copy of the legal advertisement which was published in the county in which the well is located. The contents of such advertisement must include:

- (1) The name, address, phone number, and contact party for the applicant;
- (2) The intended purpose of the injection well; with the exact location of single wells or the Section, Township, and Range location of multiple wells;
- (3) The formation name and depth with expected maximum injection rates and pressures; and,
- (4) A notation that interested parties must file objections or requests for hearing with the Oil Conservation Division, 1220 South St. Francis Dr., Santa Fe, New Mexico 87505, within 15 days.

NO ACTION WILL BE TAKEN ON THE APPLICATION UNTIL PROPER PROOF OF NOTICE HAS BEEN SUBMITTED.

NOTICE: Surface owners or offset operators must file any objections or requests for hearing of administrative applications within 15 days from the date this application was mailed to them.

INJECTION WELL DATA SHEET

OPERATOR: LONGWOOD WATER MANAGEMENT COMPANY, LLCWELL NAME & NUMBER: RANDY ALLEN FED SWD 1WELL LOCATION: 133' FSL & 2588' FEL

0

FOOTAGE LOCATION

UNIT LETTER

12

SECTION

26 S

TOWNSHIP

31 E

RANGE

WELLBORE SCHEMATIC

(not to scale)

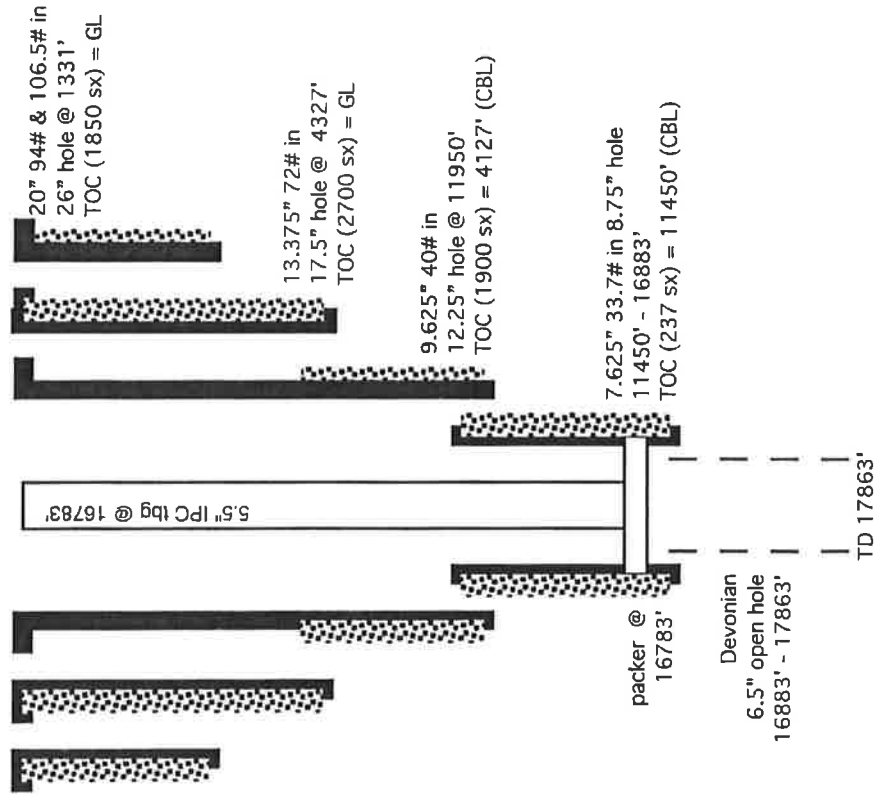
WELL CONSTRUCTION DATASurface CasingHole Size: 26" Casing Size: 20"Cemented with: 1850 sx. or ft³Top of Cement: SURFACE Method Determined: VISUALIntermediate CasingHole Size: 17.5" & 12.25 Casing Size: 13.375" & 9.625"Cemented with: 2700 & 1900 sx. or ft³Top of Cement: SURFACE & 4936' Method Determined: VISUAL & CBLProduction CasingHole Size: 8.75" Casing Size: 7.625" @ 11,450'Cemented with: 237 sx. or ft³Top of Cement: 11,450' Method Determined: CBLTotal Depth: 16,883'Injection Interval 6.5" OPEN HOLE16,883' feet to 17,863'

(Perforated or Open Hole; indicate which)

■■■■■■■■■■

INJECTION WELL DATA SHEET

Tubing Size: 5.5" Lining Material: IPC

Type of Packer: STAINLESS STEEL &/OR NICKEL

Packer Setting Depth: 16,783' - 16,883'

Other Type of Tubing/Casing Seal (if applicable): _____

Additional Data

1. Is this a new well drilled for injection? XXX Yes No

If no, for what purpose was the well originally drilled? _____

2. Name of the Injection Formation: DEVONIAN

3. Name of Field or Pool (if applicable): SWD; DEVONIAN (POOL CODE 96101)

4. Has the well ever been perforated in any other zone(s)? List all such perforated intervals and give plugging detail, i.e. sacks of cement or plug(s) used. _____

NO

5. Give the name and depths of any oil or gas zones underlying or overlying the proposed injection zone in this area: _____

OVER: DELAWARE (4,277'), BONE SPRING (8,249'), WOLFCAMP (11,514')

UNDER: none

LONGWOOD WATER MANAGEMENT COMPANY, LLC
RANDY ALLEN FED SWD 1
133' FSL & 2588' FEL
SEC. 12, T. 26 S., R. 31 E., EDDY COUNTY, NM

PAGE 1

I. Goal is to drill a 17,863' deep commercial saltwater disposal well on BLM. Disposal interval will be 16,883' – 17,863' in the SWD; Devonian (96101). See Exhibit A for C-102 and map.

II. Operator: Longwood Water Management Company, LLC [OGRID 328484]
Operator phone number: (972) 371-5420
Operator address: 5400 LBJ Freeway, Suite 1500, Dallas TX 75240
Contact for Application: Brian Wood (Permits West, Inc.)
Phone: (505) 466-8120

III. A. (1) Lease (BLM): NMNM-120904 Lease Size: 360 acres
Lease Area: SWSW Sec. 10, SE Sec. 12, NE Sec. 13; T. 26 S., R 31 E.
Well name and number: Randy Allen Fed SWD 1
Location: 133' FSL & 2588' FEL Section 12, T. 26 S., R. 31 E.

A. (2) Surface casing (20", 94 & 106.5#, J-55, BTC) will be set at 1,331' in a 26" hole and cemented to GL with 1,850 sacks (based on 50% OH excess).

First intermediate casing (13.375", 72#, P-110 HC, BTC) will be set at 4,327' in a 17.5" hole and cemented to GL with 2,700 sacks (based on 50% OH excess).

Second intermediate casing (9.625", 40#, P-110 HC, BTC) will be set at 11,950' in a 12.25" hole and cemented to 4,127' with 1,900 sacks (based on 40% OH excess).

Production liner (7.625", 33.7#, P-110 HP, USS Liberty FJM) will be set from 11,450' to 16,883' in an 8.75" hole and cemented to 11,450' (CBL) with 237 sacks.

A 6.5" open hole will be drilled from 16,883' to 17,863'.

- A. (3) Tubing will be IPC lined, 5.5", 20#, P-110 IC, BTC. Setting depth will be $\geq 16,783'$. (Disposal interval will be 16,883' to 17,863'.)
- A. (4) A stainless steel and/or nickel packer will be set at $\geq 16,783'$ (top of the open hole which will be at 16,883').
- B. (1) Disposal zone will be the Devonian (SWD; Devonian (96101) pool). Estimated fracture gradient is ≈ 0.62 to ≈ 0.68 psi per foot. Variation depends on whether limestone or dolomite.
- B. (2) Disposal interval will be open hole from 16,883' to 17,863'.
- B. (3) Well has not been drilled. It will be drilled as a saltwater disposal well.
- B. (4) No perforated intervals are in the well.
- B. (5) Only zones producing in the area of review and above the Devonian (16,873') are the Delaware (4,277'), Bone Spring (8,249'), and Wolfcamp (11,514'). No oil or gas zone is below the Devonian in the area of review.

IV. This is not an expansion of an existing injection project. It is disposal only.

V. Exhibit B shows and tabulates the 24 existing wells (23 oil or gas + 1 P&A) and 5 approved, but not yet spudded, wells within a 1-mile radius. Deepest well within a mile is 12,100' TVD. Exhibit C shows all 119 existing wells (90 oil or gas wells + 18 P & A wells + 4 disposal wells + 7 water wells) within a 2-mile radius. Closest SWD; Devonian well (30-025-43379) is 1.63 miles northeast. Closest Devonian oil or gas well is >3 miles away.

All leases within a one-mile radius are BLM or fee. Exhibit D shows and tabulates all the leases within a mile. Exhibit E shows all lessors within a two-mile radius. Two-mile radius leases are BLM, fee, or NMSLO.

VI. No Devonian penetrator is within a mile. Deepest existing or proposed well within a mile is 12,100'. That well bottomed in the Wolfcamp.

- VII. 1. Average injection rate will be $\approx 40,000$ bwpd.
Maximum injection rate will be 45,000 bwpd.
2. System will be open and closed. Water will both be trucked and piped.
3. Average injection pressure will be $\approx 2,500$ psi
Maximum injection pressure will be 3,376 psi ($= 0.2$ psi/foot $\times 16,883'$ (top of open hole)).
4. Disposal water will be produced water, mainly from Bone Spring, Delaware, and Wolfcamp wells. There are 158 approved Bone Spring wells, 141 approved Wolfcamp wells, and 84 approved Delaware wells in T. 26 S., R. 31 and 32 E. The well will take other Permian Basin waters. A summary of produced water analyses from T. 26 S., R. 31 E. is in Exhibit F. Devonian produced water analyses (in mg/L) from wells in T. 23 S., R. 37 E. are in the table below. Compatibility problems are not expected. At least 11,973,863 barrels of water have been disposed in a Devonian; SWD (30-025-43379) that is 1.63 miles northeast.

API	Section	UL	TDS	chloride	bicarbonate	sulfate
3002510717	14	K	118979	71280	462	2593
3002510945	34	A	112959	67390	288	2765
3002510947	34	H	35639			
3002510950	34	A	236252	147000	129	781

5. No Devonian production is within >3 miles.

VIII. The Devonian (estimated 1,000' thick) is comprised of limestone and dolomite. Closest possible underground source of drinking water above the proposed disposal interval is the Quaternary at the surface. There has been some interest in developing the brackish Dewey Lake which is below the Quaternary.

According to State Engineer records (Exhibit G), no water well is within a mile. However, a windmill not in the records was found $\approx 2800'$ southeast and

sampled on March 6, 2019. No underground source of drinking water is below the proposed disposal interval.

Formation tops are:

Quaternary = 0'
Rustler anhydrite = 1306'
Salado = 1832'
Castile = 2250'
Bell Canyon = 4277'
Cherry Canyon = 5228'
Brushy Canyon = 6492'
Bone Spring = 9134'
Wolfcamp = 11514'
Strawn = 13901'
Atoka = 14019'
Morrow = 14963'
Barnett = 16226'
Mississippian limestone = 16418'
Woodford = 16754'
Devonian carbonate = 16873'
disposal interval = 16883' - 17863'
TD = 17863'
(Montoya = 17873')

No water well is within a 1-mile radius according to State Engineer records (Exhibit G). A windmill not in the records was found ≈2800' southeast and sampled on March 6, 2019. Same records show 7 water wells within a 2-mile radius, deepest of which is 700'. There will be >2.9 miles of vertical separation and shale, salt, and anhydrite intervals between the bottom of the only likely underground water source (Dewey Lake) and the top of the Devonian.

IX. The well will be stimulated with acid.

X. GR log will be run from the third intermediate to TD.

LONGWOOD WATER MANAGEMENT COMPANY, LLC
RANDY ALLEN FED SWD 1
133' FSL & 2588' FEL
SEC. 12, T. 26 S., R. 31 E., EDDY COUNTY, NM

PAGE 5

XI. One water well was found within a mile during a March 6, 2019 field inspection.

XII. Longwood Water Management Company, LLC (Exhibit H) is not aware of any geologic or engineering data that may indicate the Devonian is in hydrologic connection with any underground sources of water. Deepest water well within a 2-mile radius is 700'. There are 259 approved Devonian SWD wells and 11 approved Devonian water injection wells in New Mexico. Closest Quaternary fault is \approx 68 miles west-southwest (Exhibit H).

XIII. A legal ad (see Exhibit I) was published on February 27, 2019. Notice (this application) has been sent (Exhibit J) to the surface owner (BLM) and all operators, lessees, and unleased mineral interest owners within a mile who are required to receive notice.

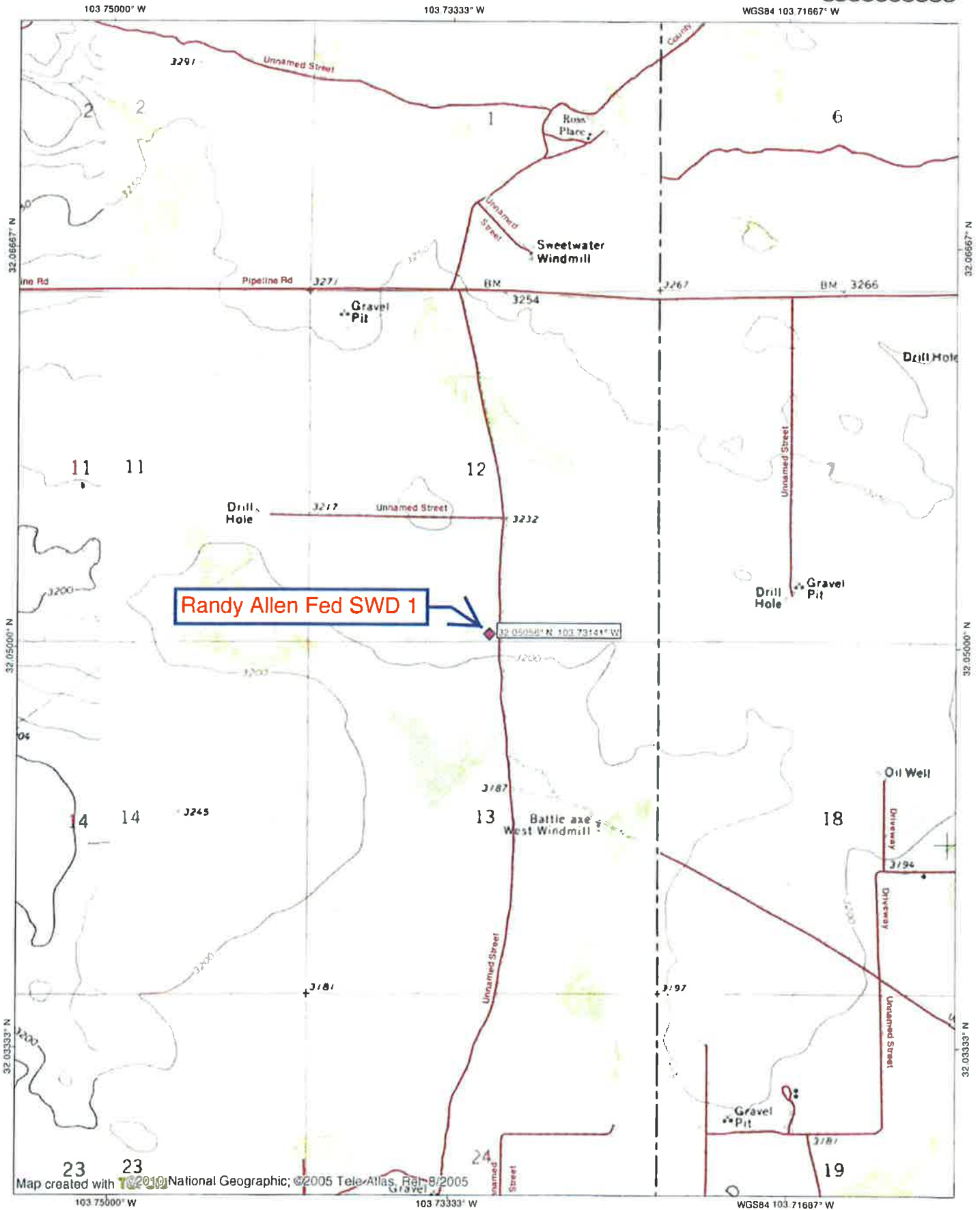

District I
1625 N. French Dr., Hobbs, NM 88240
Phone (575) 393-6161 Fax (575) 393-0720
District II
811 S. First St., Artesia, NM 88210
Phone (575) 748-1283 Fax (575) 748-9720
District III
1000 Rio Brazos Road, Aztec, NM 87410
Phone (505) 334-6178 Fax (505) 334-6170
District IV
1220 S. St. Francis Dr., Santa Fe, NM 87505
Phone (505) 476-3460 Fax (505) 476-3462

State of New Mexico
Energy, Minerals & Natural Resources
Department
OIL CONSERVATION DIVISION
1220 South St. Francis Dr.
Santa Fe, NM 87505

EXHIBIT A

FORM C-102

Revised August 1, 2011

Submit one copy to appropriate

District Office

☐ AMENDED REPORT

WELL LOCATION AND ACREAGE DEDICATION PLAT

¹ API Number 30-015-	² Pool Code 96101	³ Pool Name SWD; Devonian
⁴ Property Code	⁵ Property Name RANDY ALLEN FED SWD	⁶ Well Number 1
⁷ GRID No.	⁸ Operator Name LONGWOOD WATER MANAGEMENT COMPANY, LLC	⁹ Elevation 3208'

¹⁰Surface Location

U/L or lot no. O	Section 12	Township 26-S	Range 31-E	Lot Idn -	Feet from the 133'	North/South line SOUTH	Feet from the 2588'	East/West line EAST	County EDDY
----------------------------	----------------------	-------------------------	----------------------	---------------------	------------------------------	----------------------------------	-------------------------------	-------------------------------	-----------------------

¹¹Bottom Hole Location If Different From Surface

U/L or lot no. -	Section -	Township -	Range -	Lot Idn -	Feet from the -	North/South line -	Feet from the -	East/West line -	County -
----------------------------	---------------------	----------------------	-------------------	---------------------	---------------------------	------------------------------	---------------------------	----------------------------	--------------------

¹² Dedicated Acres	¹³ Joint or Infill	¹⁴ Consolidation Code	¹⁵ Order No.
-------------------------------	-------------------------------	----------------------------------	-------------------------

No allowable will be assigned to this completion until all interests have been consolidated or a non-standard unit has been approved by the division.

<p>SURFACE LOCATION NEW MEXICO EAST NAD 1927 X=686636 Y=382597 LAT.: N 32.0504418 LONG.: W 103.7309466 NAD 1983 X=727823 Y=382654 LAT.: N 32.0505668 LONG.: W 103.7314198</p>	<p>17 OPERATOR CERTIFICATION I hereby certify that the information contained herein is true and complete to the best of my knowledge and belief, and that the organization either owns a working interest or an undivided mineral interest in the land including the proposed bottom hole location or has a right to drill the well at this location pursuant to a contract with an owner of such a mineral or working interest, or to a voluntary pooling agreement or a compulsory pooling order heretofore entered by the division.</p> <p><i>Brian Wood</i> 4-7-19 Signature Date Brian Wood Printed Name brian@permitswest.com E-mail Address 505 466-8120</p>		
	<p>18 SURVEYOR CERTIFICATION I hereby certify that the well location shown on this plat was plotted from field notes of a land survey made by me or under my supervision, and that the same is true to the best of my belief.</p> <p>01/32/2019 Date of Survey Signature and Seal of Professional Surveyor MICHAEL B. BROWN NEW MEXICO 18329 PROFESSIONAL SURVEYOR</p> <p>Certificate Number</p>		

SORTED BY DISTANCE FROM RANDY ALLEN FED SWD 1

API	OPERATOR	WELL	TYPE	SHL UNIT-SECTION	TVD	ZONE @ TD	FEET FROM RANDY ALLEN FED SWD 1 (to SHL unless otherwise shown)
30-015-44858	ConocoPhillips	Revolver 24 13 Federal Com 4H	G	P-24	11530	Wolfcamp	1608 (BHL)
30-015-44857	ConocoPhillips	Revolver 24 13 Federal Com 3H	G	P-24	11530	Wolfcamp	1936 (BHL)
30-015-45071	Mewbourne	Sumideros 12 W1PA Federal Com #002H	G	P-12	11718	Wolfcamp	2208
30-015-45070	Mewbourne	Sumideros 12 W1PA Federal Com #001H	G	P-12	12009	Wolfcamp	2258
30-015-44856	ConocoPhillips	Revolver 24 13 Federal Com 2H	G	P-24	11530	Wolfcamp	2265 (BHL)
30-015-44855	ConocoPhillips	Revolver 24 13 Federal Com 1H	G	P-24	11530	Wolfcamp	2594 (BHL)
30-025-44215	ConocoPhillips	Zia Hills 19 Federal Com #101H	G	2-19	11842	Wolfcamp	2594 (BHL)
30-015-44758	Devon	Snapping 12 1 Federal #523H	O	F-12	9148	Bone Spring	3009
30-015-44722	Devon	Snapping 12 1 Federal #533H	O	F-12	9478	Bone Spring	3018
30-015-44738	Devon	Snapping 12 1 Federal #522H	O	F-12	9285	Bone Spring	3027
30-015-44740	Devon	Snapping 12 1 Federal #623H	G	F-12	Plan: 11541	Wolfcamp	3027
30-015-44739	Devon	Snapping 12 1 Federal #532H	O	E-12	Plan: 8973	Bone Spring	3456
30-015-44737	Devon	Snapping 12 1 Federal #521H	O	E-12	Plan: 8713	Bone Spring	3473
30-015-44721	Devon	Snapping 12 1 Federal #531H	O	E-12	Plan: 8983	Bone Spring	3490
30-025-44216	ConocoPhillips	Zia Hills 19 Federal Com #102H	G	2-19	11994	Wolfcamp	3832 (BHL)
30-025-44217	ConocoPhillips	Zia Hills 19 Federal Com #103H	G	2-19	11820	Wolfcamp	4088 (BHL)
30-025-43217	Mewbourne	Paduca 7 6 W1ED Federal Com #003H	G	2-07	12094	Wolfcamp	4196
30-025-43216	Mewbourne	Paduca 7 6 W1ED Federal Com #002H	G	2-07	12094	Wolfcamp	4255

SORTED BY DISTANCE FROM RANDY ALLEN FED SWD 1

30-025-44218	ConocoPhillips	Zia Hills 19 Federal Com #104H	G	2-19	12012	Wolfcamp	4356 (BHL)
30-025-42320	Mewbourne	Paduca 7 6 A2ED Federal Com #001H	O	2-07	8863	Bone Spring	4516
30-025-08252	Lovelady	Contiental Federal #001	P&A	N-07	4471	Delaware	4591
30-025-44236	ConocoPhillips	Zia Hills 19 Federal Com #109H	G	F-19	11619	Wolfcamp	4631 (BHL)
30-015-42712	Mewbourne	Big Sinks 1 A30B Fee #002H	O	B-12	9132	Bone Spring	4837
30-025-44237	ConocoPhillips	Zia Hills 19 Federal Com #110H	G	F-19	11619	Wolfcamp	4912 (BHL)
30-025-45600	Mewbourne	Paduca 7 6 W1FC Federal Com #003H	G	F-7	12100	Wolfcamp	5145
30-025-44238	ConocoPhillips	Zia Hills 19 Federal Com #111H	G	F-19	11619	Wolfcamp	5200 (BHL)
30-015-43725	Mewbourne	Big Sinks 1 B2 PA Federal Com #003H	O	A-12	Plan: 10317	Bone Spring	5222
30-015-43800	Mewbourne	Big Sinks 1 W1PA Federal Com #002H	G	A-12	12065	Wolfcamp	5254
30-015-42694	Mewbourne	Big Sinks 1 A2 PA Federal Com #001H	O	A-12	8838	Bone Spring	5254
30-025-31016	Sahara	Conoco D Federal #004	O	F-18	4373	Delaware	5422

EXHIBIT C

2 mile radius

Randy Allen Fed SWD 1

- LEGEND**
- New
 - + Active
 - ✦ HRZ
 - ⊙ BHL
 - ⊕ P&A
 - ⊙ INJ
 - ⊙ SWD
 - ⊙ Brine
 - ⊙ Water

Quad: JAL
Scale: 1 inch = 3,333 ft.

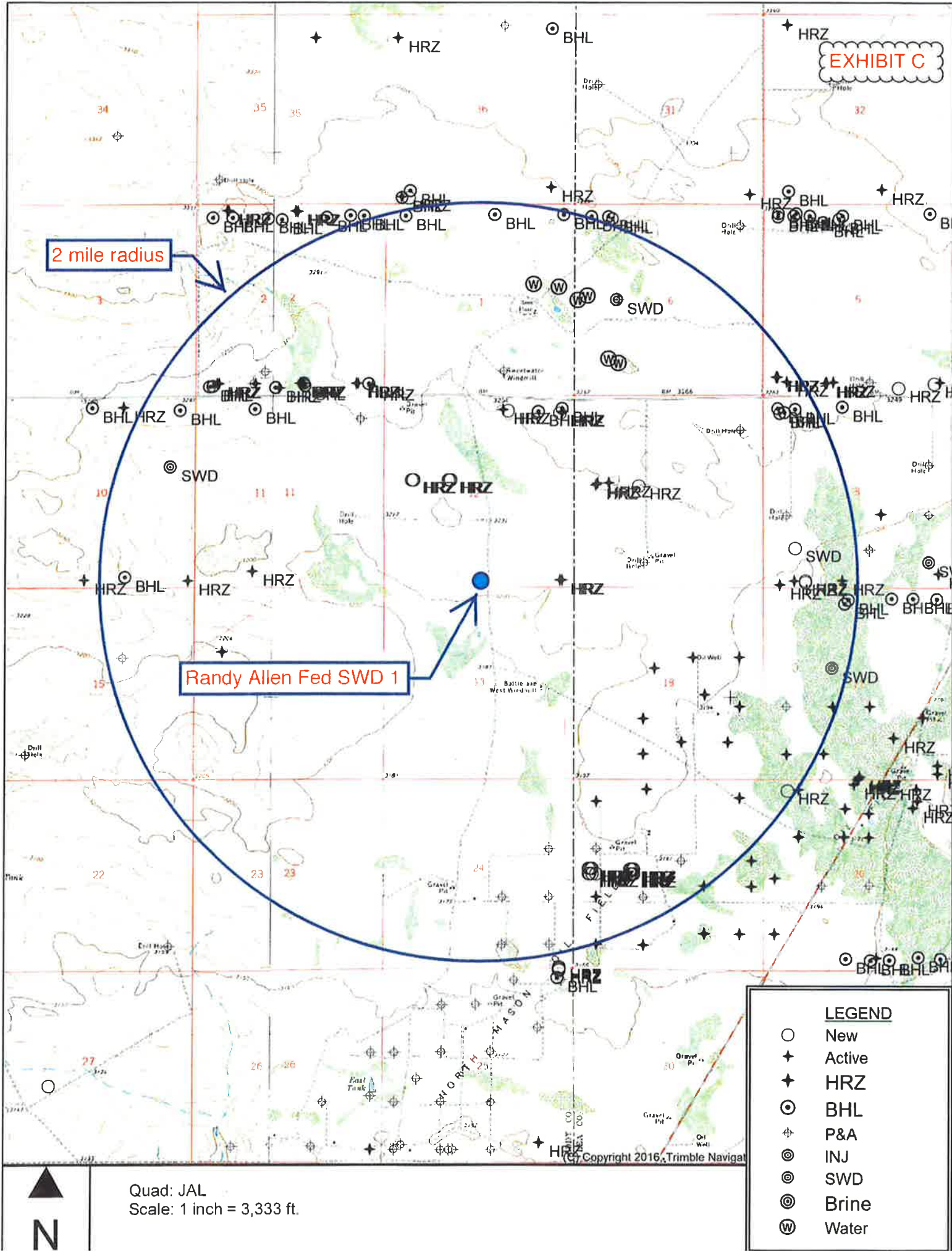
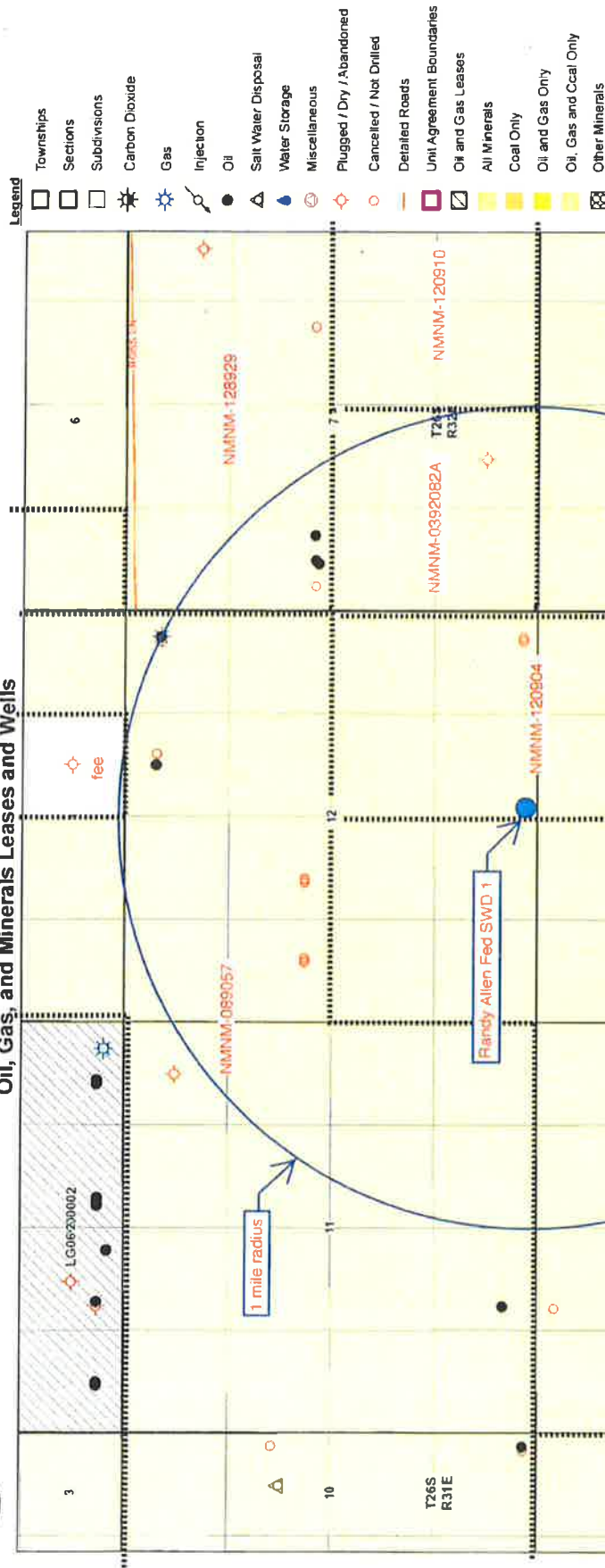



EXHIBIT D

Oil, Gas, and Minerals Leases and Wells



Disclaimer:
The New Mexico State Land Office assumes no responsibility or liability for, or in connection with the accuracy, reliability, or use of the information provided herein with respect to State Land Office data or data from other sources.
Data pertaining to New Mexico State Trust Lands are provisional and subject to revision, and do not constitute an official record of title. Official records may be reviewed at the New Mexico State Land Office in Santa Fe, New Mexico.

EXHIBIT D

Map Created: 4/7/2019

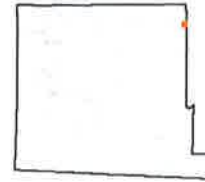

RANDY ALLEN FED SWD 1 AREA OF REVIEW LEASES

Aliquot Parts in Area of Review	Lessor	Lease	Lessee of Record	Operators (all shallower than Devonian)
SESW 1-26s-31e	BLM	NMNM-089057	Devon	Devon
SWSE 1-26s-31e	fee	Big Sinks 1	Mewbourne	Mewbourne
NENE, S2NE4, & SE4 11-26s-31e	BLM	NMNM-089057	Devon	Devon
N2 12-26s-31e	BLM	NMNM-089057	Devon	Devon, Mewbourne
SE4 12-26s-31e	BLM	NMNM-120904	Chevron	N/A
SW4 12-26s-31e	BLM	NMLC-0064756	Penroc	Mewbourne
NE4 13-26s-31e	BLM	NMNM-120904	Chevron	ConocoPhillips
NW4 & S2 13-26s-31e	BLM	NMLC-0064756	Penroc	ConocoPhillips
NE4, N2SE4, & SESE 14-26s-31e	BLM	NMLC-0064756	Penroc	ConocoPhillips
NWNW & S2NWW 7-26s-32e	BLM	NMNM-128929	Occidental Permian	Mewbourne
SWSE 7-26s-32e	BLM	NMNM-120910	COG	N/A
SW4 7-26s-32e	BLM	NMNM-0392082A	Magnum Hunter	ConocoPhillips
NWNE, NW4, N2SW4, & SWSW 18-26s-32e	BLM	NMLC-0062749C	ConocoPhillips	ConocoPhillips, Sahara



Oil, Gas, and Minerals Leases and Wells

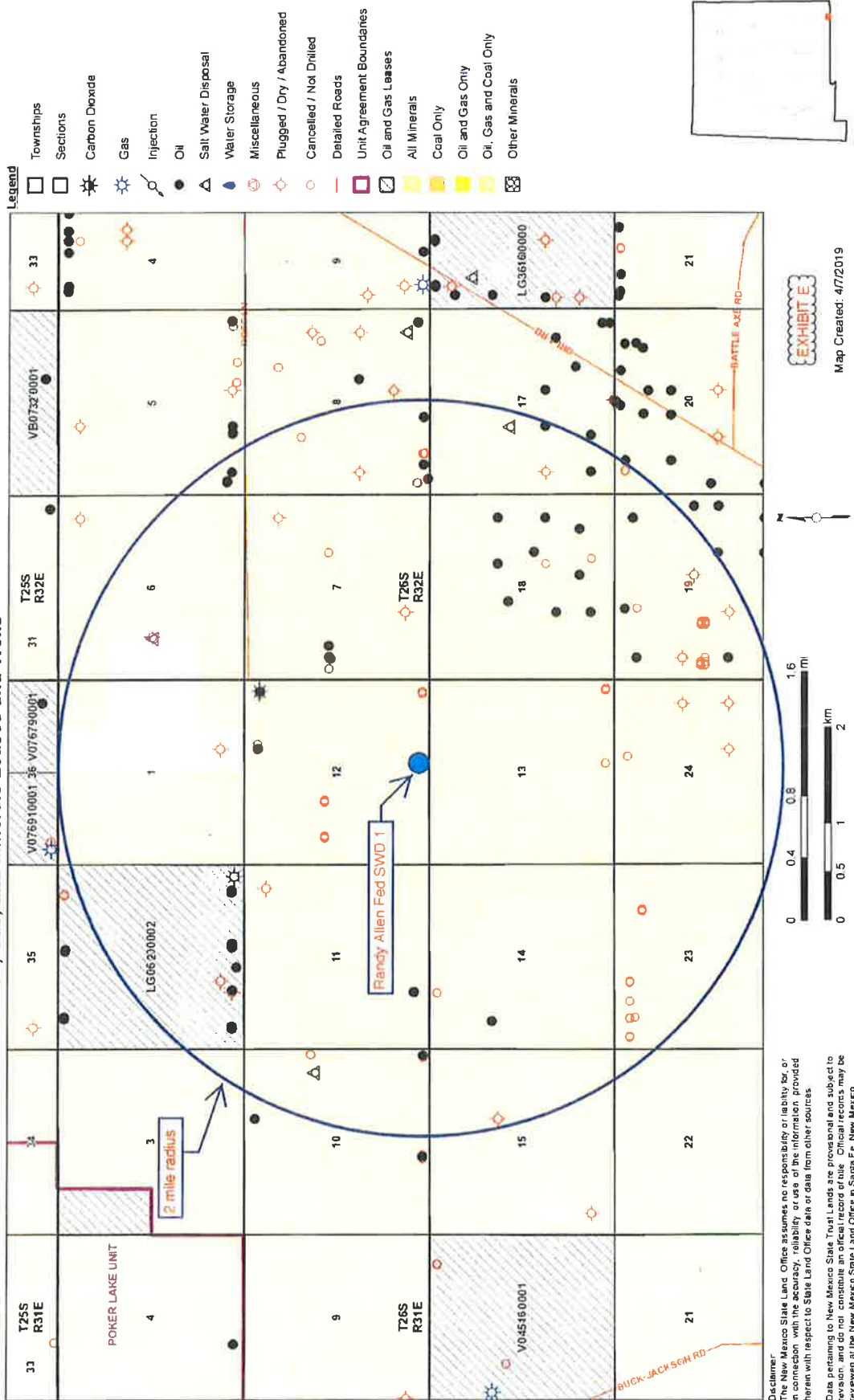

PRODUCED WATER SAMPLES FROM T. 26 S., R. 31 E. (in mg/l)

API	Section	UL	Formation	TDS	Sodium	Calcium	Iron	Magnesium	Chloride	Sulfate
3001539036	2	M	AVALON UPPER	223019	76002	10438	210	1922	131072	632
3001539104	2	N	AVALON UPPER	162560	57137	3886	42	776	97161	756
3001539162	2	O	AVALON UPPER	179789	71576	617	22	110	101374	0
3001539162	2	O	AVALON UPPER	179938	71576	617	22	110	101374	844
3001537899	10	B	AVALON UPPER	199639	68948	7560	111	1523	118195	0
3001537899	10	B	AVALON UPPER	209352	70090	7327	203	1557	127230	600
3001538193	11	N	AVALON UPPER	225190	77011	8744	636	1649	134075	0
3001538193	11	N	AVALON UPPER	196577	68797	5059	12	1066	118943	872
3001538193	11	N	AVALON UPPER	203079	72261	4407	112	904	122172	658
3001539866	10	N	BONE SPRING 2ND SAND	152439	48496	6731	29	801	94055	0
3001540994	10	P	BONE SPRING 2ND SAND	138162	44459	6281	30	781	84470	0
3001540994	10	P	BONE SPRING 2ND SAND	138376	44459	6281	30	781	84470	618
3001542113	2	N	BONE SPRING 3RD SAND	94966	31353	3679	32	484	57490	0
3001542113	2	N	BONE SPRING 3RD SAND	94518	30032	3403	20	439	58782	355
3001542113	2	N	BONE SPRING 3RD SAND	94864	30225	3424	15	444	59015	365

PRODUCED WATER SAMPLES FROM T. 26 S., R. 31 E. (in mg/l)

API	Section	UL	Formation	TDS	Sodium	Calcium	Iron	Magnesium	Chloride	Sulfate
3001542113	2	N	BONE SPRING 3RD SAND	91289	28721	3441	16	437	56957	328
3001505886	26	O	DELAWARE	212112					132100	425
3001542688	2	P	WOLFCAMP	81366	26319	2687	26	327	50281	400

TOPO! map printed on 04/07/19 from "Untitled.tpo"

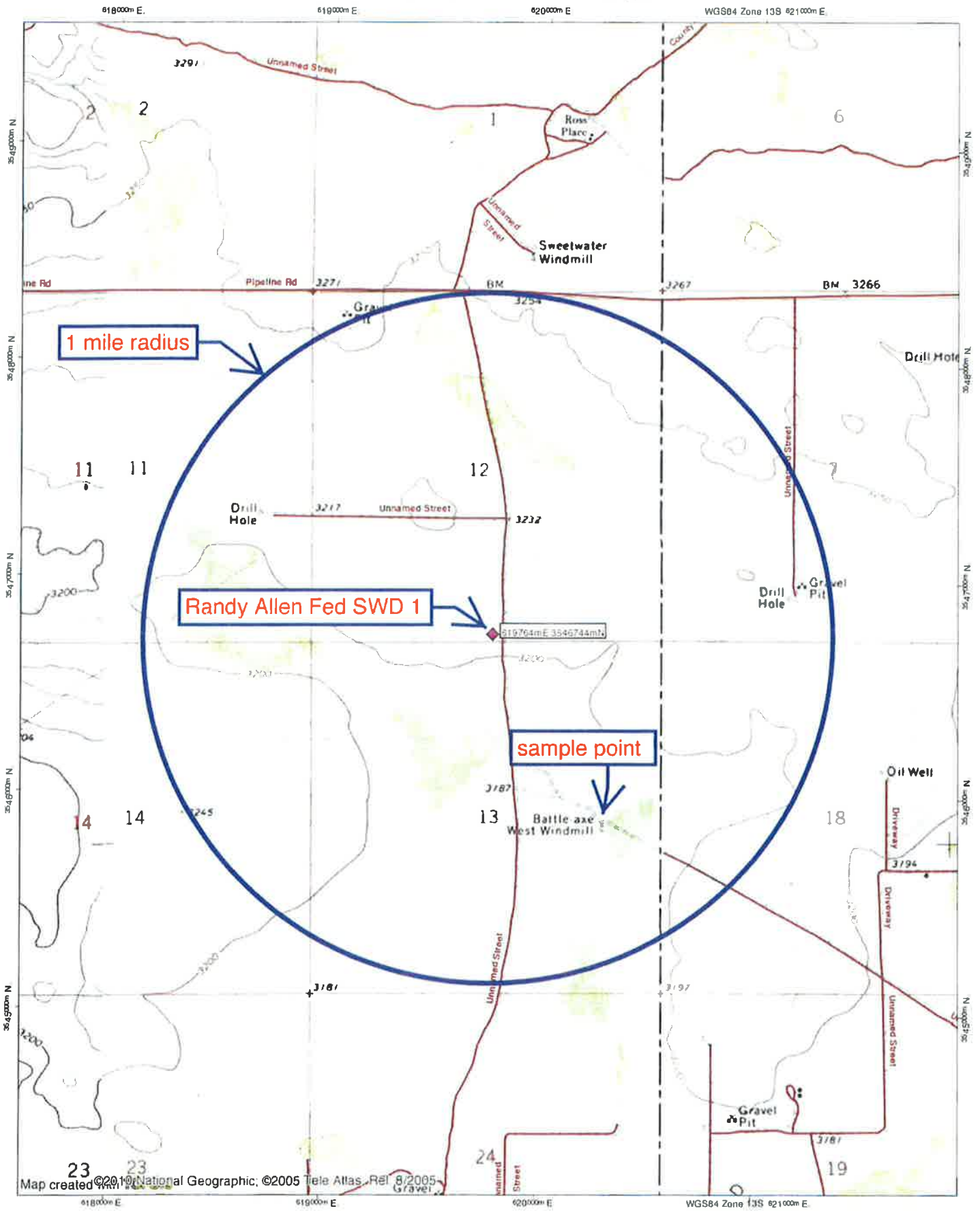



Water Column/Average Depth to Water

(A CLW#### in the POD suffix indicates the POD has been replaced & no longer serves a water right file.)

(R=POD has been replaced,
O=orphaned,
C=the file is closed)

(quarters are 1=NW 2=NE 3=SW 4=SE)
(quarters are smallest to largest)

(NAD83 UTM in meters)

(In feet)

POD Number	Code	POD Sub-basin	County	Q 64	Q 16	Q 4	Sec	Tws	Rng	X	Y	Distance	Depth	Well Depth	Water Column
C 02090		C	ED	4	4	01	26S	31E		620329	3548533*	1876	350	335	15
C 04209 POD2		C	LE	2	3	3	06	26S	32E	620818	3548657	2184	340	155	185
C 04209 POD1		CUB	LE	2	3	3	06	26S	32E	620903	3548619	2194	360	155	205
C 03554 POD1		CUB	ED	2	1	4	01	26S	31E	620547	3549148	2529	630	300	330
C 03639 POD1		CUB	ED	3	4	2	01	26S	31E	620168	3549279	2567	700	365	335
C 04256 POD1		C	ED	4	4	2	01	26S	31E	620384	3549257	2588	666	340	326
C 03829 POD1		CUB	LE	3	3	1	06	26S	32E	620628	3549186	2590	646	350	296

Average Depth to Water: **285 feet**

Minimum Depth: **155 feet**

Maximum Depth: **365 feet**

Record Count: 7

UTM NAD83 Radius Search (in meters):

Easting (X): 619764

Northing (Y): 3546744

Radius: 3220

*UTM location was derived from PLSS - see Help

The data is furnished by the NMOSE/ISC and is accepted by the recipient with the expressed understanding that the OSE/ISC make no warranties, expressed or implied, concerning the accuracy, completeness, reliability, usability, or suitability for any particular purpose of the data.

4/7/19 1:08 PM

WATER COLUMN/ AVERAGE DEPTH TO WATER

Hall Environmental Analysis Laboratory, Inc.

CLIENT: Permits West

Project: Matador Allen and Hammock

Lab ID: 1903306-001

Matrix: AQUEOUS

Client Sample ID: Sec 13 Tank

Collection Date: 3/6/2019 11:13:00 AM

Received Date: 3/7/2019 9:40:00 AM

Analyses	Result	RL	Qual	Units	DF	Date Analyzed	Batch
EPA METHOD 1664B							Analyst: plr
N-Hexane Extractable Material	ND	11.2		mg/L	1	3/11/2019 9:16:00 AM	43604
EPA METHOD 300.0: ANIONS							Analyst: MRA
Chloride	16	0.50		mg/L	1	3/7/2019 4:04:04 PM	R58208
SM2540C MOD: TOTAL DISSOLVED SOLIDS							Analyst: KS
Total Dissolved Solids	383	20.0		mg/L	1	3/13/2019 6:02:00 PM	43630

Refer to the QC Summary report and sample login checklist for flagged QC data and preservation information.

Qualifiers:	*	Value exceeds Maximum Contaminant Level.	B	Analyte detected in the associated Method Blank
	D	Sample Diluted Due to Matrix	E	Value above quantitation range
	H	Holding times for preparation or analysis exceeded	J	Analyte detected below quantitation limits
	ND	Not Detected at the Reporting Limit	P	Sample pH Not In Range
	PQL	Practical Quantitative Limit	RL	Reporting Detection Limit
	S	% Recovery outside of range due to dilution or matrix	W	Sample container temperature is out of limit as specified

QC SUMMARY REPORT

Hall Environmental Analysis Laboratory, Inc.



WO#: 1903306

21-Mar-19

Client: Permits West
Project: Matador Allen and Hammock

Sample ID: MB-43604	SampType: MBLK	TestCode: EPA Method 1664B
Client ID: PBW	Batch ID: 43604	RunNo: 58295
Prep Date: 3/11/2019	Analysis Date: 3/11/2019	SeqNo: 1955297 Units: mg/L
Analyte	Result	PQL SPK value SPK Ref Val %REC LowLimit HighLimit %RPD RPDLimit Qual
N-Hexane Extractable Material	ND	10.0

Sample ID: LCS-43604	SampType: LCS	TestCode: EPA Method 1664B
Client ID: LCSW	Batch ID: 43604	RunNo: 58295
Prep Date: 3/11/2019	Analysis Date: 3/11/2019	SeqNo: 1955298 Units: mg/L
Analyte	Result	PQL SPK value SPK Ref Val %REC LowLimit HighLimit %RPD RPDLimit Qual
N-Hexane Extractable Material	32.2	10.0 40.00 0 80.5 78 114

Qualifiers:

* Value exceeds Maximum Contaminant Level.	B Analyte detected in the associated Method Blank
D Sample Diluted Due to Matrix	E Value above quantitation range
H Holding times for preparation or analysis exceeded	J Analyte detected below quantitation limits
ND Not Detected at the Reporting Limit	P Sample pH Not In Range
PQL Practical Quantitative Limit	RL Reporting Detection Limit
S % Recovery outside of range due to dilution or matrix	W Sample container temperature is out of limit as specified

QC SUMMARY REPORT

Hall Environmental Analysis Laboratory, Inc.



21-Mar-19

Client: Permits West
Project: Matador Allen and Hammock

Sample ID: MB	SampType: mblk	TestCode: EPA Method 300.0: Anions
Client ID: PBW	Batch ID: R58208	RunNo: 58208
Prep Date:	Analysis Date: 3/7/2019	SeqNo: 1952228 Units: mg/L
Analyte	Result	PQL SPK value SPK Ref Val %REC LowLimit HighLimit %RPD RPDLimit Qual
Chloride	ND	0.50

Sample ID: LCS	SampType: lcs	TestCode: EPA Method 300.0: Anions
Client ID: LCSW	Batch ID: R58208	RunNo: 58208
Prep Date:	Analysis Date: 3/7/2019	SeqNo: 1952229 Units: mg/L
Analyte	Result	PQL SPK value SPK Ref Val %REC LowLimit HighLimit %RPD RPDLimit Qual
Chloride	4.7	0.50 5.000 0 94.8 90 110

Qualifiers:

* Value exceeds Maximum Contaminant Level,	B Analyte detected in the associated Method Blank
D Sample Diluted Due to Matrix	E Value above quantitation range
H Holding times for preparation or analysis exceeded	J Analyte detected below quantitation limits
ND Not Detected at the Reporting Limit	P Sample pH Not In Range
PQL Practical Quantitative Limit	RL Reporting Detection Limit
S % Recovery outside of range due to dilution or matrix	W Sample container temperature is out of limit as specified

QC SUMMARY REPORT

Hall Environmental Analysis Laboratory, Inc.



WO#: 1903306

21-Mar-19

Client: Permits West
Project: Matador Allen and Hammock

Sample ID: MB-43630	SampType: MBLK	TestCode: SM2540C MOD: Total Dissolved Solids								
Client ID: PBW	Batch ID: 43630	RunNo: 58346								
Prep Date: 3/12/2019	Analysis Date: 3/13/2019	SeqNo: 1957077 Units: mg/L								
Analyte	Result	PQL	SPK value	SPK Ref Val	%REC	LowLimit	HighLimit	%RPD	RPDLimit	Qual
Total Dissolved Solids	ND	20.0								

Sample ID: LCS-43630	SampType: LCS	TestCode: SM2540C MOD: Total Dissolved Solids								
Client ID: LCSW	Batch ID: 43630	RunNo: 58346								
Prep Date: 3/12/2019	Analysis Date: 3/13/2019	SeqNo: 1957078 Units: mg/L								
Analyte	Result	PQL	SPK value	SPK Ref Val	%REC	LowLimit	HighLimit	%RPD	RPDLimit	Qual
Total Dissolved Solids	1010	20.0	1000	0	101	80	120			

Qualifiers:

* Value exceeds Maximum Contaminant Level.	B Analyte detected in the associated Method Blank
D Sample Diluted Due to Matrix	E Value above quantitation range
H Holding times for preparation or analysis exceeded	J Analyte detected below quantitation limits
ND Not Detected at the Reporting Limit	P Sample pH Not In Range
PQL Practical Quantitative Limit	RI Reporting Detection Limit
S % Recovery outside of range due to dilution or matrix	W Sample container temperature is out of limit as specified

Longwood Water Management Company, LLC

One Lincoln Centre • 5400 LBJ Freeway • Suite 1500 • Dallas, Texas 75240

Voice 972.371.5200 • Fax 972.371.5201

jharrington@matadorresources.com

Jake Harrington
Geologist

April 9, 2019

NM Oil Conservation Division
1220 S. St. Francis Dr.
Santa Fe, NM 87505

Re: Geology Statement
Randy Allen Fed SWD #1
Section 12, T. 26S, R. 31E
Eddy County, New Mexico

To whom it may concern:

Available geologic and engineering data related to the proposed Well have been thoroughly reviewed, and no evidence for a hydrological connection between the proposed deep Devonian injection zone, located at approximately 16,883 ft., and any underground sources of drinking water has been found.

Sincerely,
Longwood Water Management Company, LLC



Jake Harrington



AFFIDAVIT OF PUBLICATION

Ad No.
0001278510

PERMITS WEST, INC.
37 VERANO LOOP

SANTA FE NM 87508

I, a legal clerk of the **Carlsbad Current-Argus**, a newspaper published daily at the City of Carlsbad, in said county of Eddy, state of New Mexico and of general paid circulation in said county; that the same is a duly qualified newspaper under the laws of the State wherein legal notices and advertisements may be published; that the printed notice attached hereto was published in the regular and entire edition of said newspaper and not in supplement thereof on the date as follows, to wit:

02/27/19



Legal Clerk

Subscribed and sworn before me this
27th of February 2019.

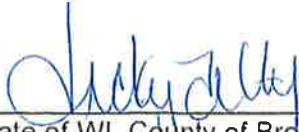

State of WI, County of Brown
NOTARY PUBLIC



My Commission Expires

Longwood Water Management Company, LLC is applying to drill the Randy Allen Fed SWD 1 as a saltwater disposal well. The well is staked at 133' FSL & 2588' FEL Sec. 12, T. 26 S., R. 31 E., Eddy County. This is 23 miles southeast of Malaga, NM and 18 miles northeast of Orla, TX. Disposal will be in the Devonian from 16,883' to 17,863'. Maximum injection pressure will be 3,376 psi. Maximum disposal rate will be 45,000 bwpd. Interested parties must file objections or requests for hearing with the NM Oil Conservation Division, 1220 South Saint Francis Dr., Santa Fe, NM 87505 within 15 days. Additional information can be obtained by contacting: Brian Wood, Permits West, Inc., 37 Verano Loop, Santa Fe, NM 87508. Phone number is (505) 466-8120.

Pub: February 27, 2019 #1278510

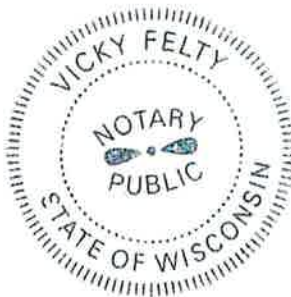

April 16, 2019

BLM
620 E. Greene
Carlsbad NM 88220

TYPICAL LETTER

Longwood Water Management Company, LLC is applying (see attached application) to drill the Randy Allen Fed SWD 1 well as a saltwater disposal well. As required by NM Oil Conservation Division (NMOCD) rules, I am notifying you of the following proposed saltwater disposal well. This letter is a notice only. No action is needed unless you have questions or objections.

Well Name: Randy Allen Fed SWD 1 (BLM surface & lease) TD = 17,863'

Proposed Disposal Zone: Devonian (from 16,883' to 17,863')

Location: 133' FSL & 2588' FEL Sec. 12, T. 26 S., R. 31 E., Eddy County, NM

Approximate Location: 23 miles southeast of Malaga, NM

Applicant: Longwood Water Management Company, LLC (972) 371-5420

Applicant's Address: 5400 LBJ Freeway, Suite 1500, Dallas TX 75240

Submittal Information: Application for a saltwater disposal well will be filed with the NMOCD. If you have an objection, or wish to request a hearing, then it must be filed with the NMOCD within 15 days of receipt of this letter. NMOCD address is 1220 South St. Francis Dr. Santa Fe, NM 87505. Phone is (505) 476-3440.

Please call me if you have any questions.

Sincerely,

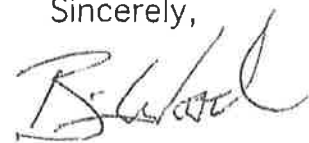

Brian Wood

7016 0750 0000 8802 3456

U.S. Postal Service[®]
CERTIFIED MAIL[®] RECEIPT
Domestic Mail Only

For delivery information, visit our website at www.usps.com

OFFICIAL USE

Certified Mail Fee
Extra Services & Fees (check box, add fee as appropriate)
☐ Return Receipt (hardcopy) \$
☐ Return Receipt (electronic) \$
☐ Certified Mail Restricted Delivery \$
☐ Adult Signature Required \$
☐ Adult Signature Restricted Delivery \$

Postage \$

Total Postage and Fees \$

Send To
Acme Land Co
PO Box 10280
Midland, TX 79702
Matador Randy Allen SWD 1

Street and Apt. No., or PO Box No.
City, State, ZIP+4[®]

PS Form 3800, April 2015 (PSN 7530-02-000-9000) See Reverse for instructions

PECOS NM
Postmark
Here
APR 16 2019
87552-9999

7016 0750 0000 8802 3453

U.S. Postal Service[®]
CERTIFIED MAIL[®] RECEIPT
Domestic Mail Only

For delivery information, visit our website at www.usps.com

OFFICIAL USE

Certified Mail Fee
Extra Services & Fees (check box, add fee as appropriate)
☐ Return Receipt (hardcopy) \$
☐ Return Receipt (electronic) \$
☐ Certified Mail Restricted Delivery \$
☐ Adult Signature Required \$
☐ Adult Signature Restricted Delivery \$

Postage \$

Total Postage and Fees \$

Send To
Aqua-Sucia LLC
14806 S Memorial Dr
Bixby, OK 74008
Matador Randy Allen SWD 1

Street and Apt. No., or PO Box No.
City, State, ZIP+4[®]

PS Form 3800, April 2015 (PSN 7530-02-000-9000) See Reverse for instructions

PECOS NM
Postmark
Here
APR 16 2019
87552-9999

7016 0750 0000 8802 3470

U.S. Postal Service[®]
CERTIFIED MAIL[®] RECEIPT
Domestic Mail Only

For delivery information, visit our website at www.usps.com

OFFICIAL USE

Certified Mail Fee
Extra Services & Fees (check box, add fee as appropriate)
☐ Return Receipt (hardcopy) \$
☐ Return Receipt (electronic) \$
☐ Certified Mail Restricted Delivery \$
☐ Adult Signature Required \$
☐ Adult Signature Restricted Delivery \$

Postage \$

Total Postage and Fees \$

Send To
BLM
3-1 Dinosaur Trail
Santa Fe, NM 87508
Matador Randy Allen SWD 1

Street and Apt. No., or PO Box No.
City, State, ZIP+4[®]

PS Form 3800, April 2015 (PSN 7530-02-000-9000) See Reverse for instructions

PECOS NM
Postmark
Here
APR 16 2019
87552-9999

7016 0750 0000 8802 3494

U.S. Postal Service[®]
CERTIFIED MAIL[®] RECEIPT
Domestic Mail Only

For delivery information, visit our website at www.usps.com

OFFICIAL USE

Certified Mail Fee
Extra Services & Fees (check box, add fee as appropriate)
☐ Return Receipt (hardcopy) \$
☐ Return Receipt (electronic) \$
☐ Certified Mail Restricted Delivery \$
☐ Adult Signature Required \$
☐ Adult Signature Restricted Delivery \$

Postage \$

Total Postage and Fees \$

Send To
Conoco Phillips Co
PO Box 7500
Bartlesville, OK 74605
Matador Randy Allen SWD 1

Street and Apt. No., or PO Box No.
City, State, ZIP+4[®]

PS Form 3800, April 2015 (PSN 7530-02-000-9000) See Reverse for instructions

PECOS NM
Postmark
Here
APR 16 2019
87552-9999

7016 0750 0000 8802 3500

U.S. Postal Service[®]
CERTIFIED MAIL[®] RECEIPT
Domestic Mail Only

For delivery information, visit our website at www.usps.com

OFFICIAL USE

Certified Mail Fee
Extra Services & Fees (check box, add fee as appropriate)
☐ Return Receipt (hardcopy) \$
☐ Return Receipt (electronic) \$
☐ Certified Mail Restricted Delivery \$
☐ Adult Signature Required \$
☐ Adult Signature Restricted Delivery \$

Postage \$

Total Postage and Fees \$

Send To
Conoco Phillips Co
600 N Dairy Ashford
Houston, TX 77079
Matador Randy Allen SWD 1

Street and Apt. No., or PO Box No.
City, State, ZIP+4[®]

PS Form 3800, April 2015 (PSN 7530-02-000-9000) See Reverse for instructions

PECOS NM
Postmark
Here
APR 16 2019
87552-9999

7016 0750 0000 8802 3517

U.S. Postal Service[®]
CERTIFIED MAIL[®] RECEIPT
Domestic Mail Only

For delivery information, visit our website at www.usps.com

OFFICIAL USE

Certified Mail Fee
Extra Services & Fees (check box, add fee as appropriate)
☐ Return Receipt (hardcopy) \$
☐ Return Receipt (electronic) \$
☐ Certified Mail Restricted Delivery \$
☐ Adult Signature Required \$
☐ Adult Signature Restricted Delivery \$

Postage \$

Total Postage and Fees \$

Send To
COG Production LLC
600 W Illinois Ave
Midland, TX 79701
Matador Randy Allen SWD 1

Street and Apt. No., or PO Box No.
City, State, ZIP+4[®]

PS Form 3800, April 2015 (PSN 7530-02-000-9000) See Reverse for instructions

PECOS NM
Postmark
Here
APR 16 2019
87552-9999

7016 0750 0000 8802 3531

U.S. Postal Service[®]
CERTIFIED MAIL[®] RECEIPT
Domestic Mail Only

For delivery information, visit our website at www.usps.com

OFFICIAL USE

Certified Mail Fee
Extra Services & Fees (check box, add fee as appropriate)
☐ Return Receipt (hardcopy) \$
☐ Return Receipt (electronic) \$
☐ Certified Mail Restricted Delivery \$
☐ Adult Signature Required \$
☐ Adult Signature Restricted Delivery \$

Postage \$

Total Postage and Fees \$

Send To
Devon Energy Prod Co LP
333 W Sheridan Ave
Oklahoma City, OK 73102
Matador Randy Allen SWD 1

Street and Apt. No., or PO Box No.
City, State, ZIP+4[®]

PS Form 3800, April 2015 (PSN 7530-02-000-9000) See Reverse for instructions

PECOS NM
Postmark
Here
APR 16 2019
87552-9999

7016 0750 0000 8802 3548

U.S. Postal Service[®]
CERTIFIED MAIL[®] RECEIPT
Domestic Mail Only

For delivery information, visit our website at www.usps.com

OFFICIAL USE

Certified Mail Fee
Extra Services & Fees (check box, add fee as appropriate)
☐ Return Receipt (hardcopy) \$
☐ Return Receipt (electronic) \$
☐ Certified Mail Restricted Delivery \$
☐ Adult Signature Required \$
☐ Adult Signature Restricted Delivery \$

Postage \$

Total Postage and Fees \$

Send To
Don L Sparks
800 N Marlenfeld 100
Midland, TX 79701
Matador Randy Allen SWD 1

Street and Apt. No., or PO Box No.
City, State, ZIP+4[®]

PS Form 3800, April 2015 (PSN 7530-02-000-9000) See Reverse for instructions

PECOS NM
Postmark
Here
APR 16 2019
87552-9999

7016 0750 0000 8802 3555

U.S. Postal Service[®]
CERTIFIED MAIL[®] RECEIPT
Domestic Mail Only

For delivery information, visit our website at www.usps.com

OFFICIAL USE

Certified Mail Fee
Extra Services & Fees (check box, add fee as appropriate)
☐ Return Receipt (hardcopy) \$
☐ Return Receipt (electronic) \$
☐ Certified Mail Restricted Delivery \$
☐ Adult Signature Required \$
☐ Adult Signature Restricted Delivery \$

Postage \$

Total Postage and Fees \$

Send To
Dorothy Simmons
1404 W Main
El Dorado, AR 71730
Matador Randy Allen SWD 1

Street and Apt. No., or PO Box No.
City, State, ZIP+4[®]

PS Form 3800, April 2015 (PSN 7530-02-000-9000) See Reverse for instructions

PECOS NM
Postmark
Here
APR 16 2019
87552-9999

7016 0750 0000 8802 3579

U.S. Postal Service[™]
CERTIFIED MAIL[®] RECEIPT
Domestic Mail Only

For delivery information, visit our website at www.usps.com[™]

OFFICIAL USE

For delivery information, visit our website at www.usps.com[™]

Postmark Here

EOG Resources Inc
 PO Box 4362
 Houston TX 77210
 Matador Randy Allen SWD 1

PS Form 3800, April 2015 PSN 7530-01-000-9001 See Reverse for Instructions

7016 0750 0000 8802 3586

U.S. Postal Service[™]
CERTIFIED MAIL[®] RECEIPT
Domestic Mail Only

For delivery information, visit our website at www.usps.com[™]

OFFICIAL USE

For delivery information, visit our website at www.usps.com[™]

Postmark Here

EOG Resources Inc
 PO Box 2267
 Midland TX 79702
 Matador Randy Allen SWD 1

PS Form 3800, April 2015 PSN 7530-01-000-9001 See Reverse for Instructions

7016 0750 0000 8802 3593

U.S. Postal Service[™]
CERTIFIED MAIL[®] RECEIPT
Domestic Mail Only

For delivery information, visit our website at www.usps.com[™]

OFFICIAL USE

For delivery information, visit our website at www.usps.com[™]

Postmark Here

EOG Resources Inc
 5509 Champions Dr
 Midland TX 79706
 Matador Randy Allen SWD 1

PS Form 3800, April 2015 PSN 7530-01-000-9001 See Reverse for Instructions

7016 0750 0000 8802 3616

U.S. Postal Service[™]
CERTIFIED MAIL[®] RECEIPT
Domestic Mail Only

For delivery information, visit our website at www.usps.com[™]

OFFICIAL USE

For delivery information, visit our website at www.usps.com[™]

Postmark Here

HPC Energy Inc
 810 N Dixie Blvd 202
 Odessa TX 79761
 Matador Randy Allen SWD 1

PS Form 3800, April 2015 PSN 7530-01-000-9001 See Reverse for Instructions

7016 0750 0000 8802 3623

U.S. Postal Service[™]
CERTIFIED MAIL[®] RECEIPT
Domestic Mail Only

For delivery information, visit our website at www.usps.com[™]

OFFICIAL USE

For delivery information, visit our website at www.usps.com[™]

Postmark Here

JKTS Corp
 North Marlenfeld 100
 Midland TX 79701
 Matador Randy Allen SWD 1

PS Form 3800, April 2015 PSN 7530-01-000-9001 See Reverse for Instructions

7016 0750 0000 8802 3630

U.S. Postal Service[™]
CERTIFIED MAIL[®] RECEIPT
Domestic Mail Only

For delivery information, visit our website at www.usps.com[™]

OFFICIAL USE

For delivery information, visit our website at www.usps.com[™]

Postmark Here

Magnum Hunter Production
 202 S Cheyenne Ave
 STE 1000
 Tulsa OK 74103
 Matador Randy Allen SWD 1

PS Form 3800, April 2015 PSN 7530-01-000-9001 See Reverse for Instructions

U.S. Postal Service[™]
CERTIFIED MAIL[®] RECEIPT
Domestic Mail Only

For delivery information, visit our website at www.usps.com

OFFICIAL USE

Certified Mail Fee \$
Extra Services & Fees (check box, add fee as appropriate)
☐ Return Receipt (hardcopy) \$
☐ Return Receipt (electronic) \$
☐ Certified Mail Restricted Delivery \$
☐ Adult Signature Required \$
☐ Adult Signature Restricted Delivery \$

Postage \$
Total Postage and Fees \$

Send To: **Mawbourne Oil Co.**
PO Box 5270
Hobbs, NM 88241
Matador Randy Allen SWD 1

Send and App. No., or PO Box No.
City, State, ZIP+4[®]

PS Form 3800, April 2015 with PSN 7530-01-000-9047 See Reverse for Instructions

U.S. Postal Service[™]
CERTIFIED MAIL[®] RECEIPT
Domestic Mail Only

For delivery information, visit our website at www.usps.com

OFFICIAL USE

Certified Mail Fee \$
Extra Services & Fees (check box, add fee as appropriate)
☐ Return Receipt (hardcopy) \$
☐ Return Receipt (electronic) \$
☐ Certified Mail Restricted Delivery \$
☐ Adult Signature Required \$
☐ Adult Signature Restricted Delivery \$

Postage \$
Total Postage and Fees \$

Send To: **Parroc Oil Corp.**
PO Box 5970
Hobbs, NM 88241
Matador Randy Allen SWD 1

Send and App. No., or PO Box No.
City, State, ZIP+4[®]

PS Form 3800, April 2015 with PSN 7530-01-000-9047 See Reverse for Instructions

U.S. Postal Service[™]
CERTIFIED MAIL[®] RECEIPT
Domestic Mail Only

For delivery information, visit our website at www.usps.com

OFFICIAL USE

Certified Mail Fee \$
Extra Services & Fees (check box, add fee as appropriate)
☐ Return Receipt (hardcopy) \$
☐ Return Receipt (electronic) \$
☐ Certified Mail Restricted Delivery \$
☐ Adult Signature Required \$
☐ Adult Signature Restricted Delivery \$

Postage \$
Total Postage and Fees \$

Send To: **Sahara Operating Company**
PO Box 4130
Midland, TX 79704
Matador Randy Allen SWD 1

Send and App. No., or PO Box No.
City, State, ZIP+4[®]

PS Form 3800, April 2015 with PSN 7530-01-000-9047 See Reverse for Instructions

U.S. Postal Service[™]
CERTIFIED MAIL[®] RECEIPT
Domestic Mail Only

For delivery information, visit our website at www.usps.com

OFFICIAL USE

Certified Mail Fee \$
Extra Services & Fees (check box, add fee as appropriate)
☐ Return Receipt (hardcopy) \$
☐ Return Receipt (electronic) \$
☐ Certified Mail Restricted Delivery \$
☐ Adult Signature Required \$
☐ Adult Signature Restricted Delivery \$

Postage \$
Total Postage and Fees \$

Send To: **Occidental Permian LP**
5 E Greenway Plaza #110
Houston, TX 77046
Matador Randy Allen SWD 1

Send and App. No., or PO Box No.
City, State, ZIP+4[®]

PS Form 3800, April 2015 with PSN 7530-01-000-9047 See Reverse for Instructions

U.S. Postal Service[™]
CERTIFIED MAIL[®] RECEIPT
Domestic Mail Only

For delivery information, visit our website at www.usps.com

OFFICIAL USE

Certified Mail Fee \$
Extra Services & Fees (check box, add fee as appropriate)
☐ Return Receipt (hardcopy) \$
☐ Return Receipt (electronic) \$
☐ Certified Mail Restricted Delivery \$
☐ Adult Signature Required \$
☐ Adult Signature Restricted Delivery \$

Postage \$
Total Postage and Fees \$

Send To: **Raymon Newton Sharp**
Box 66
Joplin, MO 64802
Matador Randy Allen SWD 1

Send and App. No., or PO Box No.
City, State, ZIP+4[®]

PS Form 3800, April 2015 with PSN 7530-01-000-9047 See Reverse for Instructions

U.S. Postal Service[™]
CERTIFIED MAIL[®] RECEIPT
Domestic Mail Only

For delivery information, visit our website at www.usps.com

OFFICIAL USE

Certified Mail Fee \$
Extra Services & Fees (check box, add fee as appropriate)
☐ Return Receipt (hardcopy) \$
☐ Return Receipt (electronic) \$
☐ Certified Mail Restricted Delivery \$
☐ Adult Signature Required \$
☐ Adult Signature Restricted Delivery \$

Postage \$
Total Postage and Fees \$

Send To: **SRBI-OG-NM LLC**
201 Main Street #2700
Fort Worth, TX 76102
Matador Randy Allen SWD 1

Send and App. No., or PO Box No.
City, State, ZIP+4[®]

PS Form 3800, April 2015 with PSN 7530-01-000-9047 See Reverse for Instructions

U.S. Postal Service[™]
CERTIFIED MAIL[®] RECEIPT
Domestic Mail Only

For delivery information, visit our website at www.usps.com

OFFICIAL USE

Certified Mail Fee \$
Extra Services & Fees (check box, add fee as appropriate)
☐ Return Receipt (hardcopy) \$
☐ Return Receipt (electronic) \$
☐ Certified Mail Restricted Delivery \$
☐ Adult Signature Required \$
☐ Adult Signature Restricted Delivery \$

Postage \$
Total Postage and Fees \$

Send To: **Ransom Trust**
PO Box 66
Joplin, MO 64802
Matador Randy Allen SWD 1

Send and App. No., or PO Box No.
City, State, ZIP+4[®]

PS Form 3800, April 2015 with PSN 7530-01-000-9047 See Reverse for Instructions

U.S. Postal Service[™]
CERTIFIED MAIL[®] RECEIPT
Domestic Mail Only

For delivery information, visit our website at www.usps.com

OFFICIAL USE

Certified Mail Fee \$
Extra Services & Fees (check box, add fee as appropriate)
☐ Return Receipt (hardcopy) \$
☐ Return Receipt (electronic) \$
☐ Certified Mail Restricted Delivery \$
☐ Adult Signature Required \$
☐ Adult Signature Restricted Delivery \$

Postage \$
Total Postage and Fees \$

Send To: **Robinson Oil Inc.**
PO Box 1829
Eunice, NM 88231
Matador Randy Allen SWD 1

Send and App. No., or PO Box No.
City, State, ZIP+4[®]

PS Form 3800, April 2015 with PSN 7530-01-000-9047 See Reverse for Instructions

U.S. Postal Service[™]
CERTIFIED MAIL[®] RECEIPT
Domestic Mail Only

For delivery information, visit our website at www.usps.com

OFFICIAL USE

Certified Mail Fee \$
Extra Services & Fees (check box, add fee as appropriate)
☐ Return Receipt (hardcopy) \$
☐ Return Receipt (electronic) \$
☐ Certified Mail Restricted Delivery \$
☐ Adult Signature Required \$
☐ Adult Signature Restricted Delivery \$

Postage \$
Total Postage and Fees \$

Send To: **Steve Guyton**
PO box 3195
Midland, TX 79702
Matador Randy Allen SWD 1

Send and App. No., or PO Box No.
City, State, ZIP+4[®]

PS Form 3800, April 2015 with PSN 7530-01-000-9047 See Reverse for Instructions

7016 0750 0000 8802 3654

7016 0750 0000 8802 3652

7016 0750 0000 8802 3739

7016 0750 0000 8802 3661

7016 0750 0000 8802 3704

7016 0750 0000 8802 3746

7016 0750 0000 8802 3678

7016 0750 0000 8802 3715

7016 0750 0000 8802 3753

7016 0750 0000 8802 3722

7016 0750 0000 8802 3777

U.S. Postal Service[™]
CERTIFIED MAIL[®] RECEIPT
 Domestic Mail Only

For delivery information, visit our website at www.usps.com

OFFICIAL USE

Postmark Here

APR 16 2019

582-9991

PS Form 3800, April 2013 with postage changes. See Instructions for details.

7016 0750 0000 8802 3791

U.S. Postal Service[™]
CERTIFIED MAIL[®] RECEIPT
 Domestic Mail Only

For delivery information, visit our website at www.usps.com

OFFICIAL USE

Postmark Here

APR 16 2019

PS Form 3800, April 2013 with postage changes. See Instructions for details.

7016 0750 0000 8802 3784

U.S. Postal Service[™]
CERTIFIED MAIL[®] RECEIPT
 Domestic Mail Only

For delivery information, visit our website at www.usps.com

OFFICIAL USE

Postmark Here

APR 16 2019

PS Form 3800, April 2013 with postage changes. See Instructions for details.

**APPLICATION OF LONGWOOD WATER
MANAGEMENT COMPANY, LLC FOR
AUTHORIZATION TO INJECT INTO THE
RANDY ALLEN FEDERAL SWD No. 1 WELL
FOR PURPOSES OF DISPOSAL, EDDY
COUNTY, NEW MEXICO.**

AFFIDAVIT

Adam G. Rankin, attorney in fact and authorized representative of Longwood Water Management Company, LLC, the Applicant herein, being first duly sworn, upon oath, states that the above-referenced Application has been provided under the notice letters and proof of receipts attached hereto.

SUBSCRIBED AND SWORN to before me this 12th day of June, 2019 by Adam G.
1.

August 26, 2021

BEFORE THE OIL CONSERVATION DIVISION
Santa Fe, New Mexico
Exhibit No. B
Submitted by: **Longwood Water Mngt Co. LLC**
Hearing Date: June 13, 2019
Case No 20484



April 22, 2019

VIA CERTIFIED MAIL
CERTIFIED RECEIPT REQUESTED

TO: AFFECTED PARTIES

**Re: Application of Longwood Water Management Company, LLC For
Authorization to Inject into the Randy Allen Federal SWD No. 1 Well For
Purposes of Disposal, Eddy County, New Mexico.
Randy Allen Federal SWD No. 1 Well**

Ladies & Gentlemen:

This letter is to advise you that Longwood Water Management Company, LLC has filed the enclosed application with the New Mexico Oil Conservation Division. A hearing has been requested before a Division Examiner on June 13, 2019 and the status of the hearing can be monitored through the Division's website at <http://www.emnrd.state.nm.us/ocd/>. Division hearings will commence at 8:15 a.m. in Porter Hall at the Oil Conservation Division's Santa Fe Offices located at 1220 South Saint Francis Drive, Santa Fe, New Mexico 87505. You are not required to attend this hearing, but as an owner of an interest that may be affected by this application, you may appear and present testimony. Failure to appear at that time and become a party of record will preclude you from challenging the matter at a later date.

Parties appearing in cases are required by Division Rule 19.15.4.13.B to file a Pre-hearing Statement four business days in advance of a scheduled hearing. This statement must be filed at the Division's Santa Fe office at the above specified address and should include: the names of the parties and their attorneys; a concise statement of the case; the names of all witnesses the party will call to testify at the hearing; the approximate time the party will need to present its case; and identification of any procedural matters that are to be resolved prior to the hearing.

If you have any questions about this matter please contact Tara Flume at (972) 629-2129 or tflume@matadorresources.com.

Sincerely,

Adam G. Rankin

**ATTORNEY FOR LONGWOOD WATER
MANAGEMENT COMPANY, LLC**



Shipment Confirmation Acceptance Notice

A. Mailer Action

Note to Mailer: The labels and volume associated to this form online, **must** match the labeled packages being presented to the USPS® employee with this form.

Longwood Water Management
Randy Allen Fed SWD No. 1
CM#

Shipment Date: 04/19/2019

Shipped From:

Name: HOLLAND & HART LLP

Address: 110 N GUADALUPE ST # 1

City: SANTA FE

State: NM ZIP+4® 87501

Type of Mail	Volume
Priority Mail Express®*	
Priority Mail®	0
First-Class Package Service®	
Returns	
International*	
Other	11
Total	11

*Start time for products with service guarantees will begin when mail arrives at the local Post Office™ and items receive individual processing and acceptance scans.

B. USPS Action

Note to RSS Clerk:

1. Home screen > Mailing/Shipping > More
2. Select Shipment Confirm
3. Scan or enter the barcode/label number from PS Form 5630
4. Confirm the volume count message by selecting Yes or No
5. Select Pay and End Visit to complete transaction

USPS EMPLOYEE: Please scan upon pickup or receipt of mail.
Leave form with customer or in customer's mail receptacle.

USPS SCAN AT ACCEPTANCE



9275 0901 1935 6200 0013 9947 08



Firm Mailing Book For Accountable Mail

Name and Address of Sender Holland & Hart LLP 110 N Guadalupe St # 1 Santa Fe NM 87501		Check type of mail or service <input type="checkbox"/> Adult Signature Required <input type="checkbox"/> Adult Signature Restricted Delivery <input checked="" type="checkbox"/> Certified Mail <input type="checkbox"/> Certified Mail Restricted Delivery <input type="checkbox"/> Collect on Delivery (COD) <input type="checkbox"/> Insured Mail <input type="checkbox"/> Priority Mail <input type="checkbox"/> Priority Mail Express <input type="checkbox"/> Registered Mail <input type="checkbox"/> Return Receipt for Merchandise <input type="checkbox"/> Signature Confirmation <input type="checkbox"/> Signature Confirmation Restricted Delivery		Affix Stamp Here <i>(if issued as an international certificate of mailing or for additional copies of this receipt).</i> Postmark with Date of Receipt.												
USPS Tracking/Article Number		Addressee (Name, Street, City, State, & ZIP Code™)		Postage	(Extra Service) Fee	Handling Charge	Actual Value if Registered	Insured Value	Due Sender if COD	ASR Fee	ASRD Fee	RD Fee	RR Fee	SC Fee	SCRD Fee	SH Fee
1. 9214 8901 9403 8381 9174 70		Devon Energy Production Company LP 333 W Sheridan Ave Oklahoma City OK 73102-5010		0.95	3.50								1.60			
2. 9214 8901 9403 8381 9174 87		Mewbourne Oil Company PO BOX 5270 Hobbs NM 88241		0.95	3.50								1.60			
3. 9214 8901 9403 8381 9174 94		XTO Holdings LLC 22777 Springwood Village Pkwy Spring TX 77389-1425		0.95	3.50								1.60			
4. 9214 8901 9403 8381 9175 00		Bureau of Land Management 301 Dinosaur Trail Santa Fe NM 87508		0.95	3.50								1.60			
5. 9214 8901 9403 8381 9175 17		Conoco Phillips Company 600 N Dairy Ashford Houston TX 77079		0.95	3.50								1.60			
6. 9214 8901 9403 8381 9175 24		Ague Suda LLC 14605 S Memorial Dr Bixby OK 74006-3767		0.95	3.50								1.60			
7. 9214 8901 9403 8381 9175 31		EOG Resources Inc 1111 Bagby Sky Lobby 2 Houston TX 77002		0.95	3.50								1.60			
8. 9214 8901 9403 8381 9175 48		Pennco Oil Corp PO BOX 5970 Hobbs NM 88241-5970		0.95	3.50								1.60			
Total Number of Pieces Listed by Sender 11		Postmaster, Per (Name of receiving employee)														



Firm Mailing Book For Accountable Mail

[illegible]

**Return address:**

HOLLAND & HART LLP
P.O. BOX 2208
SANTA FE, NM 87504-2208

Recipient address:

BUREAU OF LAND MANAGEMENT
301 DINOSAUR TRAIL
SANTA FE NM 87508

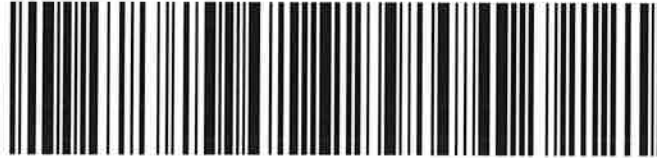
USPS CERTIFIED MAIL

9214 8901 9403 8381 9175 00

USPS Tracking Label Number: 9214 8901 9403 8381 9175 00

USPS Tracking History	Postal Facility	ZIP	Date	Time
PRE-SHIPMENT INFO SENT USPS AWAITS ITEM		SANTA FE,NM 87501		04/19/2019 13:06
SHIPMENT RECEIVED ACCEPTANCE PENDING		SANTA FE,NM 87501		04/22/2019 16:47
ORIGIN ACCEPTANCE		SANTA FE,NM 87501		04/22/2019 19:45
PROCESSED THROUGH USPS FACILITY		ALBUQUERQUE,NM 87101		04/22/2019 21:00
DEPART USPS FACILITY		ALBUQUERQUE,NM 87101		04/22/2019 21:25
PROCESSED THROUGH USPS FACILITY		ALBUQUERQUE,NM 87101		04/23/2019 18:15

ORIGIN ACCEPTANCE:

PROOF OF ACCEPTANCE
(ELECTRONIC)

PRODUCED DATE: 06/07/2019

HOLLAND & HART LLP:

The following is information for Certified Mail™/RRE item number:
9214 8901 9403 8381 9175 17

Our records indicate that this item was accepted by the USPS at:
ORIGIN ACCEPTANCE SANTA FE,NM 87501 04/22/2019

ORIGINAL INTENDED RECIPIENT:
CONOCO PHILLIPS COMPANY
600 N DAIRY ASHFORD
HOUSTON TX 77079

**Return address:**

HOLLAND & HART LLP
P.O. BOX 2208
SANTA FE, NM 87504-2208

Recipient address:

CONOCO PHILLIPS COMPANY
600 N DAIRY ASHFORD
HOUSTON TX 77079

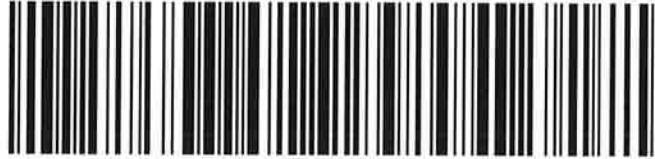
USPS CERTIFIED MAIL**9214 8901 9403 8381 9175 17****USPS Tracking Label Number: 9214 8901 9403 8381 9175 17**

USPS Tracking History	Postal Facility	ZIP	Date	Time
PRE-SHIPMENT INFO SENT USPS AWAITS ITEM		SANTA FE,NM 87501		04/19/2019 13:06
SHIPMENT RECEIVED ACCEPTANCE PENDING		SANTA FE,NM 87501		04/22/2019 16:47
ORIGIN ACCEPTANCE		SANTA FE,NM 87501		04/22/2019 19:45
PROCESSED THROUGH USPS FACILITY		ALBUQUERQUE,NM 87101		04/22/2019 21:00
DEPART USPS FACILITY		ALBUQUERQUE,NM 87101		04/22/2019 21:25
PROCESSED THROUGH USPS FACILITY		NORTH HOUSTON,TX 77315		04/24/2019 12:49
PROCESSED THROUGH USPS FACILITY		ALBUQUERQUE,NM 87101		04/26/2019 13:48
PROCESSED THROUGH USPS FACILITY		NORTH HOUSTON,TX 77315		04/28/2019 11:45
PROCESSED THROUGH USPS FACILITY		NORTH HOUSTON,TX 77315		04/29/2019 18:15
PROCESSED THROUGH USPS FACILITY		ALBUQUERQUE,NM 87101		05/01/2019 13:48
PROCESSED THROUGH USPS FACILITY		NORTH HOUSTON,TX 77315		05/03/2019 11:10

ORIGIN ACCEPTANCE:

POSTAL DELIVERY REPORT
RANDY ALLEN
CASE NO. 20484

Recipient	Status	Custom
Devon Energy Production Company LP 333 W Sheridan Ave Oklahoma City OK 73102-5010	Delivered Signature Received	Ref#: C1336919.7544219 RetRef#:
Mewbourne Oil Company PO BOX 5270 Hobbs NM 88241	Delivered Signature Received	Ref#: C1336919.7544220 RetRef#:
XTO Holdings LLC 22777 Springwood Village Pkwy Spring TX 77389-1425	Delivered Signature Received	Ref#: C1336919.7544221 RetRef#:
Bureau of Land Management 301 Dinosaur Trail Santa Fe NM 87508	In-Transit	Ref#: C1336919.7544222 RetRef#:
Conoco Phillips Company 600 N Dairy Ashford Houston TX 77079	In-Transit	Ref#: C1336919.7544223 RetRef#:
Agua Sucia LLC 14605 S Memorial Dr Bixby OK 74008-3767	In-Transit	Ref#: C1336919.7544224 RetRef#:
EOG Resources Inc 1111 Bagby Sky Lobby 2 Houston TX 77002	Delivered Signature Received	Ref#: C1336919.7544225 RetRef#:
Penroc Oil Corp PO BOX 5970 Hobbs NM 88241-5970	Delivered Signature Received	Ref#: C1336919.7544226 RetRef#:
Saga Petroleum LTD 200 N Loraine Street #1300 Midland TX 79701-4779	In-Transit	Ref#: C1336919.7544227 RetRef#:
Occidental Permian LP 5 E Greenway Plaza #110 Houston TX 77046-0521	Delivered Signature Received	Ref#: C1336919.7544228 RetRef#:
Sahara Operating Company PO BOX 4130 Midland TX 79704	Delivered Signature Received	Ref#: C1336919.7544229 RetRef#:

CARLSBAD
CURRENT-ARGUS

AFFIDAVIT OF PUBLICATION

Ad No.
0001284559

HOLLAND & HART
PO BOX 2208

SANTA FE NM 87504

I, a legal clerk of the **Carlsbad Current-Argus**, a newspaper published daily at the City of Carlsbad, in said county of Eddy, state of New Mexico and of general paid circulation in said county; that the same is a duly qualified newspaper under the laws of the State wherein legal notices and advertisements may be published; that the printed notice attached hereto was published in the regular and entire edition of said newspaper and not in supplement thereof on the date as follows, to wit:

04/30/19

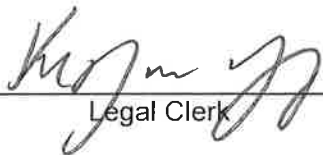
Legal Clerk

Subscribed and sworn before me this
30th of April 2019.

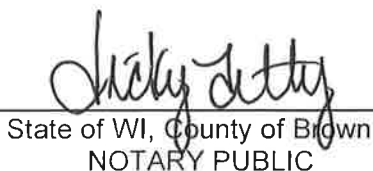
State of WI, County of Brown
NOTARY PUBLIC

My Commission Expires

Ad#:0001284559
P O : 0001284559
of Affidavits :0.00



**STATE OF NEW MEXICO
ENERGY, MINERALS AND NATURAL RESOURCES
DEPARTMENT
OIL CONSERVATION DIVISION
SANTA FE, NEW MEXICO**

The State of New Mexico through its Oil Conservation Division hereby gives notice pursuant to law and the Rules and Regulations of the Division of the following public hearing to be held at 8:15 A.M. on **June 13, 2019** in the Oil Conservation Division Hearing Room at 1220 South St. Francis, Santa Fe, New Mexico, before an examiner duly appoint for the hearing. If you are an individual with a disability who is in need of a reader, amplifier, qualified sign language interpreter, or any other form of auxiliary aid or service to attend or participate in the hearing, please contact: Florene Davidson at 505-476-3458 or through the New Mexico Relay Network, 1-800-659-1779 by **June 3, 2019**. Public documents, including the agenda and minutes, can be provided in various accessible forms. Please contact Florene Davidson if a summary or other type of accessible form is needed.

**STATE OF NEW MEXICO TO:
All named parties and persons
having any right, title, interest
or claim in the following case
and notice to the public.**

(NOTE: All land descriptions herein refer to the New Mexico Principal Meridian whether or not so stated.)

To:All affected parties, including: Devon Energy Production Company, LP; Mewbourne Oil Company; XTO Holdings, LLC; Bureau of Land Management; Conoco Phillips Company; Agu Sucia, LLC; EOG Resources, Inc.; Penroc Oil Corp.; Saga Petroleum, LTD; Occidental Petroleum, LP; Sahara Operating Company.

Case No. 20484: Application of Longwood Water Management Company, LLC For Authorization to Inject into the Randy Allen Federal SWD No. 1 Well For Purposes of Disposal, Eddy County, New Mexico. Applicant in the above-styled cause seeks an order authorizing it to drill and operate an injection well for purposes of disposing produced salt water to be named the **Randy Allen Federal SWD No. 1 Well** (API No. 30-015-pending), to be located 133 feet from the south line and 2,588 feet from the east line (Unit O), Section 12, Township 26 South, Range 31 East, NMPM, Eddy County, New Mexico. Injection would be into the Devonian formation through an open-hole completion between 16,883 feet and 17,863 feet. Disposal fluid will be produced water from producing oil and gas wells in the area. Average disposal volume will be 40,000 bpd with a maximum of 45,000 bpd. Average injection pressure will be 2,500 psi with a maximum injection

tion pressure of 3,376 psi. The subject well will be located approximately 21 miles southeast of Malaga, N.M.

Fault-Slip Probability Assessment for the Randy Allen Federal SWD #1

Dr. Edmund L Frost III, Vice President—Geoscience

In order to minimize the potential risk of induced seismicity associated with deep waste water disposal, Longwood Water Management Company, LLC (“LWMC”) has undertaken a study to characterize the fault-slip potential for the Randy Allen Federal SWD #1 in Eddy County, New Mexico. This document presents the results of an eight well model, which investigates the impact of waste water injection at a rate of 40,000 bbl/day until 2050 (Figure 1a, Table 1). This study utilizes a mix of public and proprietary data in conjunction with the Stanford Center for Induced and Triggered Seismicity’s (SCITS) Fault Slip Potential (FSP; Walsh et al., 2017) code (table 2).

The model presented here interrogates the stability of a population of 500 stochastically oriented, and located, faults. The orientations (strike, dip) of the model fault population are constrained by data from 26 regional basement faults mapped by LWMC in the Randy Allen Federal SWD#1 area on a 48 mi² proprietary PSTM 3D seismic volume. A maximum horizontal stress orientation of N35°E. was taken from published regional stress orientations (Lund Snee and Zoback 2018). Horizontal stress magnitudes were not modeled explicitly by LWMC, instead the published A_0 value of 0.52 (Lund Snee and Zoback 2018; Table 2) for southern Eddy County, New Mexico was used, which implies a pure normal faulting environment.

The impact of high-rate injection in the eight-well case can be seen as a modest regional increase in pore pressure with time (Figure 1b). At the Randy Allen Federal SWD #1, the model predicts a maximum reservoir pressure increase of 209 psi by year 2050. At the modelled depth of 16,750 ft, this translates to a pore pressure gradient increase of 0.012 psi/ft. Results of the geomechanical modeling show that all faults have a “distance to failure” of greater than 650 psi; meaning that aquifer pore pressure would need to be increased by greater than 650 psi at a given fault plane to potentially induce failure. The results of the model case presented here are well below this limit. Based on the simulation run by this study, the overall probability of fault slip is less than 10% well into the future (2050), even with multiple high-volume injectors spaced roughly one mile apart. However, caution still needs to be exercised to avoid injection near unstable features. In order to minimize risk, Matador screens all of its SWD locations, including the Randy Allen Federal SWD #1, against its 3D seismic to avoid injection near faults.

BEFORE THE OIL CONSERVATION DIVISION

Santa Fe, New Mexico

Exhibit No. C

Submitted by: Longwood Water Mngt Co. LLC

Hearing Date: June 13, 2019

Case No 20484

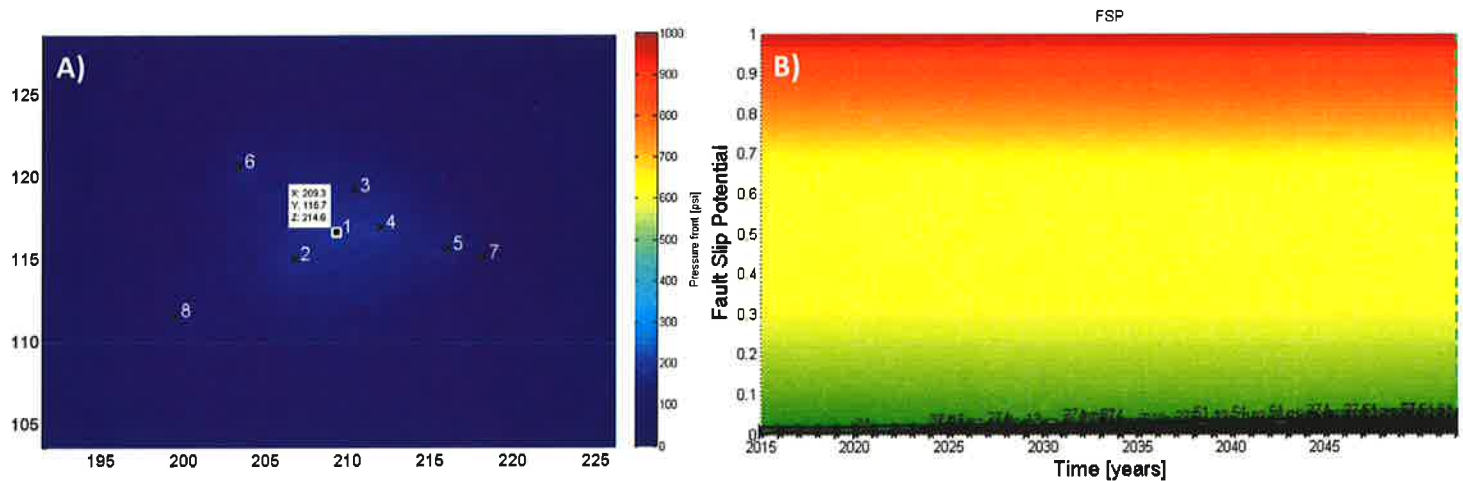

Figure 1: A) Modeled reservoir pressure for the eight-well case at year 2050. A maximum pressure of 209 psi is observed at Randy Allen Federal SWD #1. B) Fault slip potential (FSP) for the eight-well case. On all faults FSP remains below 10%. The green dashed line marks year 2050, the black lines and numbers denote the slip probability of individual faults.

#	Well Name	Modeled Volume (bbl/d)	Start	End
1	Randy Allen Federal SWD #1	40,000	2020	2050
2	Jack Hammack Federal SWD #1*	40,000	2020	2050
3	Paduca 6 SWD #1Y	40,000	2017	2047
4	Red Hills West SWD #2	40,000	2020	2050
5	Maelstrom Federal SWD #1	40,000	2020	2050
6	Poker Lake Unit Big Sinks 32 State SWD #11	40,000	2020	2050
7	Salado Draw SWD 13 #1	40,000	2015	2017
8	Brinninstool SWD #4	40,000	2020	2050

Table 1: Well Data for FSP Modeling. Well numbers correspond to wells in Figure 1.

* The C-108 permit application for the Jack Hammack Federal SWD #1 has not yet been filed, but Longwood Water Management Company, LLC anticipates filing a permit application for this well in the near future and has included it in this analysis.

Parameter	Input Value	Variability (+/-)	Data Source
Vertical Stress Gradient	1.05 psi/ft	0.05 psi/ft	Pilot Hole
Shmax	N 35° E	5°	Pilot Hole
Fault Strike	variable	10°	3D Seismic
Fault Dip	variable	5°	3D Seismic
Reference Depth	13500 ft	na	Pilot Hole, 3D Seismic, Regional Mapping
Initial Reservoir Pressure Gradient	0.43 psi/ft	0.03 psi/ft	Pilot Hole
A Phi Parameter	0.52	0.03	Lund Snee and Zoback 2018
Reference Friction Coefficient	0.6	0.01	Standard Value
Aquifer Thickness	1000 ft	200	Pilot Hole, Regional Mapping
Porosity	6%	2%	Pilot Hole
Permeability	150 mD	100 mD	Pilot Hole, Step-Rate Tests
Fluid Density	1029 kg/m³	10 kg/m³	Assumed value
Dynamic Viscosity	0.0004 Pa. S	0.0001 Pa. S	Calculated value corrected for reservoir temperature

Table 2: Model Inputs, Variance, and Source.