

BEFORE THE NEW MEXICO OIL CONSERVATION DIVISION

**APPLICATION OF TROVE ENERGY AND WATER,
LLC FOR APPROVAL OF A SALT WATER DISPOSAL
WELL, LEA COUNTY, NEW MEXICO.**

Case No. _____

APPLICATION

Trove Energy and Water, LLC applies for an order approving a salt water disposal well, and in support thereof, states:

1. Applicant proposes to drill the FLC South Fed. SWD Well No. 1, located 225 feet from the south line and 50 feet from the west line of Section 26, Township 26 South, Range 32 East, N.M.P.M., Lea County, New Mexico.
2. Applicant proposes to dispose produced water into the Devonian formation in the well at depths of 17300 – 19000 feet subsurface.
3. A Form C-108 for the subject well is attached hereto as Exhibit A.
4. The granting of this application will prevent waste and protect correlative rights.

WHEREFORE, applicant requests that, after notice and hearing, the Division enter its order approving this application.

Respectfully submitted,

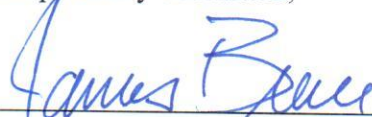

James Bruce
Post Office Box 1056
Santa Fe, New Mexico 87504
(505) 982-2043

Attorney for Trove Energy and Water, LLC

RECEIVED:	REVIEWER:	TYPE:	APP NO:
-----------	-----------	-------	---------

ABOVE THIS TABLE FOR OCD DIVISION USE ONLY

NEW MEXICO OIL CONSERVATION DIVISION
 - Geological & Engineering Bureau -
 1220 South St. Francis Drive, Santa Fe, NM 87505

**ADMINISTRATIVE APPLICATION CHECKLIST**

THIS CHECKLIST IS MANDATORY FOR ALL ADMINISTRATIVE APPLICATIONS FOR EXCEPTIONS TO DIVISION RULES AND
 REGULATIONS WHICH REQUIRE PROCESSING AT THE DIVISION LEVEL IN SANTA FE

Applicant: Trove Energy and Water, LLC**OGRID Number:** 372488**Well Name:** FLC South Federal SWD No.1**API:** 30-025-xxxxx**Pool:** Proposed: SWD; Devonian-Silurian**Pool Code:** 97869

**SUBMIT ACCURATE AND COMPLETE INFORMATION REQUIRED TO PROCESS THE TYPE OF APPLICATION
 INDICATED BELOW**

1) TYPE OF APPLICATION: Check those which apply for [A]

A. Location – Spacing Unit – Simultaneous Dedication

☐ NSL☐ NSP (PROJECT AREA)☐ NSP (PRORATION UNIT)☐ SD

B. Check one only for [I] or [II]

[I] Commingling – Storage – Measurement

☐ DHC☐ CTB☐ PLC☐ PC☐ OLS☐ OLM

[II] Injection – Disposal – Pressure Increase – Enhanced Oil Recovery

☐ WFX☐ PMX☒ SWD☐ IPI☐ EOR☐ PPR**2) NOTIFICATION REQUIRED TO:** Check those which apply.A. ☒ Offset operators or lease holdersB. ☐ Royalty, overriding royalty owners, revenue ownersC. ☒ Application requires published noticeD. ☒ Notification and/or concurrent approval by SLOE. ☒ Notification and/or concurrent approval by BLMF. ☒ Surface ownerG. ☒ For all of the above, proof of notification or publication is attached, and/or,H. ☐ No notice required**FOR OCD ONLY**☐ Notice Complete☐ Application
Content
Complete

3) CERTIFICATION: I hereby certify that the information submitted with this application for administrative approval is **accurate** and **complete** to the best of my knowledge. I also understand that **no action** will be taken on this application until the required information and notifications are submitted to the Division.

Note: Statement must be completed by an individual with managerial and/or supervisory capacity.

Ben Stone

5/09/2019

Date

Print or Type Name

903-488-9850

Phone Number

Signature

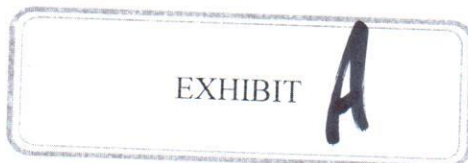

ben@sosconsulting.us

e-mail Address



May 9, 2019

New Mexico Oil Conservation Division
1220 South St. Francis Drive
Santa Fe, New Mexico 87505

Attn: Ms. Adrienne Sandoval, Director

Re: Application of Trove Energy and Water, LLC to permit for salt water disposal the proposed FLC South Federal SWD No.1, located in Section 26, Township 26 South, Range 32 East, NMPM, Lea County, New Mexico.

Dear Ms. Sandoval,

Please find the enclosed form C-108 Application for Authority to Inject, supporting the above-referenced request for salt water disposal. The well will be operated as a commercial endeavor offering operators in the area additional options for produced water disposal.

Trove Energy and Water is a developing salt water disposal services to operators in southeast New Mexico and seeks to optimize efficiency, both economically and operationally, of all its operations. Approval of this application is consistent with that goal as well as the NMOCD's mission of preventing waste and protection of correlative rights.

This application for a proposed Devonian SWD interval includes the currently mandated increased One-Mile Area of Review including pertinent and available seismic information for the area and region. Published legal notice ran May 1, 2019 in the Hobbs News-Sun and all offset operators and other affected parties have been notified individually. The legal notice affidavit is included with this application. The application also includes a wellbore schematic, area of review maps, affected party plat and other required information for a complete Form C-108. The well is located on federal surface and minerals and the Bureau of Land Management CFO and offset operators have been notified of this application.

I respectfully request that the approval of this salt water disposal well proceed swiftly and if you or your staff requires additional information or has any questions, please do not hesitate to call or email me.

Best regards,

Ben Stone, Partner
SOS Consulting, LLC
Agent for Trove Energy and Water, LLC

Cc: Application attachment and file

APPLICATION FOR AUTHORIZATION TO INJECT

- I. PURPOSE: *Salt Water Disposal* and the application *QUALIFIES* for administrative approval.
- II. OPERATOR: *Trove Energy and Water, LLC*
ADDRESS: *1919 North Turner, Hobbs, NM 88240*

CONTACT PARTY: *Agent: SOS Consulting, LLC – Ben Stone (903) 488-9850*
- III. WELL DATA: *All well data and applicable wellbore diagrams are ATTACHED.*
- IV. *This is not an expansion of an existing project.*
- V. *A map is attached that identifies all wells and leases within two miles of any proposed injection well with a ONE-Mile radius circle drawn around each proposed injection well. This circle identifies the well's area of review.*
- *VI. A tabulation is attached of data on all wells of public record within the area of review which penetrate the proposed injection zone. *There are NO (0) Wells in the subject AOR which Penetrate the proposed Devonian interval.* The data includes a description of each well's type, construction, date drilled, location, depth, and a schematic of any plugged well illustrating all plugging detail. *NO P&A Wells penetrate.*
- VII. *The following data is ATTACHED on the proposed operation, including:*
1. Proposed average and maximum daily rate and volume of fluids to be injected;
 2. Whether the system is open or closed;
 3. Proposed average and maximum injection pressure;
 4. Sources and an appropriate analysis of injection fluid and compatibility with the receiving formation if other than reinjected produced water; and,
 5. If injection is for disposal purposes into a zone not productive of oil or gas at or within one mile of the proposed well, attach a chemical analysis of the disposal zone formation water (may be measured or inferred from existing literature, studies, nearby wells, etc.).
- *VIII. *Appropriate geologic data on the injection zone is ATTACHED including appropriate lithologic detail, geologic name, thickness, and depth. Give the geologic name, and depth to bottom of all underground sources of drinking water (aquifers containing waters with total dissolved solids concentrations of 10,000 mg/l or less) overlying the proposed injection zone as well as any such sources known to be immediately underlying the injection interval.*
- IX. *Stimulation program – a conventional acid job may be performed to clean and open the formation.*
- *X. Attach appropriate logging and test data on the well. (If well logs have been filed with the Division, they need not be resubmitted). *Well Logs will be filed with OCD.*
- *XI. *There are NO water wells/ PODs within one mile of the proposed salt water disposal well. Representative analyses are ATTACHED.*
- XII. *An affirmative statement is ATTACHED that available geologic and engineering data has been examined and no evidence was found of open faults or any other hydrologic connection between the disposal zone and any underground sources of drinking water.*
- XIII. *"Proof of Notice" section on the next page of this form has been completed and ATTACHED. There are 3 offset lessees and/or mineral owners within 1 mile and state and federal minerals and the state of Texas (RRC) - all have been noticed. Well location is Federal.*
- XIV. Certification: I hereby certify that the information submitted with this application is true and correct to the best of my knowledge and belief.

NAME: *Ben Stone* TITLE: *SOS Consulting, LLC agent for Trove Energy and Water, LLC*

SIGNATURE:  DATE: *5/08/2019*

E-MAIL ADDRESS: *ben@sosconsulting.us*

* If the information required under Sections VI, VIII, X, and XI above has been previously submitted, it need not be resubmitted. Please show the date and circumstances of the earlier submittal:

DISTRIBUTION: Original and one copy to Santa Fe with one copy to the appropriate District Office

FORM C-108 – APPLICATION FOR AUTHORIZATION TO INJECT (cont.)

III. WELL DATA – *The following information and data is included (See ATTACHED Wellbore Schematic):*

A. The following well data must be submitted for each injection well covered by this application. The data must be both in tabular and schematic form and shall include:

- (1) Lease name; Well No., Location by Section, Township and Range; and footage location within the section.
- (2) Each casing string used with its size, setting depth, sacks of cement used, hole size, top of cement, and how such top was determined.
- (3) A description of the tubing to be used including its size, lining material, and setting depth.
- (4) The name, model, and setting depth of the packer used or a description of any other seal system or assembly used.

Division District Offices have supplies of Well Data Sheets which may be used or which may be used as models for this purpose. Applicants for several identical wells may submit a "typical data sheet" rather than submitting the data for each well.

B. The following must be submitted for each injection well covered by this application. All items must be addressed for the initial well. Responses for additional wells need be shown only when different. Information shown on schematics need not be repeated.

- (1) The name of the injection formation and, if applicable, the field or pool name.
- (2) The injection interval and whether it is perforated or open-hole.
- (3) State if the well was drilled for injection or, if not, the original purpose of the well.
- (4) Give the depths of any other perforated intervals and detail on the sacks of cement or bridge plugs used to seal off such perforations.
- (5) Give the depth to and the name of the next higher and next lower oil or gas zone in the area of the well, if any.

XIV. PROOF OF NOTICE *pursuant to the following criteria is ATTACHED.*

All applicants must furnish proof that a copy of the application has been furnished, by certified or registered mail, to the owner of the surface of the land on which the well is to be located and to each leasehold operator within one-half mile of the well location.

Where an application is subject to administrative approval, a proof of publication must be submitted. Such proof shall consist of a copy of the legal advertisement which was published in the county in which the well is located. The contents of such advertisement must include:

- (1) The name, address, phone number, and contact party for the applicant;
- (2) The intended purpose of the injection well; with the exact location of single wells or the Section, Township, and Range location of multiple wells;
- (3) The formation name and depth with expected maximum injection rates and pressures; and,
- (4) A notation that interested parties must file objections or requests for hearing with the Oil Conservation Division, 1220 South St. Francis Dr., Santa Fe, New Mexico 87505, within 15 days.

NO ACTION WILL BE TAKEN ON THE APPLICATION UNTIL PROPER PROOF OF NOTICE HAS BEEN SUBMITTED.

NOTICE: Surface owners or offset operators must file any objections or requests for hearing of administrative applications within 15 days from the date this application was mailed to them.

C-108 - Items III, IV, V

Item III - Subject Well Data

Wellbore Diagram - PROPOSED

Item IV – Tabulation of AOR Wells

NO wells penetrate the proposed injection interval.

Item V – Area of Review Maps

1. Two Mile AOR Map with One-Mile Fresh Water Well Radius
2. One-Half Mile AOR Map

All Above Exhibits follow this page.



WELL SCHEMATIC - PROPOSED **FLC South Federal SWD Well No.1**

API 30-025-xxxxx
 225' FSL & 50' FWL, SEC. 26-T26S-R32E
 LEA COUNTY, NEW MEXICO

SWD: Devonian-Silurian (97869)
 Spud Date: 1/15/2020
 SWD Config Dt: 3/01/2020

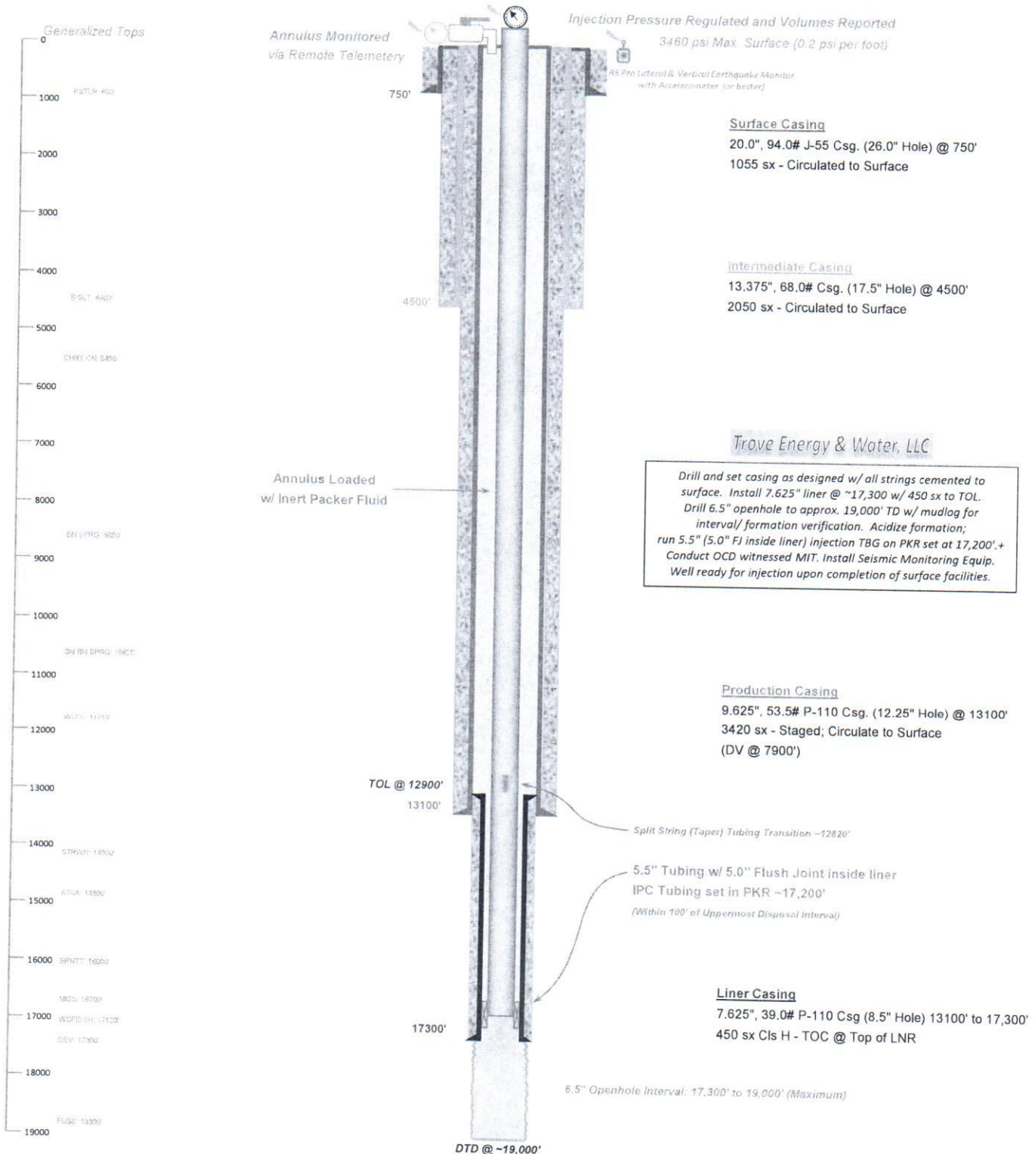

Trove Energy & Water, LLC

Drill and set casing as designed w/ all strings cemented to surface. Install 7.625" liner @ ~17,300 w/ 450 sx to TOL. Drill 6.5" openhole to approx. 19,000' TD w/ mudlog for interval/formation verification. Acidize formation; run 5.5" (5.0" FJ inside liner) injection TBG on PKR set at 17,200'.+ Conduct OCD witnessed MIT. Install Seismic Monitoring Equip. Well ready for injection upon completion of surface facilities.

Drawn by: Ben Stone, 5/07/2019



FLC South Federal SWD No.1 - Area of Review / 2 Miles

(Attachment to NMOCD Form C-108 - Item V)

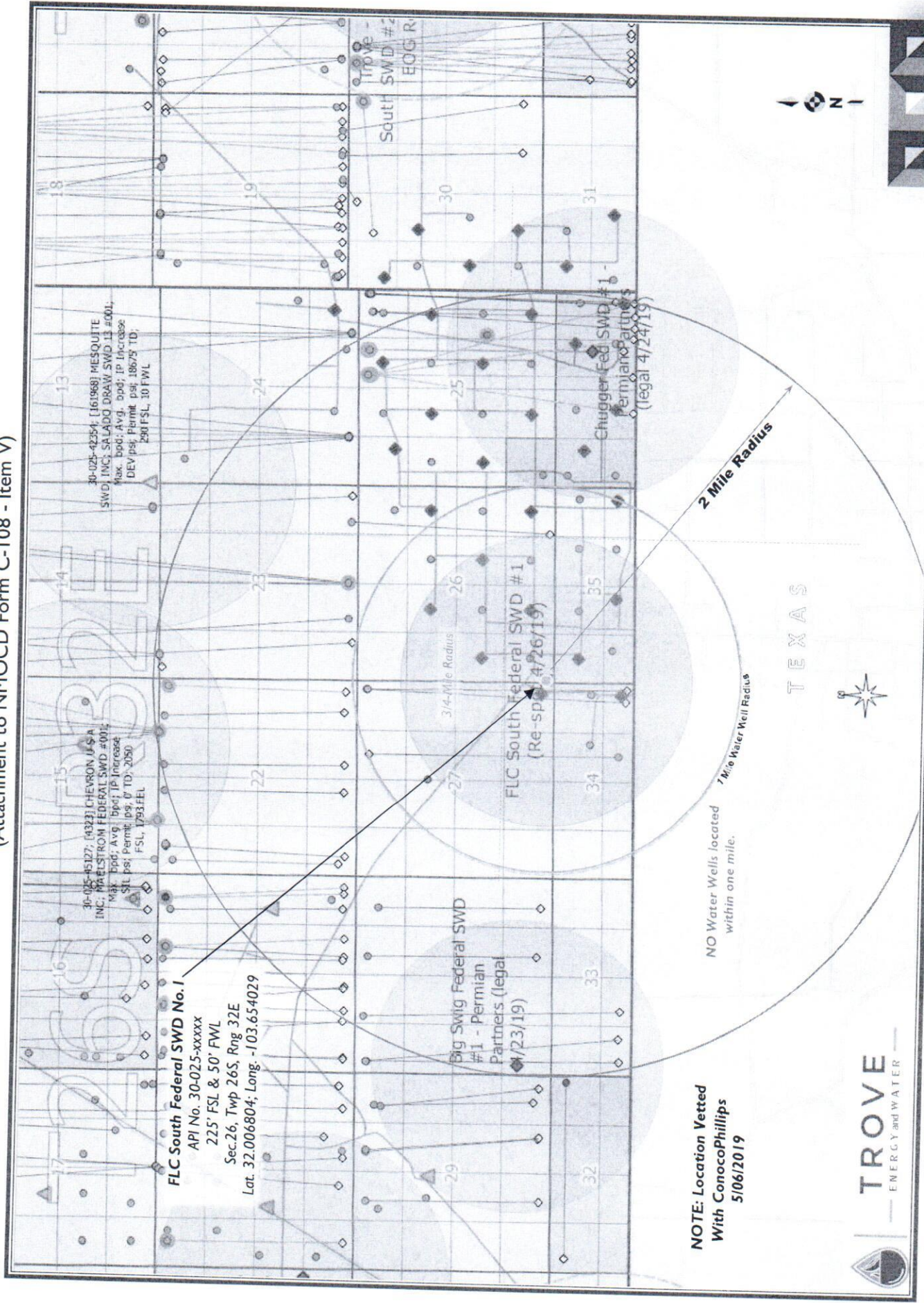

NOTE: Location Vetted
With ConocoPhillips
5/06/2019



FLC South Federal SWD Well No.1 – One Mile Area of Review / Overview Map

(Attachment to NMOCD Form C-108, Application for Authority to Inject.)

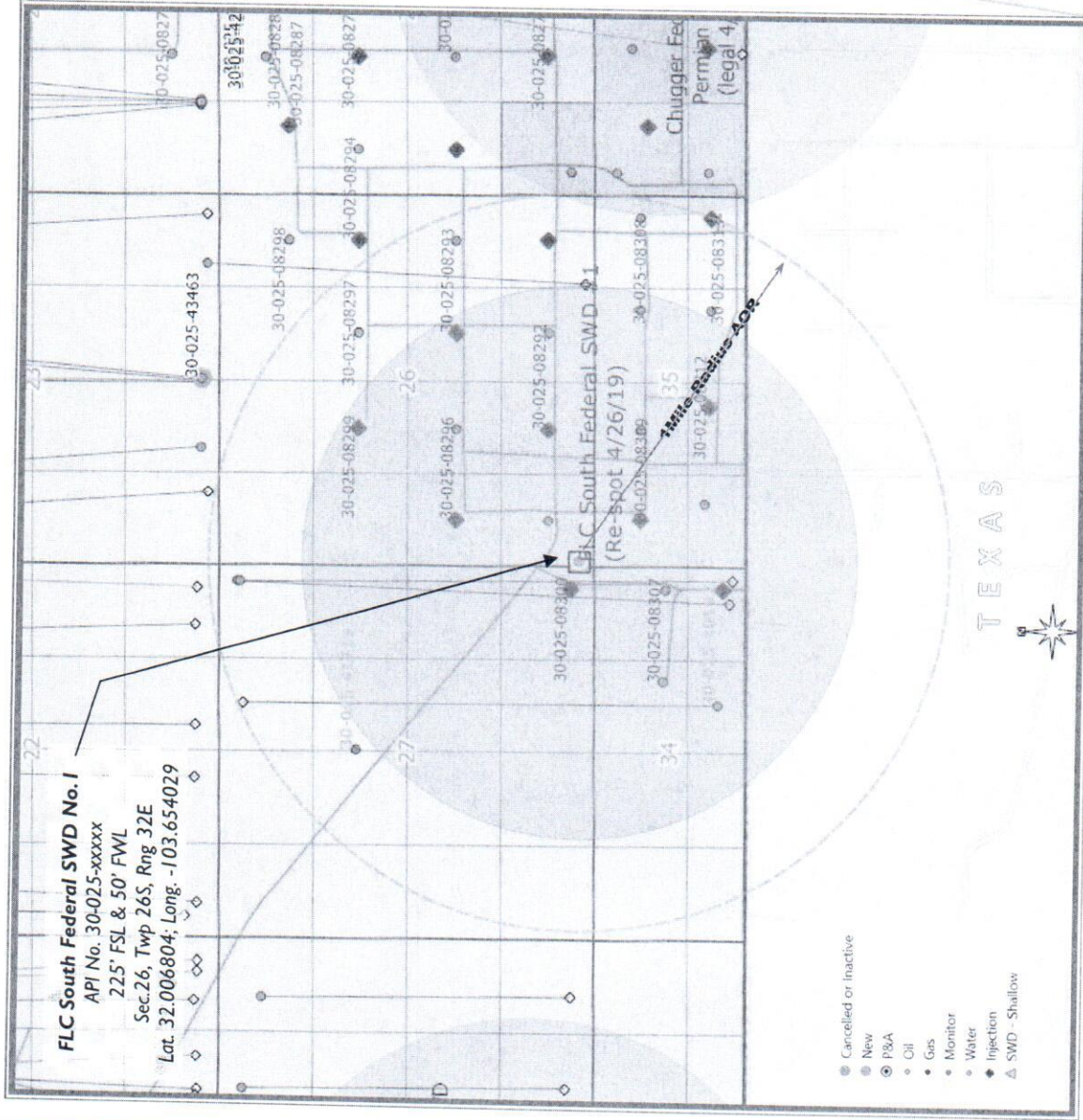

28.1 miles W/SW of Jal, NM

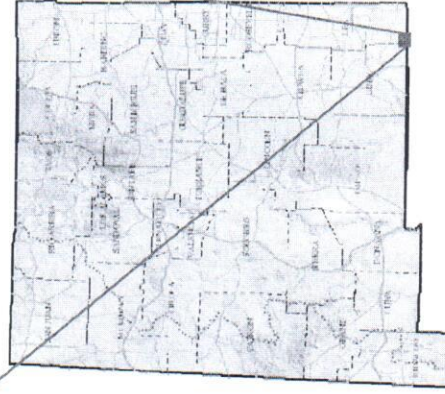
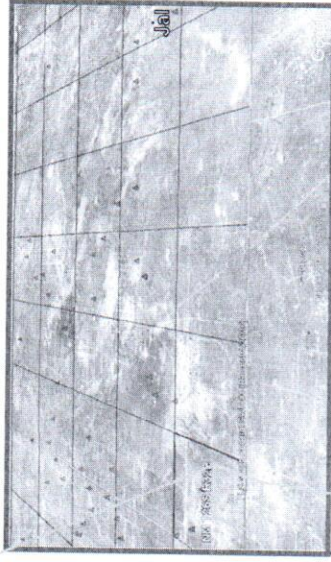

Lea County, New Mexico



C-108 ITEM X

LOGS and AVAILABLE TEST DATA

A Standard Suite of Logs will be run after
drilling the well and submitted to the Division.

C-108 ITEM VII – PROPOSED OPERATION

Note: All Trove Energy and Water FLC South SWD Prospects were vetted with ConocoPhillips Review Team for compatibility with their development plans.

Trove FLC South Federal SWD #1

Commercial SWD Facility

Upon approval of all permits for SWD, operations would begin within 30 days. Completion of the well operations will take approximately 6-8 weeks. Facility construction including installation of the tank battery, berms, plumbing and other and associated equipment would be occurring during the same interval but at a different location from the well. In any event, it is not expected for the construction phase of the project to last more than 60 days, depending on availability of contractors and equipment.

Configure for Salt Water Disposal

Prior to commencing any work, an NOI sundry(ies) will be submitted to configure the well for SWD and will detail the completion workover including all work otherwise described above, any change to the procedure noted herein and to perform mechanical integrity pressure test per OCD test procedures. (Notify NMOCD 24 hours prior.) The casing/tubing annulus will be monitored for communication with injection fluid or loss of casing integrity. In addition to operational SCADA system control and monitoring, Trove will install RS Pro Lateral & Vertical Earthquake Monitors with Accelerometer, or better for continuous monitoring. Data will be remotely accessible; monitored and shared as needed.

Operational Summary

The SWD facility will not be fenced so that trucks may access for load disposal 24/7.

Ultimately, Trove's plans would include tying the SWD into a pipeline so the well and injection equipment will be a closed system and equipped with pressure limiting devices and volume meters. The annulus, loaded with an inert, anti-corrosion packer fluid, will be monitored for pressure.

The facility and tanks will be equipped with telemetry devices and visual alarms to alert the operator and customers of full tanks or an overflow situation.

Anticipated daily maximum volume is 30,000 bpd and an average of 17,500 bpd at a maximum surface injection pressure of 3460 psi (.2 psi/ft gradient – maximum pressure will be adjusted if the top of interval is modified after well logs are run).

Potential releases will be contained and cleaned up immediately. The operator shall repair or otherwise correct the situation within 48 hours before resuming operations. OCD will be notified within 24 hours of any release greater than 5 bbls. If required, remediation will start as soon as practicable. Operator shall comply with 19.15.29 NMAC and 19.15.30 NMAC; as necessary and appropriate and OCD form C-141 will be submitted promptly.

C-108 ITEM VII – PRODUCED WATER ANALYSES

Item VII.4 – Water Analysis of Source Zone Water

Delaware
Bone Spring
Wolfcamp

Item VII.5 – Water Analysis of Disposal Zone Water

Devonian

Water Analyses follow this page.

C-108 Item VII.5 - Produced Water Data
Trove Energy & Water, LLC - FLC South Federal Project Area

SOURCE ZONE

DELAWARE

API No	3001510181	Lab ID	
Well Name	SUPERIOR STATE 002	Sample ID	5532
		Sample No	
Location	ULSTR 08 25 S 30 E	Lat / Long	32.14281 -103.89616
	1980 S 660 E	County	Eddy
Operator (when sampled)			
	Field CORRAL CANYON	Unit	I
Sample Date		Analysis Date	
	Sample Source SWAB	Depth (if known)	
	Water Typ		
ph		alkalinity_as_caco3_mgL	
ph_temp_F		hardness_as_caco3_mgL	
specificgravity		hardness_mgL	
specificgravity_temp_F		resistivity_ohm_cm	
tds_mgL	155173	resistivity_ohm_cm_temp	
tds_mgL_180C		conductivity	
chloride_mgL	92820	conductivity_temp_F	
sodium_mgL		carbonate_mgL	
calcium_mgL		bicarbonate_mgL	122
iron_mgL		sulfate_mgL	133
barium_mgL		hydroxide_mgL	
magnesium_mgL		h2s_mgL	
potassium_mgL		co2_mgL	
strontium_mgL		o2_mgL	
manganese_mgL		anionremarks	
Remarks			

(Produced water data courtesy of NMT Octane NM WAIDS database.)



C-108 Item VII.5 - Produced Water Data
Trove Energy & Water, LLC - FLC South Federal Project Area

SOURCE ZONE

BONE SPRING

API No	3002533529	Lab ID	
Well Name	THYME APY FEDERAL 002	Sample ID	6681
Location	ULSTR 01 23 S 32 E 1650 N 1650 E	Lat / Long	32.33657 -103.62470
Operator (when sampled)		County	Lea
Field	RED TANK	Unit	G
Sample Date	11/27/2001	Analysis Date	
Sample Source		Depth (if known)	
Water Typ			
ph	6.1	alkalinity_as_caco3_mgL	
ph_temp_F		hardness_as_caco3_mgL	
specificgravity	1.15	hardness_mgL	
specificgravity_temp_F		resistivity_ohm_cm	
tds_mgL	172896	resistivity_ohm_cm_temp	
tds_mgL_180C		conductivity	
chloride_mgL	104976	conductivity_temp_F	
sodium_mgL		carbonate_mgL	
calcium_mgL	0	bicarbonate_mgL	781
iron_mgL	0	sulfate_mgL	1150
barium_mgL	0	hydroxide_mgL	
magnesium_mgL	2025	h2s_mgL	0
potassium_mgL		co2_mgL	
strontium_mgL		o2_mgL	
manganese_mgL		anionremarks	
Remarks			

(Produced water data courtesy of NMT Octane NM WAIDS database.)



C-108 Item VII.5 - Produced Water Data
Trove Energy & Water, LLC - FLC South Federal Project Area

SOURCE ZONE

WOLFCAMP

API No	3002501678	Lab ID	
Well Name	LAGUNA PLATA FEDERAL UNIT 001	Sample ID	5096
		Sample No	
Location	ULSTR 22 19 S 33 E	Lat / Long	32.64341 -103.64461
	1980 S 710 E	County	Lea
Operator (when sampled)			
	Field TONTO	Unit I	
Sample Date		Analysis Date	
	Sample Source DST	Depth (if known)	
	Water Typ		
ph		alkalinity_as_caco3_mgL	
ph_temp_F		hardness_as_caco3_mgL	
specificgravity		hardness_mgL	
specificgravity_temp_F		resistivity_ohm_cm	
tds_mgL	46915	resistivity_ohm_cm_temp	
tds_mgL_180C		conductivity	
chloride_mgL	27270	conductivity_temp_F	
sodium_mgL		carbonate_mgL	
calcium_mgL		bicarbonate_mgL	714
iron_mgL		sulfate_mgL	1116
barium_mgL		hydroxide_mgL	
magnesium_mgL		h2s_mgL	
potassium_mgL		co2_mgL	
strontium_mgL		o2_mgL	
manganese_mgL		anionremarks	
Remarks			

(Produced water data courtesy of NMT Octane NM WAIDS database.)



C-108 Item VII.5 - Produced Water Data
Trove Energy & Water, LLC - FLC South Federal Project Area
DISPOSAL ZONE

DEVONIAN

API No	3002521082	Lab ID	
		Sample ID	5720
Well Name	ANTELOPE RIDGE UNIT 003	Sample No	
Location	ULSTR 34 23 S 34 E 1980 S 1650 W	Lat / Long	32.25922 -103.46068
		County	Lea
Operator (when sampled)			
	Field ANTELOPE RIDGE	Unit	K
Sample Date	11/14/1967	Analysis Date	
	Sample Source UNKNOWN	Depth (if known)	
	Water Typ		
ph	6.9	alkalinity_as_caco3_mgL	
ph_temp_F		hardness_as_caco3_mgL	
specificgravity		hardness_mgL	
specificgravity_temp_F		resistivity_ohm_cm	
tds_mgL	80187	resistivity_ohm_cm_temp_	
tds_mgL_180C		conductivity	
chloride_mgL	47900	conductivity_temp_F	
sodium_mgL		carbonate_mgL	
calcium_mgL		bicarbonate_mgL	476
iron_mgL		sulfate_mgL	900
barium_mgL		hydroxide_mgL	
magnesium_mgL		h2s_mgL	
potassium_mgL		co2_mgL	
strontium_mgL		o2_mgL	
manganese_mgL		anionremarks	
Remarks			

(Produced water data courtesy of NMT Octane NM WAIDS database.)



C-108 - Item VIII

Geological Data

EARTHQUAKE / SEISMIC INFORMATION SUPPLEMENT

Map Source: State of stress in the Permian Basin, Texas and New Mexico: Implications for induced seismicity (Figure 1); Jens-Erik Lund Snee/ Mark Zoback, February 2018

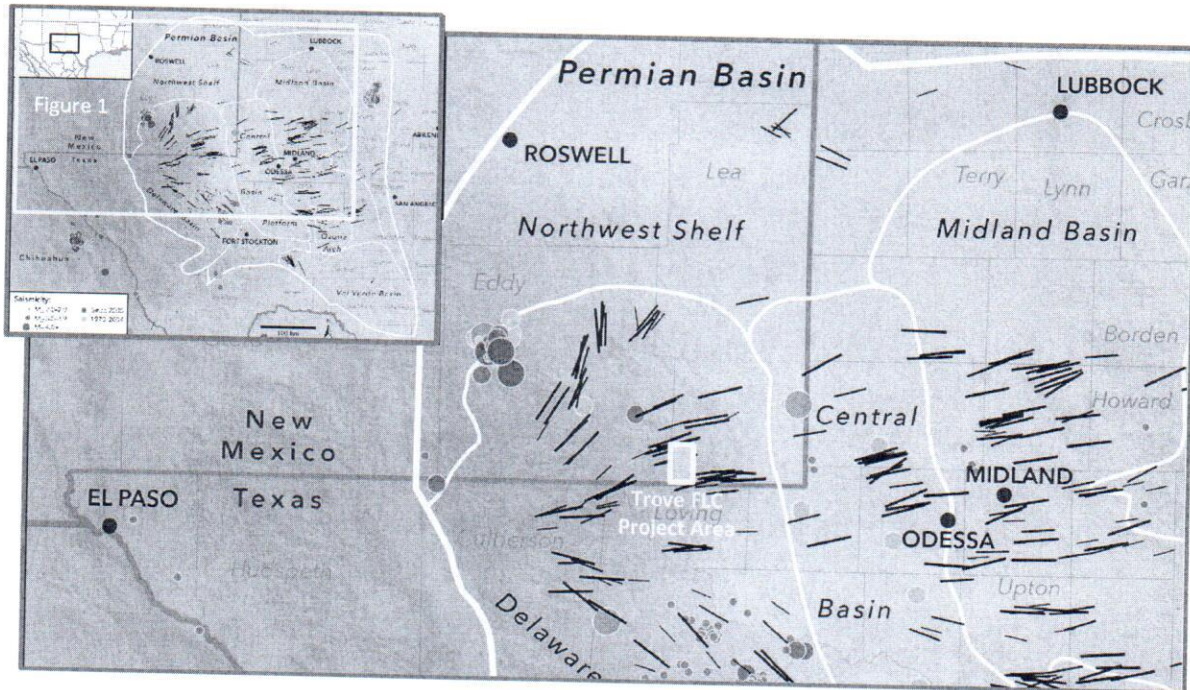

TROVE PSE PROJECT VICINITY

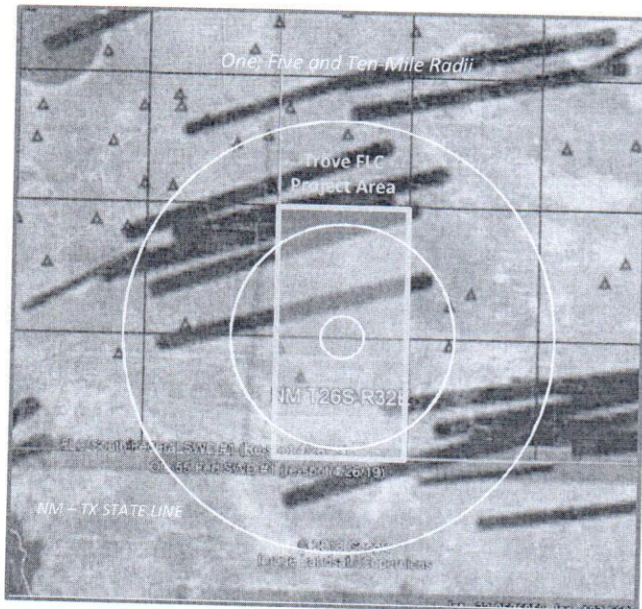

Figure 1. State of stress in the Permian Basin, Texas and New Mexico. Black lines are the measured orientations of the maximum horizontal stress (SHmax), with line length scaled by data quality. The colored background is an interpolation of measured relative principal stress magnitudes (faulting regime) expressed using the $A\phi$ parameter (see text for details) of Simpson (1997). Blue lines are fault traces known to have experienced normal-sense offset within the past 1.6 Ma, from the USGS Quaternary Faults and Folds Database (Crone and Wheeler, 2000). The boundary between the Shawnee and Mazatzal basement domains is from Lund et al. (2015), and the Precambrian Grenville Front is from Thomas (2006). The Permian Basin boundary is from the U.S. Energy Information Administration, and the subbasin boundaries are from the Texas Bureau of Economic Geology Permian Basin Geological Synthesis Project. Earthquakes are from the USGS National Earthquake Information Center, the TexNet Seismic Monitoring Program, and Gan and Frohlich (2013). Focal mechanisms are from Saint Louis University (Herrmann et al., 2011).

C-108 - Item VIII

Geological Data

EARTHQUAKE / SEISMIC INFORMATION SUPPLEMENT (cont.)

In the following map, a layer with USGS historical earthquake data is overlaid and, a layer showing lines to represent Precambrian faults as documented by Ruppel, et al. (2005). Finally, a layer showing all currently permitted SWDs completed or proposed to be completed in the Devonian (Silurian) formation.

The USGS earthquakes shown are well known to the area. The 2012 quake located approximately 13 miles due east of Loving is also shown (19.2 miles). This was perhaps the most significant of the area in recent years but was determined to not be related to oil and gas activity. The best known and largest in recent history was the 1992, 4.6 magnitude quake centered south of Eunice, NM (36.0 miles).

The Precambrian faults and existing Devonian SWDs are discussed in more detail on the next page.

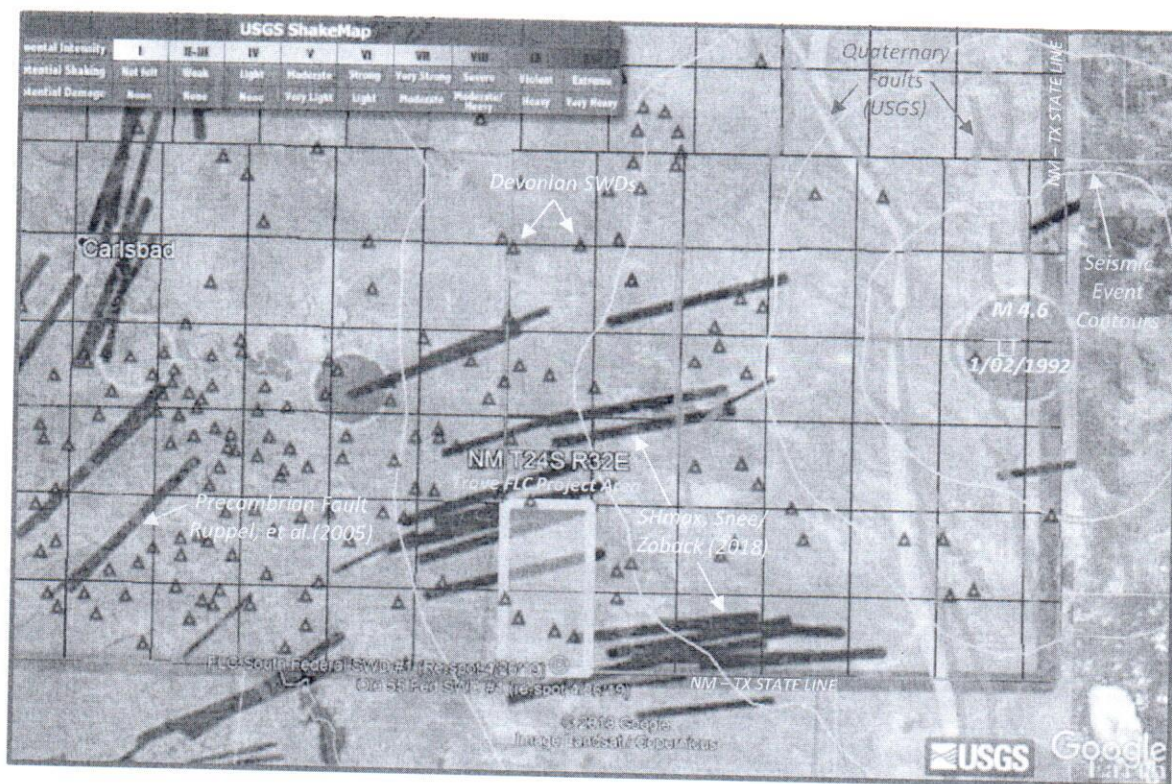

REGIONAL VIEW - DEVONIAN SWD LOCATIONS, PRECAMBRIAN FAULTS, S_{Hmax} , USGS MAGNITUDE

C-108 - Item VIII

Geological Data

EARTHQUAKE / SEISMIC INFORMATION SUPPLEMENT (cont.)

The primary Precambrian faults in the area as documented by Ruppel, et al. (2005) is represented on this map by the thick, pink colored lines. The most significant of these is the fault associated with the Rio Grande Rift, running southeast to northwest and, runs adjacent to a portion of Hwy 285; a portion the associated fault which runs parallel approximately 15 miles northeast is also depicted below. The Trove FLC Project SWD Area is located some 23 miles from the fault. Other documented faults (USGS, 2000) are shown for eastern Lea County and extending into west Texas. Other Devonian SWDs in the area are also shown (small purple triangles) completed or proposed to be completed in the Devonian (Silurian) formation.

The previously referenced study by Snee and Zoback (shown on previous exhibits) evaluated the strike-slip probability using probabilistic FSP (Fault Slip Potential) analysis of known faults in the Permian Basin. The study predicts that the Precambrian fault shown here has less than a 10% probability of being critically stressed to the point of creating an induced seismicity event. The main reason for the low probability is due to the relationship of the strike of the fault to the regional S_{Hmax} orientation; the proposed SWD being well removed from the area.

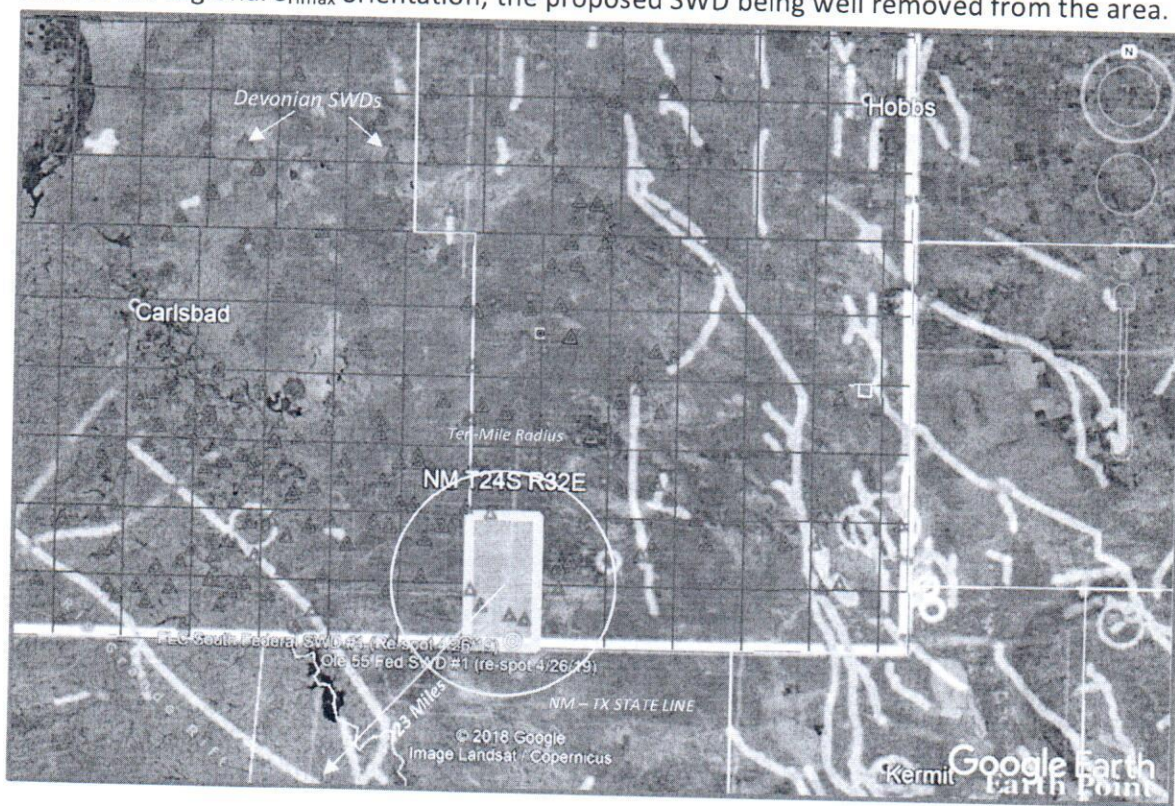

VICINITY - PERMITTED DEVONIAN SWDs, COMPOSITE FAULTS

C-108 - Item VIII

Geological Data

EARTHQUAKE / SEISMIC INFORMATION SUPPLEMENT (cont.)

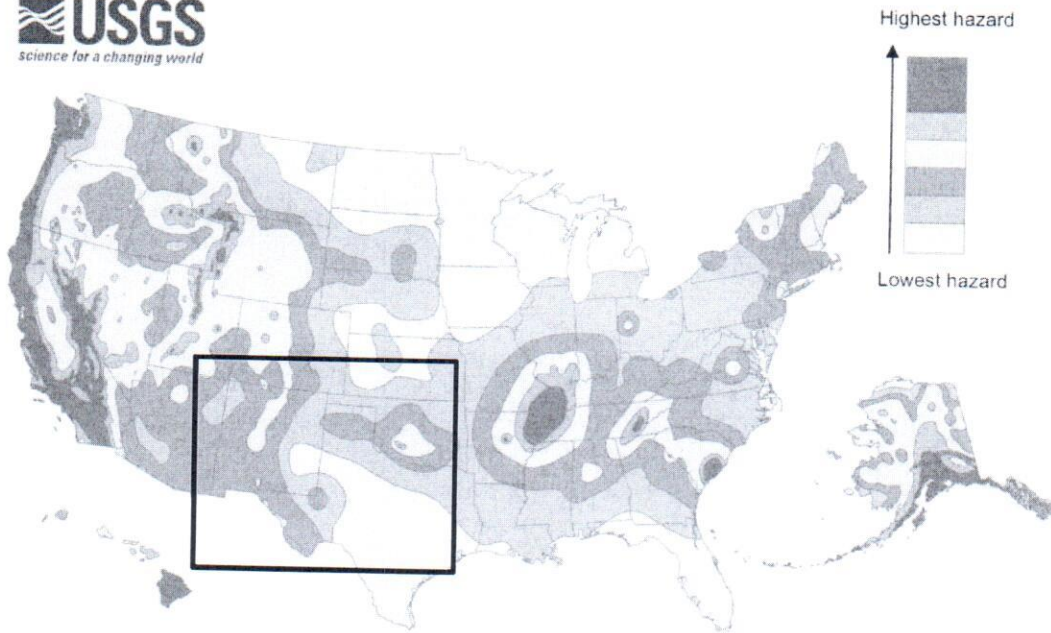

2014 map data: The USGS notes in its report that fracking may be to blame for a sizeable uptick in earthquakes in places like Oklahoma. "Some states have experienced increased seismicity in the past few years that may be associated with human activities such as the disposal of wastewater in deep wells," the report says. USGS hopes to use that data in future maps but it isn't included in this one. "Injection-induced earthquakes are challenging to incorporate into hazard models because they may not behave like natural earthquakes and their rates change based on man-made activities," the report says.



C-108 - Item VIII

Geological Data

EARTHQUAKE / SEISMIC INFORMATION SUPPLEMENT (cont.)

USGS 2014 REGIONAL MAP DATA OVERLAY IN GOOGLE EARTH w/ HISTORICAL EARTHQUAKES

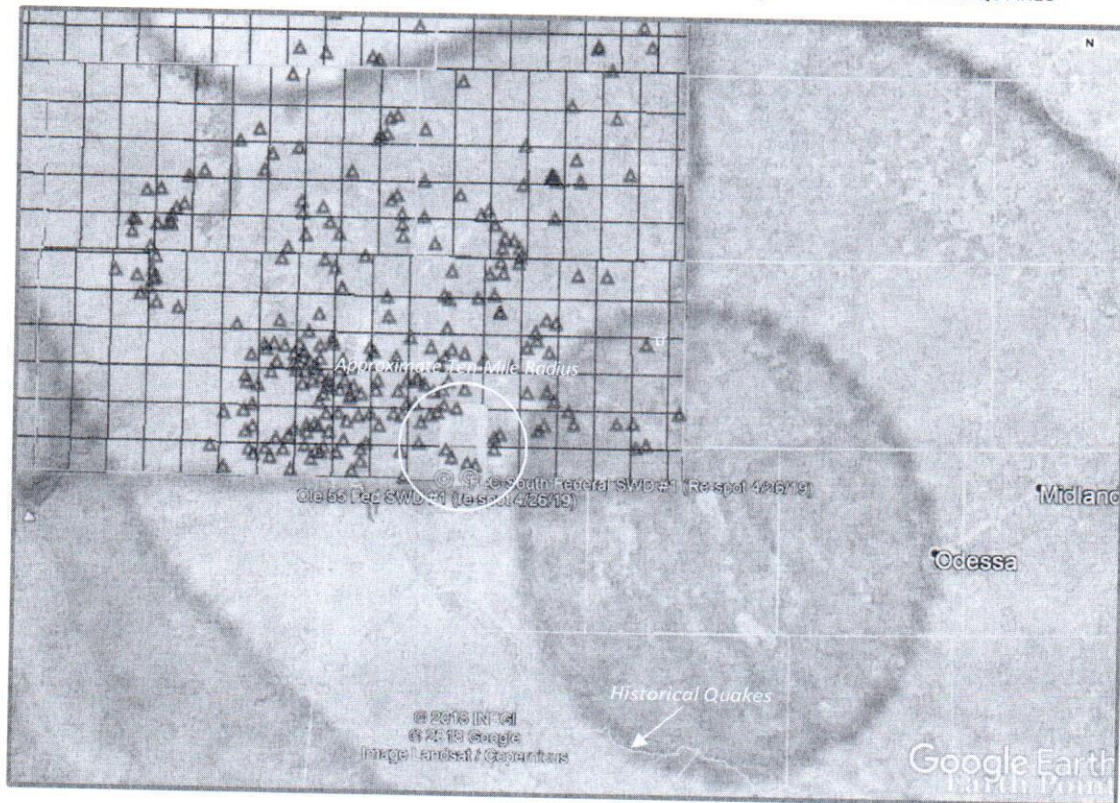

An updated USGS map for 2018 is on the next page. While methodology remained essentially the same according to USGS, the interpreted results and color-coding did have some modification. However, the subject area in southeast New Mexico on both maps remains very low and on the 2018 map, the area is assigned a value of <1% of "potentially minor-damage ground shaking".

C-108 - Item VIII

Geological Data

EARTHQUAKE / SEISMIC INFORMATION SUPPLEMENT (cont.)

USGS 2018 ONE-YEAR MODEL

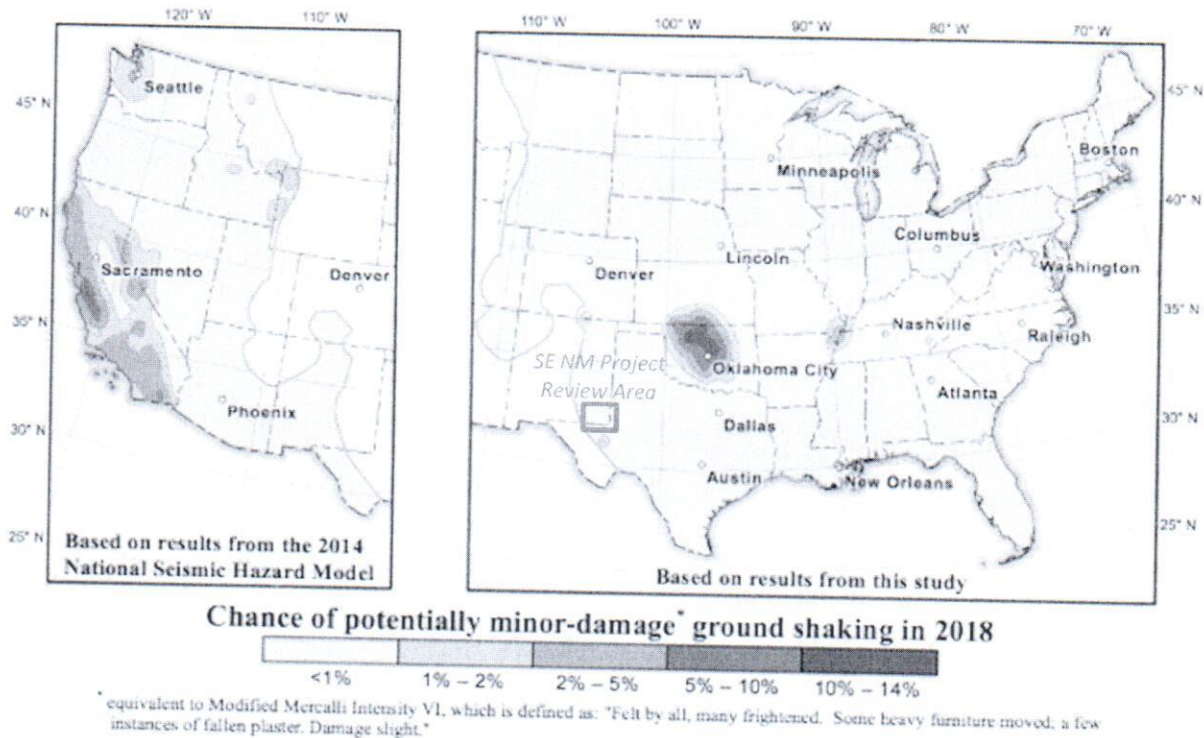

Map showing chance of damage from an earthquake in the Central and Eastern United States during 2018. Percent chances are represented as follows: pale yellow, less than 1 percent; dark yellow, 1 to 2 percent; orange, 2 to 5 percent; red, 5 to 10 percent; dark red, 10 to 12 percent. See Hazard from the western United States from the [2014 National Seismic Hazard Maps](#) (Petersen et al., 2014) for comparison.

The USGS has produced the 2018 one-year probabilistic seismic hazard forecast for the central and eastern United States from induced and natural earthquakes. For consistency, the updated 2018 forecast is developed using the same probabilistic seismicity-based methodology as applied in the two previous forecasts.

Based on publicly available data for the subject area, it is reasonable to believe the risk of induced seismic activity due to disposal injection into this well is extremely low.

C-108 - Item XI

Groundwater Basins - Water Column / Depth to Groundwater

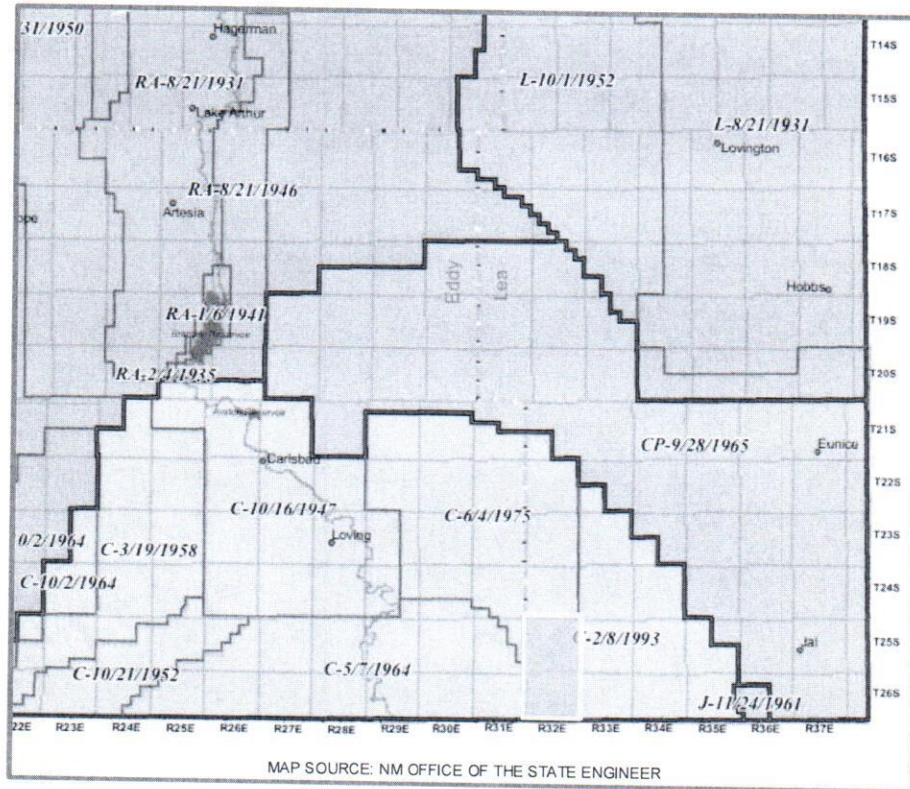

The subject well is located within the Carlsbad Basin.

Fresh water in the area is generally available from the Rustler and Santa Rosa formations. State Engineer's records show water wells in the area with a depth to groundwater of 125 to 405 feet and an average depth of 239 feet.

There are NO water wells located within one mile of the proposed SWD.

C-108 Item XI

Water Wells Within One Mile

FLC South Federal SWD No.1 - Water Well Locator Map

There are NO water wells (PODs) within a one-mile radius of the proposed SWD.

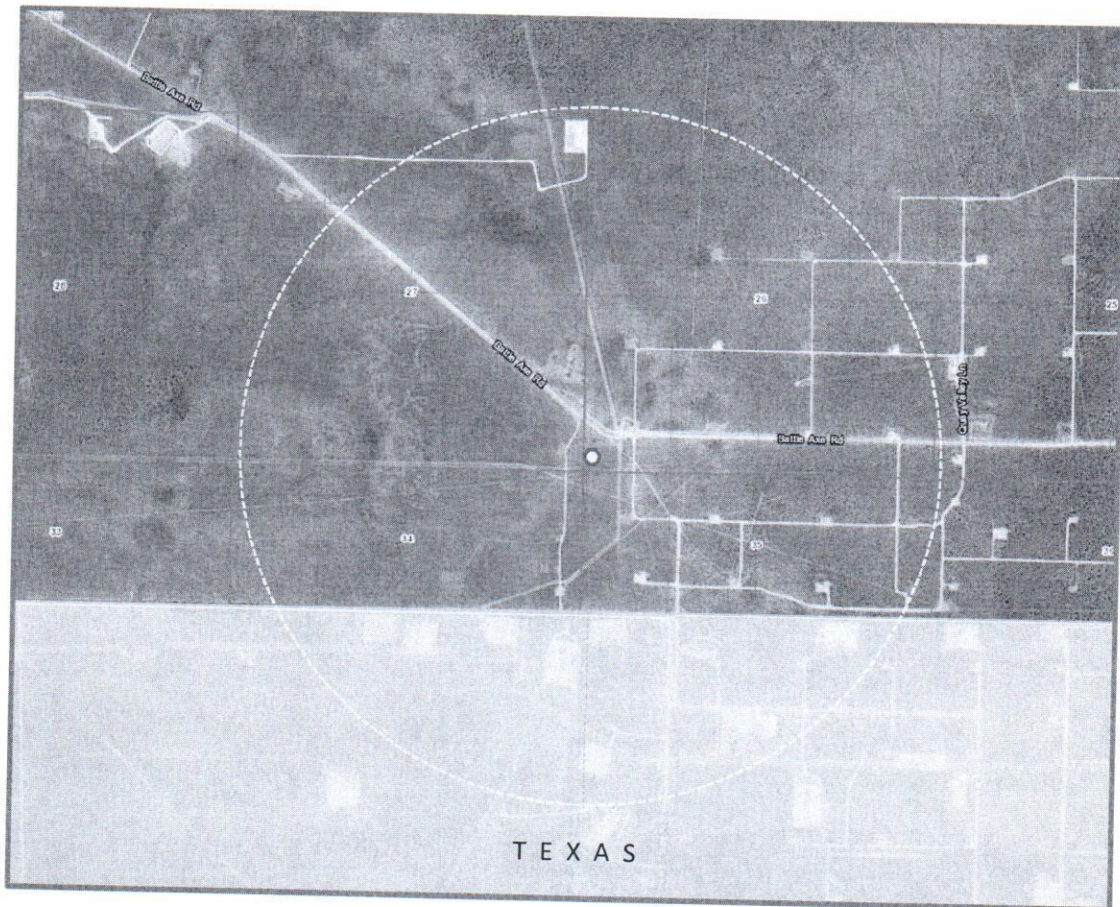

Data from NM Office of the State Engineer displayed in OSE-GIS System.

C-108 ITEM XII

Geologic Affirmation

We have examined available geologic and engineering data and have found no evidence of open faults or other hydrologic connection between the disposal interval and any underground sources of drinking water.

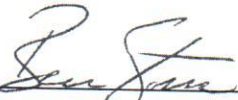

Ben Stone, Partner
SOS Consulting, LLC

Project: Trove Energy and Water, LLC
FLC South Project Area
Reviewed 3/26/2019

C-108 ITEM XIII – PROOF OF NOTIFICATION

IDENTIFICATION AND NOTIFICATION OF INTERESTED PARTIES

Exhibits for Section

Affected Parties Map

List of Interested Parties

Notification Letter to Interested Parties

Proof of Certified Mailing

Published Legal Notice

FLC South Federal SWD Well No.1 – Affected Parties Plat (Attachment to NMOCD Form C-108, Application for Authority to Inject.)

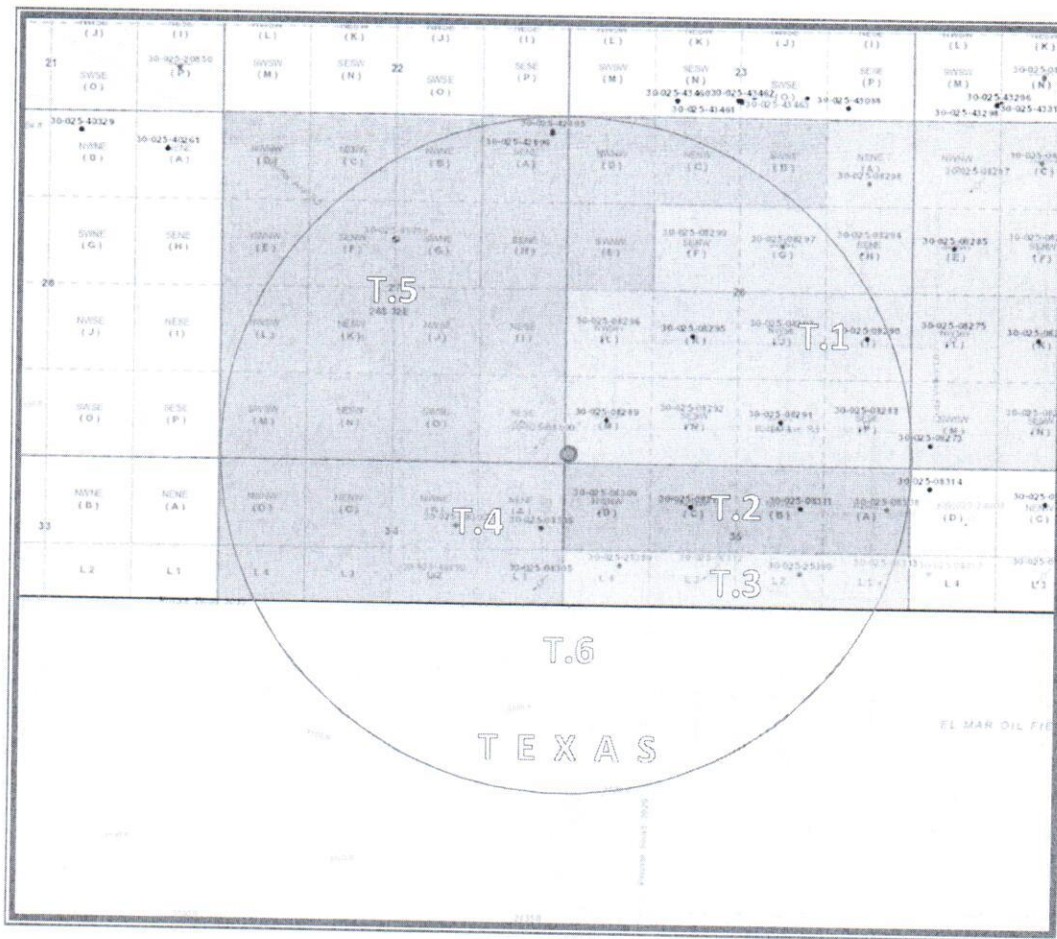

TROVE
ENERGY and WATER

LEGEND

- | | |
|--|---|
| T.1 – NMNM-0069515 – ConocoPhillips Company | T.4 – NMNM-0071985 – Elliot Industries, LTD P |
| T.2 – NMNM-0068777 – ConocoPhillips Company | T.5 – NMNM-027509 – Elliot Industries, LTD P |
| T.3 – NMNM-0002791A – ConocoPhillips Company | T.6 – Texas – Texas Railroad Commission |

C-108 ITEM XIII – PROOF OF NOTIFICATION AFFECTED PARTIES LIST

SOS Consulting is providing electronic delivery of C-108 applications.
ALL APPLICABLE AFFECTED PARTIES ARE PROVIDED A LINK IN THE NOTICE LETTER
TO A SECURE SOS/ CITRIX SHAREFILE® SITE TO VIEW AND DOWNLOAD
A FULL COPY OF THE SUBJECT C-108 APPLICATION IN PDF FORMAT.

"AFFECTED PERSON" MEANS THE DIVISION DESIGNATED OPERATOR; IN THE ABSENCE OF AN OPERATOR, A LESSEE WHOSE INTEREST IS EVIDENCED BY A WRITTEN CONVEYANCE DOCUMENT EITHER OF RECORD OR KNOWN TO THE APPLICANT AS OF THE DATE THE APPLICANT FILES THE APPLICATION; OR IN THE ABSENCE OF AN OPERATOR OR LESSEE, A MINERAL INTEREST OWNER WHOSE INTEREST IS EVIDENCED BY A WRITTEN CONVEYANCE DOCUMENT EITHER OF RECORD OR KNOWN TO THE APPLICANT AS OF THE DATE THE APPLICANT FILED THE APPLICATION FOR PERMIT TO INJECT.; PER OCD RULES NMAC 19.15.26.7, A. AND 19.15.26.8, B.2.

SURFACE OWNER

- 1 U.S. DEPARTMENT OF INTERIOR
Bureau of Land Management
Oil & Gas Division
620 E. Greene St.
Carlsbad, NM 88220
Certified: 7018 1130 0000 8736 0670

OFFSET MINERALS LESSEES and OPERATORS (All Notified via USPS Certified Mail)

- BLM Leases NMNM-0069515, 0068777, 0002791A (T.1, T.2 and T.3 on Map)**
Lessee & Operator
- 2 CONOCOPHILLIPS COMPANY
P.O. Box 2197
Houston, TX 77252-2197
Certified: 7018 1130 0000 8736 0687
 - Operator**
 - 3 SARAHA OPERATING COMPANY
306 W. Wall St., Ste.1025
Midland, TX 79701
Certified: 7018 1130 0000 8736 0694

BLM Leases NMNM-0071985 027509 (T.4 and T.5 on Map)

Lessee
ELLIOT INDUSTRIES, LP
P.O. Box 1328
Santa Fe, NM 87504

Operator
CONOCOPHILLIPS COMPANY
P.O. Box 2197
Houston, TX 77252-2197

- 4 **State of Texas (T.6 on Map)**
RAILROAD COMMISSION OF TEXAS
Technical Permitting Section - UIC Program
P.O. Box 12967
Austin, TX 78711-2967
Certified: 7018 1130 0000 8736 0700

C-108 ITEM XIII – PROOF OF NOTIFICATION
AFFECTED PARTIES LIST (cont.)

OFFSET MINERALS OWNERS (Notified via USPS Certified Mail)

U.S. DEPARTMENT OF INTERIOR
Bureau of Land Management
Oil & Gas Division
620 E. Greene St.
Carlsbad, NM 88220

REGULATORY

NEW MEXICO OIL CONSERVATION DIVISION (FedEx'ed original and copy)
1220 S. St. Francis Dr.
Santa Fe, NM 87505

NEW MEXICO OIL CONSERVATION DIVISION (FedEx'ed copy)
1625 N. French Drive
Hobbs, NM 88240

May 7, 2019

NOTIFICATION TO INTERESTED PARTIES
via U.S. Certified Mail – Return Receipt Requested

To Whom It May Concern:

Trove Energy and Water, LLC, Hobbs, New Mexico, is preparing applications to the New Mexico Oil Conservation Division to drill and complete for salt water disposal the FLC South Federal SWD Well No.1. The proposed commercial operation will be for produced water disposal from area operators. As indicated in the notice below, the well will be located in Section 26, Township 26 South, Range 32 East in Lea County, New Mexico.

The published notice states that the interval will be from 17,300 feet to 19,000 feet into the Devonian and Silurian formations.

Following is the notice published in the Artesia Daily Press, Artesia, New Mexico on or about May 1, 2019.

LEGAL NOTICE

Trove Energy and Water, LLC, 1919 North Turner, Hobbs, NM 88240, is filing Form C-108 (Application for Authority to Inject) with the New Mexico Oil Conservation Division seeking administrative approval for a salt water disposal well. The proposed well, the FLC South Federal SWD Well No.1 will be located 225' FSL and 50' FWL, Section 26, Township 26 South, Range 32 East, Lea County, New Mexico; approximately 28.1 miles west/ southwest of Jal, NM.

Produced water from area production will be commercially disposed into the Devonian, Silurian and Fusselman formations at a maximum interval depth of 17,300' to 19,000' at a maximum surface pressure of 3460 psi and a rate limited only by such pressure. Mudlogging and e-logs will confirm final interval depths.

Interested parties wishing to object to the proposed application must file with the New Mexico Oil Conservation Division, 1220 St. Francis Dr., Santa Fe, NM 87505, (505)476-3460 within 15 days of the date of this notice or the OCD receive date, whichever is later. Additional information may be obtained from the applicant's agent, SOS Consulting, LLC, (903)488-9850 or, email info@sosconsulting.us.

You have been identified as a party who may be interested as an offset lessee or operator.

You are entitled to a full copy of the application. A full copy in PDF format will be posted on the SOS Consulting **ShareFile** site and available for future download (posting may lag behind the notice effort).

Use the URL link: <https://sosconsulting.sharefile.com/d-s7bc1c95a5e3433f9>
(Please Note: The ShareFile service is powered by Citrix Systems and is completely secure.*)

The link to this file will be active for 60 days from the date of this letter. Your company can access and download the file a maximum of five (5) times. (One copy may be downloaded and shared as needed among your company.)

If preferred, you may call SOS Consulting, LLC at 903-488-9850, or email info@sosconsulting.us, and the same PDF file copy will be expedited to you via email.

Please use a subject like "**FLC South Fed SWD #1 May 2019 PDF Copy Request**".

Thank you for your attention in this matter.

Best regards,



Ben Stone, SOS Consulting, LLC
Agent for Trove Energy and Water, LLC

Cc: Application File

SOS Consulting is committed to providing superior quality work using technology to assist clients and affected parties in obtaining the documentation required. SOS will continue to utilize methods which are less energy and resource intensive including, the reduction of paper copies.

We hope you'll partner with us and appreciate these efforts.

* You will be asked for your email, name and company.
This will not be used by anyone except keeping track of the file downloads.
You will not be solicited by SOS or anyone else. Data is stored on Citrix Systems servers only.

CITRIX



C-108 - Item XIV

Proof of Notice (Certified Mail Receipts)

7018 1130 0000 8738 0670

**U.S. Postal Service™
CERTIFIED MAIL® RECEIPT**
Domestic Mail Only

For delivery information, visit our website at www.usps.com®.

OFFICIAL USE

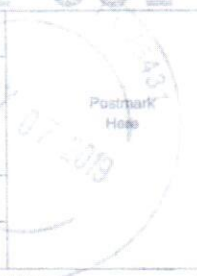
Certified Mail Fee	\$ 3.50	
Extra Services & Fees (check box, add fee as appropriate)		
<input type="checkbox"/> Return Receipt (hardcopy)	\$	
<input type="checkbox"/> Return Receipt (electronic)	\$ 2.80	
<input type="checkbox"/> Certified Mail Restricted Delivery	\$	
<input type="checkbox"/> Adult Signature Required	\$	
<input type="checkbox"/> Adult Signature Restricted Delivery	\$	
Postage	\$.55	
Total Postage and Fees	\$ 6.85	
Sent To	Bureau of Land Management	
Street and	Oil & Gas Division	
City, State	620 E. Greene St. Carlsbad, NM 88220	
PS Form	itions	

7018 1130 0000 8738 0687

**U.S. Postal Service™
CERTIFIED MAIL® RECEIPT**
Domestic Mail Only

For delivery information, visit our website at www.usps.com®.

OFFICIAL USE

Certified Mail Fee	\$ 3.50	
Extra Services & Fees (check box, add fee as appropriate)		
<input type="checkbox"/> Return Receipt (hardcopy)	\$	
<input type="checkbox"/> Return Receipt (electronic)	\$ 2.80	
<input type="checkbox"/> Certified Mail Restricted Delivery	\$	
<input type="checkbox"/> Adult Signature Required	\$	
<input type="checkbox"/> Adult Signature Restricted Delivery	\$	
Postage	\$.55	
Total Postage and Fees	\$ 6.85	
Sent To	CONOCOPHILLIPS COMPANY	
Street and	P.O. Box 2197	
City, State	Houston, TX 77252-2197	
PS Form	itions	

7018 1130 0000 8738 0694

**U.S. Postal Service™
CERTIFIED MAIL® RECEIPT**
Domestic Mail Only

For delivery information, visit our website at www.usps.com®.

OFFICIAL USE

Certified Mail Fee	\$ 3.50	
Extra Services & Fees (check box, add fee as appropriate)		
<input type="checkbox"/> Return Receipt (hardcopy)	\$	
<input type="checkbox"/> Return Receipt (electronic)	\$ 2.80	
<input type="checkbox"/> Certified Mail Restricted Delivery	\$	
<input type="checkbox"/> Adult Signature Required	\$	
<input type="checkbox"/> Adult Signature Restricted Delivery	\$	
Postage	\$.55	
Total Postage and Fees	\$ 6.85	
Sent To	SARAH OPERATING COMPANY	
Street and	306 W. Wall St., Ste 1025	
City, State	Midland, TX 79701	
PS Form	itions	

7018 1130 0000 8738 0700

**U.S. Postal Service™
CERTIFIED MAIL® RECEIPT**
Domestic Mail Only

For delivery information, visit our website at www.usps.com®.

OFFICIAL USE

Certified Mail Fee	\$ 3.50	
Extra Services & Fees (check box, add fee as appropriate)		
<input type="checkbox"/> Return Receipt (hardcopy)	\$	
<input type="checkbox"/> Return Receipt (electronic)	\$ 2.80	
<input type="checkbox"/> Certified Mail Restricted Delivery	\$	
<input type="checkbox"/> Adult Signature Required	\$	
<input type="checkbox"/> Adult Signature Restricted Delivery	\$	
Postage	\$.55	
Total Postage and Fees	\$ 6.85	
Sent To	RAILROAD COMMISSION OF TEXAS	
Street and	Technical Permitting Section - UIC Program	
City, State	P.O. Box 12967	
PS Form	Austin, TX 78711-2967 itions	

Affidavit of Publication

STATE OF NEW MEXICO
COUNTY OF LEA

I, Daniel Russell, Publisher of the Hobbs News-Sun, a newspaper published at Hobbs, New Mexico, solemnly swear that the clipping attached hereto was published in the regular and entire issue of said newspaper, and not a supplement thereof for a period of 1 issue(s).

Beginning with the issue dated
May 01, 2019
and ending with the issue dated
May 01, 2019.

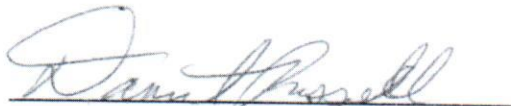
Publisher

Sworn and subscribed to before me this
1st day of May 2019.

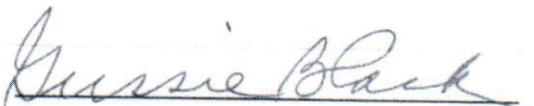
Business Manager



This newspaper is duly qualified to publish legal notices or advertisements within the meaning of Section 3, Chapter 167, Laws of 1937 and payment of fees for said

LEGALS

LEGAL NOTICE MAY 1, 2019

Trove Energy and Water, LLC, 1919 North Turner, Hobbs, NM 88240, is filing Form C-108 (Application for Authority to Inject) with the New Mexico Oil Conservation Division seeking administrative approval for a salt water disposal well. The proposed well, the FLC South Federal SWD Well No.1 will be located 225' FSL and 50' FWL, Section 26, Township 26 South, Range 32 East, Lea County, New Mexico; approximately 28.1 miles west/ southwest of Jal, NM.

Produced water from area production will be commercially disposed into the Devonian, Silurian and Fusselman formations at a maximum interval depth of 17,300' to 19,000' at a maximum surface pressure of 3460 psi and a rate limited only by such pressure. Mudlogging and e-logs will confirm final interval depths.

Interested parties wishing to object to the proposed application must file with the New Mexico Oil Conservation Division, 1220 St. Francis Dr., Santa Fe, NM 87505, (505)476-3460 within 15 days of the date of this notice or the OCD receive date, whichever is later. Additional information may be obtained from the applicant's agent, SOS Consulting, LLC, (903)488-9850 or email info@sosconsulting.us. #34101

67104420

00227733

BEN STONE
SOS CONSULTING, LLC.
P.O. BOX 300
COMO, TX 75431