

**BEFORE THE OIL CONSERVATION DIVISION
EXAMINER HEARING AUGUST 8, 2019**

CASE No. 20709

SAN JUAN 28-7 UNIT 224 WELL

RIO ARRIBA COUNTY, NEW MEXICO



**STATE OF NEW MEXICO
DEPARTMENT OF ENERGY, MINERALS AND NATURAL RESOURCES
OIL CONSERVATION DIVISION**

**APPLICATION OF HILCORP ENERGY
COMPANY FOR AN EXCEPTION TO THE
WELL DENSITY REQUIREMENTS OF THE
SPECIAL RULES AND REGULATIONS FOR
THE BLANCO-MESAVERDE GAS POOL,
RIO ARriba COUNTY, NEW MEXICO.**

CASE NO. 20709

AFFIDAVIT OF BRAD PEARSON IN SUPPORT OF CASE NO. 20709

I, Brad Pearson, being of lawful age and duly sworn, declare as follows:

1. My name is Brad Pearson. I work for Hilcorp Energy Company ("Hilcorp") as a Landman.
2. I have previously testified before the New Mexico Oil Conservation Division as an expert witness in petroleum land matters. My credentials as a petroleum landman have been accepted by the Division and made a matter of record.
3. I am familiar with the application filed by Hilcorp in this case, and I am familiar with the status of the lands in the subject areas.
4. None of the affected parties in this case has indicated opposition, and therefore I do not expect any opposition at the hearing.
5. Hilcorp seeks an exception to the well density requirements of Rule I.B of the Special Rules and Regulations of the Blanco-Mesaverde Gas Pool to permit it to complete and simultaneously produce four Mesaverde gas wells in the same quarter section, with two wells in the same quarter-quarter section, for a total of five Mesaverde gas wells within the same standard 320-acre, more or less, spacing and proration unit.

6. The Blanco-Mesaverde Gas Pool is governed by Special Rules and Regulations which provide for 320-acre spacing and proration units on which as many as four wells may be drilled. The Special Rules therefore limit the number of wells in a spacing unit to four and the number of wells in a half section within a spacing unit to two. The Special Rules also provide that well density exceptions can be approved only after notice and hearing.

7. Hilcorp is the operator of a standard 320-acre, more or less, spacing and proration unit in the Blanco-Mesaverde Gas Pool comprised of the E/2 of Section 28, Township 28 North, Range 7 West, Rio Arriba County, New Mexico, in which the following four wells are currently completed and producing:

- a. San Juan 28-7 Unit 073 Well (API No. 30-039-07332), Sec. 28, T28N, R7W (Unit A);
- b. San Juan 28-7 Unit 224F Well (API No. 30-039-30270), Sec. 28, T28N, R7W (Unit G);
- c. San Juan 28-7 Unit 224G Well (API No. 30-039-30285), Sec. 28, T28N, R7W (Unit H); and
- a. San Juan 28-7 Unit 224M Well (API No. 30-039-25697), Sec. 28, T28N, R7W (Unit I).

8. Hilcorp now proposes to simultaneously dedicate and produce the following fifth well within the same standard spacing and proration unit, at the following location:

- a. **San Juan 28-7 Unit 224 Well** (API No. 30-039-21004), Sec. 28, T28N, R7W (Unit H).

9. This will be the fifth well within the same spacing unit with four wells in the same quarter section, exceeding well density limits imposed by the Special Rules.

10. Hilcorp therefore requests that the Division enter an order granting an exception to the well density requirements of Rule 1.B of the Special Rules and Regulations of the Blanco-Mesaverde Pool to authorize Hilcorp to simultaneously dedicate and produce the **San Juan 28-7 Unit 224 Well** (API No. 30-039-21004) within the E/2 of Section 28, Township 28 North, Range 7 West, permitting the total number of wells dedicated and producing within this spacing and proration unit to five, with four wells in the same quarter section and two wells in the same quarter-quarter section (Unit H).

11. The proposed simultaneous dedication of the proposed well, which is currently producing in the Dakota formation, within the Blanco-Mesaverde is part of Hilcorp's strategy to use existing wells completed in other zones to economically target development of incremental Mesaverde gas reserves in areas where there is not adequate gas drainage.

12. The Division has pre-approved downhole commingling the Dakota formation with the Blanco-Mesaverde Gas Pool.

13. Pursuant to the Special Rules and Division precedent, Hilcorp provided notice to all Division-designated operators in offsetting 320-acre spacing units. Where Hilcorp is the operator, Hilcorp identified all working interest owners in offsetting spacing units as affected parties requiring notice. In some offsetting spacing units, Hilcorp may own 100% of the working interest, in which case there are no affected parties to notice.

14. **Exhibit A-1** is an overview map identifying the location of the subject Blanco-Mesaverde Gas Pool spacing unit, in the green outline, to which the well will be simultaneously dedicated.

15. Exhibit A-1 also identifies the locations of the existing Mesaverde wells as dark blue circles, as well as the subject well as a dark blue triangle.

16. Exhibit A-1 also depicts the notice area comprised of the offsetting spacing units. which is the shaded area within the dark blue hashed line surrounding the subject spacing unit outlined in green. Hilcorp has provided notice of this application to the operators within the notice area. In some instances, Hilcorp may be the operator of offsetting spacing units within the notice area, in which case notice of the application was provided to all the working interest owners within the notice area.

17. **Exhibit A-2** identifies the affected parties within the offsetting spacing units who are required to be noticed. I provided a list of all affected parties requiring notice to Holland & Hart LLP. All parties were locatable.

18. To the best of my knowledge, the addresses used to provide notice are valid and correct addresses which have been recently used by Hilcorp and at which mail has been received by the notice parties.

19. Exhibits A-1 and A-2 were prepared by me or under my direction and supervision.

FURTHER AFFIANT SAYETH NAUGHT.

Bradley W. Pearson
Brad Pearson

STATE OF TEXAS)

COUNTY OF Harris)

SUBSCRIBED and SWORN to before me this 6th day of August, 2019 by
Brad Pearson.

[Signature]
NOTARY PUBLIC

My Commission Expires:

8/08/2023



13383396 v1

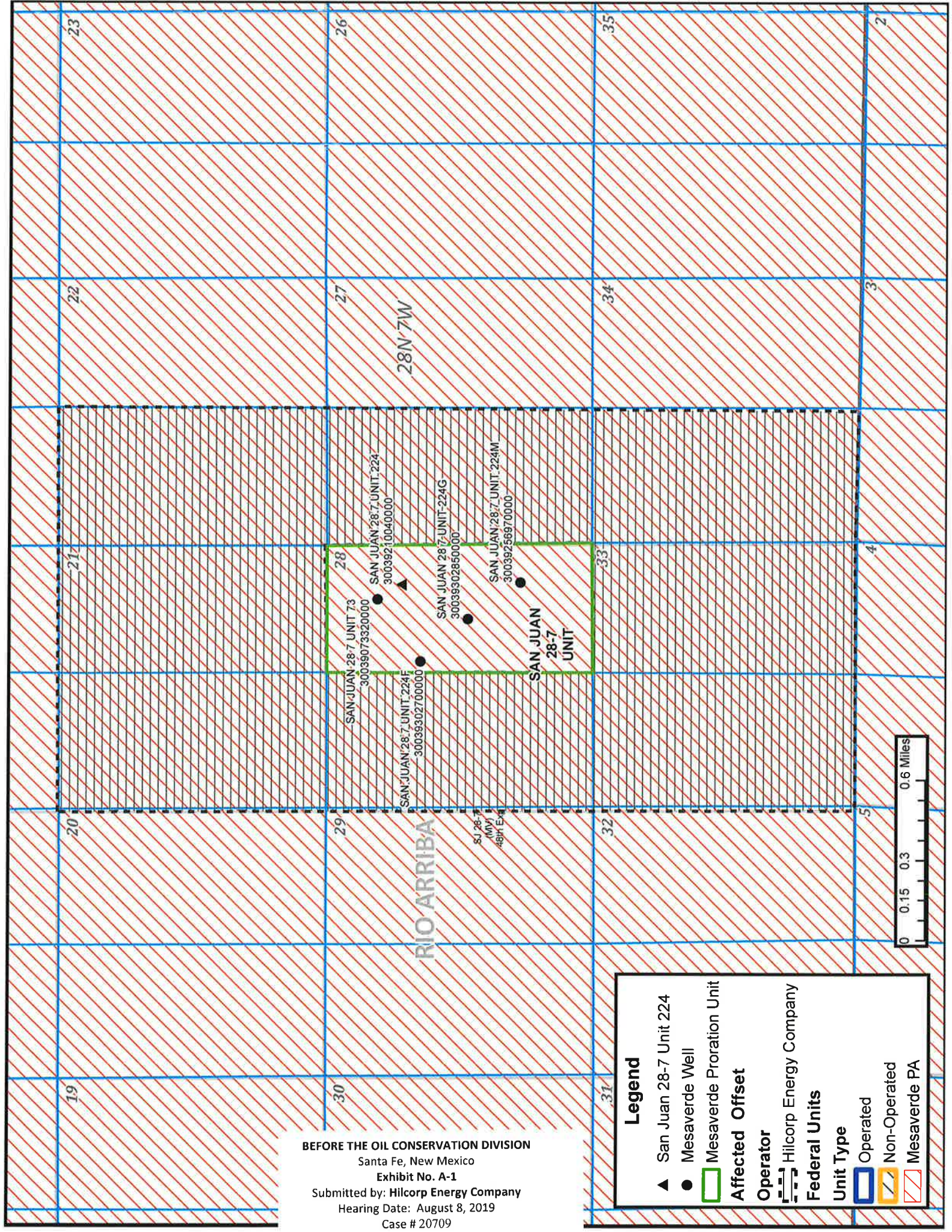

BEFORE THE OIL CONSERVATION DIVISION
Santa Fe, New Mexico
Exhibit No. A-1
Submitted by: **Hilcorp Energy Company**
Hearing Date: August 8, 2019
Case # 20709

Legend

- ▲ San Juan 28-7 Unit 224
- Mesaverde Well
- ▭ Mesaverde Proration Unit

Affected Offset

- Operator
 - Hilcorp Energy Company

Federal Units

- Unit Type
 - Operated
 - Non-Operated
 - Mesaverde PA

Name	Address	City	State	Zip Code	Remarks	Offset Drillblock
HILCORP ENERGY COMPANY	1111 TRAVIS	HOUSTON	TX	77002	OFFSET OPERATOR	SJ 28-7 Unit MV PA
BOFB LTD	2104 WINTER SUNDAY WAY	ARLINGTON	TX	76012	OFFSET W/O	SJ 28-7 Unit MV PA
CAROLEE SIMMONS SMITH	6704 ASHBROOK DR	FORT WORTH	TX	76132-1140	OFFSET W/O	SJ 28-7 Unit MV PA
CAROLYN BEAMON TILLEY	4 LAWRESTON PLACE	DALLAS	TX	75225	OFFSET W/O	SJ 28-7 Unit MV PA
CB LIFELINE PARTNERSHIP	4 LAWRESTON PLACE	DALLAS	TX	75225	OFFSET W/O	SJ 28-7 Unit MV PA
CLAUDIA MARCIA LUNDELL GILMER	723 W UNIVERSITY AVE STE 300-371	GEORGETOWN	TX	78626	OFFSET W/O	SJ 28-7 Unit MV PA
DUGAN PRODUCTION CORP	PO BOX 420	FARMINGTON	NM	87499	OFFSET W/O	SJ 28-7 Unit MV PA
JAMES R BEAMON	6140 HWY 6 SUITE 154	MISSOURI CITY	TX	77459	OFFSET W/O	SJ 28-7 Unit MV PA
JUNE SIMMONS LIVELY	3529 BELLAIRE DR N	FORT WORTH	TX	76109-2110	OFFSET W/O	SJ 28-7 Unit MV PA
LINDA JEANNE LUNDELL LINDSEY	PO BOX 631565	NACOGDOCHES	TX	75963	OFFSET W/O	SJ 28-7 Unit MV PA
LORELEI VON SCHILLING	4008 INWOOD ROAD	FORT WORTH	TX	76109	OFFSET W/O	SJ 28-7 Unit MV PA
MUSTANG ENERGY RESOURCES LLC	1660 LINCOLN ST #1450	DENVER	CO	80264	OFFSET W/O	SJ 28-7 Unit MV PA
ROBERT E BEAMON III	C/O JAMES R BEAMON 6140 HWY 6, SUITE 154	MISSOURI CITY	TX	77459	OFFSET W/O	SJ 28-7 Unit MV PA
ROBERT WALTER LUNDELL	2450 FONDREN STE 304	HOUSTON	TX	77063-2318	OFFSET W/O	SJ 28-7 Unit MV PA
SHARON BEAMON BURNS	200 BISCAYNE BOULEVARD WAY APT 3411	MIAMI	FL	33131	OFFSET W/O	SJ 28-7 Unit MV PA
SUSAN BEAMON PORTER	319 KNIPP FOREST	HOUSTON	TX	77024-5030	OFFSET W/O	SJ 28-7 Unit MV PA
W G PEAVY OIL COMPANY	221 WOODCREST DR	RICHARDSON	TX	75080-2038	OFFSET W/O	SJ 28-7 Unit MV PA

**STATE OF NEW MEXICO
DEPARTMENT OF ENERGY, MINERALS AND NATURAL RESOURCES
OIL CONSERVATION DIVISION**

**APPLICATION OF HILCORP ENERGY
COMPANY FOR AN EXCEPTION TO THE
WELL DENSITY REQUIREMENTS OF THE
SPECIAL RULES AND REGULATIONS FOR
THE BLANCO-MESA VERDE GAS POOL,
RIO ARriba COUNTY, NEW MEXICO.**

CASE NO. 20709

AFFIDAVIT

STATE OF NEW MEXICO)
) ss.
COUNTY OF SANTA FE)

Adam G. Rankin, attorney in fact and authorized representative of Hilcorp Energy Company, the Applicant herein, being first duly sworn, upon oath, states that the above-referenced Application has been provided under the notice letters and proof of receipts attached hereto.



Adam G. Rankin

SUBSCRIBED AND SWORN to before me this 7th day of August, 2019 by Adam G. Rankin.



Notary Public

My Commission Expires:

August 26, 2021

BEFORE THE OIL CONSERVATION DIVISION
Santa Fe, New Mexico
Exhibit No. B
Submitted by: **Hilcorp Energy Company**
Hearing Date: August 8, 2019
Case # 20709



July 17, 2019

VIA CERTIFIED MAIL
CERTIFIED RECEIPT REQUESTED

TO: AFFECTED PARTIES

Re: Application of Hilcorp Energy Company for an Exception to the Well Density Requirements of the Special Rules and Regulations of the Blanco-Mesaverde Gas Pool, Rio Arriba County, New Mexico.

Ladies & Gentlemen:

This letter is to advise you that Hilcorp Energy Company has filed the enclosed application with the New Mexico Oil Conservation Division. A hearing has been requested before a Division Examiner on August 8, 2019 and the status of the hearing can be monitored through the Division's website at <http://www.emnrd.state.nm.us/ocd/>. Division hearings will commence at 8:15 a.m. in Porter Hall at the Oil Conservation Division's Santa Fe Offices located at 1220 South Saint Francis Drive, Santa Fe, New Mexico 87505. You are not required to attend this hearing, but as an owner of an interest that may be affected by this application, you may appear and present testimony. Failure to appear at that time and become a party of record will preclude you from challenging the matter at a later date.

Parties appearing in cases are required by Division Rule 19.15.4.13.B to file a Pre-hearing Statement four business days in advance of a scheduled hearing. This statement must be filed at the Division's Santa Fe office at the above specified address and should include: the names of the parties and their attorneys; a concise statement of the case; the names of all witnesses the party will call to testify at the hearing; the approximate time the party will need to present its case; and identification of any procedural matters that are to be resolved prior to the hearing.

If you have any questions about this matter, please contact Brad Pearson at (713) 289-2793.

Sincerely,

Adam G. Rankin
ATTORNEY FOR HILCORP ENERGY COMPANY

Tracking Number	Recipient	Status
9214890194038386306194	BoFB Ltd 2104 WINTER SUNDAY WAY ARLINGTON TX 76012	Delivered Signature Received
9214890194038386306200	Carolee Simmons Smith 6704 ASHBROOK DR FORT WORTH TX 76132-1140	Delivered Signature Received
9214890194038386306217	Carolyn Beamon Tilley 4 LAWRESTON PLACE DALLAS TX 75225	Delivered Signature Received
9214890194038386306224	CB Lifeline Partnership 4 LAWRESTON PLACE DALLAS TX 75225	Delivered Signature Received
9214890194038386306231	Claudia Marcia Lundell Gilmer 723 W UNIVERSITY AVE STE 300-371 GEORGETOWN TX 78626	Delivered Signature Received
9214890194038386306248	Dugan Production Corp PO BOX 420 FARMINGTON NM 87499	Delivered Signature Received
9214890194038386306255	James R Beamon 6140 HWY 6 SUITE 154 MISSOURI CITY TX 77459	Delivered Signature Received
9214890194038386306262	June Simmons Lively 3529 BELLAIRE DR N FORT WORTH TX 76109-2110	Delivered Signature Received
9214890194038386306279	Linda Jeanne Lundell Lindsey PO BOX 631565 NACOGDOCHES TX 75963	In-Transit
9214890194038386306286	Lorelei Von Schilling 4008 INWOOD ROAD FORT WORTH TX 76109	Delivered Signature Received
9214890194038386306293	Mustang Energy Resources LLC 1660 LINCOLN ST #1450 DENVER CO 80264	Delivered Signature Received
9214890194038386306309	Robert E Beamon III C/O: JAMES R BEAMON 6140 HWY 6 SUITE 154 MISSOURI CITY TX 77459	Delivered Signature Received
9214890194038386306316	Robert Walter Lundell 2450 FONDREN STE 304 HOUSTON TX 77063-2318	Delivered Signature Received
9214890194038386306323	Sharon Beamon Burns 200 BISCAYNE BOULEVARD WAY APT 3411 MIAMI FL 33131	Delivered Signature Received
9214890194038386306330	Susan Beamon Porter 319 KNIPP FOREST HOUSTON TX 77024-5030	Delivered Signature Received
9214890194038386306347	W G Peavy Oil Company 221 WOODCREST DR RICHARDSON TX 75080-2038	Delivered Signature Received

$5.60 \times 16 = \$89.60$



Shipment Confirmation Acceptance Notice

A. Mailer Action

Note to Mailer: The labels and volume associated to this form online, **must** match the labeled packages being presented to the USPS® employee with this form.

HEC/SAN JUAN 28-7 UNIT 224
Case No. 20709
CM# 93904.0003

Shipment Date: 07/16/2019

Shipped From:

Name: HOLLAND & HART LLP

Address: 110 N GUADALUPE ST # 1

City: SANTA FE

State: NM ZIP+4® 87501

Type of Mail	Volume
Priority Mail Express®*	
Priority Mail®	0
First-Class Package Service®	
Returns	
International*	
Other	16
Total	16

*Start time for products with service guarantees will begin when mail arrives at the local Post Office™ and items receive individual processing and acceptance scans.

B. USPS Action

Note to RSS Clerk:

1. Home screen > Mailing/Shipping > More
2. Select Shipment Confirm
3. Scan or enter the barcode/label number from PS Form 5630
4. Confirm the volume count message by selecting Yes or No
5. Select Pay and End Visit to complete transaction

USPS EMPLOYEE: Please scan upon pickup or receipt of mail.
Leave form with customer or in customer's mail receptacle.

USPS SCAN AT ACCEPTANCE



9275 0901 1935 6200 0015 7037 97





Firm Mailing Book For Accountable Mail

Name and Address of Sender Holland & Hart LLP 110 N Guadalupe St # 1 Santa Fe NM 87501		Check type of mail or service <input type="checkbox"/> Adult Signature Required <input type="checkbox"/> Adult Signature Restricted Delivery <input checked="" type="checkbox"/> Certified Mail <input type="checkbox"/> Certified Mail Restricted Delivery <input type="checkbox"/> Collect on Delivery (COD) <input type="checkbox"/> Insured Mail <input type="checkbox"/> Priority Mail <input type="checkbox"/> Priority Mail Express <input type="checkbox"/> Registered Mail <input type="checkbox"/> Return Receipt for Merchandise <input type="checkbox"/> Signature Confirmation <input type="checkbox"/> Signature Confirmation Restricted Delivery		Affix Stamp Here (if issued as an international certificate of mailing or for additional copies of this receipt). Postmark with Date of Receipt.												
USPS Tracking/Article Number		Addressee (Name, Street, City, State, & ZIP Code™)		Postage	(Extra Service) Fee	Handling Charge	Actual Value if Registered	Insured Value	Due Sender if COD	ASR Fee	ASRD Fee	RD Fee	RR Fee	SC Fee	SCRD Fee	SH Fee
1. 9214 8901 9403 8386 3061 94		BoFB Ltd 2104 WINTER SUNDAY WAY ARLINGTON TX 76012		0.50	3.50								1.60			
2. 9214 8901 9403 8386 3062 00		Carolee Simmons Smith 6704 ASHBROOK DR FORT WORTH TX 76132-1140		0.50	3.50								1.60			
3. 9214 8901 9403 8386 3062 17		Cirolyn Beamon Tilley 4 LAWRESTON PLACE DALLAS TX 75225		0.50	3.50								1.60			
4. 9214 8901 9403 8386 3062 24		CB Lifetime Partnership 4 LAWRESTON PLACE DALLAS TX 75225		0.50	3.50								1.60			
5. 9214 8901 9403 8386 3062 31		Claudia Marcia Lundell Glimmer 723 W UNIVERSITY AVE STE 300-371 GEORGETOWN TX 78626		0.50	3.50								1.60			
6. 9214 8901 9403 8386 3062 48		Dugan Production Corp PO BOX 420 FARMINGTON NM 87489		0.50	3.50								1.60			
7. 9214 8901 9403 8386 3062 55		James R Beamon 6140 HWY 6 SUITE 154 MISSOURI CITY TX 77459		0.50	3.50								1.60			
8. 9214 8901 9403 8386 3062 62		June Simmons Lively 3529 BELLAIRE DR N FORT WORTH TX 76109-2110		0.50	3.50								1.60			
Total Number of Pieces Listed by Sender 16		Total Number of Pieces Received at Post Office														



Firm Mailing Book For Accountable Mail

Name and Address of Sender Holland & Hart LLP 110 N Guadalupe St # 1 Santa Fe NM 87501		Check type of mail or service <input type="checkbox"/> Adult Signature Required <input type="checkbox"/> Adult Signature Restricted Delivery <input checked="" type="checkbox"/> Certified Mail <input type="checkbox"/> Certified Mail Restricted Delivery <input type="checkbox"/> Collect on Delivery (COD) <input type="checkbox"/> Insured Mail <input type="checkbox"/> Priority Mail <input type="checkbox"/> Priority Mail Express <input type="checkbox"/> Registered Mail <input type="checkbox"/> Return Receipt for Merchandise <input type="checkbox"/> Signature Confirmation <input type="checkbox"/> Signature Confirmation Restricted Delivery		Affix Stamp Here <i>(if issued as an international certificate of mailing or for additional copies of this receipt).</i> Postmark with Date of Receipt.												
USPS Tracking/Article Number		Addressee (Name, Street, City, State, & ZIP Code™)		Postage	(Extra Service) Fee	Handling Charge	Actual Value if Registered	Insured Value	Due Sender if COD	ASR Fee	ASRD Fee	RD Fee	RR Fee	SC Fee	SCRD Fee	SH Fee
9. 9214 8901 9403 8386 3062 79		Linda Jeanne Lundell Lindsay PO BOX 631565 NACOGDOCHES TX 75963		0.50	3.50								1.60			
10. 9214 8901 9403 8386 3062 86		Lorelei Von Schilling 4008 INWOOD ROAD FORT WORTH TX 76109		0.50	3.50								1.60			
11. 9214 8901 9403 8386 3062 93		Mudlang Energy Resources LLC 1660 LINCOLN ST #450 DENVER CO 80264		0.50	3.50								1.60			
12. 9214 8901 9403 8386 3063 09		Robert E Beamon III C/O: JAMES R BEAMON 6140 HWY 6 SUITE 154 MISSOURI CITY TX 77459		0.50	3.50								1.60			
13. 9214 8901 9403 8386 3063 16		Robert Walter Lundell 2450 FONDREN STE 304 HOUSTON TX 77063-2318		0.50	3.50								1.60			
14. 9214 8901 9403 8386 3063 23		Sharon Beamon Burns 200 BISCAYNE BOULEVARD WAY APT 3411 MIAMI FL 33131		0.50	3.50								1.60			
15. 9214 8901 9403 8386 3063 30		Susan Beamon Porter 319 KNIPP FOREST HOUSTON TX 77024-5030		0.50	3.50								1.60			
16. 9214 8901 9403 8386 3063 47		W G Peavy Oil Company 221 WOODCREST DR RICHARDSON TX 75080-2038		0.50	3.50								1.60			
Total Number of Pieces Listed by Sender 16		Postmaster, Per (Name of receiving employee)														

STATE OF
NEW MEXICO
ENERGY, MINERALS
AND NATURAL
RESOURCES
DEPARTMENT
OIL CONSERVATION
DIVISION
SANTA FE,
NEW MEXICO

The State of New Mexico through its Oil Conservation Division hereby gives notice pursuant to law and the Rules and Regulations of the Division of the following public hearing to be held at 8:15 A.M. on August 8, 2019, in the Oil Conservation Division Hearing Room at 1220 South St. Francis, Santa Fe, New Mexico, before an examiner duly appointed for the hearing. If you are an individual with a disability who is in need of a reader, amplifier, qualified sign language interpreter, or any other form of auxiliary aid or service to attend or participate in the hearing, please contact: Florene Davidson at 505-476-3458 or through the New Mexico Relay Network, 1-800-659-1779 by July 29, 2019. Public documents, including the agenda and minutes, can be provided in various accessible forms. Please contact Florene Davidson if a summary or other type of accessible form is needed.

STATE OF
NEW MEXICO;
All named parties and persons having any right, title, interest or claim in the following case and notice to the public.

(NOTE: All land descriptions herein refer to the New Mexico Principal Meridian whether or not so stated.)

TO: All working interest owners in the subject spacing unit and offsetting operators or leased mineral interest owners, including: BOFB Ltd;

Publisher's Bill

150 lines one time at 105.00

 lines times at

Affidavit 5.00

Subtotal 110.00

Tax 9.83

Total 119.83

Payment received at Rio Grande SUN

Date 7/25/19

By Maria Chavez

Affidavit of Publication

State of New Mexico

County of Rio Arriba

I, Robert Trapp, being first duly sworn, declare and say I am the publisher of the Rio Grande SUN, a weekly newspaper published in the English language and having a general circulation in the County of Rio Arriba, State of New Mexico, and being a newspaper duly qualified to publish legal notices and advertisements under the provisions of Chapter 167 of the Session Laws of 1937. The publication, a copy of which is hereto attached, was published in said paper once each week for

1 consecutive weeks and on the same day of each week in the regular issue of the paper during the time of publication and the notice was published in the newspaper proper, and not in any supplement. The first publication being on the 25 day of July, 2019 and the last publication on the 25 day of July, 2019 payment for said advertisement has been duly made, or assessed as court costs. The undersigned has personal knowledge of the matters and things set forth in this affidavit.

Robert Trapp
Publisher

Subscribed and sworn to before me this 25 day of July A.D. 2019

Maria V. Lopez-Garcia
Maria V. Lopez-Garcia, Notary Public
My commission expires 13 July 2021

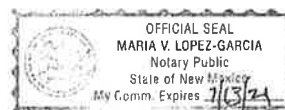

Carolee Simmons Smith, her heirs and devisees; Car Beammon Tilley, her heirs and devisees; CB Life Insurance Company, its assigns and devisees; Gilmer, her heirs and devisees; Dugan Production Corp.; James R. Beammon, his heirs and devisees; June Simmons Lively, her heirs and devisees; Linda Jeanne Lundell Lindsay, her heirs and devisees; Lorelei Von Schilling, her heirs and devisees; Mustang Energy Resources, LLC; Robert E. Beammon, III, c/o James R. Beammon, his heirs and devisees; Robert Walker Lundell, his heirs and devisees; Sharon Beammon Burns, her heirs and devisees; Susan Beammon Porter, her heirs and devisees; T.H. Washburn Oil & Gas, L.L.P.; Tamaacac LLC; James M. Raymond APENCO, W. G. Beammon, c/o APENCO, Inc.; CASE 207003; Application of Hilcorp Energy Company for an Exception to the Well Density Requirements of the Special Rules and Regulations of the Blanco-Mesaverde Gas Pool, Rio Arriba County, New Mexico. Applicant in the above-styled cause seeks an order for an exception to the well density requirements of Rule 18 of the Special Rules and Regulations for the Blanco-Mesaverde Gas Pool (72219), Rio Arriba County, New Mexico, to permit it to complete and simultaneously produce live Mesaverde gas wells in the same standard 320-acre, more or less, spacing and portion unit, with the well located in the same quarter section and two wells in the same quarter-quarter section (Unit H). Hilcorp further seeks approval for the proposed location of the San Juan 28-7 Unit 224 Well (API No. 30-039-21004) in the Mesaverde formation with a surface location in Unit H of the 320-acre section 28, Township 28 North, Range 7 West, NMPM, Rio Arriba County, New Mexico, and authorization to simultaneously complete and produce the San Juan 28-7 Unit 224 Well from the Blanco-Mesaverde Gas Pool. Said area is located approximately 25 miles southeast of Aztec, NM (Published July 25, 2019)

**STATE OF NEW MEXICO
DEPARTMENT OF ENERGY, MINERALS AND NATURAL RESOURCES
OIL CONSERVATION DIVISION**

**APPLICATION OF HILCORP ENERGY
COMPANY FOR AN EXCEPTION TO THE
WELL DENSITY REQUIREMENTS OF THE
SPECIAL RULES AND REGULATIONS FOR
THE BLANCO-MESAVERDE GAS POOL,
RIO ARRIBA COUNTY, NEW MEXICO.**

CASE NO. 20709

AFFIDAVIT OF TYLER TEYKL IN SUPPORT OF CASE NO. 20709

Tyler Teykl, being of lawful age and duly sworn, declare as follows:

1. My name is Tyler Teykl. I work for Hilcorp Energy Company ("Hilcorp") as a reservoir engineer.
2. I have previously testified before the New Mexico Oil Conservation Division as an expert in reservoir engineering. My credentials as a reservoir engineer have been accepted by the Division and made a matter of record.
3. I am familiar with the application filed by Hilcorp in this case and have conducted an engineering study of the subject area and of the Blanco-Mesaverde Gas Pool.
4. As with Hilcorp's prior applications for well density exceptions in the Blanco-Mesaverde Gas Pool, I used a decline curve analysis of existing wells to estimate ultimate recoveries for the subject spacing unit under the existing well density. I then compared the estimated ultimate gas recoveries against log-derived volumetric calculations for the original gas in place with the cumulative gas production in the spacing unit. Using this approach, we identified areas, including the subject spacing unit, that have substantial remaining recoverable

gas and lower-than-expected gas recoveries where additional well bores or well completions are necessary to adequately drain remaining gas reserves.

5. **Exhibit C-1** contains information relating to the subject spacing unit and the **San Juan 28-7 Unit 224 Well** (API No. 30-039-21004) within the E/2 of Section 28, Township 28 North, Range 7 West, which is the well Hilcorp proposes for simultaneous dedication within the Blanco-Mesaverde Gas Pool in this application. It is currently producing within the Dakota formation. It will be the third Mesaverde completion in the quarter section in the spacing unit. I anticipate that it will help drain the area to the southeast.

6. **Exhibit C-2** is a basin-wide map reflecting Hilcorp's calculations for original gas in place across the Blanco-Mesaverde Gas Pool. The warmer colors represent areas where there is more original gas in place. The cooler colors indicate areas where there is less original gas in place. The red star indicates the location of the subject well in an area where we calculate moderately high volumes of original gas in place.

7. **Exhibit C-3** is a map depicting the calculated estimated ultimate recovery (EUR) from the Blanco-Mesaverde Gas Pool and drainage radius. The larger radius circles reflect wells with higher EURs and larger drainage areas. The red star identifies the location of the subject well where there is relatively low EURs and the drainage radii are smaller.

8. **Exhibit C-4** is a map depicting calculated remaining recoverable gas. The cooler colors indicate areas where there is relatively less remaining recoverable gas. The warmer colors reflect areas where there is relatively more remaining recoverable gas. The red star identifies the location of the subject well in an area where we calculate that there is relatively considerable remaining recoverable gas and relatively low EURs under the existing well density.

9. **Exhibit C-5** is a table that supports this volumetric analysis. The first column titled "Volumetric OGIP" reflects the calculated volumetric original gas in place on a quarter section, section, and nine-section area basis around the subject spacing unit. The column titled "Section Equivalent OGIP" shows the estimated gas in place to show that the estimates are consistent across the area. The column titled "CTD/RF%" shows the cumulative gas production to date on a quarter section, section, and nine-section area basis and the calculated recovery factor. The column titled "Remaining GIP" shows the estimated remaining gas in place on a quarter section, section, and nine-section area basis. The last column titled "EUR/RF%" shows the estimated ultimate gas recovery and recovery factor calculated on a quarter section, section, and nine-section area basis.

10. I would expect recovery factors of approximately 70-80% in a gas pool of this type. The relatively low recovery factors in Exhibit C-5 indicate that this area is not being sufficiently drained by the existing wells in the subject spacing unit under the existing well density and that additional well bores, or completions, are necessary to adequately drain the Blanco-Mesaverde Gas Pool in this area.

11. Approval of Hilcorp's application is therefore necessary to drain unrecovered gas reserves that will otherwise be left in place under the existing well density.

12. **Exhibit C-6** is a well bore diagram for the subject well. It provides the most current information known regarding the status and construction of the well, as well as the location and condition of cement within the wellbore. Hilcorp will separately seek administrative approval from the Division's Aztec District Office for authorization to recompleting this well in advance of undertaking any recompletion operations.

13. In my opinion, granting this application will not impair the Blanco-Mesaverde Gas Pool, and will be in the interest of conservation, the prevention of waste and will protect correlative rights.

14. Exhibits C-1 through C-6 were prepared by me or under my direction and supervision.

FURTHER AFFIANT SAYETH NAUGHT.

Tyler Teykl
Tyler Teykl

STATE OF TEXAS)
COUNTY OF Harris)

SUBSCRIBED and SWORN to before me this 6th day of August, 2019 by
Tyler Teykl.

[Signature]
NOTARY PUBLIC

My Commission Expires:

02/08/2023



San Juan 28-7 Unit 224

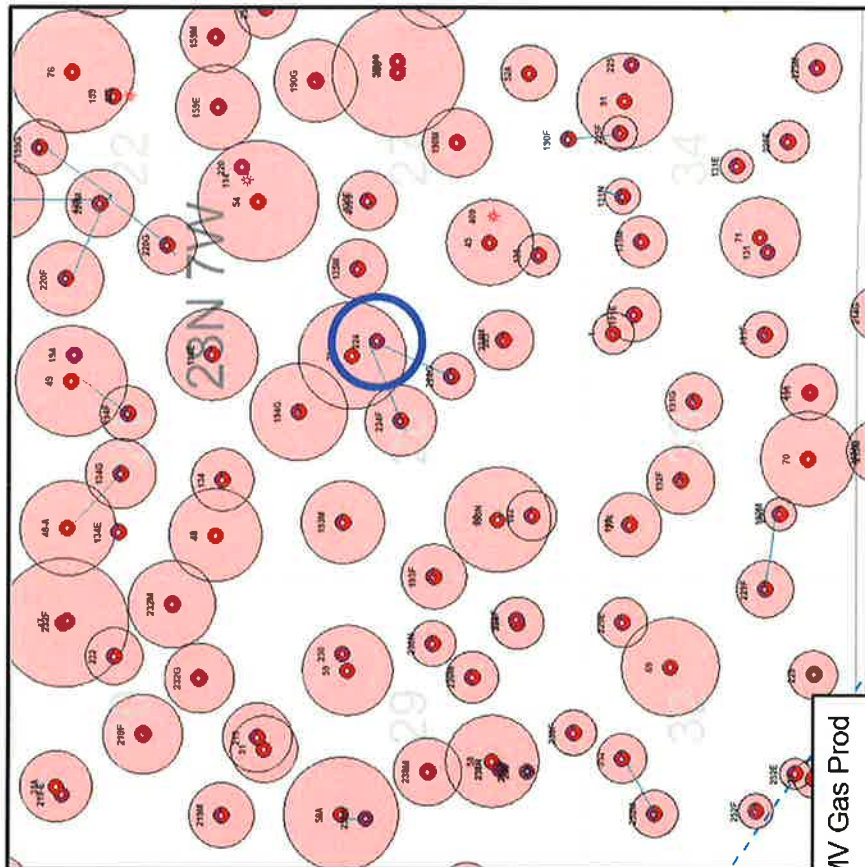

Well Specifics

- NE28 28-07 3003921004 1975 drill
- 3rd MV completion in 1/4 section
- 548' from nearest MV producer
- Help drain area to the southeast
- Complete MV in 1-3 stages





MV Original Gas In Place

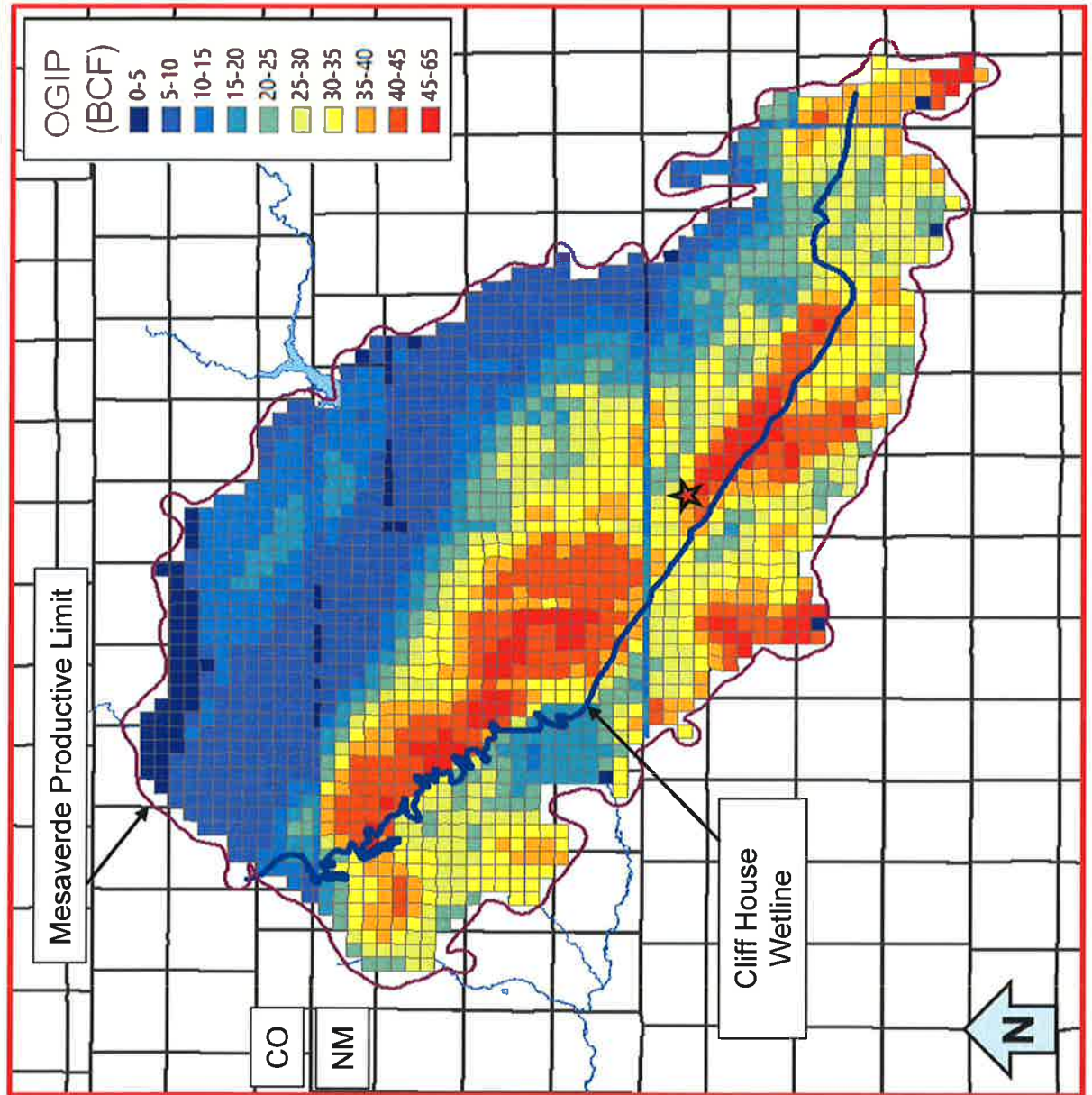



MV EUR and Drainage Radius

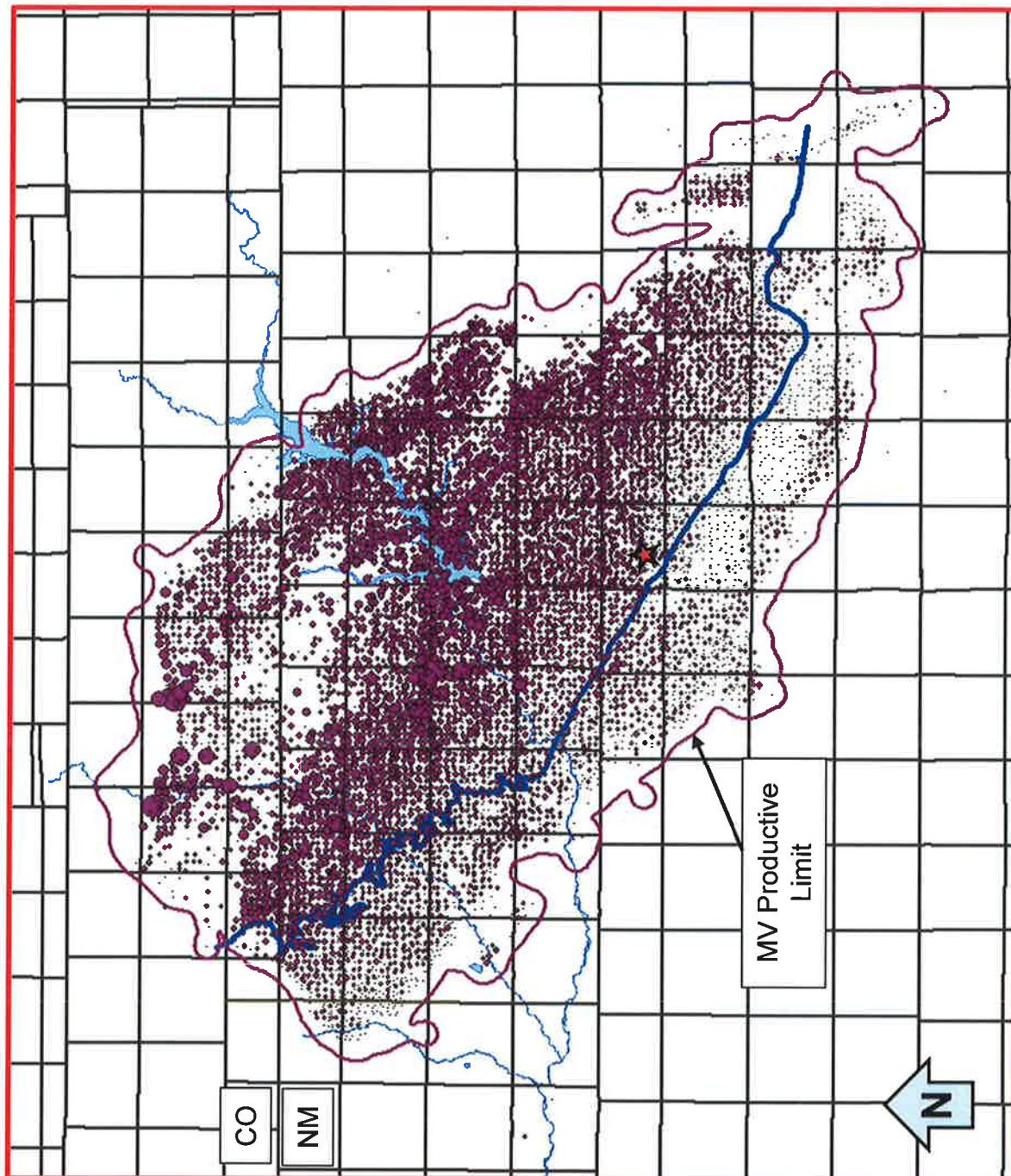



MV Remaining Recoverable Gas

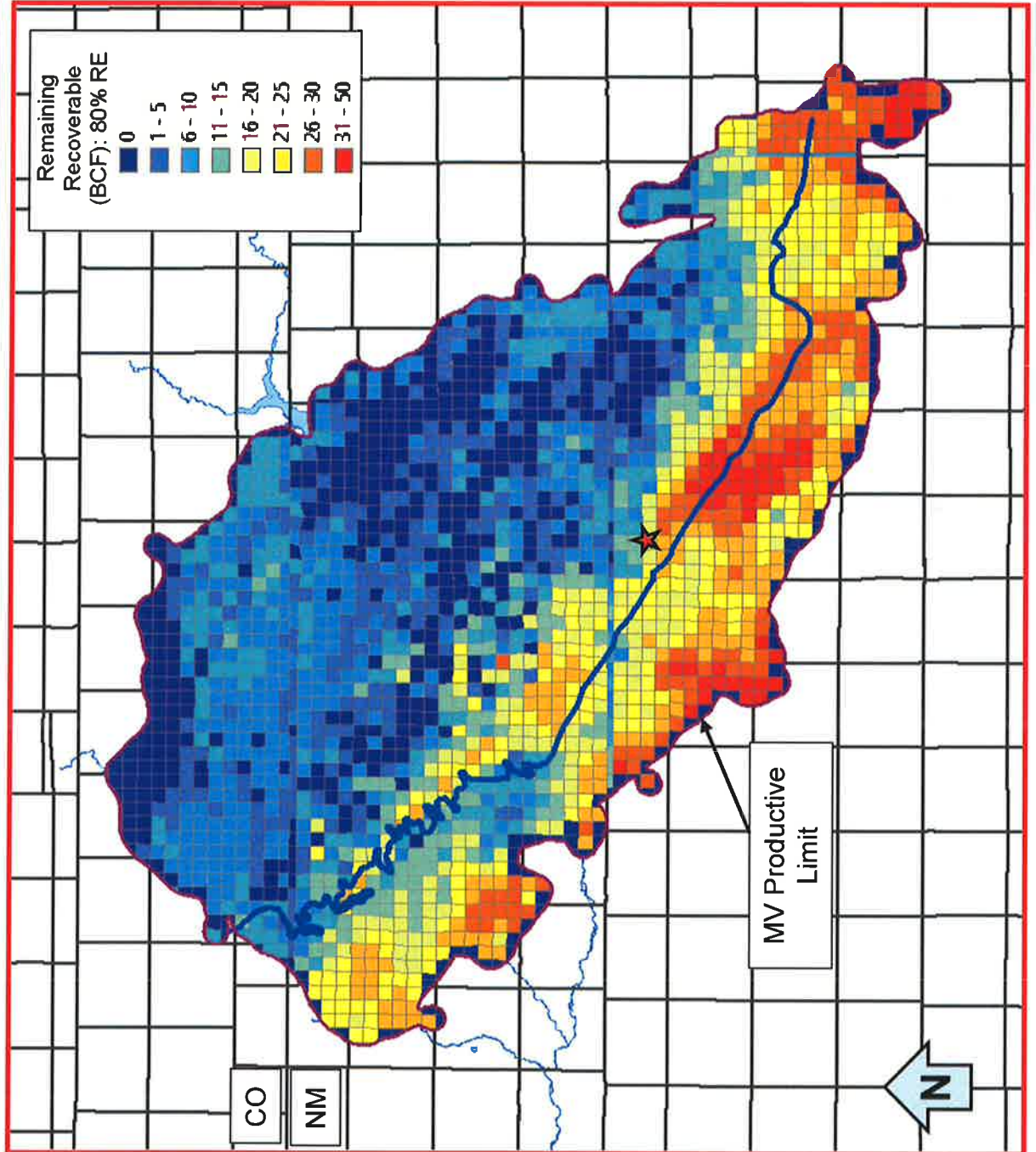

San Juan 28-7 Unit 224



Reference Area	Volumetric OGIP	Section Equivalent OGIP	CTD / RF%	Remaining GIP	EUR / RF%
Qtr Section	8.19 Bcf	32.8 Bcf	3.29 Bcf / 40%	4.9 Bcf	5.3 Bcf / 65%
Section	39.1 Bcf	39.1 Bcf	10.5 Bcf / 27%	28.6 Bcf	15.6 Bcf / 40%
9 Section	297 Bcf	33 Bcf	124 Bcf / 42%	173 Bcf	161 Bcf / 54%

- Remaining Gas in Place in Quarter Section of 4.9 Bcf
- Cumulative Recovery Factor to Date 40% and 27% in the Quarter Section and Section, respectively
- Considerable gas remaining in area with opportunity to recover additional volumes utilizing existing wellbore

San Juan 28-7 Unit 224

