



# United States Department of the Interior

GEOLOGICAL SURVEY  
South Central Region  
P. O. Box 26124  
Albuquerque, New Mexico 87125  
20 JAN 1981

366

Bass Enterprises Production Company  
Attention: Mr. Jens Hansen  
Fort Worth National Bank Building  
Fort Worth, Texas 76102

Gentlemen:

On this date, your 1981 plan of development and operation for the Poker Lake unit area, Eddy County, New Mexico, wherein you propose to drill Poker Lake No. 51 to test the Delaware and to drill wells Nos. 52 and 53 to test the Morrow formation, was approved. Such approval is subject to like approval by the appropriate State officials. One approved copy is enclosed.

Sincerely yours,

(ORIG. SGD.) GENE F. DANIEL

Gene F. Daniel  
Deputy Conservation Manager  
Oil and Gas

Enclosure

cc:  
NMOCD, Santa Fe (ltr only)

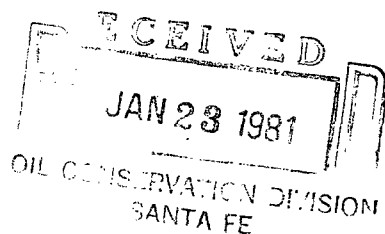

State of New Mexico

360



Commissioner of Public Lands

ALEX J. ARMIJO  
COMMISSIONER

January 22, 1981

P. O. BOX 1148  
SANTA FE, NEW MEXICO 87501

Bass Enterprises Production Company  
Fort Worth National Bank Building  
Fort Worth, Texas 76102

Re: 1981 Plan of Development  
Poker Lake Unit  
Eddy County, New Mexico

ATTENTION: Mr. Jens Hansen

Gentlemen:

The Commissioner of Public Lands has this date approved your 1981 Plan of Development for the Poker Lake Unit, Eddy County, New Mexico. Such plan proposes the drilling of Wells No. 51 (Delaware Test) and No. 52 and 53 both Morrow tests. Our approval is subject to like approval by the USGS and the NMOCD.

Enclosed is one approved copy for your files.

The Three (\$3.00) Dollar filing fee has been received.

Please be advised that your timely attention to our request for additional information in regard to this plan of development has greatly facilitated our review of same. Your cooperation in this matter is appreciated.

Very truly yours,

ALEX J. ARMIJO  
COMMISSIONER OF PUBLIC LANDS

BY:  
FLOYD O. PRANDO, Assistant Director  
Oil and Gas Division  
AC 505-827-2748

AJA/FOP/s  
encls.  
cc:

OCD-Santa Fe, New Mexico  
USGS-Roswell, New Mexico  
USGS-Albuquerque, New Mexico

OIL CONSERVATION DIVISION

P. O. BOX 2088  
SANTA FE, NEW MEXICO 87501

February 17, 1981

Bass Enterprises Production Co.  
Fort Worth National Bank Building  
Fort Worth, Texas 76102

Attention: Jens Hansen

Re: Case No. 366  
Poker Lake Unit  
1981 Plan of Development

Gentlemen:

We hereby approve the 1981 Plan of Development for the Poker Lake Unit, Eddy County, New Mexico, subject to like approval by the United States Geological Survey and the Commissioner of Public Lands.

Five approved copies of the Plan of Development are returned herewith.

Yours very truly,

JOE D. RAMEY  
Director

JDR/EP/fd  
enc.

cc: U.S.G.S. - Albuquerque  
Commissioner of Public Lands

C  
O  
P  
Y

BASS ENTERPRISES PRODUCTION CO.  
FORT WORTH NATIONAL BANK BUILDING  
FORT WORTH, TEXAS 76102

June 26, 1981

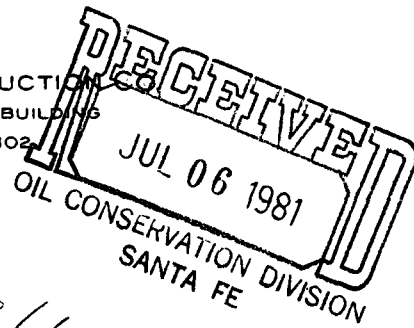

366

UNITED STATES GEOLOGICAL SURVEY  
P. O. Box 26124  
Albuquerque, New Mexico 87125

COMMISSIONER OF PUBLIC LANDS  
P. O. Box 1148  
Santa Fe, New Mexico 87501

OIL CONSERVATION DIVISION  
P. O. Box 2088  
Santa Fe, New Mexico 87501

OK  
8/25/81  
E/P

Re: First Amendment to the  
1981 Plan of Development  
for the Poker Lake Unit  
Eddy County, New Mexico

Gentlemen:

In accordance with the terms and provisions of Section 10 of the Poker Lake Unit Agreement dated March 18, 1952, which specifically provides that the Plan of Development may be modified when necessary to meet changing conditions, we propose the following change to the 1981 Plan of Development for your review and approval.

Poker Lake Unit Well #52 - The approved 1981 Plan of Development dated December 30, 1980, provides for the drilling of a 15,250' Morrow Test to be located in Section 10, T24S-R30E, Eddy County, New Mexico. Due to additional geological information received from drilling of the Poker Lake Wells #49 and #50, we request that the location of this well be changed from the above described location to a location of Section 35, T24S-R30E, with a new projected depth of 15,400' which will test the Morrow Formation. In addition, the rig availability problems experienced during this year prevent the actual drilling of this well until the first quarter of 1982. The Superior Oil Company will operate the drilling and completion of this well with all subsequent operations to be conducted in accordance with the terms of the Unit Agreement.

UNITED STATES GEOLOGICAL SURVEY  
COMMISSIONER OF PUBLIC LANDS  
OIL CONSERVATION DIVISION  
June 25, 1981

Page 2

If this proposed amendment to the 1981 Plan of Development meets with your approval, please so indicate by signing in the appropriate space provided below and return one (1) copy of this letter to us for our records.

Very truly yours,

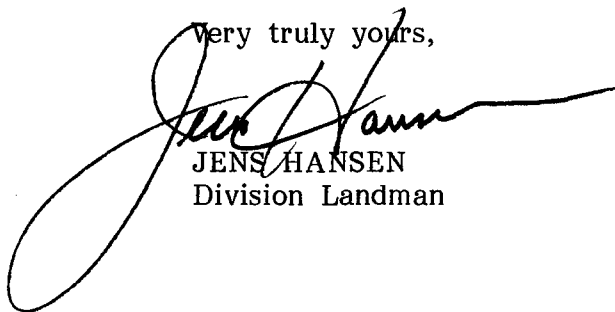
A large, stylized handwritten signature in black ink, appearing to read "Jens Hansen".

JENS HANSEN  
Division Landman

JH:ep

AGREED TO AND ACCEPTED this the 26 day of August, 1981.

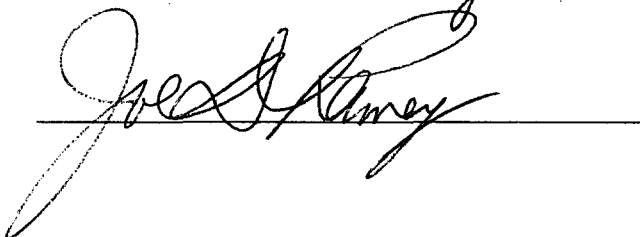
A handwritten signature in black ink, appearing to read "Joe A. Ames", written over a horizontal line.

# State of New Mexico

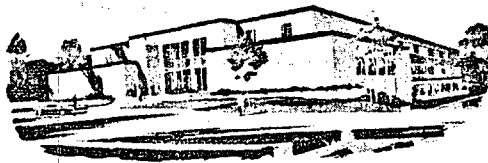

## Commissioner of Public Lands

July 7, 1981

P. O. BOX 1148  
SANTA FE, NEW MEXICO 87501

ALEX J. ARMIJO  
COMMISSIONER

366

Bass Enterprises Production Co.  
Fort Worth National Bank Building  
Fort Worth, Texas 76102

Re: First Amendment to the  
1981 Plan of Development  
for the Poker Lake Unit  
Eddy County, New Mexico

ATTENTION: Mr. Jens Hansen

Gentlemen:

The Commissioner of Public Lands has this date approved the First Amendment to the 1981 Plan of Development for the Poker Lake Unit, Eddy County, New Mexico. Such amendment changes the location of the well # 52 from Section 10 to Section 35 of Township 24 South, Range 30 East. Our approval is subject to like approval by the United States Geological Survey and the New Mexico Oil Conservation Commission.

Enclosed is one approved copy for your files.

Please remit a Three (\$3.00) Dollar filing fee.

Very truly yours,

ALEX J. ARMIJO  
COMMISSIONER OF PUBLIC LANDS

BY:  
RAY D. GRAHAM, Director  
Oil and Gas Division  
AC 505-827-2748

AJA/RDG/s  
encls.  
cc:

OCD-Santa Fe, New Mexico  
USGS-Roswell, New Mexico  
USGS-Albuquerque, New Mexico

BASS ENTERPRISES PRODUCTION CO.  
FORT WORTH NATIONAL BANK BUILDING  
FORT WORTH, TEXAS 76102

August 7, 1981

OK  
8/25/81  
[Signature]

UNITED STATES GEOLOGICAL SURVEY  
P. O. Box 26124  
Albuquerque, New Mexico 87125

COMMISSIONER OF PUBLIC LANDS  
P. O. Box 1148  
Santa Fe, New Mexico 87501

OIL CONSERVATION DIVISION  
P. O. Box 2088  
Santa Fe, New Mexico 87501

366

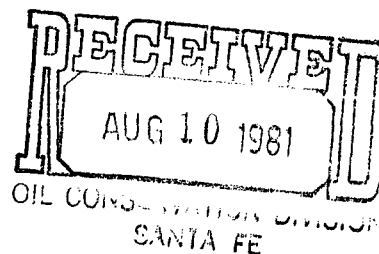

Re: Second Amendment to the  
1981 Plan of Development  
for the Poker Lake Unit,  
Eddy County, New Mexico

Gentlemen:

In accordance with the terms and provisions of Section 10 of the Poker Lake Unit Agreement dated March 18, 1952, which specifically provides that the Plan of Development may be modified when necessary to meet changing conditions, we propose the following change to the 1981 Plan of Development for your review and approval.

Poker Lake Unit Well # 53 - The approved 1981 Plan of Development dated December 30, 1980, provides for the drilling of a 16,000' Morrow Test to be located in Section 20, T25S-R31E, Eddy County, New Mexico. After evaluating the geological data obtained from the drilling of the Poker Lake Well #50, we believe that a location in Section 9, T25S-R30E will evaluate the Morrow, Atoka, and Wolfcamp Formations as were found in the Poker Lake #50 Well and will also evaluate the Delaware Formation which we anticipate to be productive at this location. We do not see this possibility for the Delaware Formation in Section 20. Therefore, we respectfully request that the location of the Poker Lake Unit Well #53 be changed from the above described location to a location of 660' from the North line and 1980' from the East line of Section 9, T25S-R30E, Eddy County, New Mexico and that such well be drilled to a depth of 15,500' which will test the Morrow Formation.

UNITED STATES GEOLOGICAL SURVEY  
COMMISSIONER OF PUBLIC LANDS  
OIL CONSERVATION DIVISION  
August 7, 1981

Page 2

If this proposed amendment to the 1981 Plan of Development meets with your approval, please so indicate by signing in the appropriate space provided below and return one (1) copy of this letter to us for our records.

Yours very truly,

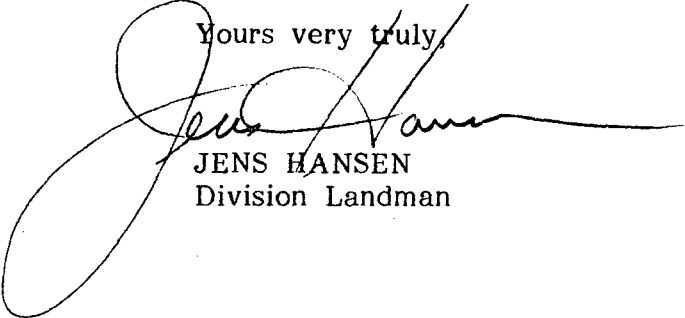

JENS HANSEN  
Division Landman

JH/bb

AGREED TO AND ACCEPTED this the 26 day of Aug., 1981

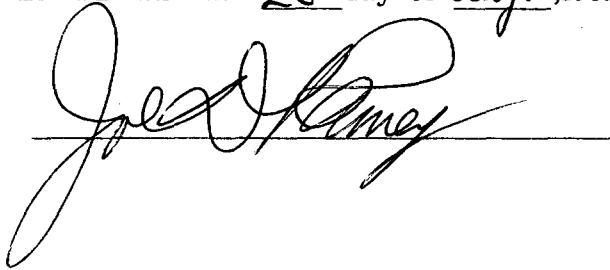



BASS ENTERPRISES PRODUCTION CO.  
FORT WORTH NATIONAL BANK BUILDING  
FORT WORTH, TEXAS 76102

August 10, 1981

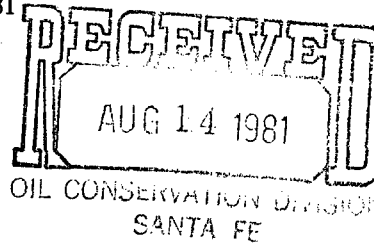

366

OIL CONSERVATION DIVISION  
P. O. Box 2088  
Santa Fe, New Mexico 87501

Re: Second Amendment to the  
1981 Plan of Development  
for the poker Lake Unit,  
Eddy County, New Mexico

Gentlemen:

Under date of August 7, 1981 we proposed an Amendment to the 1981 Plan of Development for the Poker Lake Unit. In the proposed Amendment a revised well location was proposed which is described incorrectly as Section 9, T25S-R30E. The correct location should read Section 9, T25S-R31E, Eddy County, New Mexico. It would be appreciated if you would incorporate this change in the said August 7 letter.

Yours very truly,

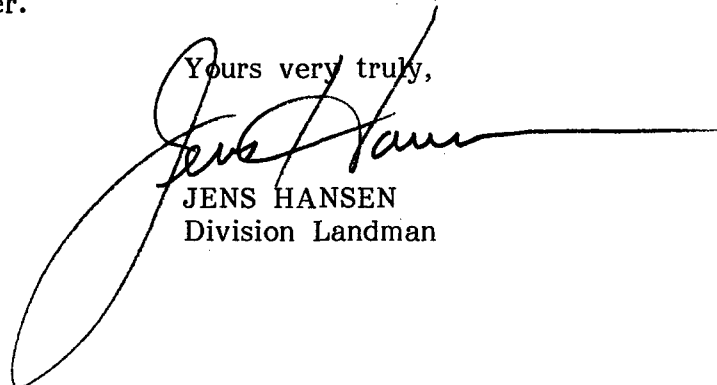
  
JENS HANSEN  
Division Landman

JH/bb

State of New Mexico



ALEX J. ARMIJO  
COMMISSIONER

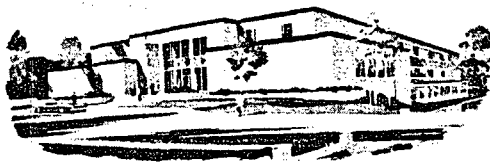

Commissioner of Public Lands

August 12, 1981

366

P. O. BOX 1148  
SANTA FE, NEW MEXICO 87501

Bass Enterprises Production Co.  
Ft. Worth Nat'l Bank Building  
Fort Worth, Texas 76102

Re: Poker Lake Unit  
Second Amendment to the  
1981 Plan of Development

ATTENTION: Mr. Jens Hansen

Gentlemen:

Your Second Amendment to the 1981 Plan of Development dated August 7, 1981, has this date been approved by the Commissioner of Public Lands. Such plan proposes the changing from a 16,000' Morrow Test Well in Section 20 Township 25 South, Range 31 East, to be drilled in a new location 660' from the North line and 1980' from the East line of Section 9, Township 25 South, Range 30 East. Such well will be drilled to a depth of 15,000' which will test the Morrow Formation. Our approval is subject to like approval by the Oil Conservation Division and the United States Geological Survey.

Enclosed is one approved copy for your files. In the future please file three copies with this office of your Plan of Development, also, please remit a Three (\$3.00) Dollar filing fee at your earliest convenience.

Very truly Yours,

ALEX J. ARMIJO  
COMMISSIONER OF PUBLIC LANDS

BY:  
RAY D. GRAHAM, Director  
Oil and Gas Division  
AC 505/827-2748

AJA/RDG/pm  
encl.

cc: OCD-Santa Fe, New Mexico  
USGS-Albuquerque, New Mexico



STATE OF NEW MEXICO  
ENERGY AND MINERALS DEPARTMENT  
OIL CONSERVATION DIVISION

BRUCE KING  
GOVERNOR  
LARRY KEHOE  
SECRETARY

August 26, 1981

POST OFFICE BOX 2088  
STATE LAND OFFICE BUILDING  
SANTA FE, NEW MEXICO 87501  
(505) 827-2434

Bass Enterprises Production Co.  
Fort Worth National Bank Building  
Fort Worth, Texas 76102

Attention: Jens Hansen

Re: Case No. 366  
Poker Lake Unit  
First Amendment to  
1981 Plan of Development

Gentlemen:

We hereby approve the First Amendment to the 1981 Plan of Development for the Poker Lake Unit, Eddy County, New Mexico, subject to like approval by the United States Geological Survey and the Commissioner of Public Lands.

One approved copy of the First Amendment is returned herewith.

Yours very truly,

JOE D. RAMEY  
Director

JDR/EP/fd  
enc.

cc: U.S.G.S. - Albuquerque  
Commissioner of Public Lands



STATE OF NEW MEXICO  
**ENERGY AND MINERALS DEPARTMENT**  
OIL CONSERVATION DIVISION

BRUCE KING  
GOVERNOR

LARRY KEHOE  
SECRETARY

August 26, 1981

POST OFFICE BOX 2088  
STATE LAND OFFICE BUILDING  
SANTA FE, NEW MEXICO 87501  
(505) 827-2434

Bass Enterprises Production Co.  
Fort Worth National Bank Building  
Fort Worth, Texas 76102

Attention: Jens Hansen

Re: Case No. 366  
Poker Lake Unit  
Second Amendment to  
1981 Plan of Development

Gentlemen:

We hereby approve the Second Amendment to the 1981 Plan of Development for the Poker Lake Unit, Eddy County, New Mexico, subject to like approval by the United States Geological Survey and the Commissioner of Public Lands.

One approved copy of the Second Amendment is returned herewith.

Yours very truly,

JOE D. RAMEY  
Director

JDR/EP/fd  
enc.

cc: U.S.G.S. - Albuquerque  
Commissioner of Public Lands

South Central Region  
P. O. Box 26124  
Albuquerque, New Mexico 87125

366

SEP 2 1981

Bass Enterprises Production Co.  
Attention: Jens Hansen  
Fort Worth National Bank Bldg.  
Fort Worth, Texas 76102

Gentlemen:

An approved copy of your second amendment to the 1981 plan of development for the Poker Lake unit area, Eddy County, New Mexico is enclosed. Such plan, proposing to change the location of well #53 from sec. 20, T. 25 S., R. 31 E., to sec. 9, T. 25 S., R. 31 E., to test the Morrow formation, was approved on this date subject to like approval by the appropriate officials of the State of New Mexico.

Sincerely yours,

(ORIG. SGD.) JAMES W. SHELTON

FOR Gene F. Daniel  
Deputy Conservation Manager  
Oil and Gas

Enclosure

cc:  
Comm of Pub Lands  
NMOCD  
D.D. Roswell (w/encl)

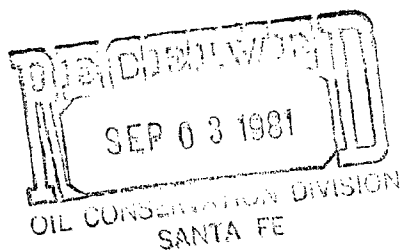

BASS ENTERPRISES PRODUCTION CO.  
FORT WORTH NATIONAL BANK BUILDING  
FORT WORTH, TEXAS 76102

December 10, 1981

UNITED STATES GEOLOGICAL SURVEY  
P. O. Box 26124  
Albuquerque, New Mexico 87125

NEW MEXICO OIL CONSERVATION DIVISION  
P. O. Box 2088  
Santa Fe, New Mexico 87501

COMMISSIONER OF PUBLIC LANDS  
P. O. Box 1148  
Santa Fe, New Mexico 87501

Re: Application for Approval of  
Initial Participating Area for the  
Wolfcamp Formation  
Poker Lake Unit Area  
Eddy County, New Mexico

Gentlemen:

Bass Enterprises Production Co., as unit operator for the Poker Lake Unit Agreement, pursuant to the provisions of Section 11, respectfully submits for your approval the selection of the following described lands to constitute the Initial Participating Area for the Wolfcamp producing zone or formation, to wit:

Lots 1, 2, 3 and 4 and the S/2 N/2, Section 4, T25S-R31E, Eddy County, New Mexico, and containing 319.82 acres of land.

In support of this application, the following numbered items are attached hereto and made a part hereof:

- (1) An ownership map showing thereon the boundaries of the unit area and the proposed Initial Participating Area.
- (2) A schedule showing the lands entitled to participation in the unitized substances produced from the Wolfcamp Formation, with the percentage of participation of each lease or tract indicated thereon.

Applicant is submitting separately in triplicate a geological and engineering report with accompanying geologic maps supporting and justifying the proposed selection of the Participating Area.

This proposed Initial Participating Area is predicated upon the knowledge and information first obtained upon the completion in paying quantities under the terms of the Unit Agreement on May 16, 1981, of Unit Well No. 50, in the NW/4 NE/4,

366

UNITED STATES GEOLOGICAL SURVEY  
NEW MEXICO OIL CONSERVATION DIVISION  
COMMISSIONER OF PUBLIC LANDS  
December 10, 1981  
Page 2 of 2

Section 4, T25S-R31E, with an initial production of gas and gas condensate from the Wolfcamp Formation at a depth of 12,956 to 12,963 feet. The effective date of this initial area shall be June 1, 1981, pursuant to Section 11 of the Unit Agreement.

Consequently, applicant respectfully requests your approval of the hereinabove selection of lands to constitute the Initial Wolfcamp Participating Area, to be effective June 1, 1981.

Sincerely,

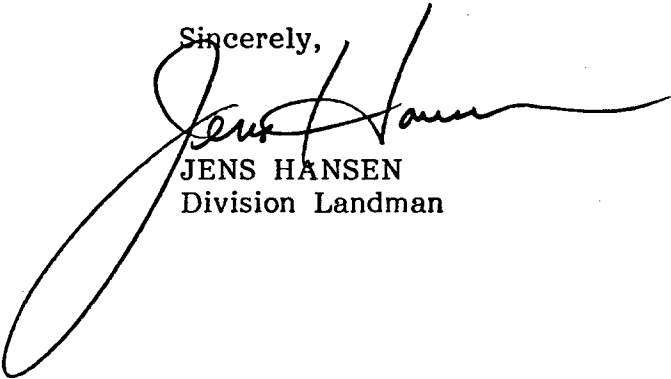

JENS HANSEN  
Division Landman

JH:ep

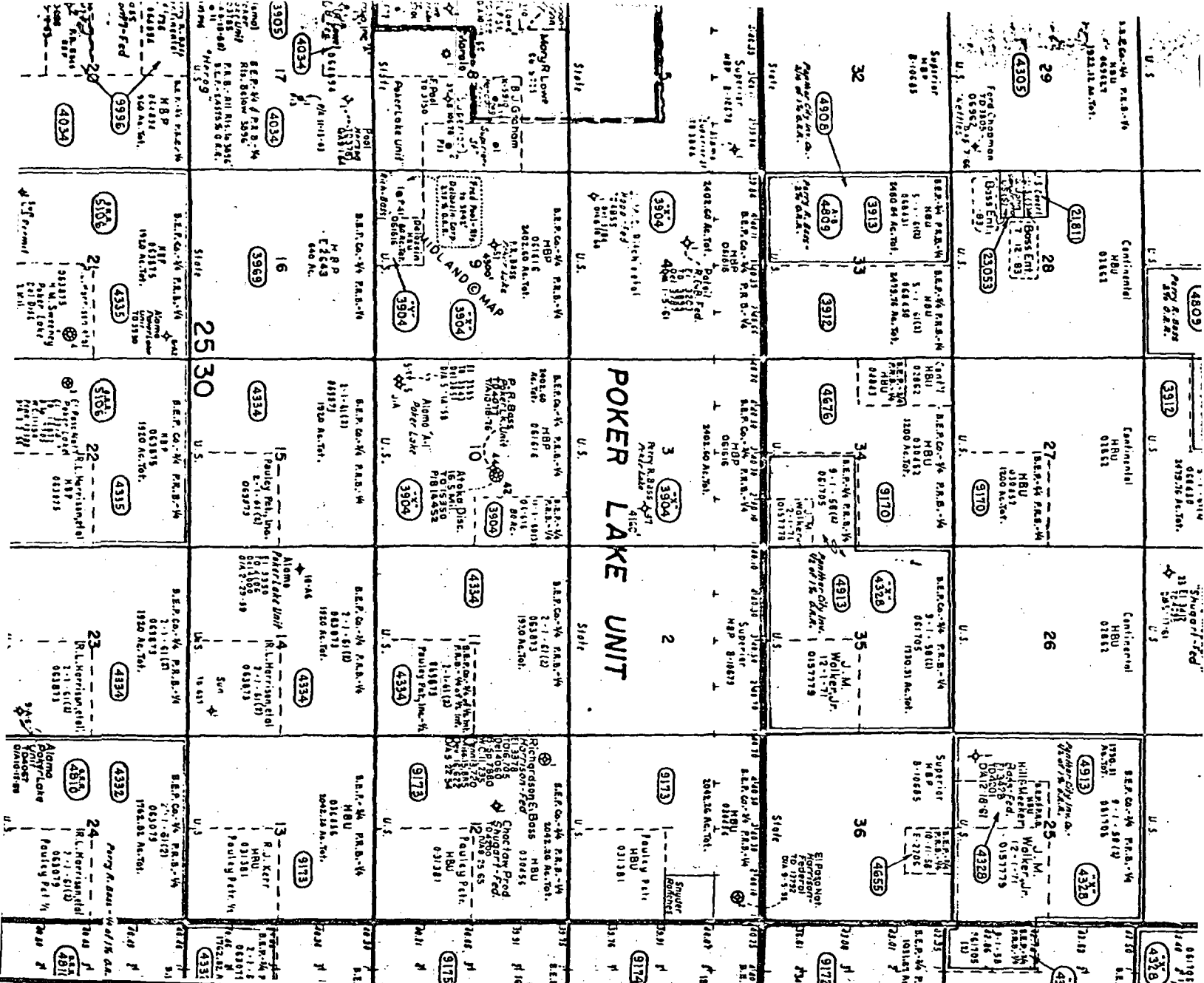

Date	Inter By	Scale 1"=4000'
------	----------	----------------



EXHIBIT "B"  
 INITIAL WOLF CAMP FORMATION  
 PARTICIPATING AREA  
 POKER LAKE UNIT  
 EDDY COUNTY, NEW MEXICO

Tract No.	Lease No. Type of Land	Description	Participating Acres	Percentage of Participation	Working Interest Owners
22-A	NM-030457	T25S-R31E Sec. 4: Lots, 1, 2, 3, 4 S/2 N/2	319.82	73.21	Bass Enterprises Production Co. & Perry R. Bass
			319.82	100.00	Amoco Production Co. Tenneco Oil Co.
			319.82	100.00	
			0.00	0.00	
			0.00	0.00	
			319.82	100.00	

Total Federal Lands  
 Total State Lands  
 Total Patented Lands

319.82 100.00  
 0.00 0.00  
 0.00 0.00  
 319.82 100.00

POKER LAKE UNIT NO. 50

Poker Lake Unit No. 50 was initially completed in the Morrow formation and had a CAOF of 644 MCFGPD. With the Morrow being non-commercial, the Atoka was tested at 992 MCFPD but was never completed due to the low flow rate. Finally, after 7500 gallons 7-1/2% MSR acid, the Wolfcamp was completed, and because of downhole mechanical problems and abnormally high pressures was placed on line immediately. Current cumulative production through August 31, 1981, is 561.2 MMCFG and 7637 BC. The August rate was 134,415 MCFG and 1785 BC. The well is a commercial producer.

# WORKSHEET FOR COMMERCIAL DETERMINATION AND PARTICIPATING AREA IN FEDERAL UNITS

## WELL DATA

WELL POKER LAKE 50 FORMATION WOLFCAMP  
 LOCATION B UNIT, 660 FEET FROM N LINE & 1980 FEET FROM E LINE,  
 SECTION 4, RANGE 31E, TOWNSHIP 25S, COUNTY EDDY NEW MEXICO.  
 SPUD DATE 8-6-80 COMPLETION DATE 5-16-81 INIT. PROD. DATE 5-18-81  
 PERFORATIONS 1 9/16" select fire @ 12,950 1/2', 12,956, 12,963', 12,968',  
12,975', 12,978', 12,982', 12,988', 12,992 1/2', 1 JSPF

## STIMULATION:

ACID with 7,500 gallons 7 1/2 MSR-100

FRACTURE

POTENTIAL 6,006 MCFPD \*Not CAOF, but accepted by State of New Mexico in  
satisfaction of AOF requirements.

(ATTACH COPY OF C-122. ATTACH COPY OF WELLBORE SKETCH OF COMPLETED WELL.)

## VOLUMETRIC CALCULATION

	FORMATION	
	SANDS PERFORATED	SANDS NOT PERFORATED BUT POTENTIALLY PRODUCTIVE
Area (A) proration unit size, acres	320	
Porosity ( $\phi$ ), %	9	
Water saturation ( $S_w$ ), %	27	
Net thickness (h) > 6% $\phi$ & 40% $S_w$ , ft	42	
Temperature (T), °F	170	

Bottomhole pressure (P), psia 10,300  
 Recovery factor (RF), (80% assumed) .8  
 Recoverable gas, MCF (See eq. below) 12,308,425

Recoverable Gas, MCF =  $(43,560)(\emptyset)(1-S_w)(A)(h)(RF)(B_{gi})$  where

$$B_{gi} = 0.03535 \frac{P}{zT} \left( \frac{MSCF}{Cu Ft} \right) = 0.03535 \frac{(10300)}{(1.475)(621)} = .40$$

#### PERFORMANCE DATA

If sufficient history exists, attach plot of gas production rate vs time.

(Cumulative production to 8 / 31 / 81; 561,205 MCF.

Current rate ( $q_i$ ), 134,415 MCF/mo

Economic limit ( $q_l$ ), 3000 MCF/mo

Decline rate,  $dy$  \_\_\_\_\_ %

Remaining gas (Q) = \_\_\_\_\_ MCF

Ultimate Recoverable Gas \_\_\_\_\_ MCF

$$Q = \frac{(q_i - q_l) 12 \text{ mo/yr}}{-\ln(1-dy)}$$

Attach plat showing proration unit and participating area.

<u>RECOVERABLE GAS</u>	<u>GAS (MCF)</u>	<u>COND (BBLS)</u>
Gas sand previously produced	<u>0</u>	<u>0</u>
Sand perforated	<u>7,800,000* (1)</u>	<u>93,600</u>
Sand not perforated, but potentially productive	<u>0 (2)</u>	<u>0</u>
Total recoverable gas	_____	_____

(1) performance recoverable gas if available

(2)  $\frac{\text{performance sand perforated}}{\text{volumetric sand perforated}} \times \frac{\text{volumetric sands not perforated}}{\text{performance sands not perforated}} =$

Participating area size based on ratio of production history and volumetrics

320 acres---minimum area is proration unit.

\*Attached BHP/z

## ECONOMIC

\*Well Cost \$ 2,766,939 (to the depth of formation completed)

Recompletion Cost \$ 0

TOTAL COST \$ 2,766,939

(Gas Price)(Net Revenue Interest)(1-Production and Ad Valorem Taxes) + {(Oil Price)  
(Net Revenue Interest)(Cond. Yield, Bbls/MCF)(1-Production and Ad Valorem Taxes) -  
(Oil Price - Base Excise Tax) WFPT Frac}

Net Gas Price = Gas Price (.845)(1-0.1) + (16 + (33-16).7)(0.845)(1-.1)(Cond. Yield,  
Bbls/MCF)

\$2.19/MCF

\*\*Operating Cost \$2000/Month

Bepco Net Income = (Gross Gas) (Net Gas Price)

YEAR	GROSS GAS	BEPCO NET INCOME	OPERATING COST	20% DISCOUNT FACTOR	DISCOUNTED CASH FLOW
zero	---	---	---	0 1.0000	-2,766,939
1981	561,205	1,229,038	8,000	1 0.9129	1,114,686
Through August 31 198			Through August 31	0.7607	
198				0.6339	
198				0.5283	
198				0.4402	
Remainder				0.3669	

If payout is five years or less, well is considered economical.

(Bepco Net Income - Operating Expense) discount factor = discounted cash flow.

ECONOMICAL

\* Includes 11% of drilling cost as overhead.

\*\* Includes \$500/month as overhead.

NEW MEXICO OIL CONSERVATION COMMISSION  
MULTIPOINT AND ONE POINT BACK PRESSURE TEST FOR GAS WELL

Form C-122  
Revised 9-1-

Type Test <input checked="" type="checkbox"/> Initial <input type="checkbox"/> Annual <input type="checkbox"/> Special				Test Date <u>May 17, 1981</u>			
Company <u>PERRY R. BASS</u>				Connection <u>NATURAL GAS PIPELINE CO. OF AM.</u>			
Pool <u>WILDCAT</u>				Formation <u>WOLF CAMP</u>			
Completion Date <u>MAY 16, 1981</u>		Total Depth <u>15,345'</u>		Plug Line 1 <u>14,780'</u>		Elevation <u>3437' GL</u>	
Cas. Size <u>5"</u>	Wt. <u>18</u>	d <u>15,345'</u>	Set At <u>15,345'</u>	Perforations: From <u>12,950 1/2'</u> To <u>12,992 1/2'</u>		Well No. <u>50</u>	
Thg. Size <u>2 3/8"</u>	Wt. <u>4.7</u>	d <u>12,830</u>	Set At <u>12,830</u>	Perforations: From <u>—</u> To <u>—</u>		Unit    Sec.    Twp.    Rge. <u>B    4    25S    31E</u>	
Type Well - Single - Blindhead - G.C. or C.O. Multiple <u>SINGLE</u>				Packer Set At <u>12,270'</u>		County <u>EDDY</u>	
Producing Thru <u>TUBING</u>		Reservoir Temp. °F <u>—</u>		Mean Annual Temp. °F <u>—</u>		Baro. Press. - P <sub>a</sub> <u>—</u>	
State <u>NEW MEXICO</u>							
L	H	Cg	% CO <sub>2</sub>	% N <sub>2</sub>	% H <sub>2</sub> S	Prover	Motor Run    Tape

FLOW DATA						TUBING DATA		CASING DATA		Duration of Flow
NO.	Prover Line Size	X	Orifice Size	Press. p.s.i.g.	Diff. h <sub>w</sub>	Temp. °F	Press. p.s.i.g.	Temp. °F	Press. p.s.i.g.	
SI										
1.										
2.										
3.										
4.										
5.										

RATE OF FLOW CALCULATIONS							
NO.	Coefficient (24 Hour)	$\sqrt{h_w P_m}$	Pressure P <sub>m</sub>	Flow Temp. Factor Ft.	Gravity Factor Fg	Super Compress. Factor, Fpv	Rate of Flow Q, Mcd
1							
2							
3							
4							
5							

NO.	P <sub>i</sub>	Temp. °R	T <sub>i</sub>	Z	Gas Liquid Hydrocarbon Ratio	Mcf/bbl.
1						
2						
3						
4						
5						

NO.	P <sub>i</sub> <sup>2</sup>	P <sub>w</sub>	P <sub>w</sub> <sup>2</sup>	P <sub>c</sub> <sup>2</sup> - P <sub>w</sub> <sup>2</sup>	(1) $\frac{P_c^2}{P_c^2 - P_w^2} =$	(2) $\left[ \frac{P_c^2}{P_c^2 - P_w^2} \right]^n =$
1						
2						
3						
4						
5						

Absolute Open Flow _____ Mcd @ 15.025				Angle of Slope θ _____		Slope, n _____	
---------------------------------------	--	--	--	------------------------	--	----------------	--

Remarks: ONE DAY FLOWING POTENTIAL 6006 MCF + 77 BC + 0 BW IN 24 HRS.  
\* SUBMITTED IN LIEU OF 4 POINT \* 4 POINT WILL BE RUN AS  
PRESSURES PER MIT RE: GRESSETT/ARTESIA/NMOC

Approved By Commission:	Conducted By: <u>McCuningham</u>	Calculated By:	Checked By:
-------------------------	-------------------------------------	----------------	-------------

# BASS ENTERPRISES PRODUCTION CO.

## WEST TEXAS DIVISION

POKER LAKE UNIT NO. 50

BIG SINKS (MORELOW)

LOCATION: 660 FNL-1980 FCL SECTION 4, T.25-S, R.32-E  
 EDDY COUNTY  
 NEW MEXICO

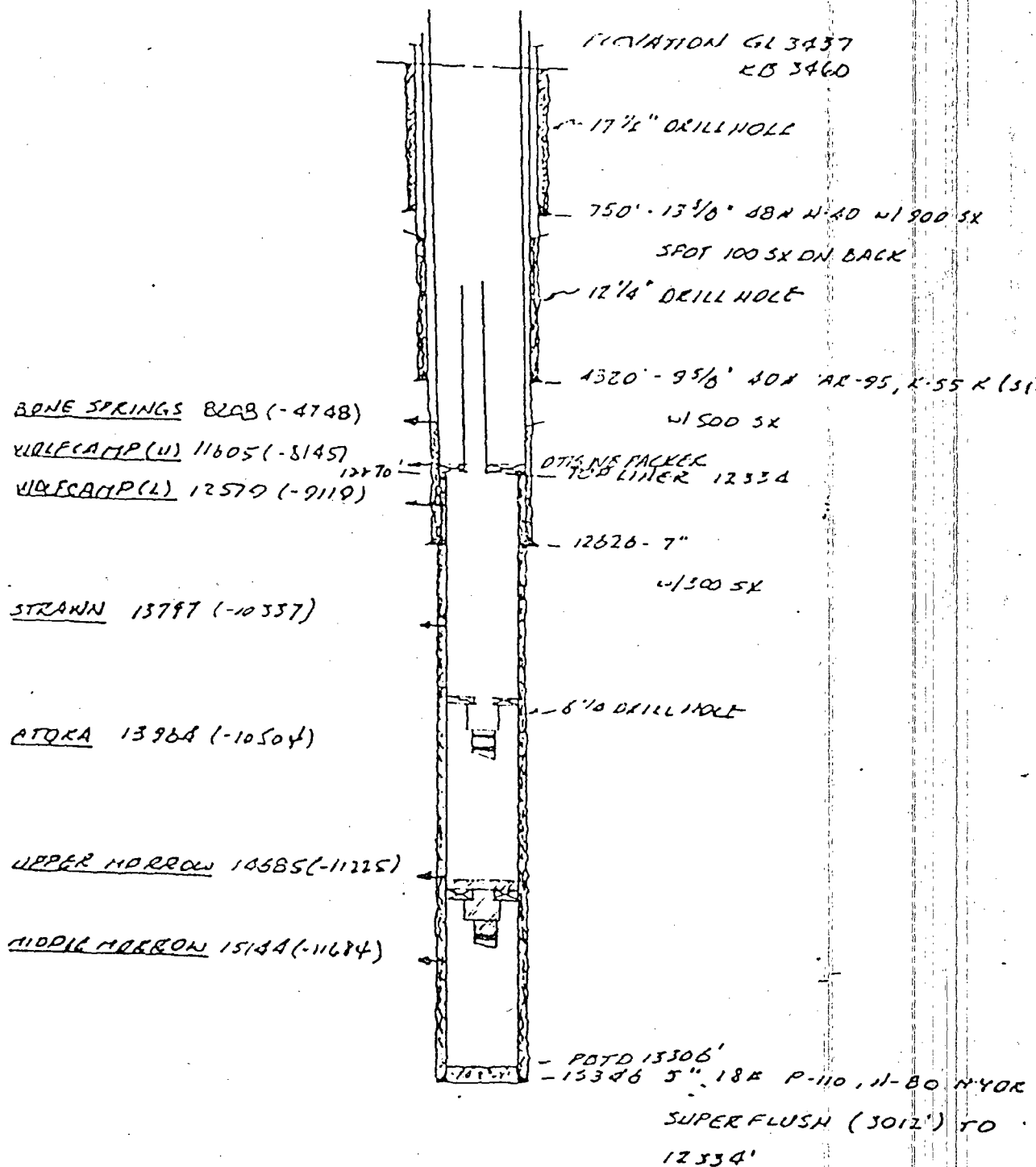

FIELD: Wildcat Walfcamp COUNTY: \_\_\_\_\_

OPERATOR: \_\_\_\_\_

LEASE: Poker Lake Unit NM

BTY. NO. \_\_\_\_\_

WELLS: # 50

	Number Producing Wells	Oil Produced Bbls.	Cumulative Oil Rbls.	Gas Produced MCF	Cumulative Gas MCF	Water Produced Bbls.
1981						
Jan.	-	/		/		/
Feb.	-					
March	-					
April	-					
May	1	992		82,293		36
June		2494		174,059		261
July		2366		170,433		256
August		1785		134,415		202
Sept.		7637		561,205		755
Oct.						
Nov.						
Dec.						
Yearly Total						

Jan.						
Feb.						
March						
April						
May						
June						
July						
August						
Sept.						
Oct.						
Nov.						
Dec.						
Yearly Total						

Jan.						
Feb.						
March						
April						
May						
June						
July						
August						
Sept.						
Oct.						
Nov.						
Dec.						
Yearly Total						





# NEW MEXICO OIL CONSERVATION COMMISSION WELL LOCATION AND ACREAGE DEDICATION PLAT

Form C-102  
Supersedes C-1  
Effective 1-1-61

All distances must be from the outer boundaries of the Section.

Operator <b>Perry R. Bass</b>			Lease <b>Poker Lake Unit</b>		Well No. <b>50</b>
Unit Letter <b>B</b>	Section <b>4</b>	Township <b>25S</b>	Range <b>31E</b>	County <b>Eddy</b>	
Actual Footage Location of Well: <b>660</b> feet from the <b>North</b> line and <b>1980</b> feet from the <b>East</b> line					
Ground Level Elev. <b>3436.8'</b>	Producing Formation <b>Wolfcamp</b>		Pool <b>Wildcat</b>		Dedicated Acreage: <b>320</b> Acres

1. Outline the acreage dedicated to the subject well by colored pencil or hatchure marks on the plat below.
2. If more than one lease is dedicated to the well, outline each and identify the ownership thereof (both as to working interest and royalty).
3. If more than one lease of different ownership is dedicated to the well, have the interests of all owners been consolidated by communitization, unitization, force-pooling, etc?

☒ Yes    ☐ No    If answer is "yes" type of consolidation Unit

If answer is "no," list the owners and tract descriptions which have actually been consolidated. (Use reverse side of this form if necessary.)

No allowable will be assigned to the well until all interests have been consolidated (by communitization, unitization, forced-pooling, or otherwise) or until a non-standard unit, eliminating such interests, has been approved by the Commission.

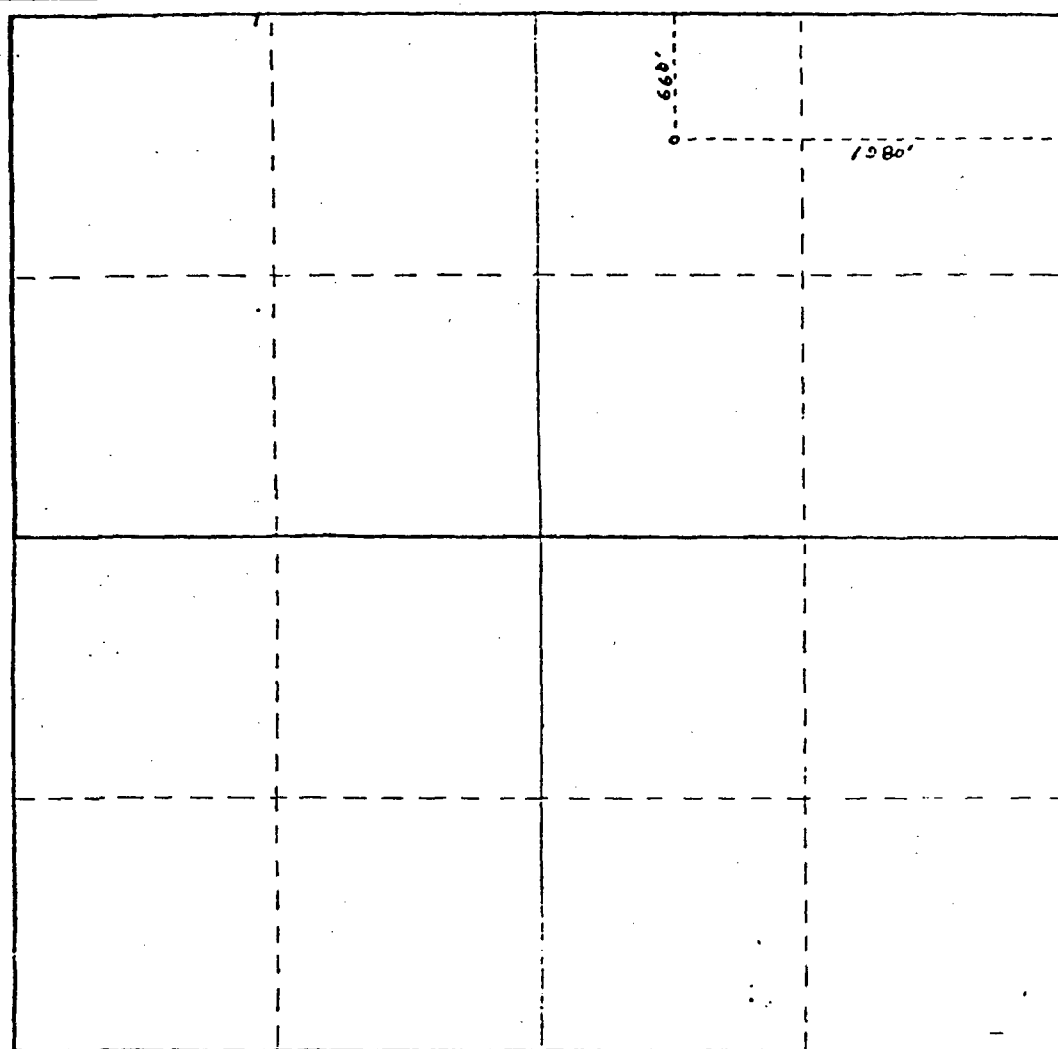

## CERTIFICATION

I hereby certify that the information contained herein is true and complete to the best of my knowledge and belief.

*H. F. Wurtz, Jr.*

Name

**H. F. Wurtz, Jr.**

Position

**Senior Production Clerk**

Company

**Perry R. Bass**

Date

**May 27, 1981**

I hereby certify that the well location shown on this plat was plotted from field notes of actual surveys made by me or under my supervision, and that the same is true and correct to the best of my knowledge and belief.

Date Surveyed

**June 7, 1980**

Registered Professional Engineer and/or Land Surveyor

**John W. West**

Certificate No.

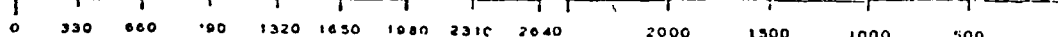

# BASS ENTERPRISES PRODUCTION COMPANY

PAGE NO.

SUBJECT	DATE	DEPARTMENT	PREPARED BY
---------	------	------------	-------------

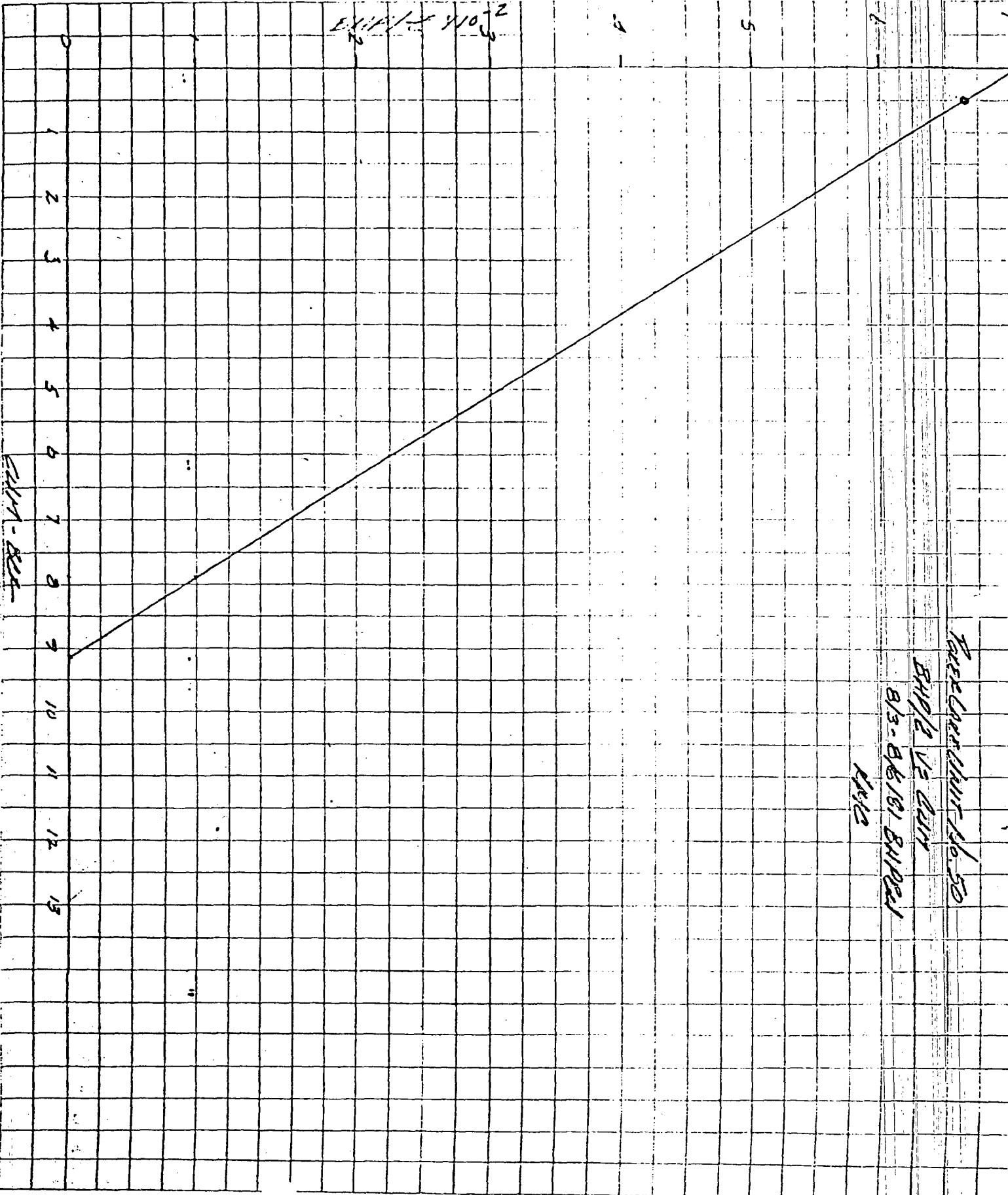

# STRUCTURE MAP : TOP WOLFCAMP

 Proposed 320 acre Initial Wolfcamp Participating Area

Scale - 1" = 4,000'

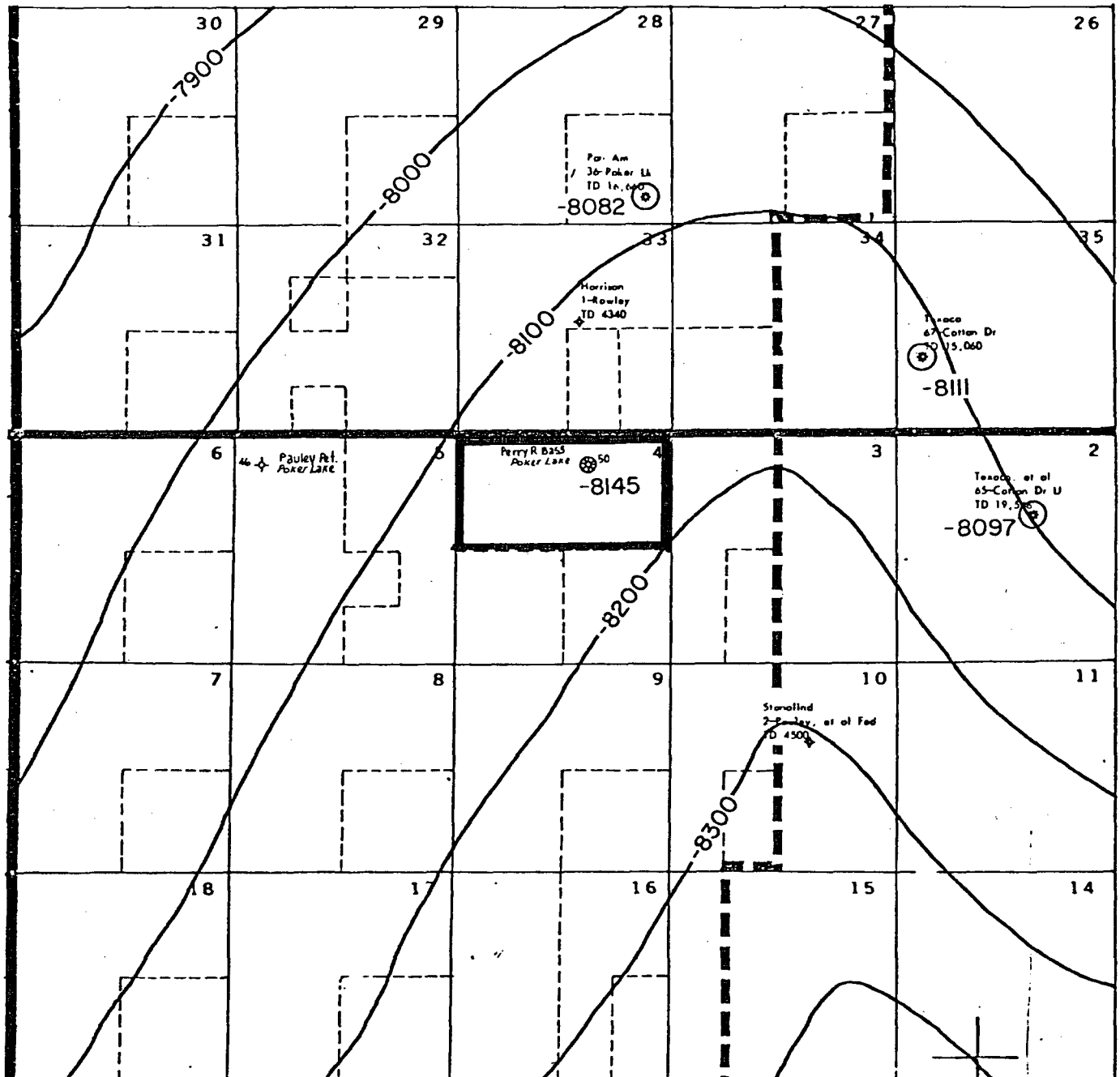

BASS ENTERPRISES PRODUCTION CO.  
FORT WORTH NATIONAL BANK BUILDING  
FORT WORTH, TEXAS 76102

December 15, 1981

UNITED STATES GEOLOGICAL SURVEY  
P. O. Box 26124  
Albuquerque, New Mexico 87125

366

COMMISSIONER OF PUBLIC LANDS  
P. O. Box 1148  
Santa Fe, New Mexico 87501  
Attention: Ray Graham

NEW MEXICO OIL CONSERVATION DIVISION  
P. O. Box 2088  
Santa Fe, New Mexico 87501

Re: 1982 Plan of Development  
Poker Lake Unit  
Eddy County, New Mexico

Gentlemen:

In accordance with Section 10 of the Poker Lake Unit Agreement, Perry R. Bass, as Operator, hereby submits for your approval a Plan of Development for the year 1982.

History of Past Development

We refer to our previous Plans of Development for a detailed description of this Unit.

1981 Activity

Poker Lake Unit Well #49 - located 1980' FNL and 990' FWL, Section 17, T24S-R30E, Eddy County, New Mexico. This Well was drilled to a total depth of 14,470' and completed in the Morrow Formation as a gas well with the perforation interval being 14,307'-14,349'. The Well is currently producing as a gas well.

Poker Lake Unit Well #50 - located 660' FNL and 1980' FEL, Section 4, T25S-R31E, Eddy County, New Mexico. This Well was drilled to a total depth of 15,356' and was completed in the Wolfcamp Formation as a gas well, with the perforation interval being 12,950'-12,992'. The Well is currently producing.

Poker Lake Unit Well #51 - located 1980' FNL and 1980' FWL, Section 9, T25S-R30E, Eddy County, New Mexico. This Well was drilled to a total depth of 3,962' to test the Delaware Formation. This Well was plugged and abandoned on April 12, 1981, as a dry hole.

UNITED STATES GEOLOGICAL SURVEY  
COMMISSIONER OF PUBLIC LANDS  
NEW MEXICO OIL CONSERVATION DIVISION  
December 15, 1981  
Page 2 of 3

Poker Lake Unit Well #52 - Under the First Amendment, dated June 26, 1981, to the 1981 Plan of Development for the Poker Lake Unit, it was agreed that the Poker Lake Unit Well #52 would be deferred to the 1982 Plan of Development. Due to additional Geological information, we wish to drill this Well at a location 660' FNL and 1980' FWL, Section 33, T25S-R31E, Eddy County, New Mexico, to a depth of 16,000' to test the Morrow Formation.

Poker Lake Unit Well #53 - located 1980' FEL and 660' FNL, Section 9, T25S-R31E, Eddy County, New Mexico. This Well is currently drilling to a projected depth of 15,485' to test the Morrow Formation. The results of this Well will appear in this section in the 1983 Plan of Development.

Future Development

Poker Lake Unit Well #52 - Section 33, T25S-R31E - Morrow Test.

Poker Lake Unit Well #54 - Section 4, T24S-R30E - Delaware Test.

Poker Lake Unit Well #55 - Section 19, T24S-R30E - Delaware Test.

Poker Lake Unit Well #56 - Section 25, T25S-R30E - Delaware Test.

Poker Lake Unit Well #57 - Section 20, T25S-R31E - Delaware Test.

Additional Development

This Plan of Development shall constitute the drilling obligations of the Unit Operator under the terms of the Poker Lake Unit Agreement for the period ending December 31, 1982. However, due to the problems of obtaining drilling rigs and the drilling problems which have been encountered from time to time, the actual drilling of one or more of these Wells may encroach into the year 1983.

Offset Obligations

Appropriate and adequate measures will be taken to prevent drainage of unitized substances from land subject to the Poker Lake Unit Agreement or pursuant to applicable regulations, fair and reasonable compensatory royalty will be paid as provided by the Unit Agreement.

Modifications

It is understood that this Plan of Development may be modified from time to time to meet changing conditions.

Effective Date

This Plan of Development shall be effective January 1, 1982.

UNITED STATES GEOLOGICAL SURVEY  
COMMISSIONER OF PUBLIC LANDS  
NEW MEXICO OIL CONSERVATION DIVISION  
December 15, 1981  
Page 3 of 3

If this Plan of Development meets with your approval, please indicate by signing in the appropriate space provided below and return one (1) copy to us for our records.

Sincerely,

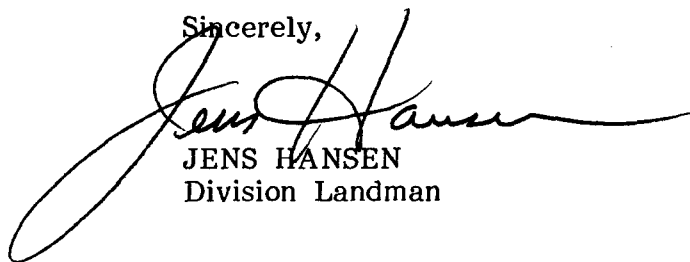

JENS HANSEN  
Division Landman

JH:ep

AGREED TO AND ACCEPTED this \_\_\_\_\_ day of \_\_\_\_\_, 1981.

UNITED STATES GEOLOGICAL SURVEY

By \_\_\_\_\_

AGREED TO AND ACCEPTED this \_\_\_\_\_ day of \_\_\_\_\_, 1981.

COMMISSIONER OF PUBLIC LANDS

By \_\_\_\_\_

AGREED TO AND ACCEPTED this 12 day of Jan, 1981

NEW MEXICO OIL CONSERVATION DIVISION

By 

State of New Mexico



Commissioner of Public Lands

December 30, 1981

ALEX J. ARMIJO  
COMMISSIONER

P. O. BOX 1148  
SANTA FE, NEW MEXICO 87501

Bass Enterprises Production Co.  
Fort Worth National Bank Building  
Fort Worth, Texas 76102

Re: Initial Participating Area for the  
Wolfcamp Formation  
Poker Lake Unit Area  
Eddy County, New Mexico

ATTENTION: Mr. Jens Hansen

Gentlemen:

The Commissioner of Public Lands has this date approved the Initial Wolfcamp Formation Participating Area for the Poker Lake Unit Area, Eddy County, New Mexico. The Initial Wolfcamp Participating Area is 319.82 acres described as Lots 1,2,3,4,S/2N/2 of Section 4, Township 25 South, Range 31 East, and is based on the completion of the Unit Well No. 50.

Our approval is subject to like approval by the United States Geological Survey and the New Mexico Oil Conservation Division.

Enclosed is one approved copy for your files.

Very truly yours,

ALEX J. ARMIJO  
COMMISSIONER OF PUBLIC LANDS

BY:  
RAY D. GRAHAM, Director,  
Oil and Gas Division  
AC 505/827-2748

AJA/RDG/pm  
encls.

cc: OCD-Santa Fe, New Mexico  
USGS-Albuquerque, New Mexico

*Approved*  
*1/14/82*

*366*