

JAMES BRUCE
ATTORNEY AT LAW

POST OFFICE BOX 1056
SANTA FE, NEW MEXICO 87504

369 MONTEZUMA, NO. 213
SANTA FE, NEW MEXICO 87501

(505) 982-2043 (Phone)
(505) 660-6612 (Cell)
(505) 982-2151 (Fax)

jamesbruce@aol.com

RECEIVED OGD

2012 NOV 13 P 2:13

November 13, 2012

Florene Davidson
Oil Conservation Division
1220 South St. Francis Drive
Santa Fe, New Mexico 87505

Case 14943

Dear Florene:

Enclosed for filing, on behalf of Devon Energy Production Company, L.P., are an original and one copy of an application for a salt water disposal well, together with a proposed advertisement. The advertisement has also been e-mailed to the Division. Please set this matter for the December 13, 2012 Examiner hearing. Thank you.

Very truly yours,

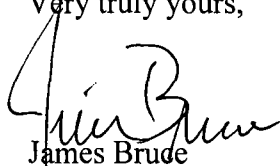
James Bruce

Attorney for Devon Energy Production Company, L.P.

PERSONS BEING NOTIFIED

Conoco Phillips
P.O. Box 7500
Bartlesville, OK 74005-7500

Mcleod Douglas C
P.O. Box 18481
Denver, Colorado 80218-0000

Scott W. Tanberg
2502 Keswick
Midland, Texas 79705-0000

Mark L. Shidler Inc.
1313 Campbell Rd. Bldg D
Houston, Texas 77055-0000

Moore & Shelton Co LTD
A Texas LTD Partnership
P.O. Box 3070
Galveston, Texas 77552-0000

Kruse Properties
P.O. Box 327
Key West, Florida 33040-0000

Hayes Properties
P.O. Box 51510
Midland, Texas 79710-1510

Robert E. Landreth
110 W. Louisiana STE 404
Midland, Texas 79701-0000

Kaiser-Francis Oil Company
P.O. Box 21468
Tulsa, OK 74121-1468

Hess Corporation
P.O. Box 2040
Houston, Texas 77252-2040

Edward R. Hudson Trusts 1-3
616 Texas Street
Fort Worth, Texas 76102-0000

Edward R. Hudson Trust 4
Mary T. Hudson Ard Trustee
222 W. 4th Street PH 5
Fort Worth, Texas 76102-0000

Bureau of Land Management*
Carlsbad Field Office
620 East Greene Street
Carlsbad, New Mexico 88220

BEFORE THE NEW MEXICO OIL CONSERVATION DIVISION

APPLICATION OF DEVON ENERGY
PRODUCTION COMPANY, L.P. FOR
APPROVAL OF A SALT WATER
DISPOSAL WELL, LEA COUNTY,
NEW MEXICO.

RECEIVED OCD

2012 NOV 13 P 2:13

Case No. 14943

APPLICATION

Devon Energy Production Company, L.P. applies for an order approving a salt water disposal well, and in support thereof, states:

1. Applicant proposes to convert to disposal its Rio Blanco 33 Fed. Well No. 2, located 1980 feet from the north line and 1980 feet from the west line of Section 33, Township 22 South, Range 34 East, N.M.P.M., Lea County, New Mexico.
2. Injection will be into the Devonian formation (Northeast Bell Lake-Devonian Pool) at a depth of 14570-14660 feet subsurface.
3. A Form C-108 for the well is attached hereto as Exhibit A.
4. The granting of this application will prevent waste and protect correlative rights.

WHEREFORE, applicant requests that, after notice and hearing, the Division enter its order approving this application.

Respectfully submitted,

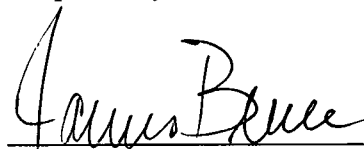

James Bruce
Post Office Box 1056
Santa Fe, New Mexico 87504
(505) 982-2043

Attorney for Devon Energy Production
Company, L.P.

APPLICATION FOR AUTHORIZATION TO INJECT

Case 14943

- I. PURPOSE: Secondary Recovery Pressure Maintenance X Disposal Storage
Application qualifies for administrative approval? X Yes No
- II. OPERATOR: Devon Energy Production Company, LP
ADDRESS: 333 West Sheridan Avenue, Oklahoma City, Oklahoma 73102-5010
CONTACT PARTY: Stephanie A. Porter PHONE: 405-552-7802
- III. WELL DATA: Complete the data required on the reverse side of this form for each well proposed for injection.
Additional sheets may be attached if necessary.
- IV. Is this an expansion of an existing project? Yes X No
If yes, give the Division order number authorizing the project: _____
- V. Attach a map that identifies all wells and leases within two miles of any proposed injection well with a one-half mile radius circle drawn around each proposed injection well. This circle identifies the well's area of review.
- VI. Attach a tabulation of data on all wells of public record within the area of review which penetrate the proposed injection zone. Such data shall include a description of each well's type, construction, date drilled, location, depth, record of completion, and a schematic of any plugged well illustrating all plugging detail.
- VII. Attach data on the proposed operation, including:
1. Proposed average and maximum daily rate and volume of fluids to be injected;
 2. Whether the system is open or closed;
 3. Proposed average and maximum injection pressure;
 4. Sources and an appropriate analysis of injection fluid and compatibility with the receiving formation if other than reinjected produced water; and,
 5. If injection is for disposal purposes into a zone not productive of oil or gas at or within one mile of the proposed well, attach a chemical analysis of the disposal zone formation water (may be measured or inferred from existing literature, studies, nearby wells, etc.).
- *VIII. Attach appropriate geologic data on the injection zone including appropriate lithologic detail, geologic name, thickness, and depth. Give the geologic name, and depth to bottom of all underground sources of drinking water (aquifers containing waters with total dissolved solids concentrations of 10,000 mg/l or less) overlying the proposed injection zone as well as any such sources known to be immediately underlying the injection interval.
- IX. Describe the proposed stimulation program, if any.
- *X. Attach appropriate logging and test data on the well. (If well logs have been filed with the Division, they need not be resubmitted).
- *XI. Attach a chemical analysis of fresh water from two or more fresh water wells (if available and producing) within one mile of any injection or disposal well showing location of wells and dates samples were taken.
- XII. Applicants for disposal wells must make an affirmative statement that they have examined available geologic and engineering data and find no evidence of open faults or any other hydrologic connection between the disposal zone and any underground sources of drinking water.
- XIII. Applicants must complete the "Proof of Notice" section on the reverse side of this form.
- XIV. Certification: I hereby certify that the information submitted with this application is true and correct to the best of my knowledge and belief.
- NAME: Stephanie A. Porter TITLE: Operations Technician
SIGNATURE: [Signature] DATE: 7/10/2012
E-MAIL ADDRESS: Stephanie.Porter@dvn.com
- * If the information required under Sections VI, VIII, X, and XI above has been previously submitted, it need not be resubmitted. Please show the date and circumstances of the earlier submittal: _____

DISTRIBUTION: Original and one copy to Santa Fe with one copy to the appropriate Distri

EXHIBIT

A

III. WELL DATA

- A. The following well data must be submitted for each injection well covered by this application. The data must be both in tabular and schematic form and shall include:

- (1) Lease name; Well No.; Location by Section, Township and Range; and footage location within the section.
- (2) Each casing string used with its size, setting depth, sacks of cement used, hole size, top of cement, and how such top was determined.
- (3) A description of the tubing to be used including its size, lining material, and setting depth.
- (4) The name, model, and setting depth of the packer used or a description of any other seal system or assembly used.

Division District Offices have supplies of Well Data Sheets which may be used or which may be used as models for this purpose. Applicants for several identical wells may submit a "typical data sheet" rather than submitting the data for each well.

- B. The following must be submitted for each injection well covered by this application. All items must be addressed for the initial well. Responses for additional wells need be shown only when different. Information shown on schematics need not be repeated.

- (1) The name of the injection formation and, if applicable, the field or pool name.
- (2) The injection interval and whether it is perforated or open-hole.
- (3) State if the well was drilled for injection or, if not, the original purpose of the well.
- (4) Give the depths of any other perforated intervals and detail on the sacks of cement or bridge plugs used to seal off such perforations.
- (5) Give the depth to and the name of the next higher and next lower oil or gas zone in the area of the well, if any.

XIV. PROOF OF NOTICE

All applicants must furnish proof that a copy of the application has been furnished, by certified or registered mail, to the owner of the surface of the land on which the well is to be located and to each leasehold operator within one-half mile of the well location.

Where an application is subject to administrative approval, a proof of publication must be submitted. Such proof shall consist of a copy of the legal advertisement which was published in the county in which the well is located. The contents of such advertisement must include:

- (1) The name, address, phone number, and contact party for the applicant;
- (2) The intended purpose of the injection well; with the exact location of single wells or the Section, Township, and Range location of multiple wells;
- (3) The formation name and depth with expected maximum injection rates and pressures; and,
- (4) A notation that interested parties must file objections or requests for hearing with the Oil Conservation Division, 1220 South St. Francis Dr., Santa Fe, New Mexico 87505, within 15 days.

NO ACTION WILL BE TAKEN ON THE APPLICATION UNTIL PROPER PROOF OF NOTICE HAS BEEN SUBMITTED.

NOTICE: Surface owners or offset operators must file any objections or requests for hearing of administrative applications within 15 days from the date this application was mailed to them.

WELL NAME & NUMBER: RIO BLANCO 33 FED #2

WELL LOCATION: 1980' FNL & 1980' FWL F Sec 33 T22S R34E
FOOTAGE LOCATION UNIT LETTER SECTION TOWNSHIP RANGE

WELL CONSTRUCTION DATA

Surface Casing

DEVON ENERGY PRODUCTION COMPANY LP

Well Name: RIO BLANCO 33 FED 2	Field: NE BELL LAKE: DEVONIAN
Location: 1980' FNL & 1980' FWL; SEC 33-T22S-R34E	County: LEA State: NM
Elevation: 3429' KB: 3406' GL: 23' KB-GL	Spud Date: 5/2/04 Compl Date: 8/6/04
API# 30-025-36360 Prepared by: Ronnie Slack	Date: 8/15/12 Rev:

PROPOSED DEVONIAN SWD

17-1/2" hole
15-3/8" ID @ 84.8M, K&S, 9 T&C @ 2,425'
 Cmt'd to surface w/ 1900 sxs

12-1/4" hole
8-7/8" ID @ 110' @ 1,145'
 Cmt'd to surface w/ 1900 sxs

Calc TOC @ 9,000'

5" Liner top hanger @ 11,546'
 Liner tested to 14,46 EMW

8.75" Hole
7" ID @ 110' T&C @ 11,877' MD
 Cmt'd w/ 600 sxs. CTC @ 5000'

6-1/8" Hole
5" ID @ 139' @ 14,570'
 Cmt'd w/ 460 sxs

Proposed For SWD:
 Existing Devonian Open Hole 14,570' - 14,660'

FORMATION TOP

Delaware	5178
Bone Spring	8478
Wolfcamp	11173
Strawn	11688
Atoka Clastics	11995
M Mrrw Clastics	12708
Lower Morrow	13273
Mississippian Lm	13866
Woodford	14373
Devonian	14572

Proposed:
 ~11400', 3-1/2, 10W, L80, IPC tubing
 ~3000', 2-7/8, 7W, L80, IPC tubing
 1/2 On off tool, w/ L87 F nipple
Nickel Coated Arrowroot Packer @ 11,600'
 8" x 2-3/8 sub (nickel coated)
 1.87 R Nipple (nickel coated)

3-7/8" Open hole

TD @ 14,660'

Hole Size: 17-1/2" Casing Size: 13-3/8", 61# & 54.5# @ 2428'

Cemented with: 1900 _____ sx, *or* _____ ft³

Top of Cement: Surface Method Determined: Circ. cement

Intermediate Casing

Hole Size: 12-1/4" Casing Size: 9-5/8", 40#, @ 5148'

Cemented with: 1900 sx. *or* _____ ft³

Top of Cement: Surface Method Determined: Circ. cement

Production Casing

Hole Size: 8-3/4" Casing Size: 7", 26#, @ 11977'

Cemented with: 600 sx. *or* ft³

Top of Cement: 9000' Method Determined: CTOC

Total Depth: 14660' 5" Liner 11646'-14570'

Injection Interval (Open Hole)

14570' to 14660'

(Perforated or Open Hole; indicate which)

INJECTION WELL DATA SHEET

Tubing Size: 3-1/2" & 2-7/8" Lining Material: IPC

Type of Packer: 5" Nickel Coated Arrowset Packer

Packer Setting Depth: 11400'

Other Type of Tubing/Casing Seal (if applicable): _____

Additional Data

1. Is this a new well drilled for injection? No

If no, for what purpose was the well originally drilled? oil & gas producer

2. Name of the Injection Formation: Devonian

3. Name of Field or Pool (if applicable): Bell Lake; Devonian, NE (Gas)

4. Has the well ever been perforated in any other zone(s)? List all such perforated intervals and give plugging detail, i.e. sacks of cement or plug(s) used.

Bell Lake Devonian 14570-14660. (Open hole). Proposed nickel coated arrow set packer @ 11400'

5. Give the name and depths of any oil or gas zones underlying or overlying the proposed injection zone in this area:

Delaware 5178; Bone Spring 8478; Wolfcamp 11173; Strawn 11688; Atoka Clastics 11995; Middle Morrow Clastics 12768; Lower Morrow 13273; Mississippian Lime 13866; Woodford 14373; Devonian 14570

DEVON ENERGY PRODUCTION COMPANY LP

Well Name: RIO BLANCO 33 FED 2		Field: NE BELL LAKE; DEVONIAN	
Location: 1980' FNL & 1980' FWL; SEC 33-T225-R34E		County: LEA	State: NM
Elevation: 3429' KB; 3406' GL; 23' KB-GL		Spud Date: 5/2/04	Compl Date: 8/6/04
API#: 30-025-36360	Prepared by: Ronnie Slack	Date: 8/15/12	Rev:

PROPOSED DEVONIAN SWD

17-1/2" hole

13-3/8", 61# & 54.5#, K55, ST&C, @ 2,428'

Cmt'd to surface w/ 1900 sxs

12-1/4" hole

9-5/8", 40#, P110, @ 5,148'

Cmt'd to surface w/ 1900 sxs

Calc TOC @ 9,000'

5" Liner top hanger @ 11,646'

Liner tested to 14.45 EMW

8.75" Hole

7", 26#, P110, LT&C, @ 11,977' MD

Cmt'd w/ 600 sxs. CTOC @ 9000'

6-1/8" Hole

5", 23#, T95, STL, @ 14,570'

Cmt'd w/ 460 sxs

Proposed For SWD:

Existing Devonian Open Hole 14,570' - 14,660'

3-7/8" Openhole

TD @ 14,660'

FORMATION	TOP
Delaware	5178
Bone Spring	8478
Wolfcamp	11173
Strawn	11688
Atoka Clastics	11995
M Mrrw Clastics	12768
Lower Morrow	13273
Mississippian Lm	13866
Woodford	14373

Proposed:

~11400', 3-1/2, 10#, L80, IPC tubing

~3000', 2-7/8, 7#, L80, IPC tubing

T/2 On off tool, w/1.87 F nipple

Nickel Coated Arrowset Packer @ 11,400'

8' x 2-3/8 sub (nickel coated)

1.87 R Nipple (nickel coated)

DEVON ENERGY PRODUCTION COMPANY LP

Well Name: RIO BLANCO 33 FED 2		Field: NE BELL LAKE; DEVONIAN	
Location: 1980' FNL & 1980' FWL; SEC 33-T22S-R34E		County: LEA	State: NM
Elevation: 3429' KB; 3406' GL; 23' KB-GL		Spud Date: 5/2/04	Compl Date: 8/6/04
API#: 30-025-36360	Prepared by: Ronnie Slack	Date: 8/15/12	Rev:

CURRENT WELLBORE

17-1/2" hole
13-3/8", 61# & 54.5#, K55, ST&C, @ 2,428'
 Cmt'd to surface w/ 1900 sxs

12-1/4" hole
9-5/8", 40#, P110, @ 5,148'
 Cmt'd to surface w/ 1900 sxs

Calc TOC @ 9,000'

5" Liner top hanger @ 11,646'
 Liner tested to 14.45 EMW

8.75" Hole
7", 26#, P110, LT&C, @ 11,977' MD
 Cmt'd w/ 600 sxs. CTOC @ 9000'

6-1/8" Hole
5", 23#, T95, STL, @ 14,570'
 Cmt'd w/ 460 sxs

DEVONIAN
 Openhole 14,570' - 14,660'

3-7/8" Openhole

TD @ 14,660'

2% KCI Packer Fluid

PRODUCTION TUBING

379 Jts 2-7/8", 6.5#, L80, 8RD EUE
 84 Jts 2-7/8", 6.5#, L80, RTS-8

On / Off Tool
1.875" F Profile @ 13,896'
 Arrow Set 1-X Packer @ 13,898'
 6', 2-3/8" sub
1.875" R profile (1.82" No Go) @ 13,910'
 4', 2-3/8" sub
 W/L Re-entry guide bottom @ 13,915'

Proposed Injection Well: Rio Blanco 33 Fed #2
API: 30-025-36360
APPLICATION FOR INJECTION
Form C-108 Section III

III. Well Data—On Injection Well

A. Injection Well Information

- | | |
|-----------------------------|--|
| (1) <u>Lease</u> | Rio Blanco 33 Fed |
| <u>Well No</u> | #2 |
| <u>Location</u> | 1980' FNL & 1980' FWL |
| <u>Sec, Twn, Rnge</u> | Sec 33-T22S-R34E |
| <u>Cnty, State</u> | Lea County, NM |
| | |
| (2) <u>Casing</u> | 13-3/8", 61 & 54.5#, K55, STC, @ 2,428'
Cmt'd w/1900 sx, circ cmt to surf |
| | 9-5/8", 40#, P110, LTC, @ 5,148'
Cmt'd w/1900, circ cmt to surf |
| | 7", 26#, P110, LTC @ 11,977'
Cmt'd w/600 sx. CTOC @ 9000' |
| | 5", 23#, T95, STL liner from 11646' to 14570'
Cmt'd w/460 sx |
| (3) <u>Injection Tubing</u> | 3-1/2" & 2-7/8" IPC injection tubing |
| (4) <u>Packer</u> | 5" Nickel Coated Arrowset Packer @ 11400' |

B. Other Well Information

- | | |
|---------------------------------|-------------------------------|
| (1) <u>Injection Formation:</u> | Devonian |
| <u>Field Name:</u> | Bell Lake; Devonian, NE (Gas) |
| (2) <u>Injection Interval:</u> | 14570' - 14660' (open hole) |

- (3) Original Purpose of Wellbore:

Devonian producer

- (4) Other perforated intervals:

Bell Lake Devonian 14570-14660. (Open hole). Proposed nickel coated arrow set packer @ 11400'

- (5) Give the depth to and the name of the next higher and next lower oil or gas zone in the area of the well if any.

Delaware 5178; Bone Spring 8478; Wolfcamp 11173; Strawn 11688; Atoka Clastics 11995; Middle Morrow Clastics 12768; Lower Morrow 13273; Mississippian Lime 13866; Woodford 14373; Devonian 14570

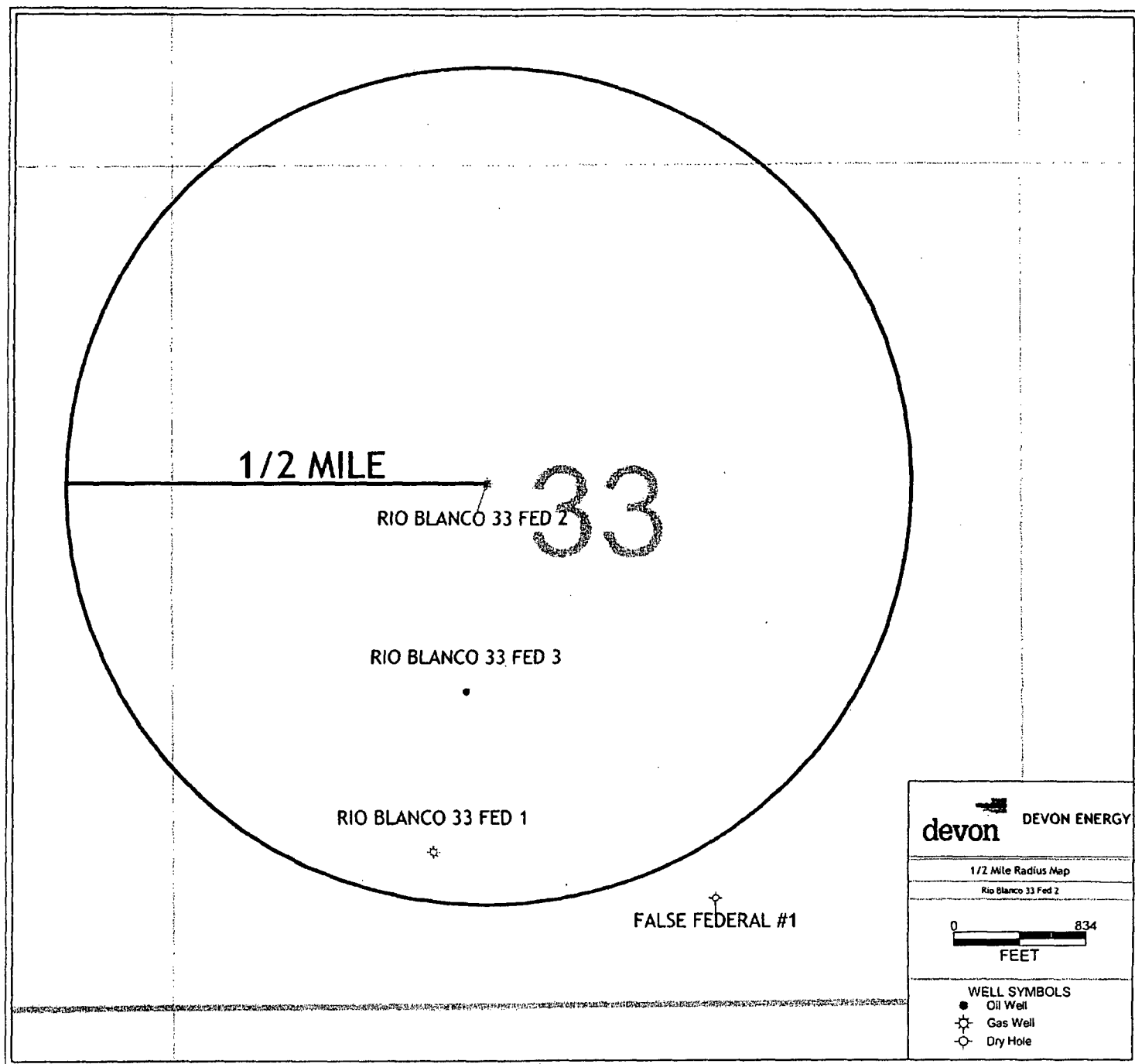

PETRA 8/12/2012 4:17:14 PM

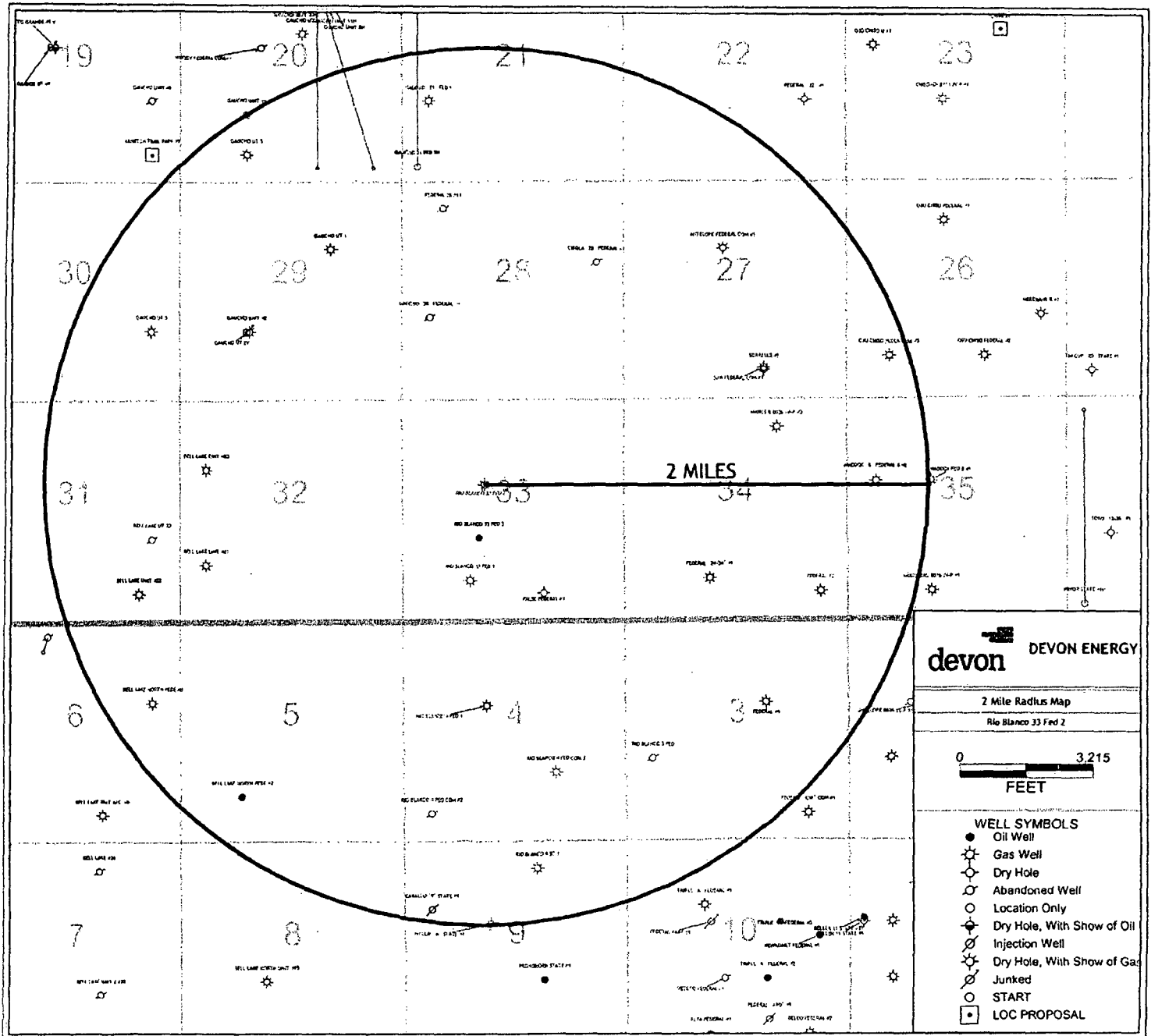

PETRA 8/12/2012 4:20:33 PM

Proposed Injection Well: Rio Blanco 33 Fed #2

API: 30-025-36360

APPLICATION FOR INJECTION

Form C-108 Section VII to XIII

VII Attach data on the proposed operation, including:

- (1) Proposed average injection rate: 2000 BWPD
Proposed maximum injection rate: 5000 BWPD
- (2) The system will be a closed system.
- (3) Proposed average injection pressure: 2000 psi
Proposed max injection pressure: 2920 psi
- (4) The injection fluid will be produced water from area wells producing from the Delaware and Bone Spring formations that will be injected into the Bell Lake Devonian formation.
- (5) A representative water analysis is submitted for the Devonian formation.

VIII Geologic Injection Zone Data

The injection zone is the Bell Lake Devonian formation from 14570' to 14660'. The gross injection interval is 90' thick. The Bell Lake Devonian formation is a Permian aged sandstone. The average depth to fresh water is 125' in this area.

IX Proposed Stimulation

Based on injectivity results this interval could be frac stimulated.

X Log Data

Logs have previously been submitted to the OCD.

XI Fresh Water Analysis

Attached is a fresh water analysis for a fresh water well drilled in Section 33-T22S-R34E on Bill Angel's property within 1 mile of the proposed SWD location.

XII Geologic / Engineering Statement

An examination of this area has determined there are no open faults or other hydrologic connection between the disposal zone and any underground drinking water.

XIII Proof of Notice

Proof of notice to surface owner, and public legal notification are attached.

Surface Owners Rio Blanco 33 Fed #2 SWD Lea County, New Mexico

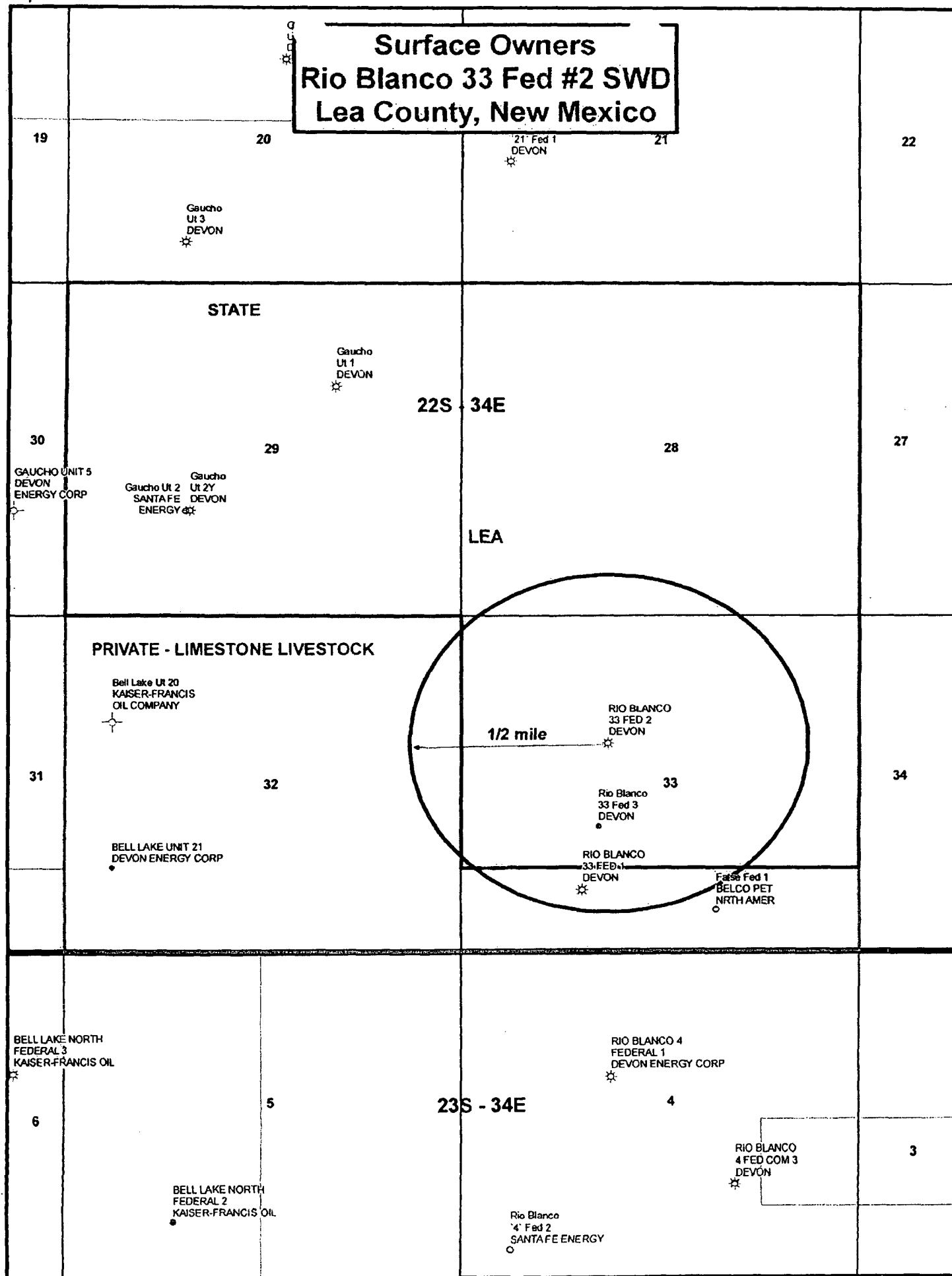

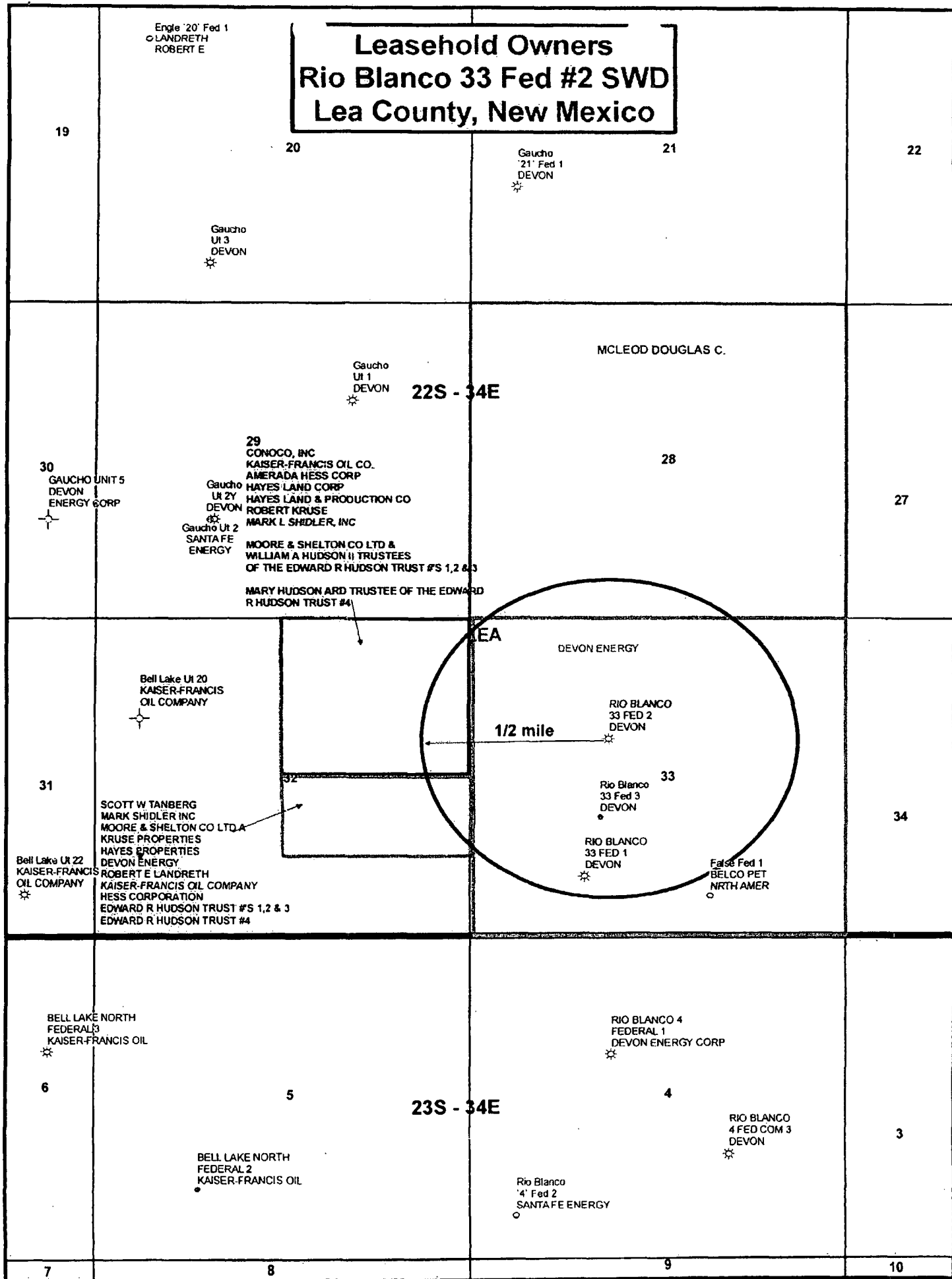

Leasehold Ownership
½ mile Rio Blanco 33 Fed #2

22S-34E Section 33: NE, N2SE, SESE

1. Devon Energy Prod. CO LP				
20 N Broadway	Oklahoma City	OK	73102-0000	

22S-34E Section 33: W2, SWSE

1. Devon Energy Prod CO LP (Record Title)				
20 N Broadway	Oklahoma City	OK	73102-0000	

22S-34E Section 28: All

1. Mcleod Douglas C. (Record Title)				
PO Box 18481	Denver	CO	80218-0000	

22S-34E Section 32: NE/4

APO

Conoco, Inc.	.1248559
Kaiser-Francis Oil Co.	.5903984
Amerada Hess Corp.	.1248329
Hayes Land Corp.	.0279350
Hayes Land & Production Co.	.0279350
Robert Kruse	.0279350
Mark L. Shidler, Inc.	.0279350
Moore & Shelton Co. LTD	.0125668
Edward R. Hudson, Jr. & William A. Hudson II trustees Of the Edward R. Hudson Trust #s 1,2,&3	.0267045
Mary Hudson Ard trustee of the Edward R. Hudson Trust # 4	<u>.0089015</u>

Total: 1.000000

Leasehold Ownership
½ mile Rio Blanco 33 Fed # 2

22S-34E Sec 32: N2, N2SE, SW

1. Scott W. Tanberg 2502 Keswick	Midland	TX	79705-0000
2. Mark L. Shidler Inc. 1313 Campbell Rd Bldg. D	Houston	TX	77055-0000
3. Moore & Shelton Co. LTD A Texas LTD Partnership P.O. Box 3070	Galveston	TX	77552-0000
4. Kruse Properties P.O. Box 327	Key West	FL	33040-0000
5. Hayes Properties, Inc. P.O. Box 51510	Midland	TX	79710-1510
6. Devon Energy 20 N. Broadway	OKC	OK	73102-0000
7. Robert E. Landreth 110 W. Louisiana STE 404	Midland	TX	79701-0000
8. Kaiser-Francis Oil Company P.O. Box 21468 P.O. Box 21468	Tulsa	OK	74121-1468
9. Hess Corporation P.O. Box 2040	Houston	TX	77252-2040
10. Edward R. Hudson Trusts 1-3 616 Texas Street	Fort Worth	TX	76102-0000
11. Edward R. Hudson Trust 4 Mary T. Hudson Ard Trustee 222 W. 4 th Street PH 5	Fort Worth	TX	76102-0000

Section XIV—Proof of Notice to Leasehold Operators
Devon Energy Prod Co LP
C108 Application For Injection
Proposed Well: RIO BLANCO 33 FED 2

Proof of Notice to Leasehold Operators within 1/2 mile of Rio Blanco 33 Fed #2

Conoco Phillips P.O. Box 7500 Bartlesville, OK 74005-7500	Certified receipt No. 7008 1830 0002 7421 9130
Mcleod Douglas C P.O. Box 18481 Denver, Colorado 80218-0000	Certified receipt No. 7008 1830 0002 7421 9109
Scott W. Tanberg 2502 Keswick Midland, Texas 79705-0000	Certified receipt No. 7008 1830 0002 7421 9116
Mark L. Shidler Inc. 1313 Campbell Rd. Bldg D Houston, Texas 77055-0000	Certified receipt No. 7008 1830 0002 7421 9178
Moore & Shelton Co LTD A Texas LTD Partnership P.O. Box 3070 Galveston, Texas 77552-0000	Certified receipt No. 7008 1830 0002 7421 9185
Kruse Properties P.O. Box 327 Key West, Florida 33040-0000	Certified receipt No. 7008 1830 0002 7421 9192
Hayes Properties P.O. Box 51510 Midland, Texas 79710-1510	Certified receipt No. 7008 1830 0002 7421 9208
Robert E. Landreth 110 W. Louisiana STE 404 Midland, Texas 79701-0000	Certified receipt No. 7008 1830 0002 7421 9215
Kaiser-Francis Oil Company P.O. Box 21468 Tulsa, OK 74121-1468	Certified receipt No. 7008 1830 0002 7421 9222
Hess Corporation P.O. Box 2040 Houston, Texas 77252-2040	Certified receipt No. 7008 1830 0002 7421 9239
Edward R. Hudson Trusts 1-3 616 Texas Street Fort Worth, Texas 76102-0000	Certified receipt No. 7008 1830 0002 7421 9246
Edward R. Hudson Trust 4 Mary T. Hudson Ard Trustee 222 W. 4 th Street PH 5 Fort Worth, Texas 76102-0000	Certified receipt No. 7008 1830 0002 7421 9253
Bureau of Land Management* Carlsbad Field Office 620 East Greene Street Carlsbad, New Mexico 88220	Certified receipt No. 7008 1830 0002 7421 9260

A copy of this application has been mailed to the above leasehold* operators by certified mail, pertaining to Devon Energy's application for salt water disposal in the Rio Blanco 33 Fed #2.

* Includes Mineral (BLM)

Date Mailed: 9/10/2012

Signature: [Signature]

Stephanie A. Porter, Operations Technician
Devon Energy Production Co., L.P.
333 West Sheridan Avenue
Oklahoma City, OK 73102

Date: 9/11/2012

Section XIV--Proof of Notice to Surface Land Owner
Devon Energy Prod Co LP
C108 Application For Injection
Proposed Well: RIO BLANCO 33 FED 2

Proof of Notice to Surface Land Owner of well location site.

New Mexico State Land Office
310 Old Santa Fe Trail
Santa Fe, New Mexico 87501

Certified receipt No.
7008 1830 0002 7421 9123

A copy of this application has been mailed to the above surface land owner by certified mail, pertaining to Devon Energy's application for salt water disposal in the Rio Blanco 33 Fed #2.

Date Mailed: _____

9/10/2012

Signature: _____

[Handwritten Signature]

Date: _____

9/10/2012

Stephanie A. Porter, Operations Technician
Devon Energy Production Co., L.P.
333 West Sheridan Avenue
Oklahoma City, OK 73102

C108 ITEM VI-Well Tabulation in 1/2 Mile Review Area
Devon Energy Production Company, LP
Proposed Inj Well: RIO BLANCO 33 FED 2
Proposed Formation: DEVONIAN
Proposed Interval: 14570' - 14660'

Operator	Well Name	API NO	County	Surf Location	Sec	Twn	Rnge	Type	Status	Spud Date	Comp Date	TD	PBTD	Comp Zone	Comp Interval-Ft	Casing Program	Cement / TOC
Devon Energy Prod Co LP	Rio Blanco 33 Fed 2	30-025-36360	Lea	1980' FNL 1980' FWL	33	22S	34E	Oil	Act	5/2/04	8/6/04	14660	14660	Devonian	14570-14660 (open hole)	13-3/8", 61 & 54.5# @ 2428' 9-5/8", 40# @ 5148' 7", 26# @ 11977' 5", 23.2# liner 11646-14570	1900 sx / surface 1900 sx / surface 600 sx / 9000-etc 460 sx / liner top
Devon Energy Prod Co LP	Rio Blanco 33 Fed 1	30-025-36359	Lea	1000' FSL 1620' FWL	33	22S	34E	Oil	Act	9/20/03	3/8/04	14682	14682	Devonian	14486-14682 (open hole)	20", 106#, @ 1764' 13-3/8", 68#, @ 5135' 9-5/8", 53.5#, @ 11980 7 5/8", 38#, @ 14497	3405 sx / surface 2700 sx / surface 1320 sx / 7500-etc 360 sx / liner top
Devon Energy Prod Co LP	Rio Blanco 33 Fed 3	30-025-37860	Lea	1980' FSL 1830' FWL	33	22S	34E	Oil	Act	2/1/07	4/25/07	8600	8497	Delaware	6872-8456 (open)	13-3/8", 61#, @ 2200' 8-5/8", 32#, @ 5155 7 7/8", 15.5/17#, @ 8600	1450 sx / surface 2015 sx / surface 620 sx / 4040-cbl

Affidavit of Publication

State of New Mexico,
County of Lea.

I, JUDY HANNA
PUBLISHER
of the Hobbs News-Sun, a
newspaper published at Hobbs, New
Mexico, do solemnly swear that the
clipping attached hereto was
published in the regular and entire
issue of said newspaper, and not a
supplement thereof for a period

of 1 issue(s).
Beginning with the issue dated
June 15, 2012
and ending with the issue dated
June 15, 2012

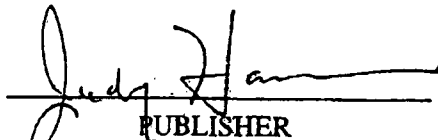
PUBLISHER

Sworn and subscribed to before me
this 15th day of
June, 2012

Notary Public

My commission expires
February 28, 2016
(Seal)

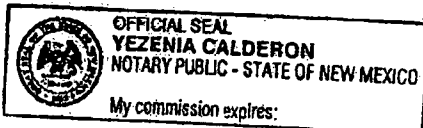

This newspaper is duly qualified to
publish legal notices or
advertisements within the meaning of
Section 3, Chapter 167, Laws of
1937 and payment of fees for said
publication has been made.

LEGAL NOTICE JUNE 15, 2012

Devon Energy Production Company, LP, 333 West Sheridan Avenue, Oklahoma City, OK 73102-8260 has filed form C-108 (Application for Authorization to Inject) with the New Mexico Oil Conservation Division seeking administrative approval for an injection well. The proposed well, the Rio Blanco 33 Fed #2, is located 1980' ENL & 1980' FWL, Section 33, Township 22 South, Range 34 East, in Lea County, New Mexico. Disposal water will be sourced from area wells producing from the Delaware and Bone Spring formations. The disposal water will be injected into the Devonian formation at a depth of 14570' to 14660' open hole, at a maximum surface pressure of 2820 psi and a maximum rate of 5000 BWPD. Any interested party who has an objection to this must give notice in writing to the Oil Conservation Division, 1220 South Saint Francis Drive, Santa Fe, New Mexico 87505, within (15) days of this notice. Any interested party with questions or comments may contact Jimmy Turnini at Devon Energy Corporation, 333 West Sheridan Avenue, Oklahoma City, OK 73102-8260, or call (405) 228-4478.
#27403

67106734

00094777

ATTN: DVNOKC98
DEVON ENERGY - ATTN: DVNOKC98
P O BOX 3198
OKLAHOMA CITY, OK 73101-3198

**Rio Blanco 33 Fed #2
C108 Application for Injection
Fresh Water Analysis Report
Avalon Shale Formation
Devon Energy Production Co LP**

North Permian Basin Region
P.O. Box 740
Sundown, TX 79372-0740
(806) 229-8121
Lab Team Leader - Sheila Hernandez
(432) 495-7240

Water Analysis Report by Baker Petrolite

Company:	DEVON ENERGY CORPORATION	Sales RDT:	33521.1
Region:	PERMIAN BASIN	Account Manager:	GENE ROGERS (575) 910-1022
Area:	ARTESIA, NM	Sample #:	535126
Lease/Platform:	BILL ANGEL	Analysis ID #:	123841
Entity (or well #):	WATER WELL	Analysis Cost:	\$90.00
Formation:	UNKNOWN		
Sample Point:	WELLHEAD		

Summary		Analysis of Sample 535126 @ 75 F					
Sampling Date:	08/16/12	Anions	mg/l	meq/l	Cations	mg/l	meq/l
Analysis Date:	09/04/12	Chloride:	41.0	1.16	Sodium:	17.0	0.74
Analyst:	JENNIFER HARDELL	Bicarbonate:	207.4	3.4	Magnesium:	28.0	2.3
TDS (mg/l or g/m3):	529.6	Carbonate:	0.0	0	Calcium:	85.0	4.24
Density (g/cm3, tonne/m3):	1.001	Sulfate:	142.0	2.96	Strontium:	2.5	0.06
Anion/Cation Ratio:	1.0000022	Phosphate:			Barium:	0.1	0
		Borate:			Iron:	0.1	0
		Silicate:			Potassium:	6.5	0.17
					Aluminum:		
Carbon Dioxide:	1 PPM	Hydrogen Sulfide:		0	Chromium:		
Oxygen:		pH at time of sampling:		8.7	Copper:		
Comments:		pH at time of analysis:			Lead:		
		pH used in Calculation:		8.7	Manganese:	0.025	0
					Nickel:		

Conditions		Values Calculated at the Given Conditions - Amounts of Scale in lb/1000 bbl										
Temp	Gauge Press.	Calcite CaCO ₃		Gypsum CaSO ₄ ·2H ₂ O		Anhydrite CaSO ₄		Celestite SrSO ₄		Barite BaSO ₄		CO ₂ Press
°F	psi	Index	Amount	Index	Amount	Index	Amount	Index	Amount	Index	Amount	psi
80	0	1.34	14.71	-1.44	0.00	-1.51	0.00	-1.26	0.00	0.45	0.00	0.01
100	0	1.38	16.47	-1.44	0.00	-1.44	0.00	-1.24	0.00	0.31	0.00	0.01
120	0	1.44	18.92	-1.42	0.00	-1.35	0.00	-1.20	0.00	0.20	0.00	0.02
140	0	1.50	21.37	-1.40	0.00	-1.23	0.00	-1.16	0.00	0.12	0.00	0.02

Note 1: When assessing the severity of the scale problem, both the saturation index (SI) and amount of scale must be considered.

Note 2: Precipitation of each scale is considered separately. Total scale will be less than the sum of the amounts of the five scales.

Note 3: The reported CO₂ pressure is actually the calculated CO₂ fugacity. It is usually nearly the same as the CO₂ partial pressure.

Scale Predictions from Baker Petrolite

Analysis of Sample 535126 @ 75 °F for DEVON ENERGY CORPORATION, 09/04/12

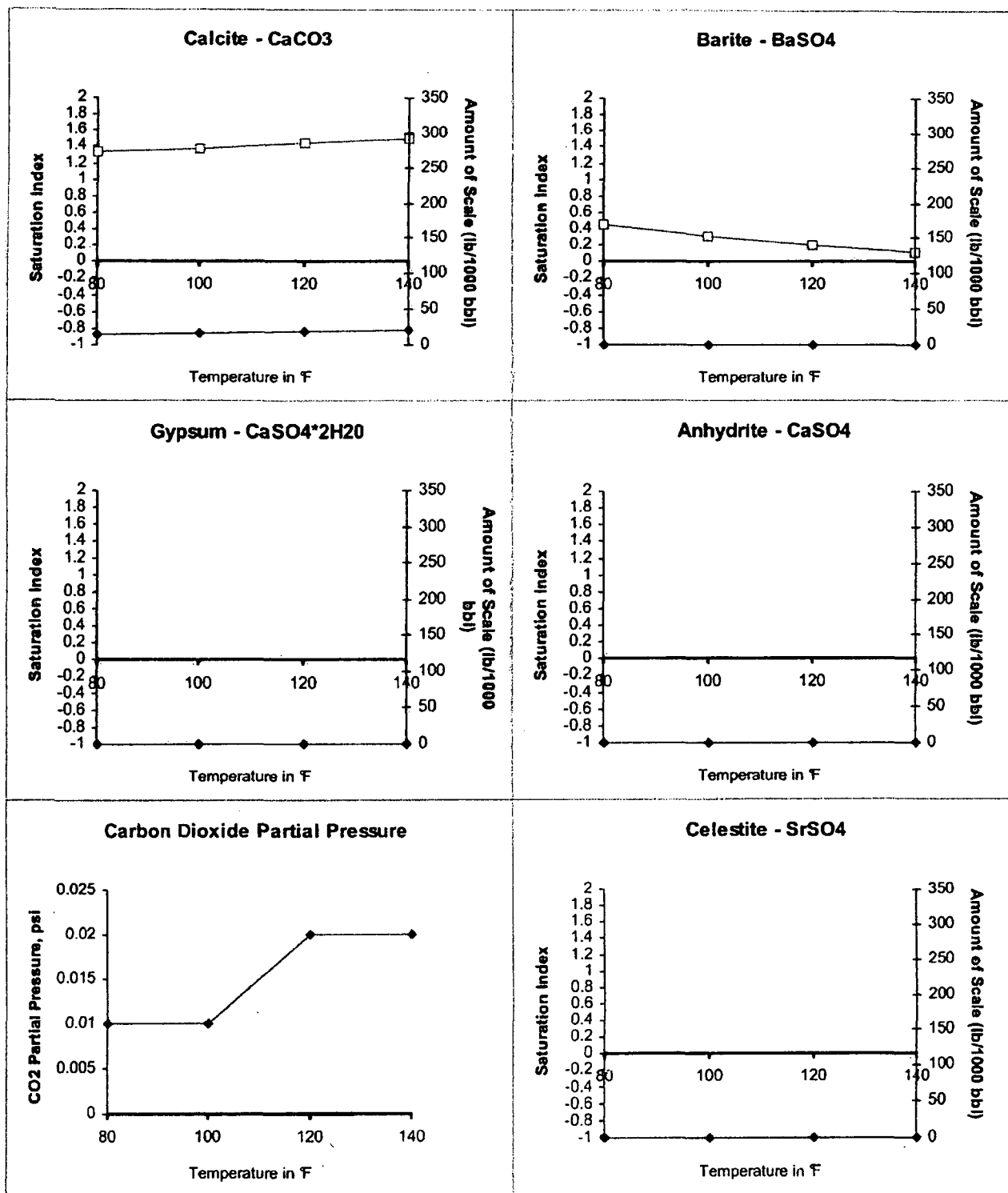

UNITED STATES
DEPARTMENT OF THE INTERIOR
BUREAU OF LAND MANAGEMENT

FORM APPROVED
OMB No. 1004-0137
Expires: March 31, 2007

SUNDRY NOTICES AND REPORTS ON WELLS
Do not use this form for proposals to drill or to re-enter an abandoned well. Use Form 3160-3 (APD) for such proposals.

SUBMIT IN TRIPLICATE - Other instructions on page 2.

1. Type of Well

☒ Oil Well ☐ Gas Well ☐ Other

2. Name of Operator
Devon Energy Production Co., LP

3a. Address
20 North Broadway
OKC, OK 73102

3b. Phone No. (include area code)
(405)-552-7802

4. Location of Well (Footage, Sec., T., R., M., or Survey Description)
SE1/4 1980' FNL & 1980' FWL
Sec 33-T22S-R34E

5. Lease Serial No.

NMNM 100864

6. If Indian, Allottee or Tribe Name

7. If Unit of CA/Agreement, Name and/or No.

8. Well Name and No.

Rio Blanco 33 Fed 2

9. API Well No.

30-025-36360

10. Field and Pool or Exploratory Area

Bell Lake; Devonian, NE (Gas) 97328

11. Country or Parish, State

Lea County, NM

12. CHECK THE APPROPRIATE BOX(ES) TO INDICATE NATURE OF NOTICE, REPORT OR OTHER DATA

TYPE OF SUBMISSION

☒ Notice of Intent

☐ Subsequent Report

☐ Final Abandonment Notice

TYPE OF ACTION

☐ Acidize

☐ Alter Casing

☐ Casing Repair

☐ Change Plans

☐ Convert to Injection

☐ Deepen

☐ Fracture Treat

☐ New Construction

☐ Plug and Abandon

☐ Plug Back

☐ Production (Start/Resume)

☐ Reclamation

☐ Recomplete

☐ Temporarily Abandon

☒ Water Disposal

☐ Water Shut-Off

☐ Well Integrity

☐ Other

13. Describe Proposed or Completed Operation: Clearly state all pertinent details, including estimated starting date of any proposed work and approximate duration thereof. If the proposal is to deepen directionally or recompleat horizontally, give subsurface locations and measured and true vertical depths of all pertinent markers and zones. Attach the Bond under which the work will be performed or provide the Bond No. on file with BLM/BIA. Required subsequent reports must be filed within 30 days following completion of the involved operations. If the operation results in a multiple completion or recompleat in a new interval, a Form 3160-4 must be filed once testing has been completed. Final Abandonment Notices must be filed only after all requirements, including reclamation, have been completed and the operator has determined that the site is ready for final inspection.)

PROPOSED SWD CONVERSION: Devon is filing Form C-108 (Application for Authorization to Inject) with the Oil Conservation Division in Santa Fe, New Mexico. Proposed SWD conversion is in the existing Devonian formation (open hole from 14,570' - 14,660').

1. MIRU. Establish injection in existing Devonian open hole formation interval from 14,570 -14653', not to exceed maximum authorized surface injection pressure per C-108.
2. Stimulate Devonian formation, if necessary.
3. Run MIT test and chart. File MIT w/OCD.
4. Initiate and evaluate injection in Devonian formation using existing 2 7/8", L-80 production tubulars and Arrowset packer @ 14,500'.
5. Replace as warranted current 2 7/8" production tubulars with mixed string of 3-1/2" x 2-7/8" IPC injection tubing and 5" nickel coated packer @ +/- 14,400'.
6. Run MIT test and chart. File MIT with OCD office.
7. Return well to injection service.

14. I hereby certify that the foregoing is true and correct.

Name (Printed/Typed)
Stephanie A. Porter

Title Operations Technician

Signature

Date 09/10/2012

THIS SPACE FOR FEDERAL OR STATE OFFICE USE

Approved by

Title

Date

Conditions of approval, if any, are attached. Approval of this notice does not warrant or certify that the applicant holds legal or equitable title to those rights in the subject lease which would entitle the applicant to conduct operations thereon.

Office

Title 18 U.S.C. Section 1001 and Title 43 U.S.C. Section 1212, make it a crime for any person knowingly and willfully to make to any department or agency of the United States any false, fictitious or fraudulent statements or representations as to any matter within its jurisdiction.

(Instructions on page 2)

21

PROPOSED ADVERTISEMENT

Case No. 14943:

Application of Devon Energy Production Company, L.P. for approval of a water disposal well, Lea County, New Mexico. Applicant seeks an order approving water disposal into the Devonian formation (Northeast Bell Lake-Devonian Pool) at a depth of 14570-14660 feet subsurface in the Rio Blanco33 Fed. Well No. 2, located 1980 feet from the north line and 1980 feet from the west line of Section 33, Township 22 South, Range 34 East, NMPM. The well is located approximately 16-1/2 miles southwest of Oil Center, New Mexico.

RECEIVED OCD

2012 NOV 13 P 2:13