



286

ConocoPhillips
 San Juan Business Unit
 Land Department
 P.O. Box 4289
 Farmington, NM 87499-4289

February 28, 2013

Burlington Resources Oil & Gas Co LP
 "A subsidiary of ConocoPhillips Company"

Bureau of Land Management
 Farmington Resource Area
 6251 College Blvd, Ste A
 Farmington, NM 87402

Commissioner of Public Lands
 State of New Mexico
 PO Box 1148
 Santa Fe, NM 87501-1148

Oil Conservation Division
 State of New Mexico
 1220 S Saint Francis Dr
 Santa Fe, NM 87505

**RE: 2013 Plan of Development
 HUERFANITO UNIT I SEC. NO. 943
 SAN JUAN COUNTY, NEW MEXICO**

Ladies and Gentlemen:

The following Participating Areas currently exist in the HUERFANITO UNIT:

FORMATION	EXPANSION	EFFECTIVE DATE
DAKOTA	009	01-MAY-65
FRUITLAND COAL	010	01-APR-07
MESAVERDE	006	01-NOV-66
PICTURED CLIFFS	003	01-MAR-06

The **2012 Plan of Development** (or amendments thereto) provided for the following activity:

WELL NAME	FORMATION	TYPE	DEDICATION	STATUS
HUERFANITO UNIT 70S	FRUITLAND COAL	NEW DRILL - SINGLE	N2 010-026N-009W	CARRYOVER
HUERFANITO UNIT 74E	DAKOTA	NEW DRILL - SINGLE	N2 034-027N-009W	CANCELLED
HUERFANITO UNIT 74M Was Huerfanito Unit 100A	MESAVERDE	NEW DRILL - SINGLE	E2 034-027N-009W	CARRYOVER
HUERFANITO UNIT 79N	MESAVERDE / DAKOTA / MANCOS	NEW DRILL - TRIMINGLE	E2 026-027N-009W	COMPLETED
HUERFANITO UNIT 82N	MESAVERDE / DAKOTA / MANCOS	NEW DRILL - TRIMINGLE	W2 025-027N-009W	COMPLETED
HUERFANITO UNIT 82P	MESAVERDE / DAKOTA / MANCOS	NEW DRILL - TRIMINGLE	W2 025-027N-009W	COMPLETED
HUERFANITO UNIT 85M	MESAVERDE / DAKOTA / MANCOS	NEW DRILL - TRIMINGLE	W2 026-027N-009W	COMPLETED
HUERFANITO UNIT 87N	MESAVERDE / DAKOTA	NEW DRILL - COMMINGLE	MV-W2 001-026N-009W DK-S2 001-026N-009W	CARRYOVER
HUERFANITO UNIT 88N	MESAVERDE / DAKOTA / MANCOS	NEW DRILL - TRIMINGLE	E2 023-027N-009W	COMPLETED
HUERFANITO UNIT 88P	DAKOTA	NEW DRILL - SINGLE	E2 023-027N-009W	CARRYOVER
HUERFANITO UNIT 97E	DAKOTA	NEW DRILL - SINGLE	W2 024-027N-009W	CARRYOVER
HUERFANITO UNIT 97N	MESAVERDE / DAKOTA	NEW DRILL - COMMINGLE	W2 024-27N-009W	CARRYOVER
HUERFANITO UNIT 98N	MESAVERDE / DAKOTA	NEW DRILL - COMMINGLE	E2 035-027N-009W	COMPLETED
HUERFANITO UNIT 99E	MESAVERDE / DAKOTA / MANCOS	NEW DRILL - TRIMINGLE	W2 035-027N-009W	COMPLETED
HUERFANITO UNIT 99N	MESAVERDE / DAKOTA	NEW DRILL - COMMINGLE	W2 035-027N-009W	CARRYOVER
HUERFANITO UNIT 150S	FRUITLAND COAL	NEW DRILL - SINGLE	E2 001-026N-009W	CARRYOVER

HUERFANITO UNIT
2013 PLAN OF DEVELOPMENT

HUERFANITO UNIT 152S	FRUITLAND COAL	NEW DRILL - SINGLE	W2 001-026N-009W	CARRYOVER
HUERFANITO UNIT 153S	FRUITLAND COAL	NEW DRILL - SINGLE	W2 002-026N-009W	CARRYOVER
HUERFANITO UNIT 176S	FRUITLAND COAL / PICTURED CLIFFS	NEW DRILL - COMMINGLE	FTC-W2 026-027N-009W PC-NW4 026-027N-009W	CARRYOVER
STAR CANYON COM HZMC 2H (was NE HUERFANITO HZMC 1H)	MANCOS	NEW DRILL - SINGLE	N2 013-027N-009W	AT THIS TIME, SPACING FALLS OUTSIDE OF THE HUERFANITO UNIT. SHOULD THIS CHANGE WE WILL RESUBMIT.
STAR CAYON COM HZMC 1H (was NE HUERFANITO HZMC 2H)	MANCOS	NEW DRILL - SINGLE	S2 013-027N-009W	AT THIS TIME, SPACING FALLS OUTSIDE OF THE HUERFANITO UNIT. SHOULD THIS CHANGE WE WILL RESUBMIT.
HUERFANITO UNIT 20	FRUITLAND COAL	RECOMPLETE	W2 003-026N-009W	CARRYOVER
HUERFANITO UNIT 77	FRUITLAND COAL	RECOMPLETE	S2 024-027N-009W	CARRYOVER

Pursuant to Section 10 of the HUERFANITO UNIT Agreement, Burlington Resources Oil & Gas Company LP, as Unit Operator, hereby submits the **2013 Plan of Development** as follows:

WELL NAME	FORMATION	TYPE	DEDICATION
HUERFANITO UNIT 70S	FRUITLAND COAL	NEW DRILL - SINGLE	N2 010-026N-009W
HUERFANITO UNIT 74M Was Huerfanito Unit 100A	MESAVERDE	NEW DRILL - SINGLE	E2 034-027N-009W
HUERFANITO UNIT 87N	MESAVERDE / DAKOTA	NEW DRILL - COMMINGLE	MV-W2 001-026N-009W DK-S2 001-026N-009W
HUERFANITO UNIT 88P	DAKOTA	NEW DRILL - SINGLE	E2 023-027N-009W
HUERFANITO UNIT 97E	DAKOTA	NEW DRILL - SINGLE	W2 024-027N-009W
HUERFANITO UNIT 97N	MESAVERDE / DAKOTA	NEW DRILL - COMMINGLE	W2 024-027N-009W
HUERFANITO UNIT 99N	MESAVERDE / DAKOTA	NEW DRILL - COMMINGLE	W2 035-027N-009W
HUERFANITO UNIT 150S	FRUITLAND COAL	NEW DRILL - SINGLE	E2 001-026N-009W
HUERFANITO UNIT 152S	FRUITLAND COAL	NEW DRILL - SINGLE	W2 001-026N-009W
HUERFANITO UNIT 153S	FRUITLAND COAL	NEW DRILL - SINGLE	W2 002-026N-009W
HUERFANITO UNIT 176S	FRUITLAND COAL / PICTURED CLIFFS	NEW DRILL - COMMINGLE	FTC-W2 026-027N-009W PC-NW4 026-027N-009W
HUERFANITO UNIT 20	FRUITLAND COAL	RECOMPLETE	W2 003-026N-009W
HUERFANITO UNIT 74R	MESAVERDE	RECOMPLETE	E2 034-27N-009W
HUERFANITO UNIT 77	FRUITLAND COAL	RECOMPLETE	S2 024-027N-009W
HUERFANITO UNIT 97	MESAVERDE	RECOMPLETE	W2 024-027N-009W

HUERFANITO UNIT
2013 PLAN OF DEVELOPMENT

The working interest owners are being furnished a copy of this letter, well status listing and enclosed map. Burlington, as Unit Operator, will drill any offset wells required to prevent drainage of unitized substances and any other wells deemed necessary by the working interest owners or Unit Operator.

In accordance to Section 10 of the Unit Agreement, please provide your approvals by executing and returning a copy of the attached approval page to the undersigned.

Please contact me at (505) 324-6180 if there are any questions regarding this letter.

Sincerely,

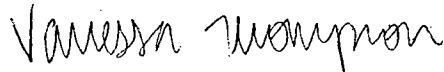
A handwritten signature in cursive script that reads "Vanessa Thompson".

Vanessa Thompson, RPL
Land Supervisor, SE

VT/d

xc: Huerfanito Unit, 3.0 (2013)
Huerfanito Unit Working Interest Owners

HUERFANITO UNIT
2013 PLAN OF DEVELOPMENT

HUERFANITO UNIT
2013 PLAN OF DEVELOPMENT APPROVALS

Bureau of Land Management

Date



New Mexico Oil Conservation Division

3
5/5/2013

Date

New Mexico Commissioner of Public Lands

Date

WORKING INTEREST OWNERS HUERFANITO UNIT

AJM LLC

BENSON MONTIN GREER DRILLING CORP

BURLINGTON RESOURCES O&G CO LP

BURLINGTON RESOURCES O&G SJBT

CHARLES W GAY

CLARIS SENTER

CONOCOPHILLIPS COMPANY

ELIZABETH TURNER CALLOWAY

FOUR STAR OIL & GAS COMPANY

FRANKLIN P LILLY

J GLENN TURNER JR

J&M RAYMOND LTD

LA PLATA GATHERING SYSTEM INC

LORRAYN GAY HACKER

MARY E GLENN

MARY FRANCES TURNER TR #6743

MCCONNELL LTD CO

MICHAEL R DIMOND

SAN JUAN BASIN TRUST

STOABS OIL CORP

T H MCELVAIN OIL AND GAS PROP

TAMACAM LLC

HUERFANITO UNIT

R9W

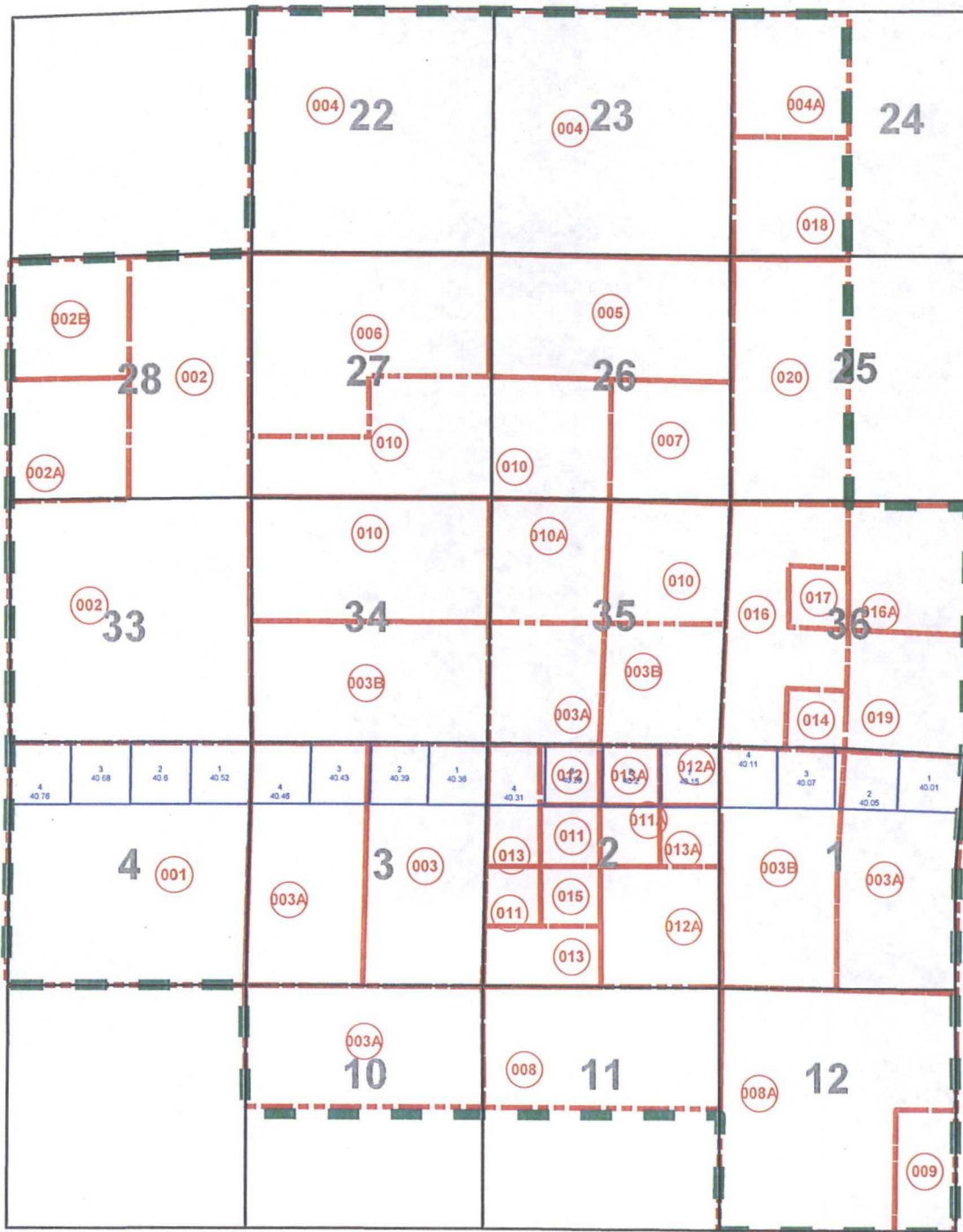

T
27
N

T
26
N

**HUERFANITO UNIT
STATUS OF WELLS REPORT 02/08/2013**

API	WELL NAME	CTY	ST	TWN	RGE	SEC	Unit Letter	COMP TYPE	Lse ID	Oper ID	Rsvr Name	PROD STAT	Completion Date	Abandon Date	Initial Production Date	First Sale Date
300451208600S01	HUERFANITO 10 DK	SAN JUAN	NM	27 N	9 W	21 N		G	A722310	216600	BASIN::DAKOTA	11	3/7/66		8/1/92	8/1/92
300452988500N01	HUERFANITO 174 FC NU	SAN JUAN	NM					G	A723151	216600	BASIN CB::FRUITLAND COAL	11				
300452988500N01	HUERFANITO 174 FC UT	SAN JUAN	NM					G	A728745	216600	BASIN CB::FRUITLAND COAL	11				
300452946500S01	HUERFANITO 5E	SAN JUAN	NM	26 N	9 W	10		G	A731434	35340	BASIN::DAKOTA	11	1/16/98		1/16/98	1/16/98
300452970100S01	HUERFANITO 5R	SAN JUAN	NM	26 N	9 W	10		G	A735866	35340	BASIN::DAKOTA	11	11/4/99		11/17/99	11/17/99
300453373900	HUERFANITO 74R DK	SAN JUAN	NM	27 N	9 W	34		G	A705308	30274	BASIN::DAKOTA	11	6/1/06			
300453297800N01	HUERFANITO 76E DK UT	SAN JUAN	NM					G	A728742	216600	BASIN::DAKOTA	11				
300453297800N02	HUERFANITO 76E MV NU	SAN JUAN	NM					G	A712017	216600	BLANCO::MESAVERDE	11				
300453297800N02	HUERFANITO 76E MV UT	SAN JUAN	NM					G	A728743	216600	BLANCO::MESAVERDE	11				
300451216600S01	HUERFANITO 8 DK	SAN JUAN	NM	27 N	9 W	17 A		G	A722310	216600	BASIN::DAKOTA	11	3/17/66		8/1/92	8/1/92
300453378000	HUERFANITO 81E DK	SAN JUAN	NM	26 N	9 W	11		G	A705308	30274	BASIN::DAKOTA	11	7/1/06			
300453444800S01	HUERFANITO 8E DK	SAN JUAN	NM	27 N	9 W	17 H		G	A722310	216600	BASIN::DAKOTA	11	6/12/08		7/7/08	7/7/08
300451216700S01	HUERFANITO 9 DK	SAN JUAN	NM	27 N	9 W	20 A		G	A722310	216600	BASIN::DAKOTA	11	3/6/66		8/1/92	8/1/92
300453377000	HUERFANITO 91F DK	SAN JUAN	NM	26 N	9 W	12		G	A705308	30274	BASIN::DAKOTA	99				
300453086500S01	HUERFANITO U 26R PC P&A	SAN JUAN	NM	27 N	9 W	33 P		G	A728744	216600	BALLARD::PICTURED CLIFFS	72	3/8/02	4/3/12	3/19/02	3/19/02
300450618100S03	HUERFANITO U NP 32 PC P&A	SAN JUAN	NM	27 N	9 W	33 D		G	A728744	216600	BALLARD::PICTURED CLIFFS	72	12/15/01	9/1/11	2/25/56	2/25/56
300451170400C02	HUERFANITO UN 103 PC P&A	SAN JUAN	NM	26 N	9 W	3 N		G	A728744	216600	BALLARD::PICTURED CLIFFS	71	3/1/96	3/1/10	5/9/96	5/9/96
300450617900S01	HUERFANITO UNIT 10 PC	SAN JUAN	NM	27 N	9 W	36 A		G	A728744	216600	BLANCO S::PICTURED CLIFF	11	6/8/55		12/1/55	12/1/55
300451176600S01	HUERFANITO UNIT 101 MV	SAN JUAN	NM	26 N	9 W	2 A		G	A728743	216600	BLANCO::MESAVERDE	11	7/28/66		7/28/66	7/28/66
300451187500S01	HUERFANITO UNIT 102 DK	SAN JUAN	NM	27 N	9 W	34 M		G	A728742	216600	BASIN::DAKOTA	11	1/26/67		8/29/66	8/29/66
300451170400S01	HUERFANITO UNIT 103 DK	SAN JUAN	NM	26 N	9 W	3 N		G	A728742	216600	BASIN::DAKOTA	11	6/30/66		6/30/66	6/30/66
300453389600S01	HUERFANITO UNIT 103E DK	SAN JUAN	NM	26 N	9 W	3 E		G	A728742	216600	BASIN::DAKOTA	11	6/1/07		7/3/07	7/3/07
300453441300S01	HUERFANITO UNIT 103F DK	SAN JUAN	NM	26 N	9 W	3 L		G	A728742	216600	BASIN::DAKOTA	11	5/2/08		5/21/08	5/21/08
300451181600S01	HUERFANITO UNIT 104 DK	SAN JUAN	NM	27 N	9 W	27 M		G	A728742	216600	BASIN::DAKOTA	11	10/28/66		10/28/66	10/28/66
300451180700S01	HUERFANITO UNIT 105 DK	SAN JUAN	NM	27 N	9 W	27 A		G	A728742	216600	BASIN::DAKOTA	11	10/6/66		10/6/66	10/6/66
300451172700S02	HUERFANITO UNIT 106 PC	SAN JUAN	NM	26 N	9 W	2 M		G	A728744	216600	BALLARD::PICTURED CLIFFS	11	7/3/99		8/10/99	8/10/99
300453480900C01	HUERFANITO UNIT 106M DK	SAN JUAN	NM	26 N	9 W	2 K		G	A728742	216600	BASIN::DAKOTA	11	2/17/09		3/23/09	3/23/09
300453480900C02	HUERFANITO UNIT 106M MV	SAN JUAN	NM	26 N	9 W	2 K		G	A712932	216600	BLANCO::MESAVERDE	11	2/17/09		3/23/09	3/23/09
300450606300S01	HUERFANITO UNIT 11 PC	SAN JUAN	NM	26 N	9 W	1 A		G	A728744	216600	BALLARD::PICTURED CLIFFS	11	3/21/56		12/11/56	12/11/56
300450606900S01	HUERFANITO UNIT 12 PC	SAN JUAN	NM	26 N	9 W	1 D		G	A728744	216600	BALLARD::PICTURED CLIFFS	11	9/1/55		11/20/55	11/20/55
300450600000S01	HUERFANITO UNIT 13 PC	SAN JUAN	NM	26 N	9 W	1 N		G	A728744	216600	BALLARD::PICTURED CLIFFS	11	6/11/55		10/21/55	10/21/55
300450599900S01	HUERFANITO UNIT 14 PC	SAN JUAN	NM	26 N	9 W	1 O		G	A728744	216600	BALLARD::PICTURED CLIFFS	11	2/6/56		6/12/56	6/12/56
300450607000S01	HUERFANITO UNIT 15 PC	SAN JUAN	NM	26 N	9 W	2 A		G	A728744	216600	BALLARD::PICTURED CLIFFS	11	7/15/55		10/17/55	10/17/55
300452718700S01	HUERFANITO UNIT 150	SAN JUAN	NM	26 N	9 W	1 H		G	A728745	216600	BASIN CB::FRUITLAND COAL	11	12/30/88		5/5/89	5/5/89
300452716200S01	HUERFANITO UNIT 151 FC	SAN JUAN	NM	27 N	9 W	36 A		G	A728745	216600	BASIN CB::FRUITLAND COAL	11	1/3/89		5/5/89	5/5/89
300452940900S01	HUERFANITO UNIT 152	SAN JUAN	NM	26 N	9 W	1 M		G	A728745	216600	BASIN CB::FRUITLAND COAL	11	6/3/97		6/25/97	6/25/97
300452938600S01	HUERFANITO UNIT 153	SAN JUAN	NM	26 N	9 W	2 L		G	A728745	216600	BASIN CB::FRUITLAND COAL	11	5/28/97		6/25/97	6/25/97
300452943200S01	HUERFANITO UNIT 155	SAN JUAN	NM	26 N	9 W	11 B		G	A728745	216600	BASIN CB::FRUITLAND COAL	11	5/22/97		6/19/97	6/19/97
300453104800S01	HUERFANITO UNIT 15J PC	SAN JUAN	NM	26 N	9 W	2 G		G	A728744	216600	BALLARD::PICTURED CLIFFS	41	9/26/02		9/25/02	9/25/02
300450607100S01	HUERFANITO UNIT 16 PC	SAN JUAN	NM	26 N	9 W	2 D		G	A728744	216600	BALLARD::PICTURED CLIFFS	11	7/17/55		10/17/55	10/17/55
300452716100S01	HUERFANITO UNIT 167	SAN JUAN	NM	26 N	9 W	2 A		G	A728745	216600	BASIN CB::FRUITLAND COAL	11	1/3/89		5/5/89	5/5/89
300453050300S01	HUERFANITO UNIT 169 P&A	SAN JUAN	NM	27 N	9 W	34 N		G	A723152	216600	BASIN CB::FRUITLAND COAL	72	4/24/01	2/3/10	4/25/01	4/25/01
300453050300S01	HUERFANITO UNIT 169 P&A	SAN JUAN	NM	27 N	9 W	34 N		G	A723152	216600	BASIN CB::FRUITLAND COAL	72	4/24/01	2/3/10	4/25/01	4/25/01
300453306300C02	HUERFANITO UNIT 175 FRC	SAN JUAN	NM	27 N	9 W	26 O		G	A728745	216600	BASIN CB::FRUITLAND COAL	11	3/7/06		3/17/06	3/17/06
300453306300C01	HUERFANITO UNIT 175 PC	SAN JUAN	NM	27 N	9 W	26 O		G	A728744	216600	BLANCO S::PICTURED CLIFFS	11	3/7/06		3/17/06	3/17/06
300453360500S01	HUERFANITO UNIT 176	SAN JUAN	NM	27 N	9 W	26 N		G	A728745	216600	BASIN CB::FRUITLAND COAL	11	8/6/06		8/22/06	8/22/06
300453360500S01	HUERFANITO UNIT 176	SAN JUAN	NM	27 N	9 W	26 N		G	A728745	216600	BASIN CB::FRUITLAND COAL	11	8/6/06		8/22/06	8/22/06
300453465100S01	HUERFANITO UNIT 177 FTC	SAN JUAN	NM	27 N	9 W	28 H		G	A712301	216600	BASIN::FRUITLAND COAL	11	11/15/08		1/20/09	1/20/09
300450600300S01	HUERFANITO UNIT 18 PC	SAN JUAN	NM	26 N	9 W	2 O		G	A728744	216600	BALLARD::PICTURED CLIFFS	11	6/18/55		11/30/55	11/30/55
300450606800S02	HUERFANITO UNIT 19 FC	SAN JUAN	NM	26 N	9 W	3 H		G	A728745	216600	BASIN CB::FRUITLAND COAL	11	7/22/55		8/6/91	8/6/91
300450605000S01	HUERFANITO UNIT 20 PC	SAN JUAN	NM	26 N	9 W	3 E		G	A728744	216600	BALLARD::PICTURED CLIFFS	11	6/28/55		10/21/55	10/21/55

PRODUCTION STATUS

- 11 - FLOWING WELL 71 - PERM ABANDON ZONE
- 41 - SHUT IN 72 - PERM ABANDON WELL
- 59 - SOLD PA - PLUG ABANDON
- 61 - TEMP ABANDON PS - PERM SHUT-IN

HUERFANITO UNIT
STATUS OF WELLS REPORT 02/08/2013

API	WELL NAME	CTY	ST	TWN	RGE	SEC	Unit Letter	COMP TYPE	Lse ID	Oper ID	Rsvr Name	PROD STAT	Completion Date	Abandon Date	Initial Production Date	First Sale Date
300450600200S01	HUERFANITO UNIT 21 PC	SAN JUAN	NM	26 N	9 W	3 O		G	A728744	216600	BALLARD::PICTURED CLIFFS	11	6/26/55		10/21/55	10/21/55
300450607200S02	HUERFANITO UNIT 23 FC	SAN JUAN	NM	26 N	9 W	4 C		G	A723149	216600	BASIN CB::FRUITLAND COAL	11	12/8/90		1/1/91	1/1/91
300450607200S02	HUERFANITO UNIT 23 FC	SAN JUAN	NM	26 N	9 W	4 C		G	A723149	216600	BASIN CB::FRUITLAND COAL	11	12/8/90		1/1/91	1/1/91
300450607200S01	HUERFANITO UNIT 23 PC TA	SAN JUAN	NM	26 N	9 W	4 C		G	A728744	216600	BALLARD::PICTURED CLIFFS	61	9/17/55		10/30/55	10/30/55
300453222600S01	HUERFANITO UNIT 23R PC	SAN JUAN	NM	26 N	9 W	4 F		G	A728744	216600	BALLARD::PICTURED CLIFFS	11	2/11/05		2/24/05	2/24/05
300450603000S01	HUERFANITO UNIT 24 PC	SAN JUAN	NM	26 N	9 W	4 K		G	A728744	216600	BALLARD::PICTURED CLIFFS	11	9/11/55		10/17/55	10/17/55
300450599800S01	HUERFANITO UNIT 25 PC	SAN JUAN	NM	26 N	9 W	4 P		G	A728744	216600	BALLARD::PICTURED CLIFFS	11	7/13/55		10/13/55	10/13/55
300450611100S01	HUERFANITO UNIT 27 PC	SAN JUAN	NM	27 N	9 W	34 M		G	A728744	216600	BALLARD::PICTURED CLIFFS	11	11/19/55		2/15/56	2/15/56
300450610000S02	HUERFANITO UNIT 29 FC	SAN JUAN	NM	27 N	9 W	35 M		G	A728745	216600	BASIN CB::FRUITLAND COAL	11	7/2/90		11/9/90	11/9/90
300453459000S01	HUERFANITO UNIT 29S FTC	SAN JUAN	NM	27 N	9 W	35 F		G	A728745	216600	BASIN::FRUITLAND COAL	11	6/16/08		7/31/08	7/31/08
300450609700S01	HUERFANITO UNIT 30 PC	SAN JUAN	NM	27 N	9 W	35 P		G	A728744	216600	BALLARD::PICTURED CLIFFS	11	10/24/55		2/15/56	2/15/56
300450613200S01	HUERFANITO UNIT 31 PC P&A	SAN JUAN	NM	27 N	9 W	33 L		G	A728744	216600	BALLARD::PICTURED CLIFFS	72	12/31/55	11/28/11	2/23/56	2/23/56
300453086400S01	HUERFANITO UNIT 34R PC	SAN JUAN	NM	27 N	9 W	34 F		G	A728744	216600	BALLARD::PICTURED CLIFFS	11	3/9/02		3/19/02	3/19/02
300450618400S01	HUERFANITO UNIT 35 PC	SAN JUAN	NM	27 N	9 W	34 A		G	A728744	216600	BALLARD::PICTURED CLIFFS	41	1/23/56		2/20/56	2/20/56
300450615400S01	HUERFANITO UNIT 36 PC	SAN JUAN	NM	27 N	9 W	35 E		G	A728744	216600	BALLARD::PICTURED CLIFFS	11	1/27/56		2/20/56	2/20/56
300453362800C02	HUERFANITO UNIT 39R FC	SAN JUAN	NM	27 N	9 W	27 M		G	A728745	216600	BASIN CB::FRUITLAND COAL	11	9/11/06		3/16/07	3/16/07
300453362800C02	HUERFANITO UNIT 39R FC	SAN JUAN	NM	27 N	9 W	27 M		G	A728745	216600	BASIN CB::FRUITLAND COAL	11	9/11/06		3/16/07	3/16/07
300453362800C01	HUERFANITO UNIT 39R PC	SAN JUAN	NM	27 N	9 W	27 M		G	A728744	216600	BALLARD::PICTURED CLIFFS	11	9/11/06		3/16/07	3/16/07
300453459200S01	HUERFANITO UNIT 39S FTC	SAN JUAN	NM	27 N	9 W	27 D		G	A728745	216600	BASIN::FRUITLAND COAL	11	6/4/08		7/1/08	7/1/08
300453086300S01	HUERFANITO UNIT 40R PC	SAN JUAN	NM	27 N	9 W	27 I		G	A728744	216600	BALLARD::PICTURED CLIFFS	41	3/10/02		3/27/02	3/27/02
300450628600S01	HUERFANITO UNIT 41 PC	SAN JUAN	NM	27 N	9 W	28 B		G	A728744	216600	FULCHER-KUTZ::PICTURED CL	11	4/15/56		8/3/56	8/3/56
300450625100S01	HUERFANITO UNIT 42 PC P&A	SAN JUAN	NM	27 N	9 W	27 E		G	A728744	216600	BALLARD::PICTURED CLIFFS	72	3/29/56	6/30/11	7/9/56	7/9/56
300450638300S01	HUERFANITO UNIT 44 PC	SAN JUAN	NM	27 N	9 W	22 E		G	A728744	216600	FULCHER-KUTZ::PICTURED CL	11	2/11/56		4/6/56	4/6/56
300453048000S01	HUERFANITO UNIT 45R PC	SAN JUAN	NM	27 N	9 W	24 M		G	A728744	216600	BLANCO S.:PICTURED CLIFF	11	3/15/01		3/26/01	3/26/01
300453053700S01	HUERFANITO UNIT 46R PC	SAN JUAN	NM	27 N	9 W	25 M		G	A728744	216600	BLANCO S.:PICTURED CLIFF	11	10/25/01		10/26/01	10/26/01
300453362700C02	HUERFANITO UNIT 47R FC	SAN JUAN	NM	27 N	9 W	27 A		G	A732757	216600	BASIN CB::FRUITLAND COAL	11	1/10/07		1/9/07	2/21/07
300453362700C01	HUERFANITO UNIT 47R PC	SAN JUAN	NM	27 N	9 W	27 A		G	A728744	216600	BALLARD::PICTURED CLIFFS	11	1/10/07		1/9/07	2/21/07
300453455900S01	HUERFANITO UNIT 47S FTC	SAN JUAN	NM	27 N	9 W	27 I		G	A732757	216600	BASIN::FRUITLAND COAL	11	6/9/08		7/2/08	7/2/08
300451323900S01	HUERFANITO UNIT 48 PC	SAN JUAN	NM	27 N	9 W	26 L		G	A728744	216600	BALLARD::PICTURED CLIFFS	11	5/11/56		3/27/57	3/27/57
300450615500S01	HUERFANITO UNIT 49 PC	SAN JUAN	NM	27 N	9 W	35 G		G	A728744	216600	BALLARD::PICTURED CLIFFS	11	5/6/56		12/14/56	12/14/56
300450615900S02	HUERFANITO UNIT 50 FRC	SAN JUAN	NM	27 N	9 W	36 E		G	A728745	216600	BASIN CB::FRUITLAND COAL	11	8/2/06		8/18/06	8/18/06
300453470500C01	HUERFANITO UNIT 50E DK	SAN JUAN	NM	27 N	9 W	36 E		G	A728742	216600	BASIN::DAKOTA	11	12/2/08		12/22/08	12/22/08
300453470500C02	HUERFANITO UNIT 50E MV	SAN JUAN	NM	27 N	9 W	36 E		G	A728743	216600	BLANCO::MESAVERDE	11	12/2/08		12/22/08	12/22/08
300450609200S02	HUERFANITO UNIT 51 FC	SAN JUAN	NM	27 N	9 W	36 N		G	A728745	216600	BASIN CB::FRUITLAND COAL	11	6/28/90		1/21/91	1/21/91
300452969100S01	HUERFANITO UNIT 51R PC	SAN JUAN	NM	27 N	9 W	36 N		G	A728744	216600	BALLARD::PICTURED CLIFFS	72	6/9/99	11/14/09	6/30/99	6/30/99
300453051200S01	HUERFANITO UNIT 52R PC	SAN JUAN	NM	27 N	9 W	36 I		G	A728744	216600	BALLARD::PICTURED CLIFFS	11	11/3/01		11/7/01	11/7/01
300450640000S01	HUERFANITO UNIT 56 PC	SAN JUAN	NM	27 N	9 W	23 B		G	A728744	216600	BLANCO S.:PICTURED CLIFF	11	9/26/56		2/26/57	2/26/57
300451347300S01	HUERFANITO UNIT 57 PC	SAN JUAN	NM	27 N	9 W	23 J		G	A728744	216600	BLANCO S.:PICTURED CLIFF	11	9/30/56		2/27/57	2/27/57
300450638100S01	HUERFANITO UNIT 59 PC	SAN JUAN	NM	27 N	9 W	23 E		G	A728744	216600	BLANCO S.:PICTURED CLIFF	11	7/4/59		10/12/59	10/12/59
300450601500S01	HUERFANITO UNIT 60 DK	SAN JUAN	NM	26 N	9 W	4 M		G	A728742	216600	BASIN::DAKOTA	11	11/19/60		11/29/60	11/29/60
300453443900S01	HUERFANITO UNIT 60E DK	SAN JUAN	NM	26 N	9 W	4 L		G	A728742	216600	BASIN::DAKOTA	11	3/19/08		3/19/08	3/19/08
300450604500S01	HUERFANITO UNIT 61 DK	SAN JUAN	NM	26 N	9 W	4 G		G	A728742	216600	BASIN::DAKOTA	11	12/30/60		1/6/61	1/6/61
300453441100S01	HUERFANITO UNIT 61E DK	SAN JUAN	NM	26 N	9 W	4 A		G	A728742	216600	BASIN::DAKOTA	11	3/6/08		3/6/08	3/6/08
300450596500S01	HUERFANITO UNIT 62 PC	SAN JUAN	NM	26 N	9 W	11 D		G	A728744	216600	BALLARD::PICTURED CLIFFS	11	11/30/54		3/3/55	3/3/55
300452391200S01	HUERFANITO UNIT 63R PC	SAN JUAN	NM	26 N	9 W	11 H		G	A728744	216600	BALLARD::PICTURED CLIFFS	11	1/28/81		3/27/81	3/27/81
300450596200S01	HUERFANITO UNIT 64 PC	SAN JUAN	NM	26 N	9 W	12 D		G	A728744	216600	BALLARD::PICTURED CLIFFS	11	12/6/54		2/19/55	2/19/55
300450590600S02	HUERFANITO UNIT 65	SAN JUAN	NM	26 N	9 W	12 M		G	A728745	216600	BASIN CB::FRUITLAND COAL	11	11/5/90		6/21/91	6/21/91
300452973100S01	HUERFANITO UNIT 65R PC	SAN JUAN	NM	26 N	9 W	12 M		G	A728744	216600	BALLARD::PICTURED CLIFFS	11	4/1/99		5/12/99	5/12/99
300450594400S02	HUERFANITO UNIT 66 FC	SAN JUAN	NM	26 N	9 W	12 H		G	A728745	216600	BASIN CB::FRUITLAND COAL	11	11/8/90		6/21/91	6/21/91
300452990100S01	HUERFANITO UNIT 66R PC	SAN JUAN	NM	26 N	9 W	12 H		G	A728744	216600	BALLARD::PICTURED CLIFFS	11	6/16/99		8/6/99	8/6/99
300450590500S01	HUERFANITO UNIT 67 PC	SAN JUAN	NM	26 N	9 W	12 O		G	A728744	216600	BALLARD::PICTURED CLIFFS	11	12/28/54		2/19/55	2/19/55

PRODUCTION STATUS

- 11 - FLOWING WELL
- 41 - SHUT IN
- 59 - SOLD
- 61 - TEMP ABANDON
- 71 - PERM ABANDON ZONE
- 72 - PERM ABANDON WELL
- PA - PLUG ABANDON
- PS - PERM SHUT-IN

**HUERFANITO UNIT
STATUS OF WELLS REPORT 02/08/2013**

API	WELL NAME	CTY	ST	TWN	RGE	SEC	Unit Letter	COMP TYPE	Lse ID	Oper ID	Rsvr Name	PROD STAT	Completion Date	Abandon Date	Initial Production Date	First Sale Date
300450596800S01	HUERFANITO UNIT 69 PC	SAN JUAN	NM	26 N	9 W	10 D		G	A728744	216600	BALLARD::PICTURED CLIFFS	11	11/15/54		3/3/55	3/3/55
300450596600S02	HUERFANITO UNIT 70	SAN JUAN	NM	26 N	9 W	10 A		G	A728745	216600	BASIN CB::FRUITLAND COAL	11	11/11/90		6/21/91	6/21/91
300452943600S01	HUERFANITO UNIT 70R PC	SAN JUAN	NM	26 N	9 W	10 G		G	A728744	216600	BALLARD::PICTURED CLIFFS	11	6/6/97		7/9/97	7/9/97
300450607600C01	HUERFANITO UNIT 71 DK P&A	SAN JUAN	NM	26 N	9 W	3 A		G	A728742	216600	BASIN::DAKOTA	72	3/14/52	4/19/12	5/1/62	5/1/62
300450607600C02	HUERFANITO UNIT 71 MV P&A	SAN JUAN	NM	26 N	9 W	3 A		G	A720685	216600	BLANCO::MESAVERDE	72	1/15/02	4/19/12	1/21/02	1/21/02
300450607600C02	HUERFANITO UNIT 71 MV P&A	SAN JUAN	NM	26 N	9 W	3 A		G	A720685	216600	BLANCO::MESAVERDE	72	1/15/02	4/19/12	1/21/02	1/21/02
300450622600S01	HUERFANITO UNIT 72 DK	SAN JUAN	NM	27 N	9 W	28 K		G	A728742	216600	BASIN::DAKOTA	71	9/1/62	8/7/08	10/25/62	10/25/62
300450622600S02	HUERFANITO UNIT 72 FC	SAN JUAN	NM	27 N	9 W	28 K		G	A712987	216600	BASIN CB::FRUITLAND COAL	11	9/1/62		12/2/08	12/2/08
300450622600S02	HUERFANITO UNIT 72 FC	SAN JUAN	NM	27 N	9 W	28 K		G	A712987	216600	BASIN CB::FRUITLAND COAL	11	9/1/62		12/2/08	12/2/08
300450616300S01	HUERFANITO UNIT 73 DK	SAN JUAN	NM	27 N	9 W	33 H		G	A728742	216600	BASIN::DAKOTA	11	1/21/63		1/29/63	1/29/63
300453373900S01	HUERFANITO UNIT 74R DK	SAN JUAN	NM	27 N	9 W	34 M		G	A728742	216600	BASIN::DAKOTA	11	1/11/07		1/11/07	1/24/07
300450637700S01	HUERFANITO UNIT 75 DK	SAN JUAN	NM	27 N	9 W	22 E		G	A728742	216600	BASIN::DAKOTA	11	5/26/63		6/1/63	6/1/63
300453460400S01	HUERFANITO UNIT 75E DK	SAN JUAN	NM	27 N	9 W	22 C		G	A728742	216600	BASIN::DAKOTA	11	7/23/08		8/8/08	8/8/08
300450605300S01	HUERFANITO UNIT 76 DK	SAN JUAN	NM	26 N	9 W	2 G		G	A728742	216600	BASIN::DAKOTA	11	6/19/63		6/28/63	6/28/63
300453297800C01	HUERFANITO UNIT 76E DK	SAN JUAN	NM	26 N	9 W	2 F		G	A728742	216600	BASIN::DAKOTA	11	6/23/05		7/14/05	7/14/05
300453297800	HUERFANITO UNIT 76E DK	SAN JUAN	NM	26 N	9 W	2 F		G	A705308	30274	BASIN::DAKOTA	11				
300453297800	HUERFANITO UNIT 76E MV	SAN JUAN	NM	26 N	9 W	2 F		G	A705309	30274	BLANCO::MESAVERDE	11				
300453297800C02	HUERFANITO UNIT 76E MV	SAN JUAN	NM	26 N	9 W	2 F		G	A728743	216600	BLANCO::MESAVERDE	11	6/23/05		7/14/05	7/14/05
300453483800C01	HUERFANITO UNIT 76M DK	SAN JUAN	NM	26 N	9 W	2 D		G	A728742	216600	BASIN::DAKOTA	11	4/20/09		6/9/09	6/9/09
300453483800C02	HUERFANITO UNIT 76M MV	SAN JUAN	NM	26 N	9 W	2 D		G	A728743	216600	BLANCO::MESAVERDE	11	4/20/09		6/9/09	6/9/09
300450635800S02	HUERFANITO UNIT 77 CH TA	SAN JUAN	NM	27 N	9 W	24 K		G	A725103	216600	OTERO::CHACRA	61	1/30/95		3/28/95	3/28/95
300450635800S03	HUERFANITO UNIT 77 PC	SAN JUAN	NM	27 N	9 W	24 K		G	A728744	216600	BLANCO S.:PICTURED CLIFF	11	2/3/03		2/6/03	2/6/03
300452538300S01	HUERFANITO UNIT 77A MV	SAN JUAN	NM	27 N	9 W	24 C		G	A728743	216600	BLANCO::MESAVERDE	11	8/16/82		8/5/82	8/5/82
300450617700C01	HUERFANITO UNIT 78 DK	SAN JUAN	NM	27 N	9 W	36 B		G	A728742	216600	BASIN::DAKOTA	11	3/31/64		4/25/64	4/25/64
300450617700C02	HUERFANITO UNIT 78 MV	SAN JUAN	NM	27 N	9 W	36 B		G	A728743	216600	BLANCO::MESAVERDE	11	3/31/64		4/18/64	4/18/64
300452897100S01	HUERFANITO UNIT 78M DK TA	SAN JUAN	NM	27 N	9 W	36 I		G	A728742	216600	BASIN::DAKOTA	61	9/6/93		1/5/95	1/5/95
300452897100S03	HUERFANITO UNIT 78M FC	SAN JUAN	NM	27 N	9 W	36 I		G	A728745	216600	BASIN CB::FRUITLAND COAL	11	9/23/03		9/29/03	9/29/03
300453434200C01	HUERFANITO UNIT 78N DK	SAN JUAN	NM	27 N	9 W	36 H		G	A728742	216600	BASIN::DAKOTA	11	3/3/08		3/3/08	3/3/08
300453434200C02	HUERFANITO UNIT 78N MV	SAN JUAN	NM	27 N	9 W	36 H		G	A728743	216600	BLANCO::MESAVERDE	11	3/3/08		3/3/08	3/3/08
300450626100C01	HUERFANITO UNIT 79 DK	SAN JUAN	NM	27 N	9 W	26 H		G	A728742	216600	BASIN::DAKOTA	11	11/20/64		12/11/64	12/11/64
300450626100C02	HUERFANITO UNIT 79 MV	SAN JUAN	NM	27 N	9 W	26 H		G	A728743	216600	BLANCO::MESAVERDE	11	11/20/64		12/4/64	12/4/64
300453495000C01	HUERFANITO UNIT 79N DK	SAN JUAN	NM	27 N	9 W	26 P		G	A728742	216600	BASIN::DAKOTA	11	5/9/12		5/9/12	5/9/12
300453495000C02	HUERFANITO UNIT 79N MCS	SAN JUAN	NM	27 N	9 W	26 P		G	A717863	216600	BASIN::MANCOS	11	5/9/12		5/9/12	5/9/12
300453495000C03	HUERFANITO UNIT 79N MV	SAN JUAN	NM	27 N	9 W	26 P		G	A728743	216600	BLANCO::MESAVERDE	11	5/9/12		5/9/12	5/9/12
300450597000S01	HUERFANITO UNIT 80 DK	SAN JUAN	NM	26 N	9 W	10 B		G	A728742	216600	BASIN::DAKOTA	11	7/24/65		8/2/65	8/2/65
300453356500S01	HUERFANITO UNIT 80E DK	SAN JUAN	NM	26 N	9 W	10 A		G	A728742	216600	BASIN::DAKOTA	11	10/10/06		10/20/06	10/20/06
300453439300S01	HUERFANITO UNIT 80F DK	SAN JUAN	NM	26 N	9 W	10 D		G	A728742	216600	BASIN::DAKOTA	11	3/18/08		4/7/08	4/7/08
300450597200S01	HUERFANITO UNIT 81 DK	SAN JUAN	NM	26 N	9 W	11 A		G	A728742	216600	BASIN::DAKOTA	11	7/31/65		8/11/65	8/11/65
300453378000S01	HUERFANITO UNIT 81E DK	SAN JUAN	NM	26 N	9 W	11 O		G	A728742	216600	BASIN::DAKOTA	11	5/17/07		6/7/07	6/7/07
300453356700S01	HUERFANITO UNIT 81F DK	SAN JUAN	NM	26 N	9 W	11 B		G	A728742	216600	BASIN::DAKOTA	11	10/18/06		10/30/06	10/30/06
300453441000S01	HUERFANITO UNIT 81G DK	SAN JUAN	NM	26 N	9 W	11 F		G	A728742	216600	BASIN::DAKOTA	11	5/8/08		5/28/08	5/28/08
300451218900C03	HUERFANITO UNIT 82 CH	SAN JUAN	NM	27 N	9 W	25 L		G	A725104	216600	OTERO::CHACRA	11	7/16/03		7/22/03	7/22/03
300451218900C01	HUERFANITO UNIT 82 DK	SAN JUAN	NM	27 N	9 W	25 L		G	A728742	216600	BASIN::DAKOTA	11	10/9/65		10/20/65	10/20/65
300451218900C02	HUERFANITO UNIT 82 MV	SAN JUAN	NM	27 N	9 W	25 L		G	A728743	216600	BLANCO::MESAVERDE	11	10/9/65		10/27/65	10/27/65
300452897700S03	HUERFANITO UNIT 82M CH	SAN JUAN	NM	27 N	9 W	25 D		G	A725104	216600	OTERO::CHACRA	11	10/3/93		4/5/95	4/5/95
300453531000C01	HUERFANITO UNIT 82N DK	SAN JUAN	NM	27 N	9 W	25 N		G	A728742	216600	BASIN::DAKOTA	11	9/17/12			
300453531000C02	HUERFANITO UNIT 82N MCS	SAN JUAN	NM	27 N	9 W	25 N		G	A717864	216600	BASIN::MANCOS	11	9/17/12			
300453531000C03	HUERFANITO UNIT 82N MV	SAN JUAN	NM	27 N	9 W	25 N		G	A728743	216600	BLANCO::MESAVERDE	11	9/17/12			
300450625600S01	HUERFANITO UNIT 83 DK	SAN JUAN	NM	27 N	9 W	28 H		G	A728742	216600	BASIN::DAKOTA	11	9/4/65		9/15/65	9/15/65
300453469500S01	HUERFANITO UNIT 83E DK	SAN JUAN	NM	27 N	9 W	28 B		G	A728742	216600	BASIN::DAKOTA	11	9/24/08		10/10/08	10/10/08
300451190300S01	HUERFANITO UNIT 84 DK	SAN JUAN	NM	27 N	9 W	33 K		G	A728742	216600	BASIN::DAKOTA	11	9/23/65		9/30/65	9/30/65

PRODUCTION STATUS

11 - FLOWING WELL 71 - PERM ABANDON ZONE
41 - SHUT IN 72 - PERM ABANDON WELL
59 - SOLD PA - PLUG ABANDON
61 - TEMP ABANDON PS - PERM SHUT-IN

**HUERFANITO UNIT
STATUS OF WELLS REPORT 02/08/2013**

API	WELL NAME	CTY	ST	TWN	RGE	SEC	Unit Letter	COMP TYPE	Lse ID	Oper ID	Rsvr Name	PROD STAT	Completion Date	Abandon Date	Initial Production Date	First Sale Date
300453528700C01	HUERFANITO UNIT 85M DK	SAN JUAN	NM	27 N	9 W	26 C		G	A728742	216600	BASIN::DAKOTA	11	5/24/12		5/24/12	5/24/12
300453528700C02	HUERFANITO UNIT 85M MC	SAN JUAN	NM	27 N	9 W	26 C		G	A718412	216600	BASIN::MANCOS	11	5/24/12		5/24/12	5/24/12
300453528700C03	HUERFANITO UNIT 85M MV	SAN JUAN	NM	27 N	9 W	26 C		G	A728743	216600	BLANCO::MESAVERDE	11	5/24/12		5/24/12	5/24/12
300450612900C01	HUERFANITO UNIT 86 DK	SAN JUAN	NM	27 N	9 W	36 L		G	A728742	216600	BASIN::DAKOTA	11	7/2/65		7/19/65	7/19/65
300450612900C02	HUERFANITO UNIT 86 MV	SAN JUAN	NM	27 N	9 W	36 L		G	A728743	216600	BLANCO::MESAVERDE	11	7/2/65		7/26/65	7/26/65
300452344700S01	HUERFANITO UNIT 86A MV	SAN JUAN	NM	27 N	9 W	36 C		G	A728743	216600	BLANCO::MESAVERDE	11	10/23/79		10/23/79	10/23/79
300450602300C01	HUERFANITO UNIT 87 DK	SAN JUAN	NM	26 N	9 W	1 K		G	A728742	216600	BASIN::DAKOTA	11	4/22/65		5/3/65	5/3/65
300450602300C02	HUERFANITO UNIT 87 MV	SAN JUAN	NM	26 N	9 W	1 K		G	A728743	216600	BLANCO::MESAVERDE	11	4/22/65		5/10/65	5/10/65
300452344400S01	HUERFANITO UNIT 87A MV	SAN JUAN	NM	26 N	9 W	1 F		G	A728743	216600	BLANCO::MESAVERDE	11	10/22/79		10/22/79	10/22/79
300453466200S01	HUERFANITO UNIT 87E DK	SAN JUAN	NM	26 N	9 W	1 I		G	A728742	216600	BASIN::DAKOTA	11	1/8/09		1/28/09	1/28/09
300453184000	HUERFANITO UNIT 87M DK	SAN JUAN	NM	26 N	9 W	1 J		G	A705308	30274	BASIN::DAKOTA	11				
300453184000C01	HUERFANITO UNIT 87M DK	SAN JUAN	NM	26 N	9 W	1 J		G	A728742	216600	BASIN::DAKOTA	11	3/9/04		3/15/04	3/15/04
300453184000	HUERFANITO UNIT 87M MV	SAN JUAN	NM	26 N	9 W	1 J		G	A705309	30274	BLANCO::MESAVERDE	11				
300453184000C02	HUERFANITO UNIT 87M MV	SAN JUAN	NM	26 N	9 W	1 J		G	A728743	216600	BLANCO::MESAVERDE	11	3/9/04		3/15/04	3/15/04
300453526700C01	HUERFANITO UNIT 88N DK	SAN JUAN	NM	27 N	9 W	23 J		G	A728742	216600	BASIN::DAKOTA	11	6/6/12		7/2/12	7/2/12
300453526700C02	HUERFANITO UNIT 88N MCS	SAN JUAN	NM	27 N	9 W	23 J		G	A717768	216600	BASIN::MANCOS	11	6/6/12		7/2/12	7/2/12
300453526700C03	HUERFANITO UNIT 88N MV	SAN JUAN	NM	27 N	9 W	23 J		G	A728743	216600	BLANCO::MESAVERDE	11	6/6/12		7/2/12	7/2/12
300453419900C01	HUERFANITO UNIT 88R DK	SAN JUAN	NM	27 N	9 W	23 H		G	A728742	216600	BASIN::DAKOTA	11	1/21/08		1/21/08	1/21/08
300453419900C02	HUERFANITO UNIT 88R MV	SAN JUAN	NM	27 N	9 W	23 H		G	A728743	216600	BLANCO::MESAVERDE	11	1/21/08		1/21/08	1/21/08
300450634400D01	HUERFANITO UNIT 89 DK	SAN JUAN	NM	27 N	9 W	23 L		G	A728742	216600	BASIN::DAKOTA	11	2/5/95		6/2/65	6/2/65
300456029600C01	HUERFANITO UNIT 90 DK	SAN JUAN	NM	26 N	9 W	1 B		G	A728742	216600	BASIN::DAKOTA	11	9/21/65		9/29/65	9/29/65
300456029600C02	HUERFANITO UNIT 90 MV	SAN JUAN	NM	26 N	9 W	1 B		G	A728743	216600	BLANCO::MESAVERDE	11	9/21/65		10/13/65	10/13/65
300453439900S01	HUERFANITO UNIT 90E DK	SAN JUAN	NM	26 N	9 W	1 E		G	A728742	216600	BASIN::DAKOTA	11	5/9/08		6/3/08	6/3/08
300453425400C01	HUERFANITO UNIT 90M DK	SAN JUAN	NM	26 N	9 W	1 H		G	A728742	216600	BASIN::DAKOTA	11	5/21/08		5/21/08	5/21/08
300453425400C02	HUERFANITO UNIT 90M MV	SAN JUAN	NM	26 N	9 W	1 H		G	A728743	216600	BLANCO::MESAVERDE	11	5/21/08		5/21/08	5/21/08
300450596300S01	HUERFANITO UNIT 91 DK	SAN JUAN	NM	26 N	9 W	12 B		G	A728742	216600	BASIN::DAKOTA	11	8/10/65		8/18/65	8/18/65
300453374100S01	HUERFANITO UNIT 91E DK	SAN JUAN	NM	26 N	9 W	12 H		G	A728742	216600	BASIN::DAKOTA	11	6/7/07		7/16/07	7/16/07
300453377000S01	HUERFANITO UNIT 91F DK	SAN JUAN	NM	26 N	9 W	12 D		G	A728742	216600	BASIN::DAKOTA	11	5/24/07		6/12/07	6/12/07
300450591600S01	HUERFANITO UNIT 92 DK	SAN JUAN	NM	26 N	9 W	12 L		G	A728742	216600	BASIN::DAKOTA	11	10/29/65		11/8/65	11/8/65
300453360000S01	HUERFANITO UNIT 92F DK	SAN JUAN	NM	26 N	9 W	12 N		G	A728742	216600	BASIN::DAKOTA	11	10/31/06		11/8/06	11/8/06
300451336500S02	HUERFANITO UNIT 93 FRC	SAN JUAN	NM	27 N	9 W	25 D		G	A728745	216600	BASIN CB::FRUITLAND COAL	11	11/15/90		8/24/92	8/24/92
300453051000S01	HUERFANITO UNIT 93R PC	SAN JUAN	NM	27 N	9 W	25 D		G	A728744	216600	BLANCO S.:PICTURED CLIFF	11	11/3/01		11/7/01	11/7/01
300453478000S01	HUERFANITO UNIT 93S FC	SAN JUAN	NM	27 N	9 W	25 K		G	A728745	216600	BASIN::FRUITLAND COAL	11	12/10/10		3/16/11	3/16/11
300453084500S01	HUERFANITO UNIT 94R PC	SAN JUAN	NM	27 N	9 W	26 B		G	A728744	216600	BLANCO S.:PICTURED CLIFF	11	11/13/03		11/17/03	11/17/03
300450639900S01	HUERFANITO UNIT 95 PC	SAN JUAN	NM	27 N	9 W	24 D		G	A728744	216600	BLANCO S.:PICTURED CLIFF	11	2/4/53		11/2/53	11/2/53
300451205100S01	HUERFANITO UNIT 96 DK	SAN JUAN	NM	27 N	9 W	22 A		G	A728742	216600	BASIN::DAKOTA	11	12/13/65		12/13/65	12/13/65
300453469000S01	HUERFANITO UNIT 96E DK	SAN JUAN	NM	27 N	9 W	22 G		G	A728742	216600	BASIN::DAKOTA	11	2/5/09		3/16/09	3/16/09
300450635600S01	HUERFANITO UNIT 97 DK	SAN JUAN	NM	27 N	9 W	24 L		G	A728742	216600	BASIN::DAKOTA	11	11/14/65		11/22/65	11/22/65
300451190400C01	HUERFANITO UNIT 98 DK	SAN JUAN	NM	27 N	9 W	35 G		G	A728742	216600	BASIN::DAKOTA	11	2/24/67		2/24/67	2/24/67
300451190400C02	HUERFANITO UNIT 98 MV	SAN JUAN	NM	27 N	9 W	35 G		G	A728743	216600	BLANCO::MESAVERDE	11	2/24/67		2/24/67	2/24/67
300452894600S03	HUERFANITO UNIT 98M	SAN JUAN	NM	27 N	9 W	35 O		G	A728745	216600	BASIN CB::FRUITLAND COAL	11	10/14/96		11/14/96	11/14/96
300453526200C01	HUERFANITO UNIT 98N DK	SAN JUAN	NM	27 N	9 W	35 I		G	A728742	216600	BASIN::DAKOTA	11	4/19/12		4/19/12	5/29/12
300453526200C02	HUERFANITO UNIT 98N MV	SAN JUAN	NM	27 N	9 W	35 I		G	A728743	216600	BLANCO::MESAVERDE	11	4/19/12		4/19/12	5/29/12
300453457200S01	HUERFANITO UNIT 98S FTC	SAN JUAN	NM	27 N	9 W	35 A		G	A728745	216600	BASIN::FRUITLAND COAL	41	5/19/08		6/17/08	6/17/08
300453525700C01	HUERFANITO UNIT 99E DK	SAN JUAN	NM	27 N	9 W	35 F		G	A728742	216600	BASIN::DAKOTA	11	6/23/12		6/23/12	6/23/12
300453525700C02	HUERFANITO UNIT 99E MCS	SAN JUAN	NM	27 N	9 W	35 F		G	A717706	216600	BASIN::MANCOS	11	6/23/12		6/23/12	6/23/12
300453525700C03	HUERFANITO UNIT 99E MV	SAN JUAN	NM	27 N	9 W	35 F		G	A728743	216600	BLANCO::MESAVERDE	11	6/23/12		6/23/12	6/23/12
300452988500S01	HUERFANITO UNIT COM 174	SAN JUAN	NM	27 N	9 W	24 P		G	A723151	216600	BASIN CB::FRUITLAND COAL	11	6/12/00		7/5/00	7/5/00
300453094000S01	HUERFANITO UNIT COM 552	SAN JUAN	NM	27 N	9 W	24 H		G	A727602	216600	BASIN CB::FRUITLAND COAL	11	11/17/03		11/19/03	11/19/03
300451187500	HUERFANITO UNIT D 102FRR	SAN JUAN	NM	27 N	9 W	34 M		G	A705308	30274	BASIN::DAKOTA	11			1/1/94	1/1/94
300451170400	HUERFANITO UNIT D 103FRR	SAN JUAN	NM	26 N	9 W	3 N		G	A705308	30274	BASIN::DAKOTA	11			1/1/94	1/1/94

PRODUCTION STATUS

- 11 - FLOWING WELL
- 41 - SHUT IN
- 59 - SOLD
- 61 - TFMP ARANDON
- 71 - PERM ABANDON ZONE
- 72 - PERM ABANDON WELL
- PA - PLUG ABANDON
- PS - PFRM SHUT-IN

**HUERFANITO UNIT
STATUS OF WELLS REPORT 02/08/2013**

API	WELL NAME	CTY	ST	TWN	RGE	SEC	Unit Letter	COMP TYPE	Lse ID	Oper ID	Rsvr Name	PROD STAT	Completion Date	Abandon Date	Initial Production Date	First Sale Date
300451181600	HUERFANITO UNIT D 104FRR	SAN JUAN	NM	27 N	9 W	27 M		G	A705308	30274	BASIN::DAKOTA	11			1/1/94	1/1/94
300451180700	HUERFANITO UNIT D 105FRR	SAN JUAN	NM	27 N	9 W	27 A		G	A705308	30274	BASIN::DAKOTA	11			1/1/94	10/6/66
300451172700	HUERFANITO UNIT D 106FRR	SAN JUAN	NM	26 N	9 W	2 M		G	A705308	30274	BASIN::DAKOTA	71			1/1/94	1/1/94
300450601500	HUERFANITO UNIT D 60FRR	SAN JUAN	NM	26 N	9 W	4 M		G	A705308	30274	BASIN::DAKOTA	11			1/1/94	1/1/94
300450604500	HUERFANITO UNIT D 61FRR	SAN JUAN	NM	26 N	9 W	4 G		G	A705308	30274	BASIN::DAKOTA	11			1/1/94	1/1/94
300450607600	HUERFANITO UNIT D 71FRR	SAN JUAN	NM	26 N	9 W	3 A		G	A705308	30274	BASIN::DAKOTA	11	5/1/62		1/1/94	5/1/62
300450622600	HUERFANITO UNIT D 72FRR	SAN JUAN	NM	27 N	9 W	28 K		G	A705308	30274	BASIN::DAKOTA	11			1/1/94	10/25/62
300450616300	HUERFANITO UNIT D 73FRR	SAN JUAN	NM	27 N	9 W	33 H		G	A705308	30274	BASIN::DAKOTA	11			1/1/94	1/1/94
300450614800	HUERFANITO UNIT D 74FRR	SAN JUAN	NM	27 N	9 W	34 G		G	A705308	30274	BASIN::DAKOTA	72		7/1/04	1/1/94	1/1/94
300450637700	HUERFANITO UNIT D 75FRR	SAN JUAN	NM	27 N	9 W	22 E		G	A705308	30274	BASIN::DAKOTA	11			1/1/94	6/8/63
300450605300	HUERFANITO UNIT D 76FRR	SAN JUAN	NM	26 N	9 W	2 G		G	A705308	30274	BASIN::DAKOTA	11			1/1/94	6/28/63
300450617700	HUERFANITO UNIT D 78FRR	SAN JUAN	NM	27 N	9 W	36 B		G	A705308	30274	BASIN::DAKOTA	11			1/1/94	3/16/64
300452897100	HUERFANITO UNIT D 78MFRR	SAN JUAN	NM	27 N	9 W	36 I		G	A705308	30274	BASIN::DAKOTA	11			1/1/94	1/5/95
300450626100	HUERFANITO UNIT D 79FRR	SAN JUAN	NM	27 N	9 W	26 H		G	A705308	30274	BASIN::DAKOTA	11			1/1/94	1/1/94
300452894800	HUERFANITO UNIT D 79MFRR	SAN JUAN	NM	27 N	9 W	26 J		G	A705308	30274	BASIN::DAKOTA	11			1/1/94	2/9/95
300450597000	HUERFANITO UNIT D 80FRR	SAN JUAN	NM	26 N	9 W	10 B		G	A705308	30274	BASIN::DAKOTA	11			1/1/94	1/1/94
300450597200	HUERFANITO UNIT D 81FRR	SAN JUAN	NM	26 N	9 W	11 A		G	A705308	30274	BASIN::DAKOTA	11			1/1/94	1/1/94
300451218900	HUERFANITO UNIT D 82FRR	SAN JUAN	NM	27 N	9 W	25 L		G	A705308	30274	BASIN::DAKOTA	11			1/1/94	1/1/94
300450625600	HUERFANITO UNIT D 83FRR	SAN JUAN	NM	27 N	9 W	28 H		G	A705308	30274	BASIN::DAKOTA	11			1/1/94	1/1/94
300451190300	HUERFANITO UNIT D 84FRR	SAN JUAN	NM	27 N	9 W	33 K		G	A705308	30274	BASIN::DAKOTA	11			1/1/94	1/1/94
300450620900	HUERFANITO UNIT D 85FRR	SAN JUAN	NM	27 N	9 W	26 N		G	A705308	30274	BASIN::DAKOTA	PS			1/1/94	1/1/94
300450612900	HUERFANITO UNIT D 86FRR	SAN JUAN	NM	27 N	9 W	36 L		G	A705308	30274	BASIN::DAKOTA	11			1/1/94	1/1/94
300450602300	HUERFANITO UNIT D 87FRR	SAN JUAN	NM	26 N	9 W	1 K		G	A705308	30274	BASIN::DAKOTA	11			1/1/94	1/1/94
300450641000	HUERFANITO UNIT D 88FRR	SAN JUAN	NM	27 N	9 W	23 B		G	A705308	30274	BASIN::DAKOTA	PA			1/1/94	5/4/65
300450634400	HUERFANITO UNIT D 89FRR	SAN JUAN	NM	27 N	9 W	23 L		G	A705308	30274	BASIN::DAKOTA	11			1/1/94	1/1/94
300456029600	HUERFANITO UNIT D 90FRR	SAN JUAN	NM	26 N	9 W	1 B		G	A705308	30274	BASIN::DAKOTA	11			1/1/94	10/13/65
300450596300	HUERFANITO UNIT D 91FRR	SAN JUAN	NM	26 N	9 W	12 B		G	A705308	30274	BASIN::DAKOTA	11			1/1/94	9/8/65
300450591600	HUERFANITO UNIT D 92FRR	SAN JUAN	NM	26 N	9 W	12 L		G	A705308	30274	BASIN::DAKOTA	11			1/1/94	11/8/65
300451205100	HUERFANITO UNIT D 96FRR	SAN JUAN	NM	27 N	9 W	22 A		G	A705308	30274	BASIN::DAKOTA	11			1/1/94	1/1/94
300450635600	HUERFANITO UNIT D 97FRR	SAN JUAN	NM	27 N	9 W	24 L		G	A705308	30274	BASIN::DAKOTA	11			1/1/94	1/1/94
300451190400	HUERFANITO UNIT D 98FRR	SAN JUAN	NM	27 N	9 W	35 G		G	A705308	30274	BASIN::DAKOTA	11			1/1/94	2/24/67
300452894600	HUERFANITO UNIT D 98MFRR	SAN JUAN	NM	27 N	9 W	35 O		G	A705308	30274	BASIN::DAKOTA	PS			1/1/94	4/7/94
300451182400	HUERFANITO UNIT D 99FRR	SAN JUAN	NM	27 N	9 W	35 L		G	A705308	30274	BASIN::DAKOTA	PA			1/1/94	11/11/66
300451178300	HUERFANITO UNIT M 100RON	SAN JUAN	NM	27 N	9 W	34 H		G	A705309	30274	BLANCO::MESAVERDE	PA			1/1/94	8/29/66
300451176600	HUERFANITO UNIT M 101RON	SAN JUAN	NM	26 N	9 W	2 A		G	A705309	30274	BLANCO::MESAVERDE	11			1/1/94	7/28/66
300452538300	HUERFANITO UNIT M 77ARON	SAN JUAN	NM	27 N	9 W	24 C		G	A705309	30274	BLANCO::MESAVERDE	11			1/1/94	8/16/82
300450635800	HUERFANITO UNIT M 77RON	SAN JUAN	NM	27 N	9 W	24 K		G	A705309	30274	BLANCO::MESAVERDE	PS			1/1/94	10/16/62
300452897100	HUERFANITO UNIT M 78MRON	SAN JUAN	NM	27 N	9 W	36 I		G	A705309	30274	BLANCO::MESAVERDE	11			1/1/94	1/5/95
300450617700	HUERFANITO UNIT M 78RON	SAN JUAN	NM	27 N	9 W	36 B		G	A705309	30274	BLANCO::MESAVERDE	41			1/1/94	5/4/64
300452894800	HUERFANITO UNIT M 79MRON	SAN JUAN	NM	27 N	9 W	26 J		G	A705309	30274	BLANCO::MESAVERDE	11			1/1/94	2/9/95
300450626100	HUERFANITO UNIT M 79RON	SAN JUAN	NM	27 N	9 W	26 H		G	A705309	30274	BLANCO::MESAVERDE	11			1/1/94	1/1/94
300451218900	HUERFANITO UNIT M 82RON	SAN JUAN	NM	27 N	9 W	25 L		G	A705309	30274	BLANCO::MESAVERDE	11			1/1/94	1/1/94
300450620900	HUERFANITO UNIT M 85RON	SAN JUAN	NM	27 N	9 W	26 N		G	A705309	30274	BLANCO::MESAVERDE	PS			1/1/94	1/1/94
300452344700	HUERFANITO UNIT M 86ARON	SAN JUAN	NM	27 N	9 W	36 C		G	A705309	30274	BLANCO::MESAVERDE	11			1/1/94	10/16/79
300450612900	HUERFANITO UNIT M 86RON	SAN JUAN	NM	27 N	9 W	36 L		G	A705309	30274	BLANCO::MESAVERDE	11			1/1/94	1/1/94
300452344400	HUERFANITO UNIT M 87ARON	SAN JUAN	NM	26 N	9 W	1 F		G	A705309	30274	BLANCO::MESAVERDE	11	10/12/79		1/1/94	10/12/79
300453184000	HUERFANITO UNIT M 87MRON	SAN JUAN	NM	26 N	9 W	1 F		G	A705309	30274	BLANCO::MESAVERDE	11	1/1/94		1/1/94	1/1/94
300450602300	HUERFANITO UNIT M 87RON	SAN JUAN	NM	26 N	9 W	1 K		G	A705309	30274	BLANCO::MESAVERDE	11			1/1/94	1/1/94
300450641000	HUERFANITO UNIT M 88RON	SAN JUAN	NM	27 N	9 W	23 B		G	A705309	30274	BLANCO::MESAVERDE	PA			1/1/94	5/4/65
300456029600	HUERFANITO UNIT M 90RON	SAN JUAN	NM	26 N	9 W	1 B		G	A705309	30274	BLANCO::MESAVERDE	11			1/1/94	10/13/65
300452894600	HUERFANITO UNIT M 98MRON	SAN JUAN	NM	27 N	9 W	35 O		G	A705309	30274	BLANCO::MESAVERDE	PS	8/5/93		1/1/94	1/1/94

PRODUCTION STATUS

11 - FLOWING WELL 71 - PERM ABANDON ZONE
41 - SHUT IN 72 - PERM ABANDON WELL
59 - SOLD PA - PLUG ABANDON
61 - TEMP ABANDON PS - PERM SHUT-IN

HUERFANITO UNIT
STATUS OF WELLS REPORT 02/08/2013

API	WELL NAME	CTY	ST	TWN	RGE	SEC	Unit Letter	COMP TYPE	Lse ID	Oper ID	Rsvr Name	PROD STAT	Completion Date	Abandon Date	Initial Production Date	First Sale Date
300451190400	HUERFANITO UNIT M 98RON	SAN JUAN	NM	27 N	9 W	35	G	G	A705309	30274	BLANCO::MESAVERDE	11			1/1/94	2/24/67
300451182400	HUERFANITO UNIT M 99RON	SAN JUAN	NM	27 N	9 W	35	L	G	A705309	30274	BLANCO::MESAVERDE	PA			1/1/94	11/11/66
300452720200S01	HUERFANITO UNIT NP 154	SAN JUAN	NM	27 N	9 W	34	H	G	A723146	216600	BASIN CB::FRUITLAND COAL	11	1/12/89		6/9/89	6/9/89
300452720200S01	HUERFANITO UNIT NP 154	SAN JUAN	NM	27 N	9 W	34	H	G	A723146	216600	BASIN CB::FRUITLAND COAL	11	1/12/89		6/9/89	6/9/89
300450600800S02	HUERFANITO UNIT NP 68	SAN JUAN	NM	26 N	9 W	3	M	G	A728745	216600	BASIN CB::FRUITLAND COAL	11	8/29/89		2/28/90	2/28/90
300452972800S01	HUERFANITO UT 19R PC P&A	SAN JUAN	NM	26 N	9 W	3	A	G	A728744	216600	BALLARD::PICTURED CLIFFS	72	6/11/99	7/29/09	7/28/99	7/28/99
300452894800C01	HUERFANITO UT 79M DK P&A	SAN JUAN	NM	27 N	9 W	26	I	G	A728742	216600	BASIN::DAKOTA	72	8/19/93	7/27/11	2/9/95	2/9/95
300452894800C02	HUERFANITO UT 79M MV P&A	SAN JUAN	NM	27 N	9 W	26	I	G	A728743	216600	BLANCO::MESAVERDE	72	8/19/93	7/27/11	2/9/95	2/9/95

PRODUCTION STATUS

11 - FLOWING WELL 71 - PERM ABANDON ZONE
 41 - SHUT IN 72 - PERM ABANDON WELL
 59 - SOLD PA - PLUG ABANDON
 61 - TFMP ARANDON PS - PFRM SHUT-IN