

**COG OPERATING LLC
LEE "3" FEE # 8H HEARING
(API:30-015-41512)**

Lakewood Area - Eddy County, New Mexico

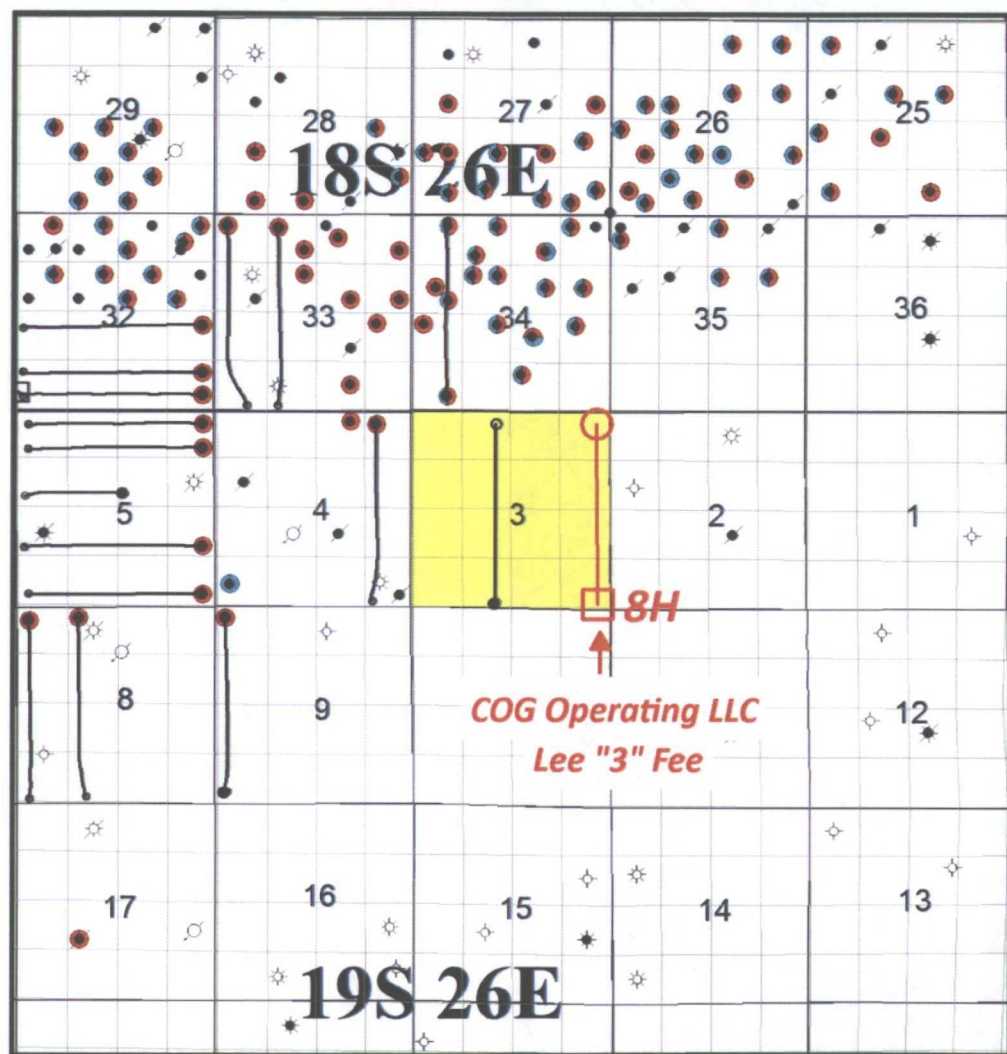

Lakewood Area – Lee “3” Fee #8H Lease Map



Map Legend

- Paddock Producer
- Blinebry Producer

- BHL ○ COG - Horizontal Location (Lee “3” Fee #8H)
- SHL □

Concho Acreage

