

# Mewbourne Oil Company

Eddy County, New Mexico  
True Grit 8 B3BO Fed Com #1H  
Design #1

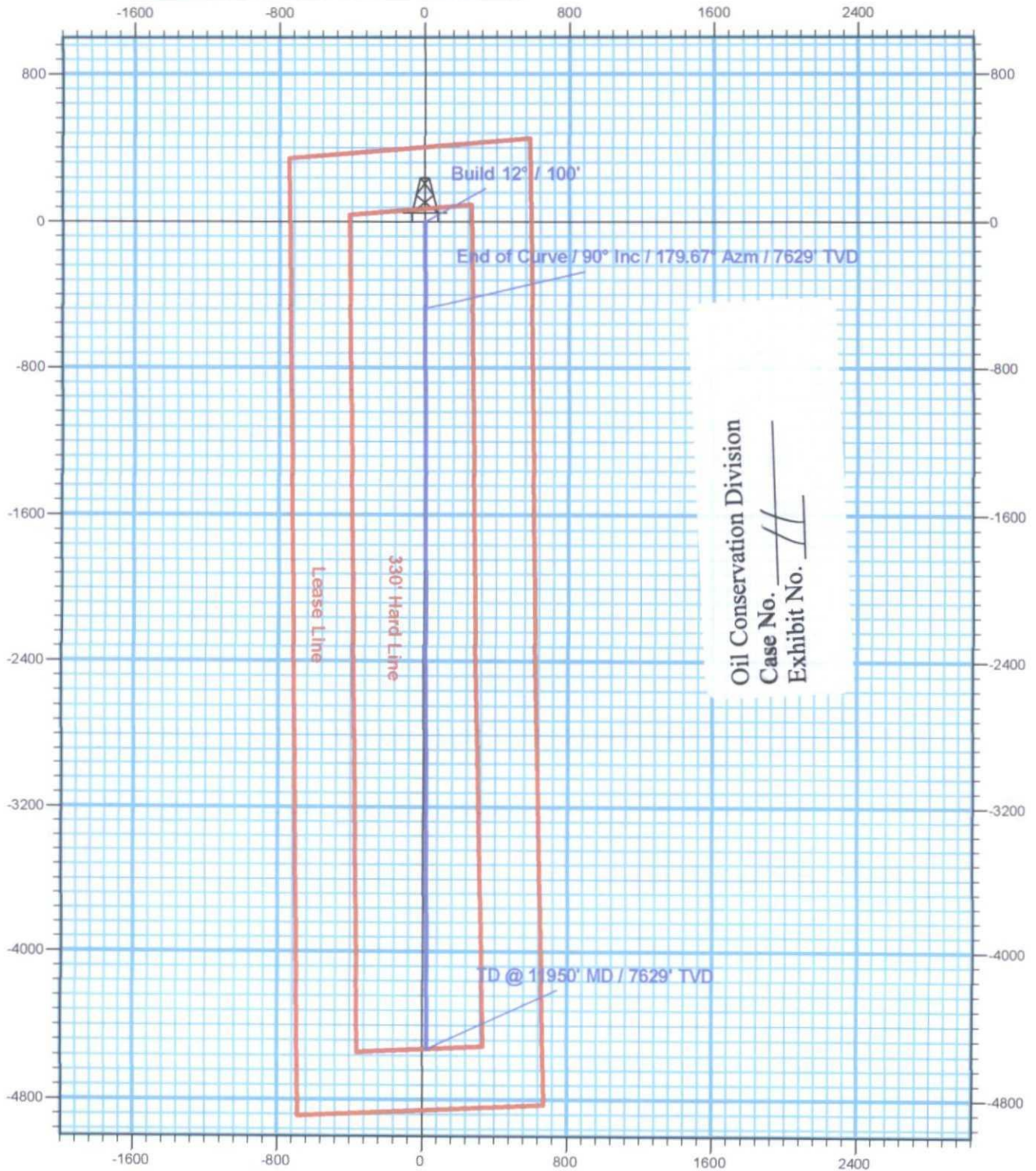

Oil Conservation Division

Case No.           

Exhibit No.   II

# Mewbourne Oil Company

Eddy County, New Mexico  
True Grit 8 B3BO Fed Com #1H  
Design #1

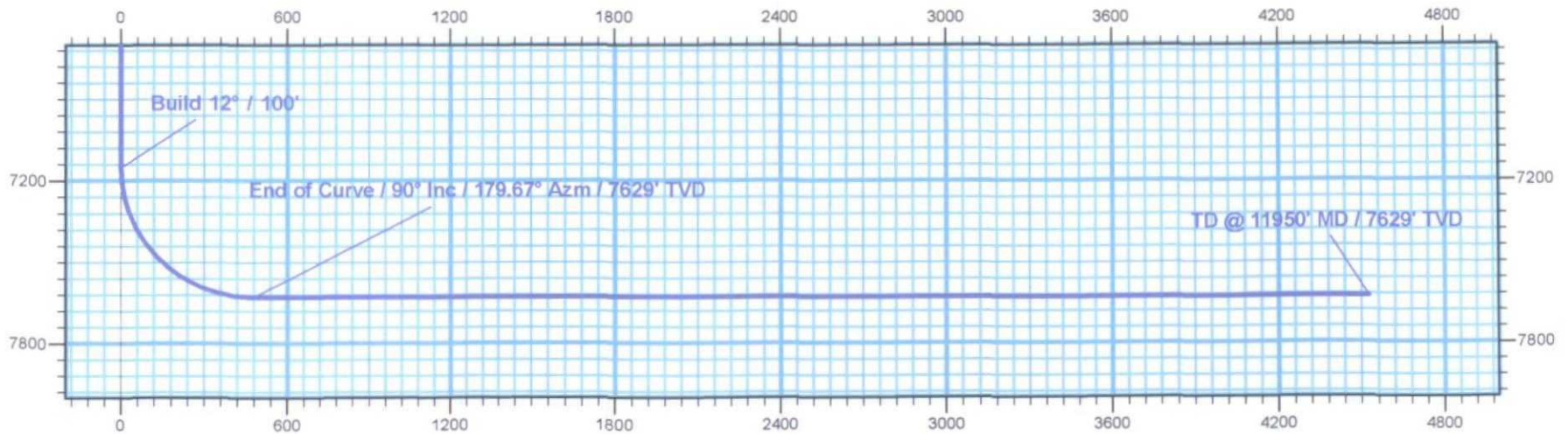
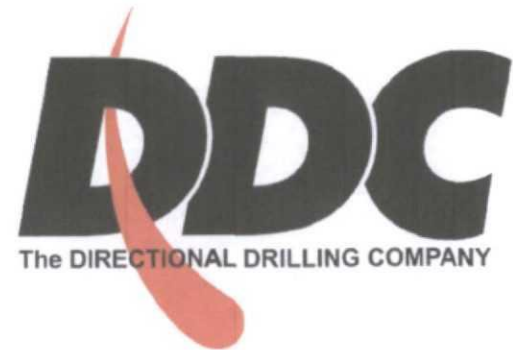

Vertical Section at 179.67° (600 usf/in)

# **Mewbourne Oil Co**

**Eddy County, New Mexico**

**Sec 8-22S-25E**

**True Grit 8 B3BO Fed Com #1H**

**Wellbore #1**

**Plan: Design #1**

## **DDC Well Planning Report**

**07 February, 2014**

**DDC**  
Well Planning Report

Database: EDM 5000.1 Single User Db	Local Co-ordinate Reference: Well True Grit 8 B3BO Fed Com #1H
Company: Mewbourne Oil Co	TVD Reference: WELL @ 3614.0usft (Patterson #46)
Project: Eddy County, New Mexico	MD Reference: WELL @ 3614.0usft (Patterson #46)
Site: Sec 8-22S-25E	North Reference: Grid
Well: True Grit 8 B3BO Fed Com #1H	Survey Calculation Method: Minimum Curvature
Wellbore: Wellbore #1	
Design: Design #1	

Project	Eddy County, New Mexico		
Map System:	US State Plane 1927 (Exact solution)	System Datum:	Mean Sea Level
Geo Datum:	NAD 1927 (NADCON CONUS)		
Map Zone:	New Mexico East 3001		

Site	Sec 8-22S-25E		
Site Position:	Northing:	513,712.70 usft	Latitude: 32° 24' 44.221 N
From: Map	Easting:	474,727.00 usft	Longitude: 104° 24' 54.825 W
Position Uncertainty:	0.0 usft	Slot Radius: 13-3/16 "	Grid Convergence: -0.04 °

Well	True Grit 8 B3BO Fed Com #1H			
Well Position	+N-S	0.0 usft	Northing: 513,712.70 usft	Latitude: 32° 24' 44.221 N
	+E-W	0.0 usft	Easting: 474,727.00 usft	Longitude: 104° 24' 54.825 W
Position Uncertainty	0.0 usft	Wellhead Elevation:	Ground Level:	3,594.0 usft

Wellbore	Wellbore #1				
Magnetics	Model Name	Sample Date	Declination (°)	Dip Angle (°)	Field Strength (nT)
	IGRF2010	2/7/2014	7.66	60.15	48,370

Design	Design #1			
Audit Notes:				
Version:	Phase:	PLAN	Tie On Depth:	0.0
Vertical Section:	Depth From (TVD) (usft)	+N-S (usft)	+E-W (usft)	Direction (°)
	0.0	0.0	0.0	179.67

Plan Sections										
Measured Depth (usft)	Inclination (°)	Azimuth (°)	Vertical Depth (usft)	+N-S (usft)	+E-W (usft)	Dogleg Rate (°/100usft)	Build Rate (°/100usft)	Turn Rate (°/100usft)	TFO (°)	Target
0.0	0.00	0.00	0.0	0.0	0.0	0.00	0.00	0.00	0.00	
7,151.5	0.00	0.00	7,151.5	0.0	0.0	0.00	0.00	0.00	0.00	
7,901.5	90.00	179.67	7,629.0	-477.5	2.8	12.00	12.00	23.96	179.67	
11,950.2	90.00	179.67	7,629.0	-4,526.1	26.2	0.00	0.00	0.00	0.00	PBHL True Grit 8 B3E

**DDC**  
Well Planning Report

Database:	EDM 5000.1 Single User Db	Local Co-ordinate Reference:	Well True Grit 8 B3BO Fed Com #1H
Company:	Mewbourne Oil Co	TVD Reference:	WELL @ 3614.0usft (Patterson #46)
Project:	Eddy County, New Mexico	MD Reference:	WELL @ 3614.0usft (Patterson #46)
Site:	Sec 8-22S-25E	North Reference:	Grid
Well:	True Grit 8 B3BO Fed Com #1H	Survey Calculation Method:	Minimum Curvature
Wellbore:	Wellbore #1		
Design:	Design #1		

Planned Survey										
Measured Depth (usft)	Inclination (°)	Azimuth (°)	Vertical Depth (usft)	+N/-S (usft)	+E/-W (usft)	Vertical Section (usft)	Dogleg Rate (°/100usft)	Build Rate (°/100usft)	Turn Rate (°/100usft)	
<b>Build 12° / 100'</b>										
7,151.5	0.00	0.00	7,151.5	0.0	0.0	0.0	0.00	0.00	0.00	0.00
7,200.0	5.82	179.67	7,199.9	-2.5	0.0	2.5	12.00	12.00	0.00	0.00
7,300.0	17.82	179.67	7,297.6	-22.9	0.1	22.9	12.00	12.00	0.00	0.00
7,400.0	29.82	179.67	7,388.9	-63.2	0.4	63.2	12.00	12.00	0.00	0.00
7,500.0	41.82	179.67	7,469.9	-121.6	0.7	121.6	12.00	12.00	0.00	0.00
7,600.0	53.82	179.67	7,536.9	-195.6	1.1	195.6	12.00	12.00	0.00	0.00
7,700.0	65.82	179.67	7,587.1	-281.9	1.6	281.9	12.00	12.00	0.00	0.00
7,800.0	77.82	179.67	7,618.2	-376.7	2.2	376.7	12.00	12.00	0.00	0.00
7,900.0	89.82	179.67	7,629.0	-476.0	2.8	476.0	12.00	12.00	0.00	0.00
<b>End of Curve / 90° Inc / 179.67° Azm / 7629' TVD</b>										
7,901.5	90.00	179.67	7,629.0	-477.5	2.8	477.5	12.00	12.00	0.00	0.00
8,000.0	90.00	179.67	7,629.0	-576.0	3.3	576.0	0.00	0.00	0.00	0.00
8,100.0	90.00	179.67	7,629.0	-676.0	3.9	676.0	0.00	0.00	0.00	0.00
8,200.0	90.00	179.67	7,629.0	-776.0	4.5	776.0	0.00	0.00	0.00	0.00
8,300.0	90.00	179.67	7,629.0	-876.0	5.1	876.0	0.00	0.00	0.00	0.00
8,400.0	90.00	179.67	7,629.0	-975.9	5.6	976.0	0.00	0.00	0.00	0.00
8,500.0	90.00	179.67	7,629.0	-1,075.9	6.2	1,076.0	0.00	0.00	0.00	0.00
8,600.0	90.00	179.67	7,629.0	-1,175.9	6.8	1,176.0	0.00	0.00	0.00	0.00
8,700.0	90.00	179.67	7,629.0	-1,275.9	7.4	1,276.0	0.00	0.00	0.00	0.00
8,800.0	90.00	179.67	7,629.0	-1,375.9	8.0	1,376.0	0.00	0.00	0.00	0.00
8,900.0	90.00	179.67	7,629.0	-1,475.9	8.5	1,476.0	0.00	0.00	0.00	0.00
9,000.0	90.00	179.67	7,629.0	-1,575.9	9.1	1,576.0	0.00	0.00	0.00	0.00
9,100.0	90.00	179.67	7,629.0	-1,675.9	9.7	1,676.0	0.00	0.00	0.00	0.00
9,200.0	90.00	179.67	7,629.0	-1,775.9	10.3	1,776.0	0.00	0.00	0.00	0.00
9,300.0	90.00	179.67	7,629.0	-1,875.9	10.9	1,876.0	0.00	0.00	0.00	0.00
9,400.0	90.00	179.67	7,629.0	-1,975.9	11.4	1,976.0	0.00	0.00	0.00	0.00
9,500.0	90.00	179.67	7,629.0	-2,075.9	12.0	2,076.0	0.00	0.00	0.00	0.00
9,600.0	90.00	179.67	7,629.0	-2,175.9	12.6	2,176.0	0.00	0.00	0.00	0.00
9,700.0	90.00	179.67	7,629.0	-2,275.9	13.2	2,276.0	0.00	0.00	0.00	0.00
9,800.0	90.00	179.67	7,629.0	-2,375.9	13.7	2,376.0	0.00	0.00	0.00	0.00
9,900.0	90.00	179.67	7,629.0	-2,475.9	14.3	2,476.0	0.00	0.00	0.00	0.00
10,000.0	90.00	179.67	7,629.0	-2,575.9	14.9	2,576.0	0.00	0.00	0.00	0.00
10,100.0	90.00	179.67	7,629.0	-2,675.9	15.5	2,676.0	0.00	0.00	0.00	0.00
10,200.0	90.00	179.67	7,629.0	-2,775.9	16.1	2,776.0	0.00	0.00	0.00	0.00
10,300.0	90.00	179.67	7,629.0	-2,875.9	16.6	2,876.0	0.00	0.00	0.00	0.00
10,400.0	90.00	179.67	7,629.0	-2,975.9	17.2	2,976.0	0.00	0.00	0.00	0.00
10,500.0	90.00	179.67	7,629.0	-3,075.9	17.8	3,076.0	0.00	0.00	0.00	0.00
10,600.0	90.00	179.67	7,629.0	-3,175.9	18.4	3,176.0	0.00	0.00	0.00	0.00
10,700.0	90.00	179.67	7,629.0	-3,275.9	19.0	3,276.0	0.00	0.00	0.00	0.00
10,800.0	90.00	179.67	7,629.0	-3,375.9	19.5	3,376.0	0.00	0.00	0.00	0.00
10,900.0	90.00	179.67	7,629.0	-3,475.9	20.1	3,476.0	0.00	0.00	0.00	0.00
11,000.0	90.00	179.67	7,629.0	-3,575.9	20.7	3,576.0	0.00	0.00	0.00	0.00
11,100.0	90.00	179.67	7,629.0	-3,675.9	21.3	3,676.0	0.00	0.00	0.00	0.00
11,200.0	90.00	179.67	7,629.0	-3,775.9	21.9	3,776.0	0.00	0.00	0.00	0.00
11,300.0	90.00	179.67	7,629.0	-3,875.9	22.4	3,876.0	0.00	0.00	0.00	0.00
11,400.0	90.00	179.67	7,629.0	-3,975.9	23.0	3,976.0	0.00	0.00	0.00	0.00
11,500.0	90.00	179.67	7,629.0	-4,075.9	23.6	4,076.0	0.00	0.00	0.00	0.00
11,600.0	90.00	179.67	7,629.0	-4,175.9	24.2	4,176.0	0.00	0.00	0.00	0.00
11,700.0	90.00	179.67	7,629.0	-4,275.9	24.7	4,276.0	0.00	0.00	0.00	0.00
11,800.0	90.00	179.67	7,629.0	-4,375.9	25.3	4,376.0	0.00	0.00	0.00	0.00
11,900.0	90.00	179.67	7,629.0	-4,475.9	25.9	4,476.0	0.00	0.00	0.00	0.00
<b>TD @ 11950' MD / 7629' TVD</b>										

**DDC**  
Well Planning Report

Database:	EDM 5000.1 Single User Db	Local Co-ordinate Reference:	Well True Grit 8 B3BO Fed Com #1H
Company:	Mewbourne Oil Co	TVD Reference:	WELL @ 3614.0usft (Patterson #46)
Project:	Eddy County, New Mexico	MD Reference:	WELL @ 3614.0usft (Patterson #46)
Site:	Sec 8-22S-25E	North Reference:	Grid
Well:	True Grit 8 B3BO Fed Com #1H	Survey Calculation Method:	Minimum Curvature
Wellbore:	Wellbore #1		
Design:	Design #1		

Measured Depth (usft)	Inclination (°)	Azimuth (°)	Vertical Depth (usft)	+N-S (usft)	+E-W (usft)	Vertical Section (usft)	Dogleg Rate (°/100usft)	Build Rate (°/100usft)	Turn Rate (°/100usft)
11,950.2	90.00	179.67	7,629.0	-4,526.1	26.2	4,526.2	0.00	0.00	0.00

Target Name	Dip Angle (°)	Dip Dir. (°)	TVD (usft)	+N-S (usft)	+E-W (usft)	Northing (usft)	Easting (usft)	Latitude	Longitude
PBHL True Grit 8 B3BO - hit/miss target - Shape - Point	0.00	0.00	7,629.0	-4,526.1	26.2	509,186.61	474,753.19	32° 23' 59.430 N	104° 24' 54.479 W

Measured Depth (usft)	Vertical Depth (usft)	Local Coordinates		Comment
		+N-S (usft)	+E-W (usft)	
7,151.5	7,151.5	0.0	0.0	Build 12° / 100'
7,901.5	7,629.0	-477.5	2.8	End of Curve / 90° Inc / 179.67° Azm / 7629' TVD
11,950.2	7,629.0	-4,526.1	26.2	TD @ 11950' MD / 7629' TVD