

**COG OPERATING LLC
STONEWALL "9" FEE #2H
HEARING**

30-015-39778





Lakewood Area - Eddy County, New Mexico

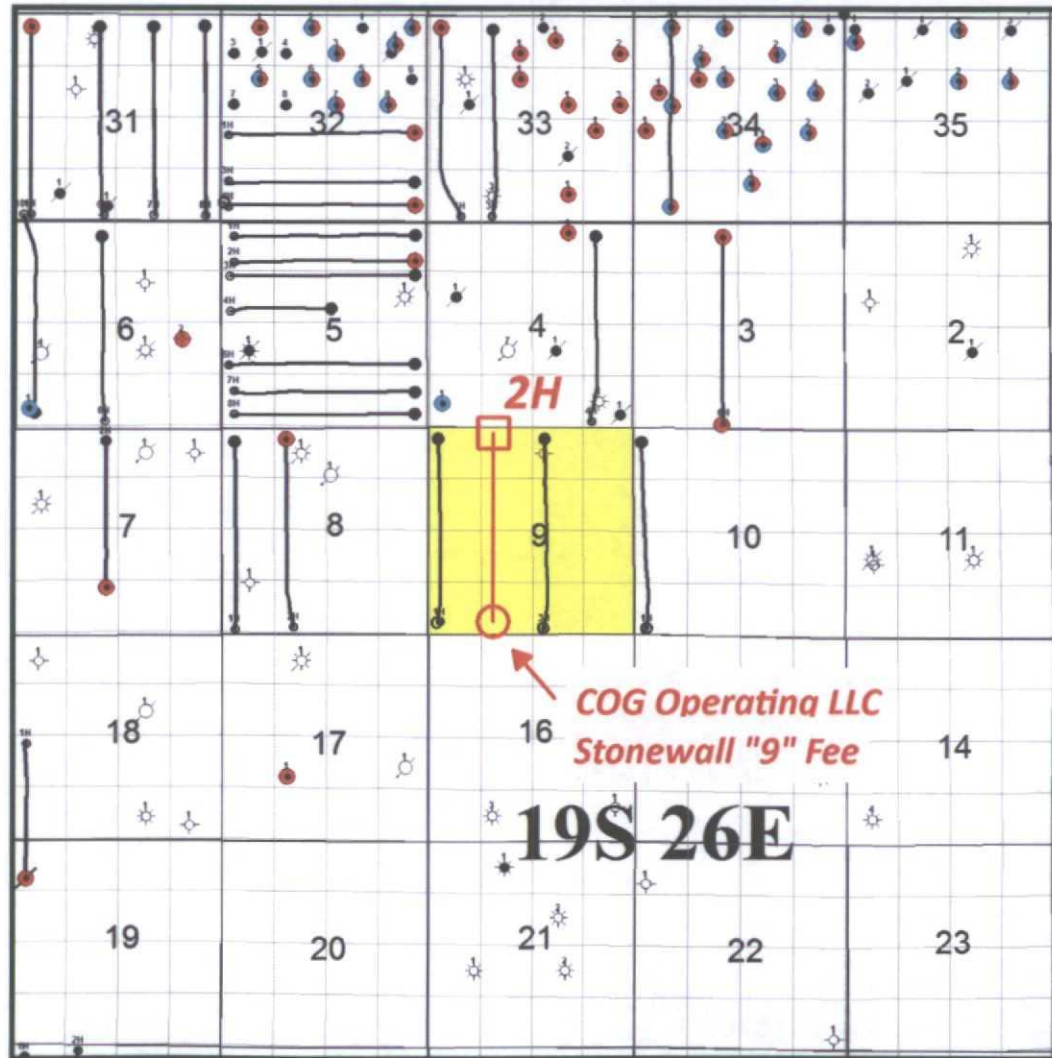

Lakewood Area – Stonewall “9” Fee #2H Lease Map



Map Legend

-  Paddock Producer
-  Blinebry Producer
- BHL  COG - Horizontal Location (Stonewall “9” Fee #2H)
- SHL 



Concho Acreage



BEFORE THE OIL CONVERSION
DIVISION
Santa Fe, New Mexico
Exhibit No. 1
Submitted by: COG OPERATING LLC
Hearing Date: April 30, 2014