

**COG OPERATING LLC  
SHERMAN "4" FEE #2H  
HEARING  
30-015-42204**

**Lakewood Area - Eddy County, New Mexico**

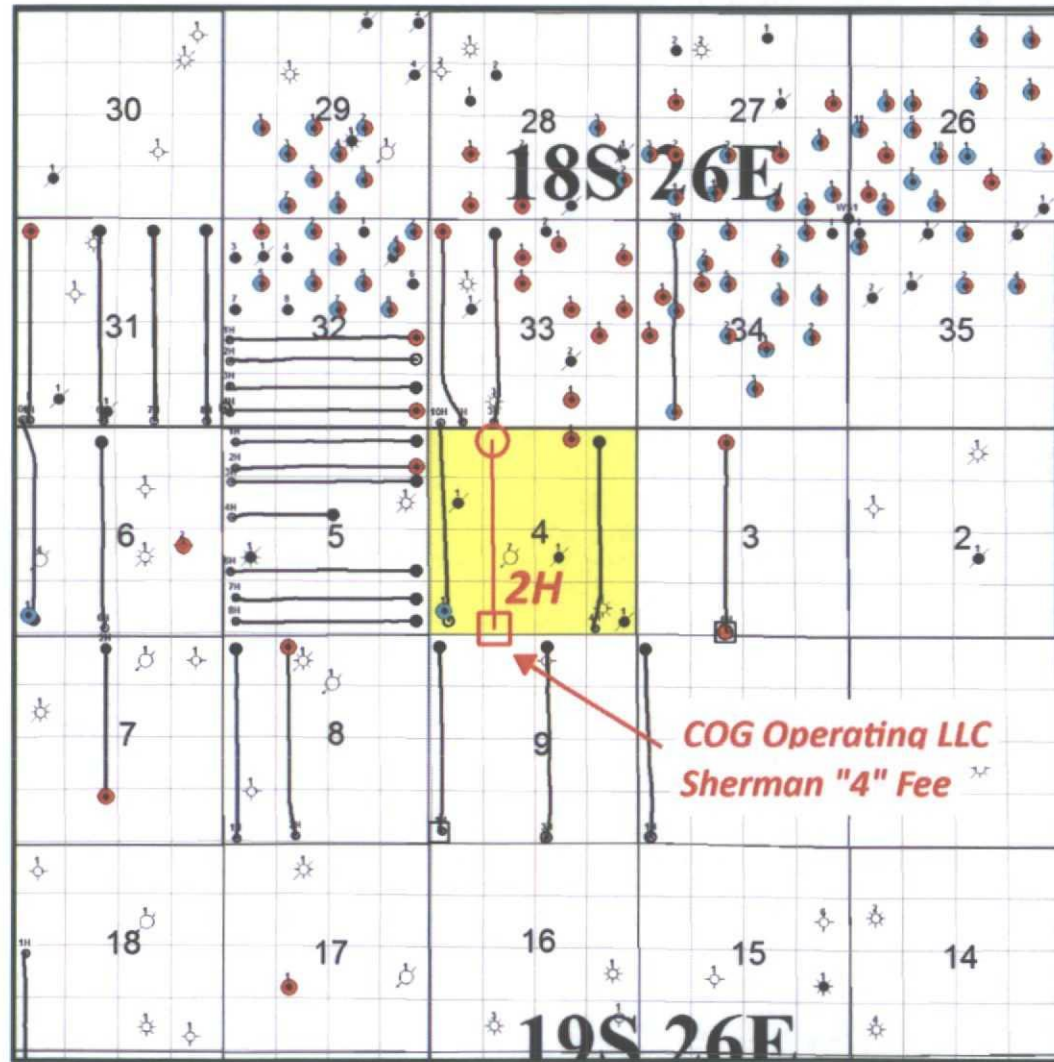

# Lakewood Area – Sherman “4” Fee #2H Lease Map



## Map Legend

- Paddock Producer
- Blinebry Producer

- BHL ○ COG - Horizontal Location (Sherman “4” Fee #2H)
- SHL □

Concho Acreage

