

NOTE TO FILE

Case No. 12822

By Michael E. Stogner, Examiner *ms*

May 8, 2002

The attached "Notice of Intention to Drill a New Well" is a copy of the only official record on this well. This is made a part of this case and is not to be removed by order of the Examiner. Thank you.

NEW MEXICO STATE LAND OFFICE
SANTA FE, NEW MEXICO

DEPARTMENT OF THE STATE GEOLOGIST
NEW MEXICO SCHOOL OF MINES
SOCORRO, NEW MEXICO

NOTICE OF INTENTION TO DRILL NEW WELL

Notice must be given to the State Geologist or to the proper Oil and Gas Inspector and approval obtained before drilling begins. If changes in the proposed plan are considered advisable a copy of this notice showing such changes will be returned to the sender. Submit this notice in duplicate.

Mr. Galla, E. H. Farmington, 5495555555555555 N. Mex., 9/29/ 1925

State Geologist,
Socorro, N. Mex.

Dear Sir:

You are hereby notified that it is our intention to commence the drilling of a well to be known as Cross, Gould and Worlock Well No. three in of Sec. 15, T. 24 R. 13, east, N. M. P. M., San Juan Basin Oil Field, San Juan County County.

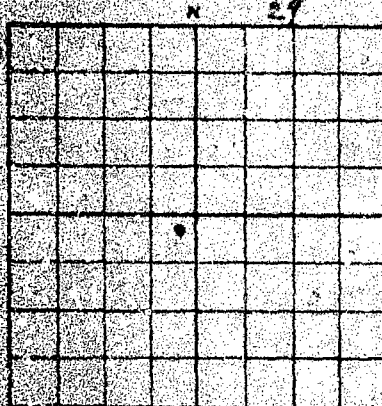

The well is 150 feet S. of line and 200 feet

W. of line of of Sec 15-24-13.

(Give location from section or other legal subdivision lines. Cross out wrong directions.)

If state land the oil and gas lease is No. 55555555
Assignment No. 5555555555

If patented land the owner is Foster Blanklock
Address Farmington, New Mexico

The lessee is Cross, Gould and Worlock Address Farmington, New Mexico

The elevation of the derrick floor above sea level is 5280 feet. We propose to drill well with No. 5 Acystone machine.

MARK OF DRILL

We propose to use the following strings of casing and to land or cement them as indicated.

SIZE OF CASING	WEIGHT PER FOOT	NEW OR SECOND HAND	DEPTH	LANDED OR CEMENTED
12-8 & 6	46- 28 & 18	second hand,	between 300 & 500 feet,	do not know as yet.

If changes in the above plan become advisable we will notify you before cementing or landing casing. We estimate that the first productive oil or gas sand should occur at a depth of about 370 feet.

Additional information: This well was spudded in on the day of August 1925, and we have used 18 feet of 12 inch casing, and put in about 90 feet of 8 inch casing which has been pulled and we are now running 6 inch casing, the well at this date is 267 feet.

Approved E. H. Galla 1925

Except as follows:

Sincerely yours,

Cross, Gould and Worlock
COMPANY OR OPERATOR.

By E. H. Galla

Position Manager

Send communications regarding well to

Name Cross, Gould and Worlock

Address Farmington, N. M.

E. H. Galla

STATE GEOLOGIST OR OIL AND GAS INSPECTOR

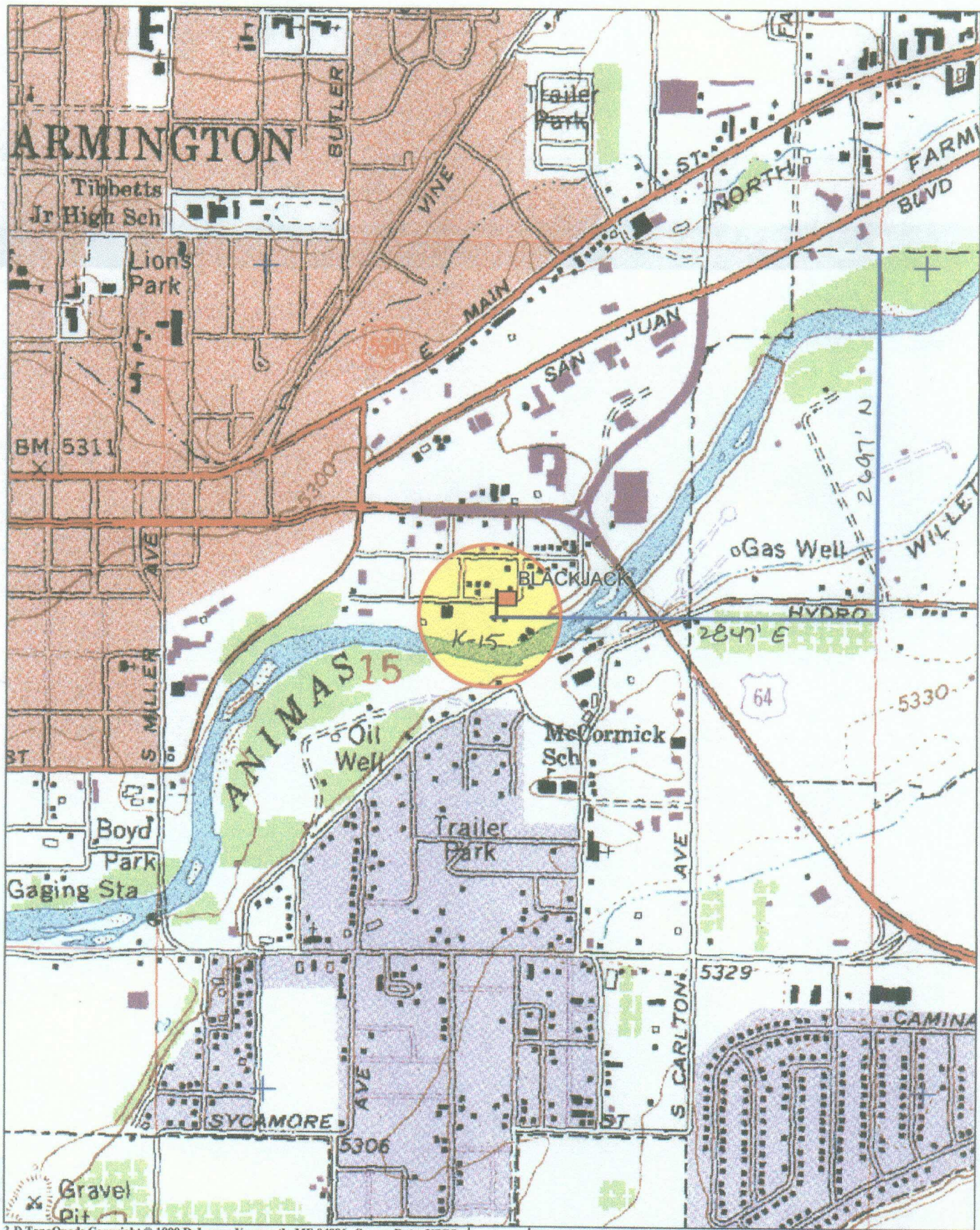

3-D TopoQuads Copyright © 1999 DeLorme Yarmouth, ME 04096 Source Data: USGS

450 ft Scale: 1 : 11,200 Detail: 13-4 Datum: WGS84

36.726256689

108.19427380875

2697 FNL
2847 FEL

K-15-29-13