

STATE OF NEW MEXICO  
ENERGY, MINERALS AND NATURAL RESOURCES DEPARTMENT  
OIL CONSERVATION DIVISION

APPLICATION OF CIMAREX ENERGY CO.  
FOR A NON-STANDARD OIL SPACING AND  
PRORATION UNIT AND FOR COMPULSORY  
POOLING, CHAVES COUNTY, NEW MEXICO.

Case No. 14,408

AFFIDAVIT OF LEE CATALANO

COUNTY OF MIDLAND            )  
  ) ss.  
STATE OF TEXAS                )

Lee Catalano, being duly sworn upon his oath, deposes and states:

1. I am over the age of 18, and have personal knowledge of the matters stated herein.
2. I am a geologist for Cimarex Energy Co. ("Cimarex").
3. Exhibit A is a structure map on top of the Hueco (Wolfcamp) formation. The formation dips gently to the southeast. Exhibit A also contains production data from existing wells in the pool.
4. Exhibit B is a cross section which shows the productive interval and stratigraphic target for horizontal Abo/Wolfcamp wells in the area.
5. Attached as Exhibit C is the horizontal drilling plan for the subject well. A horizontal wellbore will test a greater reservoir length, increasing the chances for an economic completion.
6. All four quarter-quarter sections in the well unit are prospective in the Abo/Wolfcamp formation, and Cimarex anticipates producing reserves from each quarter-quarter section.

  
\_\_\_\_\_  
Lee Catalano

SUBSCRIBED AND SWORN TO before me this 20<sup>th</sup> day of January, 2010 by Lee Catalano.

My Commission Expires: 4/22/2013

  
\_\_\_\_\_  
Notary Public

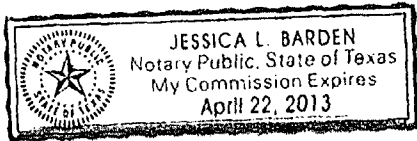

Oil Conservation Division  
Case No. 2  
Exhibit No. 2



North  
A

ELEV. 4871.471  
28079

MARSHALL & WINSTON INCORPORATED  
COMP. DATE: 3/18/2009  
MEDLIN 8 FEDERAL COM

TUSAS 214 SA  
680 PSL 330 FWL

28037

CIMAREX ENERGY OF CO  
FRANKLIN 18 FEE  
3

TUSAS 214 18  
330 PSL 224 FWL

ELEV. 4874.489  
28034

CIMAREX ENERGY OF COLORADO  
COMP. DATE: 9/19/2004  
MIDWAY 17 FEDERAL

TUSAS 201E 8T  
1860 PSL 330 FWL

ELEV. 4871.432  
28034

CIMAREX ENERGY OF CO  
FRANKLIN 18 FEDERAL COM

TUSAS 214 18  
330 PSL 310 FWL

South  
A'

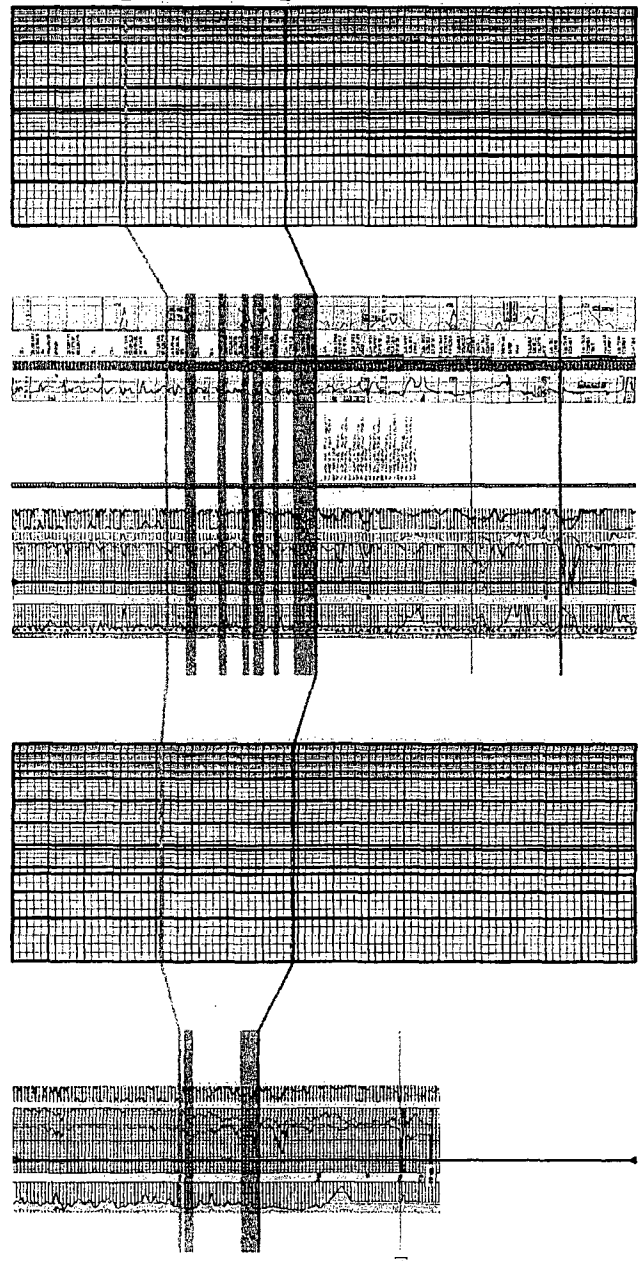

BASE ANHYDRITE (LEC)  
Stredigapuz Target  
L. Abo Fly Interval  
HUECO (WOLF CAMP) (LEC)

X\_MKR (LEC)

EXHIBIT **B**

CIMAREX ENERGY  
Caprock Area  
Lower Abo/Wolfcamp  
Struct X-Section  
Chaves Co., NM

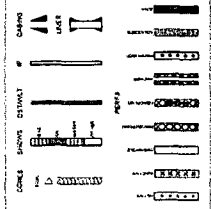

Franklin 18 Lease

By: Lisa Calhoun  
January 2008 11:17 AM

DISTRICT I  
1026 N. French Dr., Hobbs, NM 88240

DISTRICT II  
1301 V. Grand Avenue, Artesia, NM 88210

DISTRICT III  
1000 Rio Brazos Rd., Aztec, NM 87410

DISTRICT IV  
1020 E. St. Francis Dr., Santa Fe, NM 87505

State of New Mexico  
Energy, Minerals and Natural Resources Department

Form C-102  
Revised October 12, 2009

Submit to Appropriate District Office  
State Lease - 4 Copies  
Fee Lease - 3 Copies

**OIL CONSERVATION DIVISION**  
1220 South St. Francis Dr.  
Santa Fe, New Mexico 87505

**WELL LOCATION AND ACREAGE DEDICATION PLAT**

AMENDED REPORT

API Number <b>30-005-29099</b>	Pool Code <b>97722</b>	Pool Name <b>Abo Wildcat Abo-Wolfcamp</b>
Property Code <b>37761</b>	Property Name <b>VALLEY FORGE "20" STATE COM</b>	Well Number <b>1</b>
GRID No. <b>162683</b>	Operator Name <b>CIMAREX ENERGY CO. OF COLORADO</b>	Elevation <b>4417'</b>

**Surface Location**

UL of lot No.	Section	Township	Range	Lot Idn	Feet from the	North/South line	Feet from the	East/West line	County
P	20	15 S	31 E		375	SOUTH	375	EAST	CHAVES

**Bottom Hole Location If Different From Surface**

UL of lot No.	Section	Township	Range	Lot Idn	Feet from the	North/South line	Feet from the	East/West line	County
M	20	15 S	31 E		375	SOUTH	375	WEST	CHAVES
Dedicated Acres <b>160</b>	Joint or Infill	Consolidation Code <b>P</b>	Order No.						

NO ALLOWABLE WILL BE ASSIGNED TO THIS COMPLETION UNTIL ALL INTERESTS HAVE BEEN CONSOLIDATED OR A NON-STANDARD UNIT HAS BEEN APPROVED BY THE DIVISION

<p><b>BOTTOM HOLE LOCATION</b> Lat - N 32°59'42.92" Long - W 103°51'05.28" NAD-83 NAD-83 E 689075.567</p> <p><b>BHL</b> 375 FSL &amp; 375 FWL B1-041-0025</p>	<p><b>EOC</b> 374 FSL &amp; 571 FEL OG-5911-0002</p>	<p><b>SURFACE LOCATION</b> Lat - N 32°59'42.49" Long - W 103°50'11.96" NAD-83 NAD-83 E 693016.1</p> <p><b>SHL &amp; PP</b> 375 FSL &amp; 375 FEL OG-741-0005</p>	<p><b>OPERATOR CERTIFICATION</b></p> <p>I hereby certify that the information contained herein is true and complete to the best of my knowledge and belief, and that this organization either owns a working interest or undivided mineral interest in the land including the proposed bottom hole location pursuant to a contract with an owner of such a mineral or working interest, or is a voluntary pooling agreement or a compulsory pooling order as required by the division.</p> <p><i>Zeno Farris</i> 7/27/2009 Signature Date</p> <p>Zeno Farris Printed Name</p>
			<p><b>SURVEYOR CERTIFICATION</b></p> <p>I hereby certify that the well location shown on this plat was plotted from field notes of actual surveys made by me or under my supervision and that the same is true and correct to the best of my belief.</p> <p>Date Surveyed Signature Professional Surveyor 7977</p> <p>Certificate No. Cory L. Jones 7977</p> <p><b>BASIN SURVEYS</b></p>

EXHIBIT **C**



30-005-24099

# Cimarex Energy Co.

Location Chaves County, NM  
Field (Valley) Sec 20, T15S, R31E  
Facility Valley Forge 20 State Com #1H  
Well No. 1H  
Wellbore No. 1H PWB

**BAKER  
HUGHES**  
INTEQ

## Well Profile Data

Design Comment	MD (ft)	Inc (°)	Az (°)	TVD (ft)	Local N (ft)	Local E (ft)	DLS (7100ft)	VS (ft)
The On	0.00	0.000	269.772	0.00	0.00	0.00	0.00	0.00
EST. KOP	8650.00	0.000	269.772	8650.00	0.00	0.00	0.00	0.00
END OF CURVE	8654.65	91.396	269.772	8650.93	-0.78	-195.64	30.00	195.64
No. 1H P8HL	13311.18	91.396	269.772	8745.00	-18.09	-4540.83	0.00	4540.87

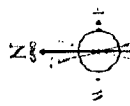
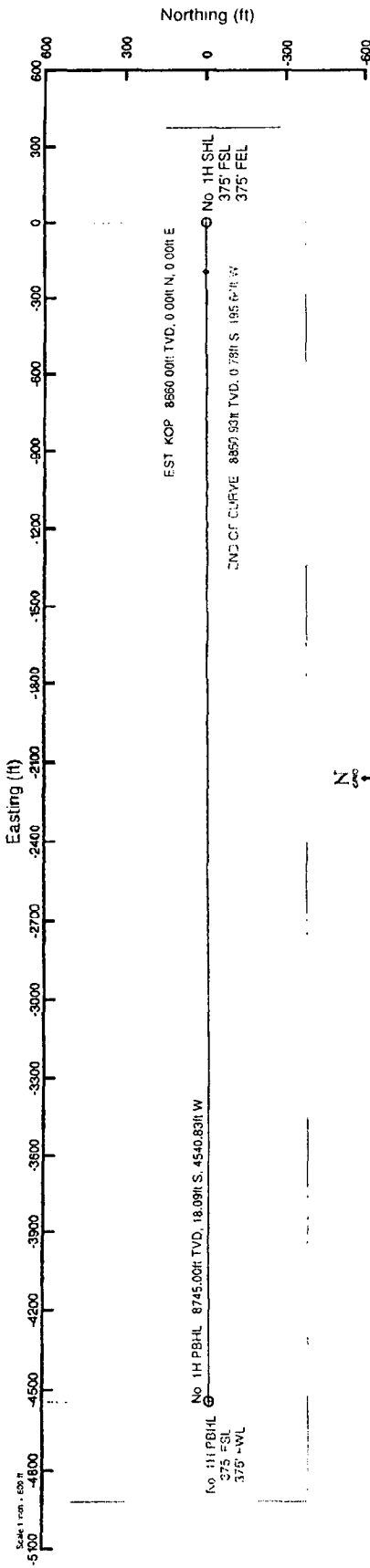

360 ft (113.06 m) from the top of the wellhead to the top of the casing head. The wellhead is located 360 ft (113.06 m) from the top of the wellhead to the top of the casing head. The wellhead is located 360 ft (113.06 m) from the top of the wellhead to the top of the casing head. The wellhead is located 360 ft (113.06 m) from the top of the wellhead to the top of the casing head.

Fig. reference: Wellbore Plan #1	0-1 System: NAD83/PA New Mexico State Survey, Zone 1800, 15B Merc
True vertical depth is referenced to Top of No. 1H SHL (PT)	North reference: Contours
Measured depth is referenced to Rig on No. 1H SHL (PT)	Scale: True distance
Rig on No. 1H SHL (PT) is above Sea Level 4477ft	Depth: sea level
Mean Sea Level is 4477ft above Valley Forge 20 State Com #1H	Checked by: Mike Hernandez on 03/28/25
Coordinates are all referenced to local datum	

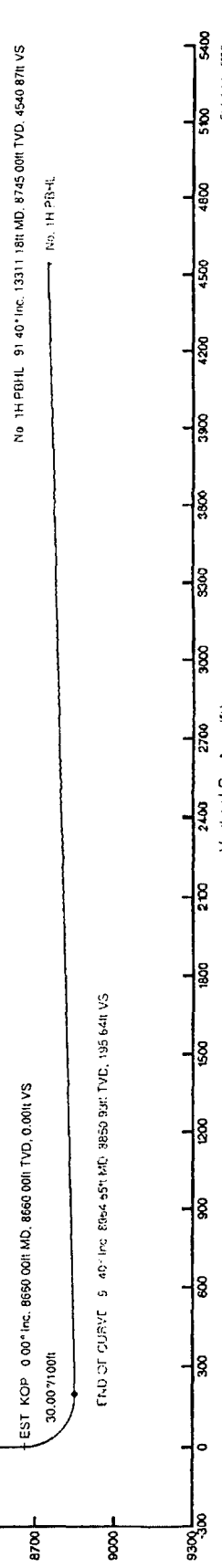

Vertical Section (ft)  
AZIMUTH 269.77° with reference 0 00 N, 0 00 E



# Planned Wellpath Report

Plan #1  
Page 1 of 4



## REFERENCE WELLPATH IDENTIFICATION

Operator	Cimarex Energy Co.	Slot	No. 1H SHL
Area	Chaves County, NM	Well	No. 1H
Field	(Valley) Sec 20, T15S, R31E	Wellbore	No. 1H PWB
Facility	Valley Forge 20 State Com #1H		

## REPORT SETUP INFORMATION

Projection System	NAD83 / TM New Mexico State Planes, Eastern Zone (3001), US feet	Software System	WellArchitect@ 2.0
North Reference	Grid	User	Victor Hernandez
Scale	0.999936	Report Generated	7/20/2009 at 2:33:16 PM
Convergence at slot	0.27° East	Database/Source file	WA_Midland/No. 1H_PWB.xml

## WELLPATH LOCATION

	Local coordinates		Grid coordinates		Geographic coordinates	
	North(ft)	East(ft)	Easting[USft]	Northing[USft]	Latitude	Longitude
Slot Location	0.00	0.00	693616.10	726126.50	32°59'42.492"N	103°50'11.963"W
Facility Reference Pt			693616.10	726126.50	32°59'42.492"N	103°50'11.963"W
Field Reference Pt			693616.10	726126.50	32°59'42.492"N	103°50'11.963"W

## WELLPATH DATUM

Calculation method	Minimum curvature	Rig on No. 1H SHL (RT) to Facility Vertical Datum	0.00ft
Horizontal Reference Pt	Facility Center	Rig on No. 1H SHL (RT) to Mean Sea Level	4417.00ft
Vertical Reference Pt	Rig on No. 1H SHL (RT)	Facility Vertical Datum to Mud Line (Facility)	0.00ft
MD Reference Pt	Rig on No. 1H SHL (RT)	Section Origin	N 0.00, E 0.00 ft
Field Vertical Reference	Mean Sea Level	Section Azimuth	269.77°

# Planned Wellpath Report

Plan #1  
Page 2 of 4



## REFERENCE WELL PATH IDENTIFICATION

Operator: Cimarex Energy Co. Slot: No. 1H SHL  
 Area: Chaves County, NM Well: No. 1H  
 Field: (Valley) Sec 20, T15S, R31E Wellbore: No. 1H PWB  
 Facility: Valley Forge 20 State Com #1H

## WELLPATH DATA (50 stations) † = interpolated/extrapolated station

MD (ft)	Inclination [°]	Azimuth [°]	TVD (ft)	Vert Sect (ft)	North (ft)	East (ft)	DLS (°/100ft)	Comments
0.00	0.000	269.772	0.00	0.00	0.00	0.00	0.00	Tie On
8660.00	0.000	269.772	8660.00	0.00	0.00	0.00	0.00	EST KOP
8760.00†	30.000	269.772	8755.49	25.59	-0.10	-25.59	30.00	
8860.00†	60.000	269.772	8825.40	95.49	-0.38	-95.49	30.00	
8960.00†	90.000	269.772	8850.99	190.99	0.76	-190.98	30.00	
8964.65	91.396	269.772	8850.93	195.64	-0.78	-195.64	30.00	END OF CURVE
9060.00†	91.396	269.772	8848.61	290.96	-1.16	-290.95	0.00	
9160.00†	91.396	269.772	8846.17	390.93	-1.56	-390.92	0.00	
9260.00†	91.396	269.772	8843.73	490.90	-1.96	-490.89	0.00	
9360.00†	91.396	269.772	8841.29	590.87	-2.35	-590.86	0.00	
9460.00†	91.396	269.772	8838.86	690.84	-2.75	-690.83	0.00	
9560.00†	91.396	269.772	8836.42	790.81	-3.15	-790.80	0.00	
9660.00†	91.396	269.772	8833.98	890.78	-3.55	-890.77	0.00	
9760.00†	91.396	269.772	8831.55	990.75	-3.95	-990.74	0.00	
9860.00†	91.396	269.772	8829.11	1090.72	-4.35	-1090.71	0.00	
9960.00†	91.396	269.772	8826.67	1190.69	-4.74	-1190.68	0.00	
10060.00†	91.396	269.772	8824.23	1290.66	-5.14	-1290.65	0.00	
10160.00†	91.396	269.772	8821.80	1390.63	-5.54	-1390.62	0.00	
10260.00†	91.396	269.772	8819.36	1490.60	-5.94	-1490.59	0.00	
10360.00†	91.396	269.772	8816.92	1590.57	-6.34	-1590.56	0.00	
10460.00†	91.396	269.772	8814.49	1690.54	-6.74	-1690.53	0.00	
10560.00†	91.396	269.772	8812.05	1790.51	-7.13	-1790.50	0.00	
10660.00†	91.396	269.772	8809.61	1890.48	-7.53	-1890.47	0.00	
10760.00†	91.396	269.772	8807.17	1990.45	-7.93	-1990.44	0.00	
10860.00†	91.396	269.772	8804.74	2090.42	-8.33	-2090.41	0.00	
10960.00†	91.396	269.772	8802.30	2190.39	-8.73	-2190.38	0.00	
11060.00†	91.396	269.772	8799.86	2290.36	-9.12	-2290.34	0.00	
11160.00†	91.396	269.772	8797.43	2390.33	-9.52	-2390.31	0.00	
11260.00†	91.396	269.772	8794.99	2490.30	-9.92	-2490.28	0.00	
11360.00†	91.396	269.772	8792.55	2590.27	-10.32	-2590.25	0.00	



# Planned Wellpath Report

Plan #1  
Page 3 of 4



INTEQ

## REFERENCE WELLPATH IDENTIFICATION

Operator: Cimarex Energy Co. Slot: No. 1H SHL  
 Area: Chaves County, NM Well: No. 1H  
 Field: (Valley) Sec 20, T15S, R31E Wellbore: No. 1H PWB  
 Facility: Valley Forge 20 State Com #1H

## WELLPATH DATA (50 stations) † = interpolated/extrapolated station

MD (ft)	Inclination (°)	Azimuth (°)	TVD (ft)	Vert Sect (ft)	North (ft)	East (ft)	DLS (ft/100ft)	Comments
11460.00†	91.396	269.772	8790.12	2690.24	-10.72	-2690.22	0.00	
11560.00†	91.396	269.772	8787.68	2790.21	-11.12	-2790.19	0.00	
11660.00†	91.396	269.772	8785.24	2890.18	-11.51	-2890.16	0.00	
11760.00†	91.396	269.772	8782.80	2990.16	-11.91	-2990.13	0.00	
11860.00†	91.396	269.772	8780.37	3090.13	-12.31	-3090.10	0.00	
11960.00†	91.396	269.772	8777.93	3190.10	-12.71	-3190.07	0.00	
12060.00†	91.396	269.772	8775.49	3290.07	-13.11	-3290.04	0.00	
12160.00†	91.396	269.772	8773.06	3390.04	-13.51	-3390.01	0.00	
12260.00†	91.396	269.772	8770.62	3490.01	-13.90	-3489.98	0.00	
12360.00†	91.396	269.772	8768.18	3589.98	-14.30	-3589.95	0.00	
12460.00†	91.396	269.772	8765.74	3689.95	-14.70	-3689.92	0.00	
12560.00†	91.396	269.772	8763.31	3789.92	-15.10	-3789.89	0.00	
12660.00†	91.396	269.772	8760.87	3889.89	-15.50	-3889.86	0.00	
12760.00†	91.396	269.772	8758.43	3989.86	-15.90	-3989.83	0.00	
12860.00†	91.396	269.772	8756.00	4089.83	-16.29	-4089.80	0.00	
12960.00†	91.396	269.772	8753.56	4189.80	-16.69	-4189.77	0.00	
13060.00†	91.396	269.772	8751.12	4289.77	-17.09	-4289.74	0.00	
13160.00†	91.396	269.772	8748.68	4389.74	-17.49	-4389.70	0.00	
13260.00†	91.396	269.772	8746.25	4489.71	-17.89	-4489.67	0.00	
13317.18	91.396	269.772	8745.00†	4540.87	-18.09	-4540.83	0.00	No. 1H PWB





# Planned Wellpath Report

Plan #1  
Page 4 of 4



## REFERENCE WELLPATH IDENTIFICATION

Operator	Cimarex Energy Co.	Slot	No. 1H SHL
Area	Chaves County, NM	Well	No. 1H
Field	(Valley) Sec 20, T15S, R31E	Wellbore	No. 1H PWB
Facility	Valley Forge 20 State Com #1H		

## TARGETS

Name	MD (ft)	TVD (ft)	North (ft)	East (ft)	Grid East (srv ft)	Grid North (srv ft)	Latitude	Longitude	Shape
1) No. 1H PBHL	13311.18	8745.00	-18.09	-4540.83	689075.57	726108.41	32°59'42.522"N	103°51'05.277"W	point

## SURVEY PROGRAM Ref Wellbore: No. 1H PWB Ref Wellpath: Plan #1

Start MD (ft)	End MD (ft)	Positional Uncertainty Model	Log Name/Comment
0.00	13311.18	NaviTrak (Standard)	Wellbore No. 1H PWB

PROPOSED WELLPATH REPORT (CSV version)  
 Prepared by Baker Hughes INTEQ  
 Software System: WellArchitect@2.0

REFERENCE WELLPATH IDENTIFICATION

**Operator** Cimarex Energy Co.  
 Area Chaves County, NM  
 Field (Valley) Sec 20, T15S, R31E  
**Facility** Valley Forge 20 State Com #1H  
 Slot No. 1H SHL  
 Well No. 1H  
 Wellbore No. 1H PWB  
**Wellpath** Plan #1  
 Sidetrack (none)

REPORT SETUP INFORMATION

Projection : NAD83 / TM New Mexico State Planes, Eastern Zone (3001), US feet  
 North Refe Grid  
 Scale 0.999936  
 Convergen 0.27° East  
 Software S WellArchitect@  
 User Victor Hernandez  
 Report Ger 7/20/2009 at 2:33:04 PM  
 DataBase:\ WA\_Midland\ev112113.xml

WELLPAT	Local North [ft]	Local East [ft]	Grid East [ft]	Grid North [ft]	Latitude	Longitude
Slot Locatic	0	0	693616.1	726126.5	32°59'42.4"	103°50'11.963"W
Facility Ref			693616.1	726126.5	32°59'42.4"	103°50'11.963"W
Field Refer			693616.1	726126.5	32°59'42.4"	103°50'11.963"W

WELLPATH DATUM

Calculation Minimum curvature  
 Horizontal I Facility Center  
 Vertical Re Rig on No. 1H SHL (RT)  
 MD Refere Rig on No. 1H SHL (RT)  
 Field Vertic Mean Sea Level

**Rig on No. 0.00ft**  
**Rig on No. 4417.00ft**

Facility Ver 0.00ft  
 Section Ori 0.00ft  
 Section Ori 0.00ft  
 Section Azi 269.77°

WELLPATH DATA Wellbore: No. 1H PWB Wellpath: Plan #1 † = interpolated/extrapolated

MD [ft]	Inclination [°]	Azimuth [°]	TVD [ft]	Vert Sect [ft]	North [ft]	East [ft]	Grid East [srv ft]
0	0	269.772	0	0	0	0	0 693616.1
<b>8660</b>	<b>0</b>	<b>269.772</b>	<b>8660</b>	<b>0</b>	<b>0</b>	<b>0</b>	<b>0 693616.1</b>
† 8760	30	269.772	8755.49	25.59	-0.1	-25.59	693590.5

†	8860	60	269.772	8825.4	95.49	-0.38	-95.49	693520.6
†	8960	90	269.772	8850.99	190.99	-0.76	-190.98	693425.1
	<b>8964.65</b>	<b>91.396</b>	<b>269.772</b>	<b>8850.93</b>	<b>195.64</b>	<b>-0.78</b>	<b>-195.64</b>	<b>693420.5</b>
†	9060	91.396	269.772	8848.61	290.96	-1.16	-290.95	693325.2
†	9160	91.396	269.772	8846.17	390.93	-1.56	-390.92	693225.2
†	9260	91.396	269.772	8843.73	490.9	-1.96	-490.89	693125.2
†	9360	91.396	269.772	8841.29	590.87	-2.35	-590.86	693025.3
†	9460	91.396	269.772	8838.86	690.84	-2.75	-690.83	692925.3
†	9560	91.396	269.772	8836.42	790.81	-3.15	-790.8	692825.4
†	9660	91.396	269.772	8833.98	890.78	-3.55	-890.77	692725.4
†	9760	91.396	269.772	8831.55	990.75	-3.95	-990.74	692625.4
†	9860	91.396	269.772	8829.11	1090.72	-4.35	-1090.71	692525.5
†	9960	91.396	269.772	8826.67	1190.69	-4.74	-1190.68	692425.5
†	10060	91.396	269.772	8824.23	1290.66	-5.14	-1290.65	692325.5
†	10160	91.396	269.772	8821.8	1390.63	-5.54	-1390.62	692225.6
†	10260	91.396	269.772	8819.36	1490.6	-5.94	-1490.59	692125.6
†	10360	91.396	269.772	8816.92	1590.57	-6.34	-1590.56	692025.7
†	10460	91.396	269.772	8814.49	1690.54	-6.74	-1690.53	691925.7
†	10560	91.396	269.772	8812.05	1790.51	-7.13	-1790.5	691825.7
†	10660	91.396	269.772	8809.61	1890.48	-7.53	-1890.47	691725.8
†	10760	91.396	269.772	8807.17	1990.45	-7.93	-1990.44	691625.8
†	10860	91.396	269.772	8804.74	2090.42	-8.33	-2090.41	691525.8
†	10960	91.396	269.772	8802.3	2190.39	-8.73	-2190.38	691425.9
†	11060	91.396	269.772	8799.86	2290.36	-9.12	-2290.34	691325.9
†	11160	91.396	269.772	8797.43	2390.33	-9.52	-2390.31	691225.9
†	11260	91.396	269.772	8794.99	2490.3	-9.92	-2490.28	691126
†	11360	91.396	269.772	8792.55	2590.27	-10.32	-2590.25	691026
†	11460	91.396	269.772	8790.12	2690.24	-10.72	-2690.22	690926.1
†	11560	91.396	269.772	8787.68	2790.21	-11.12	-2790.19	690826.1
†	11660	91.396	269.772	8785.24	2890.18	-11.51	-2890.16	690726.1
†	11760	91.396	269.772	8782.8	2990.16	-11.91	-2990.13	690626.2
†	11860	91.396	269.772	8780.37	3090.13	-12.31	-3090.1	690526.2
†	11960	91.396	269.772	8777.93	3190.1	-12.71	-3190.07	690426.2
†	12060	91.396	269.772	8775.49	3290.07	-13.11	-3290.04	690326.3
†	12160	91.396	269.772	8773.06	3390.04	-13.51	-3390.01	690226.3
†	12260	91.396	269.772	8770.62	3490.01	-13.9	-3489.98	690126.4
†	12360	91.396	269.772	8768.18	3589.98	-14.3	-3589.95	690026.4
†	12460	91.396	269.772	8765.74	3689.95	-14.7	-3689.92	689926.4
†	12560	91.396	269.772	8763.31	3789.92	-15.1	-3789.89	689826.5
†	12660	91.396	269.772	8760.87	3889.89	-15.5	-3889.86	689726.5
†	12760	91.396	269.772	8758.43	3989.86	-15.9	-3989.83	689626.5
†	12860	91.396	269.772	8756	4089.83	-16.29	-4089.8	689526.6
†	12960	91.396	269.772	8753.56	4189.8	-16.69	-4189.77	689426.6
†	13060	91.396	269.772	8751.12	4289.77	-17.09	-4289.74	689326.7
†	13160	91.396	269.772	8748.68	4389.74	-17.49	-4389.7	689226.7
†	13260	91.396	269.772	8746.25	4489.71	-17.89	-4489.67	689126.7
	<b>13311.18</b>	<b>91.396</b>	<b>269.772</b>	<b>8745</b>	<b>4540.87</b>	<b>-18.09</b>	<b>-4540.83</b>	<b>689075.6</b>

#### TARGETS

Name	MD [ft]	TVD [ft]	North [ft]	East [ft]	Grid East [srv ft]	Grid North [srv ft]	Latitude	Longitude
(1) No. 1H	13311.18	8745	-18.09	-4540.83	689075.6	726108.4	32°59'42.5"	103°51'05.6"

SURVEY PROGRAM Ref Wellbore: No. 1H PWB Ref Wellpath: Plan #1

Start MD End MD Pos Unc M Log Name/ Wellbore

[ft]

[ft]

0 13311.18 NaviTrak (Standard) No. 1H PWB

station	Grid North	DLS	Comments
[srv ft]	[°/100ft]		
726126.5	0		Tie On
<b>726126.5</b>	<b>0</b>		<b>EST. KOP</b>
726126.4	30		

726126.1	30		
726125.7	30		
<b>726125.7</b>	<b>30</b>	<b>END OF CURVE</b>	
726125.3	0		
726124.9	0		
726124.5	0		
726124.2	0		
726123.8	0		
726123.4	0		
726123	0		
726122.6	0		
726122.2	0		
726121.8	0		
726121.4	0		
726121	0		
726120.6	0		
726120.2	0		
726119.8	0		
726119.4	0		
726119	0		
726118.6	0		
726118.2	0		
726117.8	0		
726117.4	0		
726117	0		
726116.6	0		
726116.2	0		
726115.8	0		
726115.4	0		
726115	0		
726114.6	0		
726114.2	0		
726113.8	0		
726113.4	0		
726113	0		
726112.6	0		
726112.2	0		
726111.8	0		
726111.4	0		
726111	0		
726110.6	0		
726110.2	0		
726109.8	0		
726109.4	0		
726109	0		
726108.6	0		
<b>726108.4</b>	<b>0</b>	<b>No. 1H PE</b>	<b>1</b>

Shape    Comment    Design Comments

point