

STATE OF NEW MEXICO
ENERGY, MINERALS AND NATURAL RESOURCES DEPARTMENT
OIL CONSERVATION DIVISION

IN THE MATTER OF THE HEARING CALLED
BY THE OIL CONSERVATION DIVISION FOR
THE PURPOSE OF CONSIDERING:

APPLICATION OF CIMAREX ENERGY CO. FOR
A NON-STANDARD OIL SPACING AND PRORATION
UNIT AND COMPULSORY POOLING, LEA COUNTY,
NEW MEXICO.

Case No. 14,469

VERIFIED STATEMENT OF MIKE WALLACE

Mike Wallace, being duly sworn upon his oath, deposes and states:

1. I am a landman for Cimarex Energy Co., and have personal knowledge of the matters stated herein.

2. Pursuant to Division Rule NMAC 19.15.4.12.A(1)(b), the following information is submitted in support of the application filed herein:

(a) No opposition to this application is expected because the mineral interest owners being pooled have simply not responded to well proposals or have not yet executed an operating agreement.

(b) A plat outlining the spacing unit being pooled is attached hereto as Exhibit A. Applicant seeks an order approving a 160-acre non-standard oil spacing and proration unit (project area) in the Bone Spring formation comprised of the N/2N/2 of Section 35, Township 19 South, Range 34 East, NMPM. Applicant further seeks the pooling of all mineral interests (i) from the surface to the top of the Bone Spring formation underlying the NE/4NE/4 of Section 35 to form a standard 40 acre oil spacing and proration unit, and (ii) the Bone Spring formation underlying the N/2N/2 of Section 35 to form a non-standard 160 acre oil spacing and proration unit (project area). The units are to be dedicated to the Mallon 35 Fed. Well No. 7, a horizontal well to be drilled at a surface location 660 feet from the north line and 330 feet from the east line, with a terminus 660 feet from the north line and 330 feet from the west line, of Section 35.

(c) The parties being pooled, their interests in the well unit, and their last known addresses, are as follows:

Oil Conservation Division
Case No. 1
Exhibit No. 1

Handwritten:
~~John P. Ridge~~
Lea BS

Pear Resources Attention: Alan Byars P.O. Box 11044 Midland, Texas 79702	3.125%
Fuel Products, Inc. Attention: Thomas M. Beall P.O. Box 3098 Midland, Texas 79702	3.125%
Hyde Oil and Gas Corporation Attention: Blair Hamburg Suite 1018 6300 Ridglea Place Fort Worth, Texas 76116	25%
Linn Energy Holdings, LLC Suite 5100 600 Travis Street Houston, Texas 77002	18.75%
Michael J. Moncrief 2008 Trust A Attention: Jerry Goodwin, CPA Suite 1030 777 Taylor Street Fort Worth, Texas 76102	2.083334%

Linn Energy Holdings, LLC is the successor-in-interest to the Merit Energy companies, having acquired its interest by an assignment recorded in March 2010.

(d) Copies of the proposal letter sent to the uncommitted mineral interest owners are attached hereto as Exhibit B. In addition, we have had telephone calls and e-mail correspondence with the parties.

(e) Cimarex Energy Co. has made a good faith effort to obtain the voluntary joinder of the uncommitted interest owners in the well.

(f) Pursuant to Division rules, applicant requests that a 200% risk charge be assessed against a non-consenting interest owner.

(g) The offset operators or lessees of the acreage surrounding the well unit are as follows:

- (i) SW $\frac{1}{4}$ SW $\frac{1}{4}$ of Section 25
Armstrong Energy Corporation

- (ii) W $\frac{1}{2}$ NW $\frac{1}{4}$ of Section 36
Rubicon Oil & Gas II, LP
- (iii) S $\frac{1}{2}$ N $\frac{1}{2}$ of Section 35
Cimarex Energy Co.
Parties being pooled
- (iv) E $\frac{1}{2}$ NE $\frac{1}{4}$ of Section 34
Cimarex Energy Co.
- (v) SE $\frac{1}{4}$ SE $\frac{1}{4}$ of Section 27
- (vi) S $\frac{1}{2}$ S $\frac{1}{2}$ of Section 26
Merit Energy Company, LLC
Linn Energy Holdings, LLC

(h) A copy of the Authority for Expenditure for the proposed well is attached hereto as Exhibit C. The drilling and completion costs set forth therein are fair and reasonable, and are comparable to those of other horizontal wells of this depth drilled in this area of Lea County.

(i) Overhead charges of \$6500/month for a drilling well, and \$650/month for a producing well, are requested. These rates are fair and reasonable, and are in line with rates charged by other operators in this area for wells of this depth. Cimarex Energy Co. requests that the rates be adjusted under the COPAS accounting procedure.

VERIFICATION

STATE OF TEXAS)
) ss.
COUNTY OF MIDLAND)

Mike Wallace, being duly sworn upon his oath, deposes and states that: He is a landman for Cimarex Energy Co.; he is authorized to make this verification on its behalf; he has read the foregoing statement, and knows the contents thereof; and the same is true and correct to the best of his knowledge, information, and belief.



Mike Wallace

SUBSCRIBED AND SWORN TO before me this 10th day of May, 2010 by Mike Wallace.

My Commission Expires September 26, 2012



Notary Public

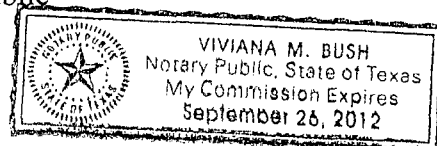

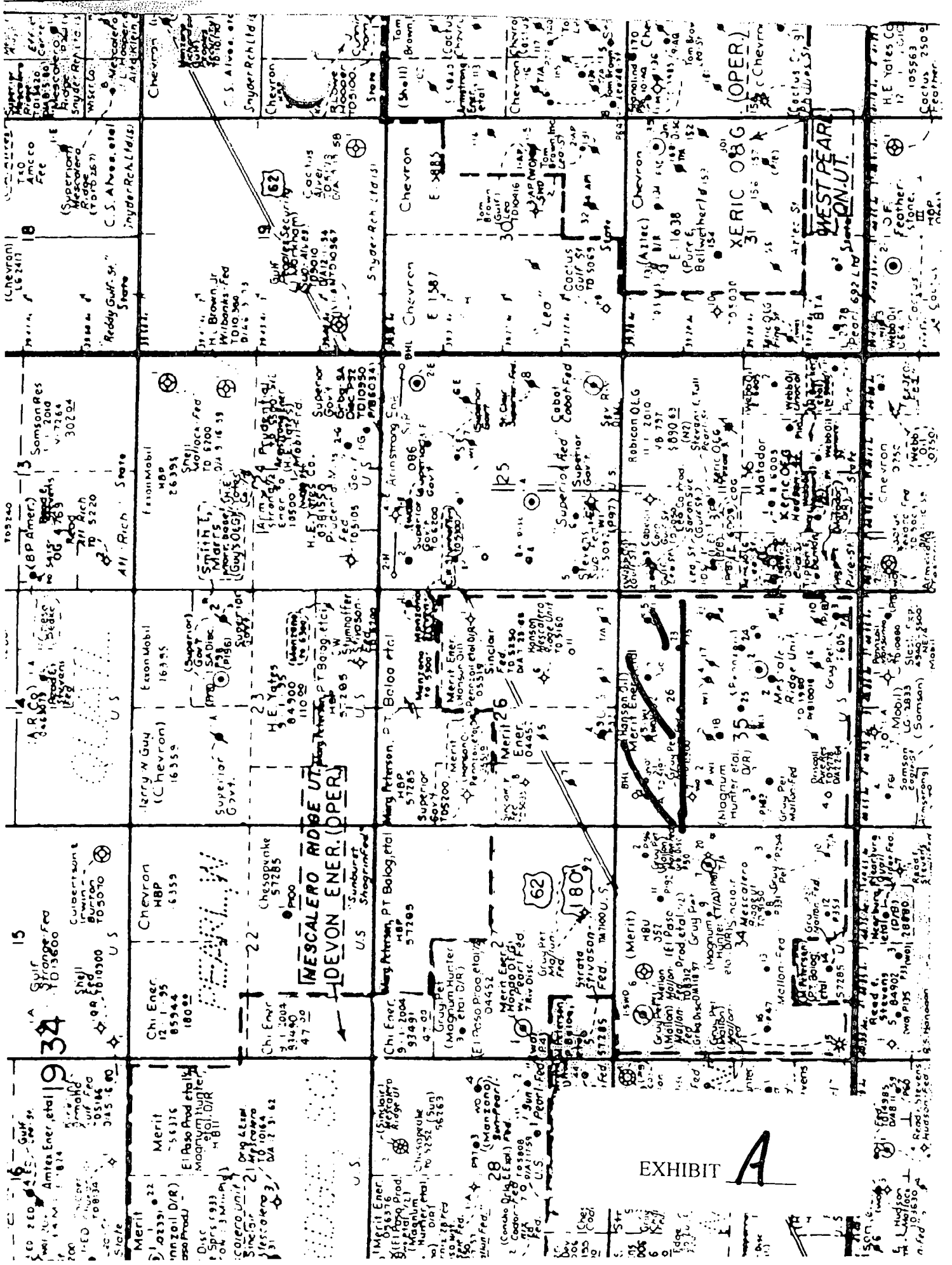

EXHIBIT

A

Cimarex Energy Co.
600 N. Marienfeld St.
Suite 600
Midland, Texas 79701
PHONE 432.571.7800

MJM 2008 JM A
W mm 6 Sir
(1)

James
PLEASE APPROVE
DEC 17 2009



December 10, 2009

Working Interest Owner Address List on Page 2

Re: **New Well Proposal-Mallon 35 Federal No. 7**
160-acre spacing unit (N/2N/2)
Section 35-T19S-R34E
Lea County, New Mexico

Dear Working Interest Owner:

Cimarex Energy Co. ("Cimarex"), on behalf of its wholly-owned subsidiary Magnum Hunter Production, Inc., proposes to drill the above-captioned well according to the project described in the enclosed Authorization for Expenditure ("AFE"). If you would like to participate in the drilling of the well, please sign, date and return one (1) copy of the AFE to the undersigned at the above-letterhead address. Also enclosed, for your review, is Cimarex' proposed form of Operating Agreement. A separate Operating Agreement of identical form will cover the spacing or proration unit dedicated to each individual well proposed herein.

Alternatively, if you do not want to participate, Cimarex would be interested in acquiring a farm-out of your working interest in the spacing or proration unit dedicated to the well. Cimarex would request delivery of a 75% net revenue interest lease, one (1) year primary term in which to spud an initial well and 180-day continuous development thereafter. Please contact me at your earliest convenience at (432) 571-7856 so that Cimarex can prepare accordingly. Thank you.

Sincerely,

Cimarex Energy Co.

Hayden P. Tresner
Hayden P. Tresner
Landman

W

EXHIBIT B

Working Interest Owner Address List
New Well Proposal-Mallon 35 Federal No. 7

Via: U.S. Certified Mail
Return Receipt No. 7007 0710 0003 0317 6817

Hyde Oil and Gas Corporation
Attn: Blair Hamburg
6300 Ridglea Place, Suite 1018
Fort Worth, Texas 76116

Via: U.S. Certified Mail
Return Receipt No. 7007 0710 0003 0317 6824

MGT Partners I, L.P., et al
Attn: Chris Heavner
13727 Noel Road, Suite 500
Dallas, Texas 75240

Via: U.S. Certified Mail
Return Receipt No. 7007 0710 0003 0317 6831

Pear Resources
Attn: Alan Byars
P.O. Box 11044
Midland, Texas 79702

Via: U.S. Certified Mail
Return Receipt No. 7007 0710 0003 0317 6855

Michael J. Moncrief 2008 Trust A
Attn: Jerry Goodwin, CPA
777 Taylor Street, Suite 1030
Fort Worth, Texas 76102

Via: U.S. Certified Mail
Return Receipt No. 7007 0710 0003 0317 6848

Fuel Products, Inc.
Attn: Thomas M. Beall
P.O. Box 3098
Midland, Texas 79702

January 15, 2010

Via Facsimile to: 432-571-7832

Via U. S. Mail to:

Cimarex Energy Co.
Attn: Mr. Hayden P. Tresner
600 N. Marlenfeld St. - Ste. 600
Midland, TX 79701

RE: New Well Proposals :

Mallon 35 Federal No. 4 (S/2S/2); AFE dated 12/15/2009 attached
Mallon 35 Federal No. 5 (N/2S/2); AFE dated 12/15/2009 attached
Mallon 35 Federal No. 6 (S/2N/2); AFE dated 12/15/2009 attached
Mallon 35 Federal No. 7 (N/2N/2); AFE dated 12/15/2009 attached
Section 35-T19S-R34E
Lea County, NM

Gentlemen:

Reference is made to your letters dated December 10, 2009 and received December 18th, 2009 by certified mail. Your proposal is problematic for several reasons.

It is not clear whether you are proposing under the existing Joint Operating Agreement (JOA) or under the unexecuted JOA that was included and referenced in your correspondence by even date. As the operator of the existing production in the lands and leases, it would seem that if Cimarex Energy Company (Cimarex) were interested in executing a new operating agreement or amending an existing JOA with the original partners in the existing wells within the leasehold estate, that business should precede proposal of the referenced wells. Since Cimarex has, by the referenced letters proposed these wells, the drilling of those wells will be governed by the existing JOA to the extent authorized. Execution of the attached JOA without clarification/ratification or abandonment of the existing JOA will certainly create a conflict between JOAs.

We object if Cimarex intends to drill the proposed four wells under an existing JOA as proposed. We do not believe that it is prudent to prosecute the drilling of four horizontal wells in a single section within the time constraints required under a single JOA with four proposals of even dates. None of these lands are in jeopardy of expiration nor are they being drained.

If there is no clear operating agreement embracing these lands, or any portion thereof, covering these proposals, or if a conflict exists between existing operating agreements, then these proposals being made are anticipating a forced pooling of the interests herein referenced. Those interests subject to the original JOA must have proper proposal/notification and the interests pooled must be so identified separately. We object to having our interest included in a forced pooling if it is subject to an existing JOA.

By this letter Fuel Products, Inc. and Pear Resources (FPI & PR) hereby request that Cimarex withdraw all of its proposals to FPI & PR until such clarification can be provided to FPI & PR in said lands. This will insure the validity of the proposals as to the interests in said wells. Failing in that action, Fuel Products, Inc. and Pear Resources, Inc. conditionally accept your proposal for drilling the captioned wells but subject to such clarification and the execution of all required documents necessary to satisfy the aforementioned exceptions.

FUEL PRODUCTS, INC.

By



Thomas M. Beall - President

PEAR RESOURCES

By



J.M. Gahr - Partner

Jerry D. Goodwin, CPA

777 Taylor Street, Suite 1030
Fort Worth, TX 76102

(817) 335-5656 (817) 378-9121

January 22, 2010

Cimarex Energy
Hayden P. Tresner, Landman
600 N. Marienfeld Street, Suite 600
Midland, TX 79701

Re: **New Well Proposal-Mallon 35 Federal No. 4**
New Well Proposal-Mallon 35 Federal No. 5
New Well Proposal-Mallon 35 Federal No. 6
New Well Proposal-Mallon 35 Federal No. 7

Michael J. Moncrief 2008 Trust A
Michael J. Moncrief, Trustee

The enclosed document has been executed per your instructions. If you have any questions regarding the enclosed, please contact me at (817) 335-5656.

Sincerely,



Connie D. McCulloch
Personal Assistant to Jerry Goodwin and
Michael J. Moncrief

Cimarex Energy Co.
600 N. Marienfeld St.
Suite 600
Midland, Texas 79701
PHONE 432.571.7800



April 23, 2010

Fuel Products, Inc.
P.O. Box 3098
Midland, TX 79702
Attn: Thomas M. Beall

Re: Operating Agreements
Mallon 35 Federal No. 4, 5, 6 & 7 Wells
Sec. 35-T19S-R34E
Lea County, New Mexico

Dear Mr. Beall:

As per our recent phone conversation, enclosed for your review and execution are the Operating Agreements for the Mallon 35 Federal No. 4, 5, 6 & 7 wells in Sec. 35-19S-34E, Lea Co., NM.

Please call if you have any questions or concerns regarding the enclosed agreements.

Respectfully,

A handwritten signature in black ink, appearing to read "Mike Wallace", with a long horizontal flourish extending to the right.

Mike Wallace
Landman
Phone: (432) 571-7873
Cell: (432) 301-4067
mwallace@cimarex.com

Cimarex Energy Co.
600 N. Marienfeld St.
Suite 600
Midland, Texas 79701
PHONE 432.571.7800



April 23, 2010

Pear Resources
P.O. Box 11044
Midland, TX 79702
Attn: Alan Byars

Re: Operating Agreements
Mallon 35 Federal No. 4, 5, 6 & 7 Wells
Sec. 35-T19S-R34E
Lea County, New Mexico

Dear Mr. Byars:

As per our recent phone conversation, enclosed for your review and execution are the Operating Agreements for the Mallon 35 Federal No. 4, 5, 6 & 7 wells in Sec. 35-19S-34E, Lea Co., NM.

Please call if you have any questions or concerns regarding the enclosed agreements.

Respectfully,

A handwritten signature in black ink, appearing to read "Mike Wallace". The signature is fluid and cursive, with a long horizontal stroke extending to the right.

Mike Wallace
Landman
Phone: (432) 571-7873
Cell: (432) 301-4067
mwallace@cimarex.com

Cimarex Energy Co.
600 N. Marienfeld St.
Suite 600
Midland, Texas 79701
PHONE 432.571.7800



April 26, 2010

Bankhead Administrative Accounting Trust
and Grace K. Bankhead
4201 Potomac
Dallas, Texas 75205

Re: Operating Agreements
Mallon 35 Federal No. 4 & 5 Wells
Sec. 35-T19S-R34E
Lea County, New Mexico

Dear Sir/Madam:

Enclosed for your review and execution are the Operating Agreements for the Mallon 35 Federal No. 4, 5, 6 & 7 wells in Sec. 35-19S-34E, Lea Co., NM.

Please call if you have any questions or concerns regarding the enclosed agreements.

Respectfully,

A handwritten signature in black ink, appearing to read "Mike Wallace", with a long, sweeping underline.

Mike Wallace
Landman
Phone: (432) 571-7873
Cell: (432) 301-4067
mwallace@cimarex.com

Cimarex Energy Co.
600 N. Marienfeld St.
Suite 600
Midland, Texas 79701
PHONE 432.571.7800



April 26, 2010

Janice Shelton Crebbs, Trustee of the First
Restatement of the Janice Shelton Crebbs
Trust Agreement, dated 2/17/2006
3769 N. Camino Leamaria
Tucson, Arizona 85716

Attn: Janice Shelton Crebbs

Re: Operating Agreements
Mallon 35 Federal No. 4 & 5 Wells
Sec. 35-T19S-R34E
Lea County, New Mexico

Dear Ms. Crebbs:

Enclosed for your review and execution are the Operating Agreements for the Mallon 35 Federal No. 4, 5, 6 & 7 wells in Sec. 35-19S-34E, Lea Co., NM.

Please call if you have any questions or concerns regarding the enclosed agreements.

Respectfully,

A handwritten signature in black ink, appearing to be "Mike Wallace", written over a horizontal line.

Mike Wallace
Landman
Phone: (432) 571-7873
Cell: (432) 301-4067
mwallace@cimarex.com

Cimarex Energy Co.
600 N. Marienfeld St.
Suite 600
Midland, Texas 79701
PHONE 432.571.7800



April 26, 2010

Robert W. Kent
1415 Louisiana Street, Suite 3100
Houston, Texas 77022-7353

Attn: Robert Kent

Re: *Operating Agreements*
Mallon 35 Federal No. 4 & 5 Wells
Sec. 35-T19S-R34E
Lea County, New Mexico

Dear Mr. Kent:

As per our recent phone conversation, enclosed for your review and execution are the Operating Agreements for the Mallon 35 Federal No. 4, 5, 6 & 7 wells in Sec. 35-19S-34E, Lea Co., NM.

Please call if you have any questions or concerns regarding the enclosed agreements.

Respectfully,

A handwritten signature in black ink, appearing to read "Mike Wallace". The signature is stylized with a long horizontal stroke extending to the right.

Mike Wallace
Landman
Phone: (432) 571-7873
Cell: (432) 301-4067
mwallace@cimarex.com

Cimarex Energy Co.
600 N. Marienfeld St.
Suite 600
Midland, Texas 79701
PHONE 432.571.7800



April 26, 2010

Hyde Oil and Gas Corporation
6300 Ridglea Place, Suite 1018
Fort Worth, Texas 76116

Attn: Blair Hamburg

Re: Operating Agreements
Mallon 35 Federal No. 4, 5, 6 & 7 Wells
Sec. 35-T19S-R34E
Lea County, New Mexico

Dear Ms. Hamburg:

Enclosed for your review and execution are the Operating Agreements for the Mallon 35 Federal No. 4, 5, 6 & 7 wells in Sec. 35-19S-34E, Lea Co., NM.

Please call if you have any questions or concerns regarding the enclosed agreements.

Respectfully,

A handwritten signature in black ink, appearing to read "Mike Wallace", with a long horizontal line extending to the right.

Mike Wallace
Landman
Phone: (432) 571-7873
Cell: (432) 301-4067
mwallace@cimarex.com

Cimarex Energy Co.
600 N. Marienfeld St.
Suite 600
Midland, Texas 79701
PHONE 432.571.7800



April 26, 2010

Michael J. Moncrief Grantor's Trust
777 Taylor Street, Suite 1030
Fort Worth, Texas 76102

Attn: Jerry Goodwin, CPA

Re: Operating Agreements
Mallon 35 Federal No. 4, 5, 6 & 7 Wells
Sec. 35-T19S-R34E
Lea County, New Mexico

Dear Mr. Goodwin:

Enclosed for your review and execution are the Operating Agreements for the Mallon 35 Federal No. 4, 5, 6 & 7 wells in Sec. 35-19S-34E, Lea Co., NM.

Please call if you have any questions or concerns regarding the enclosed agreements.

Respectfully,

A handwritten signature in black ink, appearing to read "Mike Wallace". The signature is fluid and cursive, with a long horizontal stroke extending to the right.

Mike Wallace
Landman
Phone: (432) 571-7873
Cell: (432) 301-4067
mwallace@cimarex.com

Cimarex Energy Co.
600 N. Marienfeld St.
Suite 600
Midland, Texas 79701
PHONE 432.571.7800



April 23, 2010

Sundown Energy, LP
Two Galleria Tower
13455 Noel Road, Suite 2000
Dallas, Texas 75240
Attn: Adam McCauley

Re: Operating Agreements
Mallon 35 Federal No. 4, 5, 6 & 7 Wells
Sec. 35-T19S-R34E
Lea County, New Mexico

Dear Mr. McCauley:

As per our recent phone conversation, enclosed for your review and execution are the Operating Agreements for the Mallon 35 Federal No. 4, 5, 6 & 7 wells in Sec. 35-19S-34E, Lea Co., NM.

Please call if you have any questions or concerns regarding the enclosed agreements.

Respectfully,

A handwritten signature in black ink, appearing to read "Mike Wallace", with a long horizontal flourish extending to the right.

Mike Wallace
Landman
Phone: (432) 571-7873
Cell: (432) 301-4067
mwallace@cimarex.com

Cimarex Energy Co.
600 N. Marienfeld St.
Suite 600
Midland, Texas 79701
PHONE 432.571.7800



April 26, 2010

Linn Energy Holdings, LLC
600 Travis Street, Suite 5100
Houston, Texas 77002

Attn: Glen Moulden

Re: Operating Agreements
Mallon 35 Federal No. 4, 5, 6 & 7 Wells
Sec. 35-T19S-R34E
Lea County, New Mexico

Dear Mr. Moulden:

Enclosed for your review and execution are the Operating Agreements for the Mallon 35 Federal No. 4, 5, 6 & 7 wells in Sec. 35-19S-34E, Lea Co., NM.

Please call if you have any questions or concerns regarding the enclosed agreements.

Respectfully,

A handwritten signature in black ink, appearing to be "Mike Wallace", written over a horizontal line.

Mike Wallace
Landman
Phone: (432) 571-7873
Cell: (432) 301-4067
mwallace@cimarex.com



Authorization For Expenditure

Company Entity: Cimarex Energy Co. Date Prepared: December 10, 2009

Region	Well Name	Well No.	Prospect or Field Name	Property Number	Drilling AFE No.
Permian	Mallon 35 Federal	7	Quail Ridge		

Location	County	State	Type Well			
SHL: 660 FNL & 330 FEL Section 35-T19S-R34E BHL: 660 FNL & 330 FWL Section 35-T19S-R34E	Lea	NM	Oil	X	Expl	X
			Gas		Prod	

Estimate Type	Est. Start Date	Est. Comp. Date	Formation	Ttl Measured Depth
Original Estimate <input checked="" type="radio"/>			Bone Spring	15,100'
Revised Estimate <input type="radio"/>				Ttl Vertical Depth
Supplemental Estimate <input type="radio"/>				10,850'

Project Description
Drill and complete a Bone spring horizontal well (4500' vs 12 stages). Open hole packer system. 11200' Pilot hole.

Intangibles	Dry Hole Cost	After Casing Point	Completed Well Cost
Drilling Costs	\$1,516,850		\$1,516,850
Completion Costs		\$1,252,250	\$1,252,250
Total Intangible Costs	\$1,516,850	\$1,252,250	\$2,769,100

Tangibles			
Well Equipment	\$94,000	\$1,049,462	\$1,143,462
Lease Equipment		\$147,500	\$147,500
Total Tangible Well Cost	\$94,000	\$1,196,962	\$1,290,962

Plug and Abandon Cost	\$150,000	-\$150,000	\$0
-----------------------	-----------	------------	-----

Total Well Cost	\$1,760,850	\$2,299,212	\$4,060,062
------------------------	--------------------	--------------------	--------------------

Comments on Well Costs
1. All tubulars, well or lease equipment is priced by COPAS and CEPS guidelines using the Historic Price Multiplier.

Well Control Insurance
Unless otherwise indicated below, you, as a non-operating working interest owner, agree to be covered by Operator's well control insurance procured by Operator so long as Operator conducts operations hereunder and to pay your prorated share of the premiums therefore. If you elect to purchase your own well control insurance, you must provide a certificate of such insurance acceptable to Operator, as to form and limits, at the time this AFE is returned, if available, but in no event later than commencement of drilling operations. You agree that failure to provide the certificate of insurance, as provided herein, will result in your being covered by insurance procured by Operator.
 I elect to purchase my own well control insurance policy.
Well control Insurance procured by Operator, provides, among other terms, for \$20,000,000 (100% W.I.) of Combined Single Limit coverage for well control and related redrilling and clean-up/pollution expense covering drilling (through completion) with a \$1,000,000 (100% W.I.) deductible.

Comments on AFE
The above costs are estimates only and anticipate trouble free operations without any foreseeable change in plans. The actual costs may exceed the estimated costs without affecting the authorization for expenditure herein granted. By approval of this AFE, the working interest owner agrees to pay its proportionate share of actual legal, curative, regulatory and well costs under term of the joint operating agreement, regulatory order or other applicable agreement covering this well.

Cimarex Energy Co. Approval

Prepared by	Drilling and Completion Manager	Regional Manager

Joint Interest Approval

Company	By	Date
Michael J. Moncrief 2008 Trust A		

EXHIBIT **C**



Project Cost Estimate

Lease Name: Mallon 35 Federal

Well No.: 7

Intangibles	Codes	Dry Hole Cost	Codes	After Casing Point	Completed Well Cost
Roads & Location Preparation / Restoration	DICC.100	\$35,000	DICC.100	\$3,000	\$38,000
Damages	DICC.105	\$10,000	DICC.105		\$10,000
Mud / Fluids Disposal Charges	DICC.105	\$67,000	DICC.105	\$65,625	\$132,625
Day Rate	DICC.135	\$443,000	DICC.135	\$60,000	\$503,000
Misc Preparation Cost (mouse hole, rat hole, pads, pile clusters, misc.)	DICC.120	\$5,000			\$5,000
Bits	DICC.135	\$50,700	DICC.135	\$1,000	\$51,700
Fuel	DICC.135	\$73,000	DICC.135	\$1,000	\$74,000
Water / Completion Fluids	DICC.140	\$36,750	DICC.135	\$85,625	\$122,375
Mud & Additives	DICC.145	\$63,000			\$63,000
Surface Rentals	DICC.150	\$39,000	DICC.150	\$87,000	\$126,000
Downhole Rentals	DICC.155	\$102,000	DICC.155	\$11,000	\$113,000
Formation Evaluation (DST, Coring including evaluation, G&G Services)	DICC.160				\$0
Mud Logging	DICC.170	\$30,000			\$30,000
Open Hole Logging	DICC.180	\$40,000			\$40,000
Cementing & Float Equipment	DICC.185	\$35,000	DICC.185	\$35,000	\$70,000
Tubular Inspections	DICC.190	\$5,000	DICC.190	\$3,000	\$8,000
Casing Crews	DICC.195	\$13,000	DICC.195	\$16,000	\$29,000
Extra Labor, Welding, Etc.	DICC.200	\$11,000	DICC.200	\$5,000	\$16,000
Land Transportation (Trucking)	DICC.205	\$22,000	DICC.205	\$4,000	\$26,000
Supervision	DICC.210	\$47,000	DICC.210	\$19,000	\$66,000
Trailer House / Camp / Catering	DICC.215	\$21,000	DICC.215	\$4,000	\$25,000
Other Misc Expenses	DICC.220	\$2,000	DICC.220	\$7,000	\$9,000
Overhead	DICC.225	\$13,000	DICC.225	\$3,000	\$16,000
Remedial Cementing	DICC.230		DICC.230		\$0
MOB/DEMOB	DICC.240	\$40,000			\$40,000
Directional Drilling Services	DICC.245	\$147,000			\$147,000
Dock, Dispatcher, Crane	DICC.250		DICC.250		\$0
Marine & Air Transportation	DICC.255		DICC.255		\$0
Solids Control	DICC.260	\$48,400			\$48,400
Well Control Equip (Snubbing Svcs.)	DICC.265	\$28,000	DICC.265	\$11,000	\$39,000
Fishing & Sidetrack Operations	DICC.270	\$0	DICC.270		\$0
Completion Rig	DICC.275		DICC.275	\$36,000	\$36,000
Coil Tubing	DICC.280		DICC.280	\$25,000	\$25,000
Completion Logging, Perforating, WL Units, WL Surveys	DICC.285		DICC.285	\$8,000	\$8,000
Stimulation	DICC.290		DICC.290	\$650,000	\$650,000
Legal / Regulatory / Curative	DICC.300	\$13,000	DICC.300		\$13,000
Well Control Insurance	DICC.305	\$5,000			\$5,000
Contingency	DICC.310	\$72,000	DICC.310	\$57,000	\$129,000
Construction For Well Equipment	DICC.315		DICC.315	\$25,000	\$25,000
Construction For Lease Equipment	DICC.320		DICC.320	\$30,000	\$30,000
Construction For Sales P/L	DICC.325		DICC.325		\$0
Total Intangible Cost		\$1,516,850		\$1,252,250	\$2,769,100

Tangible - Well Equipment	Size	Feet	\$ / Foot			
Casing						
Drive Pipe	20"	40.00	\$0.00	DWES.100	\$0	\$0
Conductor Pipe				DWES.100	\$0	\$0
Water String				DWES.105	\$0	\$0
Surface Casing	13-3/8"	340.00	\$48.26	DWES.110	\$16,000	\$16,000
Intermediate Casing	9 5/8"	1485.00	\$42.21	DWES.115	\$63,000	\$63,000
Drilling Liner				DWES.120	\$0	\$0
Drilling Liner				DWES.125	\$0	\$0
Production Casing or Liner	7"	11200.00	\$35.38	DWES.130	\$405,000	\$405,000
Production Tie-Back	4 1/2"	4600.00	\$15.97	DWES.135	\$73,462	\$73,462
Tubing	2 7/8"	10500.00	\$9.53	DWES.140	\$100,000	\$100,000
N/C Well Equipment						
Wellhead, Tree, Chokes				DWES.145	\$15,000	\$15,000
Liner Hanger, Isolation Packer				DWES.150	\$0	\$0
Packer, Nipples				DWES.155	\$65,000	\$65,000
Pumping Unit, Engine				DWES.160	\$1,000	\$1,000
Lift Equipment (BHP, Rods, Anchors)				DWES.165	\$140,000	\$140,000
Lift Equipment (BHP, Rods, Anchors)				DWES.170	\$85,000	\$85,000
Tangible - Lease Equipment						
N/C Lease Equipment						
Tanks, Tanks Steps, Stairs				DWES.175	\$7,500	\$7,500
Battery (Heater Treater, Separator, Gas Treating Equipment)				DWES.180	\$62,000	\$62,000
Flow Lines (Line Pipe from wellhead to central facility)				DWES.185	\$22,500	\$22,500
Offshore Production Structure for Facilities				DWES.190	\$5,500	\$5,500
Pipeline to Sales				DWES.195	\$0	\$0
Pipeline to Sales				DWES.200	\$50,000	\$50,000
Total Tangibles					\$94,000	\$1,196,962

P&A Costs	DICC.330	\$150,000	DICC.330	-\$150,000	\$0
Total Cost		\$1,760,850		\$2,299,212	\$4,060,062