

04/30/91
NMOC DIST IITA WELLS REPORT FORM 30
P.O. DRAWER DDPAGE 1
ARTESIA, NM 88210

***** OPERATOR: HARLE, CHARLES W.

===== POOL: BITTER LAKE SAN ANDRES, SOUTH

ZIMMERMAN	2	F 35 10 25	LAND TYPE P ; LAST PROD DATE 10/01/80; EXPIR DATE / /
ZIMMERMAN	3	C 35 10 25	LAND TYPE P ; LAST PROD DATE 02/01/81; EXPIR DATE / /

.....POOL TOTAL: BITTER LAKE SAN ANDRES, SOUTH 2
FEDERAL SUBTOTAL: 0; STATE & PATENT LAND SUBTOTAL: 0

===== POOL: LINDA SAN ANDRES

CHRISTOPHER	1	B 32 6 26	LAND TYPE P ; LAST PROD DATE / / ; EXPIR DATE / /
-------------	---	-----------	---

.....POOL TOTAL: LINDA SAN ANDRES 1
FEDERAL SUBTOTAL: 0; STATE & PATENT LAND SUBTOTAL: 0

.....OPERATOR TOTAL: HARLE, CHARLES W. 3
TOTAL # TA WELLS FOR HARLE, CHARLES W. ON: FED LAND 0; STATE & PATENT LAND 0

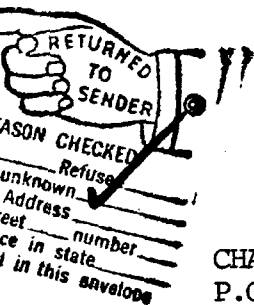

CHARLES E. HARLE
P.O. Box 354
Roswell, NM 88201



BRUCE KING
GOVERNOR

STATE OF NEW MEXICO

ENERGY, MINERALS AND NATURAL RESOURCES DEPARTMENT

OIL CONSERVATION DIVISION
ARTESIA DISTRICT OFFICE

ANITA LOCKWOOD
CABINET SECRETARY

December 15, 1995

Charles W. Harle
P.O. Box 1101
Sonora, TX 76950

Re: Christopher #1 Ut. B-32-6S-26E, Chaves County, New Mex.

Dear Mr. Harle:

According to our records the subject well was drilled to approximately 450 feet, with 8 5/8 inch casing set at 330 feet because of hole problems. To date we have no record of this well ever being completed, produced or plugged.

We ask that you submit plans, in accordance with rule 202, to plug and abandon this well by February 1, 1995.

Yours Truly,

Ray Smith
Oil & Gas Inspector

RS:br



STATE OF NEW MEXICO
ENERGY AND MINERALS DEPARTMENT
OIL CONSERVATION DIVISION
ARTESIA DISTRICT OFFICE

BRUCE KING
GOVERNOR
LARRY KEHOE
SECRETARY

November 14, 1980

P.O. DRAWER DD
ARTESIA, NEW MEXICO 88210
(505) 748-4884
748-1283

Charles W. Harle
Post Office Box 1101
Sonora, Texas 76950

Re: Christopher
#1-B-32-6-26
Chaves County, NM

Dear Sir:

According to our records, the subject well was drilled to approximately 450 feet, and operations were suspended approximately a year ago. To date, we have no record of a bond for Sutton and Tucker or S&S Hot Oil Services, Inc. Also, the changes in ownership that they have submitted are not acceptable even if they had a bond.

Therefore, we are hereby requesting that you squeeze cement the 8 5/8" casing and resume drilling operations or plug and abandon the well as soon as possible.

Please advise this office of your plans concerning the well prior to commencing any work.

Sincerely,

A handwritten signature in cursive script, reading "W. A. Gressett".

W. A. Gressett
Supervisor, District II

WAG:ar

Xc: Sutton & Tucker
1200 East Second St.
Big Lake, Texas 76932



STATE OF NEW MEXICO
ENERGY AND MINERALS DEPARTMENT

OIL CONSERVATION DIVISION
ARTESIA DISTRICT OFFICE

BRUCE KING
GOVERNOR
LARRY KEHOE
SECRETARY

January 21, 1980

P.O. DRAWER DD
ARTESIA, NEW MEXICO 88210
(505) 748-4864
748-1283

Sutton & Tucker
1200 East Second Street
Big Lake, Texas 76932

Re: Christopher
#1-B-32-6-26
Chaves County, NM

Gentlemen:

To date this office has no record of a bond for you covering the subject well. Said bond must be submitted to our Santa Fe office for approval.

Further, to date we have not received the original of the Form C-103, reporting the change in ownership on this well.

Please take care of this at your earliest convenience.

Sincerely,

W. A. Gressett
Supervisor, District II

WAG:ar

NO. OF COPIES RECEIVED	
DISTRIBUTION	
UNIT FEE	1
FILE	✓
S.G.S.	
AND OFFICE	
OPERATOR	1

RECEIVED
NEW MEXICO OIL CONSERVATION COMMISSION

NOV 7 1979

O. C. C.
ARTESIA. OFFICE

Form C-103
Supersedes Old
C-102 and C-101
Effective 1-1-65

<p align="center">SUNDRY NOTICES AND REPORTS ON WELLS <small>(DO NOT USE THIS FORM FOR PROPOSALS TO DRILL OR TO REOPEN OR PLUG BACK TO A DIFFERENT RESERVOIR. USE "APPLICATION FOR PERMIT -" (FORM C-101) FOR SUCH PROPOSALS.)</small></p>		<p>5a. Indicate Type of Lease State <input type="checkbox"/> Fee <input checked="" type="checkbox"/></p>
<p>Oil Well <input checked="" type="checkbox"/> Gas Well <input type="checkbox"/> OTHER <input type="checkbox"/></p>		<p>5. State Oil & Gas Lease No.</p>
<p>Name of Operator Charles W. Harle</p>		<p>7. Unit Agreement Name</p>
<p>Address of Operator P.O. BOX 1101 SONORA, TEXAS 76950</p>		<p>8. Farm or Lease Name CHRISTOPHER</p>
<p>Location of Well UNIT LETTER B 330 FEET FROM THE NORTH LINE AND 2310 FEET FROM THE EAST LINE, SECTION 32 TOWNSHIP 6 S RANGE 26 EAST NMPM.</p>		<p>9. Well No. # 1</p>
<p>15. Elevation (Show whether DF, RT, CR, etc.) GR 3618.64</p>		<p>10. Field and Pool, or Wildcat LINDA SAN ANDRES</p>
<p>12. County CHAVES</p>		

Check Appropriate Box To Indicate Nature of Notice, Report or Other Data
NOTICE OF INTENTION TO: SUBSEQUENT REPORT OF:

<p>FORM REMEDIAL WORK <input type="checkbox"/></p> <p>UNPLANNED ABANDON <input type="checkbox"/></p> <p>WELL OR ALTER CASING <input type="checkbox"/></p> <p>OTHER <input checked="" type="checkbox"/> CHANGE OF OWNERSHIP</p>	<p>PLUG AND ABANDON <input type="checkbox"/></p> <p>CHANGE PLANS <input checked="" type="checkbox"/></p>	<p>REMEDIAL WORK <input type="checkbox"/></p> <p>COMMENCE DRILLING OPERATIONS <input type="checkbox"/></p> <p>CASING TEST AND CEMENT JOBS <input type="checkbox"/></p> <p>OTHER <input checked="" type="checkbox"/></p>	<p>ALTERING CASING <input type="checkbox"/></p> <p>PLUG AND ABANDONMENT <input type="checkbox"/></p>
---	--	---	--

Describe Proposed or Completed Operations (Clearly state all pertinent details, and give pertinent dates, including estimated date of starting any proposed work) SEE RULE 1103.

This is to notify of change of ownership as of 11-1-79.

Previous owner was Great Southern Petroleum.
1200 Second Street Big Lake, Texas

New owner is William Harle.
P.O. Box 1101 Sonora, Texas 76950

Well will be operated as ;

William Harle
Christopher #1

*Posted
11-9-79
chg. opr.*

hereby certify that the information above is true and complete to the best of my knowledge and belief.

<p><i>L. L. Lingo</i></p>	<p>TITLE <i>Agent</i></p>	<p>DATE <i>11-2-79</i></p>
<p>VER BY <i>W. A. Gressett</i></p>	<p>TITLE SUPERVISOR, DISTRICT II</p>	<p>DATE NOV 8 1979</p>

CONDITIONS OF APPROVAL, IF ANY:

NO. OF COPIES RECEIVED		
DISTRIBUTION		
ALTA FE	1	
ILE	1	✓
.S.G.S.		
AND OFFICE		
PERATOR	1	

RECEIVED
NEW MEXICO OIL CONSERVATION COMMISSION
NOV 7 1979

Form C-103
 Supersedes Old
 C-102 and C-103
 Effective 1-1-65

O. C. C.
ARTESIA, OFFICE

5a. Indicate Type of Lease	
State <input type="checkbox"/>	Free <input checked="" type="checkbox"/>
5. State Oil & Gas Lease No.	

SUNDRY NOTICES AND REPORTS ON WELLS
(DO NOT USE THIS FORM FOR PROPOSALS TO DRILL OR TO CEMENT OR PLUG BACK TO A DIFFERENT RESERVOIR. USE "APPLICATION FOR PERMIT TO DRILL" (FORM C-101) FOR SUCH PROPOSALS.)

OIL WELL <input checked="" type="checkbox"/>	GAS WELL <input type="checkbox"/>	OTHER <input type="checkbox"/>
Name of Operator GREAT SOUTHERN PETROLEUM ✓		
Address of Operator 1200 SECOND STREET BIG LAKE, TEXAS		
Location of Well UNIT LETTER B 330 FEET FROM THE NORTH LINE AND 2310 FEET FROM THE EAST LINE, SECTION #132 TOWNSHIP 6 S RANGE 26 EAST NMPM.		

7. Unit Agreement Name
8. Farm or Lease Name CHRISTOPHER
9. Well No. # 1
10. Field and Pool, or Wildcat LINDA SAN ANDRES

11. Elevation (Show whether DF, RT, GR, etc.) GR 3618.64	12. County CHAVES
--	-----------------------------

Check Appropriate Box To Indicate Nature of Notice, Report or Other Data
 NOTICE OF INTENTION TO: SUBSEQUENT REPORT OF:

PERFORM REMEDIAL WORK <input type="checkbox"/>	PLUG AND ABANDON <input type="checkbox"/>	REMEDIAL WORK <input type="checkbox"/>	ALTERING CASING <input checked="" type="checkbox"/>
UNPLUGGABLY ABANDON <input type="checkbox"/>	CHANGE PLANS <input type="checkbox"/>	COMMENCE DRILLING OPNS. <input checked="" type="checkbox"/>	PLUG AND ABANDONMENT <input type="checkbox"/>
WELL OR ALTER CASING <input type="checkbox"/>	OTHER <input type="checkbox"/>	CASING TEST AND CEMENT JOBS <input checked="" type="checkbox"/>	
		OTHER <input type="checkbox"/>	

Describe Proposed or Completed Operations (Clearly state all pertinent details, and give pertinent dates, including estimated date of starting any proposed work) SEE RULE 1103.

WELL SPUDDED 9-22-79.
 Drilled a 11" hole to 450'.
 The well went crooked at 330'.
 Set 8 5/8 casing 10-6-79.
 Set 8 5/8 casing 24# K-55 at 330' because of crooked hole below 330'.
 Cemented casing with 200 sacks Class C cement with 2% C.C.
 Cement did not circulate to surface.
 On the 10-7-79 cemented down backside with 225 sacks Class C W/ 2% C.C.
 Cement circulated to surface.
 Left 200' of cement in pipe and did not get a Shut off on surface water.
 Plan to squeeze off surface water.
 Temporary shut down waiting on rig.

hereby certify that the information above is true and complete to the best of my knowledge and belief.

BY <u>W. A. Gressett</u> REGION OF APPROVAL, IF ANY:	TITLE <u>SUPERVISOR, DISTRICT II</u>	DATE <u>NOV 8 1979</u>
---	--------------------------------------	------------------------

NEW MEXICO OIL CONSERVATION COMMISSION
DRAWER DD
ARTESIA, NEW MEXICO

FIELD REPORT FOR CEMENTING OF WELLS

Operator <i>West Southern Petroleum Co.</i>		Lease <i>Christopher</i>		Well # <i>1</i>	
Location of Well	Unit <i>B</i> <i>330 N 23100</i>	Section <i>32</i>	Township <i>6</i>	Range <i>26</i>	County <i>Chuska</i>
Drilling Contractor	<i>Rhymes Drilling Co.</i>		Type of Equipment <i>Rotary to start 9-20-79</i>		

** witness* APPROVED CASING PROGRAM

Size of Hole	Size of Casing	Weight Per Foot	New or Used	Depth	Sacks Cement
<i>12"</i>	<i>8 7/8"</i>	<i>24</i>		<i>400</i>	<i>200 cu.</i>
<i>7 7/8"</i>	<i>4 1/2"</i>	<i>10.5</i>		<i>1200</i>	<i>cu.</i>

Casing Data:

Surface _____ joints of _____ inch _____ # Grade _____
(Approved) (Rejected) _____

Inspected by _____ date _____

Cementing Program

Size of hole *11"* Size of Casing *8 5/8* Sacks cement required _____

Type of Shoe used *guide* Float collar used *No* Btm 3 jts welded *yes*

TD of hole *429'* Set *332'* Feet of *8 5/8* Inch *23* # Grade *K-SS*

New-used csg. @ *332'* with *200* sacks neat cement around shoe
+ _____ sax _____ additives *270cc*

Plug down @ *2:30* (AM) (PM) Date *10/5/79*

Cement circulated *No* No. of Sacks *0*

Cemented by *Halliburton* Witnessed by *BW Weaver*

Temp. Survey ran @ _____ (AM) (PM) Date _____ top cement @ _____

Casing test @ _____ (AM) (PM) Date _____

Method Used _____ Witnessed by _____

Checked for shut off @ _____ (AM) (PM) Date _____

Method used _____ Witnessed by _____

Remarks: _____

Wt @ 60' 240'-260'

1 Ran 1" Tugged TOC @ 160'

pumped 150SK class C 270cc

2 Ran 1" Tugged TOC @ 40'

pumped 100SK class C 270cc

cement circulated. 10/6/79 M.S.

OIL CONSERVATION DIVISION

P. O. BOX 2088

SANTA FE, NEW MEXICO 87501

Form C-103
Revised 10-1-78

NO. OF COPIES RECEIVED	
DISTRIBUTION	
SANTA FE	
FILE	
U.S.G.S.	
LAND OFFICE	
OPERATOR	

RECEIVED

FEB 29 1980

5a. Indicate Type of Lease	
State <input checked="" type="checkbox"/>	Fee <input type="checkbox"/>
5. State Oil & Gas Lease No.	
7. Unit Agreement Name	
8. Farm or Lease Name	
9. Well No.	
10. Field and Pool, or Wildcat	
12. County CHAVES	

SUNDRY NOTICES AND REPORTS ON WELLS O. C. D.
(DO NOT USE THIS FORM FOR PROPOSALS TO DRILL OR TO DEEPEN OR PLUG BACK TO A DIFFERENT RESERVOIR. USE "APPLICATION FOR PERMIT -" (FORM C-101) FOR SUCH PROPOSALS.) ARTESIA, OFFICE

OIL WELL ☒ GAS WELL ☐ OTHER ☐

Name of Operator
S&S HOT OIL SERVICE I.N.C.

Address of Operator

Location of Well

UNIT LETTER _____ FEET FROM THE NORTH LINE AND 2310 FEET FROM THE EAST LINE, SECTION 32 TOWNSHIP 6 SOUTH RANGE 26 EAST NMPM.

15. Elevation (Show whether DF, RT, GR, etc.)

Check Appropriate Box To Indicate Nature of Notice, Report or Other Data

NOTICE OF INTENTION TO:		SUBSEQUENT REPORT OF:	
PERFORM REMEDIAL WORK <input type="checkbox"/>	PLUG AND ABANDON <input type="checkbox"/>	REMEDIAL WORK <input type="checkbox"/>	ALTERING CASING <input type="checkbox"/>
TEMPORARILY ABANDON <input type="checkbox"/>	CHANGE PLANS <input type="checkbox"/>	COMMENCE DRILLING OPNS. <input type="checkbox"/>	PLUG AND ABANDONMENT <input type="checkbox"/>
PULL OR ALTER CASING <input type="checkbox"/>	OTHER <input type="checkbox"/>	CASING TEST AND CEMENT JOB <input type="checkbox"/>	OTHER <input checked="" type="checkbox"/>
FINISH DRILLING <input type="checkbox"/>		CHANGE OF OWNERS <input checked="" type="checkbox"/>	

Describe Proposed or Completed Operations (Clearly state all pertinent details, and give pertinent dates, including estimated date of starting any proposed work) SEE RULE 1103.

L.L.LIVEOAK P.O.BOX 6588 ROSWELL, NEW MEXICO

I hereby certify that the information above is true and complete to the best of my knowledge and belief.

SIGNED L.L. Liveoak TITLE Co Owner DATE 2-26-80

APPROVED BY _____ TITLE _____ DATE _____
CONDITIONS OF APPROVAL, IF ANY:

OIL CONSERVATION DIVISION

P. O. BOX 2088
SANTA FE, NEW MEXICO 87501

Form C-103
Revised 10-1-78

NO. OF COPIES RECEIVED	
DISTRIBUTION	
SANTA FE	
FILE	
U.S.G.S.	
LAND OFFICE	
OPERATOR	

FEB 29 1980

O. C. D.

5a. Indicate Type of Lease State <input checked="" type="checkbox"/> Fee <input type="checkbox"/>
5. State Oil & Gas Lease No.
7. Unit Agreement Name
8. Farm or Lease Name
9. Well No.
10. Field and Pool, or Wildcat
12. County CHAVES

SUNDRY NOTICES AND REPORTS ON WELLS ARTESIA, OFFICE
(DO NOT USE THIS FORM FOR PROPOSALS TO DRILL OR TO DEEPEN OR PLUG BACK TO A DIFFERENT RESERVOIR.
USE "APPLICATION FOR PERMIT -" (FORM C-101) FOR SUCH PROPOSALS.)

1. OIL WELL ☒ GAS WELL ☐ OTHER- ☐

2. Name of Operator
S&S HOT OIL SERVICE I.N.C.

3. Address of Operator

4. Location of Well
UNIT LETTER _____, 380 FEET FROM THE NORTH LINE AND 2310 FEET FROM THE EAST LINE, SECTION 32 TOWNSHIP 6 SOUTH RANGE 26 EAST NMPM.

15. Elevation (Show whether DF, RT, GR, etc.)

Check Appropriate Box To Indicate Nature of Notice, Report or Other Data
NOTICE OF INTENTION TO: SUBSEQUENT REPORT OF:

PERFORM REMEDIAL WORK <input type="checkbox"/>	PLUG AND ABANDON <input type="checkbox"/>	REMEDIAL WORK <input type="checkbox"/>	ALTERING CASING <input type="checkbox"/>
TEMPORARILY ABANDON <input type="checkbox"/>	CHANGE PLANS <input type="checkbox"/>	COMMENCE DRILLING OPS. <input type="checkbox"/>	PLUG AND ABANDONMENT <input type="checkbox"/>
PULL OR ALTER CASING <input type="checkbox"/>	OTHER <input type="checkbox"/>	CASING TEST AND CEMENT JOB <input type="checkbox"/>	OTHER <input checked="" type="checkbox"/> CHANGE OF OWNERS
OTHER <input type="checkbox"/> FINISH DRILLING			

7. Describe Proposed or Completed Operations (Clearly state all pertinent details, and give pertinent dates, including estimated date of starting any proposed work) SEE RULE 1103.

L.L.LIVEOAK P.O.BOX 6588 ROSWELL, NEW MEXICO

I hereby certify that the information above is true and complete to the best of my knowledge and belief.

SIGNED L.L. Liveoak TITLE Owner DATE 2-26-80

COPIES OF APPROVAL, IF ANY: _____ TITLE _____ DATE _____

NO. OF COPIES RECEIVED	5
DISTRIBUTION	
SANTA FE	1
FILE	1 ✓
U.S.G.S.	2
LAND OFFICE	1
OPERATOR	1

NEW MEXICO OIL CONSERVATION COMMISSION

RECEIVED

SEP 1 2 1979

O. C. C.

30-005-6059

Form C-101
Revised 1-1-65

5A. Indicate Type of Lease
STATE ☐ FEE ☒

5. State Oil & Gas Lease No.

APPLICATION FOR PERMIT TO DRILL, DEEPEN, OR PLUG BACK

1a. Type of Work DRILL <input checked="" type="checkbox"/> DEEPEN <input type="checkbox"/> PLUG BACK <input type="checkbox"/>		7. Unit Agreement Name
b. Type of Well OIL WELL <input type="checkbox"/> GAS WELL <input type="checkbox"/> OTHER <input type="checkbox"/> SINGLE ZONE <input checked="" type="checkbox"/> MULTIPLE ZONE <input type="checkbox"/>		8. Farm or Lease Name CHRISTOPHER
2. Name of Operator GREAT SOUTHERN PETROLEUM COMPANY		9. Well No. #1
3. Address of Operator 1200 Second Street Big Lake, Texas		10. Field and Pool, or Wildcat Linda SanAndreas
4. Location of Well UNIT LETTER <u>B</u> LOCATED <u>330</u> FEET FROM THE <u>NORTH</u> LINE AND <u>2310</u> FEET FROM THE <u>EAST</u> LINE OF SEC. 32 TWP. 6 South, RGE. 26 East NMPM		12. County Chaves
19. Proposed Depth 1200		19A. Formation San Andees
20. Rotary or C.T. Rotary		
21. Elevations (Show whether DF, RT, etc.) 3618.64	21A. Kind & Status Plug. Bond 1 well	21B. Drilling Contractor Rhymes Drlg. Co.
22. Approx. Date Work will start 9-15-79		

23.

PROPOSED CASING AND CEMENT PROGRAM

SIZE OF HOLE	SIZE OF CASING	WEIGHT PER FOOT	SETTING DEPTH	SACKS OF CEMENT	EST. TOP
12"	8 5/8	24#	400	200	Surface
7 7/8	4 1/2	10.5	1200	200	700

APPROVAL VALID
FOR 90 DAYS UNLESS
DRILLING COMMENCED,

EXPIRES 12-20-79

IN ABOVE SPACE DESCRIBE PROPOSED PROGRAM; IF PROPOSAL IS TO DEEPEN OR PLUG BACK, GIVE DATA ON PRESENT PRODUCTIVE ZONE AND PROPOSED NEW PRODUCTIVE ZONE. GIVE BLOWOUT PREVENTER PROGRAM, IF ANY.

I hereby certify that the information above is true and complete to the best of my knowledge and belief.

Signed R. E. Day Title Chairman Date 9-11-79

(This space for State Use)

APPROVED BY W. A. Dressett TITLE SUPERVISOR, DISTRICT II DATE SEP 20 1979

CONDITIONS OF APPROVAL, IF ANY:

at must be
surface behind 8 5/8" + 4 1/2"

Notify N.M.O.C.C. in sufficient
time to witness cementing
the 8 5/8"

NO. OF COPIES RECEIVED	
DISTRIBUTION	
NYA FE	<input checked="" type="checkbox"/>
LC	
S.G.S.	
AND OFFICE	
PERATOR	

RECEIVED
NEW MEXICO OIL CONSERVATION COMMISSION
NOV 7 1979

Form C-103
 Supersedes Old
 C-102 and C-103
 Effective 1-1-65

O. C. C.
ARTESIA, OFFICE

5a. Indicate Type of Lease State <input type="checkbox"/> Fee <input checked="" type="checkbox"/>
5. State Oil & Gas Lease No.
7. Unit Agreement Name
6. Farm or Lease Name CHRISTOPHER
9. Well No. # 1
10. Field and Pool, or Wildcat LINDA SAN ANDRES
12. County CHAVES

SUNDRY NOTICES AND REPORTS ON WELLS
 (DO NOT USE THIS FORM FOR APPLICATION TO DRILL OR TO RE-OPEN OR TO BACK TO A DIFFERENT RESERVOIR.
 USE APPLICATION FOR PERMIT - "A" (FORM C-101) FOR SUCH PROPOSALS.)

OIL WELL ☒ GAS WELL ☐ OTHER ☐

Name of Operator
Charles W. Harle

Address of Operator
P.O. BOX 1101 SONORA, TEXAS 76950

Location of Well
 UNIT LETTER **B** **330** FEET FROM THE **NORTH** LINE AND **2310** FEET FROM
 THE **EAST** LINE, SECTION **32** TOWNSHIP **6 S** RANGE **26 EAST** NMPM.

15. Elevation (Show whether DF, RT, GR, etc.)
GR 3618.64

Check Appropriate Box To Indicate Nature of Notice, Report or Other Data
 NOTICE OF INTENTION TO: SUBSEQUENT REPORT OF:

REFORM REMEDIAL WORK <input type="checkbox"/> IMPROVABLY ABANDON <input type="checkbox"/> LL OR ALTER CASING <input type="checkbox"/> OTHER CHANGE OF OWNERSHIP <input checked="" type="checkbox"/>	PLUG AND ABANDON <input type="checkbox"/> CHANGE PLANS <input checked="" type="checkbox"/> OTHER <input checked="" type="checkbox"/>	REMEDIAL WORK <input type="checkbox"/> COMMENCE DRILLING OPER. <input type="checkbox"/> CASING TEST AND CEMENT JOBS <input type="checkbox"/> OTHER <input checked="" type="checkbox"/>	ALTERING CASING <input type="checkbox"/> PLUG AND ABANDONMENT <input type="checkbox"/> OTHER <input checked="" type="checkbox"/>
---	--	---	--

Describe Proposed or Completed Operations (Clearly state all pertinent details, and give pertinent dates, including estimated date of starting any proposed work) SEE RULE 1103.

This is to notify of change of ownership as of 11-1-79.

Previous owner was Great Southern Petroleum.
 1200 Second Street Big Lake, Texas

New owner is William Harle.
 P.O. Box 1101 Sonora, Texas 76950

Well will be operated as ;

William Harle
 Christopher

RECEIVED
NOV 9 - 1979
OIL CONSERVATION DIVISION
SANTA FE

I hereby certify that the information is true and complete to the best of my knowledge and belief.

BY <u><i>L.L. Lingo</i></u>	TITLE <u>Agent</u>	DATE <u>11-7-79</u>
BY <u><i>W.A. Gressitt</i></u>	TITLE <u>SUPERVISOR, DISTRICT II</u>	DATE <u>NOV 8 1979</u>

CONDITIONS OF APPROVAL, IF ANY:

NO. OF COPIES RECEIVED	
DISTRIBUTION	
STATE	<input checked="" type="checkbox"/>
FEDERAL	
U.S.	
FIELD OFFICE	
OPERATOR	

RECEIVED
NEW MEXICO OIL CONSERVATION COMMISSION
NOV 7 1979
O. C. C.
ARTESIA, OFFICE

Form C-103
Supersedes Old
C-102 and C-103
Effective 1-1-65

<p style="text-align: center;">SUNDRY NOTICES AND REPORTS ON WELLS</p> <p style="text-align: center;">DO NOT USE THIS FORM FOR PROPOSALS TO DRILL OR TO RE-DRILL OR TO PLUG BACK TO A DIFFERENT RESERVOIR. USE APPLICATION FOR PERMIT TO DRILL (Form C-101) FOR SUCH PROPOSALS.</p>		<p>5a. Indicate Type of Lease State <input type="checkbox"/> Fee <input checked="" type="checkbox"/></p>
<p>1. Name of Operator GREAT SOUTHERN PETROLEUM <input checked="" type="checkbox"/></p>		<p>3. State Oil & Gas Lease No.</p>
<p>2. Address of Operator 1200 SECOND STREET BIG LAKE, TEXAS</p>		<p>6. Farm or Lease Name CHRISTOPHER</p>
<p>3. Location of Well UNIT LETTER B 330 FEET FROM THE NORTH LINE AND 2310 FEET FROM THE EAST LINE, SECTION #32 TOWNSHIP 6 S RANGE 26 EAST NMPM.</p>		<p>7. Unit Agreement Name</p>
<p>4. Elevation (Show whether DF, RT, GR, etc.) GR 3618.64</p>		<p>8. Well No. # 1</p>
<p>5. Check Appropriate Box To Indicate Nature of Notice, Report or Other Data</p>		<p>9. Field and Pool, or Wildcat LINDA SAN ANDRES</p>
<p>6. Check Appropriate Box To Indicate Nature of Notice, Report or Other Data</p>		<p>10. County CHAVES</p>

<p>Check Appropriate Box To Indicate Nature of Notice, Report or Other Data</p>		<p>Check Appropriate Box To Indicate Nature of Notice, Report or Other Data</p>	
<p>NOTICE OF INTENTION TO:</p>	<p>SUBSEQUENT REPORT OF:</p>	<p>FORM REMEDIAL WORK <input type="checkbox"/></p>	<p>REMEDIAL WORK <input type="checkbox"/></p>
<p>TEMPORARILY ABANDON <input type="checkbox"/></p>	<p>PLUG AND ABANDON <input type="checkbox"/></p>	<p>COMMENCE DRILLING OPNS. <input checked="" type="checkbox"/></p>	<p>ALTERING CASING <input checked="" type="checkbox"/></p>
<p>CHANGE PLANS <input type="checkbox"/></p>	<p>CASING TEST AND CEMENT JOBS <input checked="" type="checkbox"/></p>	<p>PLUG AND ABANDONMENT <input type="checkbox"/></p>	<p>OTHER <input type="checkbox"/></p>

Describe Proposed or Completed Operations (Clearly state all pertinent details, and give pertinent dates, including estimated date of starting any proposed work) SEE RULE 1103.

WELL SPUDDED 9-22-79.
Drilled a 11" hole to 450'.
The well went crooked at 330'.
Set 8 5/8 casing 10-6-79.
Set 8 5/8 casing 24# K-55 at 330' because of crooked hole below 330'.
Cemented casing with 200 sacks Class C cement with 2% C.C.
Cement did not circulate to surface.
On the 10-7-79 cemented down backside with 225 sacks Class C W/ 2% -CC.
Cement circulated to surface.
Left 200' of cement in pipe and did not get a Shut off on surface water.
Plan to squeeze off surface water.
Temporary shut down waiting on rig.

RECEIVED
NOV 9 - 1979

OIL CONSERVATION DIVISION

I hereby certify that the information above is true and complete to the best of my knowledge and belief.

DATE 11-7-79 TITLE Agent

DATE NOV 8 1979 TITLE SUPERVISOR, DISTRICT II

DATE NOV 8 1979 TITLE SUPERVISOR, DISTRICT II

NO. OF COPIES RECEIVED	
DISTRIBUTION	
SANTA FE	
FILE	
U.S.G.S.	
LAND OFFICE	
OPERATOR	

RECEIVED
NEW MEXICO OIL CONSERVATION COMMISSION

SEP 12 1979

O. C. C.
ARTESIA, OFFICE

30-005-60591

Form C-101
Revised 1-1-65

5A. Indicate Type of Lease	
STATE <input type="checkbox"/>	FEE <input checked="" type="checkbox"/>

5. State Oil & Gas Lease No.

APPLICATION FOR PERMIT TO DRILL, DEEPEN, OR PLUG BACK

1a. Type of Work			7. Unit Agreement Name		
b. Type of Well DRILL <input checked="" type="checkbox"/> DEEPEN <input type="checkbox"/> PLUG BACK <input type="checkbox"/> OIL WELL <input checked="" type="checkbox"/> GAS WELL <input type="checkbox"/> OTHER <input type="checkbox"/> SINGLE ZONE <input checked="" type="checkbox"/> MULTIPLE ZONE <input type="checkbox"/>			8. Farm or Lease Name CHRISTOPHER		
2. Name of Operator GREAT SOUTHERN PETROLEUM COMPANY			9. Well No. #1		
3. Address of Operator 1200 Second Street Big Lake, Texas			10. Field and Pool, or Wildcat Linda SanAndreas		
4. Location of Well UNIT LETTER B LOCATED 330 FEET FROM THE North LINE AND 2310 FEET FROM THE EAST LINE OF SEC. 32 TWP. 6 South RGE. 26 East MPM			12. County Chaves		
19. Proposed Depth 1200			19A. Formation San Andees		20. Rotary or C.T. Rotary
21. Elevations (Show whether DT, RT, etc.) 3618.64		21A. Kind & Status Plug. Bond 1 well		21B. Drilling Contractor Rhymes Drlg. Co.	
22. Approx. Date Work will start 9-15-79					

23.

PROPOSED CASING AND CEMENT PROGRAM

SIZE OF HOLE	SIZE OF CASING	WEIGHT PER FOOT	SETTING DEPTH	SACKS OF CEMENT	EST. TOP
12"	8 5/8	24#	400	200	Surface
7 7/8	4 1/2	10.5	1200	200	700

APPROVAL VALID
FOR 90 DAYS UNLESS
DRILLING COMMENCED,

EXPIRES 12-20-79

IN ABOVE SPACE DESCRIBE PROPOSED PROGRAM: IF PROPOSAL IS TO DEEPEN OR PLUG BACK, GIVE DATA ON PRESENT PRODUCTIVE ZONE AND PROPOSED NEW PRODUCTIVE ZONE. GIVE BLOWOUT PREVENTER PROGRAM, IF ANY.

I hereby certify that the information above is true and complete to the best of my knowledge and belief.

Signed R. E. Day Title Owner Date 9-11-79

(This space for State Use)

APPROVED BY W. A. Gressett TITLE SUPERVISOR, DISTRICT II DATE SEP 20 1979

CONDITIONS OF APPROVAL, IF ANY:

Cement must be circulated to
surface behind 8 5/8" + 4 1/2" casing

Notify N.M.O.C.C. in sufficient
time to witness cementing
the 8 5/8" casing

NEW MEXICO OIL CONSERVATION COMMISSION
WELL LOCATION AND ACREAGE DEDICATION PLAT

Form C-102
Supersedes C-128
Effective 1-1-65

All distances must be from the outer boundaries of the Section.

Operator GREAT SOUTHERN PETROLEUM COMPANY		Lease 6-1-1-1 C.H. Christopher		Well No. 6-1-1-1 #1	
Unit Letter B	Section 32	Township 6 South	Range 26 East	County Chaves	
Actual Footage Location of Well: 2310 feet from the east line and 330 feet from the north line					
Ground Level Elev. 3618.64	Producing Formation SAN ANDRES		Pool LINDA SAN ANDEES	Dedicated Acreage: 40 Acres	

1. Outline the acreage dedicated to the subject well by colored pencil or hachure marks on the plat below.
2. If more than one lease is dedicated to the well, outline each and identify the ownership thereof (both as to working interest and royalty).
3. If more than one lease of different ownership is dedicated to the well, have the interests of all owners been consolidated by communitization, unitization, force-pooling, etc?

☐ Yes ☐ No If answer is "yes," type of consolidation **O. C. C.**
ARTESIA, OFFICE

If answer is "no," list the owners and tract descriptions which have actually been consolidated. (Use reverse side of this form if necessary.)

No allowable will be assigned to the well until all interests have been consolidated (by communitization, unitization, forced-pooling, or otherwise) or until a non-standard unit, eliminating such interests, has been approved by the Commission.

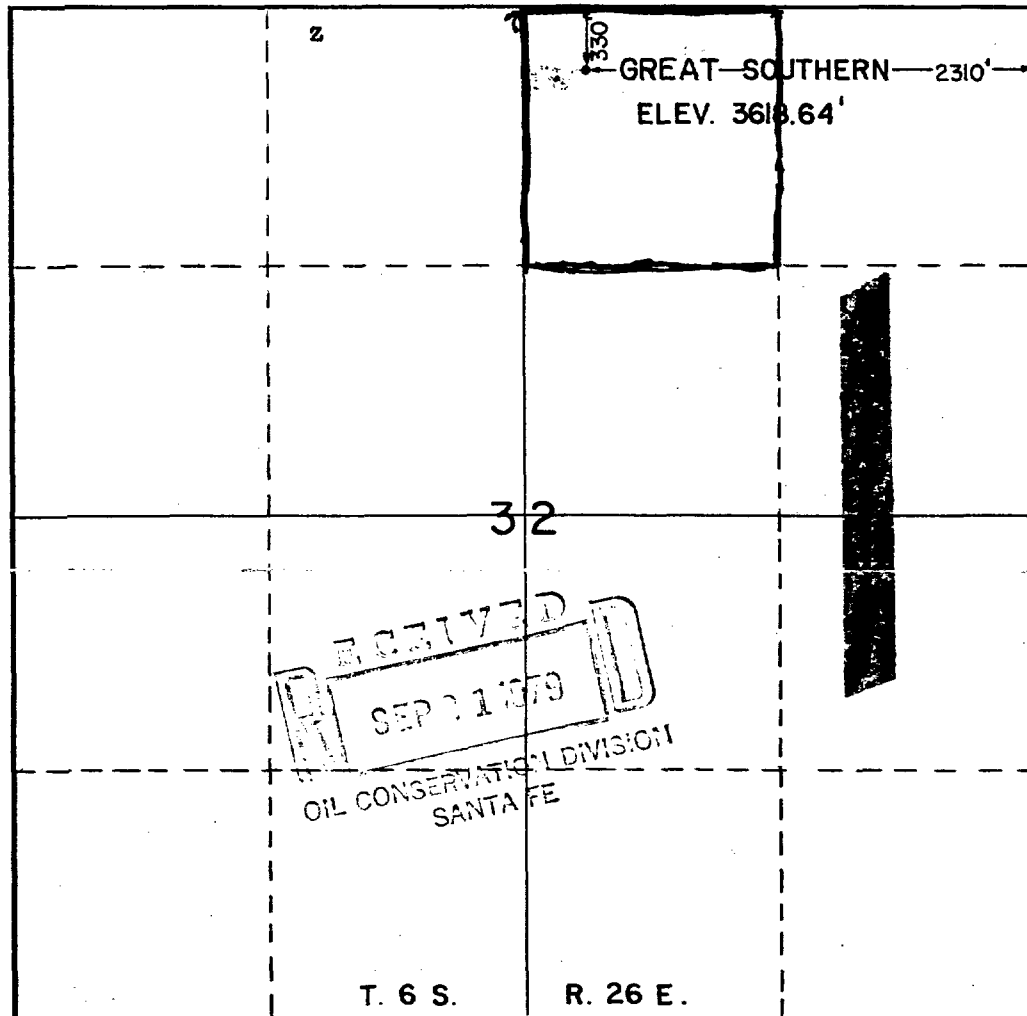

CERTIFICATION

I hereby certify that the information contained herein is true and complete to the best of my knowledge and belief.

Name **R. E. Hay**
Position **owner**
Company **Great Southern Petroleum Co**
Date **9-11-79**

I hereby certify that the well location shown on this plat was plotted from field notes of actual surveys made by me or under my supervision, and that the same is true and correct to the best of my knowledge and belief.

Date Surveyed **9-11-79**
Registered Professional Engineer and/or Land Surveyor **277**
THOMAS T. MANN
NEW MEXICO
N. M. 10. 277

NEW MEXICO OIL CONSERVATION COMMISSION
WELL LOCATION AND ACREAGE DEDICATION PLAT

Form C-102
Supersedes C-128
Effective 1-1-65

All distances must be from the outer boundaries of the Section.

Operator GREAT SOUTHERN PETROLEUM COMPANY		Lease CHRISTOPHER CHRISTOPHER		Well No. CHRISTOPHER #1	
Unit Letter B	Section 32	Township 6 South	Range 26 East	County Chaves	
Actual Footage Location of Well: 2310 feet from the east line and 330 feet from the north line					
Ground Level Elev: 3618.64	Producing Formation SAN ANDRES		Pool LINDA SAN ANDEES	Dedicated Acreage: 40 Acres	

1. Outline the acreage dedicated to the subject well by colored pencil or hachure marks on the plat below.
2. If more than one lease is dedicated to the well, outline each and identify the ownership thereof (both as to working interest and royalty).
3. If more than one lease of different ownership is dedicated to the well, have the interests of all owners been consolidated by communitization, unitization, force-pooling, etc?

☐ Yes ☐ No If answer is "yes," type of consolidation **O. C. C.**
ARTESIA, OFFICE

If answer is "no," list the owners and tract descriptions which have actually been consolidated. (Use reverse side of this form if necessary.)

No allowable will be assigned to the well until all interests have been consolidated (by communitization, unitization, forced-pooling, or otherwise) or until a non-standard unit, eliminating such interests, has been approved by the Commission.

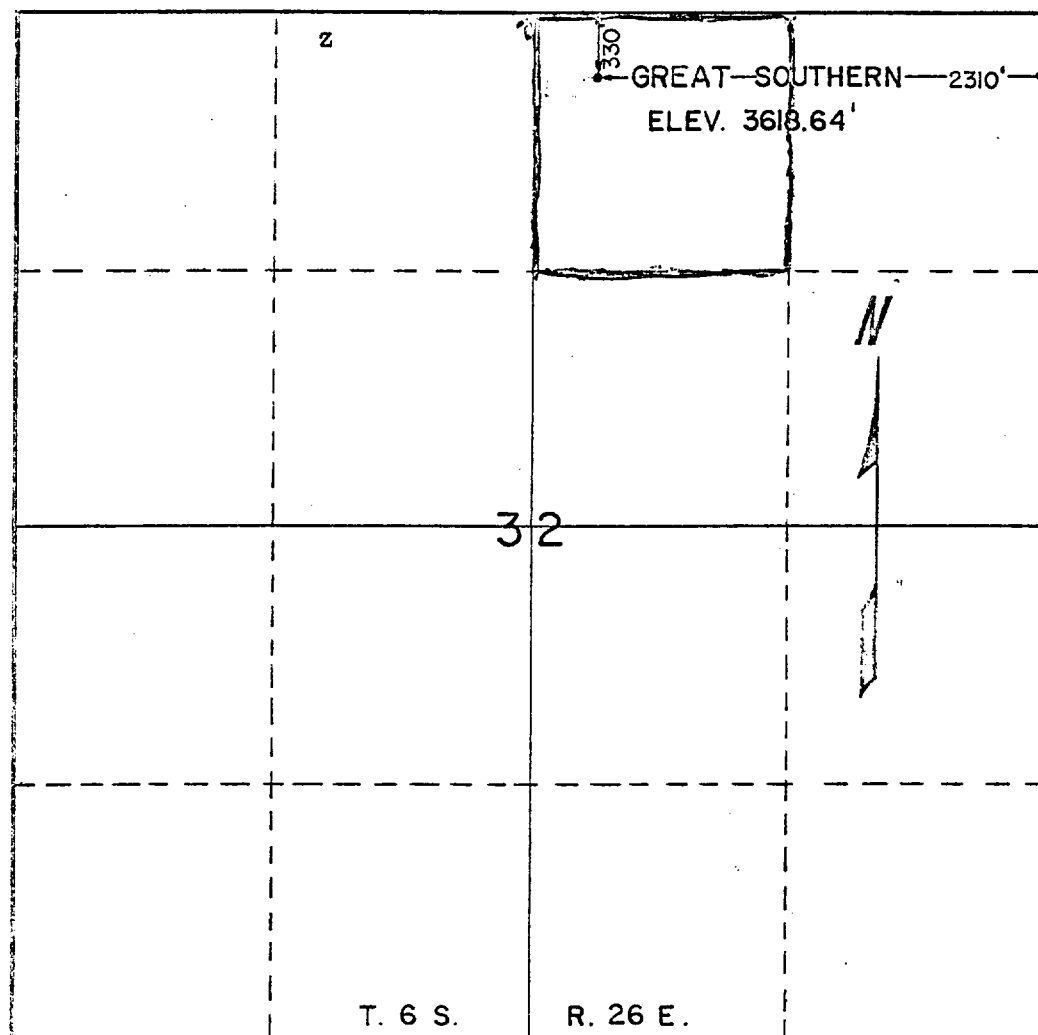

CERTIFICATION

I hereby certify that the information contained herein is true and complete to the best of my knowledge and belief.

Name **P. E. Hay**
Position **Owner**
Company **Great Southern Petroleum**
Date **9-11-79**

I hereby certify that the well location shown on this plat was plotted from field notes of actual surveys made by me or under my supervision, and that the same is true and correct to the best of my knowledge and belief.

Date Surveyed **9-11-79**
Registered Professional Engineer and/or Land Surveyor **277**
NEW MEXICO
Certificate No. **1-277**
N. M. NO. **1-277**

NO. OF COPIES RECEIVED	
DISTRIBUTION	
MAIL FILE	
U.S.G.S.	
LAND OFFICE	
OPERATOR	

NEW MEXICO OIL CONSERVATION COMMISSION

Form C-103
Supersedes Old
C-102 and C-103
Effective 1-1-65

NOV 27 1979

5a. Indicate Type of Lease	
State <input type="checkbox"/>	Fee <input checked="" type="checkbox"/>
5. State Oil & Gas Lease No.	

SUNDRY NOTICES AND REPORTS ON WELLS

(DO NOT USE THIS FORM FOR PROPOSALS TO DRILL OR TO REOPEN OR PLUG BACK TO A DIFFERENT RESERVOIR. USE APPLICATION FOR PERMIT TO DRILL (FORM C-101) FOR SUCH PROPOSALS.)

OIL WELL ☒ GAS WELL ☐ OTHER ☐

Name of Operator
SUTTON AND TUCKER

Address of Operator
1200 East Second Street BIG LAKE, TEXAS 76932

Location of Well
UNIT LETTER B 330 FEET FROM THE North LINE AND 2310 FEET FROM THE East LINE, SECTION 32 TOWNSHIP 6 south RANGE 26 East NMPM.

7. Unit Agreement Name
8. Farm or Lease Name CHRISTOPHER
9. Well No. #1
10. Field and Pool, or Wildcat Linda San Andres
12. County Chaves

15. Elevation (Show whether DF, RT, GR, etc.)
3618.64

Check Appropriate Box To Indicate Nature of Notice, Report or Other Data

NOTICE OF INTENTION TO:		SUBSEQUENT REPORT OF:	
PERFORM REMEDIAL WORK <input type="checkbox"/>	PLUG AND ABANDON <input type="checkbox"/>	REMEDIAL WORK <input type="checkbox"/>	ALTERING CASING <input type="checkbox"/>
TEMPORARILY ABANDON <input type="checkbox"/>	CHANGE PLANS <input type="checkbox"/>	COMMENCE DRILLING OPNS. <input type="checkbox"/>	PLUG AND ABANDONMENT <input type="checkbox"/>
WELL OR ALTER CASING <input type="checkbox"/>	OTHER <input checked="" type="checkbox"/> CHANGE OF OWNERSHIP	CASING TEST AND CEMENT JOB <input type="checkbox"/>	
		OTHER <input type="checkbox"/>	

Describe Proposed or Completed Operations (Clearly state all pertinent details, and give pertinent dates, including estimated date of starting any proposed work) SEE RULE 1103.

This is to notify of a change of ownership of the Christopher #1.

We propose to continue drilling well as soon as bond is approved.

New owners and operators are as follows,

JAMES E. SUTTON

JAMES M. TUCKER

I hereby certify that the information above is true and complete to the best of my knowledge and belief.

ED. James E. Sutton TITLE Owner DATE 11-23-79

COPIED BY _____ TITLE _____ DATE _____

CONDITIONS OF APPROVAL, IF ANY:

6. OF COPIES RECEIVED		
DISTRIBUTION		
NTA FE		
LE		
S.G.S.		
IND OFFICE		
OPERATOR		

NEW MEXICO OIL CONSERVATION COMMISSION

Form C-103
Supersedes Old
C-102 and C-103
Effective 1-1-65

NOV 27 1979

5a. Indicate Type of Lease	
State <input type="checkbox"/>	Fee <input checked="" type="checkbox"/>
5. State Oil & Gas Lease No.	

<p>SUNDRY NOTICES AND REPORTS ON WELLS</p> <p><small>(DO NOT USE THIS FORM FOR PROPOSALS TO DRILL OR TO RE-ENTER OR PLUG BACK TO A DIFFERENT RESERVOIR. USE APPLICATION FOR REPORT 1-1 (FORM C-101) FOR SUCH PROPOSALS.)</small></p>	
<p>OIL WELL <input checked="" type="checkbox"/> GAS WELL <input type="checkbox"/> OTHER <input type="checkbox"/></p>	
<p>Name of Operator SUTTON AND TUCKER</p>	
<p>Address of Operator 1200 East Second Street BIG LAKE, TEXAS 76932</p>	
<p>Location of Well UNIT LETTER B 330 FEET FROM THE North LINE AND 2310 FEET FROM East THE East LINE, SECTION 32 TOWNSHIP 6 south RANGE 26 East NMPM.</p>	
<p>15. Elevation (Show whether DF, RT, GR, etc.) 3618.64</p>	

7. Unit Agreement Name
8. Farm or Lease Name CHRISTOPHER
9. Well No. #1
10. Field and Pool, or Widened Linda San Andres
12. County Chaves

Check Appropriate Box To Indicate Nature of Notice, Report or Other Data	
NOTICE OF INTENTION TO:	SUBSEQUENT REPORT OF:
<p>FORM REMEDIAL WORK <input type="checkbox"/></p> <p>PERMANENTLY ABANDON <input type="checkbox"/></p> <p>AL OR ALTER CASING <input type="checkbox"/></p> <p>OTHER CHANGE OF OWNERSHIP <input checked="" type="checkbox"/></p>	<p>PLUG AND ABANDON <input type="checkbox"/></p> <p>CHANGE PLANS <input type="checkbox"/></p> <p>REMEDIAL WORK <input type="checkbox"/></p> <p>COMMENCE DRILLING OPNS. <input type="checkbox"/></p> <p>CASING TEST AND CEMENT JOBS <input type="checkbox"/></p> <p>OTHER <input type="checkbox"/></p> <p>ALTERING CASING <input type="checkbox"/></p> <p>PLUG AND ABANDONMENT <input type="checkbox"/></p>

Describe Proposed or Completed Operations (Clearly state all pertinent details, and give pertinent dates, including estimated date of starting any proposed work) SEE RULE 1103.

This is to notify of a change of ownership of the Christopher #1.
We propose to continue drilling well as soon as bond is approved.
New owners and operators are as follows,
JAMES E. SUTTON
JAMES M. TUCKER

I hereby certify that the information above is true and complete to the best of my knowledge and belief.		
<p><u>James E. Sutton</u></p>	<p>TITLE <u>Owner</u></p>	<p>DATE <u>11-26-79</u></p>
<p>APPROVED BY _____</p>	<p>TITLE _____</p>	<p>DATE _____</p>
<p>CONDITIONS OF APPROVAL, IF ANY:</p>		

NO. OF COPIES RECEIVED		
DISTRIBUTION		
NTA FE		
LE		
S.G.S.		
IND OFFICE		
PERATOR		

NEW MEXICO OIL CONSERVATION COMMISSION

RECEIVED

NOV 27 1979

Form C-103
Supersedes Old
C-102 and C-103
Effective 1-1-65

5a. Indicate Type of Lease
State ☐ Fee ☒

5. State Oil & Gas Lease No.

SUNDRY NOTICES AND REPORTS ON WELLS ARTEZIA, OFFICE

(DO NOT USE THIS FORM FOR PROPOSALS TO DRILL OR TO RE-ENTER OR PLUG BACK TO A DIFFERENT RESERVOIR. USE APPLICATION FOR PERMIT TO DRILL (FORM C-101) FOR SUCH PROPOSALS.)

OIL WELL ☒ GAS WELL ☐ OTHER ☐

Name of Operator
SUTTON AND TUCKER

Address of Operator

Location of Well
1200 East Second Street BIG LAKE, TEXAS 76932

UNIT LETTER **B** **330** FEET FROM THE **North** LINE AND **2310** FEET FROM

THE **East** LINE, SECTION **32** TOWNSHIP **6 south** RANGE **26 East** NMPM.

7. Unit Agreement Name

8. Farm or Lease Name

CHRISTOPHER

9. Well No.

#1

10. Field and Pool, or Wildcat

Linda San Andres

11. Elevation (Show whether DF, RT, GR, etc.)

3618.64

12. County

Chaves

Check Appropriate Box To Indicate Nature of Notice, Report or Other Data

NOTICE OF INTENTION TO:

SUBSEQUENT REPORT OF:

PERFORM REMEDIAL WORK ☐

PLUG AND ABANDON ☐

REMEDIAL WORK ☐

ALTERING CASING ☐

UNPLANNED ABANDON ☐

COMMENCE DRILLING OPS. ☐

PLUG AND ABANDONMENT ☐

REPAIR OR ALTER CASING ☐

CHANGE PLANS ☐

CASING TEST AND CEMENT JOBS ☐

OTHER ☐

OTHER **CHANGE OF OWNERSHIP** ☒

Describe Proposed or Completed Operations (Clearly state all pertinent details, and give pertinent dates, including estimated date of starting any proposed work) SEE RULE 1103.

This is to notify of a change of ownership of the Christopher #1.

We propose to continue drilling well as soon as bond is approved.

New owners and operators are as follows,

JAMES E. SUTTON

JAMES M. TUCKER

I hereby certify that the information above is true and complete to the best of my knowledge and belief.

By *James E. Sutton*

TITLE *Owner*

DATE *11-26-79*

APPROVED BY _____

TITLE _____

DATE _____

CONDITIONS OF APPROVAL, IF ANY:

NO. OF COPIES RECEIVED		
DISTRIBUTION		
UNIT FEE		
FILE		
S.G.S.		
AND OFFICE		
PERATOR		

NEW MEXICO OIL CONSERVATION COMMISSION

Form C-103
Supersedes Old
C-102 and C-103
Effective 1-1-65

NOV 27 1979

C. C. C.

<p>SUNDARY NOTICES AND REPORTS ON WELLS</p> <p>(DO NOT USE THIS FORM FOR PRODUCE TO WELL OR TO FILL IN FIELD BACK TO A DIFFERENT RESERVOIR. USE APPLICATION FOR PERMIT TO PRODUCE (FORM C-101) FOR SUCH PRODUCE.)</p>		<p>5a. Indicate Type of Lease</p> <p>State <input type="checkbox"/> Fee <input checked="" type="checkbox"/></p>
<p>6. State Oil & Gas Lease No.</p>		
<p>7. Unit Agreement Name</p>		
<p>8. Farm or Lease Name</p> <p>CHRISTOPHER</p>		
<p>9. Well No.</p> <p>#1</p>		
<p>10. Field and Pool, or Widout</p> <p>Linda San Andres</p>		
<p>11. Elevation (Show whether DF, RT, GR, etc.)</p> <p>3618.64</p>		<p>12. County</p> <p>Chaves</p>

<p>Check Appropriate Box To Indicate Nature of Notice, Report or Other Data</p>			
<p>NOTICE OF INTENTION TO:</p>		<p>SUBSEQUENT REPORT OF:</p>	
<p>PERFORM REMEDIAL WORK <input type="checkbox"/></p> <p>TEMPORARILY ABANDON <input type="checkbox"/></p> <p>ALL OR ALTER CASING <input type="checkbox"/></p> <p>OTHER CHANGE OF OWNERSHIP <input checked="" type="checkbox"/></p>	<p>PLUG AND ABANDON <input type="checkbox"/></p> <p>CHANGE PLANS <input type="checkbox"/></p>	<p>REMEDIAL WORK <input type="checkbox"/></p> <p>COMMENCE DRILLING OPNS. <input type="checkbox"/></p> <p>CASING TEST AND CEMENT JOBS <input type="checkbox"/></p> <p>OTHER <input type="checkbox"/></p>	<p>ALTERING CASING <input type="checkbox"/></p> <p>PLUG AND ABANDONMENT <input type="checkbox"/></p>

Describe Proposed or Completed Operations (Clearly state all pertinent details, and give pertinent dates, including estimated date of starting any proposed work) SEE RULE 1103.

This is to notify of a change of ownership of the Christopher #1.

We propose to continue drilling well as soon as bond is approved.

New owners and operators are as follows,

JAMES E. SUTTON

JAMES M. TUCKER

hereby certify that the information above is true and complete to the best of my knowledge and belief.

By James E. Sutton TITLE Partner DATE 11-23-79

OVER BY _____ TITLE _____ DATE _____

CONDITIONS OF APPROVAL, IF ANY:

1. OF COPIES RECEIVED		
DISTRIBUTION		
IT A FE		
E		
J.G.S.		
ND OFFICE		
ERATOR		

NEW MEXICO OIL CONSERVATION COMMISSION

Form C-103
Supersedes Old
C-102 and C-103
Effective 1-1-65

5a. Indicate Type of Lease
State ☐ Fee ☒
5. State Oil & Gas Lease No.

SUNDRY NOTICES AND REPORTS ON WELLS
(DO NOT USE THIS FORM FOR PROPOSALS TO ABANDON OR TO REOPEN OR PLUG BACK TO A DIFFERENT RESERVOIR. USE APPLICATION FOR PERMIT TO ABANDON (FORM C-101) FOR SUCH PROPOSALS.)

OIL WELL ☒ GAS WELL ☐ OTHER ☐
Name of Operator
SUTTON AND TUCKER
Address of Operator
1200 East Second Street BIG LAKE, TEXAS 76932
UNIT LETTER **B** **330** FEET FROM THE **North** LINE AND **2310** FEET FROM
THE **East** LINE, SECTION **32** TOWNSHIP **6 south** RANGE **26 East** NMPM.
15. Elevation (Show whether DF, RT, GR, etc.)
3618.64

7. Unit Agreement Name
8. Farm of Lease Name
CHRISTOPHER
9. Well No.
#1
10. Field and Pool, or Variant
Linda San Andres
12. County
Chaves

Check Appropriate Box To Indicate Nature of Notice, Report or Other Data

NOTICE OF INTENTION TO:		SUBSEQUENT REPORT OF:	
FORM REMEDIAL WORK <input type="checkbox"/>	PLUG AND ABANDON <input type="checkbox"/>	REMEDIAL WORK <input type="checkbox"/>	ALTERING CASING <input type="checkbox"/>
UPGRADABLY ABANDON <input type="checkbox"/>	CHANGE PLANS <input type="checkbox"/>	COMMENCE DRILLING OPNS. <input type="checkbox"/>	PLUG AND ABANDONMENT <input type="checkbox"/>
OR ALTER CASING <input type="checkbox"/>	OTHER <input checked="" type="checkbox"/> CHANGE OF OWNERSHIP	CASING TEST AND CEMENT JOBS <input type="checkbox"/>	
		OTHER <input type="checkbox"/>	

Describe Proposed or Completed Operations (Clearly state all pertinent details, and give pertinent dates, including estimated date of starting any proposed work) SEE RULE 1103.

This is to notify of a change of ownership of the Christopher #1.
We propose to continue drilling well as soon as bond is approved.
New owners and operators are as follows,
JAMES E. SUTTON
JAMES M. TUCKER

I hereby certify that the information above is true and complete to the best of my knowledge and belief.

James E. Sutton TITLE Partner DATE 11-26-79
APPROVED BY _____ TITLE _____ DATE _____
CONDITIONS OF APPROVAL, IF ANY:

STATE OF NEW MEXICO
ENERGY AND MINERALS DEPARTMENT

NO. OF COPIES RECEIVED	
DISTRIBUTION	
SANTA FE	
FILE	
U.S.G.S.	
LAND OFFICE	
OPERATOR	

OIL CONSERVATION DIVISION

P. O. BOX 2088
SANTA FE, NEW MEXICO 87501

Form C-103
Revised 10-1-78

FEB 29 1980

5a. Indicate Type of Lease
State ☒ Fee ☐

5. State Oil & Gas Lease No.

SUNDRY NOTICES AND REPORTS ON WELLS

(DO NOT USE THIS FORM FOR PROPOSALS TO DRILL OR TO DEEPEN OR PLUG BACK TO A DIFFERENT RESERVOIR.
USE "APPLICATION FOR PERMIT -" (FORM C-101) FOR SUCH PROPOSALS.)

OIL WELL ☒ GAS WELL ☐ OTHER ☐

Name of Operator

S&S HOT OIL SERVICE I.N.C.

Address of Operator

Location of Well

UNIT LETTER _____, 380 FEET FROM THE NORTH LINE AND 2310 FEET FROM

THE EAST LINE, SECTION 32 TOWNSHIP 6 SOUTH RANGE 26 EAST NMPM.

7. Unit Agreement Name

8. Farm or Lease Name

9. Well No.

10. Field and Pool, or Wildcat

15. Elevation (Show whether DF, RT, GR, etc.)

12. County
CHAVES

Check Appropriate Box To Indicate Nature of Notice, Report or Other Data
NOTICE OF INTENTION TO:

PERFORM REMEDIAL WORK ☐

TEMPORARILY ABANDON ☐

PULL OR ALTER CASING ☐

OTHER FINISH DRILLING ☐

PLUG AND ABANDON ☐

CHANGE PLANS ☐

REMEDIAL WORK ☐

COMMENCE DRILLING OPNS. ☐

CASING TEST AND CEMENT JOB ☐

OTHER CHANGE OF OWNERS ☒

ALTERING CASING ☐

PLUG AND ABANDONMENT ☐

7. Describe Proposed or Completed Operations (Clearly state all pertinent details, and give pertinent dates, including estimated date of starting any proposed work) SEE RULE 1103.

L.L.LIVEOAK P.O.BOX 6588 ROSWELL, NEW MEXICO

I hereby certify that the information above is true and complete to the best of my knowledge and belief.

SIGNED James E. Sutton SR

TITLE Co-Owner

DATE 2-26-80

APPROVED BY _____
CONDITIONS OF APPROVAL, IF ANY:

TITLE _____

DATE _____

C & W WIRELINE, INC. d/b/a BENNETT-CATHEY WELL TESTING

BACK PRESSURE CURVE

Operator Q.T.'S H. SANDERS

Location TEXAS

Well No. 41

County Eddy

Field UNDESIGNATED

Location Sec 7 16.5 25E

Date of Test 3-23-90

Slope "n" .645

Angle of Slope 57.2

Calc. Abs. Potential 907

MOFID

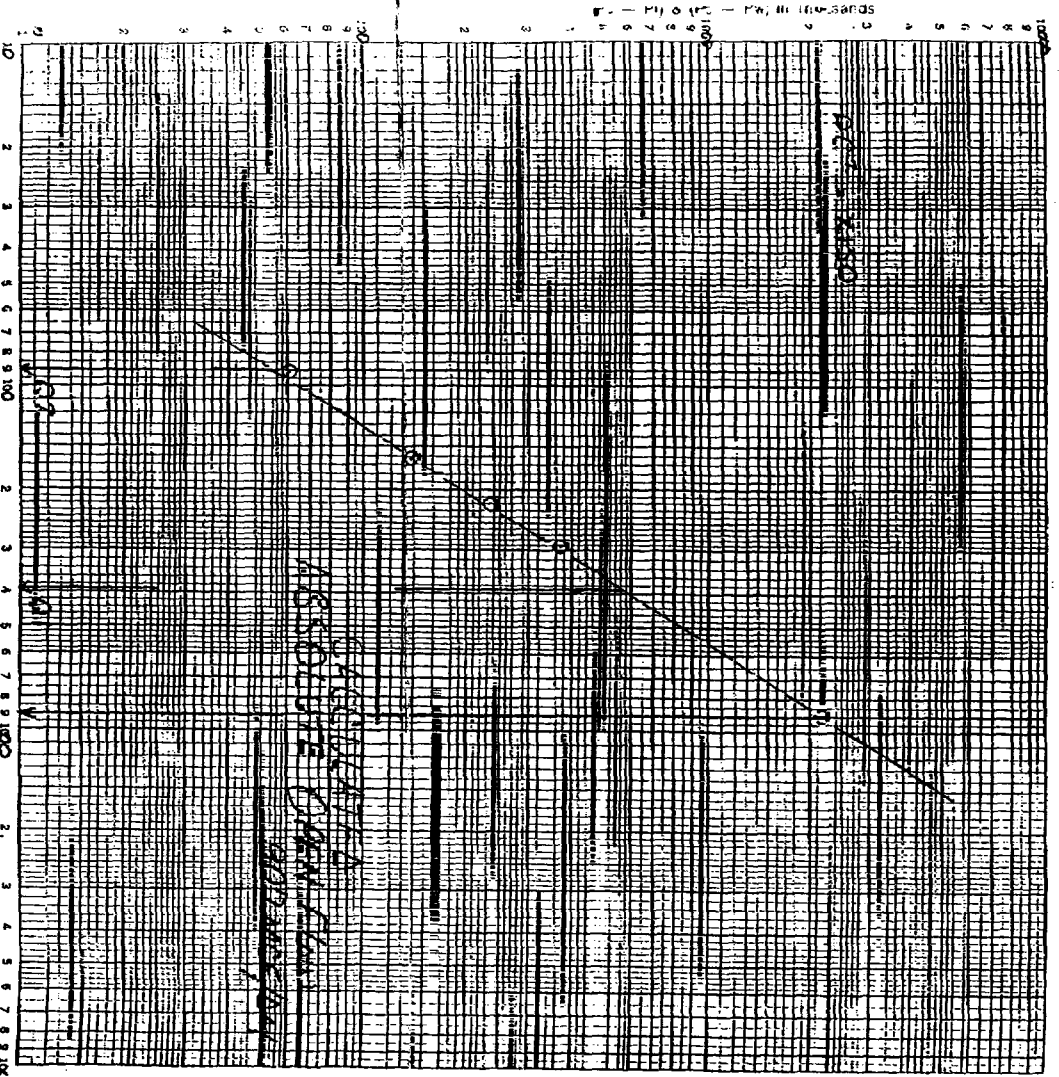

$\Delta P_1 = P_2 - P_w = 540$

Q, Mc/d

LOG $Q_1 = 2.599$

$\Delta P_2 = P_2 - P_w = 54$

LOG $Q_2 = 1.954$

CASE _____:

In the matter of the hearing called by the Oil Conservation Division ("Division") on its own motion to permit Charles W. Harle, operator, American ~~Manufacturers Mutual~~ ^{Employers'} Insurance

Company, surety, and all other interested parties to appear and show cause why the ~~Zimmerman~~ ^{Christopher}

Well No. 1, located ~~660~~ ³³⁰ feet from the North line and ~~1980~~ ²³¹⁰ feet from the ~~West~~ ^{East} line (Unit ~~C~~ ^B) of

Section ~~25~~ ³², Township ~~18~~ ⁶ South, Range ~~25~~ ^{Elkins} East, Chaves County, New Mexico (which is

approximately ~~8~~ ^{15.5} miles ~~east~~ ^{west-northwest} of Roswell, New Mexico), should not be plugged and abandoned in

accordance with a Division-approved plugging program. Should the operator fail to properly

plug said well, the Division should then be authorized to take such action as is deemed necessary

to have said well properly plugged and abandoned and to direct the operator to pay the costs of

such plugging.