

Aztec 14 Fed. Com. #1
1980'FNL, 2180'FWL
W/2 Section 14
T-21-S, R-32-E
Lea County, New Mexico
Case #11747
Date Of Hearing 03/20/97
Exhibit 1

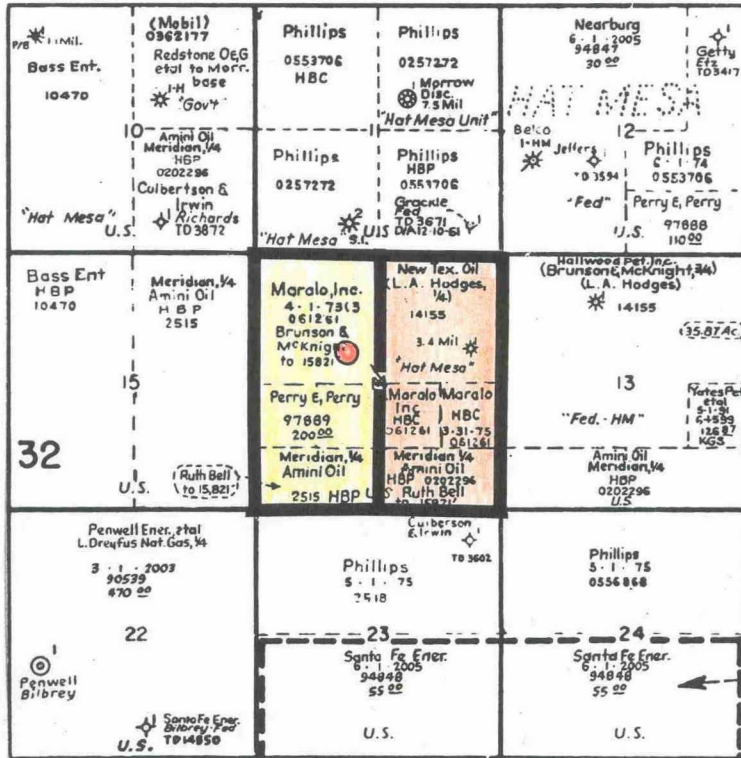

- Proration Unit
- Affected Acreage
- Location

BEFORE THE
OIL CONSERVATION DIVISION
 Case No. 11747 Exhibit No.
 Submitted By:
Nearburg Exploration Co.
 Hearing Date: March 20, 1997