



STATE OF NEW MEXICO  
ENERGY, MINERALS AND NATURAL RESOURCES DEPARTMENT

OIL CONSERVATION DIVISION

POST OFFICE BOX 1980  
HOBBS, NEW MEXICO 88241-1980  
(505) 393-6161

August 4, 1997

*File 7798*

Mike Moylett  
Collins & Ware, Inc.  
508 West Wall Avenue, Suite 1200  
Midland, Texas 79701

Re: G-O-R Limit, Warren;Tubb, East, Pool

Gentlemen:

The purpose of this letter is to state the Oil Conservation Division, District I, support for a higher G-O-R limit for the Warren;Tubb, East, Oil Pool.

This support is based on the geology of the Blinebry and Tubb Pools, near Eunice, New Mexico.

As can be seen from the attached maps, with development drilling, the Blinebry pools and the Tubb Pools have merged together.

In the Blinebry formation, the Blinebry Oil & Gas Pool, the Eunice; Blinebry-Tubb-Drinkard, North, Pool, and the Warren;Blinebry-Tubb Oil & Gas Pool, is one continuous reservoir for production in the Blinebry formation.

The Warren;Tubb (Gas) Pool, Warren;Tubb, East, Pool, the Warren;Blinebry-Tubb Oil & Gas Pool, and the Tubb Oil & Gas Pool is one continuous reservoir for production in the Tubb formation.

These pools were developed under different pool rules. In the Tubb formation, these include:

|   |                         |
|---|-------------------------|
| Warren;Tubb, East, Pool                 | 2000 to 1 G-O-R limit   |
| Warren:Blinebry-Tubb Oil & Gas Pool     | Exempt from G-O-R limit |
| Eunice;Blinebry-Tubb-Drinkard, No. Pool | 6000 to 1 G-O-R limit   |
| Tubb Oil & Gas Pool                     | 2000 to 1 G-O-R limit   |

Page -2-

I believe that taking the G-O-R limit into consideration, when the Warren;Blinebry-Tubb Oil & Gas Pool has no G-O-R limit and the Warren;Tubb, East, Pool is limited to a G-O-R of 2000 to 1, you are not protecting correlative rights.

Very truly yours

OIL CONSERVATION DIVISION



Paul F. Kautz  
Geologist, III, District I

cc: Oil Conservation Commission, c/o William J. LeMay  
File

Enclosures:  
Blinebry Pool Map  
Tubb Pool Map



TUBB

R 38 E

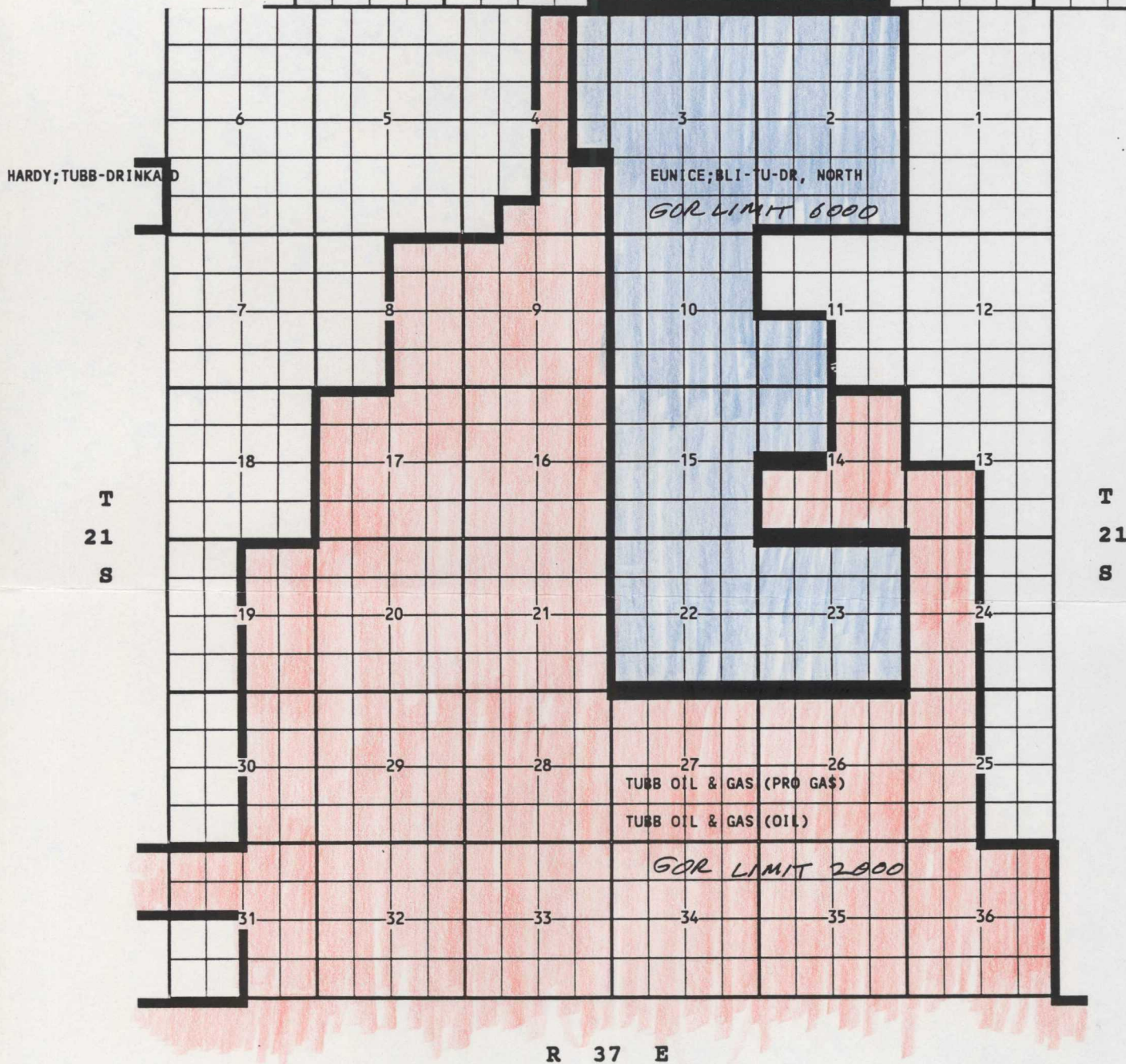
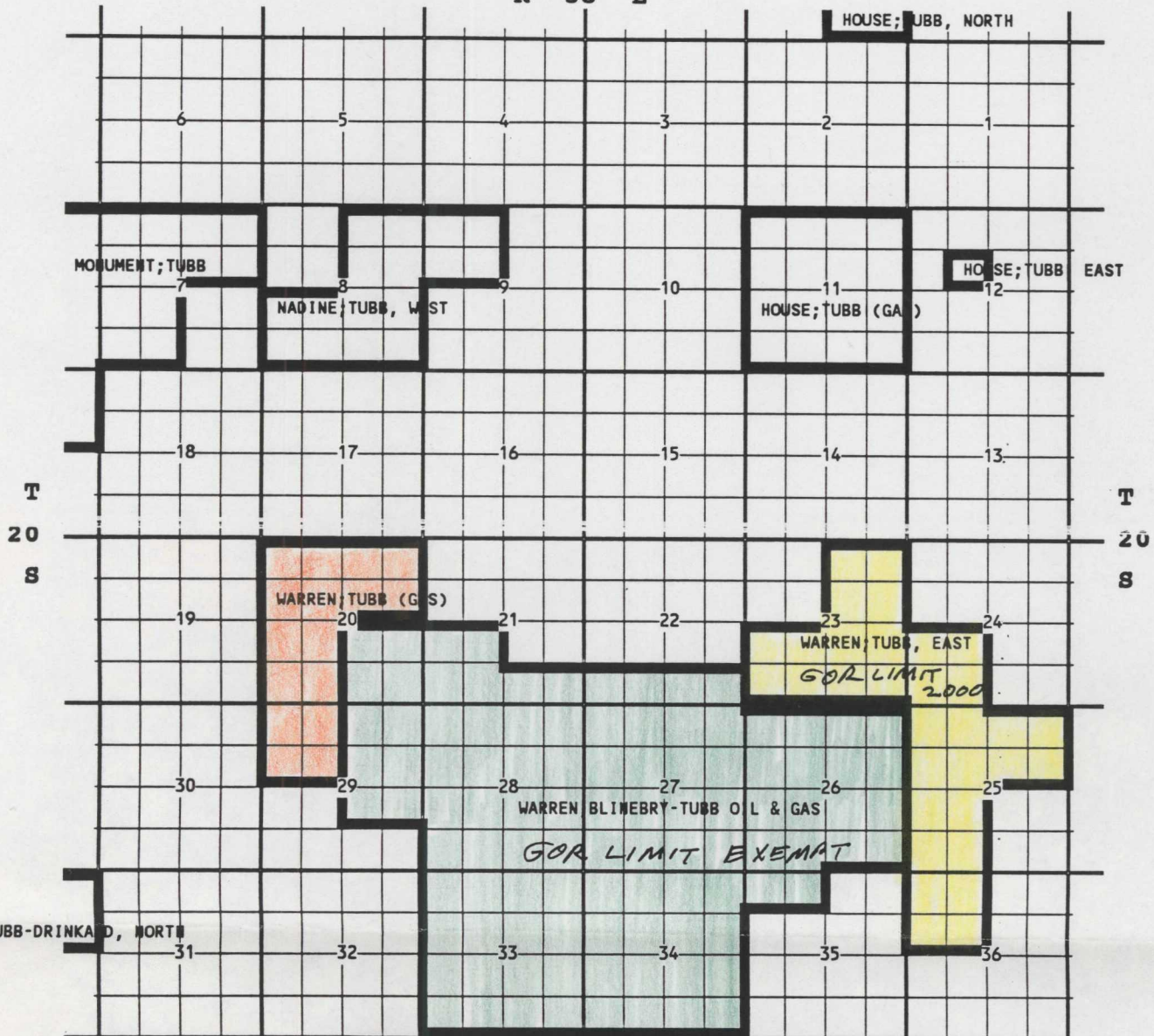

R 37 E



BLINEBRY

R 38 E

S 20 T

S 20 T

HOUSE; LINEBRY SOUTH

WEIR; BLINEBRY EAST

MADINE PADDOCK-BLINEBRY, WEST

HOUSE; LINEBRY

TERY; BLINEBRY, EAST

HARDY; BLINEBRY

S 21 T

S 21 T

R 37 E

GOR LIMIT 4000

BLINEBRY OIL & GAS (OIL)  
BLINEBRY OIL & GAS (PROD GAS)

GOR LIMIT 6000

EUNICE; BLI-TU-DR, NORTH

GOR EXEMPT

WARREN BLINEBRY-TUBB O L & GAS

GOR L. 4000

BLINEBRY OIL & GAS (OIL)

BLINEBRY OIL & GAS (PROD GAS)