

PLC 4/20/00

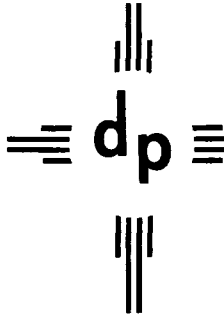

# dugan production corp.

March 29, 2000

#12389

Ms. Lori Wrotenbery, Director  
New Mexico Oil Conservation Division  
2040 South Pacheco Street  
Santa Fe, NM 87505

Mr. Ray Powell, Commissioner  
New Mexico State Land Office  
PO Box 1148  
Santa Fe, NM 87504-1148

**RECEIVED**

MAR 31 2000

Oil Conservation Division

Mr. Lee Otteni, Manager  
Bureau of Land Management - Farmington Field Office  
1235 La Plata Highway  
Farmington, NM 87401

Re: Add 3 wells to Com 1E CDP - Plus Surface Commingling, off-lease measurement and Sale of Natural Gas - Dugan Production's, Com No. 4, Federal I No. 99, and Tabor Com No. 90, San Juan County, New Mexico

Dear Ms. Wrotenbery, Mr. Powell, and Mr. Otteni,

We are writing to request your administrative approvals to add 3 wells, Dugan's Com No. 4, Federal I No. 99, and Tabor Com No. 90 to the central delivery sales meter (CDP) currently authorized for Dugan's Com No. 1E and No. 2 wells. This will also require the surface commingling of natural gas and water, plus the off lease measurement and sale of natural gas produced from the Com No. 4, Federal I No. 99, and Tabor Com No. 90. All condensate or oil produced from any of the wells will be separated, stored and sold at the individual well sites and will not be included in the Tabor Gathering System. Currently only one well, the Com No. 1E produces a small amount of condensate.

The Com No. 1E CDP (located in Unit A, Section 2, T-29N, R-14W, at the Com No. 1E well site) and surface commingling of natural gas from the Com No. 1E and Com No. 2 was approved by the New Mexico State Land Office (NMSLO) on 7-17-96, the Bureau of Land Management (BLM) on 7-30-96 and the New Mexico Oil Conservation Division (NMOCD) on 8-19-96 (NMOCD Order R-10655). This CDP was placed into service during 9/96 and has allowed the Com No. 1E and Com No. 2 to be produced using only one compressor.

Dugan Production has recently completed the Com No. 4, Federal I No. 99, and the Tabor Com No. 90, and all 3 wells will require wellhead compression to deliver gas into El Paso's system which is currently being operated at a pressure of ±250 psi and at times the pressure will approach 350 psi. We are proposing to install a gathering system to deliver production from these 3 wells (water and natural gas) to the Com No. 1E CDP. Each of these 3 wells are completed in either the Basin Fruitland Coal or the Harper Hill Fruitland Sand-Pictured Cliffs Gas Pool, and produce a significant volume of water along with natural gas. None of the 3 wells produce any condensate or oil. We are proposing to

produce natural gas from each well up the casing-tubing annulus and after metering the gas at the individual well site, using a conventional meter run and Barton dry flow meter, transport the gas to the central battery where it will be collected and compressed using a central compressor for delivery to the Com No. 1E CDP sales meter.

The water from each well, plus any natural gas that is associated with the water production, will be produced up the tubing (likely with rod pump artificial lift equipment) and will be transported to the central battery in a separate line. At the central battery, the produced water streams will be commingled and any associated natural gas will be separated. The water will be transferred to water storage tanks at the central battery and then transferred to Dugan Production's Stella Needs A Com Water Disposal System using a water injection pump also located at the central battery. The natural gas separated from the water at the central battery will be metered using a conventional gas meter run equipped with a Barton dry flow meter, and after metering, the gas will be delivered to the central compressor for compression and sale. This meter will be of similar design to the gas metering equipment located at each well. The gas recovered from the central battery water separator will be allocated to the individual wells contributing production to the separator based upon the volumes of water each well produced. Attachment No. 7 presents a sketch of the central battery and the proposed allocation procedures for water and gas are presented on Attachment No. 6. The water production rates will be periodically tested at each well using Dugan's portable, 3 phase test unit. The test frequency will be based upon need as determined by volumes at the central battery; i.e. any changes of significance in the total volume will indicate the need for retesting each well.

Attachment No. 1 was reproduced from portions of the Youngs Lake and Kirtland USGS Quadrangle Topography maps and presents Dugan Production's proposed Tabor Gathering System. In addition, the subject wells and Dugan's leases are also identified. We are currently securing the necessary rights-of-way for this gathering system.

Attachment No. 2 presents individual well and lease information and attachment No. 3 presents the C-102 for each of the five wells, along with the dedicated spacing units and associated leases. A total of four Federal (NM-33051, NM-101992, NM-0206995, and SF-078110), four State (B-11242, E-2526, E-6714, and LG-3736), and two Fee (Dugan's King and Winifred) leases are involved. Dugan Production Corp. is the operator of all 5 wells and holds 100% of the working interest in 4 of the 5 wells. Conoco holds a 6.3% working interest in the Com No. 1E with Dugan holding the balance of the working interest. The ownership for each well is presented in Attachment No.4. Page No. 1 presents a summary for all wells and pages 2 through 5 present the specific data for each well.

The Com No. 1E and Com No. 2 both produce through a common compressor and have established production histories which are presented in Attachment No. 5. The Com No. 1E is currently averaging 45 MCFD and 0.3 bbl of condensate per day from the Basin Dakota gas pool and the Com No. 2 is averaging 17 MCFD from the Harper Hill Fruitland Sand-Pictured Cliffs gas pool. As can be seen from the production curves in Attachment No. 5, production from both wells has fairly stable for the past 8 - 10 years. The Com No. 4 was completed in the Harper Hill Fruitland Sand - Pictured Cliffs gas pool on 12-7-99 and was first delivered into El Paso's system on 2-2-2000. During February, production averaged 360 MCFD plus 105 BWPD and required wellhead compression to produce into El Paso's system. The Federal I No. 99 was completed on 12-9-99 in the Basin Fruitland Coal pool testing 143 MCFD plus 85 BWPD. The well is currently shut in and will require wellhead compression to produce into El Paso's pipeline. The Tabor Com No. 90 was completed on 12-6-99 in the Basin Fruitland Coal

pool and tested 130 MCFD plus 75 BWPD. The Tabor Com 90 is also shut in and will require wellhead compression to produce into the pipeline.

The proposed Tabor Gathering System will allow all five wells to be produced using only one compressor and will also allow the water production to be transported for disposal by pipeline at a cost of 50¢ to 75¢ per barrel, rather than by hauling with a truck at a cost of \$1.50 to \$3.00/bbl. At the current water volumes, it will be necessary to haul 3 to 4 loads per day. Thus, pipelining the water for disposal will save between \$265 and \$600/day (\$8000 to \$18,000/month) in operating expenses along with a reduction in road wear and tear plus maintenance. In addition, the gas gathering system will eliminate the need to operate individual compressors which will reduce fuel requirements (with a corresponding increase in volumes available for sale) and will allow for reduced compressor noise and exhaust emissions, both of which are important considering the proximity of these wells to the cities of Farmington and Kirtland.

Production from all 3 formations to be surface commingled is compatible and mixing will not create any operational problems. Attachment No. 8 presents copies of gas analyses from the Basin Dakota (Com 1E), Harper Hill Fruitland Sand-Pictured Cliffs (Com No. 2 as representative of the Com 2 & Com 4), and the Basin Fruitland Coal (O'Henry #1 located in N-36-30N-14W, approximately 1 mile to the east as representative of the Federal I No. 99 and Tabor Com No. 90). Since the Com No 1E & Com No.2 have been surface commingled since 9/96, the analyses presented were taken prior to surface commingling to eliminate any question as to representative samples. Mixing of these three gasses will not affect the value of any of the three.

We are sending copies of this application to all interest owners and Attachments No. 9 and 10 present copies of the transmitted letters to the working interest, plus the royalty and overriding royalty interest owners, respectively.

In summary, we are proposing to add 3 recently completed wells to Dugan's existing central delivery sales meter for the Com No. 1E and Com No 2 wells. In addition, we are proposing a gathering system which will allow produced water to be transported for disposal by pipeline rather than trucking. The net result will be eliminating the need to haul 3 to 4 loads of water per day and the operation of only one compressor rather than four. Thus the Tabor Gathering System will reduce water truck traffic and will allow significant reduction of noise and exhaust emissions in an area close to the cities of Farmington and Kirtland. In addition, there will be an increased volume of gas available for sale which otherwise would have been needed for compressor fuel, had each well required a separate wellhead compressor.

Should you have any questions or need additional information, please let me know.

Sincerely,

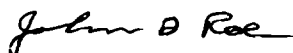

John D. Roe  
Engineering Manager

cc: All interest owners  
NMOCD - Aztec

*Attachment No. 1*  
*Dugan Production Corp*  
*Tabor Gathering System*  
*San Juan County*  
*New Mexico*

Lease Key		
Letter	Lease Name	Lease No.
A	Camp David	VA-310
B	Camp David Com	E-3149
C	Com/O Henry	E-6714
D	Com Lease 2	LG-3736
E	Com Lease 3	B-11242
F	Com Lease 4	E-2526-9
G	Com Lease 5	E-3555-8
H	Com Lease 6	V-5411
I	Com Lease 7	NM-101992
J	Federal I	SF-078110
K	Jiggs	NM-0206995
L	King	Fee
M	Stella Needs a Com	B-011571
N	Tabor	NM-33051
O	Winifred	Fee
P	King Com	Fee

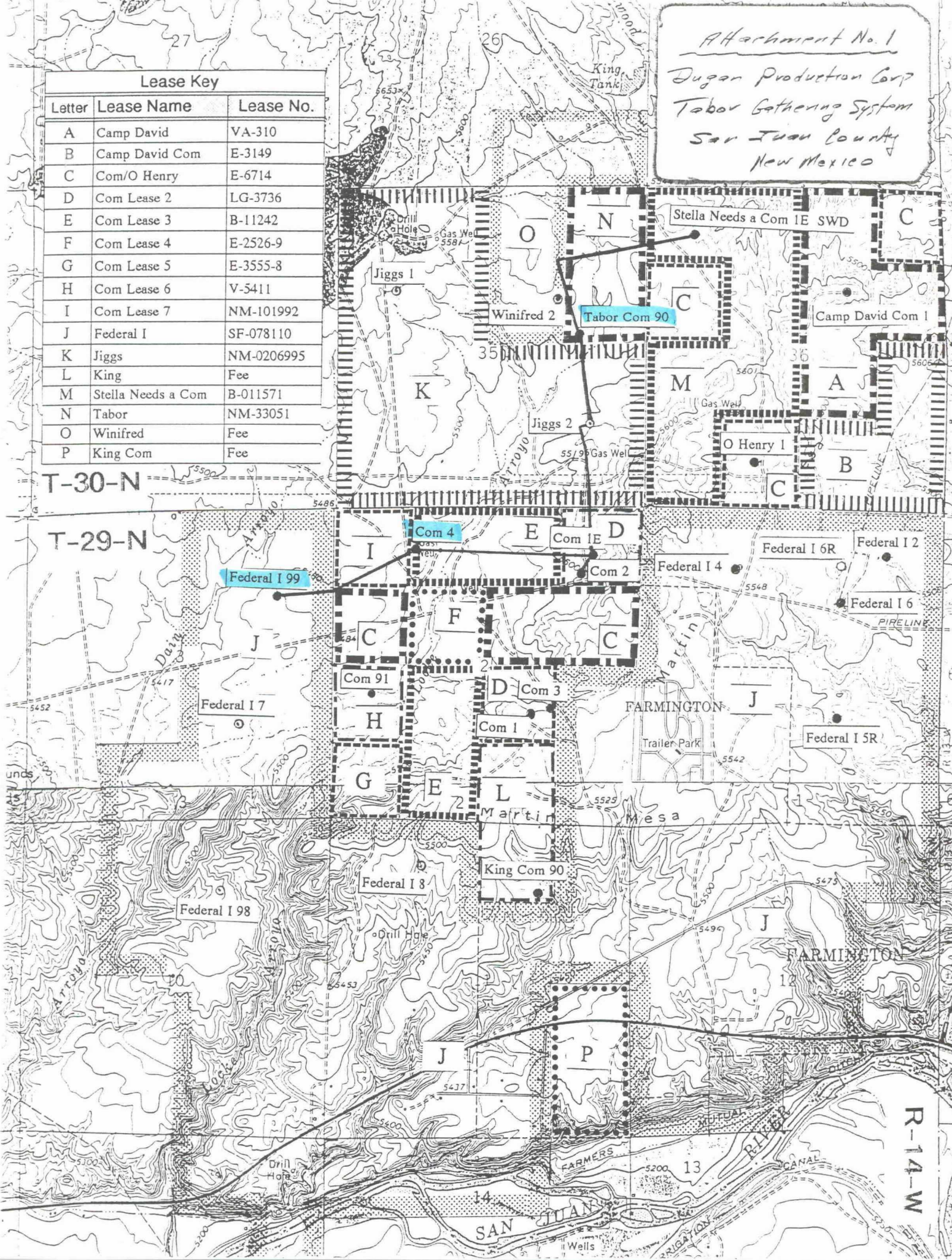

**ATTACHMENT No. 2  
 DUGAN PRODUCTION CORP.  
 PROPOSED TABOR GAS GATHERING SYSTEM AND CDP  
 SAN JUAN COUNTY, NEW MEXICO**

Well Name	API Number	Well Location		Well Location		CA Number	Pool	Compl. Date	Current Prod.		Spacing Unit
		Unit	Sec-Twn-Rng	Lease No.	Lse.Type				MCFD	BC/D	

Wells Approved for CDP

Com No. 1E	30-045-23940	A	2-29N-14W	LG-3736	State	14080017765	Basin Dakota	12/8/79	45(1)	0.3	E2-316.65A
Com No. 2	30-045-23199	A	2-29N-14W	LG-3736	State	State C.A.	Harper Hill FrSd/PC	10/2/78	17(1)	0	NE-156.65A

Wells to be Added to CDP

Com No. 4	30-045-29986	C	2-29N-14W	B-11242	State	Pending	Harper Hill FrSd/PC	12/7/99	382(2)	0	NW-157.95A
Federal I No.99	30-045-29989	H	3-29N-14W	SF-078110	Federal	N/A	Basin Fruitland Coal	12/9/99	0(3)	0	E2-318.45A
Tabor Com 90	30-045-29994	H	35-30N-14W	NM-33051	Federal	NMNM102982	Basin Fruitland Coal	12/6/99	0(4)	0	E2-332.49A

- N/A Not Needed
- (1) Average during Jan. 2000. Cum production 2-1-2000: Com #1E=742,650 MCF + 7,552 bbl condensate, Com #2 = 235,528 MCF.
- (2) Well first delivered into El Paso's pipeline 2-2-2000. Production is average for 2/2000 - Water production = 105 BWPD
- (3) Well is shut in waiting on pipeline connection - Test during completion 12/99 - SITP = 280psig, est rate = 143 MCFD + 85 BWPD
- (4) Well is shut in waiting on pipeline connection - Test during completion 12/99 - SITP = 310psig, est rate = 130 MCFD + 75 BWPD

Attachment  
No. 3  
P 71 of 5

NEW MEXICO OIL CONSERVATION COMMISSION  
WELL LOCATION AND ACREAGE DEDICATION PLAT

Form C-102  
Supersedes C-12A  
Effective 1-1-65

All distances must be from the outer boundaries of the Section.

Operator <b>Dugan Production Corporation</b>		Lease		Well No. <b>Com 1 E</b>	
Unit Letter <b>A</b>	Section <b>2</b>	Township <b>29 North</b>	Range <b>14 West</b>	County <b>San Juan</b>	
Actual Footage Location of Well:					
<b>810</b>	feet from the	<b>North</b>	line and	<b>940</b>	feet from the
Ground Level Elev. <b>5534</b>	Producing Formation <b>Dakota</b>		Pool <b>Basin</b>	Dedicated Acreage: <b>316.65</b> Acres	

1. Outline the acreage dedicated to the subject well by colored pencil or hachure marks on the plat below.
2. If more than one lease is dedicated to the well, outline each and identify the ownership thereof (both as to working interest and royalty).
3. If more than one lease of different ownership is dedicated to the well, have the interests of all owners been consolidated by communitization, unitization, force-pooling, etc?

Yes     No    If answer is "yes," type of consolidation Communitization

If answer is "no," list the owners and tract descriptions which have actually been consolidated. (Use reverse side of this form if necessary.) \_\_\_\_\_

No allowable will be assigned to the well until all interests have been consolidated (by communitization, unitization, forced-pooling, or otherwise) or until a non-standard unit, eliminating such interests, has been approved by the Commission.

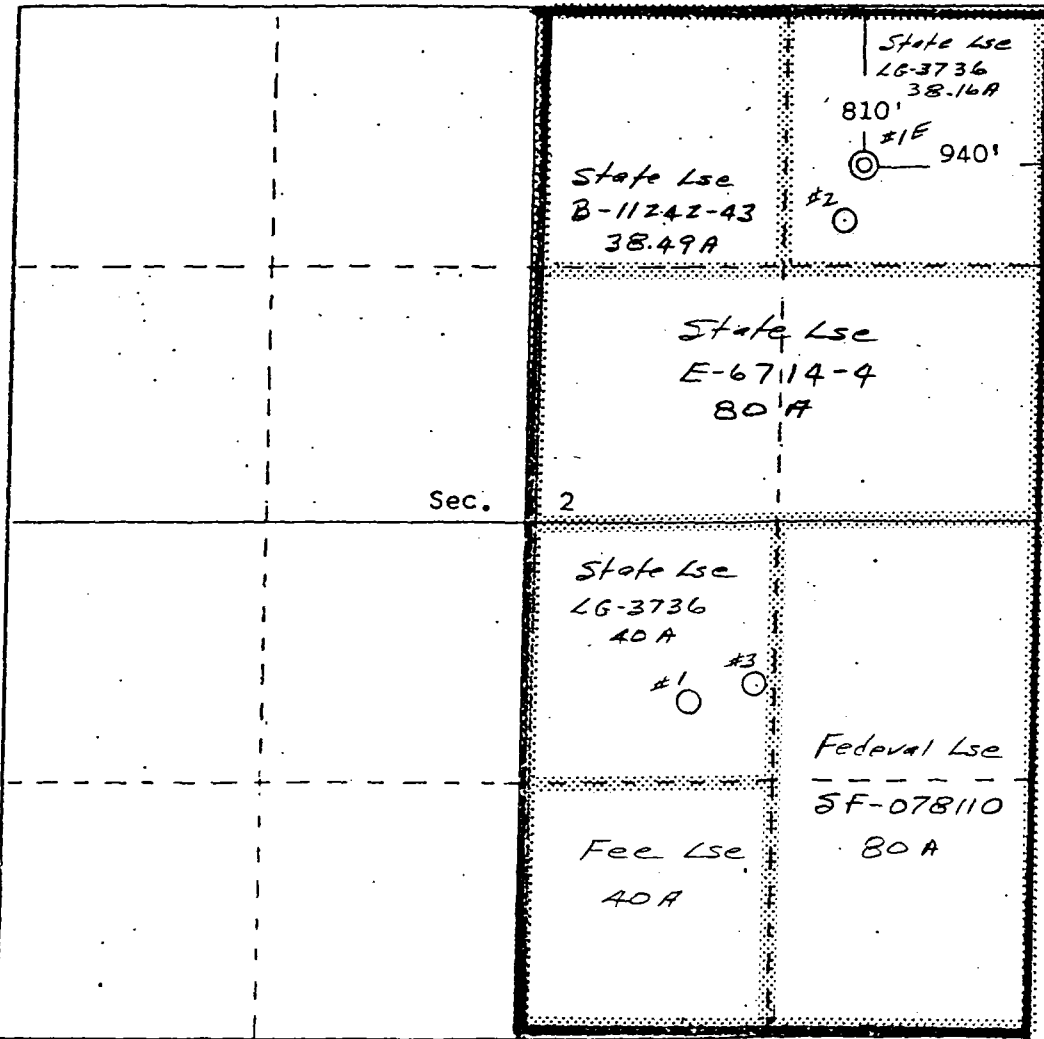

**CERTIFICATION**

I hereby certify that the information contained herein is true and complete to the best of my knowledge and belief.

*Thomas A. Dugan*

Name	Thomas A. Dugan
Position	Petroleum Engineer
Company	Dugan Production Corp.
Date	11-1-79

I hereby certify that the location shown on this plat was derived from field notes of actual surveys made by me or under my supervision, and that the same is true and correct to the best of my knowledge and belief.

**EDGAR L. RISENHOVER**  
REGISTERED LAND SURVEYOR  
NEW MEXICO  
5979

Date Surveyed	October 30, 1979
Registered Professional Engineer and/or Land Surveyor	<i>Edgar L. Risenhoover</i> Certificate No. 5979

Edgar L. Risenhoover, L.S.

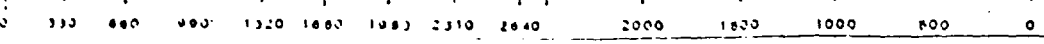

Attachment  
No. 3  
Pg 2 of 5

NEW MEXICO OIL CONSERVATION COMMISSION  
WELL LOCATION AND ACREAGE DEDICATION

Form O-16  
Supersedes O-10  
Effective 1-1-79

All distances must be from the outer boundaries of the section.

Operator <b>Dugan Production Corporation</b>		Lease <b>Com</b>		Well No. <b>2</b>
Unit Letter <b>A</b>	Section <b>2</b>	Township <b>29 North</b>	Range <b>14 West</b>	County <b>San Juan</b>
Actual Footage Location of Well:				
<b>1125</b>	feet from the	<b>North</b>	line and	<b>1070</b>
				feet from the
				<b>East</b>
Ground Level Elev. <b>5511</b>	Producing Formation <b>Fruitland - PC</b>		Pool <b>Harper Hill FR Sand PC</b>	Dedicated Acreage: <b>156.65</b> Acres

- Outline the acreage dedicated to the subject well by colored pencil or hatchure marks on the plat below.
- If more than one lease is dedicated to the well, outline each and identify the ownership thereof (both as to working interest and royalty).
- If more than one lease of different ownership is dedicated to the well, have the interests of all owners been consolidated by communitization, unitization, force-pooling, etc?  
 Yes     No    If answer is "yes," type of consolidation Communitization approved January 2, 1979  
copy attached hereto  
 If answer is "no," list the owners and tract descriptions which have actually been consolidated. (Use reverse side of this form if necessary.) \_\_\_\_\_  
 No allowable will be assigned to the well until all interests have been consolidated (by communitization, unitization, forced-pooling, or otherwise) or until a non-standard unit, eliminating such interests, has been approved by the Commission.

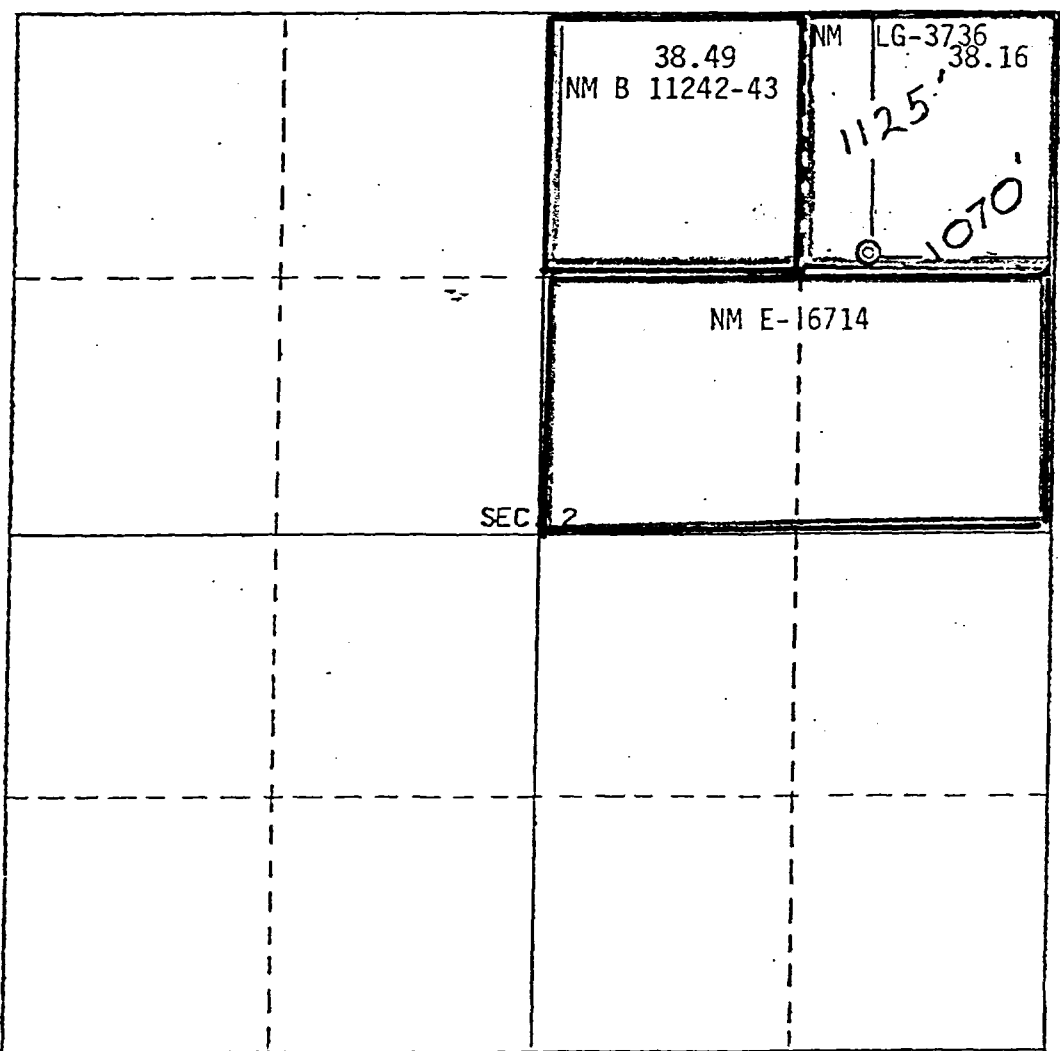

**CERTIFICATION**

I hereby certify that the information contained herein is true and complete to the best of my knowledge and belief.

*Jim L Jacobs*  
 Name  
**Jim L Jacobs**  
 Position  
**Geologist**  
 Company  
**Dugan Production Corp.**  
 Date  
**September 21, 1990**

Date Surveyed  
**July 13, 1978**  
 Registered Professional Engineer  
 and/or Land Surveyor  
*E. V. Echohawk*  
 Certificate No. **3602**  
**E. V. Echohawk LS**

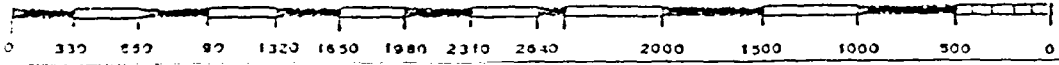

District I  
 PO Box 1980, Hobbs, NM 88241-1980  
 District II  
 PO Drawer DD, Artesia, NM 88211-0719  
 District III  
 1000 Rio Brazos Rd., Aztec, NM 87410  
 District IV  
 PO Box 2083, Santa Fe, NM 87504-2083

State of New Mexico  
 Energy, Minerals & Natural Resources Department

OIL CONSERVATION DIVISION  
 PO Box 2088  
 Santa Fe, NM 87504-2088

Form C-102  
 Revised February 21, 1994  
 Instructions on back  
 Submit to Appropriate District Office  
 State Lease - 4 Copies  
 Fee Lease - 3 Copies

Attachment  
 No. 3  
 Pg 3 of 5

AMENDED REPORT

WELL LOCATION AND ACREAGE DEDICATION PLAT

1 API Number 30 045 - 29986		1 Pool Code 78160		1 Pool Name Harper Hill Fruitland Sand PC	
2 Property Code 003621		Com		1 Property Name	
1 OGRID No. 006515		Dugan Production Corporation		1 Well Number 4	
				1 Operator Name	
				1 Elevation 5466	

10 Surface Location

UL or lot no.	Section	Township	Range	Lot Ida	Feet from the	North/South line	Feet from the	East/West line	County
C	2	29N	14W	C	790	North	1450	West	San Juan

11 Bottom Hole Location If Different From Surface

UL or lot no.	Section	Township	Range	Lot Ida	Feet from the	North/South line	Feet from the	East/West line	County

12 Dedicated Acres 157.95	13 Joint or Infill	14 Consolidation Code	15 Order No.
------------------------------	--------------------	-----------------------	--------------

NO ALLOWABLE WILL BE ASSIGNED TO THIS COMPLETION UNTIL ALL INTERESTS HAVE BEEN CONSOLIDATED OR A NON-STANDARD UNIT HAS BEEN APPROVED BY THE DIVISION

	Section 2	<b>17 OPERATOR CERTIFICATION</b> I hereby certify that the information contained herein is true and complete to the best of my knowledge and belief.  Signature Sherman E. Dugan Printed Name Vice-president Title September 21, 1999 Date
		<b>18 SURVEYOR CERTIFICATION</b> I hereby certify that the well location shown on this plat was plotted from field notes of actual surveys made by me or under my supervision, and that the same is true and correct to the best of my belief. August 31, 1999 Date of Survey Signature and Seal of Surveyor:  Certificate Number



District I  
 PO Box 1980, Hobbs, NM 88241-1980  
 District II  
 PO Drawer DD, Artesia, NM 88211-0719  
 District III  
 1000 Rio Brazos Rd., Aztec, NM 87410  
 District IV  
 PO Box 2088, Santa Fe, NM 87504-2088

State of New Mexico  
 Energy, Minerals & Natural Resources Department

Form C-102  
 Revised February 21, 1994  
 Instructions on back  
 Submit to Appropriate District Office  
 State Lease - 4 Copies  
 Fee Lease - 3 Copies

OIL CONSERVATION DIVISION  
 PO Box 2088  
 Santa Fe, NM 87504-2088

Attachment  
 No. 3  
 Pg 4 of 5

AMENDED REPORT

WELL LOCATION AND ACREAGE DEDICATION PLAT

1 API Number 30 045 29989		2 Pool Code 71629		3 Pool Name Basin Fruitland Coal	
4 Property Code 003682		5 Property Name Federal 1			6 Well Number 99
7 OGRID No. 006515		8 Operator Name Dugan Production Corporation			9 Elevation 5468

10 Surface Location

UL or lot no.	Section	Township	Range	Lot Idn	Feet from the	North/South line	Feet from the	East/West line	County
H	3	29N	14W	H	1483	North	1106	East	San Juan

11 Bottom Hole Location If Different From Surface

UL or lot no.	Section	Township	Range	Lot Idn	Feet from the	North/South line	Feet from the	East/West line	County

12 Dedicated Acres 318.45 <del>320</del>	13 Joint or Infill	14 Consolidation Code	15 Order No.
--	--------------------	-----------------------	--------------

NO ALLOWABLE WILL BE ASSIGNED TO THIS COMPLETION UNTIL ALL INTERESTS HAVE BEEN CONSOLIDATED OR A NON-STANDARD UNIT HAS BEEN APPROVED BY THE DIVISION

16	Section 3	DPC SF-078110		<p>17 OPERATOR CERTIFICATION</p> <p>I hereby certify that the information contained herein is true and complete to the best of my knowledge and belief</p> <p><i>Sherman E. Dugan</i>          Signature          Sherman E. Dugan          Printed Name          Vice-President          Title          9-22-99          Date</p>
				<p>18 SURVEYOR CERTIFICATION</p> <p>I hereby certify that the well location shown on this plat was plotted from field notes of actual surveys made by me or under my supervision, and that the same is true and correct to the best of my belief.</p> <p>August 31, 1999          Date of Survey          Signature and Title of Professional Surveyor            5979          Certificate Number</p>

District I  
 PO Box 1980, Hobbs, NM 88241-1980  
 District II  
 PO Drawer DD, Artesia, NM 88211-0719  
 District III  
 1000 Rio Brazos Rd., Aztec, NM 87410  
 District IV  
 PO Box 2088, Santa Fe, NM 87504-2088

State of New Mexico  
 Energy, Minerals & Natural Resources Department

Form C-102  
 Revised February 21, 1994  
 Instructions on back  
 Submit to Appropriate District Office  
 State Lease - 4 Copies  
 Fee Lease - 3 Copies

OIL CONSERVATION DIVISION  
 PO Box 2088  
 Santa Fe, NM 87504-2088

Attachment  
 No. 3  
 Pg 5 of 5

AMENDED REPORT

WELL LOCATION AND ACREAGE DEDICATION PLAT

API Number 30 045 - 29994		Pool Code 71629	Pool Name Basin Fruitland Coal
Property Code	Property Name Tabor Com		Well Number 90
OGRID No. 006515	Operator Name Dugan Production Corporation		Elevation 5498

10 Surface Location

UL or lot no.	Section	Township	Range	Lot Ida	Feet from the	North/South line	Feet from the	East/West line	County
H	35	30N	14W	H	2510	North	1100	East	San Juan

11 Bottom Hole Location If Different From Surface

UL or lot no.	Section	Township	Range	Lot Ida	Feet from the	North/South line	Feet from the	East/West line	County

Dedicated Acres 332.49 <del>320</del>	Joint or Infill	Consolidation Code	Order No.
---	-----------------	--------------------	-----------

NO ALLOWABLE WILL BE ASSIGNED TO THIS COMPLETION UNTIL ALL INTERESTS HAVE BEEN CONSOLIDATED OR A NON-STANDARD UNIT HAS BEEN APPROVED BY THE DIVISION

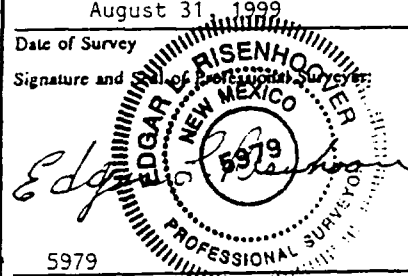
16	Section 35	Fee	DPC NM-33051	<p>17 OPERATOR CERTIFICATION</p> <p>I hereby certify that the information contained herein is true and complete to the best of my knowledge and belief</p> <p><i>Sherman E. Dugan</i>          Signature          Sherman E. Dugan          Printed Name          Vice-president          Title          9-22-99          Date</p>
		DPC NM-0206995		<p>18 SURVEYOR CERTIFICATION</p> <p>I hereby certify that the well location shown on this plat was plotted from field notes of actual surveys made by me or under my supervision, and that the same is true and correct to the best of my belief.</p> <p>August 31, 1999          Date of Survey          Signature and Seal of Professional Surveyor            5979          Certificate Number</p>

**ATTACHMENT NO. 4 - Pg 1 of 6**  
**Interest Ownership Summary**  
**Proposed Tabor Central Gathering System**  
**Dugan Production Corp.**  
**San Juan County, New Mexico**

	<u>Com No. 1E</u> (Details on Pg 2)		<u>Com No. 2</u> (Details on Pg 3)		<u>Com No. 4</u> (Details on Pg 4)		<u>Federal I No. 99</u> (Details on Pg 5)		<u>Tabor Com No. 90</u> (Details on Pg 6)	
	<u>WI</u>	<u>NI</u>	<u>WI</u>	<u>NI</u>	<u>WI</u>	<u>NI</u>	<u>WI</u>	<u>NI</u>	<u>WI</u>	<u>NI</u>
<u>Working Interest Owners</u>										
Dugan Production Corp.	93.684	81.366	100.00	79.888	100.00	74.479	100.00	87.50	100.00	79.237
Conoco, Inc.	6.316	5.527	-0-	-0-	-0-	-0-	-0-	-0-	-0-	-0-
<u>Royalty Interest Owners</u>										
USA - Federal	-0-	3.158	-0-	-0-	-0-	3.097	-0-	12.50	-0-	9.492
State of New Mexico	-0-	7.763	-0-	12.50	-0-	9.403	-0-	-0-	-0-	-0-
Rilla E. King	-0-	1.579	-0-	-0-	-0-	-0-	-0-	-0-	-0-	-0-
Patricia Harbin	-0-	-0-	-0-	-0-	-0-	-0-	-0-	-0-	-0-	1.504
Muench Family Trust	-0-	-0-	-0-	-0-	-0-	-0-	-0-	-0-	-0-	1.504

Overriding Royalty Interest Owners

Number of Owners	8	9	14	0	0	3
Total ORRI	0.608	7.612	13.021	0	0	8.263
Detail on Page No.	2	3	4	5	5	6

**TOTALS**      100,000   100,000   100,000   100,000   100,000   100,000   100,000   100,000   100,000

**ATTACHMENT 4, Pg 2 of 6**  
**Dugan Production Corp.**  
**Com Well No. #1E**  
**Basin Dakota Pool**  
**Well Location: NE/4 NE/4 Sec. 2-T29N-R14W**  
**Spacing Unit: E/2 Sec. 2-T29N-R14W - 316.65 Acres**  
**San Juan County, NM**

<u><b>INTEREST OWNER</b></u>	<u><b>INTEREST - %</b></u>	
	<u><b>Net</b></u>	<u><b>Gross</b></u>
<u>Royalty</u>		
State of New Mexico, State Land Office P.O. Box 1148 Santa Fe, NM 87504-1148	7.762910	0.00
USA - Bureau of Land Management 1235 La Plata Hwy. Farmington, NM 87401	3.158070	0.00
Rilla E. King P.O. Box 186 Dolores, CO 81325	1.579030	0.00
<u>Overriding Royalty</u>		
Marcia M. Daniels, c/o Clotilda M. Pope 5480 Wisconsin Ave., Suite 814 Chevy Chase, MD 20015	0.030390	0.00
Louise Adair McDougal Hadley 2 Bluff Road Swansboro, NC 28584	0.121550	0.00
Charles Alan McDougal 7928 Rooksley Ct. Raleigh, NC 27615	0.121550	0.00
Robert Bruce McDougal 6608 Penny Lane Bartlesville, OK 74006	0.121550	0.00
Anne S. Henderson 7611 Maple Ave., Apt 811 Silver Spring, MD 20912	0.121550	0.00
Robin Thomas Henderson 5028 River Road Bethesda, MD 20016	0.030390	0.00
Russell Stewart Henderson, Jr. 5028 River Road Bethesda, MD 20016	0.030390	0.00
Clotilda M. Pope 5028 River Road Bethesda, MD 20816	0.030390	0.00
<u>Working Interest</u>		
Conoco, Inc. 10 Conoco Plaza, 10 Desta Drive Midland, TX 79705	5.526610	6.316120
Dugan Production Corp.	<u>81.365620</u>	<u>100.00</u>
<b>WELL TOTAL</b>	<b>100.000000</b>	<b>100.00</b>

**ATTACHMENT 4, Pg 3 of 6**  
**Dugan Production Corp.**  
**Com Well No. #2**  
**Harper Hill Fruitland Sand PC**  
**Well Location: NE/4 NE/4 Sec. 2-T29N-R14W**  
**Spacing Unit: NE/4 Sec. 2-T29N-R14W - 156.65 Acres**  
**San Juan County, NM**

<u>INTEREST OWNER</u>	<u>INTEREST - %</u>	
	<u>Net</u>	<u>Gross</u>
<u>Royalty</u>		
State of New Mexico, State Land Office P.O. Box 1148 Santa Fe, NM 87504-1148	12.50	0.00
<u>Overriding Royalty</u>		
Marcia M. Daniels, c/o Clotilda M. Pope 5480 Wisconsin Ave., Suite 814 Chevy Chase, MD 20015	0.061430	0.00
Louise Adair McDougal Hadley 2 Bluff Road Swansboro, NC 28584	0.245703	0.00
Charles Alan McDougal 7928 Rooksley Ct. Raleigh, NC 27615	0.245703	0.00
Robert Bruce McDougal 6608 Penny Lane Bartlesville, OK 74006	0.245704	0.00
Anne S. Henderson 7611 Maple Ave., Apt 811 Silver Spring, MD 20912	0.245700	0.00
Robin Thomas Henderson 5028 River Road Bethesda, MD 20016	0.061430	0.00
Russell Stewart Henderson, Jr. 5028 River Road Bethesda, MD 20016	0.061430	0.00
Clotilda M. Pope 5028 River Road Bethesda, MD 20816	0.061430	0.00
Conoco, Inc. 10 Conoco Plaza, 10 Desta Drive Midland, TX 79705	6.383660	0.00
<u>Working Interest</u>		
Dugan Production Corp.	<u>79.887810</u>	<u>100.00</u>
<b>WELL TOTAL</b>	<b>100.000000</b>	<b>100.00</b>

ATTACHMENT 4, Pg 4 of 6  
Dugan Production Corp.  
Com Well No. #4  
Harper Hill Fruitland Sand PC  
Well Location: NE/4 NW/4 Sec. 2-T29N-R14W  
Spacing Unit: NW/4 Sec. 2-T29N-R14W - 157.95 Acres  
San Juan County, NM

<u>INTEREST OWNER</u>	<u>INTEREST - %</u>	
	<u>Net</u>	<u>Gross</u>
<u>Working Interest</u>		
Dugan Production Corp.	74.478758	100.00
<u>Royalty</u>		
State of New Mexico, State Land Office P.O. Box 1148 Santa Fe, NM 87504-1148	9.402501	0.00
USA - Bureau of Land Management 1235 LaPlata Hwy Farmington, NM 87401	3.097499	0.00
<u>Overriding Royalty</u>		
James A. & H.H. Borland 222 Fourteenth St., NW Albuquerque, NM 87104	2.380120	0.00
Dr. Jo Anne Callan 1028 Santa Florencia Solano Beach, CA 92075	0.015720	0.00
Conoco, Inc. P.O. Box 201940 Houston, TX 77216-1940	2.374169	0.00
Marcia M. Daniels, c/o Clotilda M. Pope 5480 Wisconsin Ave., Suite 814 Chevy Chase, MD 20015	0.061428	0.00
Evko Development Co. 4710 Cabrillo Street San Francisco, CA 94121	*6.290300	0.00
Louise Adair McDougal Hadley 2 Bluff Road Swansboro, NC 28584	0.245711	0.00
Anne S. Henderson 7611 Maple Ave., Apt 811 Silver Spring, MD 20912	0.245711	0.00
Robin Thomas Henderson 5028 River Road Bethesda, MD 20016	0.061427	0.00
Russell Stewart Henderson, Jr. 5028 River Road Bethesda, MD 20016	0.061427	0.00
Elsye L. Kilgore Trust c/o Sunwest Trust Dept/Don Kerby P.O. Box 26900 Albuquerque, NM 87103	*0.3661900	0.00
Lee W. Kilgore Trust c/o Sunwest Trust Dept/Don Kerby P.O. Box 26900 Albuquerque, NM 87103	*0.3661900	0.00
Charles Alan McDougal 7928 Rooksley Ct. Raleigh, NC 27615	0.245711	0.00
Robert Bruce McDougal 6608 Penny Lane Bartlesville, OK 74006	0.245711	0.00
Clotilda M. Pope 5028 River Road Bethesda, MD 20816	0.061427	0.00
<b>WELL TOTAL</b>	<b>100.000000</b>	<b>100.00</b>

\* Approximate interest - Exact interest to be established.

**ATTACHMENT 4, Pg 5 of 6**  
**Dugan Production Corp.**  
**Federal I #99**  
**Basin Fruitland Coal Pool**  
**Well Location: SE/4 NE/4 Sec. 3-T29N-R14W**  
**Spacing Unit: E/2 Sec. 3-T29N-R14W - 318.45 Acres**  
**San Juan County, NM**

<u>INTEREST OWNER</u>	<u>Net</u>	<u>INTEREST - %</u> <u>Gross</u>
<u>Royalty</u>		
USA - Bureau of Land Management 1235 La Plata Hwy. Farmington, NM 87401	12.50	0.00
<u>Working Interest</u>		
Dugan Production Corp. P.O. Box 420 Farmington, NM 87499	87.500	100.00
<b>WELL TOTAL</b>	<u>100.000000</u>	<u>100.00</u>

**ATTACHMENT 4 Pg No. 6 of 6**  
**Dugan Production Corp.**  
**Tabor Com #90**  
**Basin Fruitland Coal Pool**  
**Well Location: SE/4 NE/4 Sec. 35-T30N-R14W**  
**Spacing Unit: E/2 Sec. 35-T30N-R14W 332.49 Acres**  
**San Juan County, NM**

<u><b>INTEREST OWNER</b></u>	<u><b>INTEREST - %</b></u>	
	<u><b>Net</b></u>	<u><b>Gross</b></u>
<u><b>Royalty</b></u>		
USA- Bureau of Land Management 1235 La Plata Hwy. Farmington, NM 87401	9.492391	0.00
Patricia Harbin 6401 Glendora NE Albuquerque, NM 87109	1.503805	0.00
Joseph O. & Cicily M.. Muench Family Trust P.O. Box 779 Placitas, NM 87043	1.503804	0.00
<u><b>Overriding Royalty</b></u>		
Burlington Resources Oil & Gas 801 Cherry Street, Suite 700 Ft. Worth, TX 76102	6.484781	0.00
Linda Orwitz Palley, Trustee 11201 Canby Ave. Northridge, CA 91326	1.296956	0.00
Winifred and Forrest Jacobs 1000 SW Santa Fe Lake Road Towanda, KS 67144-9213	0.481217	0.00
<u><b>Working Interest</b></u>		
Dugan Production Corp. P.O. Box 420 Farmington, NM 87499-0420	79.237046	100.00
<u><b>Well Total</b></u>	<u><b>100.0000</b></u>	<u><b>100.0000</b></u>



Calculated  
 Oil .....  
 Gas .....  
 Water .....

DUGAN PRODUCTION CORP  
 Production Rate vs Time  
 BBl/Mo or Mcf/Mo vs Months  
 Com No. 1E (A-2-29N-14W)  
 Basin Dakota Gas Pool

Production  
 Oil .....  
 Gas .....  
 Water .....

*Alhara unit  
 No. 5  
 Pg 1 of 2*

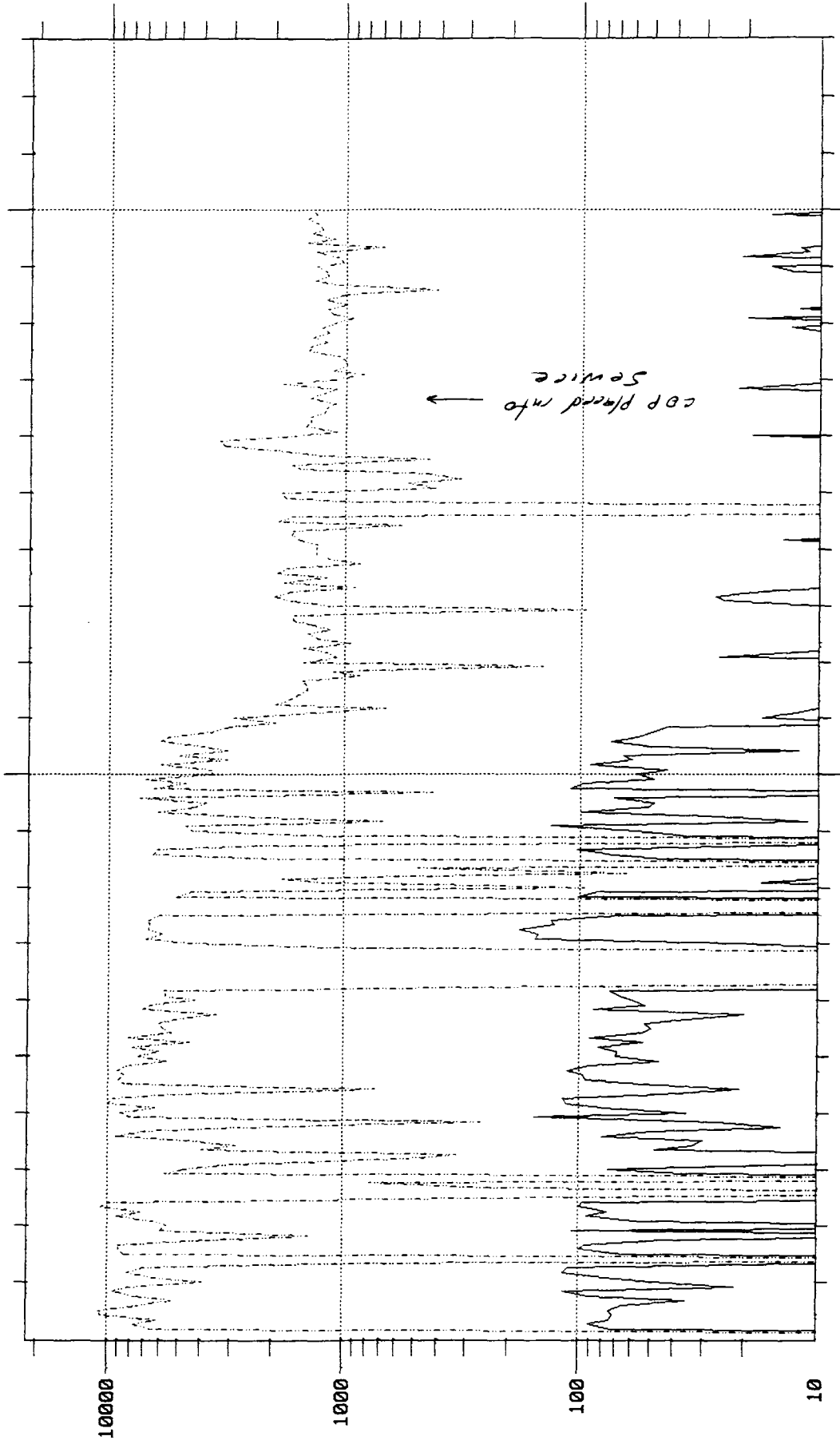

1980 1990 2000

Reported Oil Production = 7436 Bbls  
 Reported Gas Production = 725245 Mcf  
 Reported Water Production = 373 Bbls

Calculated  
 Oil  
 Gas  
 Water

DUGAN PRODUCTION CORP  
 Production Rate vs Time  
 BBl/Mo or Mcf/Mo vs Months  
 Com No. 2 (A-2-29N-14W)  
 Harper Hill Fruitland Sand Pictured Cliffs

Production  
 Oil  
 Gas  
 Water

Attachment  
 NO 5  
 PG 2 of 2

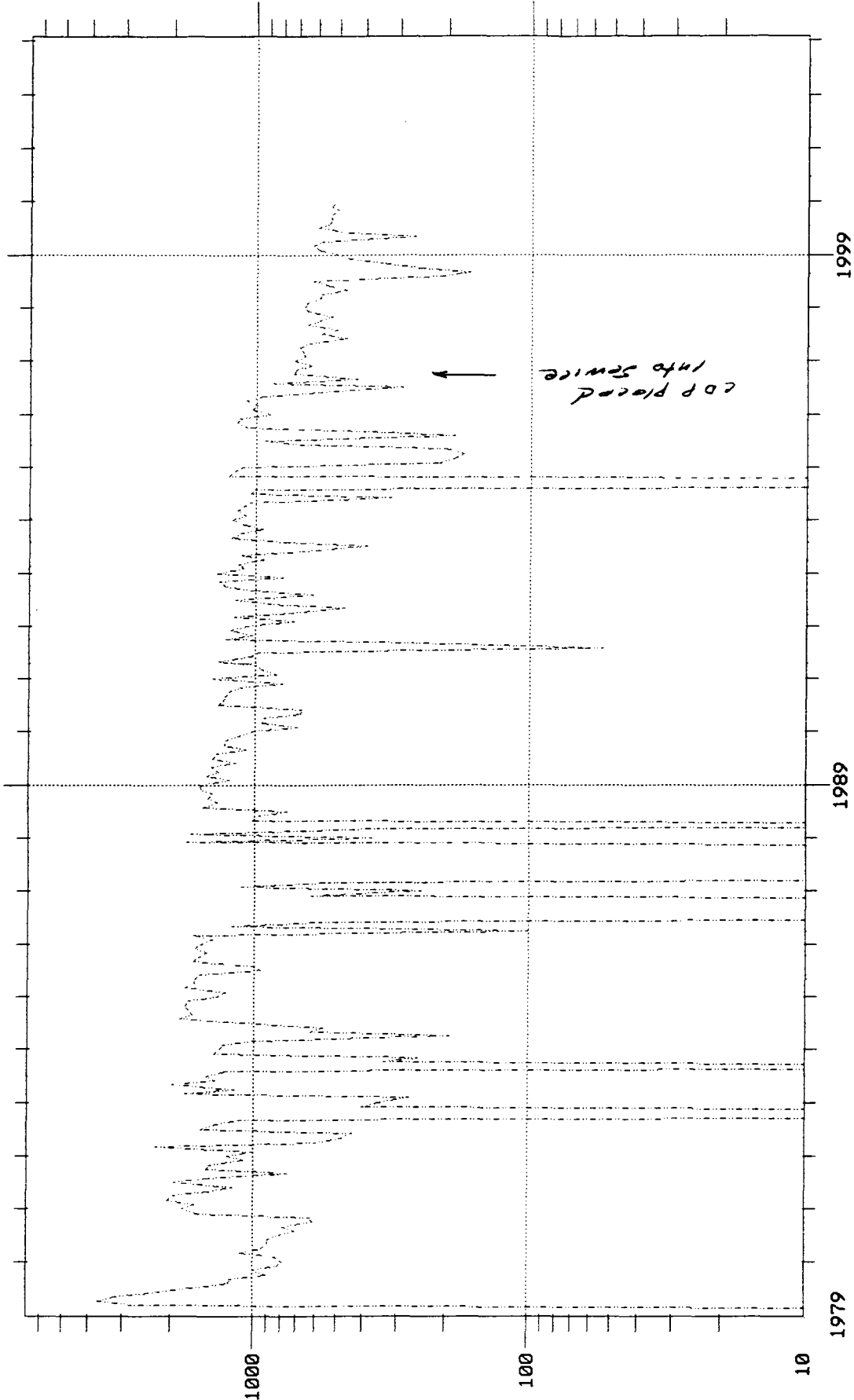

Reported Oil Production = 0 Bbls  
 Reported Gas Production = 228268 Mcf  
 Reported Water Production = 128 Bbls

**ATTACHMENT No. 6**  
**Allocation Procedures**  
**Dugan Production Corp.'s**  
**Tabor Gathering System**  
**CDP : NENE-2-29N-14W**  
**San Juan County, New Mexico**

**Base Data:**

U = Water Volume (BWPD) from Periodic Well Test x days operated during allocation period.

V = Water Volume (bbl) at Central Battery during allocation period.

W = Gas Volume (MCF) from allocation meters at individual wells and central battery separator during allocation period.

X = Gas Volume (MCF) from CDP Sales Meter during allocation period.

Y = BTU's from CDP Sales Meter during allocation period.

Allocation Period is typically a calendar month and will be the same for all wells.

1. Individual Well Gas Production = A + B + C + D + E + F

A = Allocated Sales Volume, MCF. =  $(W/SUM W) \times X$

B = Allocated gas sales volume (MCF) associated with water production

= (A) in mcf for the central battery separator multiplied by a factor of  $(U/SUM U)$  for wells delivering gas and water to the central battery separator.

C = On lease fuel usage, MCF. Determined from equipment specification and operating conditions.

D = Purged and/or vented gas from well and/or lease equipment, MCF. Calculated using equipment specifications and pressures.

E = Allocated fuel from gathering system equipment, MCF. The total fuel required to operate gathering system equipment will be allocated to the individual wells benefiting from the equipment using allocation factors determined by  $W/SUM W$  for the wells involved.

F = Allocated volume of gas lost and/or vented from the gathering system and/or gathering system equipment, MCF. The total volume will be determined using industry accepted procedures for the conditions existing at the time of the loss. All volumes corresponding to liquid condensation within the gathering system will also be determined. The total volume lost and/or vented will be allocated to the individual wells affected using factors determined by  $W/SUM W$ .

2. Allocated Individual Well BTU's =  $(W \times \text{Individual well BTU}) / \text{Sum } (W \times \text{individual well BTU}) \times Y$ .

Individual well gas heating values to be determined in accordance with BLM regulations (currently On shore Order No. 5).

3. Individual Well Water Production = Allocated production volume, bbl =  $(U/\text{Sum } U) \times V$ .

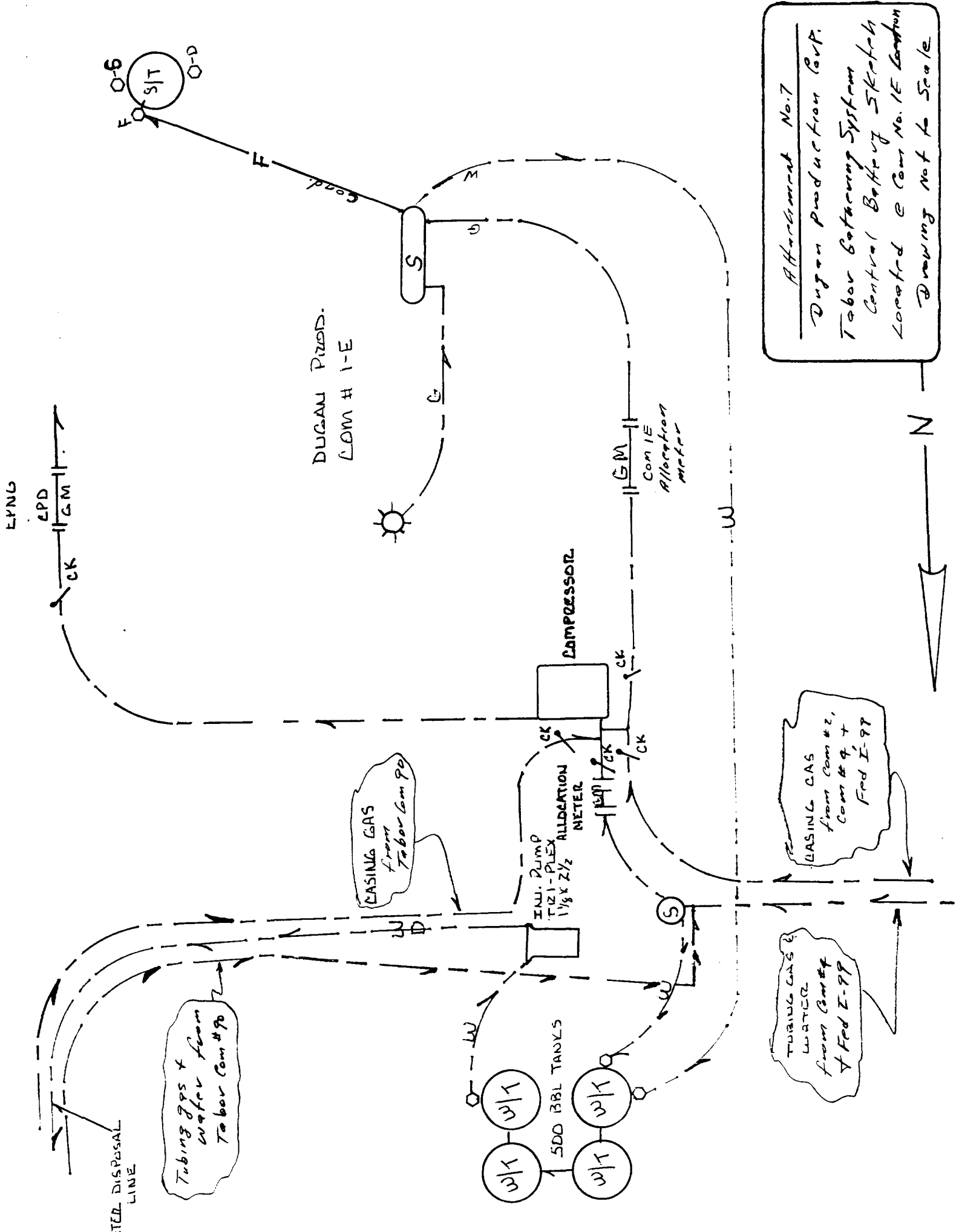

LYNG

WATER DISPOSAL LINE

Tubing gas & water from Taber Com #8

CASING GAS from Taber Com #8

500 BBL TANKS

INJ. PUMP 1 1/2" PLEX 1 1/8" X 2 1/2"

ALLIGATION METER

COMPRESSOR

COM IE Allocation meter

DUGAN PROD. COM # 1-E

Cond.

SIT O-D O-6

TUBING GAS & WATER from Com #8 & Fed I-99

CASING GAS from Com #2, Com #9, & Fed I-99

Attachment No. 7  
 Dugan Production Corp.  
 Taber Gaslifting System  
 Central Battery Sketch  
 Located @ Com No. 1E London  
 Drawing Not to Scale

N

EL PASO NATURAL GAS COMPANY  
 VOLUME ACCOUNTING DEPARTMENT  
 MEASUREMENT DIVISION  
 POST OFFICE BOX 1492  
 EL PASO, TEXAS 79978  
 PHONE: (915) 541-5267  
 CHROMATOGRAPHIC GAS ANALYSIS REPORT

DATE 11/08/95

Attachment  
 No. 8  
 Pg 1 of 3

MAILEE  
 26730

DUGAN PRODUCTION CORPORATION  
 P O BOX 420  
 FARMINGTON, NM 87499-0420

Basin Dakota

METER NUMBER 90887 - COM #1E (A-Z-29N-14W)  
 OPERATOR 1862 - DUGAN PRODUCTION CORP

ANALYSIS DATE 10/20/95  
 SAMPLE DATE 10/16/95 *prior to surface commingling w/ Com #2*  
 EFFECTIVE DATE 11/01/95  
 EFFECTIVE FOR 6 MONTHS  
 TYPE CODE 2 - ACTUAL  
 H2S GRAINS 0  
 LOCATION D - DANIELS FM

COMPONENTS	NORMALIZED MOL %	GPM
CO2	.90	.000
H2S	.00	.000
N2	.70	.000
METHANE	77.55	.000
ETHANE	10.68	2.857
PROPANE	5.88	1.621
ISO-BUTANE	.94	.307
NORM-BUTANE	1.81	.571
ISO-PENTANE	.57	.209
NORM-PENTANE	.46	.167
HEXANE PLUS	<u>.51</u>	<u>.223</u>
	100.00	5.955

SPECIFIC GRAVITY .751  
 MIXTURE HEATING VALUE (BTU @ 14.73 DRY) 1285  
 RATIO OF SPECIFIC HEATS .000  
 NO TEST SECURED FOR H2S CONTENT

EL PASO NATURAL GAS COMPANY  
 VOLUME ACCOUNTING DEPARTMENT  
 MEASUREMENT DIVISION  
 POST OFFICE BOX 1492  
 EL PASO, TEXAS 79978  
 PHONE: (915) 541-5267  
 CHROMATOGRAPHIC GAS ANALYSIS REPORT

DATE 11/08/95

*A Harcourt  
 No. 8  
 pg 2 of 3*

MAILEE  
 26730

DUGAN PRODUCTION CORPORATION  
 P O BOX 420  
 FARMINGTON, NM 87499-0420

METER NUMBER 90381 - COM #2 - A-Z-Z9N-14W  
 OPERATOR 1862 - DUGAN PRODUCTION CORP

*Harper Hill  
 Fruitland Sand-  
 Pictured Cliffs*

ANALYSIS DATE 10/20/95 *prior* TYPE CODE 2 - ACTUAL  
 SAMPLE DATE 10/18/95 *to* H2S GRAINS 0  
 EFFECTIVE DATE 11/01/95 *Surface* LOCATION D - DANIELS FM  
 EFFECTIVE FOR 6 MONTHS *Comminging  
 w/ COM 1E*

COMPONENTS	NORMALIZED MOL %	GPM
CO2	.43	.000
H2S	.00	.000
N2	.21	.000
METHANE	87.60	.000
ETHANE	6.46	1.728
PROPANE	2.58	.711
ISO-BUTANE	.46	.150
NORM-BUTANE	.69	.218
ISO-PENTANE	.29	.106
NORM-PENTANE	.22	.080
HEXANE PLUS	<u>1.06</u>	<u>.462</u>
	100.00	3.455

SPECIFIC GRAVITY .672  
 MIXTURE HEATING VALUE  
 (BTU @ 14.73 DRY) 1183  
 RATIO OF SPECIFIC HEATS .000  
 NO TEST SECURED FOR H2S CONTENT



203 Afton Place  
 Farmington, N.M. 87401  
 (505) 325-6622

Analysis No. DUG70358  
 Cust. No. 23000-11050

*Attachment  
 No. 8  
 pg 3 of 3*

WELL/LEASE INFORMATION

Company	: DUGAN PRODUCTION CORP.	Source	: TUBING
Well Name	: O HENRY 1	Pressure	: 55 PSIG
County	: SAN JUAN	Sample Temp.	: N/A DEG.F
State	: NM	Well Flowing	: YES
Location	: 36-30N-14W-unit N	Date Sampled	: 10/30/97
Fld/Formation	: <u>Basin Fruitland Co #1</u>	Sampled By	: BILLIE WRIGHT
Cust.Stn.No.	:	Foreman/Engr	: TOM BLAIR

Remarks: LEASE: E-6714

ANALYSIS

COMPONENT	MOLE %	GPM**	B.T.U.*	SP.GR.*
NITROGEN	1.177	0.0000	0.00	0.0114
CO2	0.886	0.0000	0.00	0.0135
METHANE	90.809	0.0000	919.26	0.5030
ETHANE	3.803	1.0173	67.45	0.0395
PROPANE	1.862	0.5132	46.96	0.0284
I-BUTANE	0.358	0.1171	11.67	0.0072
N-BUTANE	0.499	0.1573	16.32	0.0100
I-PENTANE	0.181	0.0662	7.26	0.0045
N-PENTANE	0.128	0.0464	5.14	0.0032
HEXANES	0.297	0.1296	15.27	0.0096
<b>TOTAL</b>	<b>100.000</b>	<b>2.0471</b>	<b>1089.33</b>	<b>0.6303</b>

\* @ 14.730 PSIA DRY & UNCORRECTED FOR COMPRESSIBILITY

\*\* @ 14.730 & 60 DEG. F

COMPRESSIBILITY FACTOR	(1/2)	1.0026
BTU/CU.FT. (DRY) CORRECTED FOR	(1/2)	1092.2
BTU/CU.FT. (WET) CORRECTED FOR	(1/2)	1073.2
REAL SPECIFIC GRAVITY		0.6317

ANALYSIS RUN AT 14.730 PSIA & 60 DEGREES F

CYLINDER #	: K073
CYLINDER PRESSURE	: 52 PSIG
DATE RUN	: 10/31/97
ANALYSIS RUN BY	: DAVE MARTIN

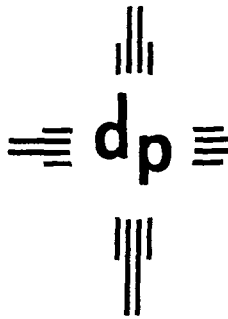

dugan production corp.

March 29, 2000

Attachment  
No. 9  
Pg 1 of 1

**CERTIFIED MAIL - RETURN RECEIPT REQUESTED**

Conoco, Inc.  
10 Conoco Plaza  
10 Desta Drive  
Midland, TX 79705

Re: Surface Commingling and Off-Lease Measurement  
Dugan Production Corp.'s - **Com No. 1E (A-2-29N-14W); Com No. 2 (A-2-29N-14W);  
Com No. 4 (C-2-29N-14W); Federal I No. 99 (H-3-29N-14W); Tabor Com No. 90  
(H-35-30N-14W) San Juan County, New Mexico**

Gentlemen:

Attached for your information, review and file is a copy of our application to the New Mexico Oil Conservation Division, the New Mexico State Land Office, and the Bureau of Land Management to surface commingle and off lease measure natural gas produced from the captioned wells. This will allow us to place the Federal I No. 99 and Tabor Com No. 90 on production and will allow all 5 wells to share the cost of operating a central compressor and production facilities as opposed to separate facilities at each individual well.

Our records reflect that Conoco has a 6.3% working interest in the Com No. 1E and an overriding royalty interest in the Com No. 2 & 4 wells. Since the Com No. 1E and No. 2 are already authorized for surface commingling and share a central compressor this proposal will have little to no effect upon Conoco's interest in these 2 wells. The Com No. 4 is currently delivering gas into El Paso's pipeline with a wellhead compressor and we are trucking approximately 105 BWPD for disposal. The proposed Tabor Gathering System will allow the Com No. 4 to benefit from the operation at central production and compression facilities which should have a positive effect upon Conoco's overriding royalty interest in this well as less compressor fuel will be used which will increase the volumes of gas available for sale from each well. In addition, our operating expenses will be lowered which will allow us to recover more of the gas reserves.

Should you have any questions, need additional information or have any concern as to our proposal, please let me know. Should you have an objection to our proposal, you should so advise the New Mexico Oil Conservation Division at 2040 South Pacheco Street in Santa Fe, New Mexico 87505, and we would appreciate receiving a copy of your objection.

Sincerely,

*John D. Roe*

John D. Roe  
Engineering Manager



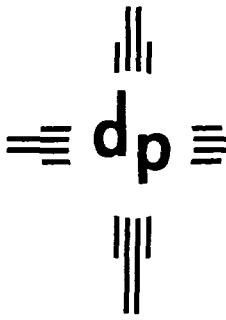

dugan production corp.

Attachment  
No. 10  
Pg 1 of 2

March 29, 2000

**CERTIFIED MAIL - RETURN RECEIPT REQUESTED**

To: Royalty and Overriding Royalty Interest Owners (Address list attached)  
Dugan Production Corp.'s  
Com No. 1E (A-2-29N-14W)  
Com No. 2 (A-2-29N-14W)  
Com No. 4 (C-2-29N-14W)  
Federal I No. 99 (H-3-29N-14W)  
Tabor Com No. 90 (H-35-30N-14W)  
San Juan County, New Mexico

Ladies and Gentlemen:

Attached for your information, review and file is a copy of our application to the New Mexico Oil Conservation Division, the New Mexico State Land Office, and the Bureau of Land Management to surface commingle and off lease measure natural gas produced from the captioned wells in which you have a royalty or overriding interest ownership in one or more of the subject wells. This will allow us to place the Federal I No. 99 and Tabor Com No. 90 on production and will allow all 5 wells to share the cost of operating a central compressor and production facilities as opposed to separate facilities at each individual well.

This proposal should not affect your interest in these wells and should allow your revenues to increase since less compressor fuel will be used which will increase the volumes of gas available for sale from each well. In addition, our operating expenses will be lowered which will allow us to recover more of the gas reserves from each well.

Should you have any questions, need additional information or have any concern as to our proposal, please let me know. Should you have an objection to our proposal, you should so advise the New Mexico Oil Conservation Division at 2040 South Pacheco Street in Santa Fe, New Mexico 87505, and we would appreciate receiving a copy of your objection.

Sincerely,

John D. Roe  
Engineering Manager

**Interest Owners - Address List**  
**Proposed Tabor Gathering System -**  
**Com No. 1E, Com No. 2, Com No. 4,**  
**Federal I No. 99, Tabor Com 90**

3/28/00

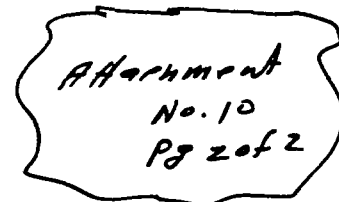

State of New Mexico, State Land Office  
P.O. Box 1148  
Santa Fe, NM 87504-1148

Robin Thomas Henderson  
5028 River Road  
Bethesda, MD 20016

USA - Bureau of Land Management  
1235 LaPlata Hwy  
Farmington, NM 87401

Russell Stewart Henderson, Jr.  
5028 River Road  
Bethesda, MD 20016

James A. & H.H. Borland  
222 Fourteenth St., NW  
Albuquerque, NM 87104

Winifred and Forrest Jacobs  
1000 SW Santa Fe Lake Road  
Towanda, KS 67144-9213

Burlington Resources Oil & Gas  
801 Cherry Street, Suite 700  
Ft. Worth, TX 76102

Elsye L. Kilgore Trust  
c/o Sunwest Trust Dept/Don Kerby  
P.O. Box 26900  
Albuquerque, NM 87103

Dr. Jo Anne Callan  
1028 Santa Florencia  
Solano Beach, CA 92075

Lee W. Kilgore Trust  
c/o Sunwest Trust Dept/Don Kerby  
P.O. Box 26900  
Albuquerque, NM 87103

Conoco, Inc.  
P.O. Box 201940  
Houston, TX 77216-1940

Rilla E. King  
P.O. Box 186  
Dolores, CO 81325

Conoco, Inc.  
10 Conoco Plaza, 10 Desta Drive  
Midland, TX 79705

Charles Alan McDougal  
7928 Rooksley Ct.  
Raleigh, NC 27615

Marcia M. Daniels  
c/o Clotilda M. Pope  
5480 Wisconsin Ave., Suite 814  
Chevy Chase, MD 20015

Robert Bruce McDougal  
6608 Penny Lane  
Bartlesville, OK 74006

Dugan Production Corp.  
P.O. Box 420  
Farmington, NM 87499

Joseph O. & Cicily M. Muench Family Trust  
P.O. Box 779  
Placitas, NM 87043

Evko Development Co.  
4710 Cabrillo Street  
San Francisco, CA 94121

Linda Orwitz Palley, Trustee  
11201 Canby Ave.  
Northridge, CA 91326

Louise Adair McDougal Hadley  
2 Bluff Road  
Swansboro, NC 28584

Clotilda M. Pope  
5028 River Road  
Bethesda, MD 20816

Patricia Harbin  
6401 Glendora NE  
Albuquerque, NM 87109

Anne S. Henderson  
7611 Maple Ave., Apt 811  
Silver Spring, MD 20912