



**Gruy Petroleum Management Co.**

600 East Las Colinas Blvd. ♦ Suite 1100 ♦ Irving, TX 75039 ♦ (972) 401-3111 ♦ Fax (972) 443-6450  
Mailing Address: P.O. Box 140907 ♦ Irving, TX 75014-0907

*A subsidiary of Magnum Hunter Resources, Inc. • An American Stock Exchange Company*

OIL CONSERVATION DIV.

01 JUL 23 8:11:01

July 20, 2001

New Mexico Oil Conservation Division  
1220 South St. Francis Drive  
Santa Fe New Mexico 87505  
Attn: Ms. Lori Wrotenbery

Re: Myers B 9  
NW/4, 13-24S-36E  
Lea County New Mexico

Case 12723

Dear Ms. Wrotenbery:

We inadvertently left out the C-102 in the simultaneous dedication and unorthodox well location application for the referenced well. We also had some spacing changes. Therefore we are resubmitting the application.

The Myers B 9 well was permitted as a Langlie Mattix oil well, at an orthodox location of 990' FNL and 330' FWL of section 13-24S-36E. It was completed as a Jalmat gas well. The 160 acre spacing unit comprised of the NW/4 of section 13-24S-36E is dedicated to the Gruy Petroleum Management Co. Myers B 3 located 660' FNL and 1980' FWL of section 13.

In this regard, Gruy Petroleum Management Co. is requesting administrative approval of the unorthodox Jalmat gas location of the Myers B 9 and for simultaneous dedication of the Myers B 9 and B 3 wells in the 160-acre proration unit. A copy of this letter and attachments has been furnished by Certified Mail to offset operators as notice of this application.

If you have any questions or require additional information concerning this application, please contact me at 972-443-6489.

Yours truly,

Zeno Farris  
Manager, Operations Administration

Cc: N.M.O.C.D. – Hobbs

DISTRICT I  
P.O. Box 1860, Hobbs, NM 88241-1860

State of New Mexico  
Energy, Minerals and Natural Resources Department

Form C-1002  
Revised February 10, 1999  
Submit to Appropriate District Office  
State Lease - 4 Copies  
Fee Lease - 3 Copies

DISTRICT II  
P.O. Drawer DD, Artesia, NM 88211-0719

DISTRICT III  
1000 Rio Brazos Rd., Aztec, NM 87410

DISTRICT IV  
P.O. BOX 2088, SANTA FE, N.M. 87504-2088

OIL CONSERVATION DIVISION  
P.O. Box 2088  
Santa Fe, New Mexico 87504-2088

AMENDED REPORT

WELL LOCATION AND ACREAGE DEDICATION PLAT

API Number 30-025-34769	Pool Code 79240	Pool Name Jalmat Tansil-Yates-7 Rivers (Gas)
Property Code 21783	Property Name MYERS B	Well Number 9
OGRID No. 162683	Operator Name GRUY PETROLEUM MANAGEMENT CO.	Elevation 3338

Surface Location

UL or lot No.	Section	Township	Range	Lot Idn	Feet from the	North/South line	Feet from the	East/West line	County
D	13	24 S	36 E		990	NORTH	330	WEST	LEA

Bottom Hole Location If Different From Surface

UL or lot No.	Section	Township	Range	Lot Idn	Feet from the	North/South line	Feet from the	East/West line	County

Dedicated Acres	Joint or Infill	Consolidation Code	Order No.
160	Y		

NO ALLOWABLE WILL BE ASSIGNED TO THIS COMPLETION UNTIL ALL INTERESTS HAVE BEEN CONSOLIDATED OR A NON-STANDARD UNIT HAS BEEN APPROVED BY THE DIVISION

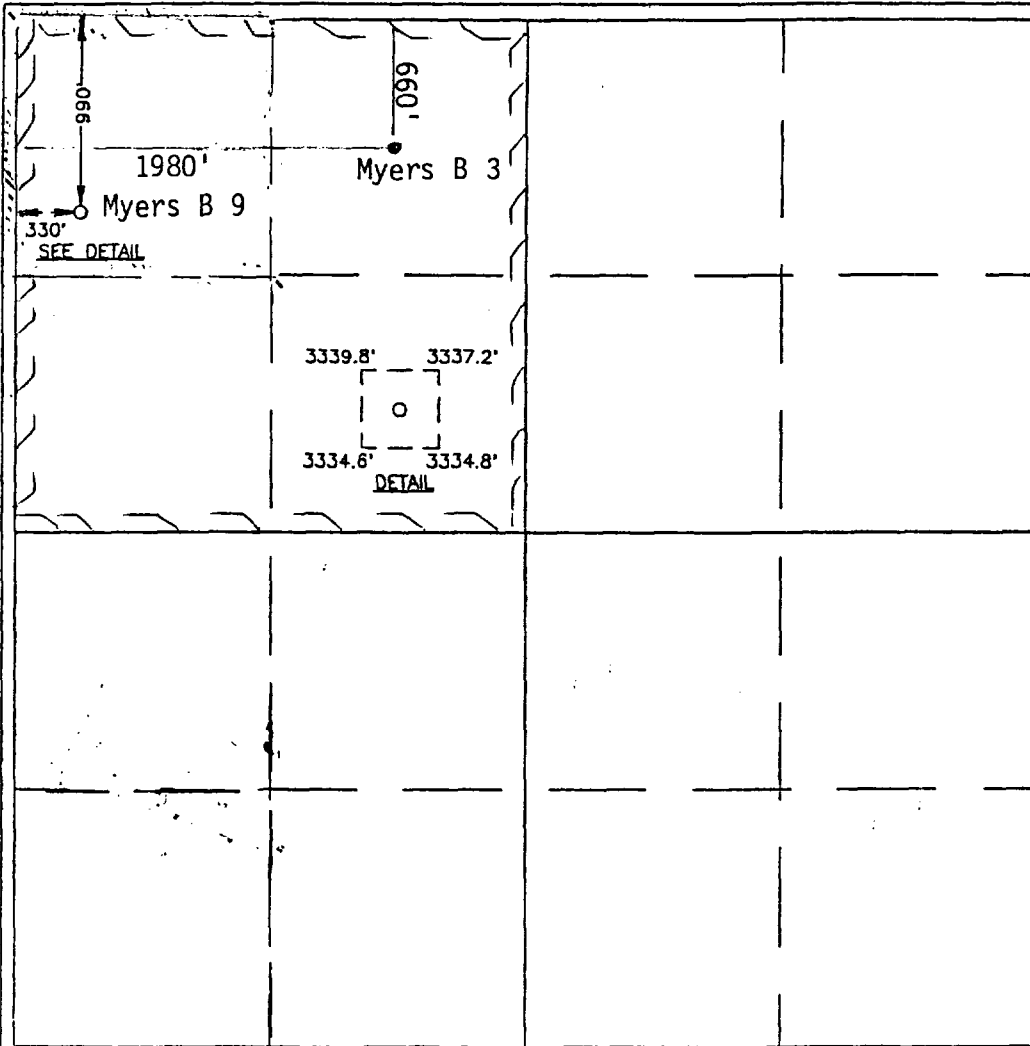

OPERATOR CERTIFICATION

I hereby certify the the information contained herein is true and complete to the best of my knowledge and belief.

*Zeno Farris*  
Signature

Zeno Farris  
Printed Name

Mgr., Ops. Admin.  
Title

July 20, 2001  
Date

Date

SURVEYOR CERTIFICATION

I hereby certify that the well location shown on this plat was plotted from field notes of actual surveys made by me or under my supervision, and that the same is true and correct to the best of my belief.

SEPTEMBER 14, 1999

Date Surveyed \_\_\_\_\_ DC

Signature \_\_\_\_\_  
Professional Surveyor

RONALD J. EDISON  
NEW MEXICO  
3239  
09-11-08  
30-99

Certificate No. RONALD J. EDISON 3239  
GARY EDSON 12641  
MCDONALD 12185

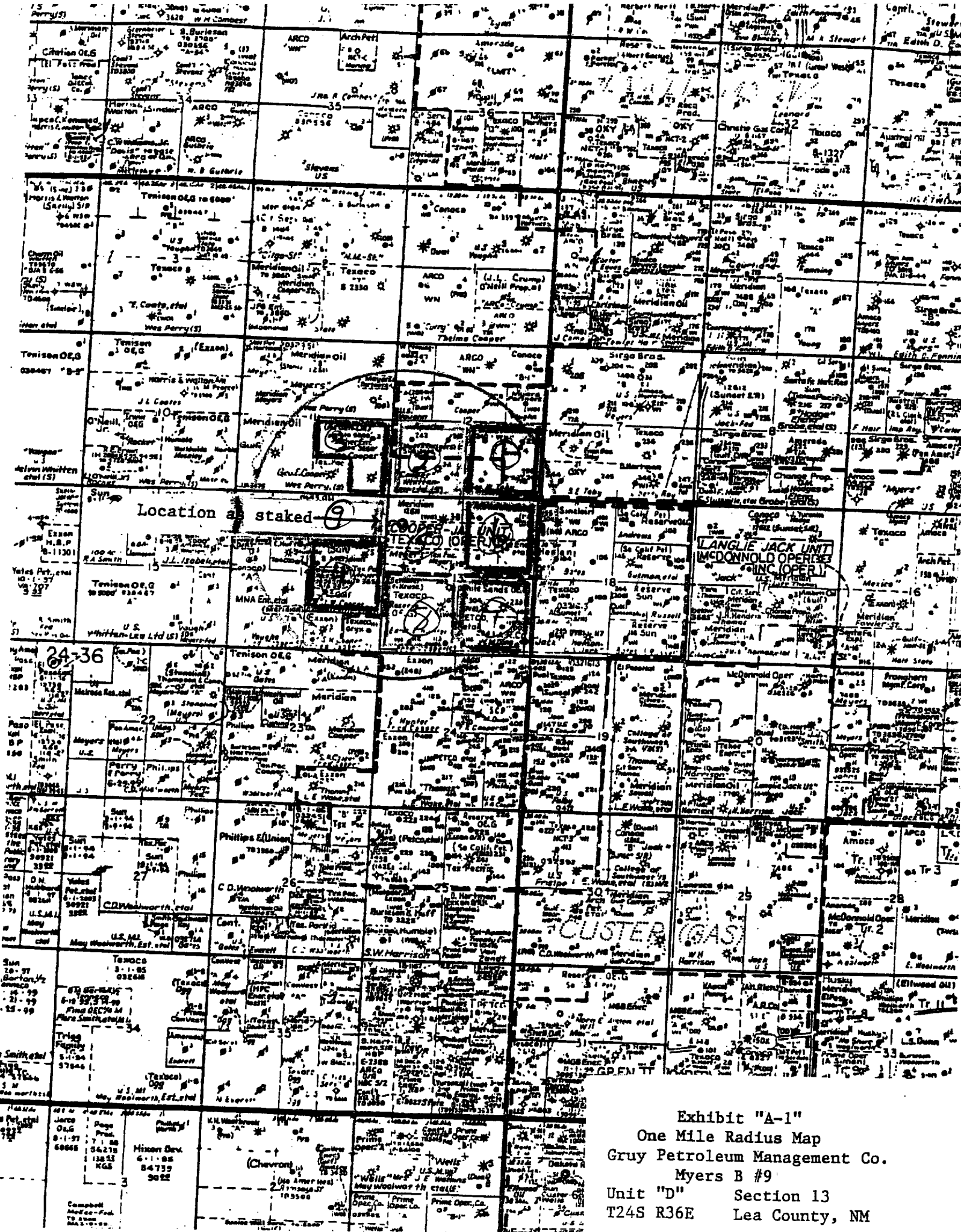

Exhibit "A-1"  
 One Mile Radius Map  
 Gruy Petroleum Management Co.  
 Myers B #9  
 Unit "D" Section 13  
 T24S R36E Lea County, NM

List of Offset SPUs  
GRUY PETROLEUM MANAGEMENT CO.  
Myers "B" 9  
Jalmat Gas Pool

OFFSET SPU	COLOR CODE	Well Name	Location	OPERATOR	ACERAGE DESCRIPTION	ACRES
1	DK Blue	GW Toby Gas W/N Com 4	I-12-24-36	Arco Permian	SE/4 Sec. 12 T-24S-R-36E	160
2	Lt Brown	JW Cooper A 3	N-12-24-36	Prize Operating Co.	SW/4 Sec. 12 T-24S-R-36E	160
3	Purple	Eunice Cooper No. 1	P-11-24-36	Lewis B Burtleson	N/2SE/4, SE/4SE/4 Sec 11 T-24S-R-36E	120
4	Red	JW Cooper No. 8	G-24-36	Gruy Pet. Management Co.	S/2NE/4, N/2SE/4 Sec 14 T-26S-R-36E	160
5	Yellow	Myers B No. 3 Myers B No. 9	C-13-24-36 D-11-24-36	Gruy Pet. Management Co. Gruy Pet. Management Co.	NW/4 Sec. 13 T-26S-R-36E	160
6	DK Green	GW Toby 2 GW Toby 7	A-13-24-36 G-13-24-36	Arco Permian Arco Permian	NE/4 Sec. 13 T-26S-R-36E	160
7	Orange	None in Jalmat (Gas)		Texaco Exploration & Prod	SE/4 Sec. 13 T-26S-R-36E	160
8	Lt Green	Cooper Jal Unit No. 107	K-13-24-36	Texaco Exploration & Prod	SW/4 Sec. 13 T-26S-R36E	160
9	Lt Blue	None in Jalmat (Gas)		Lewis B Burtleson	N/2N/2 Sec. 14 T-26S-R36E	160

**NW/4, Section 13 Township 24S, Range 36E  
Lea County, New Mexico, Containing 120 acres**

**RE: Myers B 9, Application for Unorthodox well Location and Simultaneous  
Dedication.**

**Notification of Offset Operators:**

Texaco Exploration & Production, Inc.  
P.O. Box 3109  
Midland, Texas 79702

Lewis B. Burleson  
P.O. box 2479  
Midland, Texas 79702

Arco Permian  
P.O. Box 1089  
Eunice NM 88231

Prize Operating Co.  
3500 William D Tate Ave. # 200  
Grapevine Texas 76051

Please find attached proof of notification.

U.S. Postal Service  
**CERTIFIED MAIL RECEIPT**  
 (Domestic Mail Only; No Insurance Coverage Provided)

OFFICIAL USE

Postage	\$ .57
Certified Fee	2.10
Return Receipt Fee (Endorsement Required)	1.50
Restricted Delivery Fee (Endorsement Required)	
<b>Total Postage &amp; Fees</b>	<b>\$ 4.17</b>



Sent To Lewis B. Burleson  
 Street, Apt. No., or PO Box No. P.O. Box 2419  
 City, State, ZIP+4 Midland TX 79702

PS Form 3800, May 2000 See Reverse for Instructions

7000 1530 0004 3841 7991

U.S. Postal Service  
**CERTIFIED MAIL RECEIPT**  
 (Domestic Mail Only; No Insurance Coverage Provided)

OFFICIAL USE

Postage	\$ .57
Certified Fee	2.10
Return Receipt Fee (Endorsement Required)	1.50
Restricted Delivery Fee (Endorsement Required)	
<b>Total Postage &amp; Fees</b>	<b>\$ 4.17</b>



Sent To Texeco Expl. & Prod. Inc.  
 Street, Apt. No., or PO Box No. P.O. Box 3109  
 City, State, ZIP+4 Midland TX 79702

PS Form 3800, May 2000 See Reverse for Instructions

7000 1530 0004 3841 7953

U.S. Postal Service  
**CERTIFIED MAIL RECEIPT**  
 (Domestic Mail Only; No Insurance Coverage Provided)

OFFICIAL USE

Postage	\$ .57
Certified Fee	2.10
Return Receipt Fee (Endorsement Required)	1.50
Restricted Delivery Fee (Endorsement Required)	
<b>Total Postage &amp; Fees</b>	<b>\$ 4.17</b>



Sent To Prize Operating Co.  
 Street, Apt. No., or PO Box No. 3500 William D. Tate, Ave #200  
 City, State, ZIP+4 Granger TX 76051

PS Form 3800, May 2000 See Reverse for Instructions

7000 1530 0004 3841 7984

U.S. Postal Service  
**CERTIFIED MAIL RECEIPT**  
 (Domestic Mail Only; No Insurance Coverage Provided)

OFFICIAL USE

Postage	\$ .57
Certified Fee	2.10
Return Receipt Fee (Endorsement Required)	1.50
Restricted Delivery Fee (Endorsement Required)	
<b>Total Postage &amp; Fees</b>	<b>\$ 4.17</b>

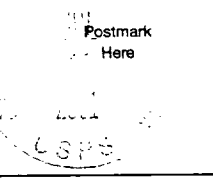

Sent To Arco Permian  
 Street, Apt. No., or PO Box No. P.O. Box 1089  
 City, State, ZIP+4 EVANESCE, NM 88231

PS Form 3800, May 2000 See Reverse for Instructions

7000 1530 0004 3841 7960

Myers B 9



**Gruy Petroleum Management Co.**

600 East Las Colinas Blvd. ♦ Suite 1100 ♦ Irving, TX 75039 ♦ (972) 401-3111 ♦ Fax (972) 443-6450

Mailing Address: P.O. Box 140907 ♦ Irving, TX 75014-0907

*A subsidiary of Magnum Hunter Resources, Inc. • An American Stock Exchange Company • "MHR"*

OIL CONSERVATION DIV.

JUL 23 PM 12:50

July 18, 2001

New Mexico Oil Conservation Division  
1220 South St. Francis Drive  
Santa Fe New Mexico 87505  
Attn: Ms. Lori Wrotenbery

Re: Myers B 9  
NW/4, 13-24S-36E  
Lea County New Mexico

Dear Ms. Wrotenbery:

The referenced well was permitted as a Langlie Mattix oil well, at an orthodox location of 990' FNL and 330' FWL of section 13-24S-36E. It was completed as a Jalmat gas well. The 160 acre spacing unit comprised of the NW/4 of section 13-24S-36E is dedicated to the Gruy Petroleum Management Co. Myers B 3 located 660' FNL and 1980' FWL of section 13.

In this regard, Gruy Petroleum Management Co. is requesting administrative approval of the unorthodox Jalmat gas location of the Myers B 9 and for simultaneous dedication of the Myers B 9 and B 3 wells in the 160-acre proration unit. A copy of this letter and attachments has been furnished by Certified Mail to offset operators as notice of this application.

If you have any questions or require additional information concerning this application, please contact me at 972-443-6489.

Yours truly,

Zeno Farris  
Manager, Operations Administration

Cc: N.M.O.C.D. – Hobbs

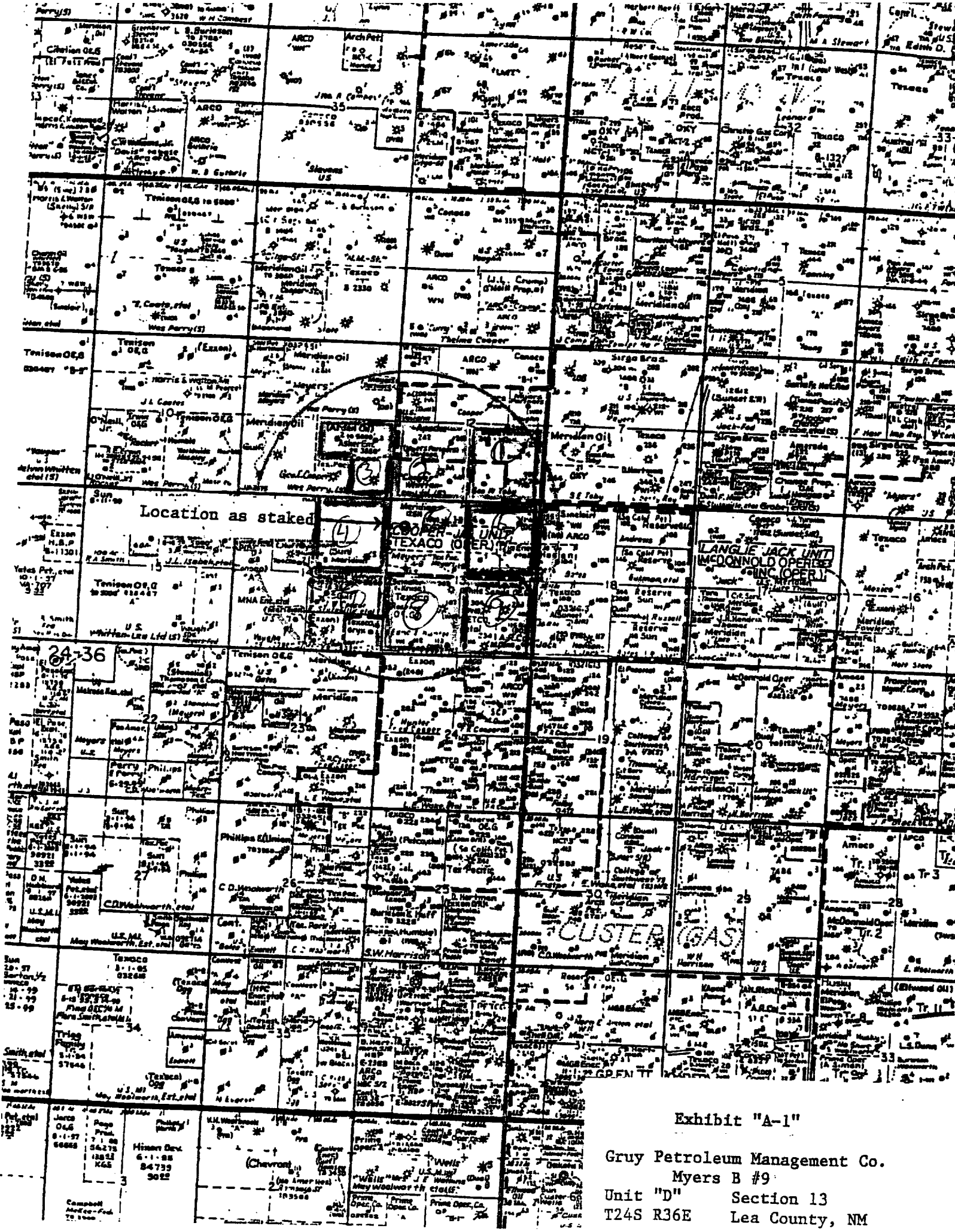

Exhibit "A-1"

Gruy Petroleum Management Co.  
 Myers B #9  
 Unit "D" Section 13  
 T24S R36E Lea County, NM



**NW/4, Section 13 Township 24S, Range 36E  
Lea County, New Mexico, Containing 120 acres**

**RE: Myers B 9, Application for Unorthodox well Location and Simultaneous  
Dedication.**

**Notification of Offset Operators:**

Texaco Exploration & Production, Inc.  
P.O. Box 3109  
Midland, Texas 79702

Lewis B. Burlison  
P.O. box 2479  
Midland, Texas 79702

Arco Permian  
P.O. Box 1089  
Eunice NM 88231

Prize Operating Co.  
3500 William D Tate Ave. # 200  
Grapevine Texas 76051

Please find attached proof of notification.

List of Offset SPU's  
GRUY PETROLEUM MANAGEMENT CO.  
Myers "B" 9  
Jalmat Gas Pool

OFFSET SPU	COLOR CODE	Well Name	Location	OPERATOR	ACERAGE DESCRIPTION	ACRES
1	Dk Blue	GW Toby Gas WN Com 4	I-12-24-36	Arco Permian	SE/4 Sec. 12 T-24S-R-36E	160
2	Lt Brown	JW Cooper A 3	N-12-24-36	Prize Operating Co.	SW/4 Sec. 12 T-24S-R-36E	160
3	Purple	Eunice Cooper No. 1	P-11-24-36	Lewis B Burteson	N/2SE/4, SE/4SE/4 Sec 11 T-24S-R-36E	120
4	Red	JW Cooper No. 8	G-24-36	Gruy Pet. Management Co.	NE/4 Sec. 14 T-26S-R-36E	160
5	Yellow	Myers B No. 3 Myers B No. 9	C-13-24-36 D-11-24-36	Gruy Pet. Management Co. Gruy Pet. Management Co.	NW/4 Sec. 13 T-26S-R-36E	160
6	Dk Green	GW Toby 2 GW Toby 7	A-13-24-36 G-13-24-36	Arco Permian Arco Permian	NE/4 Sec. 13 T-26S-R-36E	160
7	Orange	None in Jalmat (Gas)		Texaco Exploration & Prod	SE/4 Sec. 13 T-26S-R-36E	160
8	Lt Green	Cooper Jal Unit No. 107	K-13-24-36	Texaco Exploration & Prod	SW/4 Sec. 13 T-26S-R36E	160
9	Lt Blue	None in Jalmat (Gas)		Gruy Pet. Management Co.	SE/4 Sec. 14 T-26S-R36E	160