

R 34 E

R 35 E

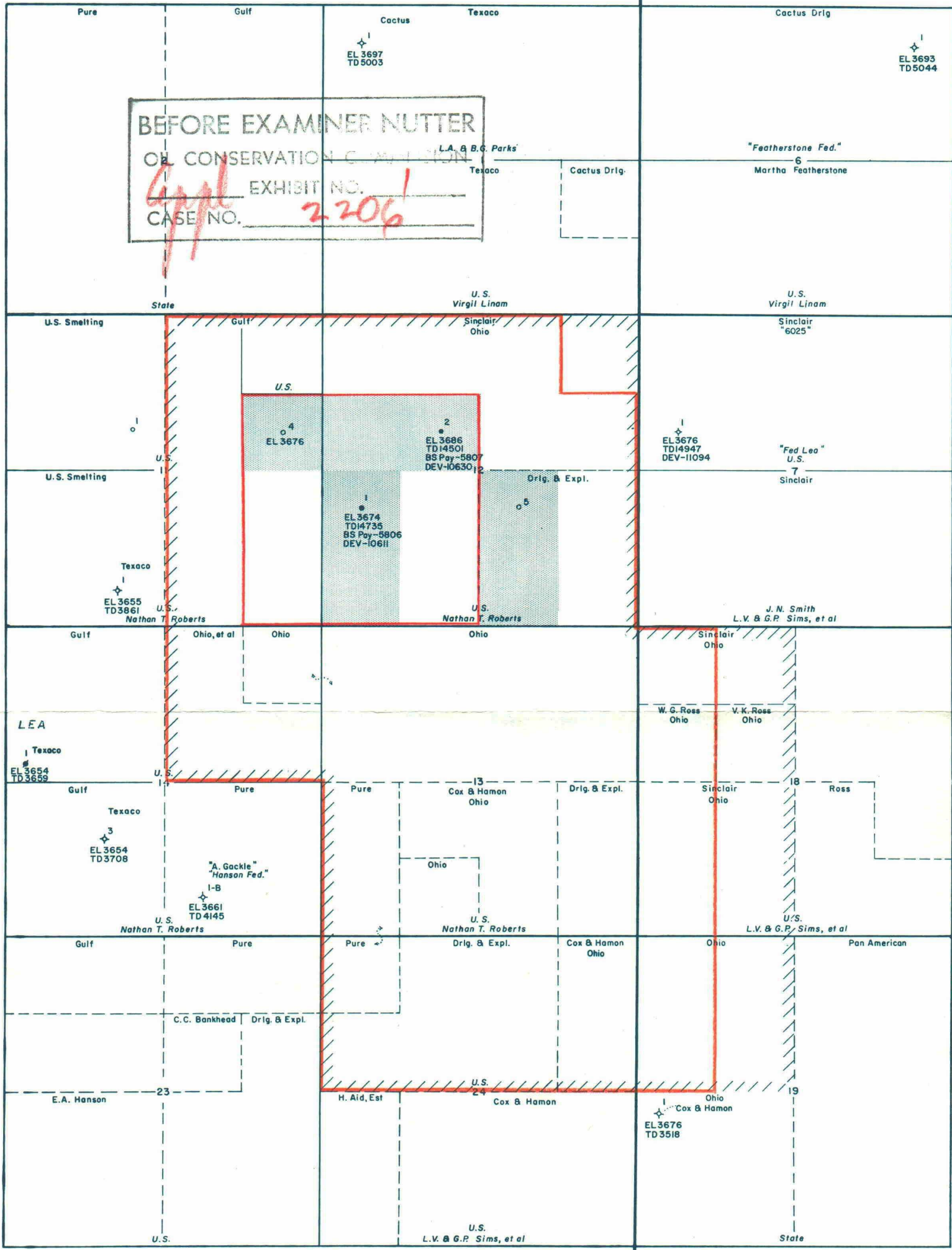

BEFORE EXAMINER NUTTER
 OF CONSERVATION COMMISSION
 L.A. & B.C. Parks
 EXHIBIT NO. _____
 CASE NO. 2206

- LEGEND**
- BOUNDARY OF LEA UNIT AREA
 - PRODUCING WELL
 - DRILLING WELL
 - BOUNDARY OF PRESENT DEVONIAN PARTICIPATING AREA
 - BOUNDARY OF PROPOSED FIRST REVISED DEVONIAN PARTICIPATING AREA AND INITIAL BONE SPRINGS PARTICIPATING AREA (APPLICATIONS NOW PENDING WITH U.S.G.S.)
 - ACREAGE DEDICATED TO WELLS



LEA UNIT AREA
LEA COUNTY, NEW MEXICO



THE OHIO OIL COMPANY — HOUSTON, TEXAS
 NMOCC CASE NO. 2206
 OHIO EXHIBIT NO. 1
 DATE 3-3-61

T 20 S