

**NEW MEXICO
OIL CONSERVATION COMMISSION**

P. O. DRAWER DD
TENTH & DALLAS STREETS
ARTESIA, NEW MEXICO

May, 1961
No. A 31

SUPPLEMENT TO THE OIL PRORATION SCHEDULE

DATE May 5, 1961

PURPOSE: ALLOWABLE REVISION (CANCELLATION)

Effective May 1, 1961, the allowable of the M. R. Volts,
K. V. Barbee, 1-I, 9-11-25, Rondo San Andres Pool, is
hereby cancelled for failure to file Form C-115.

ILLEGIBLE

MLA/ab

M. R. Volts

McWood

OIL CONSERVATION COMMISSION

SUPERVISOR, DISTRICT NO. 2

EXTRA COPY

December 2, 1960

M. R. Volts
1002 West Wall
Midland, Texas

Re: Kenneth V. Barbee Well No. 1,
Unit I, Sec. 9-113-25E, Chaves
County, New Mexico

Dear Sir:

This will acknowledge receipt of corrected forms C-104 and C-105 on the above-captioned well. Though this well is located in the water basin, it will be necessary for you to submit three (3) copies of form C-103 on each string of casing run.

Please secure this information as soon as possible and submit forms C-103 in detail as we requested in our letter of November 21, 1960. Your allowable cannot be assigned until this matter is taken care of.

Very truly yours,

OIL CONSERVATION COMMISSION

M. L. Armstrong
Supervisor, District no. 2

MLA/bh

M. R. VOLTZ
1002 WEST WALL
MIDLAND, TEXAS

RECEIVED

DEC 2 1960

O. C. C.
ARTESIA, OFFICE

November 30, 1960.

State of New Mexico
Oil Conservation Commission
321 Carper Building
Artesia, New Mexico

Attention: Mr. M. L. Armstrong, Supervisor

Re: Kenneth V. Barbee No. 1,
Unit I, Sec. 9-11S-25E,
Chaves County, New Mexico

Gentlemen:

We are returning completed forms C-104 and C-105 corrected as per your letter of November 21, 1960.

In addition to the corrections mentioned, you asked that we submit form C-103 on casing run and results of casing shut-off. We regret that we do not have this information available in any written form, and therefore, cannot be accurate in reporting the results. We trust that Mr. James I. Wright, Field Engineer, Water Rights Division, Roswell, New Mexico, has this information in correct form. If we can be of assistance in obtaining the information from that office, please contact us.

Yours very truly,

M. R. VOLTZ

By: *J. Devenport*

J. Devenport

JH/s

November 21, 1960

M. R. Velts
1002 West Wall
Midland, Texas

Re: Kenneth V. Barbee Well No. 1,
Unit I, Sec. 9-113-25E, Chavez
County, New Mexico

Dear Sir:

We are in receipt of forms C-103, C-104, and C-105 on the above-captioned well. We are returning forms C-104 and C-105 and request that you make the following corrections:

- 1) On form C-104 please give "date first new oil run to tanks;"
- 2) Please give complete casing and cementing record information in the space provided on form C-104;
- 3) Casing and cementing record information on forms C-104 and C-105 should coincide - please adjust accordingly.

In addition to the above, it will be necessary for you to submit three (3) copies of form C-103 on each string of casing run, stating depth, number of sacks of cement, and results of test of casing shutoff.

Please submit these forms to this office as soon as possible so that your allowable can be assigned.

Very truly yours,

OIL CONSERVATION COMMISSION

M. L. Armstrong
Supervisor, District No. 2

MLA/bh

Enc.

OIL CONSERVATION COMMISSION

207 CARPER BUILDING

ARTESIA, NEW MEXICO

October 3, 1960

M. R. Volts
1002 West Wall
Midland, Texas

Re: Kenneth V. Barbee Well No. 1,
Unit I, Sec. 9-11S-25E, Wildcat
Pool, Eaves County, New Mexico

Dear Sir:

This will acknowledge receipt of form C-110 on the above-captioned well. Before this form can be approved, it will be necessary for you to submit three (3) copies of form C-103 on each string of pipe run, indicating depth, number of sacks cement, and results of test of casing shutoff. It will be necessary for you to submit form C-104 (Request for Allowable) along with forms C-103. Form C-105 (Well Record) should be submitted within twenty days of the completion date.

Please see that these forms are filed as soon as possible.

Very truly yours,

OIL CONSERVATION COMMISSION

M. L. Armstrong
Supervisor, District No. 2

MLA/bh

NEW MEXICO OIL CONSERVATION COMMISSION
Santa Fe, New Mexico

Form O-101
Revised (12/1/55)

RECEIVED
AUG 5 1960

NOTICE OF INTENTION TO DRILL

Notice must be given to the District Office of the Oil Conservation Commission and approval obtained before drilling or recompletion begins. If changes in the proposed plan are considered advisable, a copy of this notice showing such changes will be returned to the sender. Submit this notice in **QUINTUPLICATE**. One copy will be returned following approval. See additional instructions in Rules and Regulations of the Commission. If State Land submit 6 Copies Attach Form O- 128 in triplicate to District Office 3 copies of form O-101

Midland, Texas

August 1, 1960

(Place)

(Date)

OIL CONSERVATION COMMISSION
SANTA FE, NEW MEXICO

Gentlemen:

You are hereby notified that it is our intention to commence the Drilling of a well to be known as

M. R. VOLTZ

(Company or Operator)

Kenneth V. Harbes

(Lease)

, Well No. **1**, in **1** (Unit) The well is

located **1500** feet from the **South** line and **640** feet from the **East** line of Section **9**, T **11S**, R **25E**, NMPM.

(GIVE LOCATION FROM SECTION LINE)

Willcox

Pool,

Chaves

County

If State Land the Oil and Gas Lease is No. **—**

If patented land the owner is **Kenneth V. Harbes**

Address **Roswell**

New Mexico

We propose to drill well with drilling equipment as follows

rotary

The status of plugging bond is **current on deposit at Santa Fe**

Drilling Contractor **Allen Drilling Company, Odessa, Texas**

We intend to complete this well in the **San Andres** formation at an approximate depth of **950** feet.

CASING PROGRAM

We propose to use the following strings of Casing and to cement them as indicated:

Size of Hole	Size of Casing	Weight per Foot	New or Second Hand	Depth	Sacks Cement
6-3/8"	5-1/2"	14	new	900	cemented to surface

If changes in the above plans become advisable we will notify you immediately.

ADDITIONAL INFORMATION (If recompletion give full details of proposed plan of work)

APPROVAL IS SUBJECT TO STATE
ENGINEERS REGULATIONS REQUIRED
ON APPLICATION FOR PERMIT TO
DRILL FOR OIL IN WATER BASIN.
BOX 810, ROSWELL, NEW MEXICO
Sincerely yours,

AUG 5

Approved:
Except as follows:

M. R. VOLTZ

(Company or Operator)

By **M. R. VOLTZ**

Position **Operator**

Send Communications regarding well to

Name **M. R. VOLTZ**

Address **1002 West 4th, Midland, Texas**

OIL CONSERVATION COMMISSION

By **W. L. ...**

ALL INFORMATION IS CONFIDENTIAL

NEW MEXICO OIL CONSERVATION COM. SECTION
Santa Fe, New Mexico

Form O-101
Revised (12/1/55)

RECEIVED

NOTICE OF INTENTION TO DRILL

AUG 1 1960

Notice must be given to the District Office of the Oil Conservation Commission and approval obtained before drilling or recompletion begins. If changes in the proposed plan are considered advisable, a copy of this notice showing such changes will be returned to the sender. Submit this notice in QUINTUPPLICATE. One copy will be returned following approval. See additional instructions in Rules and Regulations of the Commission. If State Land submit 6 Copies Attach Form G- 128 in triplicate to District Office 3 copies of form O-101

Midland, Texas

7-29-60

(Place)

(Date)

OIL CONSERVATION COMMISSION
SANTA FE, NEW MEXICO

Gentlemen:

You are hereby notified that it is our intention to commence the Drilling of a well to be known as

M. R. Voltz

(Company or Operator)

Kenneth V. Barbee

(Lease)

Well No. 1, in I. The well is

(Unit)

located 1980 feet from the South line and 660 feet from the

East line of Section 9, T. 11S, R. 23E, NMPM.

(GIVE LOCATION FROM SECTION LINE) Wildcat Pool, Chaves County

If State Land the Oil and Gas Lease is No.

If patented land the owner is Kenneth V. Barbee

Address Roswell New Mexico

We propose to drill well with drilling equipment as follows:

Rotary

The status of plugging bond is Current on deposit at Santa Fe

Drilling Contractor Allen Drilling Co,
Alameda, Texas

We intend to complete this well in the San Andres

formation at an approximate depth of 950 feet.

CASING PROGRAM

We propose to use the following strings of Casing and to cement them as indicated:

Size of Hole	Size of Casing	Weight per Foot	New or Second Hand	Depth	Backs Cement
8-3/4	5-1/2	14	New	900	Cemented to Surface

If changes in the above plans become advisable we will notify you immediately.

ADDITIONAL INFORMATION (If recompletion give full details of proposed plan of work.)

APPROVED BY DISTRICT OFFICE OF STATE
ENGINEER
ON APPROVAL OF THE DISTRICT OFFICE
DRILLING CONTRACTOR
BOX 500 S. W. ALAMEDA, TEXAS
Sincerely yours,

Approved:
Except as shown:

AUG 1 1960

OIL CONSERVATION COMMISSION

By M. R. Voltz

Allen Drilling Co.

By M. R. Voltz

Drilling Contractor

Send Communications to address well in

Name Allen Drilling Co.

NEW MEXICO OIL CONSERVATION COMMISSION
SANTA FE, NEW MEXICO

Form C-110

Revised 7/1/55

(File the original and 4 copies with the appropriate district office)

RECEIVED

CERTIFICATE OF COMPLIANCE AND AUTHORIZATION
TO TRANSPORT OIL AND NATURAL GAS

OCT 3 1960

O. C. C.
REG. OFFICE

Company or Operator M. R. Velts Lease Kenneth Barber

Well No. 1 Unit Letter I S 9 T 118 R 251 Pool Wildcat

County Chaves Kind of Lease (State, Fed. or Patented) Patented

If well produces oil or condensate, give location of tanks: Unit J S 9 T 118 R 251

Authorized Transporter of Oil or Condensate Midland Corporation

Address 306 V & J Tower, Midland, Texas

(Give address to which approved copy of this form is to be sent)

Authorized Transporter of Gas

Address

(Give address to which approved copy of this form is to be sent)

If Gas is not being sold, give reasons and also explain its present disposition:

does not produce enough to market

Reasons for Filing: (Please check proper box) New Well ☒ ()

Change in Transporter of (Check One): Oil () Dry Gas () C'head () Condensate ()

Change in Ownership () Other ()

Remarks: (Give explanation below)

The undersigned certifies that the Rules and Regulations of the Oil Conservation Commission have been complied with.

Executed this the 30 day of September 1960

By M. R. Velts

Approved DEC 14 1960 1960

Title Operator

OIL CONSERVATION COMMISSION

Company M. R. Velts

By M. L. Armstrong

Address 1002 West Wall

Title OIL AND GAS INSPECTOR

Midland, Texas

NEW MEXICO
OIL CONSERVATION COMMISSION

~~SECRET~~
~~HOBBY, NEW MEXICO~~

DRAWN BY
ANTHONY, NEW MEXICO

December, 1960
No. A 33

SUPPLEMENT TO THE OIL PRORATION SCHEDULE

DATE December 15, 1960

PURPOSE: ALLOWABLE ASSIGNMENT FOR A NEW WELL

Effective December 1, 1960 an allowable of 13 barrels of oil per day or a total of 403 barrels for the month is hereby assigned to the M.R.Voltz Kenneth V. Barbee, 1-I, 9-11-25, Wildcat San Andres Pool.

MLA/hb

M. R. Voltz

McWood

OIL CONSERVATION COMMISSION

~~PRORATION MANAGER~~
Supervisor, District No. 2

EXTRA COPY

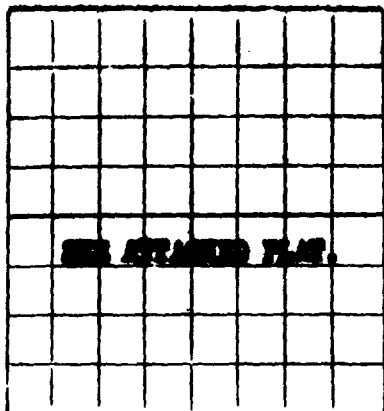

AREA 640 ACRES
LOCATE WELL CORRECTLY

NEW MEXICO OIL CONSERVATION COMMISSION

Santa Fe, New Mexico

RECEIVED
NOV 13 1960
WELL RECORD
NOV 21 1960

DEC 2 1960

D. C. C.
OFFICE

Mail to District Office, Oil Conservation Commission, to which Form O-101 was sent not later than twenty days after completion of well. Follow Instructions in Rules and Regulations of the Commission. Submit in QUINTUPLICATE. If well is drilled submit 6 Copies

E. R. VOLPE

(Company or Operator)

LEONARD V. BARNES

(Lessee)

Well No. 1, in NE 1/4 of SE 1/4, of Sec. 9, T. 11N, R. 12E, NMPM.

Wildcat Pool, Chaves County.

Well is 600 feet from East line and 1900 feet from South line

of Section 9. If State Land the Oil and Gas Lease No. is

Drilling Commenced August 7, 1960 Drilling was Completed September 5, 1960

Name of Drilling Contractor Allen Drilling Company

Address P. O. Box 961, Odessa, Texas

Elevation above sea level at Top of Tubing Head 3460 feet. The information given is to be kept confidential until , 19.

OIL SANDS OR ZONES

No. 1, from 892 to 925 No. 4, from to

No. 2, from to No. 5, from to

No. 3, from to No. 6, from to

IMPORTANT WATER SANDS

Include data on rate of water inflow and elevation to which water rose in hole.

No. 1, from 420 to 480 feet. rotary mud in hole

No. 2, from 570 to 630 feet. water flowed

No. 3, from to feet.

No. 4, from to feet.

CASING RECORD

SIZE	WEIGHT PER FOOT	NEW OR USED	AMOUNT	KIND OF SHOE	CUT AND PULLED FROM	PERFORATIONS	PURPOSE
4-1/2"	2.5	NEW	925	Halliburton		892-912	

MUDDING AND CEMENTING RECORD

SIZE OF HOLE	SIZE OF CASING	WHERE SET	NO. BAGS OF CEMENT	METHOD USED	MUD GRAVITY	AMOUNT OF MUD USED
12-1/4"	10-3/4"	30'	50	Halliburton		10 tons
8-3/4"	7"	630'	800	"		11 tons
6-1/4"	4-1/2"	925'	75	"		10 tons

RECORD OF PRODUCTION AND STIMULATION

(Record the Process used, No. of Qts. or Gals. used, interval treated or shot.)

Enclosures: 1 copy Treatment Log, stage one, depth 925'
1 copy Treatment Log, stage two, depth 924-930'
1 copy "Western Company" Gammatron simultaneous nuclear log.

Result of Production Stimulation

RECORD OF DRILL-STEM AND SPECIAL TESTS

If drill-stem or other special tests or deviation surveys were made, submit report on separate sheet and attach hereto

TOOLS USED

Rotary tools were used from 0 feet to 930 feet, and from feet to feet.
Cable tools were used from feet to feet, and from feet to feet.

PRODUCTION

Put to Producing September 7, 1960

OIL WELL: The production during the first 24 hours was 124 barrels of liquid of which 10% was oil; % was emulsion; 90% water; and % was sediment. A.P.I. Gravity.

GAS WELL: The production during the first 24 hours was M.C.F. plus barrels of liquid Hydrocarbon. Shut in Pressure lbs.

Length of Time Shut in

PLEASE INDICATE BELOW FORMATION TOPS (IN CONFORMANCE WITH GEOGRAPHICAL SECTION OF STATE):

Southeastern New Mexico

Northwestern New Mexico

T. Anhy	T. Devonian	T. Ojo Alamo
T. Salt	T. Silurian	T. Kirtland-Fruitland
B. Salt	T. Montoya	T. Farmington
T. Yates	T. Simpson	T. Pictured Cliffs
T. 7 Rivers	T. McKee	T. Menefee
T. Queen	T. Ellenburger	T. Point Lookout
T. Grayburg	T. Gr. Wash	T. Mancos
T. San Andres	T. Granite	T. Dakota
T. Glorieta	T.	T. Morrison
T. Drinkard	T.	T. Penn
T. Tubbs	T.	T.
T. Abo	T.	T.
T. Penn	T.	T.
T. Miss	T.	T.

FORMATION RECORD

From	To	Thickness in Feet	Formation	From	To	Thickness in Feet	Formation
0	430		redbed and sand				
430	490		gray limy sand				
490	530		shale, anhydrite line				
530	570		gray porous lime				
570	630		shale, gravel, lime				
630	710		gray dolomite				
710	740		dolomite gravel				
740	930		gray dolomite				

OIL CONSERVATION COMMISSION
ARTESIA DIST. OFFICE
No. Copies Received
DISTRIBUTION
FILE

ATTACH SEPARATE SHEET IF ADDITIONAL SPACE IS NEEDED

I hereby swear or affirm that the information given herewith is a complete and correct record of the well and all work done on it so far as can be determined from available records.

November 15, 1960

Company Operator M. R. VOLTZ

1002 West Wall, Midland, Texas

NEW MEXICO OIL CONSERVATION COMMISSION
Santa Fe, New Mexico

RECEIVED
21 1960

(Form C-104)
Revised 7/1/57

REQUEST FOR (OIL) - (GAS) ALLOWABLE

New Well
Recompletion

This form shall be submitted by the operator before an initial allowable will be assigned to any completed Oil or Gas well. Form C-104 is to be submitted in QUADRUPPLICATE to the same District Office to which Form C-101 was sent. The allowable will be assigned effective 7:00 A.M. on date of completion or recompletion provided this work is completed during calendar month of completion or recompletion. The completion date shall be that date in the case of an oil well when new oil is delivered into the stock tanks. Gas must be reported on 15.025 psia at 60° Fahrenheit.

Midland, Texas

DEC 2 1960

November 15, 1960

(Place)

(Date)

WE ARE HEREBY REQUESTING AN ALLOWABLE FOR A WELL KNOWN AS

M. R. VOLTS

KENNETH V. BARNE

Well No. 1

in

NE

1/4

SE

1/4

(Company or Operator)

(Lease)

I

Sec. 9

T. 11S

R. 25E

NMPM,

Midland

Pool

Unit Letter

County

Date Spudded August 7, 1960

Date Drilling Completed September 5, 1960

Please indicate location:

D	G	B	A
E	F	G	H
L	K	J	I
M	N	O	P

19803.660E

Elevation 3460' Total Depth 930' FRT 918'

Top Oil/Gas Pay 890' Name of Prod. Form. San Andres

PRODUCING INTERVAL -

Perforations 892-912

Open Hole 925-930 Depth 924' Casing Shoe 910'

OIL WELL TEST -

Natural Prod. Test: bbls. oil, bbls. water in hrs, min. Size

Test After Acid or Fracture Treatment (after recovery of volume of oil equal to volume of load oil used): 13 bbls. oil, 11 bbls. water in 24 hrs, 0 min. Size 0H

GAS WELL TEST -

Natural Prod. Test: MCF/day; Hours flowed Choke Size

Method of Testing (pitot, back pressure, etc.):

Test After Acid or Fracture Treatment: MCF/day; Hours flowed

Choke Size Method of Testing:

Acid or Fracture Treatment (Give amounts of materials used, such as acid, water, oil, and

sand): 17,500 gal. regular acid; 1000# sand

Casing Tubing Date first new

Press. 0# Press. 1900 oil run to tanks

Oil Transporter Midland Corporation, Abilene, Texas

Gas Transporter

Tubing, Casing and Cementing Record

Size Feet Sx

4-1/2	925	75
7	635	800
10 3/4	30	50

Remarks:

I hereby certify that the information given above is true and complete to the best of my knowledge.

Approved DEC 14 1960, 19.

M. R. VOLTS

(Company or Operator)

OIL CONSERVATION COMMISSION

By: M. L. Armstrong

Title OIL AND GAS INSPECTOR

By:

M. R. VOLTS

(Signature)

M. R. Volts

Title Owner and Operator

Send Communications regarding well to:

Name M. R. Volts

Address 1002 West Wall, Midland, Texas

NEW MEXICO OIL CONSERVATION COMMISSION
MISCELLANEOUS REPORTS ON WELLS

(Submit to appropriate District Office as per Commission Rule 1106) **DEC 14 1960**

COMPANY M. R. Volts 1002 West Wall Midland, Texas ☐ C. C. C.
(Address) ARTESIA OFFICE

LEASE Kenneth V. Barbee WELL NO. 1 UNIT I 5 9 T 11 S R 25 E
DATE WORK PERFORMED 8/27 to 8/29/60 POOL Wildest

This is a Report of: (Check appropriate block) ☐ Results of Test of Casing Shut-off
☐ Beginning Drilling Operations ☐ Remedial Work
☐ Plugging ☒ Other Setting 4-1/2" casing

Detailed account of work done, nature and quantity of materials used and results obtained.

Drilled 6-3/4" hole to 925'. Ran 31 lbs. 4-1/2", 9.50# J-55 STAC casing, Larkin float shoe. Total - 923'. Larkin centralizers @ 917', 902', 887'. HOMO cemented with 60 sac regular with 25 gal & 25# Gilsomite/sack & 15 sac. reg. Heat.. Circulated 16 sac. W.O.C. 48 hours. Tested casing @ 3000# for 30 minutes, Test O.K.

FILL IN BELOW FOR REMEDIAL WORK REPORTS ONLY

Original Well Data:

DF Elev. _____ TD _____ PBD _____ Prod. Int. _____ Compl Date _____
Tbng. Dia _____ Tbng Depth _____ Oil String Dia _____ Cil String Depth _____
Perf Interval (s) _____
Open Hole Interval _____ Producing Formation (s) _____

RESULTS OF WORKOVER:

	BEFORE	AFTER
Date of Test	_____	_____
Oil Production, bbls. per day	_____	_____
Gas Production, Mcf per day	_____	_____
Water Production, bbls. per day	_____	_____
Gas-Oil Ratio, cu. ft. per bbl	_____	_____
Gas Well Potential, Mcf per day	_____	_____
Witnessed by _____		
		(Company)

OIL CONSERVATION COMMISSION

Name M. L. Armstrong
Title DEC 14 1960
Date DEC 14 1960

I hereby certify that the information given above is true and complete to the best of my knowledge.

Name James E. Wood
Position Engineer
Com. M. R. Volts

DEC 14 1960

O. C. C.
ARTESIA, OFFICENEW MEXICO OIL CONSERVATION COMMISSION
MISCELLANEOUS REPORTS ON WELLS

(Submit to appropriate District Office as per Commission Rule 1106)

COMPANY M. R. Volts 1002 West Wall Midland, Texas
(Address)

LEASE Kenneth V. Barbee WELL NO. 1 UNIT I S 9 T 11 8 R 25 8

DATE WORK PERFORMED 8/14 thru 8/28/60 POOL Wildcat

This is a Report of: (Check appropriate block) ☐ Results of Test of Casing Shut-off

☐ Beginning Drilling Operations ☐ Remedial Work

☐ Plugging ☒ Other Setting 7" Casing

Detailed account of work done, nature and quantity of materials used and results obtained. Drilled 8-3/4" hole to 667'. Ran 21 joints 7", 23# J-55 SMC Casing, BOMCO float shoe, total 630'. Cemented w/200 sack regular neat. Temperature survey - top cement @ 500'. Drilled ahead to TD of 925'. Perforated casing @ 450'; cemented with 250 sack regular Neat. Tested casing & cement after 48 hours. Cement job no good. Re-cemented with 150 sack regular with 2% calcium chloride. WBC-48 hours. Tested casing & cement @ 500'. Test o.k. Drilled out cement from 426' to 455'. Went to bottom @ 925'; circulated preparatory to running 4-1/2" casing.

FILL IN BELOW FOR REMEDIAL WORK REPORTS ONLY

Original Well Data:

DF Elev. _____ TD _____ PBD _____ Prod. Int. _____ Compl Date _____

Tbng. Dia _____ Tbng Depth _____ Oil String Dia _____ Oil String Depth _____

Perf Interval (s) _____

Open Hole Interval _____ Producing Formation (s) _____

RESULTS OF WORKOVER:

	BEFORE	AFTER
Date of Test	_____	_____
Oil Production, bbls. per day	_____	_____
Gas Production, Mcf per day	_____	_____
Water Production, bbls. per day	_____	_____
Gas-Oil Ratio, cu. ft. per bbl.	_____	_____
Gas Well Potential, Mcf per day	_____	_____
Witnessed by _____		

(Company)

OIL CONSERVATION COMMISSION

Name M. L. Armstrong

Title DEC 14 1960

Date OIL AND GAS INSPECTOR

I hereby certify that the information given above is true and complete to the best of my knowledge.

Name James J. Wood

Position Engineer

Company M. R. Volts

(RECEIVED)

NEW MEXICO OIL CONSERVATION COMMISSION
MISCELLANEOUS REPORTS ON WELLS

DEC 14 1960

(Submit to appropriate District Office as per Commission Rule 1106)

COMPANY M. R. Valts 1902 West Wall Midland, Texas O. C. C.
(Address) ARTESIA, OFFICE

LEASE Samuel V. Barboe WELL NO. 1 UNIT I S 9 T 11S R 25E
DATE WORK PERFORMED 8/9/60 & 8/10/60 POOL Wildcat

This is a Report of: (Check appropriate block) ☐ Results of Test of Casing Shut-off
☐ Beginning Drilling Operations ☐ Remedial Work
☐ Plugging ☒ Other Setting 10-3/4" Casing.

Detailed account of work done, nature and quantity of materials used and results obtained.
Spent @ 3:00 P.M. 8/7/60. Drilled 15" hole to 30'. Ran 2 jts. 10-3/4", 32' STAG J-55
Casing. Cemented w/38 sac regular with 2% calcium chloride, W.O.C. 2 1/2 hrs., tested
casing @ 500# for 30 minutes, test o.k., drilled out, tested cement @ 200# for 15 min.,
test o.k.

FILL IN BELOW FOR REMEDIAL WORK REPORTS ONLY

Original Well Data:
DF Elev. _____ TD _____ PBD _____ Prod. Int. _____ Compl Date _____
Tbng. Dia _____ Tbng Depth _____ Oil String Dia _____ Oil String Depth _____
Perf Interval (s) _____
Open Hole Interval _____ Producing Formation (s) _____

RESULTS OF WORKOVER:	BEFORE	AFTER
Date of Test	_____	_____
Oil Production, bbls. per day	_____	_____
Gas Production, Mcf per day	_____	_____
Water Production, bbls. per day	_____	_____
Gas-Oil Ratio, cu. ft. per bbl.	_____	_____
Gas Well Potential, Mcf per day	_____	_____
Witnessed by _____		
	(Company)	

OIL CONSERVATION COMMISSION	I hereby certify that the information given above is true and complete to the best of my knowledge.
Name <u>M. L. Armstrong</u>	Name <u>James E. Ward</u>
Title <u>DEC 14 1960</u>	Position <u>Engineer</u>
Date <u>OIL AND GAS INSPECTOR</u>	Company <u>M. R. Valts</u>

NEW MEXICO OIL CONSERVATION COMMISSION
MISCELLANEOUS REPORTS ON WELLS

(Submit to appropriate District Office as per Commission Rule 1106) NOV 21 1960

COMPANY N. R. VOLTZ, 1002 West Wall, Midland, Texas
(Address)

☐ O. C. C.
ARTESIAN OFFICE

LEASE Kenneth V. Barbee WELL NO. 1 UNIT I 59 T 118 R 252

DATE WORK PERFORMED August 7, 1960 POOL Wildcat

This is a Report of: (Check appropriate block) ☐ Results of Test of Casing Shut-off

☒ Beginning Drilling Operations

☐ Remedial Work

☐ Plugging

☐ Other _____

Detailed account of work done, nature and quantity of materials used and results obtained.

Spudded August 7, 1960

TD 930'

Perf. 892-912'

PBD: 918'

Treatments: 17,500 gal. reg. 15% acid, 1000# sand

Tubing: 2" J-5 set @ 910'

cemented to surface

FILL IN BELOW FOR REMEDIAL WORK REPORTS ONLY

Original Well Data:

DF Elev. 3461' TD 930 PBD 918 Prod. Int. 892-912 Compl Date Sept. 5, 1960

Tbng. Dia 2" Tbng Depth 900 Oil String Dia 4-1/2" Oil String Depth 925'

Perf Interval (s) 892-912

Open Hole Interval 925-930 Producing Formation (s) San Andres

RESULTS OF WORKOVER:

BEFORE

AFTER

Date of Test

Oil Production, bbls. per day

Gas Production, Mcf per day

Water Production, bbls. per day

Gas-Oil Ratio, cu. ft. per bbl.

Gas Well Potential, Mcf per day

Witnessed by _____

(Company)

OIL CONSERVATION COMMISSION

I hereby certify that the information given above is true and complete to the best of my knowledge.

Name M. L. Armstrong

Name M. R. Valtz

Title OIL AND GAS INSPECTOR

Position Owner and Operator

Date DEC 14 1960

Com: N. R. VOLTZ

RECEIVED

NEW MEXICO OIL CONSERVATION COMMISSION
WELL LOCATION AND ACREAGE DEDICATION PLAT

FORM C-128
Revised 5/1/57
1960

SEE INSTRUCTIONS FOR COMPLETING THIS FORM ON THE REVERSE SIDE

SECTION A

ARTESIA, OFFICE

Operator M. R. Volts Lease Kenneth V. B. Lee Well No. 1

Unit Letter I Section 9 Township 11 SOUTH Range 25 EAST County CHAVES

Actual Footage Location of Well: 1980 feet from the SOUTH line and 660 feet from the EAST line

Ground Level Elev. 3960 Producing Formation SA Pool Wildcat Dedicated Acreage: Acres

1. Is the Operator the only owner in the dedicated acreage outlined on the plat below? YES _____ NO _____. ("Owner" means the person who has the right to drill into and to produce from any pool and to appropriate the production either for himself or for himself and another. (65-3-29 (e) NMSA 1935 Comp.)
2. If the answer to question one is "no," have the interests of all the owners been consolidated by communitization agreement or otherwise? YES _____ NO _____. If answer is "yes," Type of Consolidation _____
3. If the answer to question two is "no," list all the owners and their respective interests below:

Owner	Land Description

SECTION B

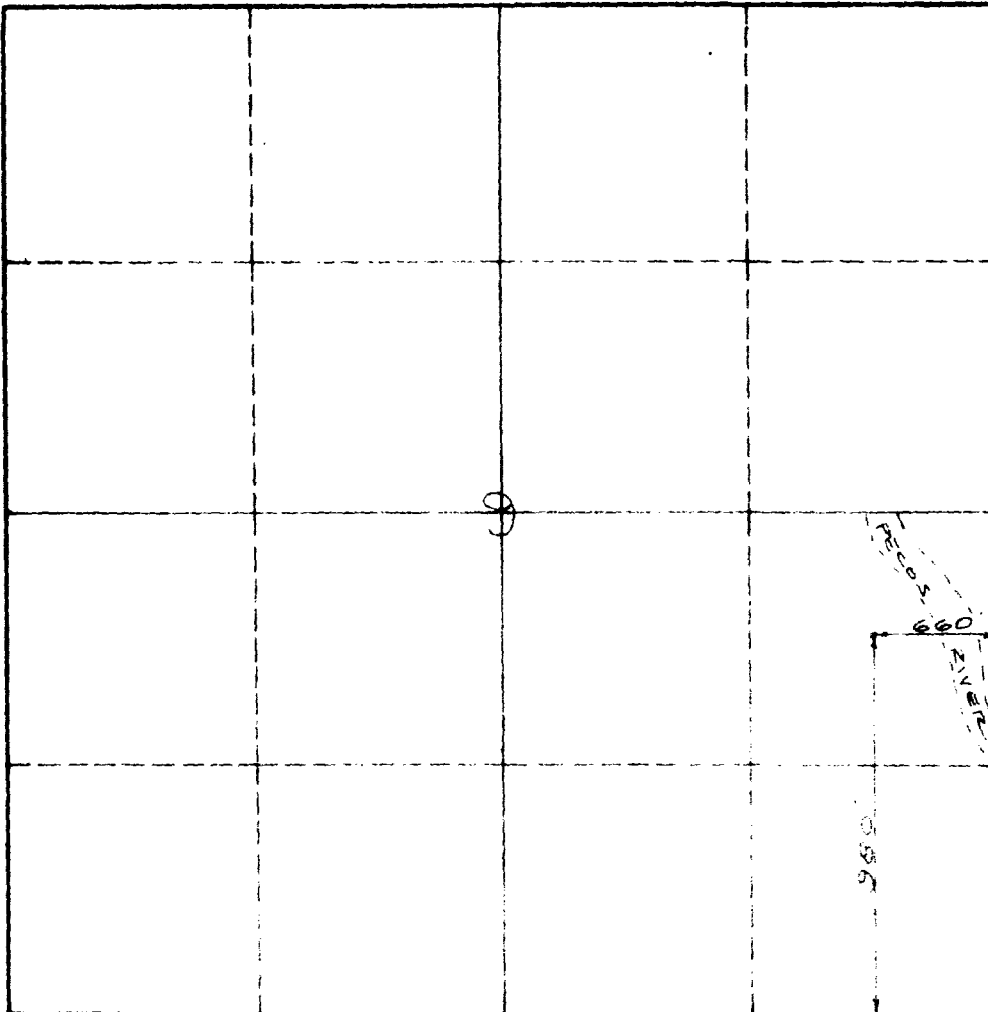

CERTIFICATION

I hereby certify that the information in SECTION A above is true and complete to the best of my knowledge and belief.

Name M. R. Volts

Position Drilling Contractor

Company Owner M. R. Volts

Date 7-29-60

I hereby certify that the well location shown on the plat in SECTION B was plotted from field notes of actual surveys made by me or under my supervision, and that the same is true and correct to the best of my knowledge and belief.

[Signature]
Certificate No. 367

0 330 660 990 1320 1650 1980 2310 2640 2000 1500 1000 500 0