

sanchez lagumidi03 27-May-1992 08:05 laguna.bmp

sanchez lagumidi03 27-May-1992 08:05 laguna.bmp

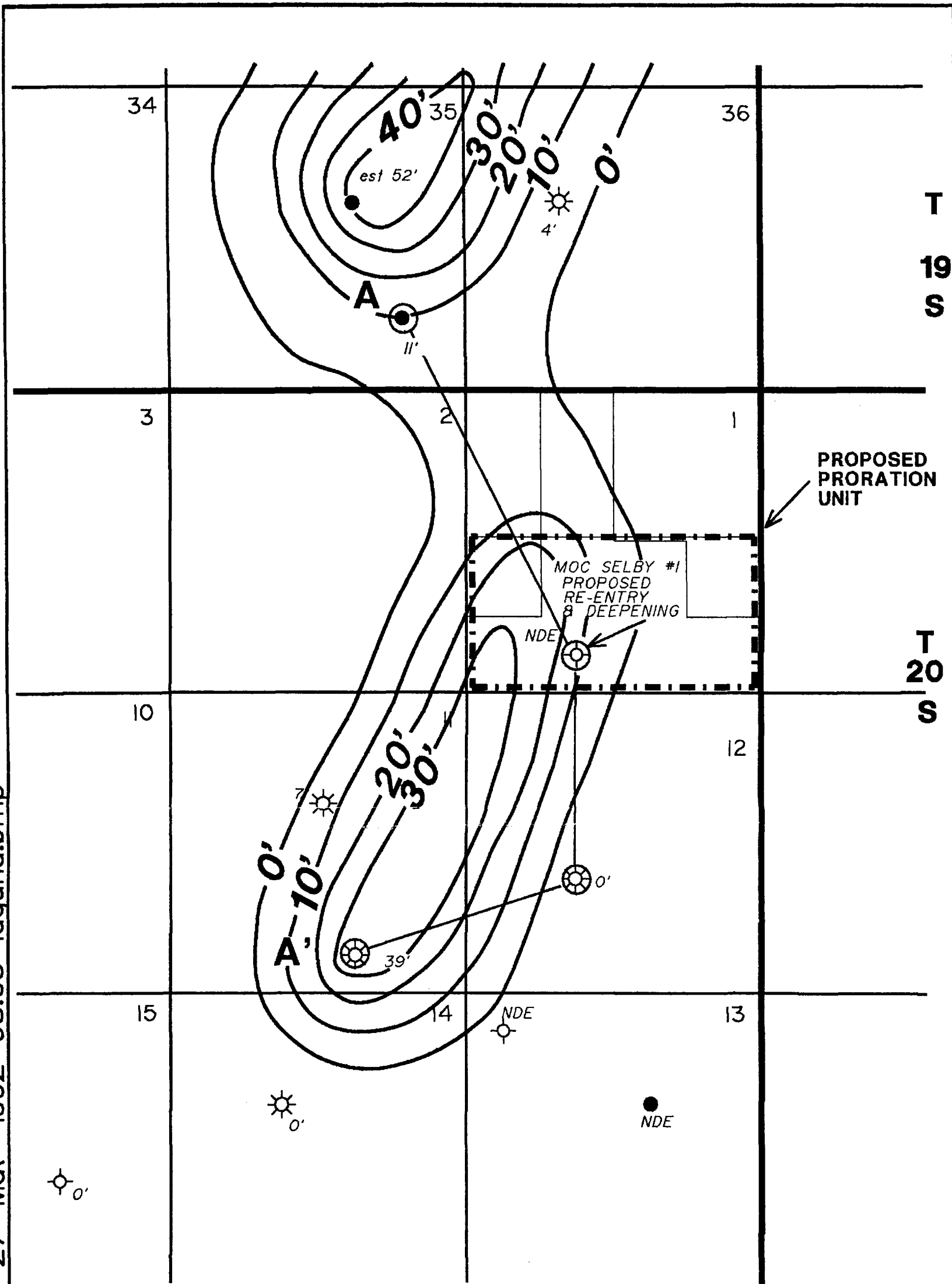

R-35-E

BEFORE THE  
OIL CONSERVATION DIVISION  
Santa Fe, New Mexico

Case No. 10796 Exhibit No. 3

Submitted by: Manzano Oil Corporation

Hearing Date: August 12, 1993

MARATHON OIL COMPANY	NMOCD COMPULSORY POOLING HEARING MAY 28, 1992
<b>LAGUNA EAST PROSPECT</b> LEA COUNTY, NEW MEXICO	
<b>ISOPACH MAP</b> MIDDLE WOLFCAMP PAY INTERVAL NET DOLOMITE POROSITY > 4% C.I. 10'	
ORIGINAL SCALE: P-3000'	DATE: 5/92
AUTHOR: S.A. WILSON	REVISED:
DRAFTED BY: R. SANCHEZ	PROJECT:
LVL. 28	FILE LOG:

LAGUNA.BMP - EPL  
LAGUNA.BMP - REF JMOCD