

STATE OF NEW MEXICO
ENERGY, MINERALS AND NATURAL RESOURCES DEPARTMENT
OIL CONSERVATION DIVISION

IN THE MATTER OF THE HEARING
CALLED BY THE OIL CONSERVATION
DIVISION FOR THE PURPOSE OF
CONSIDERING:

CASE NO. 10884
ORDER NO. R-10040

APPLICATION OF GECKO, INC. FOR AN UNORTHODOX OIL WELL LOCATION,
LEA COUNTY, NEW MEXICO

ORDER OF THE DIVISION

BY THE DIVISION:

This cause came on for hearing at 8:15 a.m. on December 16, 1993, at Santa Fe, New Mexico, before Examiner Jim Morrow.

NOW, on this 22nd day of December, 1993, the Division Director, having considered the record and the recommendations of the Examiner, and being fully advised in the premises,

FINDS THAT:

(1) Due public notice having been given as required by law, the Division has jurisdiction of this cause and the subject matter thereof.

(2) The applicant, Gecko, Inc., seeks authority to drill its Gecko State "35" Well No. 1 at an unorthodox oil well location 434 feet from the North line and 1762 feet from the East line (Unit B) of Section 35, Township 16 South, Range 37 East, NMPM, Lea County, New Mexico, to test the Undesignated Casey-Strawn Pool, the N/2 NE/4 of said Section 35 to be dedicated to said well forming a standard 80-acre oil spacing and proration unit.

(3) At the time of the hearing the applicant stated that the well had already been drilled, that the well was dry in the Strawn formation, and that the well would be properly plugged using procedures to be obtained from the Hobbs District Office of the Division. The applicant also stated that any future well completion attempts would not be initiated until application for approval had been submitted to and received from the appropriate office of the Oil Conservation Division.

- (4) The applicant requested this case be dismissed.
- (5) The applicant's request for dismissal should be granted.

IT IS THEREFORE ORDERED THAT:

Case No. 10884 is hereby dismissed.

DONE at Santa Fe, New Mexico, on the day and year hereinabove designated.

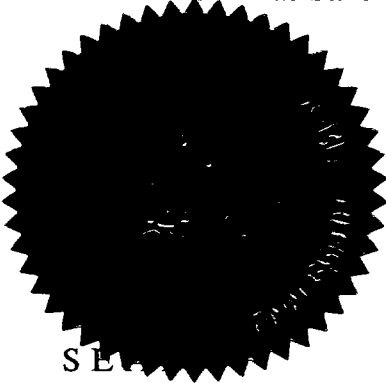

STATE OF NEW MEXICO
OIL CONSERVATION DIVISION

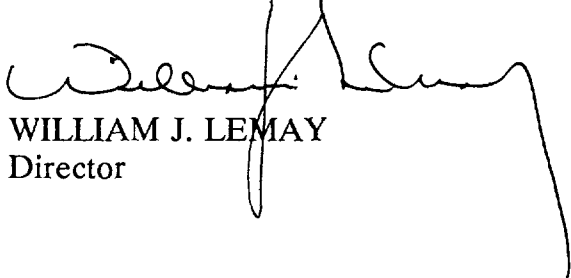
WILLIAM J. LEMAY
Director

445 BOP D

CAPROCK;QUEEN (cont.)
CIRCLE RIDGE PRODUCTION INC. (cont.)
WEST CAPROCK QUEEN SAND UNIT TR 7 (cont.)
" 3 J 17-14-31 SI INPUT
" 4 O 17-14-31 WF
WEST CAPROCK QUEEN SAND UNIT TR 8
" 2 L 17-14-31 WF
WEST CAPROCK QUEEN SAND UNIT TR 9
" 1 B 21-14-31 INPUT
" 2 A 21-14-31 WF
" 3 G 21-14-31 WF
WEST CAPROCK QUEEN SAND UNIT TR 10
" 1 D 21-14-31 INPUT
" 2 C 21-14-31 WF
" 3 F 21-14-31 SI INPUT
" 4 A 20-14-31 WF
***** DAKOTA RESOURCES INC. (1) *****
WAKAM TANKA FEDERAL
" (10) 1 M 27-13-31 M
" (56) 2 M 27-13-31 M
" (8) 3 K 27-13-31 M
***** FI-RO CORP. *****
HONDO HOLLOWAY STATE
" (2) 1 F 36-12-31 M
" (2) 2 P 36-12-31 M
NORTH CAPROCK QUEEN UNIT 1 TR 27
" (3) 5-Y E 8-13-32 M
***** GROVER-MCKINNEY OIL CO. *****
CAUDILL (41) 2 D 34-13-31 M
***** LARUE, C E & B M MUNCY JR *****
***** FEDERAL WATERFLOOD PROJECT *****
CAPACITY ALLOWABLE
FEDERAL "M" 1 P 34-13-31 INPUT
" 2 D 34-13-31 WF
" 3 J 34-13-31 SI INPUT
" 4 I 34-13-31 WF
***** LARUE, C E & B M MUNCY JR *****
***** TRIGG FEDERAL WATERFLOOD PROJECT *****
CAPACITY ALLOWABLE
TRIGG FEDERAL
" 1 I 9-14-31 WF
" 2 P 9-14-31 SI INPUT
" 4 A 9-14-31 WF
" 5 P 4-14-31 INPUT
" 6 I 4-14-31 WF
" 8 A 4-14-31 WF
" 9 O 9-14-31 WF
" 10 J 9-14-31 INPUT
" 11 G 9-14-31 WF
" 12 B 9-14-31 INPUT
" 13 O 4-14-31 WF
" 15 G 4-14-31 WF
" 16 B 4-14-31 INPUT
" 17 M 9-14-31 INPUT
" 18 K 9-14-31 WF
" 19 F 9-14-31 INPUT
" 22 K 4-14-31 WF
" 23 F 4-14-31 SI INPUT
" 24 C 4-14-31 WF
" 25 M 9-14-31 WF
" 26 L 9-14-31 INPUT
" 27 E 9-14-31 WF
" 28 D 9-14-31 INPUT
" 31 E 4-14-31 WF
" 32 D 4-14-31 INPUT
" 37 B 4-14-31 SI INPUT
***** MURPHY OPERATING CORP. *****
***** WATERFLOOD PROJECT *****
NORTH CAPROCK QUEEN UNIT #1
R- 1073
Maximum Allowable Formula:
75 X 80 = 6000
NORTH CAPROCK QUEEN UNIT 1 TR 6
" F 32-12-32 SI INPUT

CAPROCK;QUEEN (cont.)
MURPHY OPERATING CORP. (cont.)
NORTH CAPROCK QUEEN UNIT 1 TR 12
" 10 J 32-12-32 SI INPUT
" 13 M 32-12-32
NORTH CAPROCK QUEEN UNIT 1 TR 24
" 12 L 5-13-32 SI INPUT
NORTH CAPROCK QUEEN UNIT 1 TR 26
" 7 G 7-13-32 WF
***** MURPHY OPERATING CORP. *****
***** WATERFLOOD PROJECT *****
NORTHEAST CAPROCK QUEEN UNIT
R- 2133
Maximum Allowable Formula:
34 X 80 = 2720
NORTHEAST CAPROCK QUEEN UNIT
" 1 L 16-12-32 SI INPUT
" 2 K 16-12-32 WF
" 3 J 16-12-32 INPUT
" 5 L 15-12-32 INPUT
" 8 M 16-12-32 SI INPUT
" 9 O 16-12-32 WF
" 12 P 15-12-32 SI INPUT
" 14 N 14-12-32 SI INPUT
" 21 D 22-12-32 INPUT
" 22 C 22-12-32 WF
" 23 B 22-12-32 SI INPUT
" 25 E 23-12-32 SI INPUT
" 35-Y M 16-12-32 WF
***** RV OIL CO. *****
RENO FEDERAL
" (2) 2 M 3-15-31 M
" (2) 3 K 3-15-31 M
" (2) 4 M 3-15-31 M
ZIMMERMAN (3) 2 P 20-14-31 M
ZIMMERMAN "A"
" (2) 1 M 21-14-31 M
" (2) 4 L 21-14-31 M
***** UNION OIL CO. OF CALIFORNIA *****
***** WATERFLOOD PROJECT *****
SOUTH CAPROCK QUEEN UNIT
R- 1729
Maximum Allowable Formula:
194 X 80 = 15520
SOUTH CAPROCK QUEEN UNIT TR 48
" 10 J 30-15-31 SI INPUT
" 16 P 30-15-31 SI INPUT
SOUTH CAPROCK QUEEN UNIT TR 54
" 15 O 28-14-31 INPUT
SOUTH CAPROCK QUEEN UNIT TR 67
" 12 L 33-14-31 WF
SOUTH CAPROCK QUEEN UNIT TR 68
" 3 C 33-14-31 WF
SOUTH CAPROCK QUEEN UNIT TR 70
" 14 N 33-14-31 WF
***** YATES DRILLING CO. *****
FREDIA FEDERAL
" (1) 1 G 3-13-31 M
CAPROCK;SAM ANDRES
Top Allowable 80 GOR Limit 2000
No Test Required
Top Casinghead Gas Limit 160 MCF
***** ELK OIL CO. *****
STATE D J 1 H 2-12-32 M
CAPROCK;HOLFCAMP, EAST
Top Allowable 230 GOR Limit 2000
No Test Required
Top Casinghead Gas Limit 460 MCF

CAPROCK;HOLFCAMP, EAST (cont.)
AMERADA HESS CORP. (cont.)
L H CHAMBERS "A"
" 1 L 1-12-32 M
" 1 Q 2-12-32 MGV
" 2 B 11-12-32 M
***** RUK RESOURCES INC. *****
MEN MEXICO "BH" STATE NCT-1
" 2 F 11-12-32 NO C-115
CAPROCK;HOLFCAMP, NORTH
Top Allowable 230 GOR Limit 2000
No Test Required
Top Casinghead Gas Limit 460 MCF
***** MARKINS OIL & GAS INC. *****
LANDLADY 1 J 8-12-32 M
CARTER;SAM ANDRES, SOUTH
Top Allowable 44 GOR Limit 2000
No Test Required
Top Casinghead Gas Limit 88 MCF
***** GREAT WESTERN DRILLING CO. *****
BURTON 1 O 5-18-39 *29
*Acreage Factor 0.650
EFFIE CARTER 1 J 5-18-39 *29
Acreage Factor 0.650
*Acreage Factor Limits
2 N 5-18-39 M
3 K 5-18-39 M
VHQUEIN 2 F 8-18-39 M
SYLVESTER JOHNSON
" 1 B 8-18-39 M
" 2 C 8-18-39 *29
Acreage Factor 0.650
*Acreage Factor Limits
3 O 8-18-39 M
***** YOUNG, MARSHALL R OIL CO. *****
CARTER "A"
" 1 A 7-18-39 M
CARY;MONTIYA
Top Allowable 187 GOR Limit 2000
No Test Required
Top Casinghead Gas Limit 374 MCF
***** MOBIL PRODUCING TX & M INC. *****
E O CARSON 9 E 33-21-37 M
150' from Carter #142 sel
Top Allowable 445 GOR Limit 2000
Top Casinghead Gas Limit 890 MCF
***** CODY, WILLIAMS INC. *****
SHIPP *27*
" (16) 1 O 27-16-37 M 2188
SHIPP #34*
" (10) 3 M 34-16-37 M 1800
SHIPP #34* A
" (114) 1 C 34-16-37 M 1228
" (12) 2 F 34-16-37 M 1250
***** SANTA FE EXPLORATION CO. *****
WEST KNOWLES
" (11) 8 A 34-16-37 M 1727

CASEY;STRAWN (cont.)
YATES PETROLEUM CORP. (cont.)
BURTON "AER" COM
" (4) 1 J 26-16-37 M 151M
CASEY;STRAWN, WEST
Top Allowable 445 GOR Limit 2000
Top Casinghead Gas Limit 890 MCF
***** AMERIND OIL CO. LP *****
WEIERS (43) 1 C 33-16-37 M 1767
SHIPP (41) 1 B 33-16-37 M 2268
CASS;PENN
Top Allowable 267 GOR Limit 2000
Top Casinghead Gas Limit 534 MCF
***** TEXACO ENPL & PROD INC. *****
L VAN ETTEN (310) 13 K 9-20-37 M267 371
CATO;SAM ANDRES
Top Allowable 80 GOR Limit 2000
Top Casinghead Gas Limit 160 MCF
***** KELL OIL & GAS INC. *****
***** CATO SAM ANDRES UNIT W.F. PROJECT *****
CAPACITY ALLOWABLE
CATO SAM ANDRES UNIT
" 1 H 3-8-30 WF
" 5 L 2-8-30 WF
" 6 M 2-8-30 WF
" 7 N 2-8-30 WF
" 9 O 3-8-30 WF
" 11 B 8-8-30 WF
" 12 A 8-8-30 WF
" 13 D 9-8-30 WF
" 14 C 9-8-30 WF
" 16 A 9-8-30 INPUT
" 17 C 10-8-30 WF
" 18 B 10-8-30 WF
" 22 B 11-8-30 WF
" 25 H 11-8-30 WF
" 28 E 11-8-30 WF
" 30 G 10-8-30 WF
" 31 F 10-8-30 WF
" 32 E 10-8-30 INPUT
" 33 H 9-8-30 WF
" 35 F 9-8-30 WF
" 36 E 9-8-30 WF
" 37 M 8-8-30 WF
" 38 G 8-8-30 WF
" 39 J 8-8-30 WF
" 41 L 9-8-30 WF
" 42 K 9-8-30 WF
" 43 J 9-8-30 WF
" 44 I 10-8-30 SI
" 45 L 10-8-30 SI
" 49 L 11-8-30 WF
" 50 J 11-8-30 WF
" 52 M 12-8-30 SI
" 57 P 10-8-30 WF
" 60 M 10-8-30 WF
" 61 P 9-8-30 WF
" 62 O 9-8-30 WF
" 63 M 9-8-30 WF
" 64 C 17-8-30 WF
" 67 C 17-8-30 WF
" 68 B 17-8-30 WF
" 69 A 17-8-30 WF

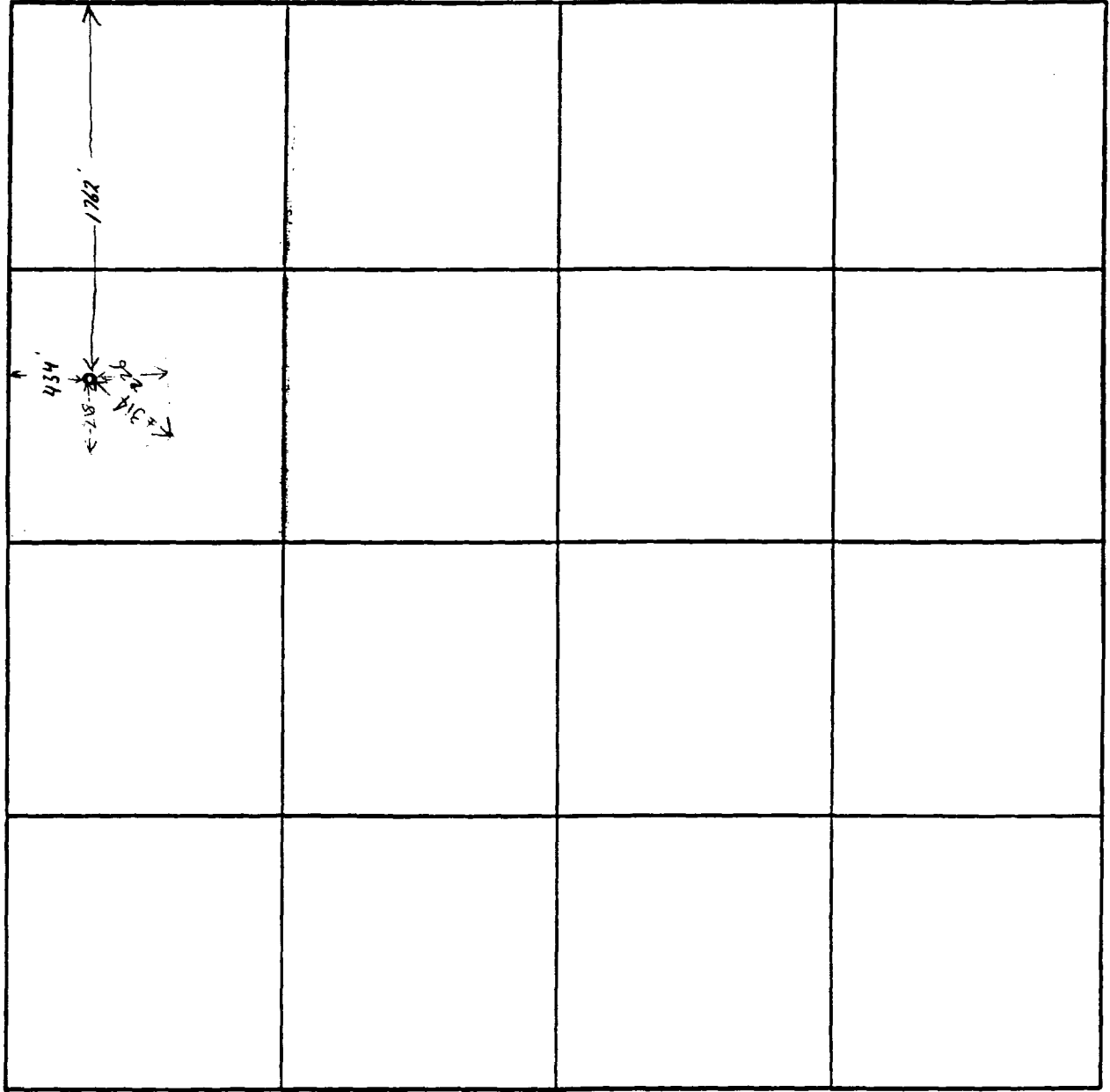

SECTION 35

TOWNSHIP 16 South

RANGE

37 East

Submit to Appropriate District Office
 State Lease - 6 copies
 Fee Lease - 5 copies

State of New Mexico
 Energy, Minerals and Natural Resources Department

Form C-101
 Revised 1-1-89

DISTRICT I
 P.O. Box 1980, Hobbs, NM 88240

DISTRICT II
 P.O. Drawer DD, Artesia, NM 88210

DISTRICT III
 1000 Rio Brazos Rd., Aztec, NM 87410

OIL CONSERVATION DIVISION
 P.O. Box 2088
 Santa Fe, New Mexico 87504-2088

API NO. (assigned by OCD on New Wells)
 5. Indicate Type of Lease
 STATE FEE
 6. State Oil & Gas Lease No.
 V-4119

APPLICATION FOR PERMIT TO DRILL, DEEPEN, OR PLUG BACK

1a. Type of Work:
 DRILL RE-ENTER DEEPEN PLUG BACK

b. Type of Well:
 OIL WELL GAS WELL OTHER
 SINGLE ZONE MULTIPLE ZONE

2. Name of Operator
 GECKO, Inc.

3. Address of Operator
 310 W. Wall, Ste. 702-LB106, Midland, Tx. 79701

4. Well Location
 Unit Letter B : 434 Feet From The North Line and 1762 Feet From The East Line
 Section 35 Township 16S Range 37 E NMPM LEA County

7. Lease Name or Unit Agreement Name
 GECKO State- 35 -

8. Well No.
 # 1

9. Pool name or Wildcat
 Casey (Strawn)

10. Proposed Depth
 12000'

11. Formation
 ATOKA

12. Rotary or C.T.
 ROTARY

13. Elevations (Show whether DF, RT, GR, etc.)
 3762' G.L.

14. Kind & Status Plug. Bond
 cash

15. Drilling Contractor
 TMBR/Sharp

16. Approx. Date Work will start
 11-08-93

17. **PROPOSED CASING AND CEMENT PROGRAM**

SIZE OF HOLE	SIZE OF CASING	WEIGHT PER FOOT	SETTING DEPTH	SACKS OF CEMENT	EST. TOP
17 1/2"	13 3/8"	48	400	440	SURFACE
11"	8 5/8"	32	4750	1300	400'
7 7/8"	5 1/2"	17	12000	1000	4750'

It is proposed to drill a 17 1/2" hole to 400'w/FW, set 13 3/8" csg and cement csg back to surface. An 11" intermediate hole will then be drilled to 4750' w/a cut brine mud system and a 8 5/8" csg string will be set and cemented back to the surface csg. A 3000# annular preventer will be used on the intermediate hole. A 7 7/8" hole will be drilled to TD of 12000' w/ FW mud. The 5 1/2" csg will be set @ TD and cemented back to the intermediate csg @ 4750'. A 3000# annular & a dual 5000# BOP pipe ram will be used. Mud-up will occur between 9000'-10000' and several DST's are planned.

Approval for drilling ONLY -- must have Non-Standard Location order before producing.

IN ABOVE SPACE DESCRIBE PROPOSED PROGRAM: IF PROPOSAL IS TO DEEPEN OR PLUG BACK, GIVE DATA ON PRESENT PRODUCTIVE ZONE AND PROPOSED NEW PRODUCTIVE ZONE. GIVE BLOWOUT PREVENTER PROGRAM, IF ANY.

I hereby certify that the information above is true and complete to the best of my knowledge and belief.

SIGNATURE Steve L. Thomson TITLE President DATE 11-2-93
 TYPE OR PRINT NAME STEVE L. THOMSON TELEPHONE NO. 915-686-0121

(This space for State Use)
 APPROVED BY [Signature] TITLE DISTRICT 1 SUPERVISOR DATE NOV-05 1993
 CONDITIONS OF APPROVAL, IF ANY:

OIL CONSERVATION DIVISION

P.O. Box 2088
Santa Fe, New Mexico 87504-2088

WELL LOCATION AND ACREAGE DEDICATION PLAT

All distances must be from the outer boundaries of the Section.

to Appropriate
Office
Lease-4 copies
Lease-3 copies

DISTRICT I
P.O. Box 1980, Hobbs, NM 88240

DISTRICT II
P.O. Drawer DD, Artesia, NM 88210

DISTRICT III
1000 Rio Brazos Rd., Aztec, NM 87410

Operator Geoscience Exploration CKO, Inc.		Lease GECKO State-35-		Well No. 1
Unit Letter B	Section 35	Township T16S	Range R37E	County NMPM
Actual Footage Location of Well: 434 feet from the North line and 1762 feet from the East line.				
Ground level Elev. 3762	Producing Formation Strawn	Pool Casey (Strawn)		Dedicated Acreage: 80 Acres

- Outline the acreage dedicated to the subject well by colored pencil or hachure marks on the plat below.
 - If more than one lease is dedicated to the well, outline each and identify the ownership thereof (both as to working interest and royalty).
 - If more than one lease of different ownership is dedicated to the well, have the interest of all owners been consolidated by communitization, unitization, force-pooling, etc.?
 - Yes No If answer is "yes", type of consolidation _____
 - If answer is "no", list the owners and tract descriptions which have actually been consolidated. (Use reverse side of this form if necessary.) _____
- No allowable will be assigned to the well until all interests have been consolidated (by communitization, unitization, forced-pooling, or otherwise) or until a non-standard unit, eliminating such interest, has been approved by the Division.

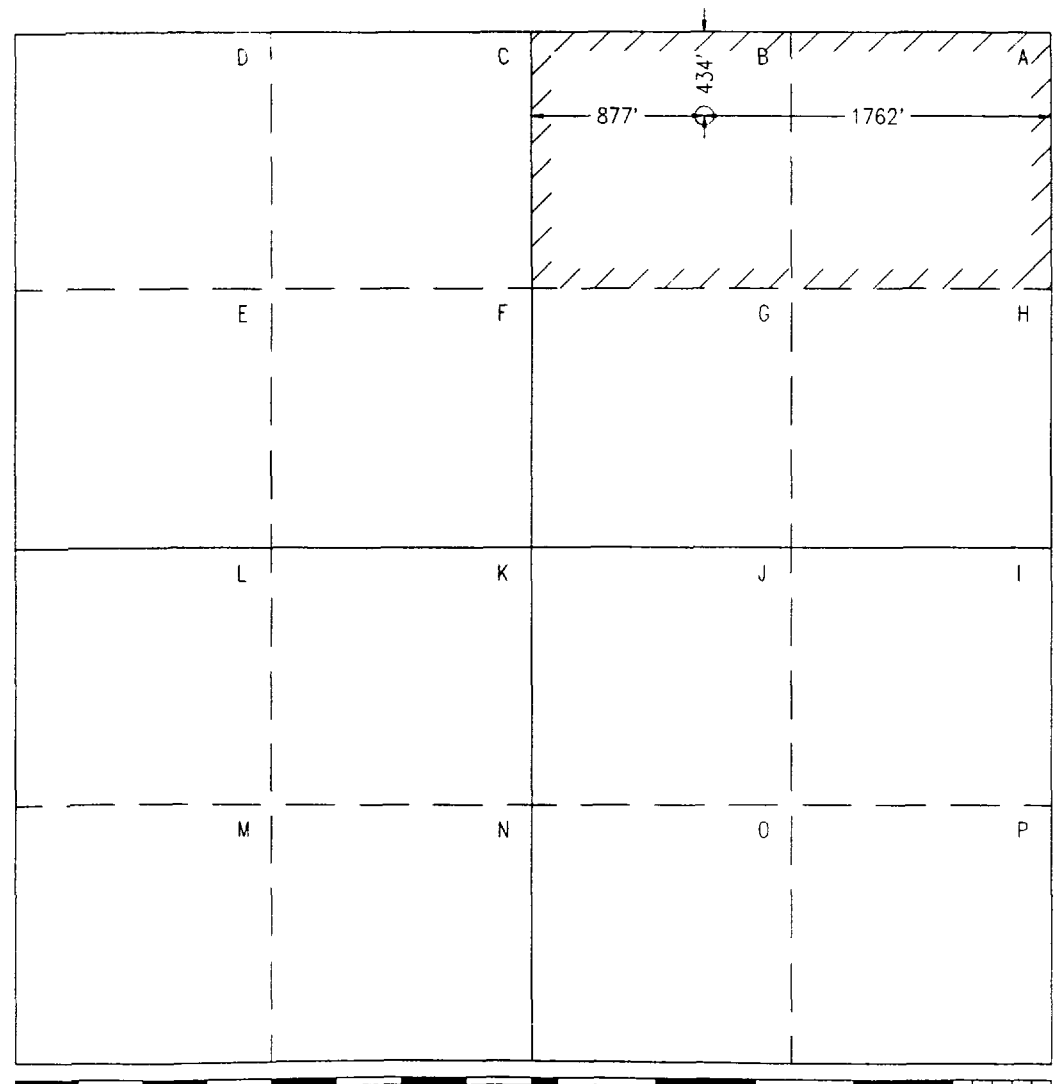

OPERATOR CERTIFICATION

I hereby certify that the information contained herein is true and complete to the best of my knowledge and belief.

Signature
Steve L. Thomson

Printed Name
Steve L. Thomson

Position
President

Company
GECKO, Inc.

Date
October 26, 1993

SURVEYOR CERTIFICATION

I hereby certify that the well location shown on this plat was plotted from field notes of actual surveys made by me or under my supervision, and that the same is true and correct to the best of my knowledge and belief.

Date Surveyed
10-20-93

Signature & Seal of Professional Surveyor
Michael L. Stanford

Certificate No. **10324**

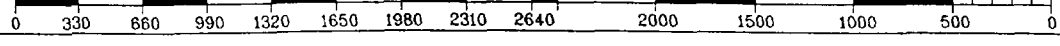

9 Miles SE of Lovington, New Mexico.

File No. A-0300

SECTION 35

TOWNSHIP 16 South

RANGE 37 East

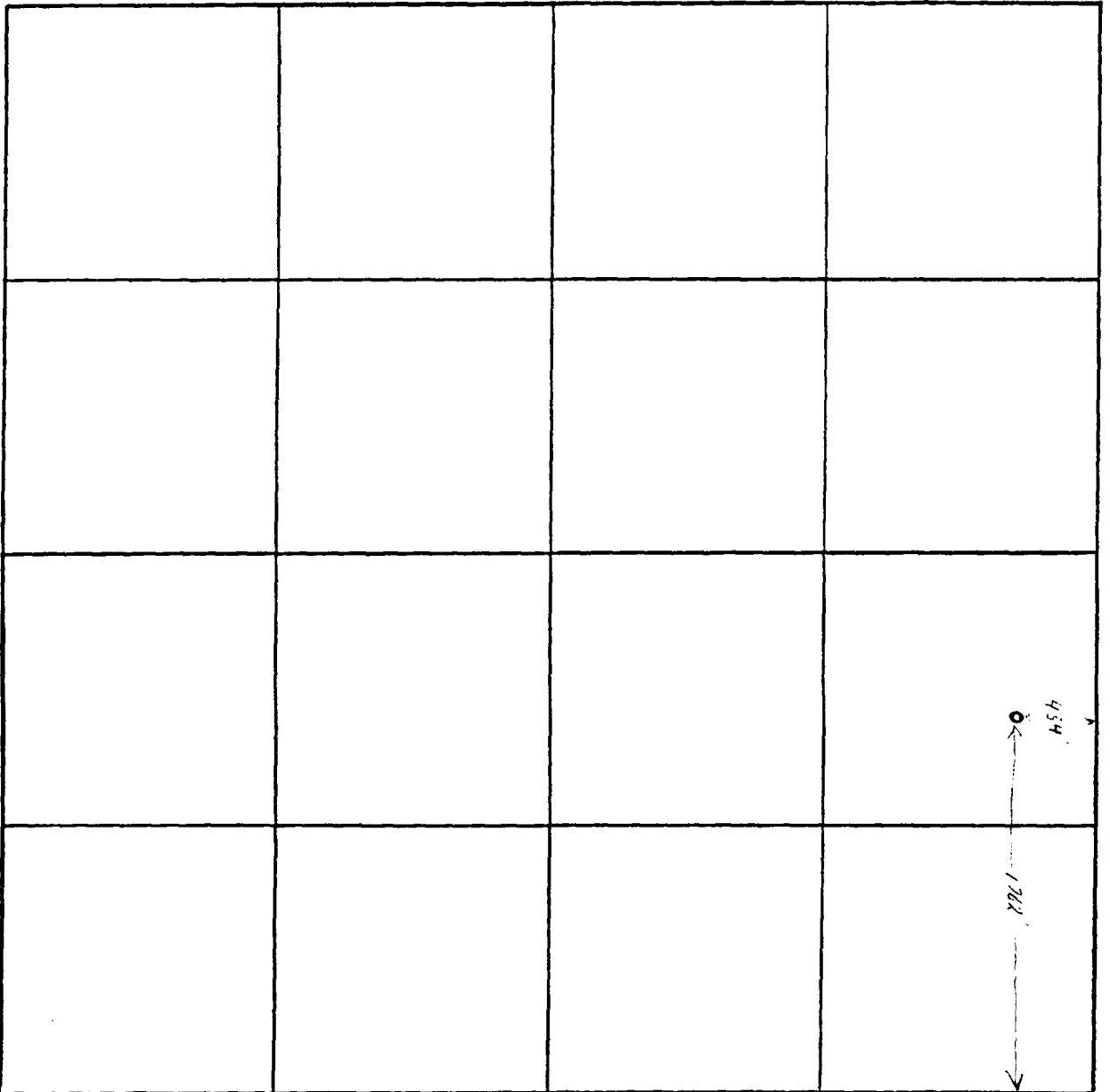

County Lea Pool Shipp-Strawn

TOWNSHIP 16 South Range 37 East NMPM

6	5	4	3	2	1	
7	8	9	10	11	12	
18	17	16	15	14	13	
*						
19	20	21	22	23	24	
30	29	28	27	26	25	
31	32	33	34	35	36	

Description: $\frac{SE}{4}$ and $\frac{E}{2}SW\frac{1}{4}$ Sec. 33, $\frac{S}{2}$ Sec. 34 (R-8062, 10-31-85)
Amend horizontal limits to include $\frac{N}{2}$ and $\frac{SE}{4}$ sec. 4 only, T12S,
R37E (R-8062-A, 1-21-86) EXT: $\frac{SE}{4}$ sec. 33 (R-8513, 9-18-87)
EXT: $\frac{SE}{4}$ SEC 32, $\frac{SW}{4}$ SEC 33 (R-8603, 2/19/88) EXT: $\frac{SE}{4}$ SEC 35 (R-8668, 6/10/88)
EXT: $\frac{SE}{4}$ SEC 36 (R-9741, 9-1-89) EXT: $\frac{SE}{4}$ SEC 34 (R-9120, 3-1-90)
EXT: $\frac{W}{2}$ SEC 36 (R-8772, 11-1-88)

3 miles north of Idumbie City NM

COUNTY Lea POOL Casey - Strawn

TOWNSHIP 16 South RANGE 37 East NMPM

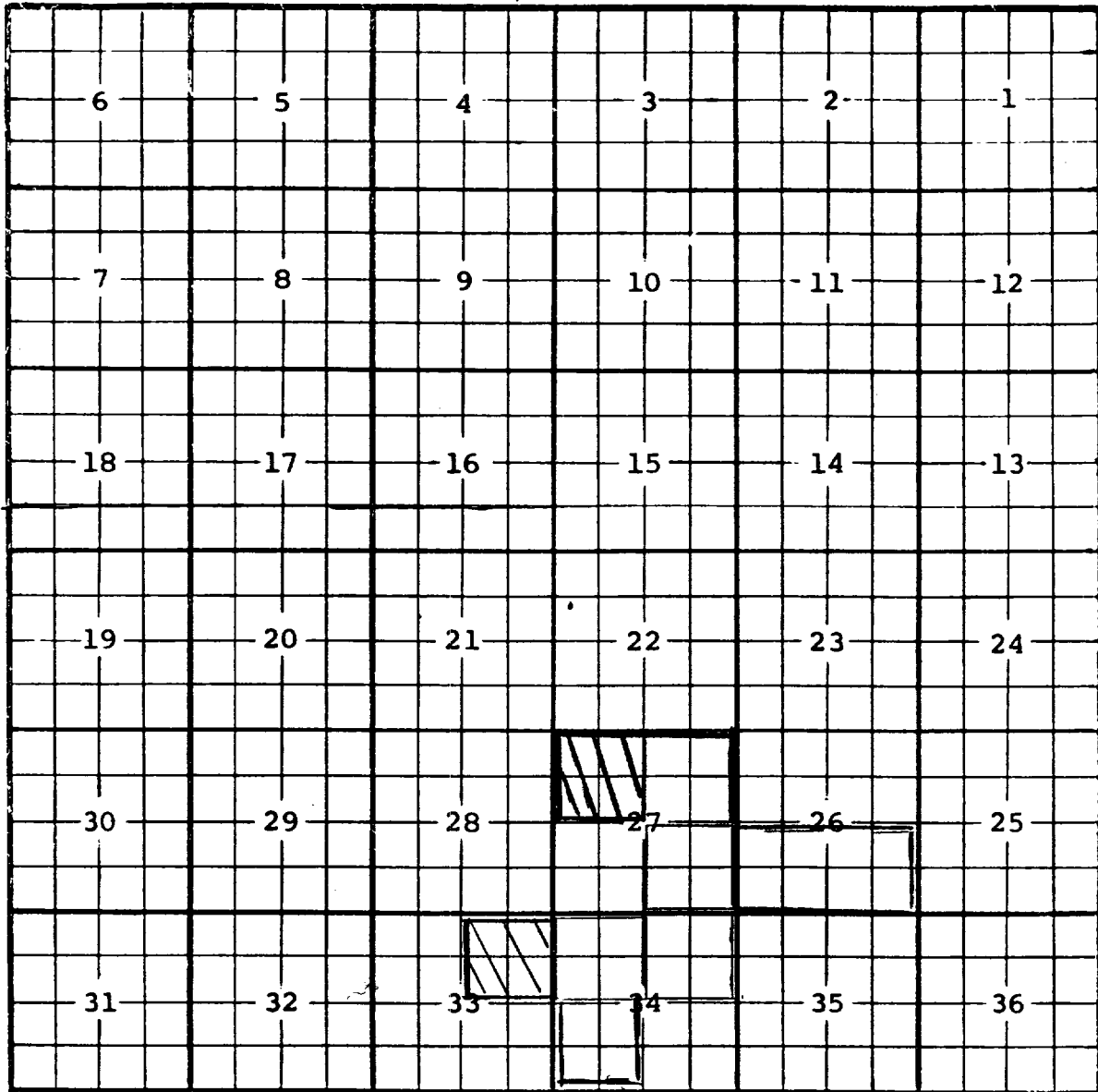

Description: $\frac{SE}{4}$ Sec 27 (R-4992, 4-1-75)

Ext: $\frac{NE}{4}$ Sec 34 (R-5081, 9-1-75) Ext: $\frac{NW}{4}$ Sec 34 (R-5124, 12-1-75)

Ext: $\frac{NE}{4}$ Sec. 33 (R-7279, 5-17-83) Ext: $\frac{N}{2}$ Sec. 27 (R-7667, 9-21-84)

Delete $\frac{NW}{4}$ sec. 27 (R-7996, 8-6-85)

Delete $\frac{NE}{4}$ Sec. 33 (R-8182, 3-11-86) Ext: $\frac{SW}{4}$ Sec. 34 (R-8451, 6-3-87)

EXT: $\frac{3}{2}$ SEC 26 (R-8603, 2/19/88)

1	2	3	4	5	6	7	8	9	10	11	12	13	14	15	16	17	18	19	20	21	22	23	24	25	26	27	28	29	30	31	32	33	34	35	36	37	38	39	40	41	42	43	44	45	46	47	48	49	50	51	52	53	54	55	56	57	58	59	60	61	62	63	64	65	66	67	68	69	70	71	72	73	74	75	76	77	78	79	80	81	82	83	84	85	86	87	88	89	90	91	92	93	94	95	96	97	98	99	100
---	---	---	---	---	---	---	---	---	----	----	----	----	----	----	----	----	----	----	----	----	----	----	----	----	----	----	----	----	----	----	----	----	----	----	----	----	----	----	----	----	----	----	----	----	----	----	----	----	----	----	----	----	----	----	----	----	----	----	----	----	----	----	----	----	----	----	----	----	----	----	----	----	----	----	----	----	----	----	----	----	----	----	----	----	----	----	----	----	----	----	----	----	----	----	----	----	----	----	-----

34

3PFAC109

13.43.11

11/03/80

CARD - END - MESSAGE

30071 11/03/80-W HIGH ORDER TERMINATION MIGHT OCCUR.

END OF COMPILATION

34 BPFACIOR 13.46.11 11/03/80

CARD ERROR MESSAGE

00371 11A50111-M HIGH ORDER TRUNCATION MIGHT OCCUR.

END OF COMPILATION

STATE OF NEW MEXICO

ENERGY, MINERALS AND NATURAL RESOURCES DEPARTMENT

OIL CONSERVATION DIVISION



BRUCE KING
GOVERNOR

ANITA LOCKWOOD
CABINET SECRETARY

POST OFFICE BOX 2088
STATE LAND OFFICE BUILDING
SANTA FE, NEW MEXICO 87504
(505) 827-5800

December 21, 1993

KELLAHIN AND KELLAHIN
Attorneys at Law
P. O. Drawer 2265
Santa Fe, New Mexico 87504

RE: CASE NO. 10884
ORDER NO. R-10040

Dear Sir:

Enclosed herewith are two copies of the above-referenced Division order recently entered in the subject case.

Sincerely,

Sally E. Martinez
Sally E. Martinez
Administrative Secretary

cc: BLM - Carlsbad