

BEFORE THE
OIL CONSERVATION DIVISION
Santa Fe, New Mexico

Case No. 10892 Exhibit No. 1
Submitted by: Collins & Ware, Inc.
Hearing Date: January 20, 1994

COLLINS & WARE, INC.
303 WEST WALL AVENUE, SUITE 2200
MIDLAND, TEXAS 79701
CREW CUT PROSPECT ENVY AA

*Exhibits 1 through 5
Complete Set*

Proposed Butch Fed #1
Collins & Ware Acreage
Scale 1:4000

C. Anderson

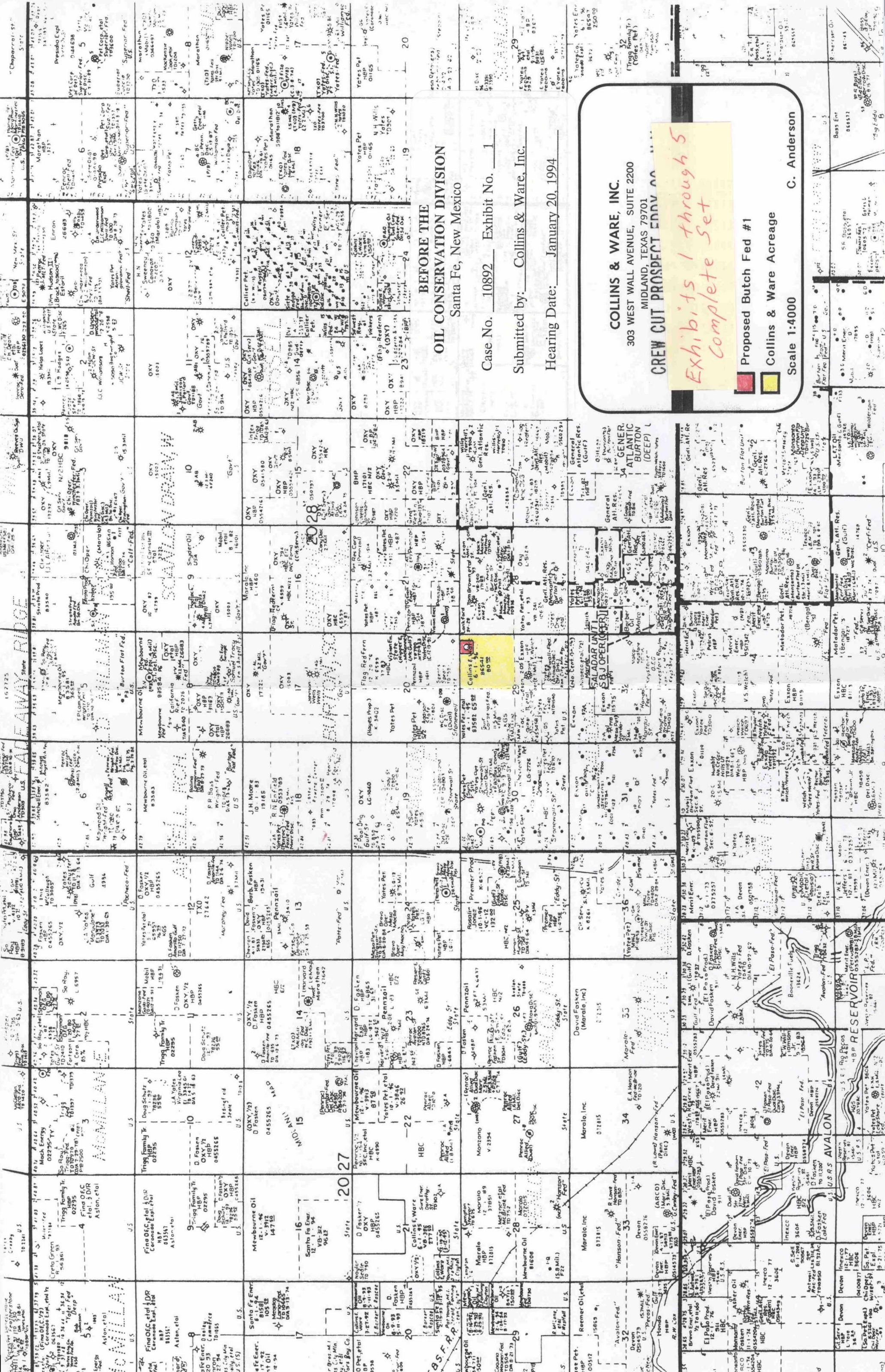

3288T

3219T

3225

3217T

28

BEFORE THE
OIL CONSERVATION DIVISION
Santa Fe, New Mexico

Case No. 10892 Exhibit No. 2

Submitted by: Collins & Ware, Inc.

Hearing Date: January 20, 1994

COLLINS & WARE, INC.
303 WEST WALL AVENUE, SUITE 2200
MIDLAND, TEXAS 79701

CREW CUT PROSPECT EDDY CO., N.M.

TOPOGRAPHIC MAP

Proposed Butch Fed #1

Collins & Ware Acreage

Scale 1:1000

C. Anderson

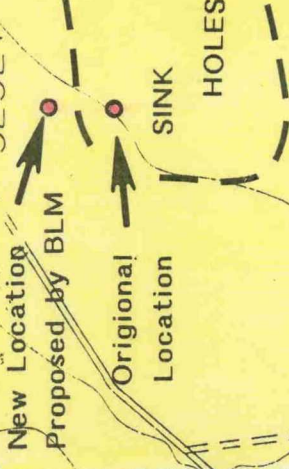
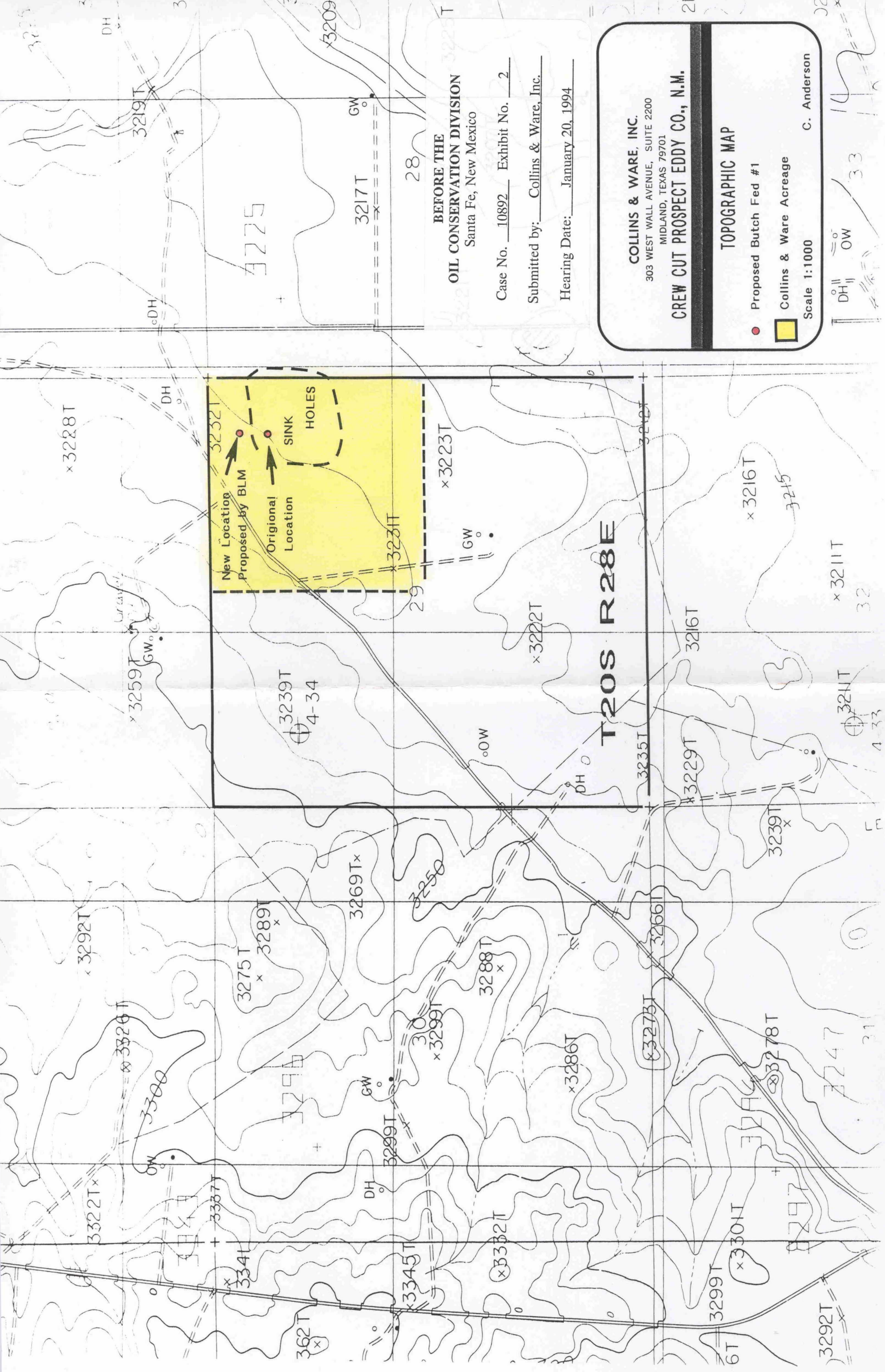

T20S R28E

32

32

31

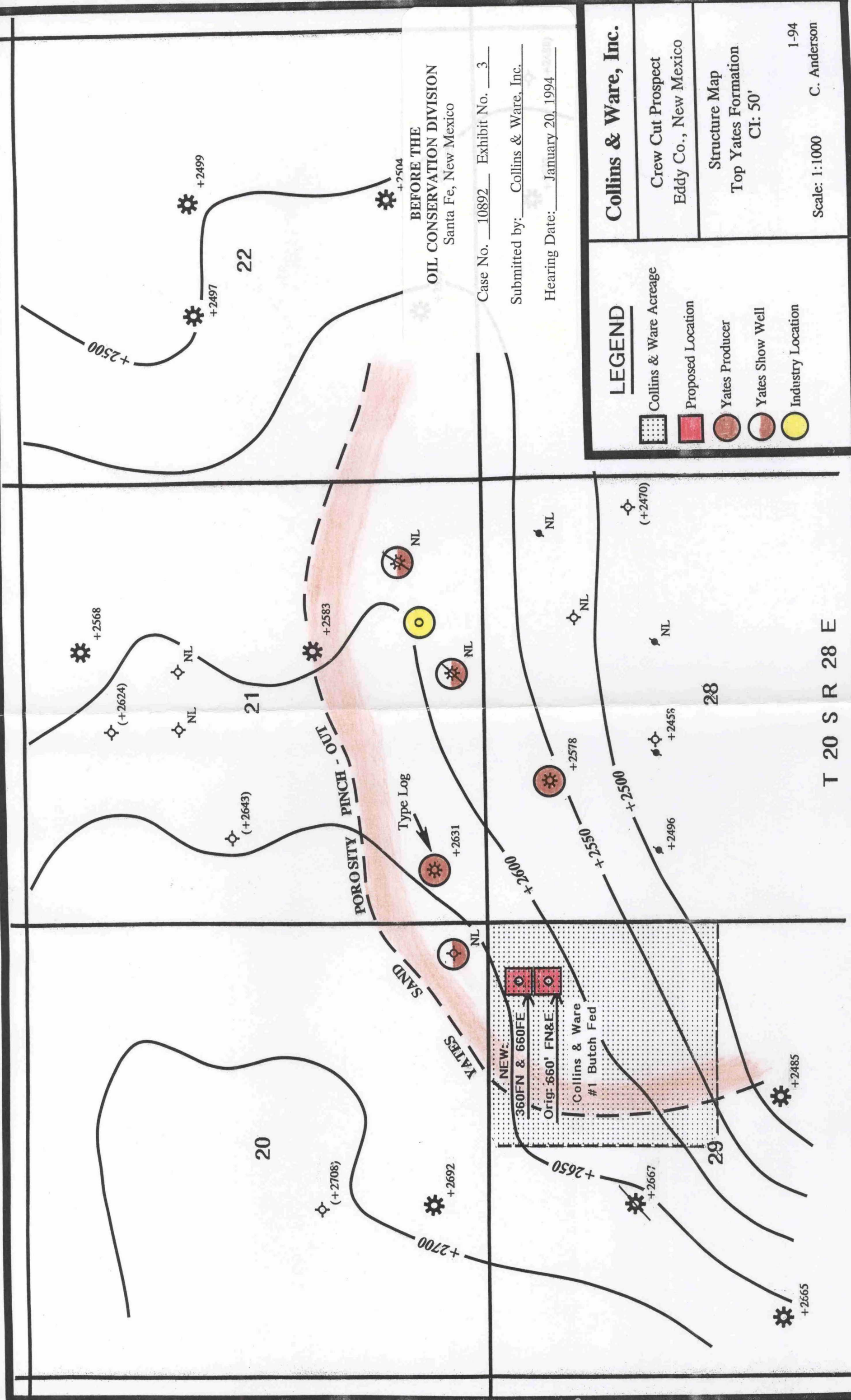

**BEFORE THE
OIL CONSERVATION DIVISION**
Santa Fe, New Mexico

Case No. 10892 Exhibit No. 3
Submitted by: Collins & Ware, Inc.
Hearing Date: January 20, 1994

LEGEND	Collins & Ware Acreage	Collins & Ware, Inc.
	Proposed Location	Crew Cut Prospect Eddy Co., New Mexico
Yates Producer	Yates Show Well	Structure Map Top Yates Formation CI: 50'
Industry Location		
Scale: 1:1000		1-94 C. Anderson

T 20 S R 28 E

TYPE LOG
 Collins & Ware, Inc.
 Crew Cut Prospect
 Gilliland & Lyon State #1
 21-20S-28E
 660' FSL, 660' FWL
 Eddy Co., New Mexico

Schlumberger Gamma Ray - Neutron Log

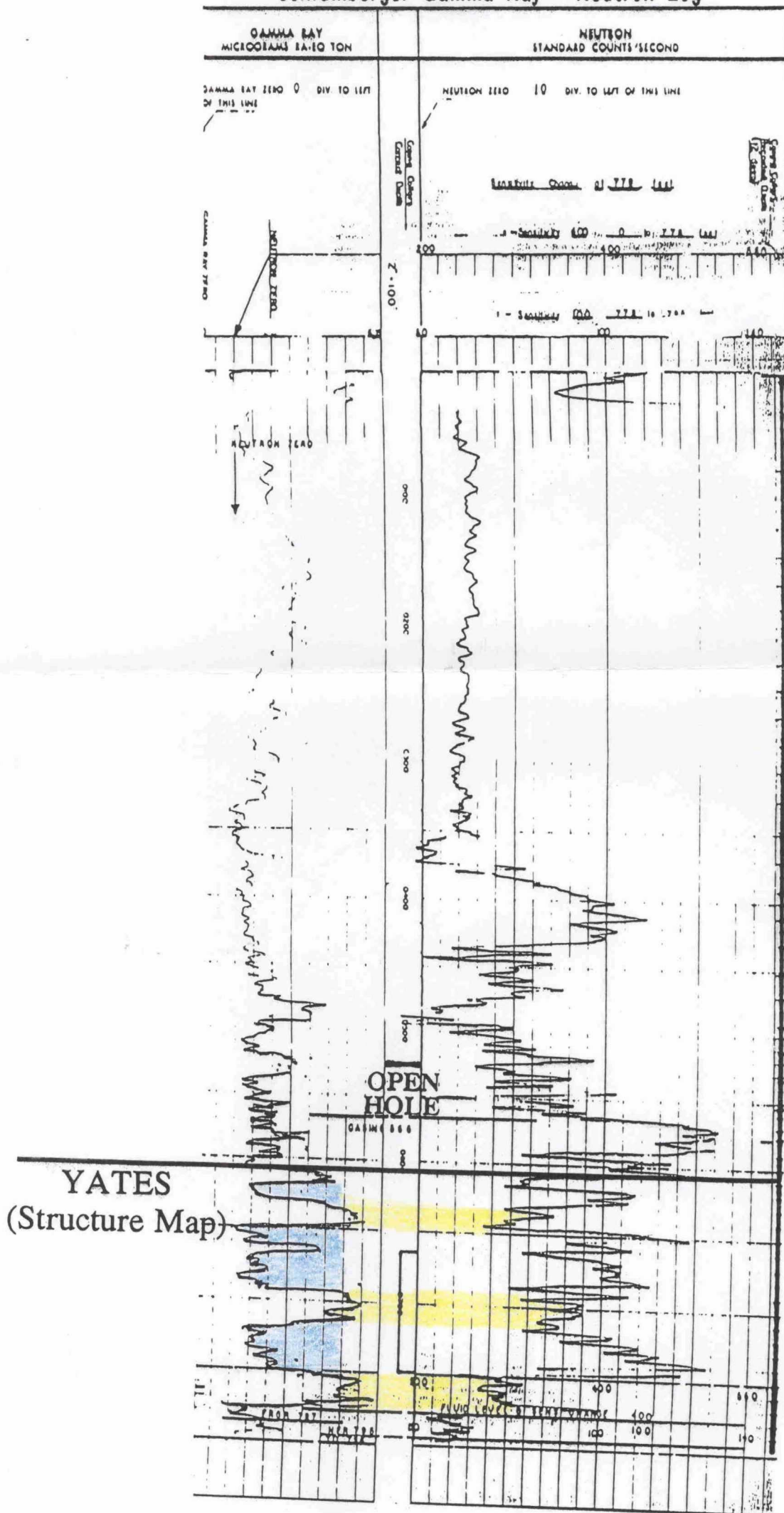

Orig. Comp: 4-6-45
 IPCAOF 3.06 MMPD
 522-906' open hole
 Plugged Producer 11-58
 Well never produced

OWWO: 12-91, Vision Energy
 IPF: 296 MCFD, 32/64" ck
 FTP 285.
 522-750' open hole
 Natural. Productive sand 670-750'

BEFORE THE
OIL CONSERVATION DIVISION
 Santa Fe, New Mexico

Case No. 10892 Exhibit No. 4

Submitted by: Collins & Ware, Inc.

Hearing Date: January 20, 1994

BEFORE THE

OIL CONSERVATION DIVISION

NEW MEXICO DEPARTMENT OF ENERGY, MINERALS AND NATURAL RESOURCES

IN THE MATTER OF THE APPLICATION
OF COLLINS & WARE, INC., FOR
AN UNORTHODOX GAS WELL LOCATION,
EDDY COUNTY, NEW MEXICO.

CASE NO. 10892

AFFIDAVIT

STATE OF NEW MEXICO)
) ss.
COUNTY OF SANTA FE)

William F. Carr, attorney in fact and authorized representative of Collins & Ware, Inc., the Applicant herein, being first duly sworn, upon oath, states that in accordance with the notice provisions of Rule 1207 of the New Mexico Oil Conservation Division the Applicant has attempted to find the correct addresses of all interested persons entitled to receive notice of this application and that notice has been given at the addresses shown on Exhibit "A" attached hereto as provided in Rule 1207.

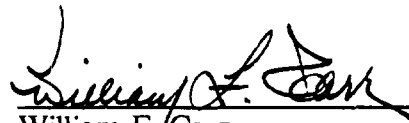

William F. Carr

SUBSCRIBED AND SWORN to before me this 19th day of January, 1994.

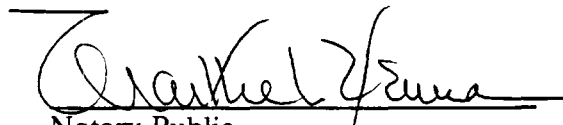

Notary Public

BEFORE THE
OIL CONSERVATION DIVISION
Santa Fe, New Mexico

My Commission Expires:
August 19, 1995

Case No. 10892 Exhibit No. 5

Submitted by: Collins & Ware, Inc.

Hearing Date: January 20, 1994

EXHIBIT A

Pennzoil Petroleum
Post Office Box 50090
4000 N. Big Spring, Suite 325
Midland, TX 79710-0090
Attn: Mike McCown

Vision Energy Inc.
Post Office Box 2459
Carlsbad, New Mexico 88220
Attn: Tommy Folsom

Exxon U.S.A.
Post Office Drawer 1600
Midland, TX 79702
Attn: Bill Duncan

Yates Petroleum Corporation
105 South Fourth Street
Artesia, New Mexico 88210

CAMPBELL, CARR, BERGE
& SHERIDAN, P.A.
LAWYERS

MICHAEL B. CAMPBELL
WILLIAM F. CARR
BRADFORD C. BERGE
MARK F. SHERIDAN
WILLIAM P. SLATTERY

PATRICIA A. MATTHEWS
MICHAEL H. FELDEWERT
DAVID B. LAWRENZ
TANYA M. TRUJILLO

JACK M. CAMPBELL
OF COUNSEL

JEFFERSON PLACE
SUITE 1 - 110 NORTH GUADALUPE
POST OFFICE BOX 2208
SANTA FE, NEW MEXICO 87504-2208
TELEPHONE: (505) 988-4421
TELECOPIER: (505) 983-6043

December 30, 1993

CERTIFIED MAIL
RETURN RECEIPT REQUESTED

Pennzoil Petroleum
Post Office Box 50090
4000 N. Big Spring, Suite 325
Midland, TX 79710-0090
Attn: Mike McCown

Re: Application of Collins & Ware, Inc. for an Unorthodox Well Location, Eddy
County, New Mexico

Dear Mr. McCown:

This letter is to advise you that Collins & Ware, Inc. has filed the enclosed application with the New Mexico Oil Conservation Division seeking approval to drill its Butch Federal No. 1 Well in the Wildcat Yates formation. This well will be drilled to the Yates formation at a location 360 feet from the North line and 660 feet from the East line of Section 29, Township 20 South, Range 28 East, N.M.P.M., Eddy County, New Mexico. The NE/4 of Section 29 will be dedicated to this well.

This application has been set for hearing before a Division Examiner on January 20, 1994. You are not required to attend this hearing, but as an owner of an interest that may be affected by the unorthodox well location, you may appear and present testimony. Failure to appear at that time and become a party of record will preclude you from challenging the matter at a later date.

Parties appearing in cases have been requested by the Division (Memorandum 2-90) to file a Prehearing Statement substantially in the form prescribed by the Division. Prehearing statements should be filed by 4:00 o'clock p.m. on the Friday before a scheduled hearing.

Very truly yours,

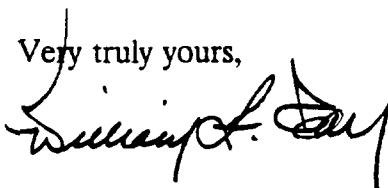

WILLIAM F. CARR
ATTORNEY FOR COLLINS & WARE, INC.
WFC:mlh
Enc.



Pennzoil Petroleum
 Post Office Box 50090
 4000 N. Big Spring, Suite 325
 Midland, TX 79710-0090
 Attn: Mike McCown

P 111 333 454

Receipt for Certified Mail

No Insurance Coverage Provided

Postage	\$
Certified Fee	
Special Delivery Fee	
Restricted Delivery Fee	
Return Receipt Showing to Whom & Date Delivered	
Return Receipt Showing to Whom, Date, and Addressee's Address	
TOTAL Postage & Fees	\$
Postmark or Date	December 30, 1993

PS Form 3800, June 1991

3 and 4. Put your address in the "RETURN TO" space on the reverse side. Failure to do this will prevent this card from being returned to you. The return receipt fee will provide you the name of the person delivered to and the date of delivery. For additional fees the following services are available. Consult postmaster for fees and check (boxed) for additional services requested.

Show to whom delivered, date, and addressee's address. **2. Restricted Delivery (zones charged)**

Article Addressed to:
 Pennzoil Petroleum
 Post Office Box 50090
 4000 N. Big Spring, Suite 325
 Midland, TX 79710-0090
 Attn: Mike McCown

Article Number: P 111 333 454

Type of Service:
 Registered
 Certified
 Express Mail
 Insured
 COD
 Return Receipt for Merchandise

Always obtain signature of addressee or agent and DATE DELIVERED.

Addresser's Address (ONLY requested and fee paid)

Signature - Agent: *[Signature]*

Postmark: *[Postmark]*

PS Form 3811, Mar. 1988 U.S.D.P.S. 1988-212-888 DOMESTIC RETURN RECEIPT

CAMPBELL, CARR, BERGE

& SHERIDAN, P.A.

LAWYERS

MICHAEL B. CAMPBELL
WILLIAM F. CARR
BRADFORD C. BERGE
MARK F. SHERIDAN
WILLIAM P. SLATTERY

PATRICIA A. MATTHEWS
MICHAEL H. FELDEWERT
DAVID B. LAWRENZ
TANYA M. TRUJILLO

JACK M. CAMPBELL
OF COUNSEL

JEFFERSON PLACE
SUITE 1 - 110 NORTH GUADALUPE
POST OFFICE BOX 2208
SANTA FE, NEW MEXICO 87504-2208
TELEPHONE: (505) 988-4421
TELECOPIER: (505) 983-6043

December 30, 1993

CERTIFIED MAIL
RETURN RECEIPT REQUESTED

Vision Energy Inc.
Post Office Box 2459
Carlsbad, New Mexico 88220
Attn: Tommy Folsom

Re: Application of Collins & Ware, Inc. for an Unorthodox Well Location, Eddy
County, New Mexico

Dear Mr. Folsom:

This letter is to advise you that Collins & Ware, Inc. has filed the enclosed application with the New Mexico Oil Conservation Division seeking approval to drill its Butch Federal No. 1 Well in the Wildcat Yates formation. This well will be drilled to the Yates formation at a location 360 feet from the North line and 660 feet from the East line of Section 29, Township 20 South, Range 28 East, N.M.P.M., Eddy County, New Mexico. The NE/4 of Section 29 will be dedicated to this well.

This application has been set for hearing before a Division Examiner on January 20, 1994. You are not required to attend this hearing, but as an owner of an interest that may be affected by the unorthodox well location, you may appear and present testimony. Failure to appear at that time and become a party of record will preclude you from challenging the matter at a later date.

Parties appearing in cases have been requested by the Division (Memorandum 2-90) to file a Prehearing Statement substantially in the form prescribed by the Division. Prehearing statements should be filed by 4:00 o'clock p.m. on the Friday before a scheduled hearing.

Very truly yours,

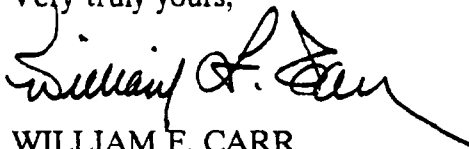

WILLIAM F. CARR
ATTORNEY FOR COLLINS & WARE, INC.

WFC:mlh

Enc.

P 111 333 455



Receipt for Certified Mail

No Insurance Coverage Provided

Vision Energy Inc.
Post Office Box 2459
Carlsbad, New Mexico 88220
Attn: Tommy Folsom

Postage	\$
Certified Fee	
Special Delivery Fee	
Restricted Delivery Fee	
Return Receipt Showing to Whom & Date Delivered	
Return Receipt Showing to Whom, Date, and Addressee's Address	
TOTAL Postage & Fees	\$
Postmark or Date	December 30, 1993

PS Form 3800, June 1991

PS Form 3811, Mar. 1988 U.S.G.P.O. 1988-212-865 DOMESTIC RETURN RECEIPT

3. Article Addressed to:
Vision Energy Inc.
Post Office Box 2459
Carlsbad, New Mexico 88220
Attn: Tommy Folsom

4. Article Number: P 111 333 455

Type of Service:
 Registered
 Certified
 Express Mail
 Insured
 COD
 Return Receipt for Merchandise

5. Signature - Addressee: *[Signature]*
 6. Signature - Agent: *[Signature]*
 7. Date of Delivery: *[Blank]*

Always obtain signature of addressee or agent and DATE DELIVERED.
 Addressee's Address (ONLY if requested and fee paid)

Carlsbad, N.M. 88220
 CANE D. W. 100
 100
 100

5. Sender: Complete item 1 and 2 when additional services are desired, and complete item 3 and 4 when "RETURN TO" Space on the reverse side. Failure to do this will prevent the card from being returned to you. The return receipt fee will provide you the name of the person delivered to and the date of delivery. For additional fees the following services are available. Consult postmaster for fees and check boxes for additional service(s) requested.
 1. Show to whom delivered, date, and addressee's address. 2. Restricted Delivery (Extra charge)

CAMPBELL, CARR, BERGE
& SHERIDAN, P.A.
LAWYERS

MICHAEL B. CAMPBELL
WILLIAM F. CARR
BRADFORD C. BERGE
MARK F. SHERIDAN
WILLIAM P. SLATTERY

PATRICIA A. MATTHEWS
MICHAEL H. FELDEWERT
DAVID B. LAWRENZ
TANYA M. TRUJILLO

JACK M. CAMPBELL
OF COUNSEL

JEFFERSON PLACE
SUITE 1 - 110 NORTH GUADALUPE
POST OFFICE BOX 2208
SANTA FE, NEW MEXICO 87504-2208
TELEPHONE: (505) 988-4421
TELECOPIER: (505) 983-6043

December 30, 1993

CERTIFIED MAIL
RETURN RECEIPT REQUESTED

Exxon U.S.A.
Post Office Drawer 1600
Midland, TX 79702
Attn: Bill Duncan

Re: Application of Collins & Ware, Inc. for an Unorthodox Well Location, Eddy
County, New Mexico

Dear Mr. Duncan:

This letter is to advise you that Collins & Ware, Inc. has filed the enclosed application with the New Mexico Oil Conservation Division seeking approval to drill its Butch Federal No. 1 Well in the Wildcat Yates formation. This well will be drilled to the Yates formation at a location 360 feet from the North line and 660 feet from the East line of Section 29, Township 20 South, Range 28 East, N.M.P.M., Eddy County, New Mexico. The NE/4 of Section 29 will be dedicated to this well.

This application has been set for hearing before a Division Examiner on January 20, 1994. You are not required to attend this hearing, but as an owner of an interest that may be affected by the unorthodox well location, you may appear and present testimony. Failure to appear at that time and become a party of record will preclude you from challenging the matter at a later date.

Parties appearing in cases have been requested by the Division (Memorandum 2-90) to file a Prehearing Statement substantially in the form prescribed by the Division. Prehearing statements should be filed by 4:00 o'clock p.m. on the Friday before a scheduled hearing.

Very truly yours,

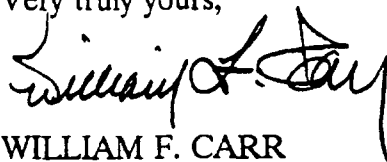

WILLIAM F. CARR
ATTORNEY FOR COLLINS & WARE, INC.

WFC:mlh

Enc.



Exxon U.S.A.
 Post Office Drawer 1600
 Midland, TX 79702
 Attn: Bill Duncan

Postage	\$
Certified Fee	
Special Delivery Fee	
Restricted Delivery Fee	
Return Receipt Showing to Whom & Date Delivered	
Return Receipt Showing to Whom, Date, and Addressee's Address	
TOTAL Postage & Fees	\$
Postmark or Date	December 30, 1993

PS Form 3800, June 1991

PS Form 3811, Mar. 1988 U.S.D.P.O. 1988-212-865 DOMESTIC RETURN RECEIPT

SENDER: COMPLETE HERE **ADDRESSEE: SERVICES ARE ASSURED, AND COMPLETE HERE**

Put your address in the "RETURN TO" space on the reverse side. Failure to do this will prevent this card from being returned to you. The return receipt fee will provide you the name of the person delivered to and the date of delivery. For additional fees the following services are available. Consult postmaster for fees and check boxes for additional services requested.

1. Show to whom delivered, date, and addressee's address. **Restricted Delivery** (Extra charge)

2. **Restricted Delivery** (Extra charge)

3. Article Addressed to:
 Exxon U.S.A.
 Post Office Drawer 1600
 Midland, TX 79702
 Attn: Bill Duncan

4. Article Number: **P 111 333 456**

Type of Service:
 Registered Mail Insured
 Certified Mail COD
 Express Mail Return Receipt for Merchandise

Always obtain signature of addressee or agent and DATE DELIVERED.

5. Addressee's Address (ONLY if requested and fee paid)

6. Signature - Agent Signature - Addressee

7. Date of Delivery: **1-4-94**

CAMPBELL, CARR, BERGE

& SHERIDAN, P.A.

LAWYERS

MICHAEL B. CAMPBELL
WILLIAM F. CARR
BRADFORD C. BERGE
MARK F. SHERIDAN
WILLIAM P. SLATTERY

PATRICIA A. MATTHEWS
MICHAEL H. FELDEWERT
DAVID B. LAWRENZ
TANYA M. TRUJILLO

JACK M. CAMPBELL
OF COUNSEL

JEFFERSON PLACE
SUITE 1 - 110 NORTH GUADALUPE
POST OFFICE BOX 2208
SANTA FE, NEW MEXICO 87504-2208
TELEPHONE: (505) 988-4421
TELECOPIER: (505) 983-6043

December 30, 1993

CERTIFIED MAIL
RETURN RECEIPT REQUESTED

Yates Petroleum Corporation
105 South Fourth Street
Artesia, New Mexico 88210

Re: Application of Collins & Ware, Inc. for an Unorthodox Well Location, Eddy County, New Mexico

Gentlemen:

This letter is to advise you that Collins & Ware, Inc. has filed the enclosed application with the New Mexico Oil Conservation Division seeking approval to drill its Butch Federal No. 1 Well in the Wildcat Yates formation. This well will be drilled to the Yates formation at a location 360 feet from the North line and 660 feet from the East line of Section 29, Township 20 South, Range 28 East, N.M.P.M., Eddy County, New Mexico. The NE/4 of Section 29 will be dedicated to this well.

This application has been set for hearing before a Division Examiner on January 20, 1994. You are not required to attend this hearing, but as an owner of an interest that may be affected by the unorthodox well location, you may appear and present testimony. Failure to appear at that time and become a party of record will preclude you from challenging the matter at a later date.

Parties appearing in cases have been requested by the Division (Memorandum 2-90) to file a Prehearing Statement substantially in the form prescribed by the Division. Prehearing statements should be filed by 4:00 o'clock p.m. on the Friday before a scheduled hearing.

Very truly yours,

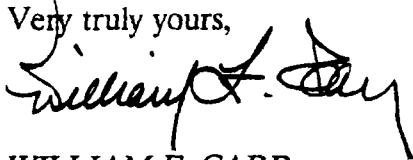

WILLIAM F. CARR
ATTORNEY FOR COLLINS & WARE, INC.

WFC:mlh

Enc.



Yates Petroleum Corporation
105 South Fourth Street
Artesia, NM 88210

Postage	\$
Certified Fee	
Special Delivery Fee	
Restricted Delivery Fee	
Return Receipt Showing to Whom & Date Delivered	
Return Receipt Showing to Whom, Date, and Addressee's Address	
TOTAL Postage & Fees	\$
Postmark or Date	December 30, 1993

PS Form 3800, June 1991

Put your address in the "RETURN TO" space on the reverse side. Failure to do this will prevent this card from being returned to you. The return receipt fee will provide you the name of the person delivered to and the date of delivery. For additional fees the following services are available. Consult postmaster for rates and special boxes for additional services requested.

1. Show to whom delivered, date, and addressee's address. (Extra charge)
2. Restricted Delivery (Extra charge)

3. Article Addressed to:
Yates Petroleum Corporation
105 South Fourth Street
Artesia, NM 88210

4. Article Number
P111333457

5. Signature - Address
[Signature]

6. Signature - Addressee
[Signature]

7. Date of Delivery
JAN 3 1994

8. Addressee's Address (ONLY if requested and fee paid)
Always obtain signature of addressee or agent and DATE DELIVERED.

Type of Service:
 Registered
 Certified
 Express Mail
 Insured
 COD
 Return Receipt for Merchandise

PS Form 3811, Mar. 1988 U.S.A.P.C. 1988-212-865 DOMESTIC RETURN RECEIPT

County, _____

Township _____ Range _____

Township _____ Range _____

Township _____ Range _____

Township _____ Range _____

Form 104—(Four on Township)

JE

6	5	4	3	2	1	6	5	4	3	2	1
7	8	9	10	11	12	7	8	9	10	11	12
18	17	16	15	14	13	18	17	16	15	14	13
19	20	21	22	23	24	19	20	21	22	23	24
30	29	28	27	26	25	30	29	28	27	26	25
31	32	33	34	35	36	31	32	33	34	35	36
6	5	4	3	2	1	6	5	4	3	2	1
7	8	9	10	11	12	7	8	9	10	11	12
18	17	16	15	14	13	18	17	16	15	14	13
19	20	21	22	23	24	19	20	21	22	23	24
30	29	28	27	26	25	30	29	28	27	26	25
31	32	33	34	35	36	31	32	33	34	35	36

Saladar-Yates

12-9703

12-10042

South Butler Yates Gas Prod