

R 19 E

R 20 E

R 21 E

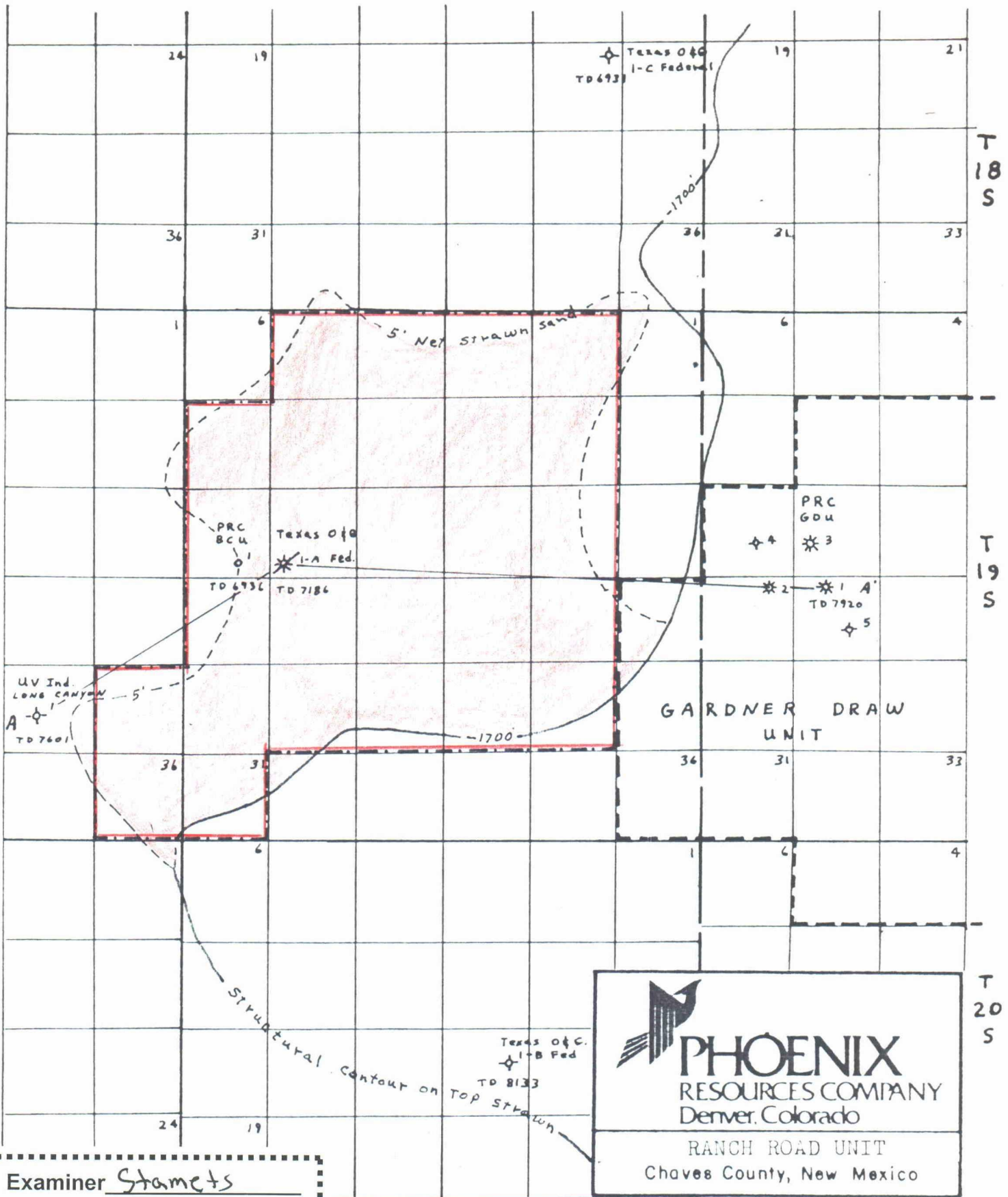

Examiner Stamets
 Case No. 6504
 EXHIBIT NO. 11

 **PHOENIX**
 RESOURCES COMPANY
 Denver, Colorado

RANCH ROAD UNIT
 Chaves County, New Mexico

STRAWN PROSPECT
 AND
 PROPOSED RANCH ROAD UNIT BOUNDARY

Scale: 1" = ~3000'

G. R. Reddy

EXHIBIT IV

March 24, 1979

BEFORE EXAMINER STATEMENTS
OIL CONSERVATION DIVISION
Phaup EXHIBIT NO. 11
CASE NO. 6504
Submitted by _____
Hearing Date _____