

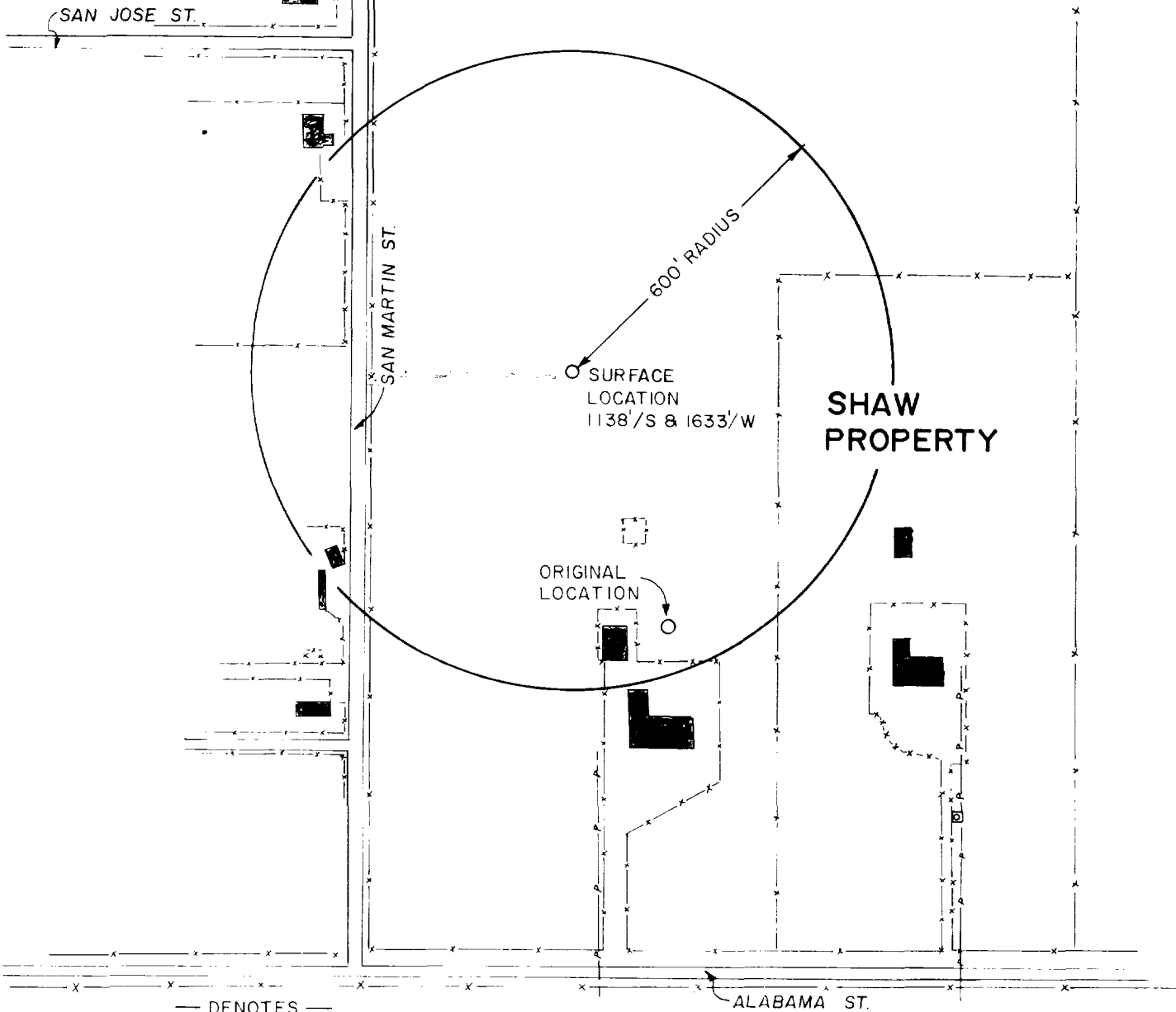

BEFORE EXAMINER STOGNER  
OIL CONSERVATION DIVISION  
BP EXHIBIT NO. 8  
CASE NO. 9645

DEES PROPERTY



- DENOTES —  
■ — BUILDING  
□ — WATER WELL  
—X—X— — FENCE  
—P—P— — POWER LN.

I HEREBY CERTIFY THAT THIS MAP WAS MADE FROM NOTES TAKEN IN THE FIELD IN A BONA FIDE SURVEY MADE UNDER MY SUPERVISION, AND THAT THE SAME IS TRUE AND CORRECT TO THE BEST OF MY KNOWLEDGE AND BELIEF

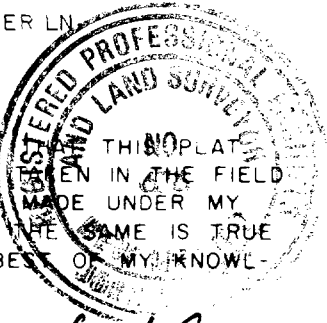

JOHN W. WEST, N.M. P.E. & L.S. No. 676  
TEXAS R.P.S. No. 1138  
RONALD J. EIDSON, N.M. L.S. No. 3239  
TEXAS R.P.S. No. 1883

BP EXPLORATION		
Section 30, Township 18 South, Range 38 East, N.M.P.M., Lea County, New Mexico.		
JOHN W. WEST ENGINEERING COMPANY CONSULTING ENGINEERS HOBBS, NEW MEXICO		
Scale: 1" = 300'	Drawn By: J Holmes	
Date: 5-5-89	Ck. gj	Sheet 1 of 1 Sheets



**BP EXPLORATION**

BP Exploration Inc.  
5151 San Felipe  
P. O. Box 4587  
Houston, Texas 77210  
(713) 552-8500

0679m

**DIRECTIONAL DRILLING PROCEDURE**

**Howling Coyote #30-1**  
Sec. 30-T17S-R38E  
Lea County, New Mexico

1. Move in and rig up rotary rig.
2. Drill to intermediate casing point and run 8-5/8" casing. Set 24#, K-55, STC at approximately 4,500 ft.
3. While W.O.C. run a gyroscopic survey to establish bottom hole location at the casing shoe depth.
4. Nipple up. Pick up a 7-7/8" bit, 6-1/2" non mag drill collar, 6-1/2" drill collar, 7-7/8" string IBS, drill collar, 7-7/8" string IBS and the rest of the drill collars and drill pipe to drill out the float collar and shoe.
5. Drill with this BHA and take intermittent single shot surveys at approximate 250' intervals to determine the trajectory of the wellbore.
6. At 9,000' +/-, drop a multishot survey and trip out of the hole surveying on 93' intervals to the bottom of the 8-5/8" casing to determine bottom hole location for the kick off.
7. Pick up a 7-7/8" bit, 5-1/2" slow speed mud motor, 1.25° or 1.5° bent sub, 6-1/4" x 30' non mag drill collar and the rest of the rig collars and drill pipe and trip in the hole.
8. Orient the deflecting assembly with a steering tool to the desired direction and drill until the desired direction is obtained and approximately 4° to 4.5° of angle is achieved.
9. Trip out and pick up a 7-7/8" bit, 7-7/8" IBS, 6-1/4" x 30' non mag drill collar, 6-1/4" drill collar, 7-7/8" string IBS, drill collar, 7-7/8" string IBS and the rest of the rig collars and drill pipe. Drilling jars may be picked up on this assembly if required.
10. Drill with this bottom hole assembly until desired angle is obtained. Estimate at 16.0° at 10,000' MD +/-.

RECEIVED BY STONER	
OIL COMPANY DIVISION	
BP	EXHIBIT NO. 9
CASE NO.	9645

11. Trip out and pick up a full packed hole assembly consisting of: 7-7/8" bit, 7-7/8" IBS, short steel collar, 7-7/8" reamer, 6-1/2" non mag drill collar, 7-7/8" string IBS, drill collar, 7-7/8" string IBS, rig collars, jars, 3 rig collars and drill with this assembly to T.D. or until a corrective run is required.
12. At T.D. drop a multishot survey and survey back to the tie in at the KOP to meet commission requirements.

BWS/dm