

NEW MEXICO OIL CONSERVATION COMMISSION

CASE NO. 9658

APPLICATION FOR SALT WATER DISPOSAL

DELAWARE FORMATION (CHERRY CANYON)

PARDUE FARMS "27" #8D

UNIT H, SEC. 27, T23-R28, 2069 FNL & 632 FEL

EDDY COUNTY, NEW MEXICO

PRESENTED BY: PARKER & PARSLEY PETROLEUM COMPANY

P. O. BOX 3178

MIDLAND, TEXAS 79701

David

APPLICATION FOR AUTHORIZATION TO INJECT

- I. Purpose: Secondary Recovery Pressure Maintenance Disposal Storage
Application qualifies for administrative approval? yes no
- II. Operator: Parker & Parslev Petroleum Co.
Address: P. O. Box 3178, Midland, Texas 79702
Contact party: Randy R. Johnson Phone: 915/683-4768
- III. Well data: Complete the data required on the reverse side of this form for each well proposed for injection. Additional sheets may be attached if necessary.
- IV. Is this an expansion of an existing project? yes no
If yes, give the Division order number authorizing the project _____.
- V. Attach a map that identifies all wells and leases within two miles of any proposed injection well with a one-half mile radius circle drawn around each proposed injection well. This circle identifies the well's area of review.
- * VI. Attach a tabulation of data on all wells of public record within the area of review which penetrate the proposed injection zone. Such data shall include a description of each well's type, construction, date drilled, location, depth, record of completion, and a schematic of any plugged well illustrating all plugging detail.
- VII. Attach data on the proposed operation, including:
1. Proposed average and maximum daily rate and volume of fluids to be injected;
 2. Whether the system is open or closed;
 3. Proposed average and maximum injection pressure;
 4. Sources and an appropriate analysis of injection fluid and compatibility with the receiving formation if other than reinjected produced water; and
 5. If injection is for disposal purposes into a zone not productive of oil or gas at or within one mile of the proposed well, attach a chemical analysis of the disposal zone formation water (may be measured or inferred from existing literature, studies, nearby wells, etc.).
- *VIII. Attach appropriate geological data on the injection zone including appropriate lithologic detail, geological name, thickness, and depth. Give the geologic name, and depth to bottom of all underground sources of drinking water (aquifers containing waters with total dissolved solids concentrations of 10,000 mg/l or less) overlying the proposed injection zone as well as any such source known to be immediately underlying the injection interval.
- IX. Describe the proposed stimulation program, if any.
- * X. Attach appropriate logging and test data on the well. (If well logs have been filed with the Division they need not be resubmitted.)
- * XI. Attach a chemical analysis of fresh water from two or more fresh water wells (if available and producing) within one mile of any injection or disposal well showing location of wells and dates samples were taken.
- XII. Applicants for disposal wells must make an affirmative statement that they have examined available geologic and engineering data and find no evidence of open faults or any other hydrologic connection between the disposal zone and any underground source of drinking water.
- XIII. Applicants must complete the "Proof of Notice" section on the reverse side of this form.
- XIV. Certification
- I hereby certify that the information submitted with this application is true and correct to the best of my knowledge and belief.
- Name: Randy R. Johnson Title Operations Engineer
Signature: Randy R. Johnson Date: 3-30-89
- * If the information required under Sections VI, VIII, X, and XI above has been previously submitted, it need not be duplicated and resubmitted. Please show the date and circumstance of the earlier submittal.

STATE OF CALIFORNIA
COUNTY OF SAN DIEGO
SUPERIOR COURT
IN AND FOR THE COUNTY OF SAN DIEGO

Parker EXHIBIT NO. 3

CASE NO. 9658

III. WELL DATA

A. The following well data must be submitted for each injection well covered by this application. The data must be both in tabular and schematic form and shall include:

- (1) Lease name; Well No.; location by Section, Township, and Range; and footage location within the section.
- (2) Each casing string used with its size, setting depth, sacks of cement used, hole size, top of cement, and how such top was determined.
- (3) A description of the tubing to be used including its size, lining material, and setting depth.
- (4) The name, model, and setting depth of the packer used or a description of any other seal system or assembly used.

Division District offices have supplies of Well Data Sheets which may be used or which may be used as models for this purpose. Applicants for several identical wells may submit a "typical data sheet" rather than submitting the data for each well.

B. The following must be submitted for each injection well covered by this application. All items must be addressed for the initial well. Responses for additional wells need be shown only when different. Information shown on schematics need not be repeated.

- (1) The name of the injection formation and, if applicable, the field or pool name.
- (2) The injection interval and whether it is perforated or open-hole.
- (3) State if the well was drilled for injection or, if not, the original purpose of the well.
- (4) Give the depths of any other perforated intervals and detail on the sacks of cement or bridge plugs used to seal off such perforations.
- (5) Give the depth to and name of the next higher and next lower oil or gas zone in the area of the well, if any.

XIV. PROOF OF NOTICE

All applicants must furnish proof that a copy of the application has been furnished, by certified or registered mail, to the owner of the surface of the land on which the well is to be located and to each leasehold operator within one-half mile of the well location.

Where an application is subject to administrative approval, a proof of publication must be submitted. Such proof shall consist of a copy of the legal advertisement which was published in the county in which the well is located. The contents of such advertisement must include:

- (1) The name, address, phone number, and contact party for the applicant;
- (2) the intended purpose of the injection well; with the exact location of single wells or the section, township, and range location of multiple wells;
- (3) the formation name and depth with expected maximum injection rates and pressures; and
- (4) a notation that interested parties must file objections or requests for hearing with the Oil Conservation Division, P. O. Box 2088, Santa Fe, New Mexico 87501 within 15 days.

NO ACTION WILL BE TAKEN ON THE APPLICATION UNTIL PROPER PROOF OF NOTICE HAS BEEN SUBMITTED.

NOTICE: Surface owners or offset operators must file any objections or requests for hearing of administrative applications within 15 days from the date this application was mailed to them.

REPORT OF THE
ON THE
PARKER 4
CASE NO. 9658

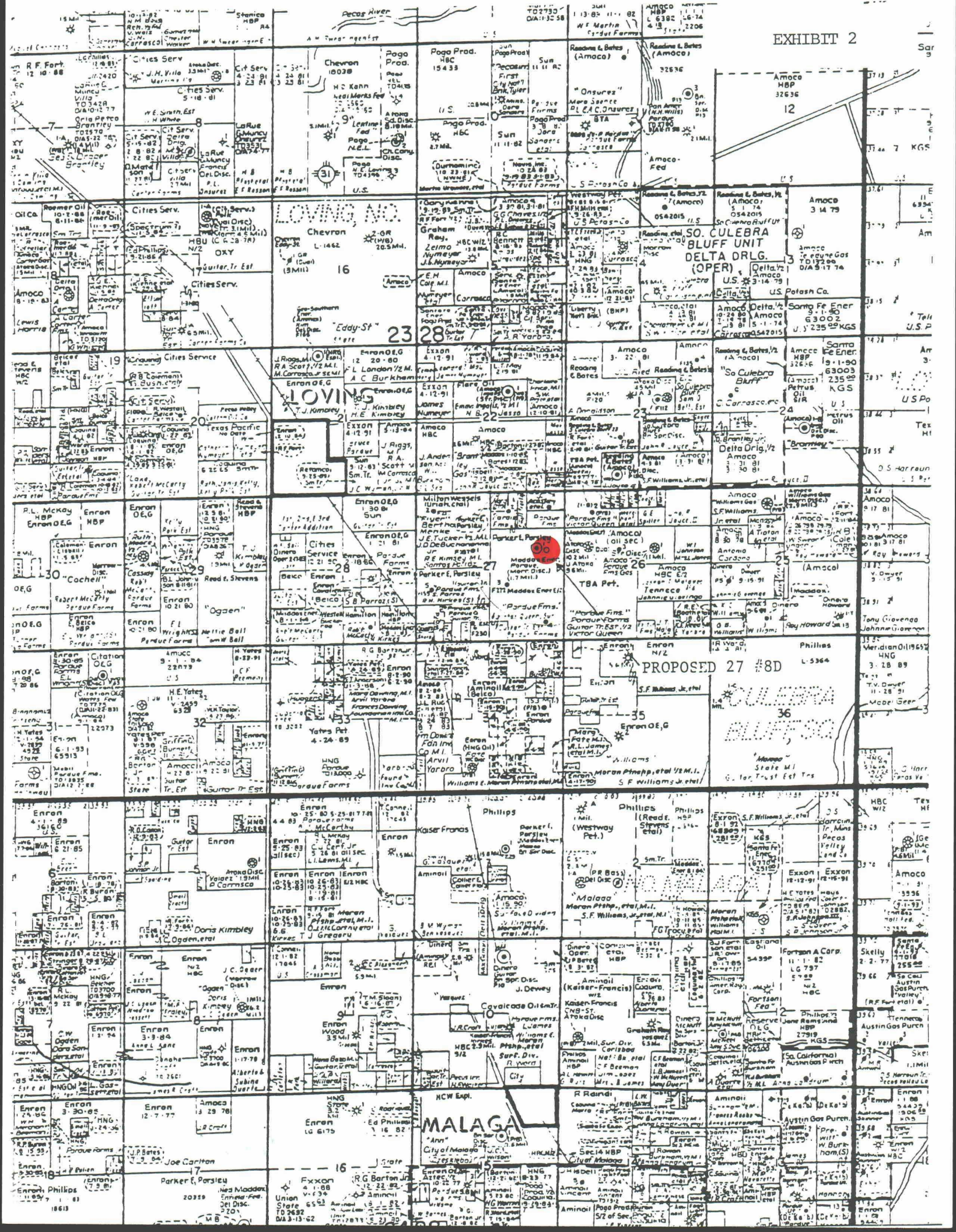

BEFORE EXAMINATION ATTACHED

OIL OIL DOCUMENTATION

Parker EXHIBIT NO. *4*

CASE NO. *9658*

EXHIBIT 4
 PARKER
 CAS# NO. 9658

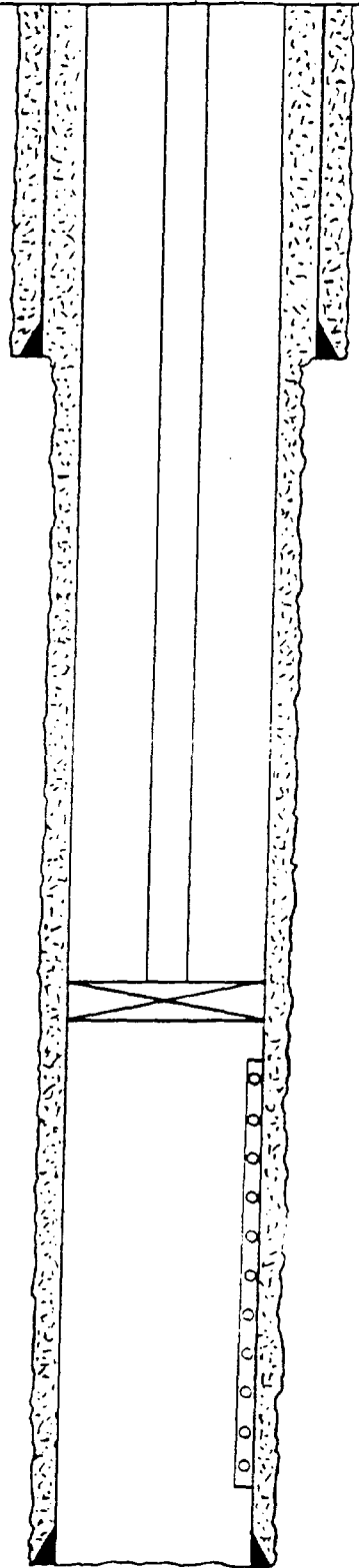

← 9 5/8" 36# csg set @ 500', cmtd w/ 500 sx, 12 1/4" hole, cmt circulated

← 3 1/2" Fiberglass tubing set @ 3400'

← CTIS 7" PERMA-LATCH packer set @ 3400'

← Proposed injection interval
 3500' - 4800' perforated
 DELAWARE (Cherry Canyon)

← 7" 24# csg set @ 4800', cmtd w/ 800 sx, 8 3/4" hole, cmt circulated

PROPOSED AVERAGE RATE : 1500 BHPD
 PROPOSED MAXIMUM RATE : 2000 BHPD
 CLOSED SYSTEM
 PROPOSED AVERAGE PRESSURE : 1000 PSIG
 PROPOSED MAXIMUM PRESSURE : 1500 PSIG

EDWARD SWANER CANTANACH
 GEOPHYSICAL DIVISION
 Parker P. H. D. NO. 6
 CASE NO. 9658

PARDUE FARMS "27" #8D

III.

- A. 1. Pardue Farms 27 #8D
 Sec. 27, T-23S, R-28E
 Unit Letter: H, 2069' FNL & 632' FEL
- 2. 9 5/8", set @ 500', cmtd w/ 500 sx Class "C"
 12 1/4" hole, cmt circulated
- 7", set @ 4800', cmtd w/ 800 sx Class "C"
 8 3/4" hole, cmt circulated
- 3. 3 1/2" Fiberglass tbg set @ +3400'
- 4. Otis Perma-Latch @ +3400'
- B. 1. Delaware (~~Bell Canyon &~~ Cherry Canyon)
- 2. 3500' - 4800'
- 3. Drilled for injection
- 4. None
- 5. Higher Zone - None known
 Lower Zone - Brushy Canyon & Bone Springs

VI.

Pardue Farms 27 #1
 Oil Well
 Spud: 7-30-78 Completed: 4-1-81
 Location: Unit H, 1980' FNL & 990' FEL;
 Sec. 27, 23-S, 28-E
 Depth: 13,100'
 PBTd: 8,000'
 Perfs: 6588 - 7036'

Pardue Farms 27 #2
 Oil Well
 Spud: 3-22-81 Completed: 5-3-81
 Location: Unit B, 1980' FEL & 660' FNL;
 Sec. 27, 23S, 28E
 Depth: 7550'
 PBTd: 7500'
 Perfs: 6252 - 7165'

Pardue Farms 27 #3
Oil Well

Spud: 5-21-81 Completed: 7-8-81
Location: Unit J, 1980' FSL & 1980' FEL;
Sec. 27, 23-S, 28-E
Depth: 7,550'
PBSD: 7,510'
Perfs: 6261 - 7112'

Pardue Farms 27 #4
Oil Well

Spud: 6-11-81 Completed: 9-25-81
Location: Unit P, 660' FSL & 660' FEL;
Sec. 27, 23-S, 28-E
Depth: 7300'
PBSD: 6265'
Perfs: 6070 - 6248'

Pardue Farms 27 #7
Oil Well

Spud: 12-14-88 Completed: 1-16-89
Location: Unit A, 560' FNL & 560' FEL;
Sec. 27, 23-S, 28-E
Depth: 7,508'
PBSD: 6,260'
Perfs: 6040 - 6251'

Pardue Farms 26 #1
Gas Well

Spud: 9-16-78 Completed: 1-7-79
Location: Unit E, 1980' FNL & 660' FWL;
Sec. 26, 23-S, 28-E
Depth: 13,117'
PBSD: 11,885'
Perfs: 11,758 - 11,782'

Pardue Farms 26 #2
Oil Well

Spud: 10-10-80 Completed: 10-26-80
Location: Unit D, 760' FNL & 990' FWL;
Sec. 26, 23-S, 28-E
Depth: 7,063'
PBSD: 6,790'
Perfs: 6,406 - 6,676'

Pardue Farms 26 #3
Oil Well
Spud: 2-4-81 Completed: 4-30-81
Location: Unit F, 2980 FNL & 1980 FWL;
Sec. 26, 23-S, 28-E
Depth: 8,000'
PBSD: 7,200'
Perfs: 6,262 - 7,104'

Flyer #1
Oil Well
Spud: 12-30-82 Completed: 1-28-83
Location: Unit , 1980' FNL & 1980 FWL;
Sec. 27, 23-S, 28-E
Depth: 6,750'
PBSD: 6,698'
Perfs: 6,356 - 6,374'

VII. 1. Average: 1500 BWPD
Maximum: 2000 BWPD

2. Closed

3. Average: 1000 psig
Masimum: 1500 psig

4. Bone Spring and Brushy Canyon, see attachment.

5. See attachment.

VIII. Proposed disposal zone is the Delaware Cherry Canyon and Bell Canyon at a depth of 3500 - 4800'. Lithology is a fine grain quartz sandstone and siltstone interbedded w/ very fine grain gray shales.

The Rustler is the only aquifer overlying the proposed disposal zone. Base of the Rustler is @ 400'.

IX. Proposed stimulation: 5000 gals 15% NEFE acid.

X. Logs & test data will be filed when the proposed well is drilled and completed.

XI. None available.

XII. I, Randy R. Johnson, have examined available geologic and engineering data, and find no evidence of open faults or any other hydrologic connection between the disposal zone and any under ground source of drinking water.

Parker & Parsley Petroleum Co.

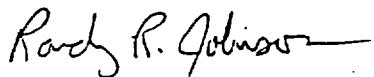
Randy R. Johnson
Operations Engineer

MAR 22 '89 08:13 BJTITAN
MAR 22 '89 08:46 B.J. TITAN (ODESSA, TEXAS)

EXHIBIT 3



Parker ?

CASE NO. 9658

PLEASE REPLY: 888 S. GRANDVIEW
P.O. BOX 8073
ODESSA, TX 79760

Parker & Parsley
Pardue Farms
Station: Hobbs

3-21-89
Craig Bailey
Waters & Oils

PURPOSE: To analyze the water samples and check the compatibility of the oil samples with each other.

WATER ANALYSIS:	INJECTION FLUID	
	<u>Bone Springs</u>	<u>Brush Canyon</u>
Specific Gravity @ 60°F:	1.186	1.196
pH:	5.94	6.08
<u>RADICALS</u>		
Total Hardness	80,000	88,000
Calcium	28,800	32,800
Magnesium	1,920	1,440
Iron(Dissolved)	38	1
Barium	ND	ND
*Sodium	91,701	87,998
Chlorides	198,000	198,000
Sulfate	282	295
Bicarbonata	312	171
Sulfide	NP	NP
Hydrogen Sulfide	NP	NP
TDS	321,053	320,705
Scaling Tendency:		
CaCO ₃ :	Probable	Probable
CaSO ₄ :	Possible	Possible

OIL ANALYSIS:

API GRAVITY @ 60°F: 42.0 45.0

There was no emulsion problems observed between the two oil samples at a 50:50 mixture.

*Sodium is a calculated value to balance the equation.

Lab. Report: 3W-032
Analyzed By: David Ellison



DRESSER TITAN DIVISION, DRESSER INDUSTRIES, INC. P. O. BOX 1407, HOUSTON, TEXAS 77001 713/972-6011

LAB REF. NO. _____

API WATER ANALYSIS REPORT FORM

COMPANY <u>Mobil</u>		SAMPLE NO.		DATE SAMPLED <u>8/19/86</u>	
FIELD		LEGAL DESCRIPTION		COUNTY OR PARISH <u>Eddy</u>	
LEASE OR UNIT <u>Gov. D</u>		WELL <u># 4</u>		DEPTH <u>3849-4010</u>	
TYPE OF WATER (PRODUCED, SUPPLY, ETC.) <u>Produced</u>		FORMATION <u>Delaware</u>		WATER, S/D	
SAMPLING POINT <u>Well head</u>		SAMPLER		SAMPLER BY <u>CB</u>	

DISSOLVED SOLIDS

CATIONS	mg/l	me/l	ppm
Sodium, Na (calc.)	<u>41,190</u>	<u>1804.69</u>	
Calcium, Ca	<u>17,600</u>	<u>880</u>	
Magnesium, Mg	<u>4,660</u>	<u>380</u>	
Barium, Ba	<u>-0-</u>	<u>-0-</u>	
Fe + 2	<u>19</u>	<u>691</u>	

OTHER PROPERTIES

pH	<u>5.7</u>
Specific Gravity, 60/60 F.	<u>1.122</u>
Resistivity (ohm-meters) <u>70° F.</u>	<u>70</u>

WATER PATTERNS - me/l

ANIONS	me/l	me/l	
Chloride, Cl	<u>107,000</u>	<u>3014.08</u>	
Sulfate, SO ₄	<u>1,400</u>	<u>34.17</u>	
Carbonate, CO ₃	<u>-0-</u>	<u>-0-</u>	
Bicarbonate, HCO ₃	<u>1317.60</u>	<u>21.60</u>	
Total Hardness	<u>63,000</u>		

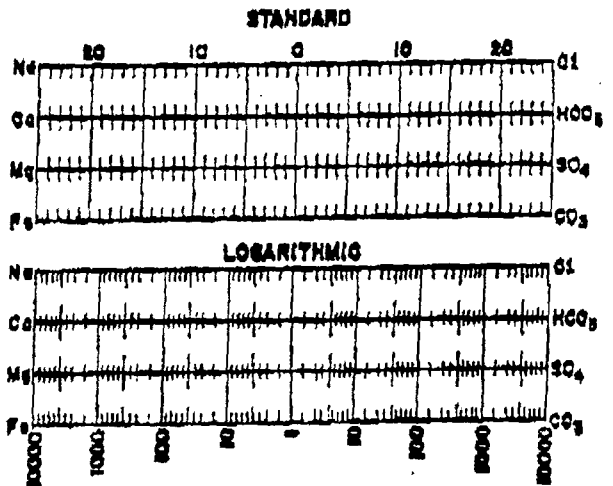

Total Dissolved Solids (calc.)	<u>173,372.60</u>	
Iron, Fe (total)		
Sulfide, as H ₂ S		

REMARKS & RECOMMENDATIONS:

Parker 8
 CASE NO. 9658

W.F

Submit to Appropriate District Office
State Lease - 6 copies
Fee Lease - 5 copies

State of New Mexico
Energy, Minerals and Natural Resources Department

Form C-101
Revised 1-1-89

OIL CONSERVATION DIVISION
P.O. Box 2088
Santa Fe, New Mexico 87504-2088

DISTRICT I
P.O. Box 1980, Hobbs, NM 88240

DISTRICT II
P.O. Drawer DD, Artesia, NM 88210

DISTRICT III
1000 Rio Brazos Rd., Aztec, NM 87410

API NO. (assigned by OCD on New Wells)

5. Indicate Type of Lease
STATE FEE

6. State Oil & Gas Lease No.

APPLICATION FOR PERMIT TO DRILL, DEEPEN, OR PLUG BACK

1a. Type of Work:
DRILL RE-ENTER DEEPEN PLUG BACK
b. Type of Well:
OIL WELL GAS WELL OTHER SWD
SINGLE ZONE MULTIPLE ZONE

7. Lease Name or Unit Agreement Name
Pardue Farms 27

2. Name of Operator
Parker & Parsley Petroleum Company

8. Well No.
8-D

3. Address of Operator
P. O. Box 3178, Midland, Texas 79702

9. Pool name or Wildcat
Delaware (Bell Canyon)

4. Well Location
Unit Letter H : 2069 Feet From The North Line and 632 Feet From The East Line
Section 27 Township 23S Range 28E NMPM Eddy County

10. Proposed Depth
4800
11. Formation
Bell Canyon
12. Rotary or C.T.
Rotary

13. Elevations (Show whether DF, RT, GR, etc.)
3033.1 GR
14. Kind & Status Plug. Bond
Blanket-Active
15. Drilling Contractor
Capstarr
16. Approx. Date Work will start
4-1-89

17. PROPOSED CASING AND CEMENT PROGRAM					
SIZE OF HOLE	SIZE OF CASING	WEIGHT PER FOOT	SETTING DEPTH	SACKS OF CEMENT	EST. TOP
12 1/4	9 5/8	36#	500'	500	Surf.
8 3/4	7"	24#	4800'	800	Surf.

BOP's - 500-4800' 10" 3000 psi double ram preventers, nearest resistance approximately 400'.

Parker
9
CASE NO. 9658

IN ABOVE SPACE DESCRIBE PROPOSED PROGRAM: IF PROPOSAL IS TO DEEPEN OR PLUG BACK, GIVE DATA ON PRESENT PRODUCTIVE ZONE AND PROPOSED NEW PRODUCTIVE ZONE. GIVE BLOWOUT PREVENTER PROGRAM, IF ANY.

I hereby certify that the information above is true and complete to the best of my knowledge and belief.
SIGNATURE Randy R. Johnson TITLE Operations Engineer DATE 3-27-89
TYPE OR PRINT NAME Randy Johnson TELEPHONE NO. 915 683 47

(This space for State Use)

APPROVED BY _____ TITLE _____ DATE _____
CONDITIONS OF APPROVAL, IF ANY:

Submit to Appropriate District Office
State Lease - 4 copies
Fee Lease - 3 copies

State of New Mexico
Energy, Minerals and Natural Resources Department

Form C-102
Revised 1-1-89

OIL CONSERVATION DIVISION

P.O. Box 2088

Santa Fe, New Mexico 87504-2088

DISTRICT I
P.O. Box 1980, Hobbs, NM 88240

DISTRICT II
P.O. Drawer DD, Artesia, NM 88210

DISTRICT III
1000 Rio Brazos Rd., Aztec, NM 87410

WELL LOCATION AND ACREAGE DEDICATION PLAT

All Distances must be from the outer boundaries of the section

Operator Parker & Parsley		Lease Pardue Farms 27		Well No. 8-D
Unit Letter H	Section 27	Township 23 South	Range 28 East	County Eddy
Actual Footage Location of Well: 2069 feet from the north line and 632 feet from the east line				
Ground level Elev. 3033.1	Producing Formation Bell Canyon	Pool Delaware (Bell Canyon)	Dedicated Acreage: 40 Acres	

- Outline the acreage dedicated to the subject well by colored pencil or hatchure marks on the plat below.
- If more than one lease is dedicated to the well, outline each and identify the ownership thereof (both as to working interest and royalty).
- If more than one lease of different ownership is dedicated to the well, have the interest of all owners been consolidated by communitization, unitization, force-pooling, etc?
 Yes No If answer is "yes" type of consolidation Designation of pooled or unitized area
 If answer is "no" list the owners and tract descriptions which have actually been consolidated. (Use reverse side of this form if necessary.)
 No allowable will be assigned to the well until all interests have been consolidated (by communitization, unitization, forced-pooling, or otherwise) or until a non-standard unit, eliminating such interest, has been approved by the Division.

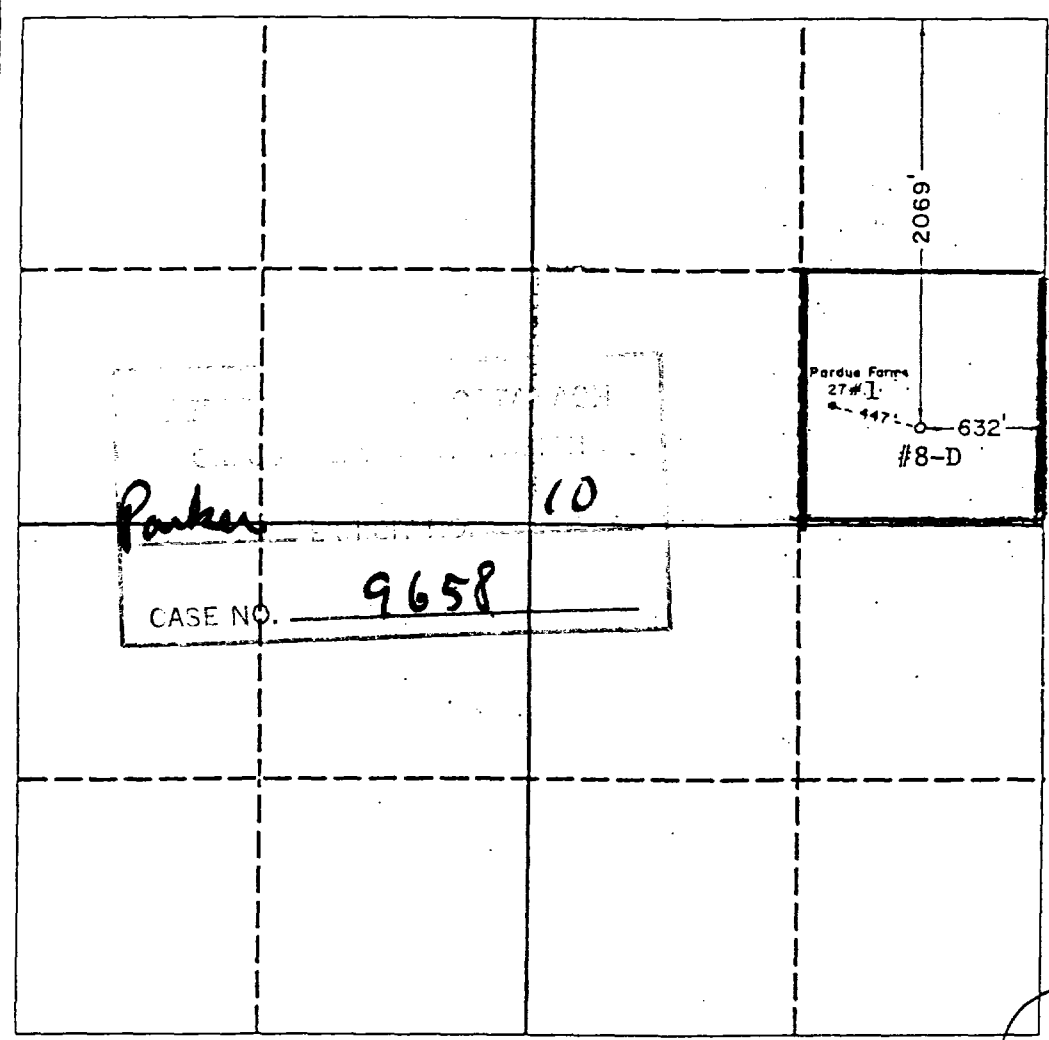

OPERATOR CERTIFICATION
I hereby certify that the information contained herein is true and complete to the best of my knowledge and belief.

Randy R. Johnson
Signature
Randy Johnson
Printed Name
Operations Engineer
Position
Parker & Parsley Petr. Co.
Company
3-27-89
Date

SURVEYOR CERTIFICATION
I hereby certify that the well location shown on this plat was plotted from field notes of actual surveys made by me or under my supervision, and that the same is true and correct to the best of my knowledge and belief.

Date Surveyed
March 21, 1989

Signature & Seal of Professional Surveyor
Ronald J. Eidson

REGISTERED PROFESSIONAL LAND SURVEYOR
NEW MEXICO
RONALD J. EIDSON
Certificate No. 676 W. WEST 676
3239

1258JU

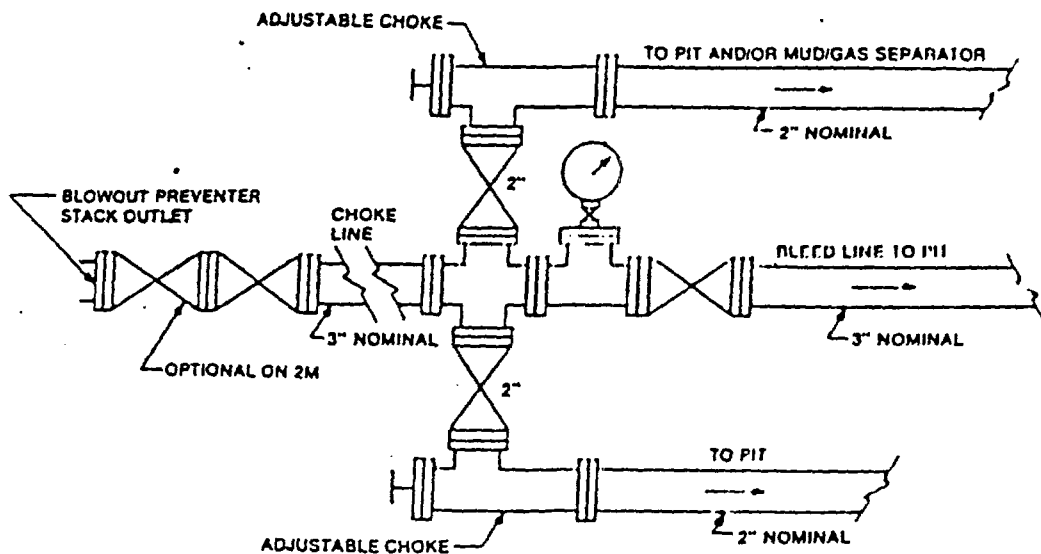

FIGURE K4-1. Typical choke manifold assembly for .3M rated working pressure service — surface installation.

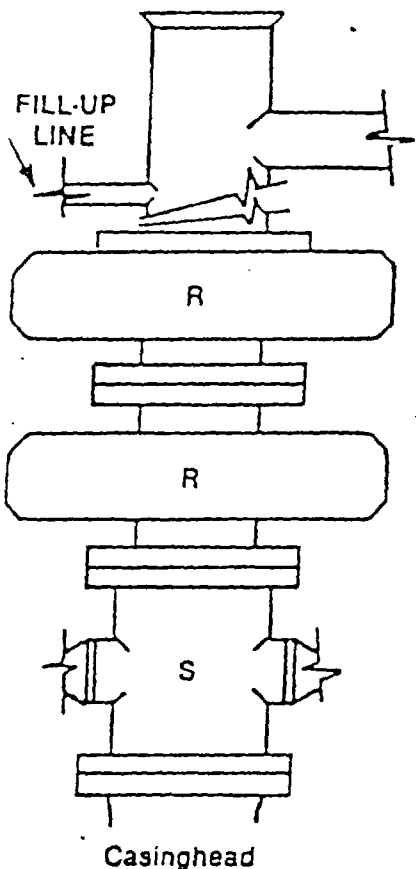

FIGURE K1-1. Recommended IADC Class 2 BOP stack; 3000 psi WP. Either SRd (left) or SA (right) arrangement is acceptable and drilling spool is optional.

Parker
11
CASE NO. 9658

STATE OF NEW MEXICO
ENERGY, MINERALS AND NATURAL RESOURCES DEPARTMENT
OIL CONSERVATION DIVISION

IN THE MATTER OF THE APPLICATION
OF PARKER & PARSLEY PETROLEUM COMPANY
FOR SALT WATER DISPOSAL
EDDY COUNTY, NEW MEXICO

CASE NO. 9658

CERTIFICATE OF MAILING

AND

COMPLIANCE WITH ORDER R-8054

In accordance with Division Rule 1207 (Order R-8054) I hereby certify that on April 4, 1989, I caused to be mailed by regular mail, a notice of this hearing and a copy of the application for the above referenced case along with the cover letter, at least twenty days prior to the hearing set for April 26, 1989 to the parties shown in the Application evidenced by the attached Exhibit A.

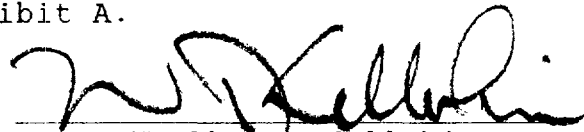
W. Thomas Kellahin

SUBSCRIBED AND SWORN TO before me this 25th day of April, 1989 by W. Thomas Kellahin, attorney for the applicant.

Notary Public

My Commission Expires:

March 3, 1993

SEARCHED	INDEXED
SERIALIZED	FILED
Parker	12
CASE NO.	9658

WTK/parker & Parsley/ "27" 8-D

SENDER: Complete items 1 and 2 when additional services are desired, and complete items 3 and 4. Put your address in the "RETURN TO" Space on the reverse side. Failure to do this will prevent this card from being returned to you. The return receipt fee will provide you the name of the person delivered to and the date of delivery. For additional fees the following services are available. Consult postmaster for fees and check boxes for additional services(s) requested. 1. XX Show to whom delivered, date, and addressee's address. 2. Restricted Delivery (Extra charge)

3. Article Addressed to: HNG Oil Cpmpany c/o Elron Oil & Gas P.O. Box 2267 Midland, TX 79702 4. Article Number P 784 194 427 Type of Service: Registered Insured Certified COD Express Mail Return Receipt for Merchandise Always obtain signature of addressee or agent and DATE DELIVERED.

5. Signature - Address X 6. Signature - Agent X 7. Date of Delivery 10/14/89

PS Form 3811, Mar. 1988 * U.S.G.P.O. 1988-212-865 DOMESTIC RETURN RECEIPT

WTK/parker & Parsley/ "27" 8-D

SENDER: Complete items 1 and 2 when additional services are desired, and complete items 3 and 4. Put your address in the "RETURN TO" Space on the reverse side. Failure to do this will prevent this card from being returned to you. The return receipt fee will provide you the name of the person delivered to and the date of delivery. For additional fees the following services are available. Consult postmaster for fees and check boxes for additional services(s) requested. 1. XX Show to whom delivered, date, and addressee's address. 2. Restricted Delivery (Extra charge)

3. Article Addressed to: Amoco Production Comapny P.O. Box 4072 Odessa, TX 79760 4. Article Number P 784 194 428 Type of Service: Registered Insured Certified COD Express Mail Return Receipt for Merchandise Always obtain signature of addressee or agent and DATE DELIVERED.

5. Signature - Address X 6. Signature - Agent X 7. Date of Delivery

PS Form 3811, Mar. 1988 * U.S.G.P.O. 1988-212-865 DOMESTIC RETURN RECEIPT

WTK/Parker & Parsley/"27" 8-D

SENDER: Complete items 1 and 2 when additional services are desired, and complete items 3 and 4. Put your address in the "RETURN TO" Space on the reverse side. Failure to do this will prevent this card from being returned to you. The return receipt fee will provide you the name of the person delivered to and the date of delivery. For additional fees the following services are available. Consult postmaster for fees and check boxes for additional services(s) requested. 1. XX Show to whom delivered, date, and addressee's address. 2. Restricted Delivery (Extra charge)

3. Article Addressed to: Mr. Milton Wessels P.O. Box 940 Marble Falls, TX 77090 4. Article Number P 784 194 426 Type of Service: Registered Insured Certified COD Express Mail Return Receipt for Merchandise Always obtain signature of addressee or agent and DATE DELIVERED.

5. Signature - Address X 6. Signature - Agent X 7. Date of Delivery 9/14/89

PS Form 3811, Mar. 1988 * U.S.G.P.O. 1988-212-865 DOMESTIC RETURN RECEIPT

WTK/Parker & Parsley/"27" 8-D

SENDER: Complete items 1 and 2 when additional services are desired, and complete items 3 and 4. Put your address in the "RETURN TO" Space on the reverse side. Failure to do this will prevent this card from being returned to you. The return receipt fee will provide you the name of the person delivered to and the date of delivery. For additional fees the following services are available. Consult postmaster for fees and check boxes for additional services(s) requested. 1. XX Show to whom delivered, date, and addressee's address. 2. Restricted Delivery (Extra charge)

3. Article Addressed to: Billie Queen Route 211 Ash Road Loving, NM 86256 4. Article Number P 784 194 429 Type of Service: Registered Insured Certified COD Express Mail Return Receipt for Merchandise Always obtain signature of addressee or agent and DATE DELIVERED.

5. Signature - Address X 6. Signature - Agent X 7. Date of Delivery 7-1-89

PS Form 3811, Mar. 1988 * U.S.G.P.O. 1988-212-865 DOMESTIC RETURN RECEIPT

UNITED STATES POSTAL SERVICE
OFFICIAL BUSINESS

SENDER INSTRUCTIONS

- Print your name, address and ZIP Code in the space below.
- Complete items 1, 2, 3, and 4 on the reverse.
 - Attach to front of article if space permits, otherwise affix to back of article.
 - Endorse article "Return Receipt Requested" adjacent to number.



PENALTY FOR PRIVATE USE, \$300

RECEIVED APR 12 1989

Print Sender's name, address, and ZIP Code in the space below.

RETURN TO

KELLAHIN and KELLAHIN
117 N. Guadalupe
P.O. Box 2265
Santa Fe, N. Mex. 87501



UNITED STATES POSTAL SERVICE
OFFICIAL BUSINESS

SENDER INSTRUCTIONS

- Print your name, address and ZIP Code in the space below.
- Complete items 1, 2, 3, and 4 on the reverse.
 - Attach to front of article if space permits, otherwise affix to back of article.
 - Endorse article "Return Receipt Requested" adjacent to number.



PENALTY FOR PRIVATE USE, \$300

RECEIVED APR 17 1989

Print Sender's name, address, and ZIP Code in the space below.

RETURN TO

KELLAHIN, KELLAHIN & AUBREY
P. O. Box 2265
Santa Fe, NM 87504-2265

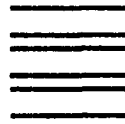

UNITED STATES POSTAL SERVICE
OFFICIAL BUSINESS

SENDER INSTRUCTIONS

- Print your name, address and ZIP Code in the space below.
- Complete items 1, 2, 3, and 4 on the reverse.
 - Attach to front of article if space permits, otherwise affix to back of article.
 - Endorse article "Return Receipt Requested" adjacent to number.



PENALTY FOR PRIVATE USE, \$300

RECEIVED APR 06 1989

Print Sender's name, address, and ZIP Code in the space below

RETURN TO

KELLAHIN, KELLAHIN & AUBREY
P. O. Box 2265
Santa Fe, NM 87504-2265

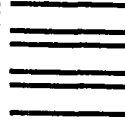

UNITED STATES POSTAL SERVICE
OFFICIAL BUSINESS

SENDER INSTRUCTIONS

- Print your name, address and ZIP Code in the space below.
- Complete items 1, 2, 3, and 4 on the reverse.
 - Attach to front of article if space permits, otherwise affix to back of article.
 - Endorse article "Return Receipt Requested" adjacent to number.



PENALTY FOR PRIVATE USE, \$300

RECEIVED APR 10 1989

Print Sender's name, address, and ZIP Code in the space below.

RETURN TO

KELLAHIN and KELLAHIN
117 N. Guadalupe
P.O. Box 2265
Santa Fe, N. Mex. 87501