

BEFORE EXAMINER SUTCHNER

Oil Conservation Division

SF 6 Exhibit No. 1

Case No. 9797

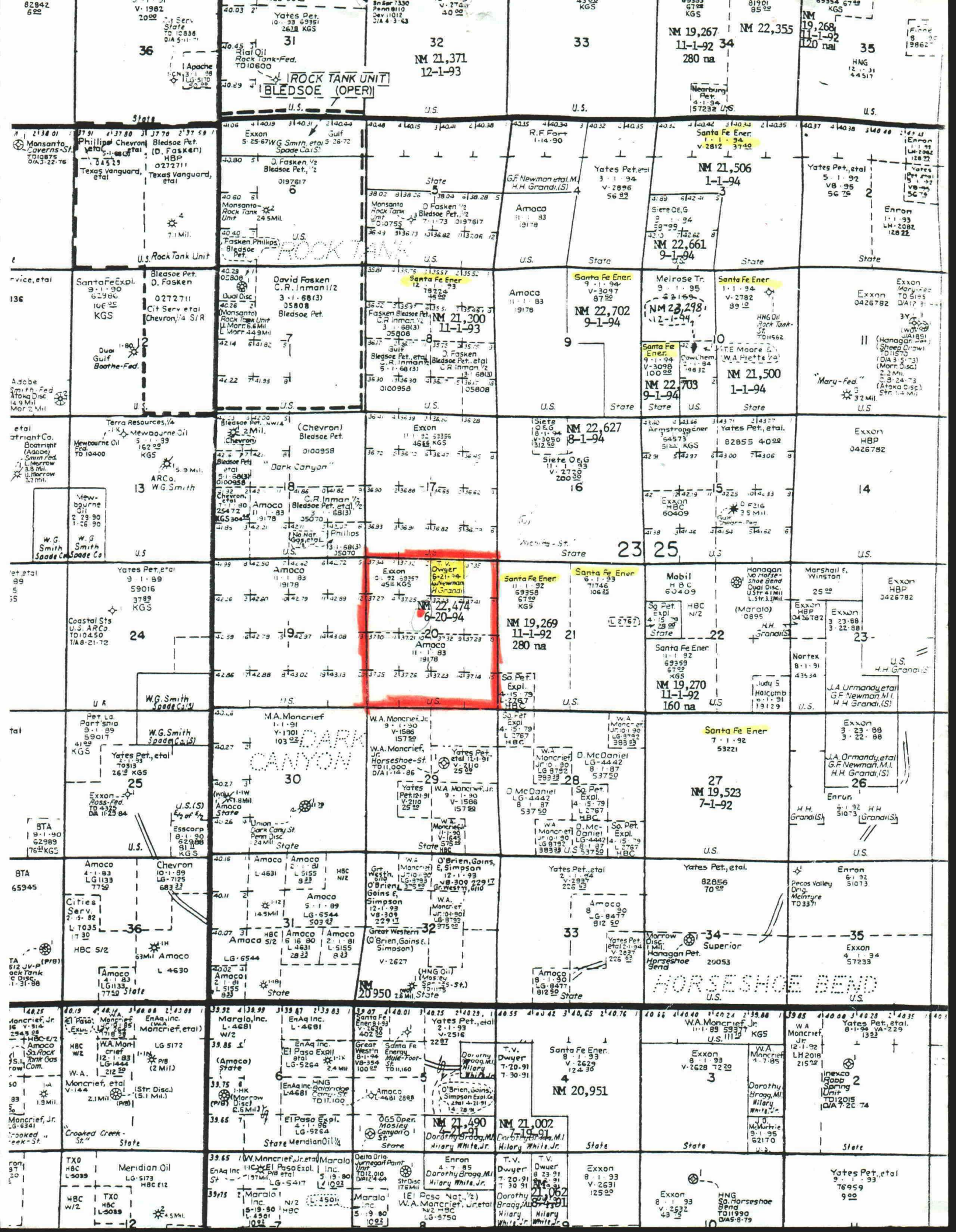

36

31

32

33

35

ROCK TANK UNIT
BLEDSOE (OPER)

NM 21,371
12-1-93

NM 19,267
11-1-92 34
280 na

NM 22,355

NM 19,268
11-1-92
20 na

Monsanto
Phillips Chevron
Bledsoe Pet.
(D. Fosken)
Texas Vanguard,
etal

Yates Pet., etal
5-25-67W
G. Smith, etal
Spade Co. (S)

R.F. Fort
1-14-90

Yates Pet., etal
3-1-94
V. 2896
56 92

Santa Fe Ener.
V. 2812
37-40

Yates Pet., etal
5-1-92
V.B. 95
56 26

Santa Fe Expl.
9-11-90
62986
106 25
KGS

David Fosken
C.R. Inman (1/2)
3-11-68(3)
35808
Bledsoe Pet.

Santa Fe Ener.
12-28-25
46 22

Amoco
11-1-83
19178

Santa Fe Ener.
11-1-94
V-3097
8750
NM 22,702
9-1-94

Exxon
0426782

Terra Resources, 1/4
Newbourne Oil
3-12-89
KGS

Bledsoe Pet., etal
(Chevron)
Bledsoe Pet.
Dark Canyon

Exxon
11-31-83
4618 KGS

Santa Fe Ener.
11-1-94
V-3097
8750
NM 22,627
8-1-94

Melrose Tr.
9-11-95
V-2782
89 12

Exxon
HBP
0426782

Coastal Sits
U.S. ARCO
TD 10450
1A-8-21-72

Amoco
11-1-83
19178

Exxon
11-31-83
4618 KGS

Santa Fe Ener.
11-1-92
6750
KGS

Santa Fe Ener.
6-11-93
71746
106 25

Exxon
HBP
0426782

Yates Pet., etal
9-1-89
59016
3789
KGS

M.A. Moncrief
1-1-91
Y-1701
103 22

W.A. Moncrief Jr.
1-1-90
V-1586
157 50

Santa Fe Ener.
11-1-92
6750
KGS

Mobil
HBC
60409

Exxon
HBP
0426782

Amoco
10-1-89
LG-1133
7750

Amoco
12-1-81
L 5155
833

W.A. Moncrief Jr.
1-1-90
V-1586
157 50

Yates Pet., etal
1-1-94
V-2924
226 22

Yates Pet., etal
8-1-90
V-2837
812 50

Enron
8-1-92
51073

Amoco
10-1-89
LG-1133
7750

Amoco
12-1-81
L 5155
833

W.A. Moncrief Jr.
1-1-90
V-1586
157 50

Yates Pet., etal
1-1-94
V-2924
226 22

Yates Pet., etal
8-1-90
V-2837
812 50

Enron
8-1-92
51073

Meridian Oil
LG-5173
HBC E12

EnAq Inc.
L-4681

EnAq Inc.
L-4681

EnAq Inc.
L-4681

EnAq Inc.
L-4681

EnAq Inc.
L-4681