

**NEW MEXICO  
OIL CONSERVATION COMMISSION**

Gas Well Plat

Date 8-31-54

The Texas Company  
Operator

Wm. Weir  
Lease

1  
Well No.

Name of Producing Formation \_\_\_\_\_ \* Pool Eumont Gas Pool & Monument Oil Pool

\*This well was originally completed as oil well in Monument Pay.  
It is ~~now~~ dually completed as gas well from Eumont (Queen) gas pay  
No. Acres Dedicated to the Well 160

SECTION 25 & 26 TOWNSHIP 19 South RANGE 36 East

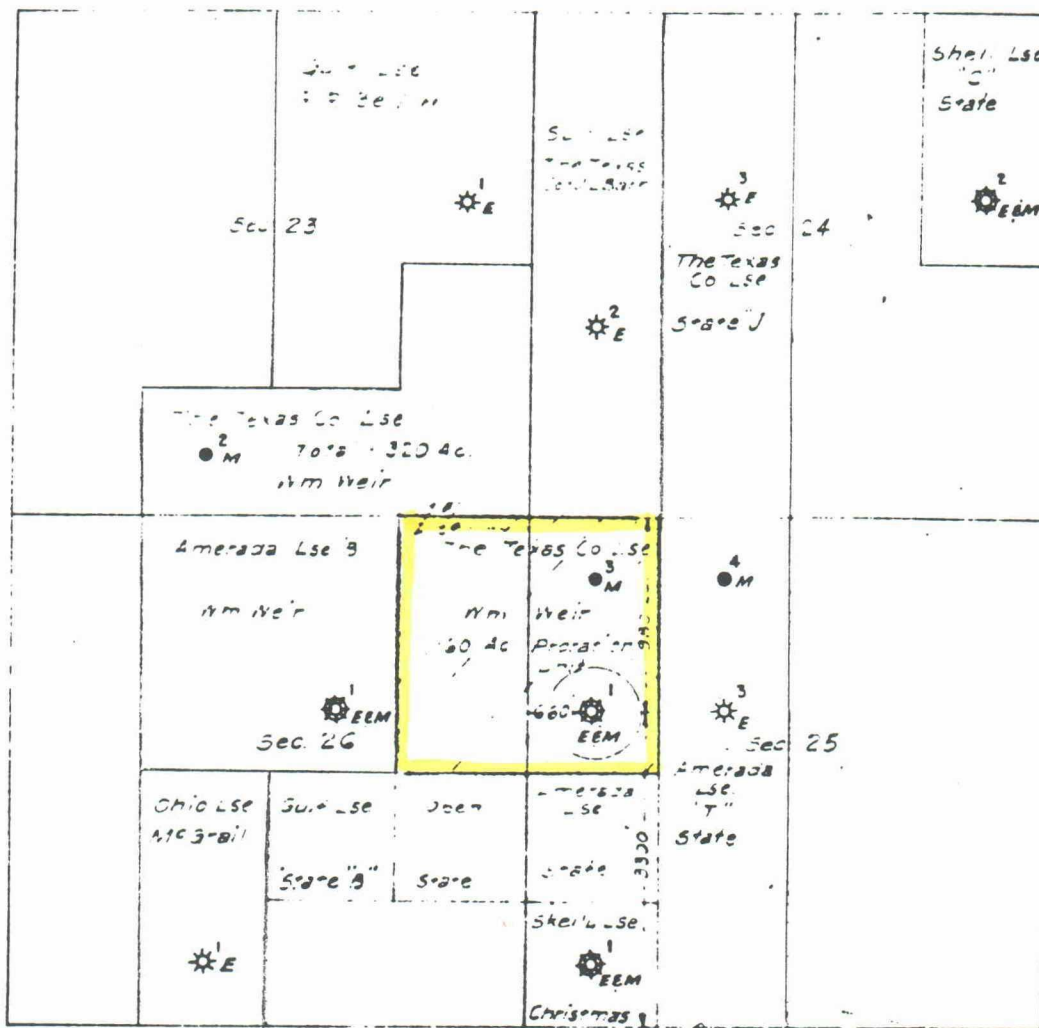

Dual well in Monument & Eumont

Scale 1" = 2000'

I hereby certify that the information given above is true and complete to the best of my knowledge.

Name [Signature]  
Position Division Civil Engineer  
Representing The Texas Company  
Address P. O. Box 1720  
Fort Worth, Texas

*Exhibits 1 through 8*

(over)

BEFORE EXAMINER CATANACH  
OIL CONSERVATION DIVISION  
TEXAco EXHIBIT NO. 2  
CASE NO. 9834

MONUMENT POOL

IAP

1936

20

21

22

23

24

BEFORE EXAMINER CATAVACH  
OIL CONSERVATION DIVISION  
EXHIBIT NO. 9834  
CASE NO.

TEXACO

AMEROCO

CONOCO

REED

SANDERSON UNIT

CONOCO (OPER)

REED-3

JIM HEWES ETAL

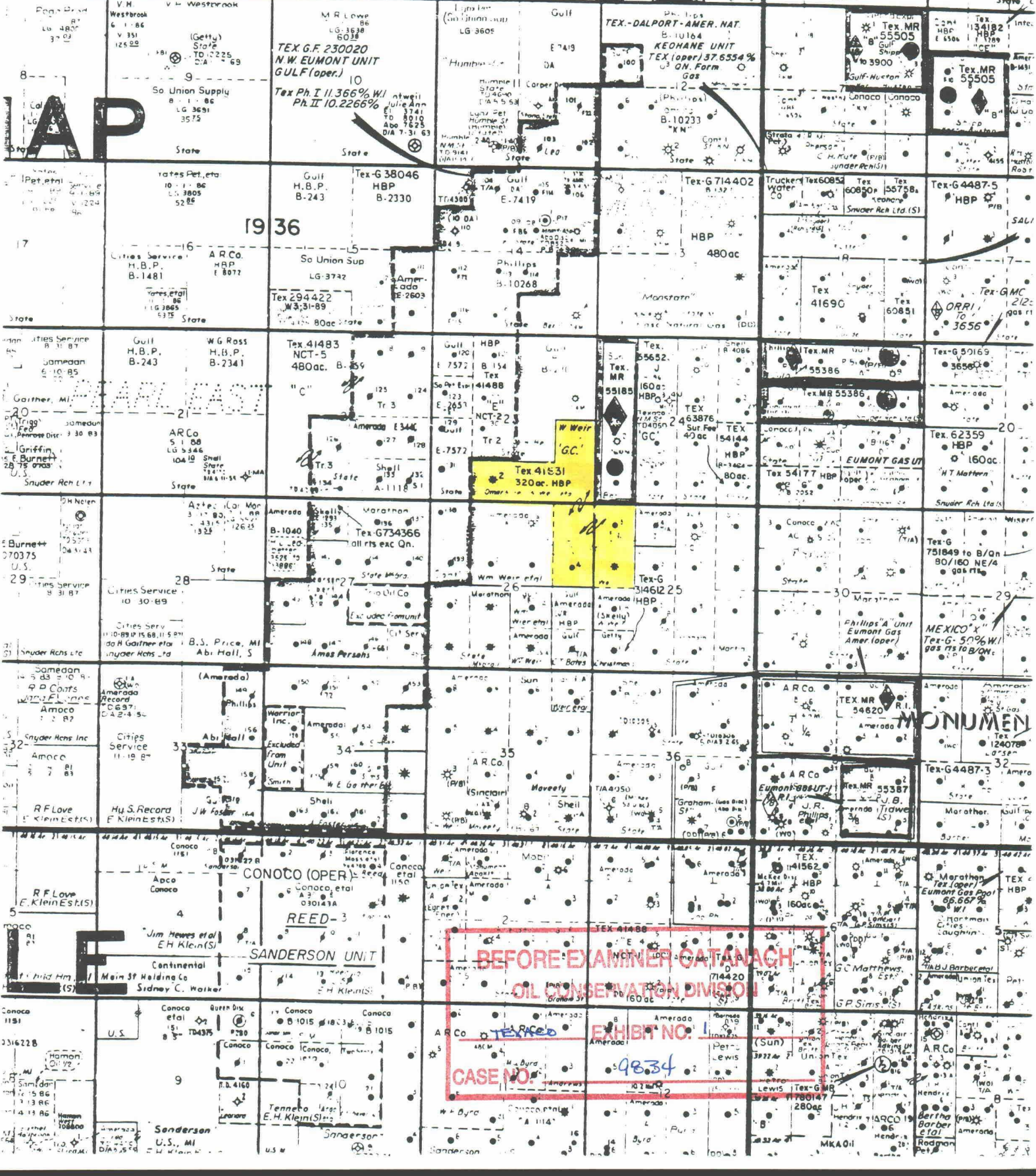

Date June 10, 1955

The Texas Company      Wm. Weir      2  
Operator                      Lease                      Well No.

Name of Producing Formation Queen      Pool Eumont

No. Acres Dedicated to the Well 160

SECTION 23      TOWNSHIP 19-S      RANGE 36-E

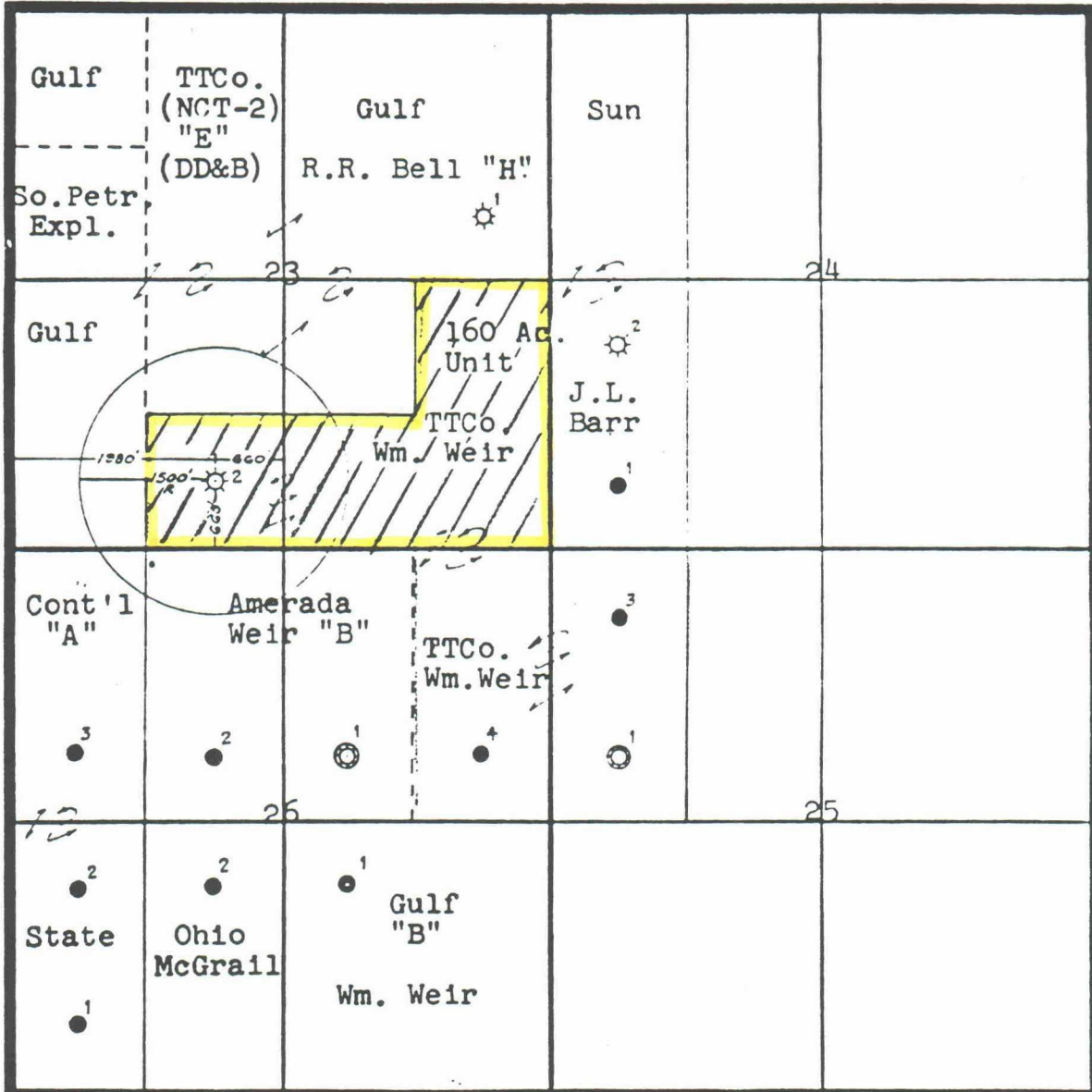

I hereby certify that the information given above is true and complete to the best of my knowledge.

- 1. Is this gas well a dual completion?  
Yes \_\_\_\_\_ No X
- 2. If the answer to Question 1 is Yes, are there any other dually completed wells within the dedicated acreage?  
Yes \_\_\_\_\_ No X

Name J. J. Vetter  
Position Division Civil Engineer  
Representing The Texas Company  
Address P.O. Box 1720, Ft. Worth, Texas

(over)

BEFORE EXAMINER CATANACH  
OIL CONSERVATION DIVISION

TEXACO EXHIBIT NO. 3

CASE NO. 9834

**OIL CONSERVATION DIVISION**

P.O. Box 2088

Santa Fe, New Mexico 87504-2088

**DISTRICT I**  
 P.O. Box 1980, Hobbs, NM 88240

**DISTRICT II**  
 P.O. Drawer DD, Artesia, NM 88210

**DISTRICT III**  
 1000 Rio Brazos Rd., Aztec, NM 87410

**WELL LOCATION AND ACREAGE DEDICATION PLAT**

All Distances must be from the outer boundaries of the section

Operator			Lease			Well No.		
Unit Letter	Section	Township	Range	County		NMPM		
Actual Footage Location of Well:								
feet from the			line and			feet from the		
Ground level Elev.			Producing Formation			Pool		
						Dedicated Acreage:		
						Acres		

- Outline the acreage dedicated to the subject well by colored pencil or hachure marks on the plat below.
- If more than one lease is dedicated to the well, outline each and identify the ownership thereof (both as to working interest and royalty).
- If more than one lease of different ownership is dedicated to the well, have the interest of all owners been consolidated by communitization, unitization, force-pooling, etc.?
   
 Yes     No    If answer is "yes" type of consolidation \_\_\_\_\_
   
If answer is "no" list the owners and tract descriptions which have actually been consolidated. (Use reverse side of this form if necessary.) \_\_\_\_\_
   
No allowable will be assigned to the well until all interests have been consolidated (by communitization, unitization, forced-pooling, or otherwise) or until a non-standard unit, eliminating such interest, has been approved by the Division.

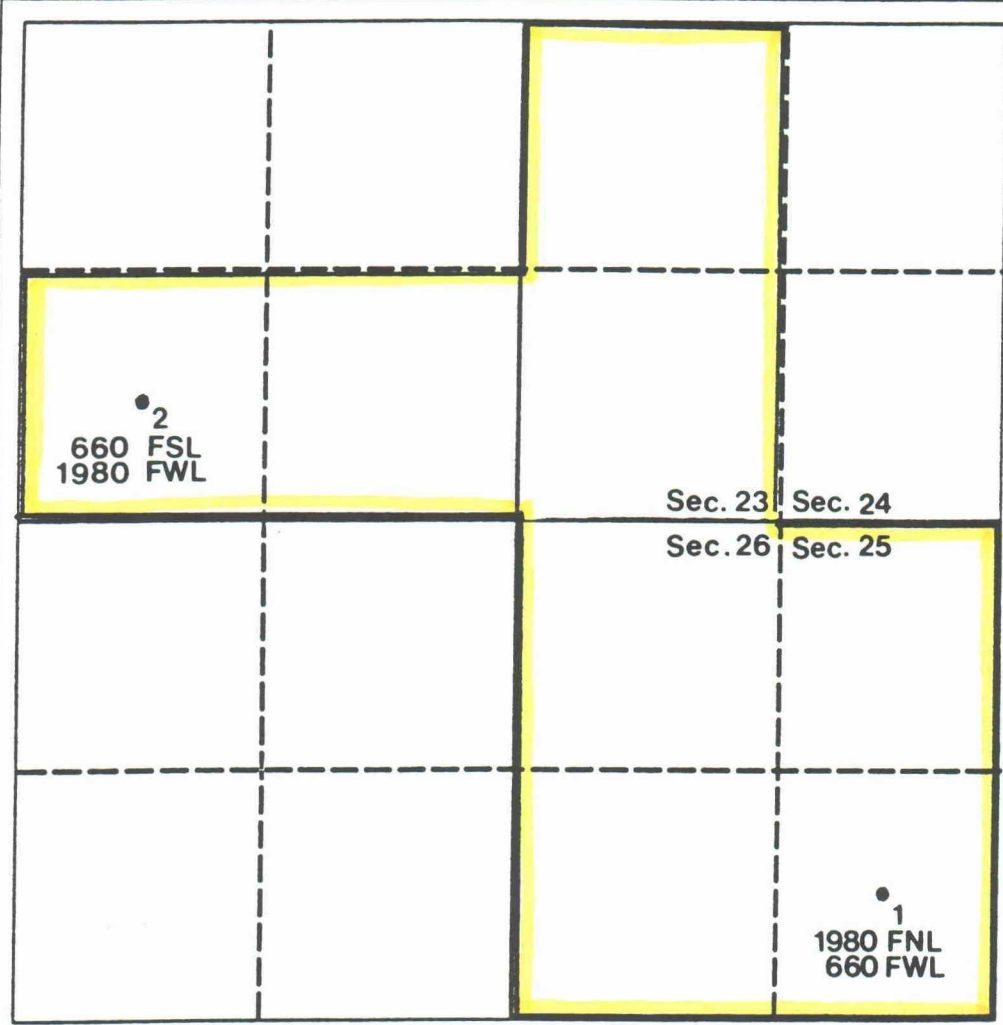

**OPERATOR CERTIFICATION**

*I hereby certify that the information contained herein is true and complete to the best of my knowledge and belief.*

Signature \_\_\_\_\_

Printed Name \_\_\_\_\_

Position \_\_\_\_\_

Company \_\_\_\_\_

Date \_\_\_\_\_

**SURVEYOR CERTIFICATION**

*I hereby certify that the well location shown on this plat was plotted from field notes of actual surveys made by me or under my supervision, and that the same is true and correct to the best of my knowledge and belief.*

Date Surveyed \_\_\_\_\_

Signature & Seal of Professional Surveyor \_\_\_\_\_

Certificate No. \_\_\_\_\_



**PROPOSED PRORATION UNIT**

BEFORE EXAMINER CATANACH  
OIL CONSERVATION DIVISION

TEXACO EXHIBIT NO. 4

CASE NO. 9834

# Eumont Yates Seven Rivers Queen 1988 Shut-In Pressures PSIA

Sec. 23	T-19S		R-36E		Sec. 24
Chevron N.W. Eumont Unit	Chevron R.R. Bell NCT H	Oryx J.L. Barr	Texaco N.M. J State	Chevron 155.2	Shell * 193.2
	* 162.2	* 177.2	* 100.2	* 170.2	State C
	* None Reported	Texaco William Weir		Graham State NCT C	
Conoco State A 26	Amerada Hess * 183.2	Texaco William Weir	Amerada Hess State T	* 153.2	Chevron State NCT C Com
	W.A. Weir B	* 186.2	* 143.2	* 185.2	
	Marathon McGrail State	Texaco A.L. Christmas B	Shut-In		
* 150.2	* 135.2 (1987)	* 143.2	* Shut-In		

Sec. 26

Sec. 25



**BEFORE EXAMINER CATANACH**  
**OIL CONSERVATION DIVISION**

TEXAS EXHIBIT NO. 5

CASE NO. 9834

WM WEIR - 001 EUMONT

TEXACO INCORPORATED PENROSE SAND (QUEEN)

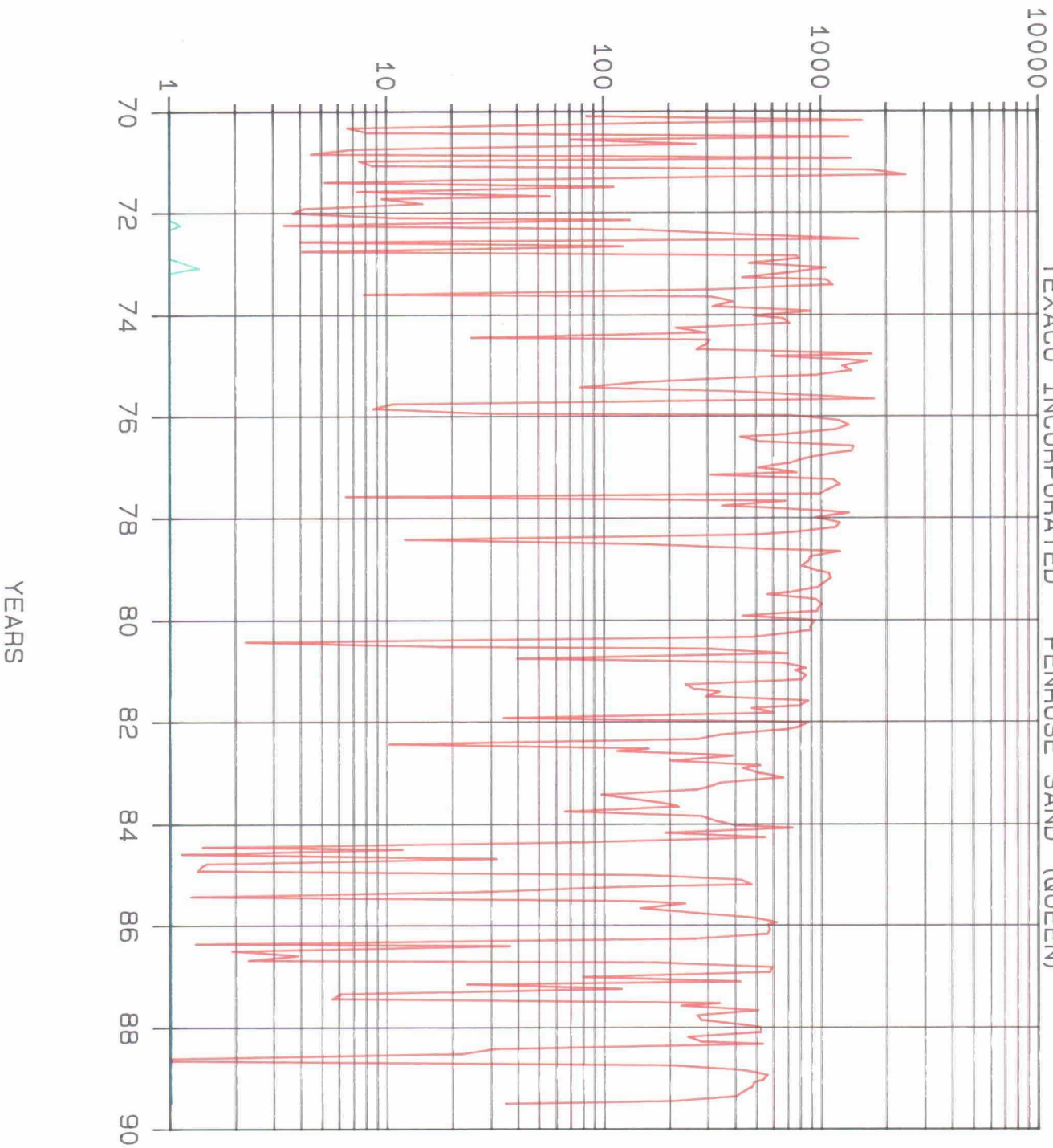

LEASE DATA

LSE 881750

FLD 19800

OPER 833000

ZONE QN

19S-36E-25

COUNTY 025

STATE 30

STATUS

CO 0.837 MBO

CG 4994 MMCF

BOPD 0

BWPD 0

MCFPD 35

WELLS 1

BEFORE EXAMINER CATANACH  
OIL CONSERVATION DIVISION

TEXACO EXHIBIT NO. 6

CASE NO. 9834

BOPD    BWPD    MCFPD

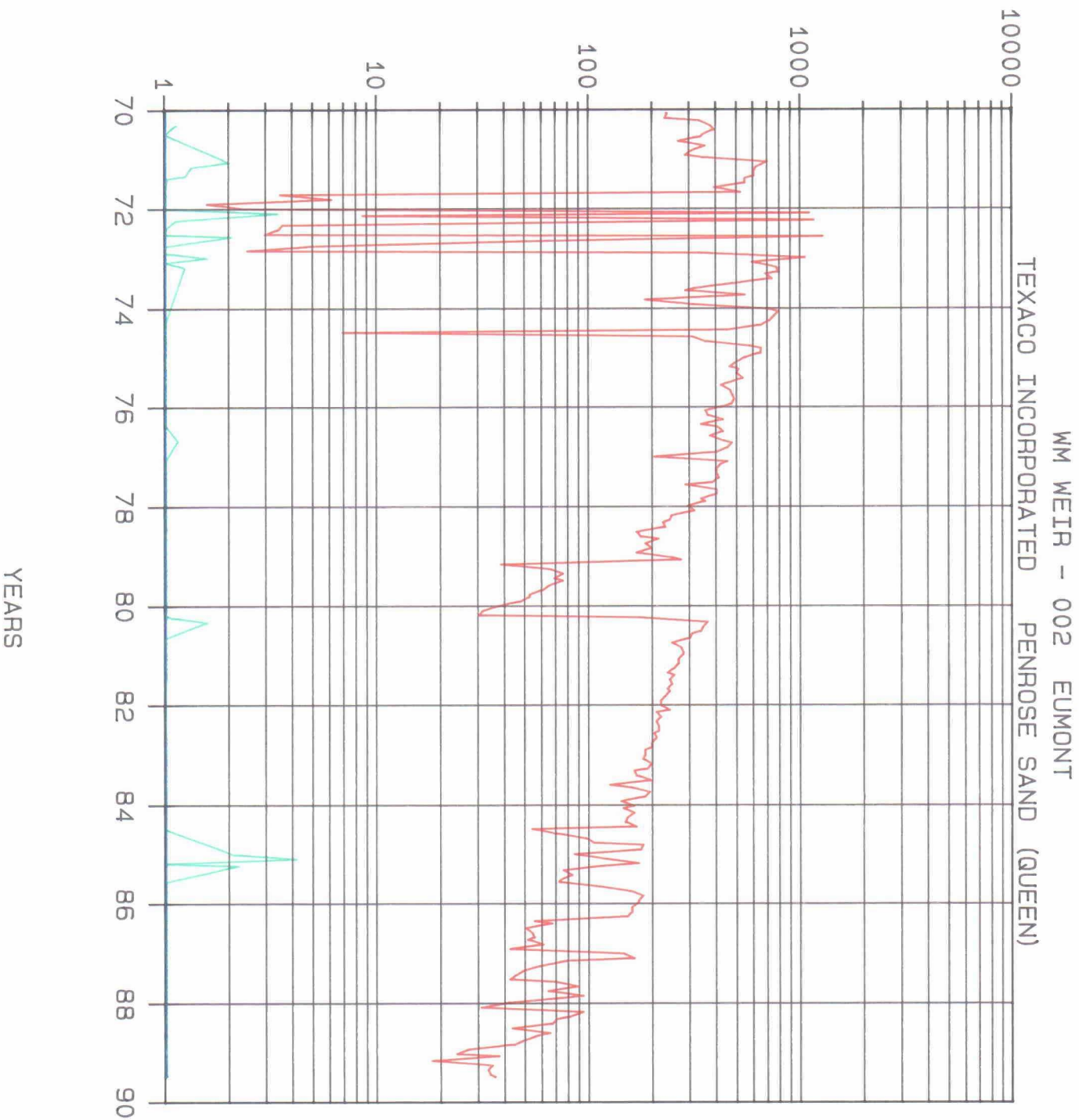

LEASE DATA  
LSE 881750  
FLD 19800  
OPER 833000  
ZONE QN  
19S-36E-23  
COUNTY 025  
STATE 30

STATUS  
CO 5 MBO  
CG 3246 MMCF  
BOPD 0  
BWPD 0  
MCFPD 36  
WELLS 1

**BEFORE EXAMINER CATANACH**  
**OIL CONSERVATION DIVISION**

TEXACO    EXHIBIT NO. 7

CASE NO. 9834

BEFORE THE  
OIL CONSERVATION DIVISION

NEW MEXICO DEPARTMENT OF ENERGY, MINERALS AND NATURAL RESOURCES

IN THE MATTER OF THE APPLICATION OF  
TEXACO INC., FOR A NON-STANDARD  
GAS PRORATION UNIT, TWO UNORTHODOX GAS  
WELL LOCATIONS AND SIMULTANEOUS  
DEDICATION, LEA COUNTY, NEW MEXICO.

CASE NO. 9834

AFFIDAVIT

STATE OF NEW MEXICO     )  
  ) ss.  
COUNTY OF SANTA FE     )

WILLIAM F. CARR, attorney in fact and authorized representative of Texaco Inc., the Applicant herein, being first duly sworn, upon oath, states that the notice provisions of Rule 1207 of the New Mexico Oil Conservation Division have been complied with, that Applicant has caused to be conducted a good faith diligent effort to find the correct addresses of all interested persons entitled to receive notice as shown by Exhibit "A" attached hereto, and that pursuant to Rule 1207, notice has been given at the correct addresses provided by such rule.

  
WILLIAM F. CARR

SUBSCRIBED AND SWORN to before me this 12<sup>th</sup> day of December, 1989.

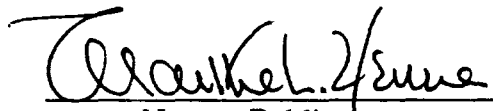
  
Notary Public

My Commission Expires:

August 19, 1991

BEFORE EXAMINER CATANACH	
OIL CONSERVATION DIVISION	
TEXACO	EXHIBIT NO. 8
CASE NO.	9834

**EXHIBIT A**

Conoco Inc.  
Post Office Box 460  
Hobbs, New Mexico 88240

ORYX Energy Company  
Post Office Box 1861  
Midland, Texas 79702

Chevron U.S.A.  
Post Office Box 670  
Hobbs, New Mexico 88240

Amerada Hess Corporation  
Post Office Box 840  
Seminole, Texas 79360

**CAMPBELL & BLACK. P.A.**  
**LAWYERS**

JACK M. CAMPBELL  
BRUCE D. BLACK  
MICHAEL B. CAMPBELL  
WILLIAM F. CARR  
BRADFORD C. BERGE  
MARK F. SHERIDAN  
J. SCOTT HALL  
JOHN H. BENIS  
WILLIAM P. SLATTERY  
PATRICIA A. MATTHEWS

JEFFERSON PLACE  
SUITE 1 - 110 NORTH GUADALUPE  
POST OFFICE BOX 2208  
SANTA FE, NEW MEXICO 87504-2208  
TELEPHONE: (505) 988-4421  
TELECOPIER: (505) 983-6043

November 7, 1989

**CERTIFIED MAIL**  
**RETURN RECEIPT REQUESTED**

Conoco Inc.  
Post Office Box 460  
Hobbs, New Mexico 88240

Re: Application of Texaco Inc. for a Non-Standard Gas Proration Unit,  
Unorthodox Gas Well Locations and Simultaneous Dedication, Lea County,  
New Mexico

Gentlemen:

This letter is to advise you that Texaco Inc. has filed an application with the New Mexico Oil Conservation Division seeking approval of a 320-acre non-standard gas proration unit consisting of the E/2 SE/4, SW/4 SE/4, SE/4 SW/4 of Section 23; W/2 NW/4 of Section 25 and the E/2 NE/4 of Section 26 all in Township 19 South, Range 36 East, N.M.P.M., Lea County, New Mexico. Texaco Inc. also seeks approval of the unorthodox gas well locations for its William Weir Well No. 1 located 1980 feet from the North line and 660 feet from the West line of Section 25 and its William Weir Well No. 2 located 660 feet from the South line and 1980 feet from the West line of said Section 23. Texaco Inc. proposes to simultaneously dedicate these wells to the above described non-standard gas proration unit.

This application has been set for hearing before a Oil Conservation Division Examiner on November 29, 1989. You are not required to attend this hearing, but as an operator who has an interest that may be affected by this application you may appear and present testimony. Failure to appear at that time and become a party of record will preclude you from challenging the matter at a later date.

Very truly yours,

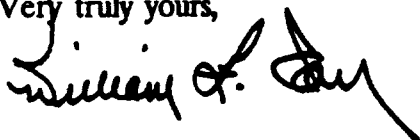

WILLIAM F. CARR  
ATTORNEY FOR TEXACO INC.  
WFC:mlh  
cc: Mr. Robert Hart  
Texaco Inc.

P-106 676 794

RECEIPT FOR CERTIFIED MAIL

NO INSURANCE COVERAGE PROVIDED  
NOT FOR INTERNATIONAL MAIL  
(See Reverse)

Sent to <b>Conoco Inc.</b>	
Street and No <b>Post Office Box 460</b>	
P.O. State and ZIP Code <b>Hobbs, NM 88240</b>	
Postage	\$
Certified Fee	
Special Delivery Fee	
Restricted Delivery Fee	
Return Receipt showing to whom and Date Delivered	
Return Receipt showing to whom, Date, and Address of Delivery	
TOTAL Postage and Fees	\$ 2.00
Postmark or Date <b>NOV 7 - 1989</b>	

PS Form 3800, June 1985

PS Form 3811, Mar. 1988 \* U.S.G.P.O. 1988-212-885 DOMESTIC RETURN RECEIPT

1. Addressee - Address  
**Conoco Inc.  
Post Office Box 460  
Hobbs, New Mexico 88240**

2. Recipient's Address for Return Receipt  
**Conoco Inc.  
Post Office Box 460  
Hobbs, New Mexico 88240**

3. Return Receipt showing to whom and Date Delivered

4. Return Receipt showing to whom, Date, and Address of Delivery

5. Signature of Addressee or Agent  
*[Signature]*

6. Signature of Recipient  
*[Signature]*

7. Date of Delivery  
**11-9-89**

8. Registered Delivery  
 Registered  
 Certified  
 Registered Delivery

9. Registered Number  
**P 106 676 794**

10. Always obtain signature of addressee or agent and DATE DELIVERED.  
E. Addressee's Address (REQUIRED) required on (PS Form)

11. *not paid*

**CAMPBELL & BLACK. P.A.**  
**LAWYERS**

JACK M. CAMPBELL  
BRUCE D. BLACK  
MICHAEL B. CAMPBELL  
WILLIAM F. CARR  
BRADFORD C. BERGE  
MARK F. SHERIDAN  
J. SCOTT HALL  
JOHN H. BEMIS  
WILLIAM P. SLATTERY  
PATRICIA A. MATTHEWS

JEFFERSON PLACE  
SUITE 1 - 110 NORTH GUADALUPE  
POST OFFICE BOX 2208  
SANTA FE, NEW MEXICO 87504-2208  
TELEPHONE: (505) 988-4421  
TELECOPIER: (505) 983-6043

November 7, 1989

**CERTIFIED MAIL**  
**RETURN RECEIPT REQUESTED**

ORYX Energy Company  
Post Office Box 1861  
Midland, Texas 79702

Re: Application of Texaco Inc. for a Non-Standard Gas Proration Unit,  
Unorthodox Gas Well Locations and Simultaneous Dedication, Lea County,  
New Mexico

Gentlemen:

This letter is to advise you that Texaco Inc. has filed an application with the New Mexico Oil Conservation Division seeking approval of a 320-acre non-standard gas proration unit consisting of the E/2 SE/4, SW/4 SE/4, SE/4 SW/4 of Section 23; W/2 NW/4 of Section 25 and the E/2 NE/4 of Section 26 all in Township 19 South, Range 36 East, N.M.P.M., Lea County, New Mexico. Texaco Inc. also seeks approval of the unorthodox gas well locations for its William Weir Well No. 1 located 1980 feet from the North line and 660 feet from the West line of Section 25 and its William Weir Well No. 2 located 660 feet from the South line and 1980 feet from the West line of said Section 23. Texaco Inc. proposes to simultaneously dedicate these wells to the above described non-standard gas proration unit.

This application has been set for hearing before a Oil Conservation Division Examiner on November 29, 1989. You are not required to attend this hearing, but as an operator who has an interest that may be affected by this application you may appear and present testimony. Failure to appear at that time and become a party of record will preclude you from challenging the matter at a later date.

Very truly yours,

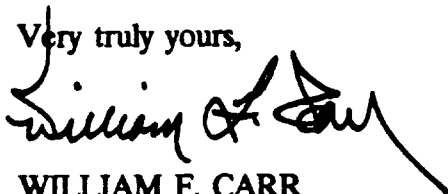

WILLIAM F. CARR  
ATTORNEY FOR TEXACO INC.

WFC:mlh

cc: Mr. Robert Hart  
Texaco Inc.



P-106 676 795

RECEIPT FOR CERTIFIED MAIL

NO INSURANCE COVERAGE PROVIDED  
NOT FOR INTERNATIONAL MAIL  
(See Reverse)

Sent to ORYX Energy Co.	
Street and No. P. O. Box 1861	
P. O. State and ZIP Code Midland, TX 79702	
Postage	\$
Certified Fee	
Special Delivery Fee	
Restricted Delivery Fee	
Return Receipt showing to whom and Date Delivered	
Return Receipt showing to whom, Date, and Address of Delivery	
TOTAL Postage and Fees	\$ 2.00
Postmark or Date NOV 7 - 1989	

PS Form 3800, June 1985

**Instructions:** Complete items 1 and 2 when additional services are desired, and complete items 3 and 4.

Put your address in the "RETURN TO" space on the reverse side. Failure to do this will prevent the mail from being returned to you. The return receipt fee will provide you the name of the person who signed the copy of delivery. For additional fee you may have the name of the addressee (see the following services) be stamped. CHECK THESE boxes and check "RETURN" for additional services requested.

1.  Show to whom delivered, date, and address of addressee. 2.  Restricted Delivery (Same day)

3. Article Addressed to:  
ORYX Energy Co.  
Post Office Box 1861  
Midland, Texas 79702

4. Article Number  
P 106 676 795

5.  Insured  
 COD  
Pay to order for Merchandise

6. Addresser's Address (ONLY if required and fee paid)  
SAME

7. Date of Delivery  
11-10-89

8. Signature - Address  
X  
X

9. Signature - Addressee  
X  
X

PS Form 3811, Mar. 1988 • U.S.G.P.O. 1988-212-885 DOMESTIC RETURN RECEIPT

**CAMPBELL & BLACK, P.A.**  
LAWYERS

JACK M. CAMPBELL  
BRUCE D. BLACK  
MICHAEL B. CAMPBELL  
WILLIAM F. CARR  
BRADFORD C. BERGE  
MARK F. SHERIDAN  
J. SCOTT HALL  
JOHN H. BEMIS  
WILLIAM P. SLATTERY  
PATRICIA A. MATTHEWS

JEFFERSON PLACE  
SUITE 1 - 110 NORTH GUADALUPE  
POST OFFICE BOX 2208  
SANTA FE, NEW MEXICO 87504-2208  
TELEPHONE: (505) 988-4421  
TELECOPIER: (505) 983-6043

November 7, 1989

**CERTIFIED MAIL**  
**RETURN RECEIPT REQUESTED**

Chevron U.S.A.  
Post Office Box 670  
Hobbs, New Mexico 88240

Re: Application of Texaco Inc. for a Non-Standard Gas Proration Unit,  
Unorthodox Gas Well Locations and Simultaneous Dedication, Lea County,  
New Mexico

Gentlemen:

This letter is to advise you that Texaco Inc. has filed an application with the New Mexico Oil Conservation Division seeking approval of a 320-acre non-standard gas proration unit consisting of the E/2 SE/4, SW/4 SE/4, SE/4 SW/4 of Section 23; W/2 NW/4 of Section 25 and the E/2 NE/4 of Section 26 all in Township 19 South, Range 36 East, N.M.P.M., Lea County, New Mexico. Texaco Inc. also seeks approval of the unorthodox gas well locations for its William Weir Well No. 1 located 1980 feet from the North line and 660 feet from the West line of Section 25 and its William Weir Well No. 2 located 660 feet from the South line and 1980 feet from the West line of said Section 23. Texaco Inc. proposes to simultaneously dedicate these wells to the above described non-standard gas proration unit.

This application has been set for hearing before a Oil Conservation Division Examiner on November 29, 1989. You are not required to attend this hearing, but as an operator who has an interest that may be affected by this application you may appear and present testimony. Failure to appear at that time and become a party of record will preclude you from challenging the matter at a later date.

Very truly yours,

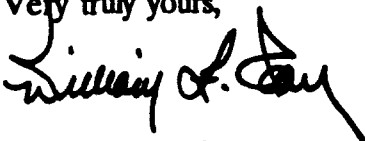

WILLIAM F. CARR  
ATTORNEY FOR TEXACO INC.  
WFC:mlh

cc: Mr. Robert Hart  
Texaco Inc.

P-106 676 793

RECEIPT FOR CERTIFIED MAIL

NO INSURANCE COVERAGE PROVIDED  
NOT FOR INTERNATIONAL MAIL  
(See Reverse)

Sent to <b>Chevron U.S.A.</b>	
Street and No <b>Post Office Box 670</b>	
P.O. State and ZIP Code <b>Hobbs, NM 88240</b>	
Postage	\$
Certified Fee	
Special Delivery Fee	
Restricted Delivery Fee	
Return Receipt showing to whom and Date Delivered	
Return Receipt showing to whom, Date, and Address of Delivery	
TOTAL Postage and Fees	\$ <b>2.00</b>
Postmark or Date <b>NOV 7 - 1989</b>	

PS Form 3800, June 1985

PS Form 3811, Mar. 1985 • U.S.G.P.O. 963-212-865 DOMESTIC RETURN RECEIPT

3 and 4. Add your address in the "RETURN TO" space on the reverse side. Failure to do this will prevent the mail from being returned to you. The return address for the sender is not required for the return receipt. The date of delivery for delivery services is required. Delivery services are provided only for delivery services for delivery services. Delivery services are provided only for delivery services. Delivery services are provided only for delivery services.

5. Addressed to: **Chevron U.S.A.**

6. Signature - Agent: *W. H. Allen*

7. Date of Delivery: *11-9-89*

8. Article Number: **P 106 676 793**

Type of Service:  
 Registered  
 Certified  
 Express Mail  
 Insured  
 COO  
 Return Receipt for Merchandise

Always obtain signature of addressee or agent and DATE DELIVERED.

9. Address of addressee ONLY required on return receipt.

*not paid*

**CAMPBELL & BLACK. P.A.**

**LAWYERS**

JACK M. CAMPBELL  
BRUCE D. BLACK  
MICHAEL B. CAMPBELL  
WILLIAM F. CARR  
BRADFORD C. BERGE  
MARK F. SHERIDAN  
J. SCOTT HALL  
JOHN H. BEMIS  
WILLIAM R. SLATTERY  
PATRICIA A. MATTHEWS

JEFFERSON PLACE  
SUITE 1 - 110 NORTH GUADALUPE  
POST OFFICE BOX 2208  
SANTA FE, NEW MEXICO 87504-2208  
TELEPHONE: (505) 968-4421  
TELECOPIER: (505) 963-8043

November 7, 1989

**CERTIFIED MAIL**  
**RETURN RECEIPT REQUESTED**

Amerada Hess Corp.  
Post Office Box 840  
Seminole, Texas 79360

Re: Application of Texaco Inc. for a Non-Standard Gas Proration Unit,  
Unorthodox Gas Well Locations and Simultaneous Dedication, Lea County,  
New Mexico

Gentlemen:

This letter is to advise you that Texaco Inc. has filed an application with the New Mexico Oil Conservation Division seeking approval of a 320-acre non-standard gas proration unit consisting of the E/2 SE/4, SW/4 SE/4, SE/4 SW/4 of Section 23; W/2 NW/4 of Section 25 and the E/2 NE/4 of Section 26 all in Township 19 South, Range 36 East, N.M.P.M., Lea County, New Mexico. Texaco Inc. also seeks approval of the unorthodox gas well locations for its William Weir Well No. 1 located 1980 feet from the North line and 660 feet from the West line of Section 25 and its William Weir Well No. 2 located 660 feet from the South line and 1980 feet from the West line of said Section 23. Texaco Inc. proposes to simultaneously dedicate these wells to the above described non-standard gas proration unit.

This application has been set for hearing before a Oil Conservation Division Examiner on November 29, 1989. You are not required to attend this hearing, but as an operator who has an interest that may be affected by this application you may appear and present testimony. Failure to appear at that time and become a party of record will preclude you from challenging the matter at a later date.

Very truly yours,

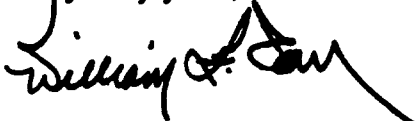

WILLIAM F. CARR  
ATTORNEY FOR TEXACO INC.  
WFC:mlh

cc: Mr. Robert Hart  
Texaco Inc.

P-106 676 792

RECEIPT FOR CERTIFIED MAIL

NO INSURANCE COVERAGE PROVIDED  
NOT FOR INTERNATIONAL MAIL

(See Reverse)

Sent to Amerada Hess Corp.	
Street and No. P. O. Box 840	
P.O. State and ZIP Code Seminole, TX 79360	
Postage	\$
Certified Fee	
Special Delivery Fee	
Restricted Delivery Fee	
Return Receipt showing to whom and Date Delivered	
Return Receipt showing to whom, Date, and Address of Delivery	
TOTAL Postage and Fees	\$ 2.00
Postmark or Date NOV 7 - 1989	

PS Form 3800, June 1985

PS Form 3811, Mar. 1988 \* U.S.A.F.O. 900-615-005 DOMESTIC RETURN RECEIPT

1. Recipient Complete items 1 and 2 when delivery services are desired, and complete item 3 when you desire in the "RETURN TO" space on the return slip, failure to do this will prevent the return from being returned to you. **RETURN TO:** For delivery to the address of the sender, check the box for "Return to Sender" for additional services requested. **2. Return to Whom:** Check the box for "Return to Whom Delivered" for additional services requested. **3. Return to Whom:** Check the box for "Return to Whom Delivered" for additional services requested. **4. Return to Whom:** Check the box for "Return to Whom Delivered" for additional services requested.

2. Recipient Addressed to:  
Amerada Hess Corp.  
P. O. Box 840  
Seminole, Texas 79360

3. Return to Whom:  
Return to Whom Delivered  (Other change)  
Return to Sender  (Other change)

4. Article Number  
P 106 676 792

5. Type of Service:  
 Registered  
 Certified  
 Registered Mail  
 Insured  
 COD  
 Return Receipt

6. Signature - Agent  
*[Signature]*

7. Date of Delivery  
11-9-89

8. Agency or Office of Post Office  
SEMINOLE TX 79360  
NOV 7 1989  
USPO

OIL CONSERVATION COMMISSION

P. O. BOX 871

SANTA FE, NEW MEXICO

BOX 2045

July 16, 1955

The Texas Company  
P. O. Box 1720  
Fort Worth 1, Texas

Attention: Mr. L. W. Folmar

RE: EUMONT GAS POOL  
PROPERTY OF THE TEXAS COMPANY  
Administrative Order NSP-165

I have examined the application dated \_\_\_\_\_  
Gentlemen:

Reference is made to your application for approval of a 160-acre non-standard gas preration unit in the Eumont Gas Pool consisting of the following acreage:

OK BFM \_\_\_\_\_ Township 19 South, Range 36 East  
OK SJS \_\_\_\_\_ E/2 SE/4, SW/4 SE/4 and SE/4 SW/4  
of Section 23

It is understood that this unit is to be ascribed to your Wm. Weir Well No. 2, located 660 feet from the South line and 1980 feet from the West line and in the SE/4 SW/4 of Section 23, Township 19 South, Range 36 East, NMPM, Lea County, New Mexico.

By authority granted me under provisions of Rule 5, Section (b)-6 of the Special Rules and Regulations for the Eumont Gas Pool, as set forth in Order R-520, you are hereby authorized to operate the above described acreage as a non-standard gas preration unit, with allowable to be assigned thereto in accordance with pool rules, based upon the unit size of 160 acres.

Very truly yours,

W. B. Macey  
Secretary-Director

WBM:jh  
cc: Oil Conservation Commission, Hobbs  
N. M. Oil & Gas Engineering Comm., Hobbs

COPY

County

Pool

TOWNSHIP		Range				NMPM	
6	5	4	3	2	1		
7	8	9	10	11	12		
18	17	16	15	14	13		
19	20	21	22	23	24		
30	29	28	27	26	25		
31	32	33	34	35	36		

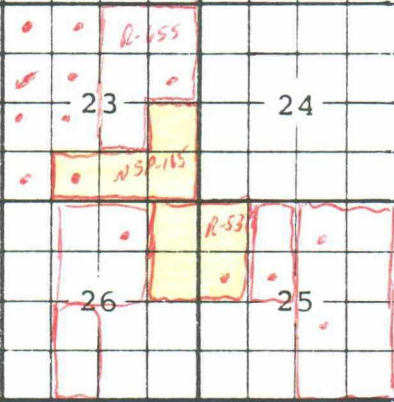

See 23

- Unit C - Chevron USA Inc. NW Eminent Unit #121: 662'FWL-1989'FWL : Oil Eminent
- Unit D - Chevron USA Inc. NW Eminent Unit #120: 660'FWL : Eminent Oil
- Unit E - Chevron USA Inc. NW Eminent Unit #123: 1880'FWL-410'FWL : Eminent Oil Inj well
- Unit F - Chevron USA Inc. NW Eminent Unit #122: 1980'FWL-1656'FWL : Eminent Oil
- \* Unit H - Chevron USA Inc. RR Bell WCT-N #1: 1980'FWL-610'FWL : Eminent Gas Comp. R-655(NSP)
- Unit K - Chevron USA Inc. NW Eminent Unit #130: 278'FWL-1650'FWL : Eminent Oil
- Unit L - Chevron USA Inc. NW Eminent Unit #129: 2310'FWL-330'FWL : Eminent Oil
- Unit M - Chevron USA Inc. NW Eminent Unit #131: 990'FWL-330'FWL : Eminent Oil
- \* Unit N - <sup>Terraco Inc.</sup> ~~Chevron USA Inc.~~ William Wier #2: 1980'FWL-160'FWL : Eminent Gas Comp. NSP-165
- Unit B - Chevron USA Inc. Graham State WCT- #9: 990'FWL-1980'FWL : Eminent Gas Comp. NSP-213
- Unit E - Terraco Inc. - William Wier #1: 660'FWL-1980'FWL : Eminent Gas Comp. R-535
- Unit F - Amerada Hess Corp. - State T #3-1980'FWL : Eminent

# ARKANSAS JUNCTION

180 State

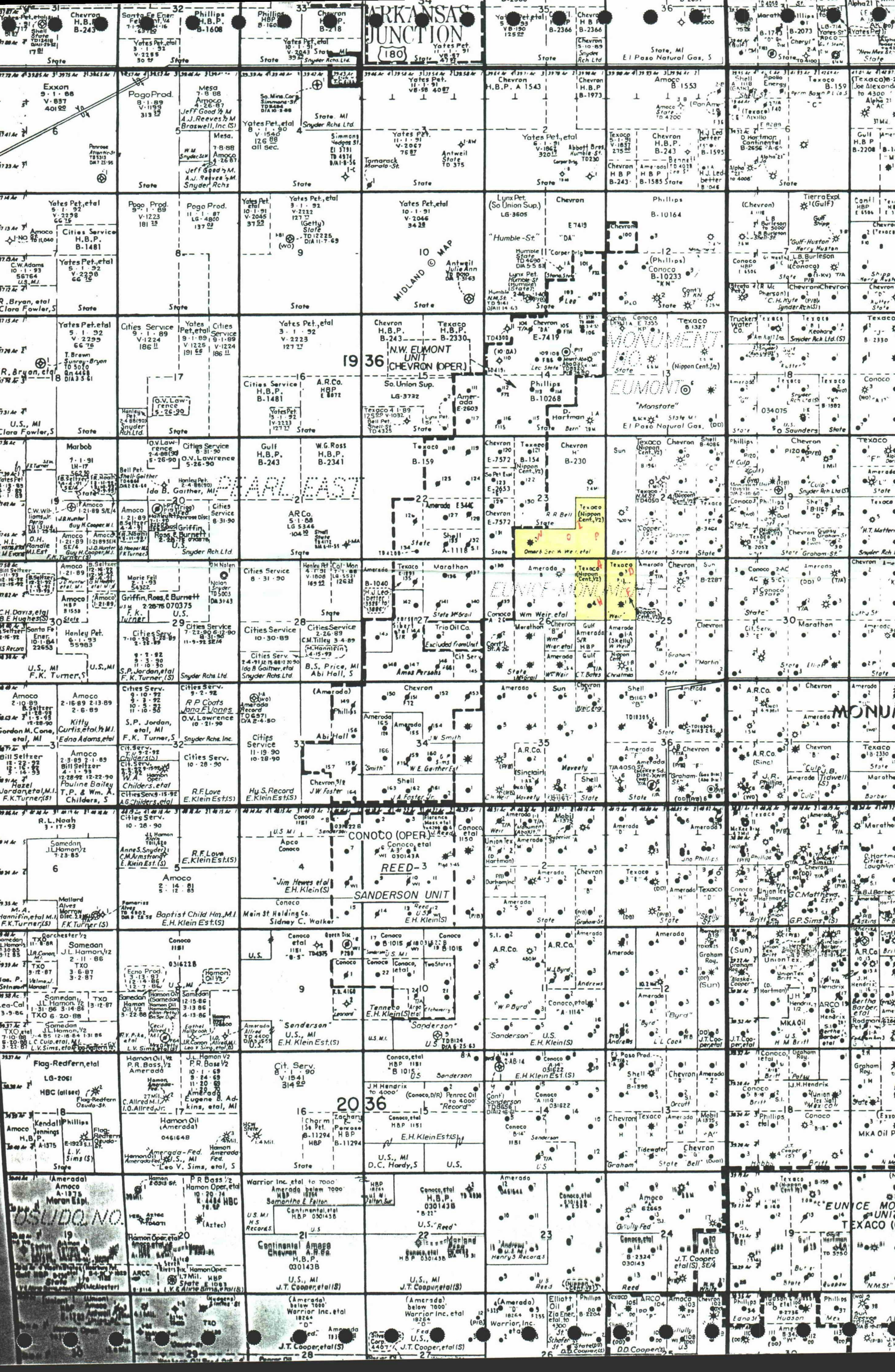

To Corland

T 19 S

T 20 S