



MIDLAND PARTNERS  
CARLTON BEAL  
CARLTON BEAL, JR.  
BARRY BEAL  
SPENCER BEAL  
KELLY BEAL

# BTA OIL PRODUCERS

104 SOUTH PECOS  
MIDLAND, TEXAS 79701  
AC 915-682-3753

ROCKY MOUNTAIN DIVISION  
555-17TH STREET  
SUITE 835  
DENVER, CO 80202  
AC 303-292-9299

DENVER PARTNER  
BARRY BEAL, JR.

March 7, 1990

RE: Application for Unorthodox Location  
Indian, 9003 JV-P  
Indian Basin (Upper Penn)  
330' FNL & 330' FEL  
Sec. 20, T22S, R23E  
Eddy County, New Mexico

9899

STATE OF NEW MEXICO  
Energy and Minerals Department  
P. O. Box 2088  
Santa Fe, New Mexico 87504-2088

Federal Express

Attn: Mr. William J. LeMay

Gentlemen:

BTA hereby requests this application, on the above referenced unorthodox location, be set for hearing on April 4, 1990.

We are this date furnishing, by certified mail, a copy of this letter, Form 3160-3 and our location plat to all offset operators on the attached list.

Please advise concerning the confirmation of the hearing date and any other information necessary before the hearing.

Sincerely,

DOROTHY HOUGHTON  
For BTA Oil Producers

DH/pdi

AC: OCD - Artesia

Attachments: Form 3160-3  
C-102  
Offset Operator List  
County Map

6 25 miles S SW

UNITED STATES  
DEPARTMENT OF THE INTERIOR  
BUREAU OF LAND MANAGEMENT

APPLICATION FOR PERMIT TO DRILL, DEEPEN, OR PLUG BACK

1a. TYPE OF WORK

DRILL ☒

DEEPEN ☐

PLUG BACK ☐

b. TYPE OF WELL

OIL  
WELL ☐

GAS  
WELL ☒

OTHER

SINGLE  
ZONE ☒

MULTIPLE  
ZONE ☐

2. NAME OF OPERATOR

BTA OIL PRODUCERS

3. ADDRESS OF OPERATOR

104 South Pecos, Midland, Texas 79701

4. LOCATION OF WELL (Report location clearly and in accordance with any State requirements.)\*

At SURFACE

330' FNL & 330' FEL

At proposed prod. zone

14. DISTANCE IN MILES AND DIRECTION FROM NEAREST TOWN OR POST OFFICE\*

32 Miles West from Carlsbad

15. DISTANCE FROM PROPOSED\*

LOCATION TO NEAREST  
PROPERTY OR LEASE LINE, FT.  
(Also to nearest drig. unit line, if any)

330'

16. NO. OF ACRES IN LEASE

640

17. NO. OF ACRES ASSIGNED  
TO THIS WELL

640

18. DISTANCE FROM PROPOSED LOCATION\*  
TO NEAREST WELL, DRILLING, COMPLETED,  
OR APPLIED FOR, ON THIS LEASE, FT.

NONE

19. PROPOSED DEPTH

7700

20. ROTARY OR CABLE TOOLS

Rotary

21. ELEVATIONS (Show whether DF, RT, GR, etc.)

4,113' GR 4,124' RT

22. APPROX. DATE WORK WILL START\*

May 1, 1990

23.

PROPOSED CASING AND CEMENTING PROGRAM

SIZE OF HOLE	SIZE OF CASING	WEIGHT PER FOOT	SETTING DEPTH	QUANTITY OF CEMENT
17 1/2"	13 3/8"	54.5# J55 STC	300'	350 sx - Circ to Surface
12 1/4"	8 5/8"	24# J55 STC	2300'	1000 sx - Circ to Surface
7 7/8"	5 1/2"	15.5&17#J55 LTC	7700'	1200 sx - Tie into 8 5/8" casing TOC ± 2000'

15. Unorthodox Location - Hearing April 4, 1990.

IN ABOVE SPACE DESCRIBE PROPOSED PROGRAM: If proposal is to deepen or plug back, give data on present productive zone and proposed new productive zone. If proposal is to drill or deepen directionally, give pertinent data on subsurface locations and measured and true vertical depths. Give blowout preventer program, if any.

24.

SIGNED

*Dorothy Houghton*  
DOROTHY HOUGHTON

TITLE Regulatory Administrator

DATE 3/7/90

(This space for Federal or State office use)

PERMIT NO. \_\_\_\_\_

APPROVAL DATE \_\_\_\_\_

APPROVED BY \_\_\_\_\_

TITLE \_\_\_\_\_

DATE \_\_\_\_\_

CONDITIONS OF APPROVAL, IF ANY:

\*See Instructions On Reverse Side

Submit to Appropriate  
District Office  
State Lease - 4 copies  
Fee Lease - 3 copies

State of New Mexico  
Energy, Minerals and Natural Resources Department

Form C-102  
Revised 1-1-89

OIL CONSERVATION DIVISION

P.O. Box 2088  
Santa Fe, New Mexico 87504-2088

DISTRICT I  
P.O. Box 1980, Hobbs, NM 88240

DISTRICT II  
P.O. Drawer DD, Artesia, NM 88210

DISTRICT III  
1000 Rio Brazos Rd., Aztec, NM 87410

WELL LOCATION AND ACREAGE DEDICATION PLAT

All Distances must be from the outer boundaries of the section

Operator BTA OIL PRODUCERS			Lease 9003 JV-P INDIAN		Well No. 1
Unit Letter "A"	Section 20	Township -22-S	Range -23-E	County NMPM	EDDY

Actual Footage Location of Well:

330	feet from the	NORTH	line and	330	feet from the	EAST	line
Ground level Elev. 4113	Producing Formation UPPER PENN		Pool INDIAN BASIN		Dedicated Acreage: 640		Acres

1. Outline the acreage dedicated to the subject well by colored pencil or hachure marks on the plat below.

2. If more than one lease is dedicated to the well, outline each and identify the ownership thereof (both as to working interest and royalty).

N/2 - Farmout Chevron; S/2 - Farmout Mobil - All Federal Royalty

3. If more than one lease of different ownership is dedicated to the well, have the interest of all owners been consolidated by communitization, unitization, force-pooling, etc.?

☒ Yes ☐ No If answer is "yes" type of consolidation Communitization

If answer is "no" list the owners and tract descriptions which have actually been consolidated. (Use reverse side of this form if necessary.)

No allowable will be assigned to the well until all interests have been consolidated (by communitization, unitization, forced-pooling, or otherwise) or until a non-standard unit, eliminating such interest, has been approved by the Division.

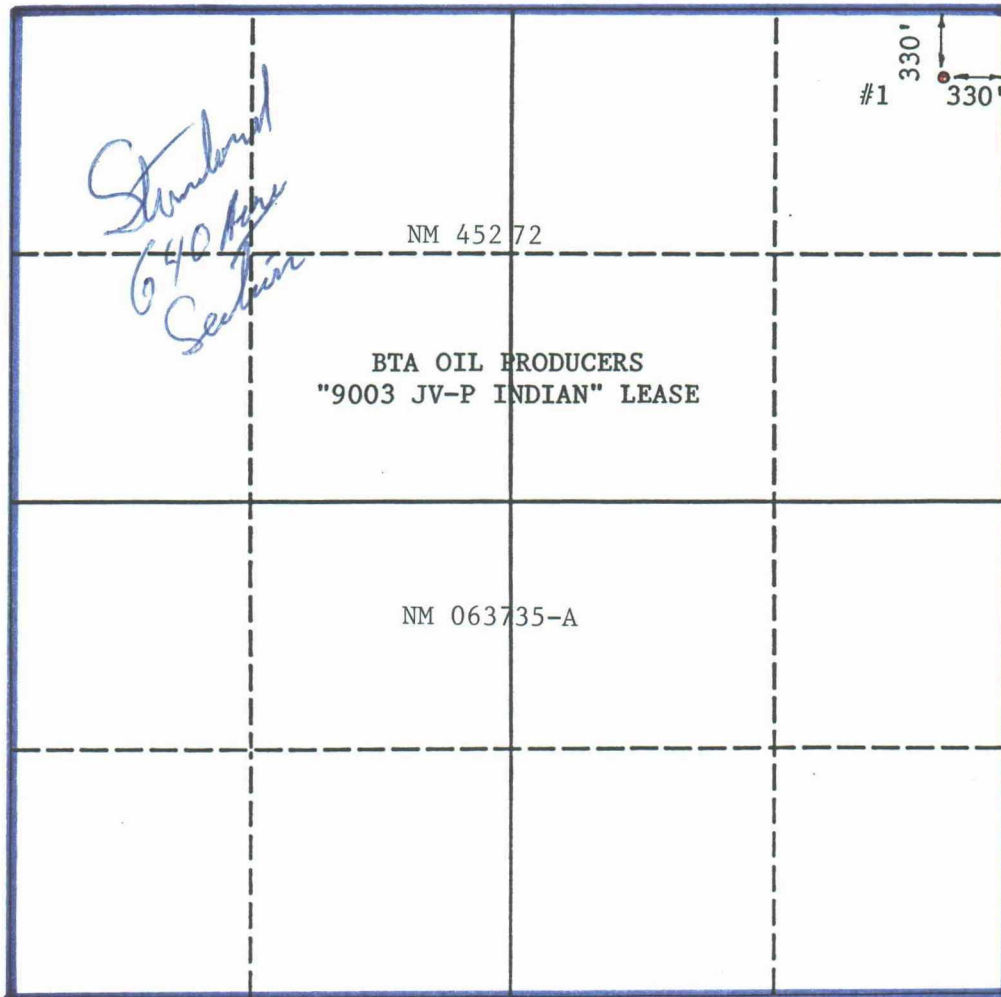

OPERATOR CERTIFICATION

I hereby certify that the information contained herein in true and complete to the best of my knowledge and belief.

Signature *Dorothy Houghton*

Printed Name DOROTHY HOUGHTON

Position Regulatory Administrator

Company BTA OIL PRODUCERS

Date 3/7/90

SURVEYOR CERTIFICATION

I hereby certify that the well location shown on this plat was plotted from field notes of actual surveys made by me or under my supervision, and that the same is true and correct to the best of my knowledge and belief.

Date Surveyed MARCH 6, 1990

Signature & Seal of Professional Surveyor *Max A. Schumann, Jr.*

MAX A. SCHUMANN, JR.

Certificate No. 1510

0 330 660 990 1320 1650 1980 2310 2640 2000 1500 1000 500 0

# BTA OIL PRODUCERS

## Offset Operators

Indian, 9003 JV-P  
Well No. 1  
Sec. 20, T-22-S, R-23-E  
Eddy County, NM

Oryx Energy Company P. O. Box 2880 Dallas, Texas 75221	S/2, Sec. 17
Chevron, U.S.A., Inc. P. O. Box 1150 Midland, Texas 79702	SW/4, Sec. 16 (50%)
Marathon Oil Company P. O. Box 552 Midland, Texas 79702	SW/4, Sec. 16 (50%)
Amax Oil & Gas, Inc. P. O. Box 42806 Houston, Texas 77042	Sec. 21
Southwestern Nat'l Gas Inc. 400 Petroleum Commerce Bldg. San Antonio, Texas 78205	Sec. 21
Kaneb Operating Company P. O. Box 4502 Houston, Texas 77210	Sec. 21
F. L. Shogrin 10100 N. 65th Street Longmont, Colorado 80501	Sec. 21
S. P. Yates 207 South 4th Street Artesia, NM 88210	NW/4, Sec. 28
Mobil Exploration & Producing U.S., Inc. P. O. Box 633 Midland, Texas 79702	N/2, Sec. 29
Joan Chorney 555 17th St., Suite 1000 Denver, Colorado 80240	NE/4, Sec. 30 SE/4, Sec. 19
Yates Petroleum Corporation 105 South 4th Street Artesia, NM 88210	NE/4, Sec. 19 SE/SE, Sec. 18





UNITED STATES  
DEPARTMENT OF THE INTERIOR  
BUREAU OF LAND MANAGEMENT

APPLICATION FOR PERMIT TO DRILL, DEEPEN, OR PLUG BACK

1a. TYPE OF WORK

DRILL ☒

DEEPEN ☐

PLUG BACK ☐

b. TYPE OF WELL

OIL  
WELL ☐

GAS  
WELL ☒

OTHER

SINGLE  
ZONE ☒

MULTIPLE  
ZONE ☐

2. NAME OF OPERATOR

BTA OIL PRODUCERS

3. ADDRESS OF OPERATOR

104 South Pecos, Midland, Texas 79701

4. LOCATION OF WELL (Report location clearly and in accordance with any State requirements.\*)

At surface

330' FNL & 330' FEL

At proposed prod. zone

14. DISTANCE IN MILES AND DIRECTION FROM NEAREST TOWN OR POST OFFICE\*

32 Miles West from Carlsbad

15. DISTANCE FROM PROPOSED\*

LOCATION TO NEAREST  
PROPERTY OR LEASE LINE, FT.  
(Also to nearest drlg. unit line, if any)

330'

16. NO. OF ACRES IN LEASE

640

17. NO. OF ACRES ASSIGNED  
TO THIS WELL

640

18. DISTANCE FROM PROPOSED LOCATION\*

TO NEAREST WELL, DRILLING, COMPLETED,  
OR APPLIED FOR, ON THIS LEASE, FT.

NONE

19. PROPOSED DEPTH

7700

20. ROTARY OR CABLE TOOLS

Rotary

21. ELEVATIONS (Show whether DF, RT, GR, etc.)

4,113' GR 4,124' RT

22. APPROX. DATE WORK WILL START\*

May 1, 1990

23.

PROPOSED CASING AND CEMENTING PROGRAM

SIZE OF HOLE	SIZE OF CASING	WEIGHT PER FOOT	SETTING DEPTH	QUANTITY OF CEMENT
17 1/2"	13 3/8"	54.5# J55 STC	300'	350 sx - Circ to Surface
12 1/4"	8 5/8"	24# J55 STC	2300'	1000 sx - Circ to Surface
7 7/8"	5 1/2"	15.5&17#J55 LTC	7700'	1200 sx - Tie into 8 5/8" casing TOC ± 2000'

15. Unorthodox Location - Hearing April 4, 1990.

IN ABOVE SPACE DESCRIBE PROPOSED PROGRAM: If proposal is to deepen or plug back, give data on present productive zone and proposed new productive zone. If proposal is to drill or deepen directionally, give pertinent data on subsurface locations and measured and true vertical depths. Give blowout preventer program, if any.

24.

SIGNED

*Dorothy Houghton*  
DOROTHY HOUGHTON

TITLE Regulatory Administrator

DATE 3/7/90

(This space for Federal or State office use)

PERMIT NO. \_\_\_\_\_

APPROVAL DATE \_\_\_\_\_

APPROVED BY \_\_\_\_\_

TITLE \_\_\_\_\_

DATE \_\_\_\_\_

CONDITIONS OF APPROVAL, IF ANY:

\*See Instructions On Reverse Side



Submit to Appropriate  
District Office  
State Lease - 4 copies  
Fee Lease - 3 copies

State of New Mexico  
Energy, Minerals and Natural Resources Department

Form C-102  
Revised 1-1-89

OIL CONSERVATION DIVISION

P.O. Box 2088  
Santa Fe, New Mexico 87504-2088

DISTRICT I  
P.O. Box 1980, Hobbs, NM 88240

DISTRICT II  
P.O. Drawer DD, Artesia, NM 88210

DISTRICT III  
1000 Rio Brazos Rd., Aztec, NM 87410

WELL LOCATION AND ACREAGE DEDICATION PLAT

All Distances must be from the outer boundaries of the section

Operator BTA OIL PRODUCERS			Lease 9003 JV-P INDIAN		Well No. 1
Unit Letter "A"	Section 20	Township -22-S	Range -23-E	County NMPM	EDDY
Actual Footage Location of Well: 330 feet from the NORTH line and 330 feet from the EAST line					
Ground level Elev. 4113	Producing Formation UPPER PENN		Pool INDIAN BASIN	Dedicated Acreage: 640 Acres	

- Outline the acreage dedicated to the subject well by colored pencil or hatchure marks on the plat below.
- If more than one lease is dedicated to the well, outline each and identify the ownership thereof (both as to working interest and royalty).  
N/2 - Farmout Chevron; S/2 - Farmout Mobil - All Federal Royalty
- If more than one lease of different ownership is dedicated to the well, have the interest of all owners been consolidated by communitization, unitization, force-pooling, etc.?

☒ Yes ☐ No If answer is "yes" type of consolidation Communitization

If answer is "no" list the owners and tract descriptions which have actually been consolidated. (Use reverse side of this form if necessary.)

No allowable will be assigned to the well until all interests have been consolidated (by communitization, unitization, forced-pooling, or otherwise) or until a non-standard unit, eliminating such interest, has been approved by the Division.

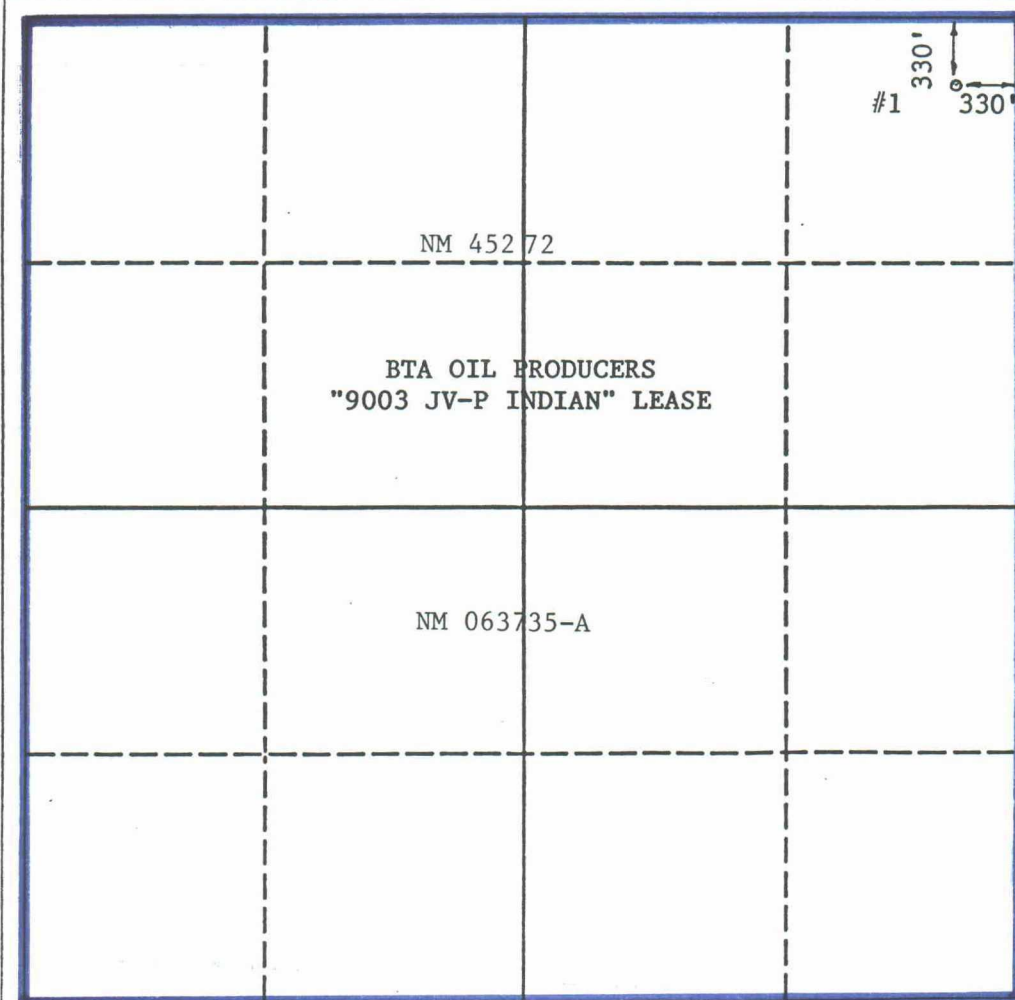

OPERATOR CERTIFICATION

I hereby certify that the information contained herein is true and complete to the best of my knowledge and belief.

*Dorothy Houghton*  
Signature

DOROTHY HOUGHTON

Printed Name

Regulatory Administrator

Position

BTA OIL PRODUCERS

Company

3/7/90

Date

SURVEYOR CERTIFICATION

I hereby certify that the well location shown on this plat was plotted from field notes of actual surveys made by me or under my supervision, and that the same is true and correct to the best of my knowledge and belief.

Date Surveyed

MARCH 6, 1990

Signature & Seal of  
Professional Surveyor

*Max A. Schumann, Jr.*

MAX A. SCHUMANN, JR.

Certificate No.

1510

0 330 660 990 1320 1650 1980 2310 2640 2000 1500 1000 500 0

BTA OIL PRODUCERS

Offset Operators

Indian, 9003 JV-P  
Well No. 1  
Sec. 20, T-22-S, R-23-E  
Eddy County, NM

Oryx Energy Company P. O. Box 2880 Dallas, Texas 75221	S/2, Sec. 17
Chevron, U.S.A., Inc. P. O. Box 1150 Midland, Texas 79702	SW/4, Sec. 16 (50%)
Marathon Oil Company P. O. Box 552 Midland, Texas 79702	SW/4, Sec. 16 (50%)
Amax Oil & Gas, Inc. P. O. Box 42806 Houston, Texas 77042	Sec. 21
Southwestern Nat'l Gas Inc. 400 Petroleum Commerce Bldg. San Antonio, Texas 78205	Sec. 21
Kaneb Operating Company P. O. Box 4502 Houston, Texas 77210	Sec. 21
F. L. Shogrin 10100 N. 65th Street Longmont, Colorado 80501	Sec. 21
S. P. Yates 207 South 4th Street Artesia, NM 88210	NW/4, Sec. 28
Mobil Exploration & Producing U.S., Inc. P. O. Box 633 Midland, Texas 79702	N/2, Sec. 29
Joan Chorney 555 17th St., Suite 1000 Denver, Colorado 80240	NE/4, Sec. 30 SE/4, Sec. 19
Yates Petroleum Corporation 105 South 4th Street Artesia, NM 88210	NE/4, Sec. 19 SE/SE, Sec. 18



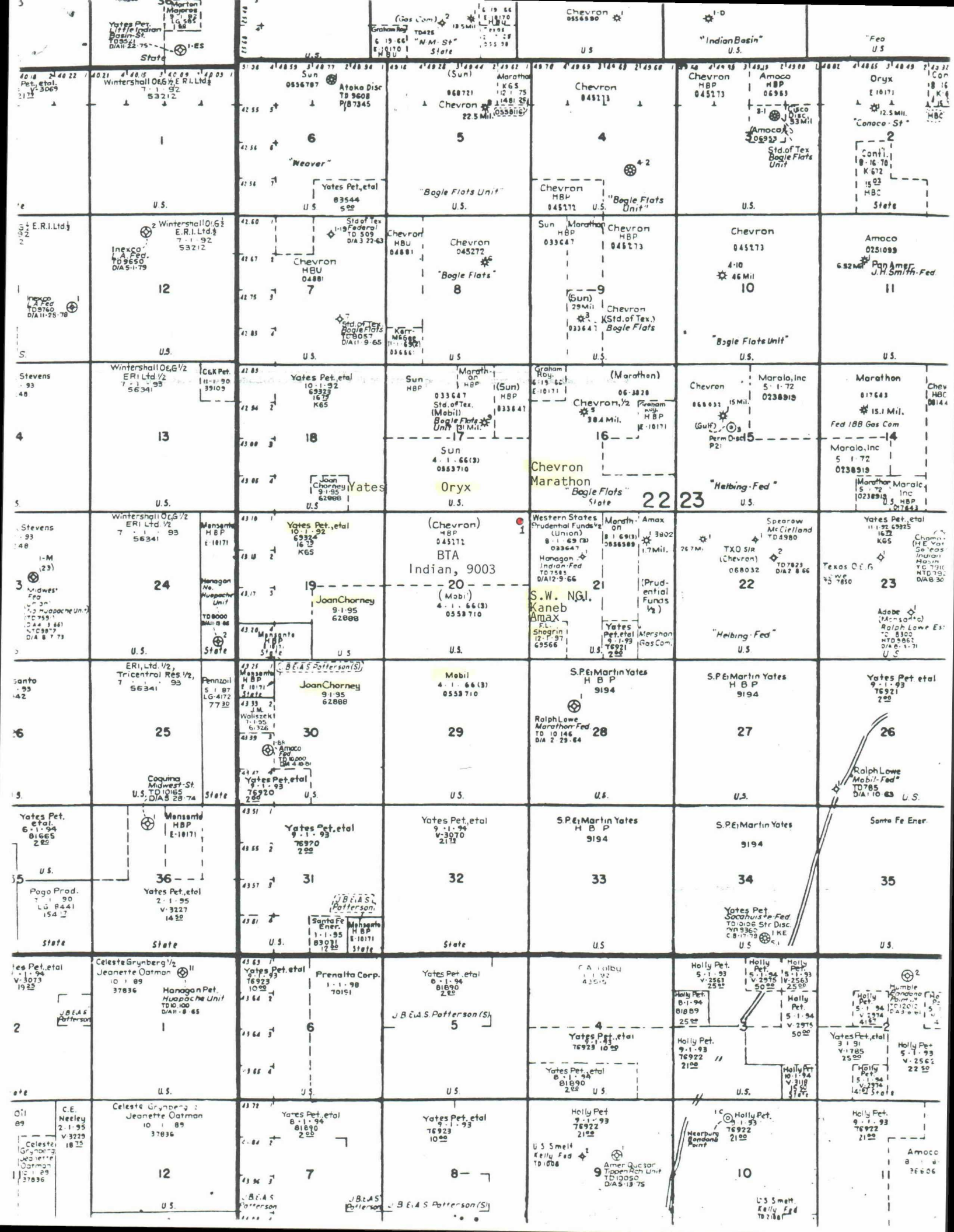

UNITED STATES  
DEPARTMENT OF THE INTERIOR  
BUREAU OF LAND MANAGEMENT

APPLICATION FOR PERMIT TO DRILL, DEEPEN, OR PLUG BACK

1A. TYPE OF WORK

DRILL ☒

DEEPEN ☐

PLUG BACK ☐

B. TYPE OF WELL

OIL  
WELL ☐

GAS  
WELL ☒

OTHER

SINGLE  
ZONE ☒

MULTIPLE  
ZONE ☐

2. NAME OF OPERATOR

BTA OIL PRODUCERS

3. ADDRESS OF OPERATOR

104 South Pecos, Midland, Texas 79701

4. LOCATION OF WELL (Report location clearly and in accordance with any State requirements.)\*

At surface

330' FNL & 330' FEL

At proposed prod. zone

14. DISTANCE IN MILES AND DIRECTION FROM NEAREST TOWN OR POST OFFICE\*

32 Miles West from Carlsbad

15. DISTANCE FROM PROPOSED\*  
LOCATION TO NEAREST  
PROPERTY OR LEASE LINE, FT.

(Also to nearest drilg. unit line, if any)

330'

16. NO. OF ACRES IN LEASE

640

17. NO. OF ACRES ASSIGNED  
TO THIS WELL

640

18. DISTANCE FROM PROPOSED LOCATION\*  
TO NEAREST WELL, DRILLING, COMPLETED,  
OR APPLIED FOR, ON THIS LEASE, FT.

NONE

19. PROPOSED DEPTH

7700

20. ROTARY OR CABLE TOOLS

Rotary

21. ELEVATIONS (Show whether DF, RT, GR, etc.)

4,113' GR 4,124' RT

22. APPROX. DATE WORK WILL START\*

May 1, 1990

23.

PROPOSED CASING AND CEMENTING PROGRAM

SIZE OF HOLE	SIZE OF CASING	WEIGHT PER FOOT	SETTING DEPTH	QUANTITY OF CEMENT
17 1/2"	13 3/8"	54.5# J55 STC	300'	350 sx - Circ to Surface
12 1/4"	8 5/8"	24# J55 STC	2300'	1000 sx - Circ to Surface
7 7/8"	5 1/2"	15.5&17#J55 LTC	7700'	1200 sx - Tie into 8 5/8" casing TOC ± 2000'

15. Unorthodox Location - Hearing April 4, 1990.

IN ABOVE SPACE DESCRIBE PROPOSED PROGRAM: If proposal is to deepen or plug back, give data on present productive zone and proposed new productive zone. If proposal is to drill or deepen directionally, give pertinent data on subsurface locations and measured and true vertical depths. Give blowout preventer program, if any.

24.

SIGNED

*Dorothy Houghton*  
DOROTHY HOUGHTON

TITLE Regulatory Administrator

DATE 3/7/90

(This space for Federal or State office use)

PERMIT NO. \_\_\_\_\_

APPROVAL DATE \_\_\_\_\_

APPROVED BY \_\_\_\_\_

TITLE \_\_\_\_\_

DATE \_\_\_\_\_

CONDITIONS OF APPROVAL, IF ANY:

\*See Instructions On Reverse Side



Submit to Appropriate  
District Office  
State Lease - 4 copies  
Fee Lease - 3 copies

State of New Mexico  
Energy, Minerals and Natural Resources Department

Form C-102  
Revised 1-1-89

OIL CONSERVATION DIVISION

P.O. Box 2088  
Santa Fe, New Mexico 87504-2088

DISTRICT I  
P.O. Box 1980, Hobbs, NM 88240

DISTRICT II  
P.O. Drawer DD, Artesia, NM 88210

DISTRICT III  
1000 Rio Brazos Rd., Aztec, NM 87410

WELL LOCATION AND ACREAGE DEDICATION PLAT

All Distances must be from the outer boundaries of the section

Operator BTA OIL PRODUCERS		Lease 9003 JV-P INDIAN		Well No. 1
Unit Letter "A"	Section 20	Township -22-S	Range -23-E NMPM	County EDDY
Actual Footage Location of Well: 330 feet from the NORTH line and 330 feet from the EAST line				
Ground level Elev. 4113	Producing Formation UPPER PENN	Pool INDIAN BASIN	Dedicated Acreage: 640 Acres	

1. Outline the acreage dedicated to the subject well by colored pencil or hatchure marks on the plat below.

2. If more than one lease is dedicated to the well, outline each and identify the ownership thereof (both as to working interest and royalty).

N/2 - Farmout Chevron; S/2 - Farmout Mobil - All Federal Royalty

3. If more than one lease of different ownership is dedicated to the well, have the interest of all owners been consolidated by communitization, unitization, force-pooling, etc.?

☒ Yes ☐ No If answer is "yes" type of consolidation Communitization

If answer is "no" list the owners and tract descriptions which have actually been consolidated. (Use reverse side of this form if necessary.)

No allowable will be assigned to the well until all interests have been consolidated (by communitization, unitization, forced-pooling, or otherwise) or until a non-standard unit, eliminating such interest, has been approved by the Division.

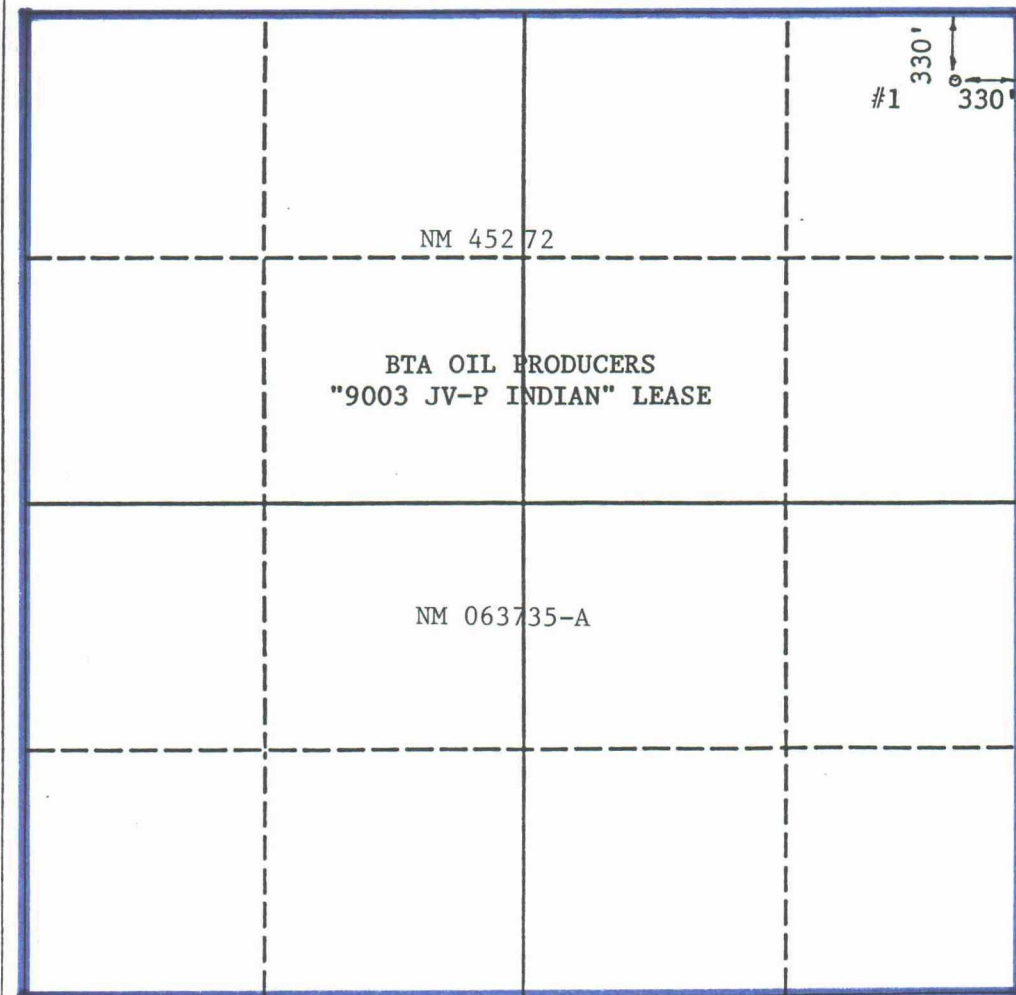

OPERATOR CERTIFICATION

I hereby certify that the information contained herein is true and complete to the best of my knowledge and belief.

*Dorothy Houghton*  
Signature

DOROTHY HOUGHTON

Printed Name

Regulatory Administrator

Position

BTA OIL PRODUCERS

Company

3/7/90

Date

SURVEYOR CERTIFICATION

I hereby certify that the well location shown on this plat was plotted from field notes of actual surveys made by me or under my supervision, and that the same is true and correct to the best of my knowledge and belief.

Date Surveyed

MARCH 6, 1990

Signature & Seal of  
Professional Surveyor

*Max A. Schumann, Jr.*

MAX A. SCHUMANN, JR.

Certificate No.

1510

0 330 660 990 1320 1650 1980 2310 2640 2000 1500 1000 500 0

BTA OIL PRODUCERS

Offset Operators

Indian, 9003 JV-P  
Well No. 1  
Sec. 20, T-22-S, R-23-E  
Eddy County, NM

Oryx Energy Company P. O. Box 2880 Dallas, Texas 75221	S/2, Sec. 17
Chevron, U.S.A., Inc. P. O. Box 1150 Midland, Texas 79702	SW/4, Sec. 16 (50%)
Marathon Oil Company P. O. Box 552 Midland, Texas 79702	SW/4, Sec. 16 (50%)
Amax Oil & Gas, Inc. P. O. Box 42806 Houston, Texas 77042	Sec. 21
Southwestern Nat'l Gas Inc. 400 Petroleum Commerce Bldg. San Antonio, Texas 78205	Sec. 21
Kaneb Operating Company P. O. Box 4502 Houston, Texas 77210	Sec. 21
F. L. Shogrin 10100 N. 65th Street Longmont, Colorado 80501	Sec. 21
S. P. Yates 207 South 4th Street Artesia, NM 88210	NW/4, Sec. 28
Mobil Exploration & Producing U.S., Inc. P. O. Box 633 Midland, Texas 79702	N/2, Sec. 29
Joan Chorney 555 17th St., Suite 1000 Denver, Colorado 80240	NE/4, Sec. 30 SE/4, Sec. 19
Yates Petroleum Corporation 105 South 4th Street Artesia, NM 88210	NE/4, Sec. 19 SE/SE, Sec. 18



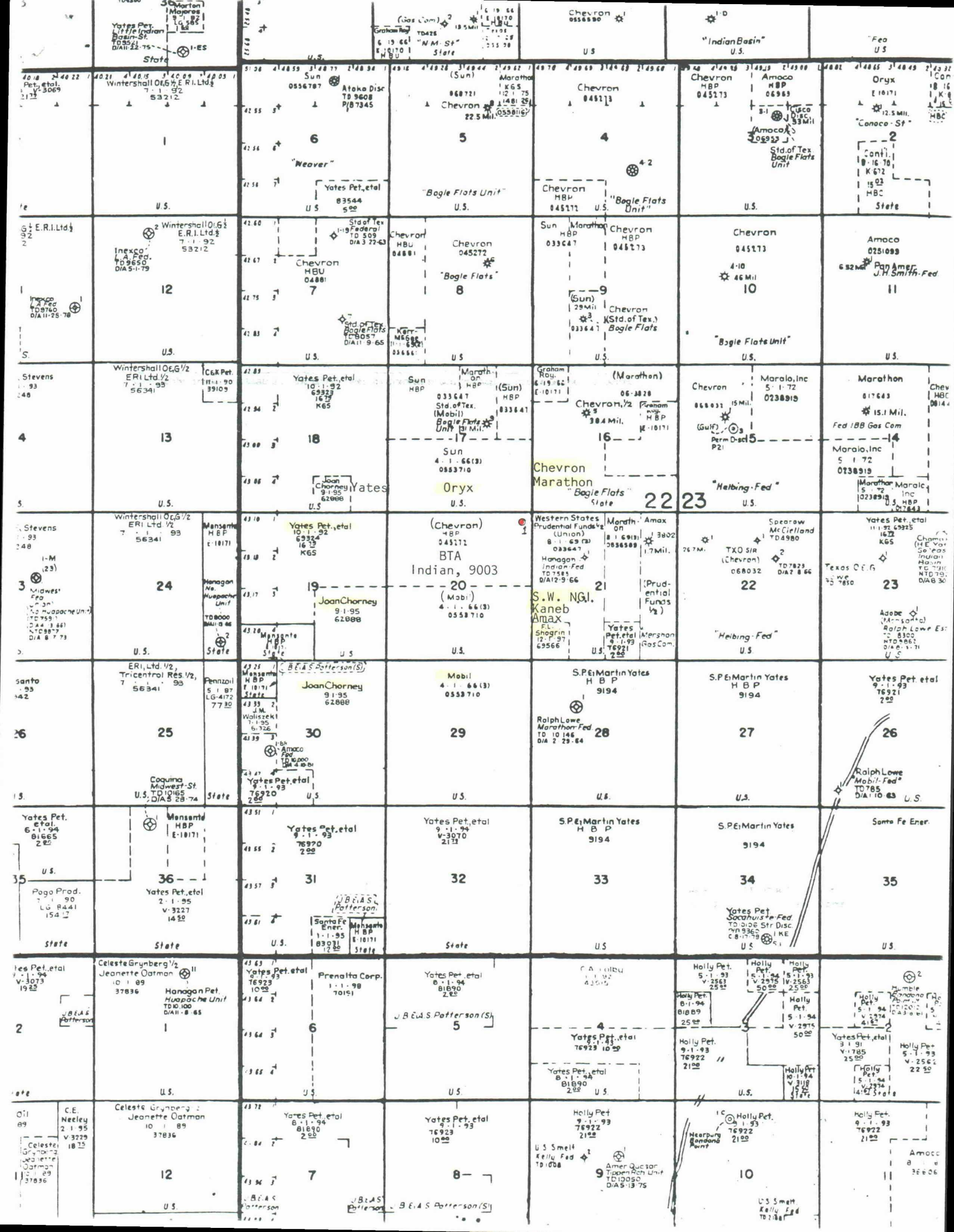



MIDLAND PARTNERS  
CARLTON BEAL  
CARLTON BEAL, JR.  
BARRY BEAL  
SPENCER BEAL  
KELLY BEAL

DENVER PARTNER  
BARRY BEAL, JR.

BTA OIL PRODUCERS  
104 SOUTH PECOS  
MIDLAND, TEXAS 79701  
AC 915-682-3753

ROCKY MOUNTAIN DIVISION  
555-17TH STREET  
SUITE 835  
DENVER, CO 80202  
AC 303-292-9299

March 7, 1990

RE: Application for Unorthodox Location  
Indian, 9003 JV-P  
Indian Basin (Upper Penn)  
330' FNL & 330' FEL  
Sec. 20, T22S, R23E  
Eddy County, New Mexico

Yates Petroleum Corporation  
105 South 4th Street  
Artesia, NM 88210

Certified Mail  
Return Receipt Requested

Gentlemen:

Attached please find a complete copy of our application filed this date with the State of New Mexico.

We have requested this application be set for hearing before a Division Examiner on April 4, 1990. You are not required to attend this hearing, but as an owner of an interest that may be affected by the unorthodox well location, you may appear and present testimony. Failure to appear at the time and become a party of record will preclude you from challenging this application at a later date.

Should you have any questions concerning this application, please call.

Sincerely,

DOROTHY HOUGHTON  
For BTA Oil Producers

DH/pdi

Attachments: Form 3160-3  
C-102  
Map



MIDLAND PARTNERS  
CARLTON BEAL  
CARLTON BEAL, JR.  
BARRY BEAL  
SPENCER BEAL  
KELLY BEAL

BTA OIL PRODUCERS  
104 SOUTH PECOS  
MIDLAND, TEXAS 79701  
AC 915-682-3753

ROCKY MOUNTAIN DIVISION  
555-17TH STREET  
SUITE 835  
DENVER, CO 80202  
AC 303-292-9299

DENVER PARTNER  
BARRY BEAL, JR.

March 7, 1990

RE: Application for Unorthodox Location  
Indian, 9003 JV-P  
Indian Basin (Upper Penn)  
330' FNL & 330' FEL  
Sec. 20, T22S, R23E  
Eddy County, New Mexico

Joan Chorney  
555 17th St., Suite 1000  
Denver, Colorado 80240

Certified Mail  
Return Receipt Requested

Gentlemen:

Attached please find a complete copy of our application filed this date with the State of New Mexico.

We have requested this application be set for hearing before a Division Examiner on April 4, 1990. You are not required to attend this hearing, but as an owner of an interest that may be affected by the unorthodox well location, you may appear and present testimony. Failure to appear at the time and become a party of record will preclude you from challenging this application at a later date.

Should you have any questions concerning this application, please call.

Sincerely,

DOROTHY HOUGHTON  
For BTA Oil Producers

DH/pdi

Attachments: Form 3160-3  
C-102  
Map



MIDLAND PARTNERS  
CARLTON BEAL  
CARLTON BEAL, JR.  
BARRY BEAL  
SPENCER BEAL  
KELLY BEAL

DENVER PARTNER  
BARRY BEAL, JR.

BTA OIL PRODUCERS  
104 SOUTH PECOS  
MIDLAND, TEXAS 79701  
AC 915-682-3753

ROCKY MOUNTAIN DIVISION  
555-17TH STREET  
SUITE 835  
DENVER, CO 80202  
AC 303-292-9299

March 7, 1990

RE: Application for Unorthodox Location  
Indian, 9003 JV-P  
Indian Basin (Upper Penn)  
330' FNL & 330' FEL  
Sec. 20, T22S, R23E  
Eddy County, New Mexico

9899

Mobil Exploration  
& Producing U.S., Inc.  
P. O. Box 633  
Midland, Texas 79702

Certified Mail  
Return Receipt Requested

Gentlemen:

Attached please find a complete copy of our application filed this date with the State of New Mexico.

We have requested this application be set for hearing before a Division Examiner on April 4, 1990. You are not required to attend this hearing, but as an owner of an interest that may be affected by the unorthodox well location, you may appear and present testimony. Failure to appear at the time and become a party of record will preclude you from challenging this application at a later date.

Should you have any questions concerning this application, please call.

Sincerely,

DOROTHY HOUGHTON  
For BTA Oil Producers

DH/pdi

Attachments: Form 3160-3  
C-102  
Map





MIDLAND PARTNERS  
CARLTON BEAL  
CARLTON BEAL, JR.  
BARRY BEAL  
SPENCER BEAL  
KELLY BEAL

DENVER PARTNER  
BARRY BEAL, JR.

BTA OIL PRODUCERS  
104 SOUTH PECOS  
MIDLAND, TEXAS 79701  
AC 915-682-3753

ROCKY MOUNTAIN DIVISION  
555-17TH STREET  
SUITE 835  
DENVER, CO 80202  
AC 303-292-9299

March 7, 1990

RE: Application for Unorthodox Location  
Indian, 9003 JV-P  
Indian Basin (Upper Penn)  
330' FNL & 330' FEL  
Sec. 20, T22S, R23E  
Eddy County, New Mexico

S. P. Yates  
207 South 4th Street  
Artesia, NM 88210

Certified Mail  
Return Receipt Requested

Gentlemen:

Attached please find a complete copy of our application filed this date with the State of New Mexico.

We have requested this application be set for hearing before a Division Examiner on April 4, 1990. You are not required to attend this hearing, but as an owner of an interest that may be affected by the unorthodox well location, you may appear and present testimony. Failure to appear at the time and become a party of record will preclude you from challenging this application at a later date.

Should you have any questions concerning this application, please call.

Sincerely,

DOROTHY HOUGHTON  
For BTA Oil Producers

DH/pdi

Attachments: Form 3160-3  
C-102  
Map



MIDLAND PARTNERS  
CARLTON BEAL  
CARLTON BEAL, JR.  
BARRY BEAL  
SPENCER BEAL  
KELLY BEAL

DENVER PARTNER  
BARRY BEAL, JR.

BTA OIL PRODUCERS  
104 SOUTH PECOS  
MIDLAND, TEXAS 79701  
AC 915-682-3753

ROCKY MOUNTAIN DIVISION  
555-17TH STREET  
SUITE 835  
DENVER, CO 80202  
AC 303-292-9299

March 7, 1990

RE: Application for Unorthodox Location  
Indian, 9003 JV-P  
Indian Basin (Upper Penn)  
330' FNL & 330' FEL  
Sec. 20, T22S, R23E  
Eddy County, New Mexico

F. L. Shogrin  
10100 N. 65th Street  
Longmont, CO 80501

Certified Mail  
Return Receipt Requested

Gentlemen:

Attached please find a complete copy of our application filed this date with the State of New Mexico.

We have requested this application be set for hearing before a Division Examiner on April 4, 1990. You are not required to attend this hearing, but as an owner of an interest that may be affected by the unorthodox well location, you may appear and present testimony. Failure to appear at the time and become a party of record will preclude you from challenging this application at a later date.

Should you have any questions concerning this application, please call.

Sincerely,

DOROTHY HOUGHTON  
For BTA Oil Producers

DH/pdi

Attachments: Form 3160-3  
C-102  
Map



MIDLAND PARTNERS  
CARLTON BEAL  
CARLTON BEAL, JR.  
BARRY BEAL  
SPENCER BEAL  
KELLY BEAL

DENVER PARTNER  
BARRY BEAL, JR.

BTA OIL PRODUCERS  
104 SOUTH PECOS  
MIDLAND, TEXAS 79701  
AC 915-682-3753

ROCKY MOUNTAIN DIVISION  
555-17TH STREET  
SUITE 835  
DENVER, CO 80202  
AC 303-292-9299

March 7, 1990

RE: Application for Unorthodox Location  
Indian, 9003 JV-P  
Indian Basin (Upper Penn)  
330' FNL & 330' FEL  
Sec. 20, T22S, R23E  
Eddy County, New Mexico

Kaneb Operating Company  
P. O. Box 4502  
Houston, Texas 77210

Certified Mail  
Return Receipt Requested

Gentlemen:

Attached please find a complete copy of our application filed this date with the State of New Mexico.

We have requested this application be set for hearing before a Division Examiner on April 4, 1990. You are not required to attend this hearing, but as an owner of an interest that may be affected by the unorthodox well location, you may appear and present testimony. Failure to appear at the time and become a party of record will preclude you from challenging this application at a later date.

Should you have any questions concerning this application, please call.

Sincerely,

DOROTHY HOUGHTON  
For BTA Oil Producers

DH/pdi

Attachments: Form 3160-3  
C-102  
Map



MIDLAND PARTNERS  
CARLTON BEAL  
CARLTON BEAL, JR.  
BARRY BEAL  
SPENCER BEAL  
KELLY BEAL

DENVER PARTNER  
BARRY BEAL, JR.

BTA OIL PRODUCERS  
104 SOUTH PECOS  
MIDLAND, TEXAS 79701  
AC 915-682-3753

ROCKY MOUNTAIN DIVISION  
555-17TH STREET  
SUITE 835  
DENVER, CO 80202  
AC 303-292-9299

March 7, 1990

RE: Application for Unorthodox Location  
Indian, 9003 JV-P  
Indian Basin (Upper Penn)  
330' FNL & 330' FEL  
Sec. 20, T22S, R23E  
Eddy County, New Mexico

Southwestern National Gas Inc.  
400 Petroleum Commerce Bldg.  
San Antonio, Texas 78205

Certified Mail  
Return Receipt Requested

Gentlemen:

Attached please find a complete copy of our application filed this date with the State of New Mexico.

We have requested this application be set for hearing before a Division Examiner on April 4, 1990. You are not required to attend this hearing, but as an owner of an interest that may be affected by the unorthodox well location, you may appear and present testimony. Failure to appear at the time and become a party of record will preclude you from challenging this application at a later date.

Should you have any questions concerning this application, please call.

Sincerely,

DOROTHY HOUGHTON  
For BTA Oil Producers

DH/pdi

Attachments: Form 3160-3  
C-102  
Map





MIDLAND PARTNERS  
CARLTON BEAL  
CARLTON BEAL, JR.  
BARRY BEAL  
SPENCER BEAL  
KELLY BEAL

DENVER PARTNER  
BARRY BEAL, JR.

BTA OIL PRODUCERS  
104 SOUTH PECOS  
MIDLAND, TEXAS 79701  
AC 915-682-3753

ROCKY MOUNTAIN DIVISION  
555-17TH STREET  
SUITE 835  
DENVER, CO 80202  
AC 303-292-9299

March 7, 1990

RE: Application for Unorthodox Location  
Indian, 9003 JV-P  
Indian Basin (Upper Penn)  
330' FNL & 330' FEL  
Sec. 20, T22S, R23E  
Eddy County, New Mexico

Amax Oil & Gas, Inc.  
P. O. Box 42806  
Houston, Texas 77042

Certified Mail  
Return Receipt Requested

Gentlemen:

Attached please find a complete copy of our application filed this date with the State of New Mexico.

We have requested this application be set for hearing before a Division Examiner on April 4, 1990. You are not required to attend this hearing, but as an owner of an interest that may be affected by the unorthodox well location, you may appear and present testimony. Failure to appear at the time and become a party of record will preclude you from challenging this application at a later date.

Should you have any questions concerning this application, please call.

Sincerely,

DOROTHY HOUGHTON  
For BTA Oil Producers

DH/pdi

Attachments: Form 3160-3  
C-102  
Map



MIDLAND PARTNERS  
CARLTON BEAL  
CARLTON BEAL, JR.  
BARRY BEAL  
SPENCER BEAL  
KELLY BEAL

BTA OIL PRODUCERS  
104 SOUTH PECOS  
MIDLAND, TEXAS 79701  
AC 915-682-3753

ROCKY MOUNTAIN DIVISION  
555-17TH STREET  
SUITE 835  
DENVER, CO 80202  
AC 303-292-9299

DENVER PARTNER  
BARRY BEAL, JR.

March 7, 1990

RE: Application for Unorthodox Location  
Indian, 9003 JV-P  
Indian Basin (Upper Penn)  
330' FNL & 330' FEL  
Sec. 20, T22S, R23E  
Eddy County, New Mexico

Marathon Oil Company  
P. O. Box 552  
Midland, Texas 79702

Certified Mail  
Return Receipt Requested

Gentlemen:

Attached please find a complete copy of our application filed this date with the State of New Mexico.

We have requested this application be set for hearing before a Division Examiner on April 4, 1990. You are not required to attend this hearing, but as an owner of an interest that may be affected by the unorthodox well location, you may appear and present testimony. Failure to appear at the time and become a party of record will preclude you from challenging this application at a later date.

Should you have any questions concerning this application, please call.

Sincerely,

DOROTHY HOUGHTON  
For BTA Oil Producers

DH/pdi

Attachments: Form 3160-3  
C-102  
Map



MIDLAND PARTNERS  
CARLTON BEAL  
CARLTON BEAL, JR.  
BARRY BEAL  
SPENCER BEAL  
KELLY BEAL

DENVER PARTNER  
BARRY BEAL, JR.

BTA OIL PRODUCERS  
104 SOUTH PECOS  
MIDLAND, TEXAS 79701  
AC 915-682-3753

ROCKY MOUNTAIN DIVISION  
555-17TH STREET  
SUITE 835  
DENVER, CO 80202  
AC 303-292-9299

March 7, 1990

RE: Application for Unorthodox Location  
Indian, 9003 JV-P  
Indian Basin (Upper Penn)  
330' FNL & 330' FEL  
Sec. 20, T22S, R23E  
Eddy County, New Mexico

Chevron, U.S.A., Inc.  
P. O. Box 1150  
Midland, Texas 79702

Certified Mail  
Return Receipt Requested

Gentlemen:

Attached please find a complete copy of our application filed this date with the State of New Mexico.

We have requested this application be set for hearing before a Division Examiner on April 4, 1990. You are not required to attend this hearing, but as an owner of an interest that may be affected by the unorthodox well location, you may appear and present testimony. Failure to appear at the time and become a party of record will preclude you from challenging this application at a later date.

Should you have any questions concerning this application, please call.

Sincerely,

DOROTHY HOUGHTON  
For BTA Oil Producers

DH/pdi

Attachments: Form 3160-3  
C-192  
Map



MIDLAND PARTNERS  
CARLTON BEAL  
CARLTON BEAL, JR.  
BARRY BEAL  
SPENCER BEAL  
KELLY BEAL

DENVER PARTNER  
BARRY BEAL, JR.

BTA OIL PRODUCERS  
104 SOUTH PECOS  
MIDLAND, TEXAS 79701  
AC 915-682-3753

ROCKY MOUNTAIN DIVISION  
555-17TH STREET  
SUITE 835  
DENVER, CO 80202  
AC 303-292-9299

March 7, 1990

RE: Application for Unorthodox Location  
Indian, 9003 JV-P  
Indian Basin (Upper Penn)  
330' FNL & 330' FEL  
Sec. 20, T22S, R23E  
Eddy County, New Mexico

Oryx Energy Company  
P. O. Box 2880  
Dallas, Texas 75221

Certified Mail  
Return Receipt Requested

Gentlemen:

Attached please find a complete copy of our application filed this date with the State of New Mexico.

We have requested this application be set for hearing before a Division Examiner on April 4, 1990. You are not required to attend this hearing, but as an owner of an interest that may be affected by the unorthodox well location, you may appear and present testimony. Failure to appear at the time and become a party of record will preclude you from challenging this application at a later date.

Should you have any questions concerning this application, please call.

Sincerely,

DOROTHY HOUGHTON  
For BTA Oil Producers

DH/pdi

Attachments: Form 3160-3  
C-162  
Map