

CASE 9894: (Continued from March 21, 1990, Examiner Hearing.)

Application of Richmond Petroleum, Inc. for compulsory pooling, unorthodox coal gas well location, and a non-standard gas spacing and proration unit, San Juan and Rio Arriba Counties, New Mexico. Applicant, in the above-styled cause, seeks an order pooling all mineral interests in the Basin-Fruitland Coal Gas Pool underlying Lots 1 through 4 and the S/2 N/2 of Irregular Section 11, Township 32 North, Range 6 West, forming a non-standard 232.80-acre gas spacing and proration unit for said pool, said unit to be dedicated to a well to be drilled at a non-standard coal gas well location 1130 feet from the North line and 760 feet from the West line (Unit E) of said Section 11. Also to be considered will be the cost of drilling and completing said well and the allocation of the cost thereof as well as actual operating costs and charges for supervision, designation of applicant as operator of the well and a charge for risk involved in drilling said well. Said unit is bounded to the north by the State of Colorado for one-half mile of either side of Astronomical Monument No. 8 located on the Colorado/New Mexico stateline.

CASE 9895: (Continued from March 21, 1990, Examiner Hearing.)

Application of Richmond Petroleum, Inc. for compulsory pooling and an unorthodox coal gas well location, San Juan and Rio Arriba Counties, New Mexico. Applicant, in the above-styled cause, seeks an order pooling all mineral interests in the Basin-Fruitland Coal Gas Pool underlying the S/2 of Irregular Section 11, Township 32 North, Range 6 West, forming a standard 320-acre gas spacing and proration unit for said pool, said unit to be dedicated to a well to be drilled at a non-standard coal gas well location 1800 feet from the South line and 230 feet from the West line (Unit L) of said Section 11. Also to be considered will be the cost of drilling and completing said well and the allocation of the cost thereof as well as actual operating costs and charges for supervision, designation of applicant as operator of the well and a charge for risk involved in drilling said well. Said unit is located 1/2 mile south of Astronomical Monument No. 8 located on the Colorado/New Mexico stateline.

CASE 9902: Application of Hanson Operating Company for salt water disposal, Chaves County, New Mexico. Applicant, in the above-styled cause, seeks authority to dispose of produced salt water into the Diablo-San Andres Pool in the perforated interval from approximately 2034 feet to 2082 feet in its Hanlad "A" State Battery No. 1 Well No. 1 located 1650 feet from the South line and 330 feet from the East line (Unit I) of Section 28, Township 10 South, Range 27 East. Said well is located approximately 3/4 of a mile south-southwest of Mile Market No. 175 on U.S. Highway 380.

CASE 9882: (Continued from March 21, 1990, Examiner Hearing.)

Application of Controlled Recovery, Inc. for an oil treating plant permit, for surface waste disposal and an exception to Order No. R-3221, Lea County, New Mexico. Applicant, in the above-styled cause, seeks authority for construction and operation of the surface waste disposal facility and an oil treating plant for the purpose of treating and reclaiming sediment oil and for the collection, disposal, evaporation or storage of produced water, drilling fluids, drill cuttings, completion fluids and other oil field related waste in unlined surface pits, at a site in the S/2 N/2 and the N/2 S/2 of Section 27, Township 20 South, Range 32 East. This site is located on either side of U.S. Highway 62/180 at Mile Marker No. 66.

CASE 9903: Application of Yates Petroleum Corporation for directional drilling and an unorthodox gas well location, Eddy County, New Mexico. Applicant, in the above-styled cause, seeks authority to drill its proposed Gazelle "AHG" Federal Com. Well No. 1 at a surface location 1312 feet from the North line and 1844 feet from the West line (Unit C) of Section 15, Township 20 South, Range 29 East, wherein the applicant proposes to deviate said well to within 50 feet of the following targeted locations;

1. On the Strawn formation - 1980 feet from the South and East lines (Unit J) of said Section 15; wherein either the S/2 (320-acre unit) will be dedicated to the wellbore if the completed interval is determined to be within the East Burton Flat-Strawn Gas Pool or the NW/4 SE/4 (40-acre unit) would be dedicated if it is determined to be within the South Parkway-Strawn Pool; and,
2. In the Morrow formation - 1472 feet from the South line and 1540 feet from the East line (Unit J) of said Section 15 (which is an unorthodox gas well location), said well to be dedicated to the S/2 of said Section 15 forming a standard 320-acre gas spacing and proration unit for the Undesignated East Burton-Flat Morrow Gas Pool. Said well location is approximately 4 miles northwest of the junction of US Highway 62/180 and New Mexico State Highway 31.

CASE 9904: Application of Nassau Resources, Inc. for unorthodox coal gas well location, Rio Arriba County, New Mexico. Applicant, in the above-styled cause, seeks approval for an unorthodox coal gas well location 470 feet from the South line and 1190 feet from the East line (Unit P) of Irregular Section 12, Township 32 North, Range 4 West, to test the Basin-Fruitland Coal Gas Pool, all of said Section 12 to be dedicated to said well forming a 266.55-acre gas spacing and proration unit for said pool. Said drilling tract is located within the Carson National Forest and is bounded to the north by the State of Colorado at Mile Corner No. 229.

CASE 9905: Application of Nassau Resources, Inc. for unorthodox coal gas well location, Rio Arriba County, New Mexico. Applicant, in the above-styled cause, seeks approval for an unorthodox coal gas well location for its Carracas Unit "25-8" Well No. 3 to be drilled 920 feet from the North line and 1850 feet from the West line (Unit C) of Section 25, Township 32 North, Range 4 West, to test the Basin-Fruitland Coal Gas Pool, the N/2 of said Section 25 to be dedicated to said well forming a standard 320-acre gas spacing and proration unit for said pool. Said drilling tract is located on the Carson National Forest approximately 3 miles south of Mile Corner No. 229 located on the Colorado/New Mexico stateline.

Dockets Nos. 11-90 and 12-90 are tentatively set for April 18, 1990 and May 2, 1990. Applications for hearing must be filed at least 22 days in advance of hearing date.

**DOCKET: EXAMINER HEARING - WEDNESDAY - APRIL 4, 1990
8:15 A.M. - OIL CONSERVATION DIVISION CONFERENCE ROOM,
STATE LAND OFFICE BUILDING
SANTA FE, NEW MEXICO**

The following cases will be heard before David R. Catanach, Examiner, or Michael E. Stogner, Alternate Examiner:

- ALLOWABLE:**
- (1) Consideration of the allowable production of gas for May, 1990, from fourteen prorated gas pools in Lea, Eddy, and Chaves Counties, New Mexico.
 - (2) Consideration of the allowable production of gas for May, 1990, from four prorated gas pools in San Juan, Rio Arriba, and Sandoval Counties, New Mexico.

CASE 9899: Application of BTA Oil Producers for an unorthodox gas well location, Eddy County, New Mexico. Applicant, in the above-styled cause, seeks approval for an unorthodox gas well location 330 feet from the North and East lines (Unit A) of Section 20, Township 22 South, Range 23 East, to test the Undesignated Indian Basin-Upper Pennsylvanian Gas Pool, all of said Section 20 to be dedicated to said well forming a standard 640-acre gas spacing and proration unit for the pool. Said well location is approximately 6.25 miles south-southwest of the Marathon Oil Company Indian Basin Gas Plant.

CASE 9900: Application of Santa Fe Energy Operating Partners, L.P. for an unorthodox gas well location, Eddy County, New Mexico. Applicant, in the above-styled cause, seeks approval for an unorthodox gas well location 660 feet from the North and East lines (Unit A) of Section 10, Township 20 South, Range 24 East, to test the Undesignated Cemetery-Morrow Gas Pool, the E/2 of said Section 10 to be dedicated to said well forming a standard 320-acre gas spacing and proration unit for said pool. The proposed well site is located approximately 8 miles north of Marathon Oil Company's Indian Basin Gas Plant.

CASE 9888: (Continued from March 21, 1990, Examiner Hearing.)

Application of Conoco Inc. for compulsory pooling, Lea County, New Mexico. Applicant, in the above-styled cause, seeks an order pooling all mineral interests in the North Dagger Draw-Upper Pennsylvanian Pool underlying the SE/4 of Section 36, Township 19 South, Range 24 East, forming a standard 160-acre oil spacing and proration unit for said pool, to be dedicated to its existing Dee State Well No. 1 located at a standard oil well location 1980 feet from the South and East lines (Unit J) of said Section 36 (said well is presently completed in the Cemetery-Morrow Gas Pool). Also to be considered will be the cost of re-entering, recompleting, equipping and operating said well and the allocation of the cost thereof as well as actual operating costs and charges for supervision, designation of applicant as operator of the well and a charge for risk involved in re-entering and recompleting said well. Said unit is located approximately 13 miles west by north of Seven Rivers, New Mexico.

CASE 9893: (Continued from March 21, 1990, Examiner Hearing.)

Application of Pacific Enterprises Oil Company (USA) for compulsory pooling, Eddy County, New Mexico. Applicant, in the above-styled cause, seeks an order pooling all mineral interests in the Atoka and Morrow formations underlying the W/2 of Section 28, Township 18 South, Range 27 East, forming a standard 320-acre gas spacing and proration unit for any and all formations and/or pools developed on 320-acre spacing within said vertical extent, which presently includes but is not necessarily limited to either the Undesignated Red Lake-Pennsylvanian Gas Pool or the Undesignated Red Lake Atoka-Morrow Gas Pool. Said unit is to be dedicated to its Trigg "28" Federal Well No. 1 to be drilled at a standard gas well location 2030 feet from the North line and 1980 feet from the West line (Unit F) of said Section 28. Also to be considered will be the cost of drilling and completing said well and the allocation of the cost thereof as well as actual operating costs and charges for supervision, designation of applicant as operator of the well and a charge for risk involved in drilling said well. Said unit is approximately 4 miles west by north of Old Illinois Oil Camp.

CASE 9901: Application of Pacific Enterprises Oil Company (USA) for compulsory pooling, Eddy County, New Mexico. Applicant, in the above-styled cause, seeks an order pooling all mineral interests from the top of the Wolfcamp formation to the base of the Morrow formation underlying the W/2 of Section 21, Township 23 South, Range 26 East, forming a standard 320-acre gas spacing and proration unit for any and all formations and/or pools developed on 320-acre spacing within said vertical extent, which presently includes but is not necessarily limited to the Undesignated Frontier Hills-Strawn Gas Pool, Undesignated North Black River-Atoka Gas Pool, and Undesignated South Carlsbad-Morrow Gas Pool, said unit to be dedicated to a well to be drilled at a standard gas well location in the NW/4 of said Section 21. Also to be considered will be the cost of drilling and completing said well and the allocation of the cost thereof as well as actual operating costs and charges for supervision, designation of applicant as operator of the well and a charge for risk involved in drilling said well. Said unit is located approximately 4 miles northeast by north of the Carlsbad Municipal Airport.

CASE 9881: (Continued from March 21, 1990, Examiner Hearing.)

Application of Richmond Petroleum, Inc. for unorthodox coal gas well location, Rio Arriba County, New Mexico. Applicant, in the above-styled cause, seeks approval for an unorthodox coal gas well location for its Federal 31-4-32 Well No. 2 to be drilled 617 feet from the South line and 1939 feet from the West line (Unit M) of Section 32, Township 31 North, Range 4 West, Basin-Fruitland Coal Gas Pool, the W/2 of said Section 32 to be dedicated to said well to form a standard 320-acre gas spacing and proration unit for said pool. Said unit is located approximately 10 miles south of Mile Corner No. 233 located on the New Mexico/Colorado Stateline.

DISTRICT I
P.O. Box 1980, Hobbs, NM 88240

DISTRICT II
P.O. Drawer DD, Artesia, NM 88210

DISTRICT III
1000 Rio Brazos Rd., Aztec, NM 87410

OIL CONSERVATION DIVISION
P.O. Box 2088
Santa Fe, New Mexico 87504-2088

WELL API NO. 30-005-62341
5. Indicate Type of Lease STATE <input checked="" type="checkbox"/> FEE <input type="checkbox"/>
6. State Oil & Gas Lease No. LG-7426
7. Lease Name or Unit Agreement Name Hanlad "A" State Battery #1
8. Well No. 1
9. Pool name or Wildcat Diablo San Andres

SUNDRY NOTICES AND REPORTS ON WELLS (DO NOT USE THIS FORM FOR PROPOSALS TO DRILL OR TO DEEPEN OR PLUG BACK TO A DIFFERENT RESERVOIR. USE "APPLICATION FOR PERMIT" (FORM C-101) FOR SUCH PROPOSALS.)	
1. Type of Well: OIL WELL <input checked="" type="checkbox"/> GAS WELL <input type="checkbox"/> OTHER <input type="checkbox"/> JAN 31 '89	
2. Name of Operator Hanson Operating Company, Inc. ✓ O. C. D.	
3. Address of Operator P. O. Box 1515, Roswell, New Mexico 88202-1515	ARTESIA, OFFICE
4. Well Location Unit Letter <u>I</u> : <u>1650</u> Feet From The <u>South</u> Line and <u>330</u> Feet From The <u>East</u> Line Section <u>28</u> Township <u>10S</u> Range <u>27E</u> NMPM Chaves County	
10. Elevation (Show whether DF, RKB, RT, GR, etc.) 3836' GR	

11. Check Appropriate Box to Indicate Nature of Notice, Report, or Other Data	
NOTICE OF INTENTION TO:	SUBSEQUENT REPORT OF:
PERFORM REMEDIAL WORK <input type="checkbox"/>	REMEDIAL WORK <input checked="" type="checkbox"/>
TEMPORARILY ABANDON <input type="checkbox"/>	COMMENCE DRILLING OPNS. <input type="checkbox"/>
PULL OR ALTER CASING <input type="checkbox"/>	CASING TEST AND CEMENT JOB <input type="checkbox"/>
OTHER: <input type="checkbox"/>	OTHER: <input type="checkbox"/>

12. Describe Proposed or Completed Operations (Clearly state all pertinent details, and give pertinent dates, including estimated date of starting any proposed work) SEE RULE 1103.

Re-perforated the San Andres @ 2034, 36, 38, 40, 48, 54, 56 & 57'.
Treated with 2000 gal 15% NeFe acid.
Treated all perforations (2034-2082') with 12,000 gal MOD 202 acid.
Put well back on production.

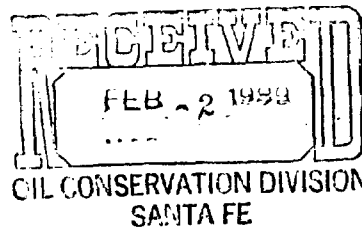

I hereby certify that the information above is true and complete to the best of my knowledge and belief.

SIGNATURE Brenda R. Godfrey TITLE Production Analyst DATE 01/30/89
TYPE OR PRINT NAME Brenda R. Godfrey TELEPHONE NO. 622-7330

(This space for State Use)

APPROVED BY Mike Williams TITLE SUPERVISOR, DISTRICT II DATE FEB 1 1989
CONDITIONS OF APPROVAL, IF ANY:

Submit 3 Copies
to Appropriate
District Office

State of New Mexico
Energy, Minerals and Natural Resources Department

Form C-103
Revised 1-1-89

DISTRICT I
P.O. Box 1980, Hobbs, NM 88240

DISTRICT II
P.O. Drawer DD, Artesia, NM 88210

DISTRICT III
1000 Rio Brazos Rd., Aztec, NM 87410

OIL CONSERVATION DIVISION
P.O. Box 2088
Santa Fe, New Mexico 87504-2088

WELL API NO. 30-005-62341
5. Indicate Type of Lease STATE <input checked="" type="checkbox"/> FEE <input type="checkbox"/>
6. State Oil & Gas Lease No. LG-7426
7. Lease Name or Unit Agreement Name Hanlad "A" State Batt #1
8. Well No. 1
9. Pool name or Wildcat Diablo San Andres

SUNDRY NOTICES AND REPORTS ON WELLS
(DO NOT USE THIS FORM FOR PROPOSALS TO DRILL OR TO DEEPEN OR PLUG BACK TO A
DIFFERENT RESERVOIR. USE APPLICATION FOR PERMIT RECEIVED
(FORM C-101) FOR SUCH PROPOSALS.)

1. Type of Well: OIL WELL <input checked="" type="checkbox"/> GAS WELL <input type="checkbox"/> OTHER <input type="checkbox"/> JAN 20 '89
2. Name of Operator Hanson Operating Company, Inc. ✓ O.C.D.
3. Address of Operator P. O. Box 1515, Roswell, New Mexico 88202-1515 ARTESIA, OFFICE
4. Well Location Unit Letter I : 1650 Feet From The South Line and 330 Feet From The East Line Section 28 Township 10S Range 27E NMPM Chaves County
10. Elevation (Show whether DF, RKB, RT, GR, etc.) 3836' GR

11. Check Appropriate Box to Indicate Nature of Notice, Report, or Other Data	
NOTICE OF INTENTION TO:	SUBSEQUENT REPORT OF:
PERFORM REMEDIAL WORK <input checked="" type="checkbox"/>	REMEDIAL WORK <input type="checkbox"/>
TEMPORARILY ABANDON <input type="checkbox"/>	ALTERING CASING <input type="checkbox"/>
PULL OR ALTER CASING <input type="checkbox"/>	COMMENCE DRILLING OPNS. <input type="checkbox"/>
OTHER: <input type="checkbox"/>	PLUG AND ABANDONMENT <input type="checkbox"/>
	CASING TEST AND CEMENT JOB <input type="checkbox"/>
	OTHER: <input type="checkbox"/>

12. Describe Proposed or Completed Operations (Clearly state all pertinent details, and give pertinent dates, including estimated date of starting any proposed work) SEE RULE 1103.

Propose to reperforate the San Andres @ 2034, 36, 38, 40, 48, 54, 56 & 57' and treat with 2000 gal 15% NeFe acid.
Treat all perforations (2034-2082') with 12000 gal MOD 202 acid.
Place well back on production.

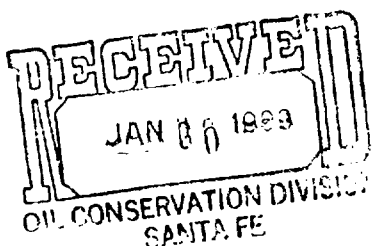

I hereby certify that the information above is true and complete to the best of my knowledge and belief.

SIGNATURE Brenda R. Godfrey TITLE Production Analyst DATE 01/19/89

TYPE OR PRINT NAME Brenda R. Godfrey TELEPHONE NO. 622-7330

(This space for State Use)

APPROVED BY Mark Williams TITLE SUPERVISOR, DISTRICT II DATE JAN 24 1989

CONDITIONS OF APPROVAL, IF ANY:

RECEIVED FOR ALL OIL AND GAS AND AUTHORIZATION TO TRANSPORT OIL AND NATURAL GAS		RECEIVED DEC 07 '88 O.C.C. ALBUQUERQUE, NEW MEXICO
OFFICE U.S.G.S. LAND OFFICE TRANSPORTER: <input type="checkbox"/> OIL <input type="checkbox"/> GAS OPERATOR PRODUCTION OFFICE		
Operator Hanson Operating Company, Inc. ✓		
Address P. O. Box 1515, Roswell, New Mexico 88202-1515		
OIL CONSERVATION DIVISION SANTA FE		
Reason(s) for filing (Check proper box) New Well <input type="checkbox"/> Change in Transporter of: Recompletion <input type="checkbox"/> Oil <input type="checkbox"/> Dry Gas <input type="checkbox"/> Change of lease name to show Change in Ownership <input type="checkbox"/> Casinghead Gas <input type="checkbox"/> Condensate <input type="checkbox"/> battery number,		

If change of ownership give name and address of previous owner _____

DESCRIPTION OF WELL AND LEASE

Lease Name Hanlad "A" State Battery #1	Well No. 1	Pool Name, including Formation Diablo San Andres	Kind of Lease State, Federal or Free State	Lease IG-7426
Location Unit Letter <u>I</u> ; <u>1650</u> Feet From The <u>South</u> Line and <u>330</u> Feet From The <u>East</u>				
Line of Section <u>28</u> Township <u>10S</u> Range <u>27E</u> , NMPL Chaves Co.				

DESIGNATION OF TRANSPORTER OF OIL AND NATURAL GAS

Name of Authorized Transporter of Oil <input checked="" type="checkbox"/> or Condensate <input type="checkbox"/> Permian	Address (Give address to which approved copy of this form is to be sent) P. O. Box 1183, Houston, Texas 77251-1183
Name of Authorized Transporter of Casinghead Gas <input type="checkbox"/> or Dry Gas <input type="checkbox"/> N/A	Address (Give address to which approved copy of this form is to be sent)
If well produces oil or liquids, give location of tanks.	Unit Sec. Twp. Rge. Is gas actually connected? When I 28 10S 27E No

If this production is commingled with that from any other lease or pool, give commingling order number _____

COMPLETION DATA

Designate Type of Completion - (X) <input type="checkbox"/> Oil Well <input type="checkbox"/> Gas Well <input type="checkbox"/> New Well <input type="checkbox"/> Workover <input type="checkbox"/> Deepen <input type="checkbox"/> Plug Back <input type="checkbox"/> Same Res't. <input type="checkbox"/> Diff. Re	
Date Spudded	Date Compl. Ready to Prod. Total Depth P.B.T.D.
Elevations (DF, RKB, RT, CR, etc.)	Name of Producing Formation Top Oil/Gas Pay Tubing Depth
Perforations	Depth Casing Shoe

TUBING, CASING, AND CEMENTING RECORD

HOLE SIZE	CASING & TUBING SIZE	DEPTH SET	SACKS CEMENT

TEST DATA AND REQUEST FOR ALLOWABLE OIL WELL

(Test must be after recovery of total volume of load oil and must be equal to or exceed top of hole for this depth or be for full 24 hours)

Date First New Oil Run To Tanks	Date of Test	Producing Method (Flow, pump, gas lift, etc.)	
Length of Test	Tubing Pressure	Casing Pressure	Choke Size
Actual Prod. During Test	Oil-Bbls.	Water-Bbls.	Gas-MCF

GAS WELL

Actual Prod. Test-MCF/D	Length of Test	Bbls. Condensate/MMCF	Gravity of Condensate
Testing Method (flow, back pr.)	Tubing Pressure (Shut-in)	Casing Pressure (Shut-in)	Choke Size

CERTIFICATE OF COMPLIANCE

I hereby certify that the rules and regulations of the Oil Conservation Commission have been complied with and that the information given above is true and complete to the best of my knowledge and belief.

Brinda R. Hodfrey
 (Signature)

Production Analyst

(Title)

12/06/88

(Date)

OIL CONSERVATION COMMISSION

APPROVED DEC 19 1988, 19

BY *Mike Williams*

TITLE SUPERVISOR, DISTRICT II

This form is to be filed in compliance with RULE 1104. If this is a request for allowable for a newly drilled or deeper well, this form must be accompanied by a tabulation of the daylight tests taken on the well in accordance with RULE 111.

All sections of this form must be filled out completely for all wells on new and recompleted wells.

Fill out only Sections I, II, III, and VI for changes of well name or number, or transporter, or other such change of condition.

SANTA FE		REQUEST FOR ALLOWABLE		E.O. 11644	
FILE		AND		Supersedes OIA C-104 and	
U.S.D.S.		AUTHORIZATION TO TRANSPORT OIL AND NATURAL GAS		Effective 1-1-85	
LAND OFFICE				RECEIVED	
TRANSPORTER				SEP 28 1987	
OPERATOR		SEP 18 '87			
PRODUCTION OFFICE		Operator			
Hanson Operating Company, Inc.		Address			
P. O. Box 1515, Roswell, New Mexico 88202-1515		D.C. ID.			
Reason(s) for filing (Check proper box)		Change in Transporter of:		Dikes (If/lease explain)	
New Well <input type="checkbox"/>		Oil <input checked="" type="checkbox"/>		Effective October 1, 1987.	
Recompletion <input type="checkbox"/>		Casinghead Gas <input type="checkbox"/>		Dry Gas <input type="checkbox"/>	
Change in Ownership <input type="checkbox"/>		Condensate <input type="checkbox"/>			

If change of ownership give name and address of previous owner

I. DESCRIPTION OF WELL AND LEASE

Lessee Name	Well No.	Pool Name, including Formation	Kind of Lease	Lease No.
Hanlad "A" State	1	Diablo San Andres	State, Federal or Fee State	LG-7426
Location				
Unit Letter	I	1650 Feet From The	South	Line and 330 Feet From The
Line of Section	28	Township	10-S	Range 27-E
			NMPA	Chaves County

II. DESIGNATION OF TRANSPORTER OF OIL AND NATURAL GAS

Name of Authorized Transporter of Oil <input checked="" type="checkbox"/> or Condensate <input type="checkbox"/>	Address (Give address to which approved copy of this form is to be sent)
Permian	P. O. Box 1183, Houston, Texas 77251-1183
Name of Authorized Transporter of Casinghead Gas <input type="checkbox"/> or Dry Gas <input type="checkbox"/>	Address (Give address to which approved copy of this form is to be sent)
N/A	
If well produces oil or liquids, give location of tanks.	Unit
	I
	28
	10S
	27E
Is gas actually connected?	When
No	

If this production is commingled with that from any other lease or pool, give commingling order number

III. COMPLETION DATA

Designate Type of Completion - (X)	Oil Well	Gas Well	New Well	Workover	Deepen	Plug Back	Same Res'v.	Dir. Res'
Date Spudded	Date Compl. Ready to Prod.	Total Depth	P.B.T.D.					
Elevations (DF, RKB, RT, CR, etc.)	Name of Producing Formation	Top Oil/Gas Pay	Tubing Depth					
Perforations	Depth Casing Shoe							

IV. TUBING, CASING, AND CEMENTING RECORD

HOLE SIZE	CASING & TUBING SIZE	DEPTH SET	SACKS CEMENT

TEST DATA AND REQUEST FOR ALLOWABLE OIL WELL

(Test must be after recovery of total volume of load oil and must be equal to or exceed top oil able for this depth or be for full 24 hours)

Date First New Oil Run To Tanks	Date of Test	Producing Method (Flow, pump, gas lift, etc.)	
Length of Test	Tubing Pressure	Casing Pressure	Choke Size
Actual Prod. During Test	Oil-Bbls.	Water-Bbls.	Gas-MCF

GAS WELL

Actual Prod. Test-MCF/D	Length of Test	Bbls. Condensate/MCF	Gravity of Condensate
Testing Method (pilot, back pr.)	Tubing Pressure (shot-in)	Casing Pressure (shot-in)	Choke Size

CERTIFICATE OF COMPLIANCE

I hereby certify that the rules and regulations of the Oil Conservation Commission have been complied with and that the information given above is true and complete to the best of my knowledge and belief.

Brenda G. Goffney
(Signature)
Production Analyst

(Title)
09/17/87

(Date)

OIL CONSERVATION COMMISSION

APPROVED *SEP 24 1987*
BY *Joe W. Clement*
TITLE **SUPERVISOR, DISTRICT 8**

This form is to be filed in compliance with RULE 1104.
If this is a request for allowable for a newly drilled or deepened well, this form must be accompanied by a tabulation of the deviated tests taken on the well in accordance with RULE 111.

All sections of this form must be filled out completely for allowable on new and recompleted wells.

Fill out only Sections I, II, III, and VI for changes of owner well name or number, or transporter, or other such change of conditions.

SANTA FE		NEW MEXICO OIL CONSERVATION COMMISSION		Form C-104 Supersedes Old C-104 and C-1 Effective 1-1-85	
FILE		REQUEST FOR ALLOWABLE AND			
U.S.G.S.		TRANSPORT OIL AND NATURAL GAS			
LAND OFFICE		AUTORECEIVED BY TRANSPORT OIL AND NATURAL GAS			
TRANSPORTER		JAN - 2 1987			
OIL		O. C. D.			
GAS		ARTESIA OFFICE			
OPERATOR		Hanson Operating Company, Inc.			
PRODUCTION OFFICE		Address			
		P. O. Box #1515, Roswell, New Mexico 88202-1515			
Reason(s) for filing (Check proper box)		Other (Please explain)			
New Well <input checked="" type="checkbox"/>		CASINGHEAD GAS MUST NOT BE			
Recompletion <input type="checkbox"/>		FLARED AFTER 3-22-87			
Change in Ownership <input type="checkbox"/>		UNLESS AN EXCEPTION TO;			
		RULE 306 IS OBTAINED			
If change of ownership give name and address of previous owner					

I. DESCRIPTION OF WELL AND LEASE

Lease Name	Well No.	Pool Name, including Formation	Kind of Lease	Lease No.
Hanlad "A" State	1	Diablo San Andres	State, Federal or Fee State	LG-7426
Location				
Unit Letter I, 1650 Feet From The South Line and 330 Feet From The East				
Line of Section 28 Township 10-S Range 27-E, NMPL, Chaves County				

DESIGNATION OF TRANSPORTER OF OIL AND NATURAL GAS

Name of Authorized Transporter of Oil <input checked="" type="checkbox"/> or Condensate <input type="checkbox"/>	Address (Give address to which approved copy of this form is to be sent)
Navajo Refining Company	P. O. Box #159, Artesia, New Mexico 88210
Name of Authorized Transporter of Casinghead Gas <input type="checkbox"/> or Dry Gas <input type="checkbox"/>	Address (Give address to which approved copy of this form is to be sent)
N/A	
If well produces oil or liquids, give location of tanks.	Unit Sec. Twp. Pgs. Is gas actually connected? When
	I 28 10S 27E N/A

If this production is commingled with that from any other lease or pool, give commingling order number:

COMPLETION DATA

Designate Type of Completion - (X)	Oil Well	Gas Well	New Well	Workover	Deepen	Plug Back	Same Resv.	Diff. Resv.
X	X		X					
Date Spudded	Date Compl. Ready to Prod.	Total Depth	P.B.T.D.					
09/25/86	12/23/86	2137'	2123'					
Elevations (DF, RKB, RT, GR, etc.)	Name of Producing Formation	Top Oil/Gas Pay	Tubing Depth					
3836' GR	San Andres	2072'	2115'					
Perforations	Depth Casing Shoe							
2072-82' (2 JSPP)	N/A							

TUBING, CASING, AND CEMENTING RECORD

HOLE SIZE	CASING & TUBING SIZE	DEPTH SET	SACKS CEMENT
12-1/4"	8-5/8"	500'	200 sx Lite, 200 sx Class
			"C", circ to surf.
8"	5-1/2"	2132'	250 sx Lite, 100 sx Class
	(Tubing - 2-3/8"	2115')	"C", 100 sx POZ "A", circ

TEST DATA AND REQUEST FOR ALLOWABLE OIL WELL

(Test must be after recovery of total volume of load oil and must be equal to or exceed top allowable for this depth or be for full 24 hours)

Date First New Oil Run To Tanks	Date of Test	Producing Method (Flow, pump, gas lift, etc.)	
12/24/86	12/26/86	Pump	
Length of Test	Tubing Pressure	Casing Pressure	Choke Size
24 hours			
Actual Prod. During Test	Oil-Bbls.	Water-Bbls.	Gas-MCF
	12	1	TSTM

GAS WELL

Actual Prod. Test-MCF/D	Length of Test	Bbls. Condensate/MCF	Gravity of Condensate
Testing Method (pilot, back pr.)	Tubing Pressure (Shut-in)	Casing Pressure (Shut-in)	Choke Size

CERTIFICATE OF COMPLIANCE

I hereby certify that the rules and regulations of the Oil Conservation Commission have been complied with and that the information given above is true and complete to the best of my knowledge and belief.

Brenda K. Godfrey
(Signature)
Production Analyst
(Title)
12/31/86
(Date)

OIL CONSERVATION COMMISSION

APPROVED JAN 21 1987
BY Joe A. Clement
TITLE SUPERVISOR, DISTRICT II

This form is to be filed in compliance with RULE 1104.
If this is a request for allowable for a newly drilled or deepened well, this form must be accompanied by a tabulation of the deviation tests taken on the well in accordance with RULE 111.
All sections of this form must be filled out completely for allowable on new and recompleted wells.
Fill out only Sections I, II, III, and VI for changes of owner, well name or number, or transporter, or other such change of condition.

NO. OF COPIES RECEIVED	
DISTRIBUTION	
SANTA FE	<input checked="" type="checkbox"/>
FILE	
U.S.G.S.	
LAND OFFICE	
OPERATOR	

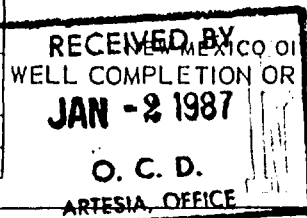

Form C-105
Revised 11-1-84

5a. Indicate Type of Lease	State <input checked="" type="checkbox"/> Fee <input type="checkbox"/>
5. State Oil & Gas Lease No.	LG-7426

1a. TYPE OF WELL	OIL WELL <input checked="" type="checkbox"/> GAS WELL <input type="checkbox"/> DRY <input type="checkbox"/> OTHER <input type="checkbox"/>
b. TYPE OF COMPLETION	NEW WELL <input checked="" type="checkbox"/> WORK OVER <input type="checkbox"/> DEEPEN <input type="checkbox"/> PLUG BACK <input type="checkbox"/> DIFF. RESVR. <input type="checkbox"/> OTHER <input type="checkbox"/>

7. Unit Agreement Name	N/A
------------------------	-----

2. Name of Operator	Hanson Operating Company, Inc.
---------------------	--------------------------------

8. Farm or Lease Name	Hanlad "A" State
-----------------------	------------------

3. Address of Operator	P. O. Box #1515, Roswell, New Mexico 88202-1515
------------------------	---

9. Well No.	1
-------------	---

4. Location of Well	UNIT LETTER I LOCATED 1650 FEET FROM THE South LINE AND 330 FEET FROM THE East LINE OF SEC. 28 TWP. 10-S RGE. 27-E N41PM
---------------------	--

10. Field and Pool, or Wildcat	Under Diablo San Andres
--------------------------------	-------------------------

12. County	Chaves
------------	--------

15. Date Spudded	09/25/86	16. Date T.D. Reached	12/15/86	17. Date Compl. (Ready to Prod.)	12/23/86	18. Elevations (DF, RKB, RT, GR, etc.)	3836' GR	19. Elev. Casinghead	3836'
------------------	----------	-----------------------	----------	----------------------------------	----------	--	----------	----------------------	-------

20. Total Depth	2137'	21. Plug Back T.D.	2123'	22. If Multiple Compl., How Many	N/A	23. Intervals Drilled By	Rotary Tools	Cable Tools	0 - 2137'
-----------------	-------	--------------------	-------	----------------------------------	-----	--------------------------	--------------	-------------	-----------

24. Producing Interval(s), of this completion - Top, Bottom, Name	2072-82' - San Andres	25. Was Directional Survey Made	No
---	-----------------------	---------------------------------	----

26. Type Electric and Other Logs Run	Compensated Neutron Density	27. Was Well Cored	No
--------------------------------------	-----------------------------	--------------------	----

28. CASING RECORD (Report all strings set in well)					
CASING SIZE	WEIGHT LB./FT.	DEPTH SET	HOLE SIZE	CEMENTING RECORD	AMOUNT PULLED
8-5/8"	24#	500'	12-1/4"	200 sx Lite, 200 sx Class	
				"C", circ 100 sx to surf.	
5-1/2"	17#	2132'	8"	250 sx Lite, 100 sx Class	
				"C", 100 sx POZ "A", circ 48 sx to surf.	

29. LINER RECORD					30. TUBING RECORD		
SIZE	TOP	BOTTOM	SACKS CEMENT	SCREEN	SIZE	DEPTH SET	PACKER SET
					2-3/8"	2115'	N/A

31. Perforation Record (Interval, size and number)	2072-82' (2 JSPPF)	32. ACID, SHOT, FRACTURE, CEMENT SQUEEZE, ETC.
		DEPTH INTERVAL
		2072-82'
		AMOUNT AND KIND MATERIAL USED
		5,000 gal 20% NEFE ac w/additives

33. PRODUCTION							
Date First Production	12/24/86	Production Method (Flowing, gas lift, pumping - Size and type pump)	Pumping - 2x1 1/2x10' RHBC	Well Status (Prod. or Shut-in)	Producing		
Date of Test	12/26/86	Hours Tested	24	Choke Size		Prod'n. For Test Period	
						Oil - Bbl.	12
						Gas - MCF	TSTM
						Water - Bbl.	1
						Gas - Oil Ratio	N/A
Flow Tubing Press.		Casing Pressure		Calculated 24-Hour Rate		Oil - Bbl.	12
						Gas - MCF	0
						Water - Bbl.	1
						Oil Gravity - API (Corr.)	25.5

34. Disposition of Gas (Sold, used for fuel, vented, etc.)	N/A	Test Witnessed By	David Sweeney
--	-----	-------------------	---------------

35. List of Attachments	Form C-104
-------------------------	------------

36. I hereby certify that the information shown on both sides of this form is true and complete to the best of my knowledge and belief.		
SIGNED	Brenda R. Godfrey	TITLE
	Production Analyst	DATE
		12/31/86

INSTRUCTIONS

This form is to be filed with the appropriate District Office of the Commission not later than 20 days after the completion of any newly-drilled or deepened well. It shall be accompanied by one copy of all electrical and radioactivity logs, run on the well and a summary of all special tests conducted, including drill stem tests. All depths reported shall be measured depths. In the case of diagonally drilled wells, true vertical depths shall also be reported. For multiple completions, Items 30 through 34 shall be reported for each zone. This form is to be filed in quintuplicate except on state land, where six copies are required. See Rule 1105.

INDICATE FORMATION TOPS IN CONFORMANCE WITH GEOGRAPHICAL SECTION OF STATE

Southeastern New Mexico

Northwestern New Mexico

T. Anhy <u>170'</u>	T. Canyon _____	T. Ojo Alamo _____	T. Penn. "B" _____
T. Salt <u>316'</u>	T. Strawn _____	T. Kirtland-Fruitland _____	T. Penn. "C" _____
T. Salt <u>405'</u>	T. Atoka _____	T. Pictured Cliffs _____	T. Penn. "D" _____
T. Yates _____	T. Miss _____	T. Cliff House _____	T. Leadville _____
T. 7 Rivers _____	T. Devonian _____	T. Menefee _____	T. Madison _____
T. Queen <u>915'</u>	T. Silurian _____	T. Point Lookout _____	T. Elbert _____
T. Grayburg _____	T. Montoya _____	T. Mancos _____	T. McCracken _____
T. San Andres <u>1415'</u>	T. Simpson _____	T. Gallup _____	T. Ignacio Qtzte _____
T. Glorieta _____	T. McKee _____	Base Greenhorn _____	T. Granite _____
T. Paddock _____	T. Ellenburger _____	T. Dakota _____	T. _____
T. Blinberry _____	T. Gr. Wash _____	T. Morrison _____	T. _____
T. Tubb _____	T. Granite _____	T. Todilto _____	T. _____
T. Drinkard _____	T. Delaware Sand _____	T. Entrada _____	T. _____
T. Abo _____	T. Bone Springs _____	T. Wingate _____	T. _____
T. Wolfcamp _____	T. _____	T. Chinle _____	T. _____
T. Penn. _____	T. _____	T. Permian _____	T. _____
T. Cisco (Bough C) _____	T. _____	T. Penn. "A" _____	T. _____

OIL OR GAS SANDS OR ZONES

No. 1, from 2072' to 2082' No. 4, from _____ to _____

No. 2, from _____ to _____ No. 5, from _____ to _____

No. 3, from _____ to _____ No. 6, from _____ to _____

IMPORTANT WATER SANDS

Include data on rate of water inflow and elevation to which water rose in hole.

No. 1, from _____ to _____ feet

No. 2, from _____ to _____ feet

No. 3, from _____ to _____ feet

No. 4, from _____ to _____ feet

FORMATION RECORD (Attach additional sheets if necessary)

From	To	Thickness in Feet	Formation	From	To	Thickness in Feet	Formation
0'	170'	170'	Redbeds				
170'	305'	135'	Anhydrite				
305'	405'	100'	Salt, anhydrite				
405'	915'	510'	Sand, red shale, anhydrite				
915'	1450'	545'	Sand, red shale, anhydrite, lime				
1450'	TD		Dolomite				

NO. OF COPIES RECEIVED	
DISTRIBUTION	
SANTA FE	<input checked="" type="checkbox"/>
FILE	
U.S.O.S.	
LAND OFFICE	
OPERATOR	

RECEIVED BY
SANTA FE
DEC 29 1986
O. C. D.
ARTESIA, OFFICE

O. BOX 2088
NEW MEXICO 87501
JAN - 2 1987

5a. Indicate Type of Lease
State ☒ Fee ☐

5. State Oil & Gas Lease No.
IG-7426

SUNDRY NOTICES AND REPORTS ON WELLS

(DO NOT USE THIS FORM FOR PROPOSALS TO DRILL OR TO DEEPEN OR PLUG BACK TO A DIFFERENT RESERVOIR.
USE "APPLICATION FOR PERMIT -" (FORM C-101) FOR SUCH PROPOSALS.)

OIL WELL ☒ GAS WELL ☐ OTHER ☐

7. Unit Agreement Name
N/A

Name of Operator
Hanson Operating Company, Inc.

8. Farm or Lease Name
HANLAD "A" STATE

Address of Operator
P. O. Box #1515, Roswell, New Mexico 88202-1515

9. Well No.
1

Location of Well
UNIT LETTER I 1650 FEET FROM THE South LINE AND 330 FEET FROM
East 28 TOWNSHIP 10-S RANGE 27-E N.M.P.M.

10. Field and Pool, or Wildcat
Undes Diablo SA

15. Elevation (Show whether DF, RT, CR, etc.)
3836' GR

12. County
Chaves

Check Appropriate Box To Indicate Nature of Notice, Report or Other Data

NOTICE OF INTENTION TO:

SUBSEQUENT REPORT OF:

PERFORM REMEDIAL WORK <input type="checkbox"/>	PLUG AND ABANDON <input type="checkbox"/>	REMEDIAL WORK <input type="checkbox"/>	ALTERING CASING <input type="checkbox"/>
TEMPORARILY ABANDON <input type="checkbox"/>	CHANGE PLANS <input type="checkbox"/>	COMMENCE DRILLING OPNS. <input type="checkbox"/>	PLUG AND ABANDONMENT <input type="checkbox"/>
WELL OR ALTER CASING <input type="checkbox"/>	OTHER <input type="checkbox"/>	CASING TEST AND CEMENT JOB <input type="checkbox"/>	
		OTHER <u>Perforate & acidize</u> <input checked="" type="checkbox"/>	

Describe Proposed or Completed Operations (Clearly state all pertinent details, and give pertinent dates, including estimated date of starting any proposed work) SEE RULE 1103.

Ran perf gun & shot 2 SPF interval 2072-82'.
Acidized w/5,000 gal 20% NE FE acid w/additives.
Flow & swab test well.

I hereby certify that the information above is true and complete to the best of my knowledge and belief.

BY Brenda G. Godfrey TITLE Production Analyst DATE 12/24/86

APPROVED BY Les H. Clements TITLE SUPERVISOR, DISTRICT 4 DATE DEC 30 1986

CONDITIONS OF APPROVAL, IF ANY:

NO. OF COPIES RECEIVED	
DISTRIBUTION	
SAFETY	<input checked="" type="checkbox"/>
FILE	
U.S.O.S.	
LAND OFFICE	
OPERATOR	

OIL CONSERVATION DIVISION

Form C-103
Revised 10-1-

RECEIVED BY
DEC 29 1986
O. C. D.
ARTESIA OFFICE

NEW MEXICO 87501
JAN - 2 1987

5a. Indicate Type of Lease
State ☒ Fee ☐

5. State Oil & Gas Lease No.
IG-7426

SUNDRY NOTICES AND REPORTS ON WELLS
(DO NOT USE THIS FORM FOR PROPOSALS TO DRILL OR TO DEEPEN OR PLUG BACK TO A DIFFERENT RESERVOIR. USE "APPLICATION FOR PERMIT -" (FORM C-101) FOR SUCH PROPOSALS.)

OIL WELL ☒ GAS WELL ☐ OTHER ☐

Name of Operator
Hanson Operating Company, Inc.

Address of Operator
P. O. Box #1515, Roswell, New Mexico 88202-1515

Location of Well
UNIT LETTER **I** **1650** FEET FROM THE **South** LINE AND **330** FEET FROM
THE **East** LINE, SECTION **28** TOWNSHIP **10-S** RANGE **27-E** NMPM.

7. Unit Agreement Name
N/A

8. Farm or Lease Name
HANLAD "A" STATE

9. Well No.
1

10. Field and Pool, or Wildcat
Undes Diablo SA

11. Elevation (Show whether DF, RT, CR, etc.)
3836' GR

12. County
Chaves

Check Appropriate Box To Indicate Nature of Notice, Report or Other Data
NOTICE OF INTENTION TO: SUBSEQUENT REPORT OF:

<input type="checkbox"/> PERFORM REMEDIAL WORK <input type="checkbox"/> TEMPORARILY ABANDON <input type="checkbox"/> PLUG OR ALTER CASING <input type="checkbox"/> OTHER	<input type="checkbox"/> PLUG AND ABANDON <input type="checkbox"/> CHANGE PLANS <input type="checkbox"/> OTHER	<input type="checkbox"/> REMEDIAL WORK <input type="checkbox"/> COMMENCE DRILLING OPNS. <input checked="" type="checkbox"/> CASING TEST AND CEMENT JOB <input type="checkbox"/> OTHER	<input type="checkbox"/> ALTERING CASING <input type="checkbox"/> PLUG AND ABANDONMENT <input type="checkbox"/> OTHER
---	--	--	---

Describe Proposed or Completed Operations (Clearly state all pertinent details, and give pertinent dates, including estimated date of starting any proposed work) SEE RULE 1103.

Ran & cemented 53 jts J55 5½" 17# casing, set @ 2132'.
Cem w/250 sx Halliburton Lite w/5# salt & ½# flocele/sk, followed by 100 sx Class "C"
& 100 sx POZ mix "A" w/2% gel & 5# salt/sk. Plug dn @ 3:00 p.m. Pressured to 500 psi -
held OK. Circ 48 sx to pit. WOC 48 hrs.

I hereby certify that the information above is true and complete to the best of my knowledge and belief.

BY *Brenda E. Godfrey* TITLE Production Analyst DATE 12/23/86

APPROVED BY *Les H. Clement* TITLE SUPERVISOR, DISTRICT 14 DATE DEC 30 1986

CONDITIONS OF APPROVAL, IF ANY:

NO. OF COPIES RECEIVED	
DISTRIBUTION	
SANTA FE	<input checked="" type="checkbox"/>
FILE	
U.S.G.S.	
LAND OFFICE	
OPERATOR	

OIL CONSERVATION DIVISION

P. O. BOX 2088

Form C-103
Revised 10-1-

RECEIVED BY NEW MEXICO 87501

OCT 15 1986

O. C. D.

5a. Indicate Type of Lease

State ☒

Fee ☐

5. State Oil & Gas Lease No.

IG-7426

SUNDRY NOTICES AND REPORTS ON WELLS

(DO NOT USE THIS FORM FOR PROPOSALS TO DRILL OR TO DEEPEN OR PLUG BACK TO A DIFFERENT RESERVOIR. USE "APPLICATION FOR PERMIT -" (FORM C-101) FOR SUCH PROPOSALS.)

OIL WELL ☒

CAS WELL ☐

OTHER ☐

RECEIVED BY

OCT 17 1986

O. C. D.

ARTESIA, OFFICE

7. Unit Agreement Name

N/A

8. Farm or Lease Name

HANLAD "A" STATE

9. Well No.

1

10. Field and Pool, or Wildcat

Undes Diablo San Andres

UNIT LETTER I 1650 FEET FROM THE South LINE AND 330 FEET FROM

THE East LINE, SECTION 28 TOWNSHIP 10S RANGE 27E NMPM.

11. Elevation (Show whether DF, RT, CR, etc.)

3836' GR

12. County

Chaves

Check Appropriate Box To Indicate Nature of Notice, Report or Other Data

NOTICE OF INTENTION TO:

SUBSEQUENT REPORT OF:

FORM REMEDIAL WORK ☐

PLUG AND ABANDON ☐

REMEDIAL WORK ☐

ALTERING CASING ☐

TEMPORARILY ABANDON ☐

COMMENCE DRILLING OPS. ☒

PLUG AND ABANDONMENT ☐

WILL OR ALTER CASING ☐

CHANGE PLANS ☐

CASING TEST AND CEMENT JOB ☒

OTHER ☐

Describe Proposed or Completed Operations (Clearly state all pertinent details, and give pertinent dates, including estimated date of starting any proposed work) SEE RULE 1103.

Spud @ 8:00 a.m., 09/25/86.

Ran 500' 8-5/8" csg. Pmpd 50 BBLS gelled wtr w/500# fresh wtr gel. Cem w/200 sx Halliburton Lite w/1/4# flocele, 10# gel, 3% CaCl/sx, followed by 200 sx Class "C" cement w/3% CaCl. Circ 100 sx Halliburton Lite to pit. WOC 4 days. Pressured up to 400# for 30 minutes - held OK.

I hereby certify that the information above is true and complete to the best of my knowledge and belief.

BY Brenda K. Godfrey

TITLE Production Analyst

DATE 10/13/86

APPROVED BY Jos. D. Clements

TITLE SUPERVISOR, DISTRICT II

DATE OCT 20 1986

CONDITIONS OF APPROVAL, IF ANY:

All distances must be from the outer boundaries of the Section.

Operator Hanson Operating Company, Inc.		Lease Hanlad "A" State		Well No. 1
Unit Letter I	Section 28	Township 10 South	Range 27 East	County Chaves
Actual Footage Location of Well: 1650 feet from the South line and 330 feet from the East line				
Ground Level Elev. 3836	Producing Formation San Andres		Pool Diablo San Andres	Dedicated Acreage 40

1. Outline the acreage dedicated to the subject well by colored pencil or hatchure marks on the plat below.
2. If more than one lease is dedicated to the well, outline each and identify the ownership thereof (both as to working interest and royalty).

3. If more than one lease of different ownership is dedicated to the well, have the interests of all owners been consolidated by communitization, unitization, force-pooling, or otherwise?

☐ Yes ☐ No If answer is "yes," type of consolidation _____

If answer is "no," list the owners and tract descriptions which have actually been consolidated. (Use reverse side of this form if necessary.) _____

No allowable will be assigned to the well until all interests have been consolidated (by communitization, unitization, forced-pooling, or otherwise) or until a non-standard unit, eliminating such interests, has been approved by the Division.

CERTIFICATION

I hereby certify that the information contained herein is true and complete to the best of my knowledge and belief.

Brenda R. Godfrey
Name

Brenda R. Godfrey

Position

Production Analyst

Company

Hanson Operating Co., Inc.

Date

September 17, 1986

I hereby certify that the well location shown on this plat was plotted from field notes of actual surveys made by me or under my supervision, and that the same is true and correct to the best of my knowledge and belief.

September 15, 1986

Date Surveyed

P. R. Patton

Registered Professional Engineer
and/or Land Surveyor

8112

Certificate No.

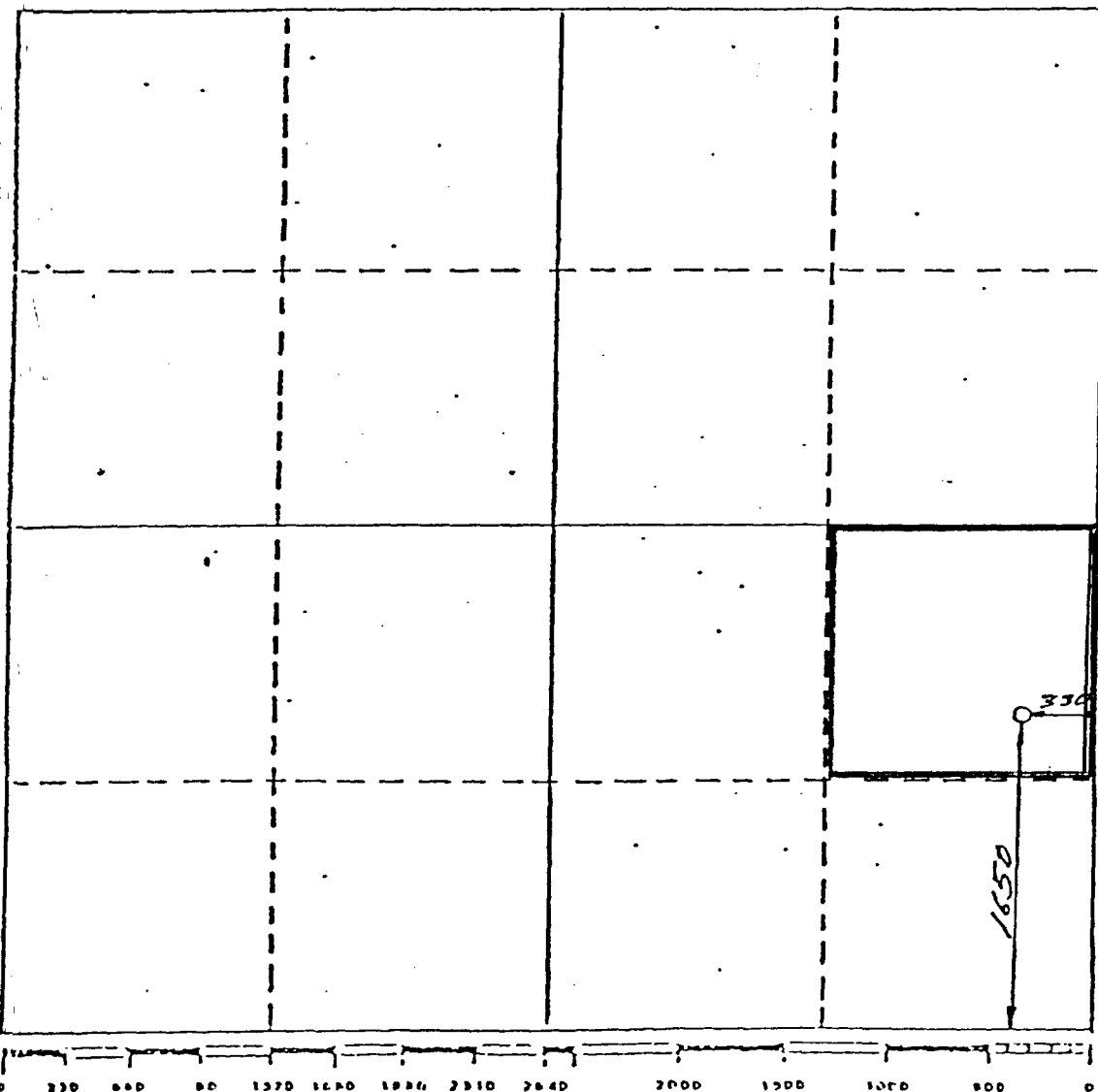

30-005-62341

Form C-101
Revised 1-1-65
 5A. Indicate Type of Lease
 STATE ☒ REC ☐
 5. State Oil & Gas Lease No.
 LG-7426

APPLICATION FOR PERMIT TO DRILL, DEEPEN, OR PLUG BACK

1a. Type of Work DRILL <input checked="" type="checkbox"/> DEEPEN <input type="checkbox"/> PLUG BACK <input type="checkbox"/>		7. Unit Agreement Name N/A
b. Type of Well OIL WELL <input checked="" type="checkbox"/> GAS WELL <input type="checkbox"/> OTHER <input type="checkbox"/>		8. Farm or Lease Name HANLAD "A" STATE
2. Name of Operator Hanson Operating Company, Inc.		9. Well No. 1
3. Address of Operator P. O. Box #1515, Roswell, New Mexico 88202-1515		10. Field and Pool, or Wildcat Undes Diablo San Andr
4. Location of Well UNIT LETTER I LOCATED 1650 FEET FROM THE South LINE AND 330 FEET FROM THE East LINE OF SEC. 28 TWP. 10S RGE. 27E NMPM		12. County Chaves
19. Proposed Depth 2200'		19A. Formation San Andres
20. Rotary or C.T. Cable Tool		
21. Elevations (Show whether DF, RT, etc.) 3836' GR	21A. Kind & Status Plug. Bond Statewide	21B. Drilling Contractor N/A
22. Approx. Date Work will start September 22, 1986		

PROPOSED CASING AND CEMENT PROGRAM

SIZE OF HOLE	SIZE OF CASING	WEIGHT PER FOOT	SETTING DEPTH	SACKS OF CEMENT	EST. TOP
12-1/4"	8-5/8"	24#	500'	150	Circulate
8"	5-1/2"	15#	2200'	450	Circulate

It is proposed to drill the above-mentioned well with cable tools to a depth sufficient to test the San Andres formation. If commercial production is indicated, pipe would be set. The well will be perforated and stimulated as needed.

We request that this well be kept under "Tight Hole" stipulations.

APPROVAL VALID FOR 180 DAYS
 PERMIT EXPIRES 3-23-87
 UNLESS DRILLING UNDERWAY

IN ABOVE SPACE DESCRIBE PROPOSED PROGRAM: IF PROPOSAL IS TO DEEPEN OR PLUG BACK, GIVE DATA ON PRESENT PRODUCTIVE ZONE AND PROPOSED NEW PRO-
 DUCTIVE ZONE. GIVE BLOWOUT PREVENTER PROGRAM, IF ANY.

I hereby certify that the information above is true and complete to the best of my knowledge and belief.

Signed Bruno R. Godfrey Title Production Analyst Date Sept. 17, 1986
 (This space for State Use)
 Approved by Les H. Clement TITLE SUPERVISOR, DISTRICT DATE SEP 23 1986

CONDITIONS OF APPROVAL, IF ANY:

WRS COMPLETION REPORTCOMPLETIONS SEC 28 TWP 10S RGE 27E
PI# 30-T-0001 02/02/87 30-005-62341-0000 PAGE 1NMEX CHAVES * 1650FSL 330FEL SEC NE SE
STATE COUNTY FOOTAGE SPOT
HANSON OPERATING D DO
OPERATOR WELL CLASS INIT FIN1 HANLAD "A" STATE
WELL NO. LEASE NAME
3836GR DIABLO
OPER ELEV FIELD POOL AREAAPI 30-005-62341-0000
LEASE TYPE NO. PERMIT OR WELL I.D. NO.
09/25/1986 12/26/1986 ROTARY OIL
SPUD DATE COMP. DATE TYPE TOOL STATUS2200 SN ANDRS NOT RPTD
PROJ. DEPTH PROJ. FORM CONTRACTOR
DTD 2137 PB 2123 FM/TD SN ANDRS
DRILLERS T.D. LOG T.D. PLUG BACK TD OLD T.D. FORM T.D.**LOCATION DESCRIPTION**

18 MI NE DEXTER, NM

CASING/LINER DATACSG 8 5/8 @ 500 W/ 400 SACKS
CSG 5 1/2 @ 2132 W/ 450 SACKS**TUBING DATA**

TBG 2 3/8 AT 2115

INITIAL POTENTIALIPP 12BOPD 1BW 24HRS
SN ANDRS PERF W/ 2/FT 2072- 2082
PERF 2072- 2082
ACID 2072- 2082 5000GALS
20% NEFE
GTY 25.5 GOR (TSTM)

TYPE	FORMATION	LTH	TOP	DEPTH/SUB	BSE	DEPTH/SUB
LOG	RUSTLER		170	3666		
LOG	SALT		316	3520	405	3431
LOG	QUEEN		915	2921		
LOG	SN ANDRS		1415	2421		

CONTINUED IC# 300057003786

Copyrighted 1987
Reproduction
Prohibited**Petroleum Information****BB** a company of
The Dun & Bradstreet CorporationPI-WRS-GET
Form No187

COMPLETIONS SEC 28 TWP 10S RGE 27E
PI# 30-T-0001 02/02/87 30-005-62341-0000 PAGE 2

HANSON OPERATING D DO
1 HANLAD "A" STATE

LOGS AND SURVEYS /INTERVAL,TYPE/

LOGS CNDL

DRILLING PROGRESS DETAILS

HANSON OPERATING
BOX 1515
ROSWELL, NM 88202
505-622-7330
09/29 LOC/1986/
01/27 2137 TD, PB 2123
COMP 12/26/86, IPP 12 BO, 1 BWPD,
GOR (TSTM), GTY 25.5
PROD ZONE - SAN ANDRES 2072-2082
NO CORES OR DSTS RPTD



W.R. HUMPHRIES
COMMISSIONER

State of New Mexico



Commissioner of Public Lands

CAPE FILE - 9902

P.O. BOX 1148
SANTA FE, NEW MEXICO 87504-1148

April 3, 1990

Mr. David Catanach
Energy, Minerals & Natural Resources Dept.
Oil Conservation Division
P. O. Box 2088
State Land Office Building
Santa Fe, New Mexico 87504

RE: Application for a Salt Water Disposal

Dear Mr. Catanach:

Application is being made to the Oil Conservation Division from Hanson Operating Company, Inc. for approval of a Salt Water Disposal in Section 28, Township 10 South, Range 27 East within the NE $\frac{1}{4}$ SE $\frac{1}{4}$, Chaves County.

The Commissioner of Public Lands has no objections at this time for your approval of the above application. However, the Commissioner reserves the right to refuse to grant a salt water lease when it would be detrimental to the Trust. As you know the applicant has a right under his valid Oil & Gas lease to dispose of the salt water subject to your approval. However, if he is going to inject salt water from wells outside of the leased premises he will have to apply for a salt water disposal easement from us.

If you have any questions, please call us at 827-5724.

Sincerely,

Zilla Porter Padilla

Zilla Porter Padilla
Commercial Resources

ZPP/LRM/jm

cc: Date File
Mr. William F. Carr



STATE OF NEW MEXICO
ENERGY, MINERALS AND NATURAL RESOURCES DEPARTMENT
OIL CONSERVATION DIVISION

GARREY CARRUTHERS
GOVERNOR

POST OFFICE BOX 2088
STATE LAND OFFICE BUILDING
SANTA FE NEW MEXICO 87504
(505) 827-5800

July 18, 1990

Hanson Operating Co.
P.O. Box 1515
Roswell, NM 88202-1515

Attention: David Sweeney

*RE: Injection Pressure Increase
Hanlad "A" State No. 1
Chaves County, New Mexico*

Dear Mr. Sweeney:

Reference is made to your request dated July 9, 1990, to increase the surface injection pressure on the Hanlad "A" State SWD No. 1. This request is based on a step rate test conducted on the well on July, 1990. The results of the test have been reviewed by my staff and we feel an increase in injection pressure on the well is justified at this time.

You are therefore authorized to increase the surface injection pressure on the following well.

WELL AND LOCATION

MAXIMUM INJECTION
SURFACE PRESSURE

Hanlad "A" State No. 1
Unit I, Section 28, T-10 South,
R-27 East, NMPM, Chaves County,
New Mexico.

1090 PSIG

Injection Pressure Increase
Hanson Operating Company, Inc.
July 18, 1990
Page 2

The Division Director may rescind this injection pressure increase if it becomes apparent that the injected water is not being confined to the injection zone or is endangering any fresh water aquifers.

Sincerely,

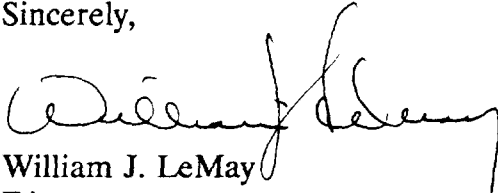
A handwritten signature in black ink, appearing to read "William J. LeMay". The signature is fluid and cursive, with a long horizontal stroke extending to the right.

William J. LeMay
Director

cc: Oil Conservation Division - Artesia
File: Case No. 9902
T. Gallegos
D. Catanach

NO WAITING PERIOD

COMPANY: Hanson Operating Company, Inc.
ADDRESS: D.O. Box 1515
CITY, STATE, ZIP: Roswell, N.M. 88203-1515
ATTENTION: Daniel Sweeney

Re: Injection Pressure Increase
Hantel "A" Stat No. 1
Chaves County, New Mexico

Dear Sir:

Reference is made to your request dated July 9, 1990, to increase the surface injection pressure on the Hantel "A" Stat No. 1. This request is based on a step rate test conducted on the well on July 9, 1990. The results of the test have been reviewed by my staff and we feel an increase in injection pressure on the well is justified at this time.

You are therefore authorized to increase the surface injection pressure on the following well:

<u>Well & Location</u>	<u>Maximum Injection Surface Pressure</u>
<u>Hantel "A" Stat No. 1</u>	<u>1090 PSIG</u>
<u>Unit I, Sector 28, T-1 South, R-2 West,</u>	
<u>21000 Chaves County, New Mexico</u>	

The Division Director may rescind this injection pressure increase if it becomes apparent that the injected water is not being confined to the injection zone or is endangering any fresh water aquifers.

XC: T. GALLEGOS
D. CATANACH
FILE- Case No. 9802
OCD- Artesia

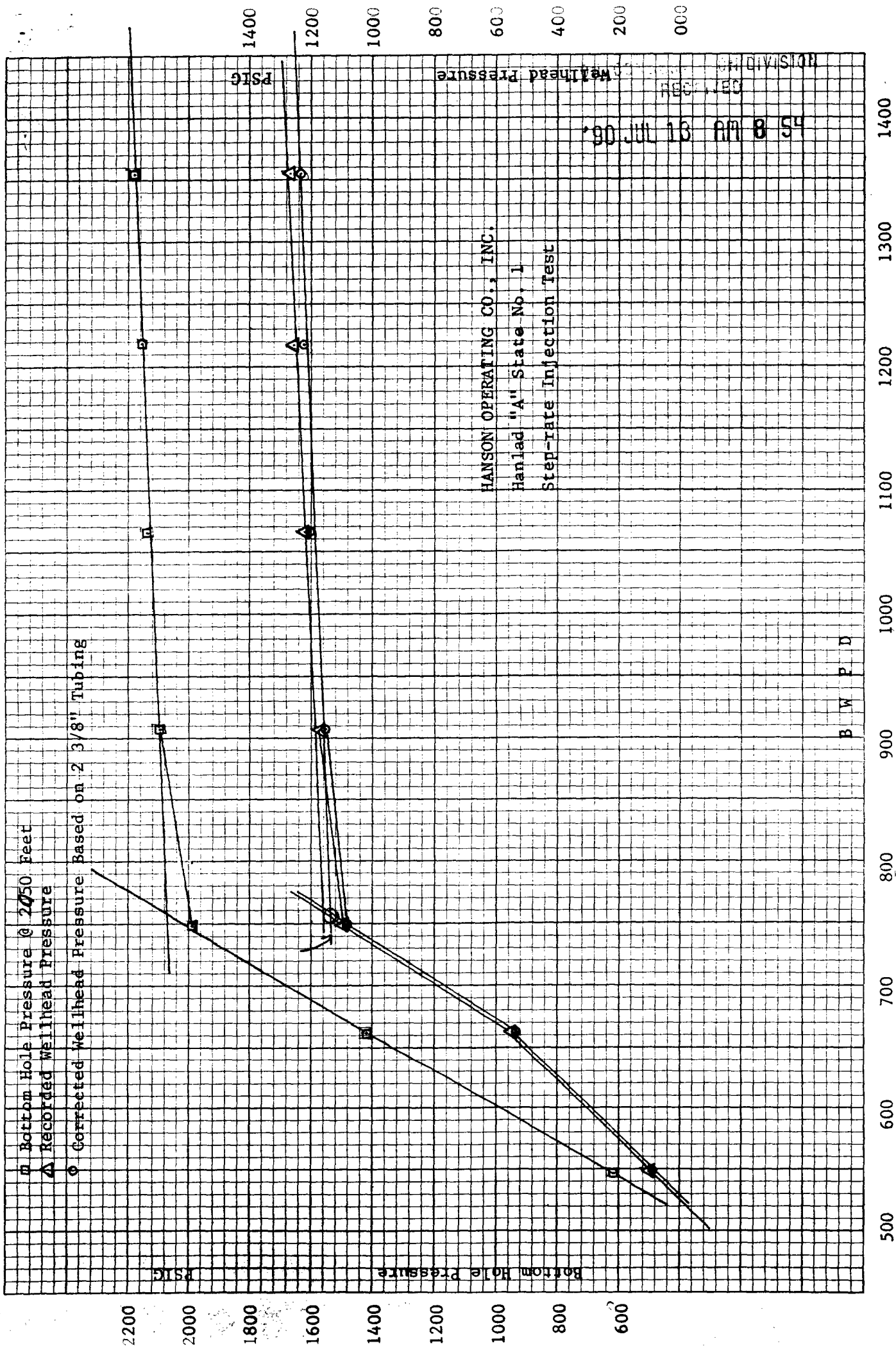

Well Name Hanlad "A" State No. 1
CO. Name Hanson Operating Co., Inc.

CO. Name Hanson Operating Co., Inc.

[illegible]

JOHN WEST ENGINEERING CO.

Step Rate Injection Test

Well Name Hanlad "A" State No. 1

Date July 9, 1990

CO. Name Hanson Operating Co., Inc.

Page 2

[illegible]



OIL & GAS
RECEIVED
DIVISION

'90 SEP 25 AM 8 40

HANSON OPERATING COMPANY, INC.

P.O. BOX 1515

ROSWELL, NEW MEXICO 88202-1515

PHONE AC 505-622-7330

RECEIVED

SEP 21 '90

SEP 21 '90

September 20, 1990

New Mexico Oil Conservation Division
Mike Williams
P. O. Drawer DD
Artesia, New Mexico 88210

RE: Hanlad "A" State Battery #1
Well #1
Sec. 28-T. 20S-R. 27E
Chaves County, New Mexico

Dear Mr. Williams:

Hanson Operating Company, Inc. has recently deepened the above captioned well. We are requesting the interval from 2034-2658' (San Andres) to be used for the injection of produced water.

If you have any questions or if I may be of further assistance, please notify me.

Sincerely,
Hanson Operating Company, Inc.

David Sweeney
Drilling & Production Superintendent

DS/1j



HANSON OPERATING COMPANY, INC.

P.O. BOX 1515

ROSWELL, NEW MEXICO 88202-1515

PHONE AC 505-622-7330

September 20, 1990

New Mexico Oil Conservation Division
David Catanach
Room 216
310 Old Santa Fe Trail
Santa Fe, New Mexico 87503

RE: Hapiad "A" State Battery #1
Well #1
Sec. 28-T.20S-R.27E
Chaves County, New Mexico

Dear Mr. Catanach:

Hanson Operating Company, Inc. has recently deepened the above captioned well. We are requesting the interval from 2034-2658' (San Andres) to be used for the injection of produced water.

If you have any questions or if I may be of further assistance, please notify me.

Sincerely,
Hanson Operating Company, Inc.

David Sweeney
Drilling & Production Superintendent

DS/1j



STATE OF NEW MEXICO
ENERGY, MINERALS AND NATURAL RESOURCES DEPARTMENT
OIL CONSERVATION DIVISION

September 27, 1990

GARREY CARRUTHERS
GOVERNOR

POST OFFICE BOX 2088
STATE LAND OFFICE BUILDING
SANTA FE, NEW MEXICO 87504
(505) 827-5800

Hanson Operating Co. Inc.
P.O. Box 1515
Roswell, New Mexico 88202-1515

Attention: David Sweeney

Re: Amendment of Order No. R-9156

Dear Mr. Sweeney:

Reference is made to your request dated September 20, 1990, to expand the injection interval in the Hanlad "A" State Well No. 1 located in Section 28, Township 20 South, Range 27 East, NMPM, Chaves County, New Mexico, to include the perforated interval from approximately 2034 feet to 2658 feet. It is our understanding that Division Order No. R-9156, dated April 19, 1990, authorized the use of said well as a San Andres disposal well with injection into the perforated interval from approximately 2034 feet to 2082 feet. It is further our understanding that the additional injection interval, 2083 feet to 2658 feet is within the San Andres formation.

You are hereby authorized to expand the injection interval in the subject well to include the total interval from approximately 2034 feet to 2658 feet. All other provisions contained within Division Order No. R-9156 shall remain in full force and effect.

Sincerely,

A handwritten signature in cursive script, appearing to read "David Catanach".

David Catanach
Engineer

xc: OCD-Artesia
•Case File-9902



STATE OF NEW MEXICO
ENERGY, MINERALS AND NATURAL RESOURCES DEPARTMENT
OIL CONSERVATION DIVISION

GARREY CARRUTHERS
GOVERNOR

POST OFFICE BOX 2088
STATE LAND OFFICE BUILDING
SANTA FE, NEW MEXICO 87504
(505) 827-5800

December 12, 1990

Hanson Operating Company, Inc.
P.O. Box 1515
Roswell, NM 88202-1515

Attention: David Sweeney

*RE: Injection Pressure Increase
Hanlad "A" State Well No. 1
Chaves County, New Mexico*

Dear Mr. Sweeney:

Reference is made to your request dated November 20, 1990, to increase the surface injection pressure on the Hanlad "A" State Well No. 1. This request is based on a step rate test conducted on the well on November 15, 1990. The results of the test have been reviewed by my staff and we feel an increase in injection pressure on the well is justified at this time.

You are therefore authorized to increase the surface injection pressure on the following well.

WELL AND LOCATION

MAXIMUM INJECTION
SURFACE PRESSURE

Hanlad "A" State Well No. 1
Unit I, Section 28, T-10 South,
R-27 East, NMPM, Chaves County,
New Mexico.

1530 PSIG

*Injection Pressure Increase
Hanson Operating Company, Inc.
December 12, 1990
Page 2*

The Division Director may rescind this injection pressure increase if it becomes apparent that the injected water is not being confined to the injection zone or is endangering any fresh water aquifers.

Sincerely,

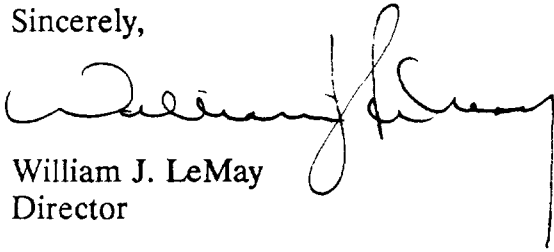
A handwritten signature in black ink, appearing to read 'William J. LeMay', with a long horizontal stroke extending to the right.

William J. LeMay
Director

cc: Oil Conservation Division - Artesia
File: Case No. 9902
D. Catanach

NO WAITING PERIOD

COMPANY: Hanson Operating Company, Inc
ADDRESS: P.O. Box 1515
CITY, STATE, ZIP: Roswell, New Mexico 88203-1515
ATTENTION: David Sweeney

Re: Injection Pressure Increase
Hanford "A" State Well No. 1

Chaves County, New Mexico

Dear Sir:

Reference is made to your request dated November 20, 1990, to increase the surface injection pressure on the Hanford "A" State Well No. 1. This request is based on a step rate test conducted on the well on November 15, 1990. The results of the test have been reviewed by my staff and we feel an increase in injection pressure on the well is justified at this time.

You are therefore authorized to increase the surface injection pressure on the following well:

<u>Well & Location</u>	<u>Maximum Injection Surface Pressure</u>
<u>Hanford "A" State Well No. 1</u> <u>Unit I, Section 24, T-10S, R-27E, S. 21N, W. 4E,</u> <u>Chaves County, New Mexico</u>	<u>1530 PSIG</u>

The Division Director may rescind this injection pressure increase if it becomes apparent that the injected water is not being confined to the injection zone or is endangering any fresh water aquifers.

XC: T. GALLEGOS
D. CATANACH
FILE- Case No. 9902
OCD- Hanson



HANSON OPERATING COMPANY, INC.

P.O. BOX 1515

ROSWELL, NEW MEXICO 88202-1515

PHONE AC 505-622-7330

90 NOV 26 AM 10 15

November 20, 1990

N. M. Oil Conservation Division
Room 206
310 Old Santa Fe Trail
Santa Fe, New Mexico 87503

Attention: Mr. David Catanach

Dear Mr. Catanach:

Attached, please find the information on the Haniad #1 State Battery #1 Well #1, Sec. 28, T. 10S, R. 28 E, Chaves County, New Mexico, indicating the results of the Step-Rate Test that was performed on November 10, 1990.

Hanson Operating Company, Inc. is requesting, after review of this information, a higher disposal pressure than what was previously allowed by the State of New Mexico.

If you have any questions or if I can be of further assistance, please notify me.

Sincerely,

Hanson Operating Company, Inc.

Lisa L. Jennings

Lisa L. Jennings for David Sweeney
Production Analyst

71)
enci

*Gave Sweeney verbal
to start at
1530 P/16
on
12/3/90
Dre*

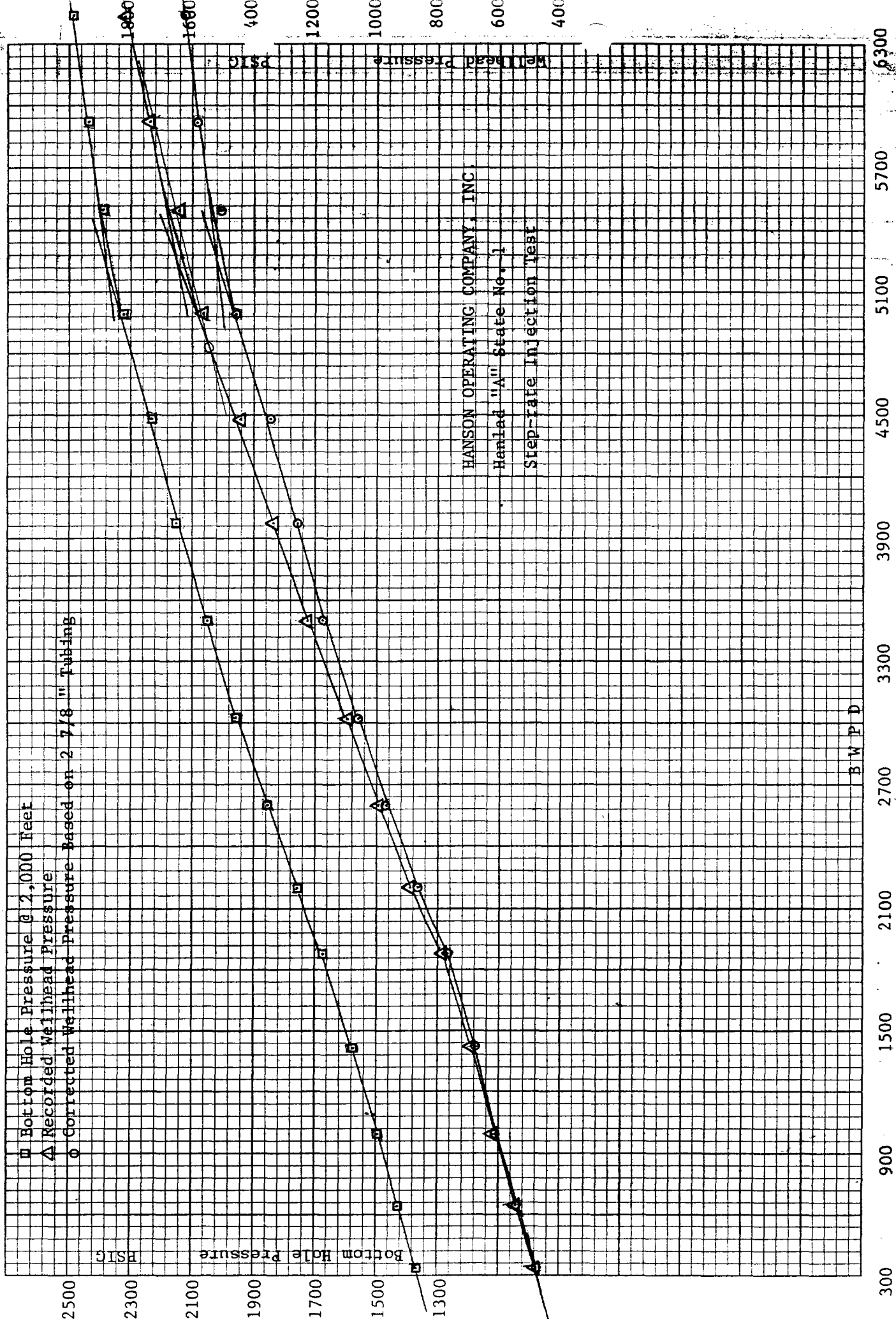

Step Rate Injection Test

Well Name Hanlad "A" State No. 1Test Date 11/15/90Company Name Hanson Operating Company, Inc.

Remarks	Time	Tbg. Press.	Rate B P D	Total	B H P	Tbg. Press.	Rate G P M	Total
				BOMB SET @ 2000'				
	10:15	429.60		0	1326			
	10:20	451.00	345.60	1.2	1351.0			
	10:25	461.00	316.80	2.3	1361.00			
Rate I	10:30	478.60	345.60	3.5	1374.00	477.8	9.80	0.757
	10:35	504.00	662.40	5.8	1400.00			
	10:40	522.10	633.60	8.0	1417.00			
Rate II	10:45	527.70	662.40	10.3	1426.00	525.1	19.04	2.585
			652.80					
	10:50	573.00	1036.80	13.9	1459.00			
	10:55	606.70	950.40	17.2	1480.00			
Rate III	11:00	612.20	1008.00	20.7	1496.00	606.5	29.12	5.673
			998.40					
	11:05	648.10	1411.20	25.60	1536.00			
	11:10	674.80	1411.20	30.50	1554.00			
Rate IV	11:15	687.10	1440.00	35.50	1579.00	676.2	41.44	10.897
			1420.80					
	11:20	750.20	1872.00	42.00	1622.00			
	11:25	770.00	1872.00	48.50	1647.00			
Rate V	11:30	791.20	1872.00	55.00	1670.00	773.1	54.60	18.150
			1872.00					
	11:35	844.40	2217.60	62.7	1714.00			
	11:40	868.30	2217.60	70.4	1739.00			
Rate VI	11:45	889.60	2188.80	78.6	1760.00	865.0	64.40	24.632
			2208.00					
	11:50	939.20	2592.00	87.0 0	1802.00			
	11:55	967.10	2620.80	96.10	1830.00			
Rate VII	12:00	997.60	2592.00	105.10	1856.00	964.2	75.88	33.366
			2601.60					
	12:05	1057.70	3024.00	115.60	1902.00			
	12:10	1079.40	3024.00	126.10	1931.00			
Rate VIII	12:15	1102.30	3024.00	136.60	1954.00	1058.2	88.20	44.074
			3024.00					

Test Date 11/15/90

Page 3

[illegible]



NOV 19 '90 10:14 HANSON OPER INC 505 622-7330

HANSON OPERATING COMPANY, INC. ^{P.1}

P.O. BOX 1818

ROSWELL, NEW MEXICO 88202-1818

PHONE AC 505-622-7330

FROM FAX NUMBER: (505) 622-7330

F A C S I M I L E T R A N S M I S S I O N

DATE: 11-19-90

TIME: _____ MST

TOTAL NUMBER OF PAGES: 5

TO: DCD

~~DEPENDENT~~ re: Strip Rate Test
Hambel "A" State Bath. 1 Well #1

COMMENTS: _____

SIGNED: *L. Jennings*

PLEASE NOTE

If you do not receive the total number of pages indicated above or do not receive a clear image, please telephone the above representative at the phone number indicated above.

Company Name Hanson Operating Company, Inc.

Page 3

[illegible]

Company Name Hanson Operating Company, Inc.

Page 2

[illegible]

Step Rate Injection Test

Well Name Hanlad "A" State No. 1Test Date 11/15/90Company Name Hanson Operating Company, Inc.

Remarks	Time	Tbg. Press.	Rate B P D	Total	B H P	Tbg. Press.	Rate G P M	Total
				BOMB SET @ 2000'				
	10:15	429.60		0	1326			
	10:20	451.00	345.60	1.2	1351.0			
	10:25	461.00	316.80	2.3	1361.00			
Rate I	10:30	478.60	345.60	3.5	1374.00	477.8	9.80	0.757
	10:35	504.00	662.40	5.8	1400.00			
	10:40	522.10	633.60	8.0	1417.00			
Rate II	10:45	527.70	662.40	10.3	1426.00	525.1	19.04	2.585
			652.80					
	10:50	573.00	1036.80	13.9	1459.00			
	10:55	606.70	950.40	17.2	1480.00			
Rate III	11:00	612.20	1008.00	20.7	1496.00	606.5	29.12	5.673
			998.40					
	11:05	648.10	1411.20	25.60	1536.00			
	11:10	674.80	1411.20	30.50	1554.00			
Rate IV	11:15	687.10	1440.00	35.50	1579.00	676.2	41.44	10.897
			1420.80					
	11:20	750.20	1872.00	42.00	1622.00			
	11:25	770.00	1872.00	48.50	1647.00			
Rate V	11:30	791.20	1872.00	55.00	1670.00	773.1	54.60	18.150
			1872.00					
	11:35	844.40	2217.60	62.7	1714.00			
	11:40	868.30	2217.60	70.4	1739.00			
Rate VI	11:45	889.60	2188.80	78.6	1760.00	865.0	64.40	24.632
			2208.00					
	11:50	939.20	2592.00	87.0 0	1802.00			
	11:55	967.10	2620.80	96.10	1830.00			
Rate VII	12:00	997.60	2592.00	105.10	1856.00	964.2	75.88	33.366
			2601.60					
	12:05	1057.70	3024.00	115.60	1902.00			
	12:10	1079.40	3024.00	126.10	1931.00			
Rate VIII	12:15	1102.30	3024.00	136.60	1954.00	1058.2	88.20	44.074
			3024.00					

