

NEW MEXICO OIL CONSERVATION COMMISSION
WELL LOCATION AND ACREAGE DEDICATION PLAT

Form O-102
Supersedes O-128
Effective 1-1-65

All distances must be from the outer boundaries of the Section

Operator Continental Oil Co.		Lease SEMU Burger Blinebry "B"		Well No. 99
Unit Letter F	Section 29	Township 20 South	Range 38 East	County Lea
Actual Footage Location of Well: 1980 feet from the North line and 1650 feet from the West line				
Ground Level Elev. 3525.0	Producing Formation Tubb & Blinebry	Pool West Warren Blinebry	Dedicated Acreage: 40 Acres	

- Outline the acreage dedicated to the subject well by colored pencil or hachure marks on the plat below.
- If more than one lease is dedicated to the well, outline each and identify the ownership thereof (both as to working interest and royalty).
- If more than one lease of different ownership is dedicated to the well, have the interests of all owners been consolidated by communitization, unitization, force-pooling, etc?

Yes No If answer is "yes," type of consolidation _____

If answer is "no," list the owners and tract descriptions which have actually been consolidated. (Use reverse side of this form if necessary.) _____

No allowable will be assigned to the well until all interests have been consolidated (by communitization, unitization, forced-pooling, or otherwise) or until a non-standard unit, eliminating such interests, has been approved by the Commission.

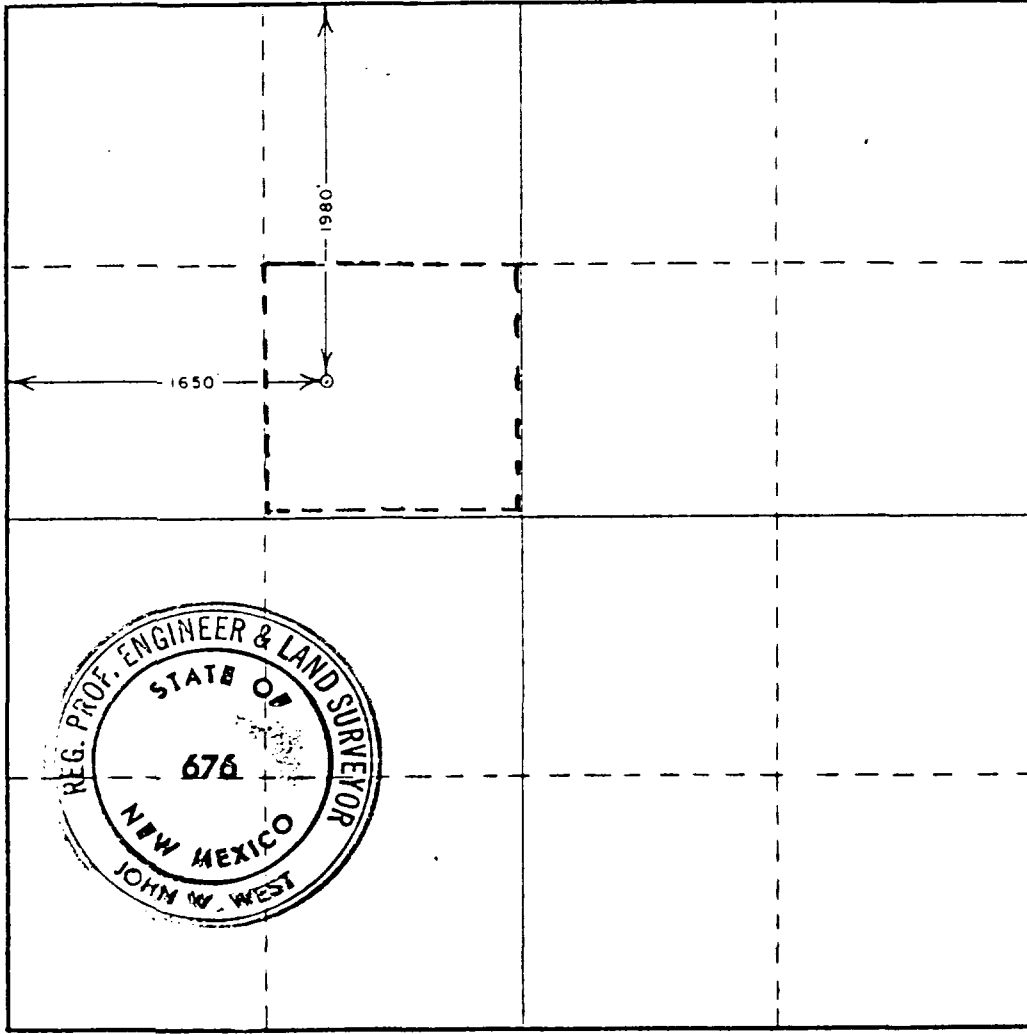

CERTIFICATION

I hereby certify that the information contained herein is true and complete to the best of my knowledge and belief.

Name
Wm. A. Tuttlefield
Position
ADMIN. SUPERV.
Company
CONTINENTAL OIL CO.
Date
JUNE 21, 1978

I hereby certify that the well location shown on this plat was plotted from field notes of actual surveys made by me or under my supervision, and that the same is true and correct to the best of my knowledge and belief.

Date Surveyed
May 30, 1978
Registered Professional Engineer and/or Land Surveyor
John W. West
Certificate No. **John W. West 676**
Ronald J. Eidson 3239

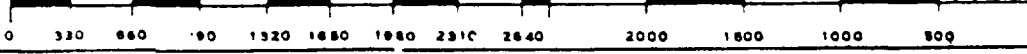

EXHIBIT 2-A

BEFORE EXAMINER CATANACH
OIL CONSERVATION DIVISION
EXHIBIT NO. **2-A**
CASE NO. **9971**
Submitted by **Conoco Inc.**
Hearing Date **6-27-90**

NEW MEXICO OIL CONSERVATION COMMISSION
WELL LOCATION AND ACREAGE DEDICATION PLAT

Form OCS-12
Supersedes OCS-1
Effective 1-1-65

All distances must be from the outer boundaries of the Section

Operator Continental Oil Co.		Lease SEMU Burger <u>Blinebry</u>		Well No. 101
Section Letter D	Section 29	Township 20 South	Range 38 East	County Lea
Actual Footage Location of Well: 660 feet from the North line and 330 feet from the West line				
Ground Level Elev. 3527.1	Producing Formation <u>Blinebry 3 Sand</u>	Pool <u>W. Warren 132</u> <u>Warren</u> <u>DEDICATED TUBING</u>		Dedicated Acreage: 40

- Outline the acreage dedicated to the subject well by colored pencil or hachure marks on the plat below.
- If more than one lease is dedicated to the well, outline each and identify the ownership thereof (both as to working interest and royalty).
- If more than one lease of different ownership is dedicated to the well, have the interests of all owners been consolidated by communitization, unitization, force-pooling, etc?

Yes No If answer is "yes," type of consolidation _____

If answer is "no," list the owners and tract descriptions which have actually been consolidated. (Use reverse side of this form if necessary.) _____

No allowable will be assigned to the well until all interests have been consolidated (by communitization, unitization, forced-pooling, or otherwise) or until a non-standard unit, eliminating such interests, has been approved by the Commission.

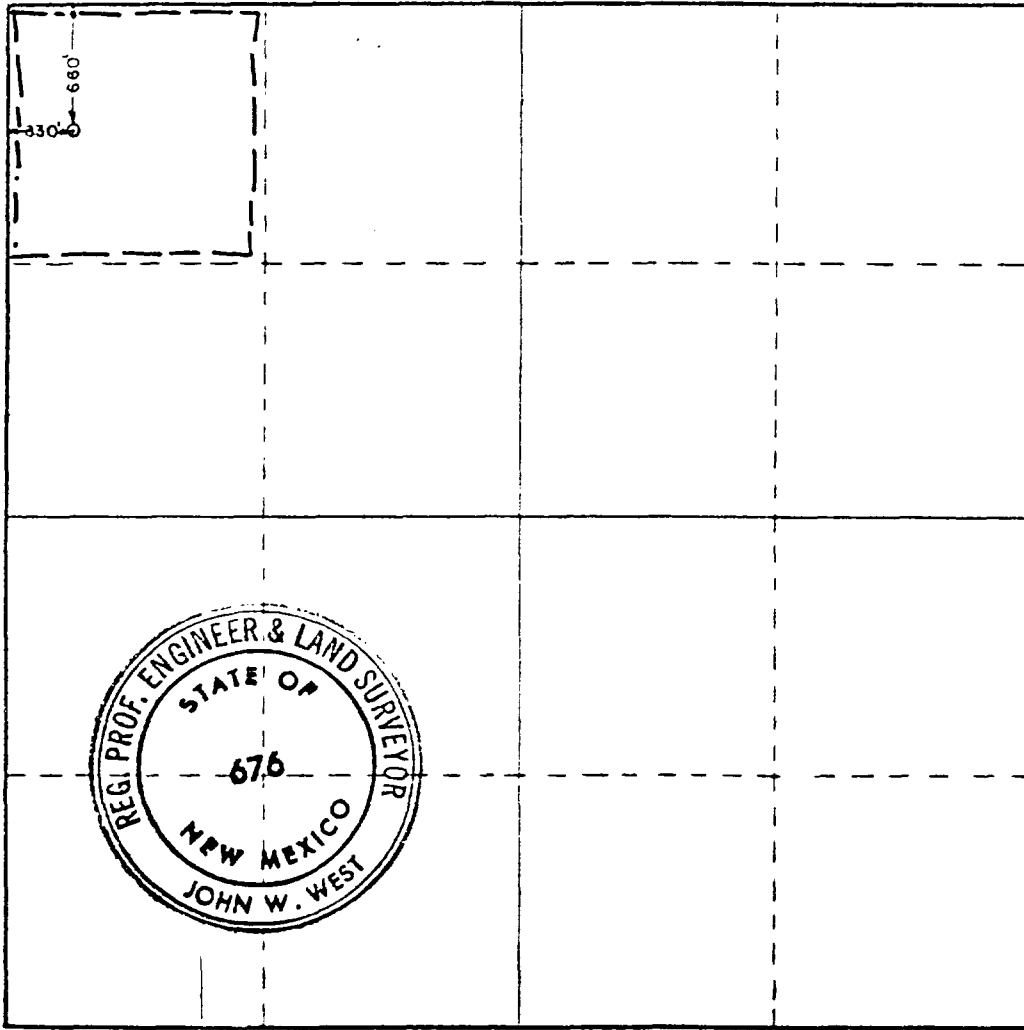

CERTIFICATION

I hereby certify that the information contained herein is true and complete to the best of my knowledge and belief.

Name
Ben A. Lee
Position
Administrative Supervisor
Company
Continental Oil Company
Date
November 30, 1978

I hereby certify that the well location shown on this plat was plotted from field notes of actual surveys made by me or under my supervision, and that the same is true and correct to the best of my knowledge and belief.

Date Surveyed
October 14, 1978
Registered Professional Engineer and/or Land Surveyor

John W. West
Certificate No. John W. West 676

0 330 660 990 1320 1650 1980 2310 2640 2970 3300

BEFORE EXAMINER CATANACH
OIL CONSERVATION DIVISION
EXHIBIT NO. 2-B
CASE NO. 9971
Submitted by Conoco Inc.
Hearing Date 6-27-90

EXHIBIT 2-B