

UNITED STATES
DEPARTMENT OF THE INTERIOR
BUREAU OF LAND MANAGEMENT

Sundry Notices and Reports on Wells

1. Type of Well GAS	5. Lease Number SF-078766
2. Name of Operator Meridian Oil Inc.	6. If Indian, All.or Tribe Name
3. Address & Phone No. of Operator Box 4289, Farmington, NM 87499 (505)326-9700	7. Unit Agreement Name Rosa Unit
4. Location of Well, Footage, Sec, T, R, M. 1640'N, 420'E Sec.22, T-31-N, R-6-W, NMPM	8. Well Name & Number Rosa Unit #201
	9. API Well No.
	10. Field and Pool Basin Fruitland Coal
	11. County and State Rio Arriba County, NM
12. CHECK APPROPRIATE BOX TO INDICATE NATURE OF NOTICE, REPORT, OTHER DATA	
Type of Submission	Type of Action
<input type="checkbox"/> Notice of Intent	<input type="checkbox"/> Abandonment
<input checked="" type="checkbox"/> Subsequent Report	<input type="checkbox"/> Recompletion
<input type="checkbox"/> Final Abandonment	<input type="checkbox"/> Plugging Back
	<input type="checkbox"/> Casing Repair
	<input type="checkbox"/> Altering Casing
	<input type="checkbox"/> Other
	<input type="checkbox"/> Change of Plans
	<input type="checkbox"/> New Construction
	<input type="checkbox"/> Non-Routine Fracturing
	<input type="checkbox"/> Water Shut Off
	<input type="checkbox"/> Conversion to Injection

13. Describe Proposed or Completed Operations

Attached is a revised copy of the C-102 showing the resurveyed footages for this well. This resurvey was conducted by Meridian Oil Inc. to verify or correct the location of the stake as reported in the Northwest Pipeline APD. The location of the well has not moved, only the footages describing the staked location have been corrected.

NWPL survey 1230'N, 1330'E
MOI survey 1640'N, 420'E

ACCEPTED FOR RECORD
FARMINGTON RESOURCE AREA

Examiner _____
Case No. 10040
EXHIBIT NO. 3

MAR 29 1990

FARMINGTON, NEW MEXICO
BY [Signature]

14. I hereby certify that the foregoing is true and correct
Signed [Signature] Title Regulatory Affairs Date 3-28-90

(This space for Federal or State office use)

APPROVED BY _____ TITLE _____ DATE _____
CONDITION OF APPROVAL, IF ANY:
OPERATOR

OIL CONSERVATION DIVISION

DISTRICT I
P.O. Box 1980, Hobbs, NM 88240

P.O. Box 2088

Santa Fe, New Mexico 87504-2088

DISTRICT II
P.O. Drawer DD, Artesia, NM 88210

DISTRICT III
1000 Rio Brazos Rd., Aztec, NM 87410

WELL LOCATION AND ACREAGE DEDICATION PLAT

All Distances must be from the outer boundaries of the section

Operator Meridian Oil Inc.		Lease Rosa Unit		Well No. 201	
Unit Letter H	Section 22	Township 31 North	Range 6 West	County Rio Arriba	
Actual Footage Location of Well: 1640 feet from the North line and 420 feet from the East line					
Gross level Elev. 6250'	Producing Formation Fruitland Coal		Pool Basin	Dedicated Acreage: 320 Acres	

- Outline the acreage dedicated to the subject well by colored pencil or hectare marks on the plat below.
- If more than one lease is dedicated to the well, outline each and identify the ownership thereof (both as to working interest and royalty).
- If more than one lease of different ownership is dedicated to the well, have the interest of all owners been consolidated by communitization, unitization, force-pooling, etc.?
☒ Yes ☐ No If answer is "yes" type of consolidation unitization
If answer is "no" list the owners and tract descriptions which have actually been consolidated. (Use reverse side of this form if necessary).
No allowable will be assigned to the well until all interests have been consolidated (by communitization, unitization, forced-pooling, or otherwise) or until a non-standard unit, eliminating such interest, has been approved by the Division.

	OPERATOR CERTIFICATION I hereby certify that the information contained herein is true and complete to the best of my knowledge and belief. <i>Peggy Bradfield</i> Signature Peggy Bradfield Printed Name Regulatory Affairs Position Meridian Oil Inc. Company 3-28-98 Date
	SURVEYOR CERTIFICATION I hereby certify that the well location shown on this plat was plotted from field notes of actual surveys made by me or under my supervision, and that the same is true and correct to the best of my knowledge and belief. 11-15-89 Date Surveyed Noble C. Edwards Signature of Seal of Professional Surveyor 6857 Certificate No.

Submit 3 Copies
Appropriate District Office
DISTRICT I
P.O. Box 1980, Hobbs, NM 88240

DISTRICT II
P.O. Drawer DD, Artesia, NM 88210

DISTRICT III
1000 Rio Brazos Rd., Aztec, NM 87410

State of New Mexico
Energy, Minerals and Natural Resources Department

OIL CONSERVATION DIVISION

P.O. Box 2088
Santa Fe, New Mexico 87504-2088

R

Form C-104
Revised 1-1-89
See Instructions
at Bottom of Page

OIL CON. DIV.
DIST. 3.

REQUEST FOR ALLOWABLE AND AUTHORIZATION TO TRANSPORT OIL AND NATURAL GAS

Operator <u>Meridian Oil Inc. New Pipeline</u>		Well APN No. 30-039-24392
Address PO Box 4289, Farmington, NM 87499		NORTHWEST PIPELINE COMPLETION JAN 19 1990
Reason(s) for Filing (Check proper box) <input type="checkbox"/> Other (Please explain)		
New Well <input checked="" type="checkbox"/>	Change in Transporter of: Oil <input type="checkbox"/> Dry Gas <input type="checkbox"/> Casinghead Gas <input type="checkbox"/> Condensate <input type="checkbox"/>	
Recompletion <input type="checkbox"/>		
Change in Operator <input type="checkbox"/>		
If change of operator give name and address of previous operator		PRODUCTION AND DRILLING

II. DESCRIPTION OF WELL AND LEASE

Lease Name Rosa Unit	Well No. 201	Pool Name, including Formation Basin Fruitland Coal	Kind of Lease State, Federal or Fee	Lease No. SF-078766
Location Unit Letter <u>B</u> : <u>1230</u> Foot From The <u>North</u> Line and <u>1330</u> Foot From The <u>East</u> Line Section <u>22</u> Township <u>31N</u> Range <u>6W</u> , NMPM, Rio Arriba County				

III. DESIGNATION OF TRANSPORTER OF OIL AND NATURAL GAS

Name of Authorized Transporter of Oil <input type="checkbox"/> or Condensate <input checked="" type="checkbox"/>	Address (Give address to which approved copy of this form is to be sent) <u>Meridian Oil Inc.</u> <u>PO Box 4289, Farmington, NM 87499</u>	
Name of Authorized Transporter of Casinghead Gas <input type="checkbox"/> or Dry Gas <input checked="" type="checkbox"/>	Address (Give address to which approved copy of this form is to be sent) <u>Northwest Pipeline</u> <u>3539 E. 30th, Farmington, NM 87401</u>	
If well produces oil or liquids, give location of tanks.	Unit <u>B</u>	Sec. <u>22</u>
	Twp. <u>31N</u>	Rge. <u>6W</u>
	Is gas actually connected? <input type="checkbox"/> When?	

If this production is commingled with that from any other lease or pool, give commingling order number:

IV. COMPLETION DATA

Designate Type of Completion - (X)	Oil Well	Gas Well	New Well	Workover	Deepen	Plug Back	Same Res'v	Diff Res'v
		X	X					
Date Spudded 10-18-89	Date Compl. Ready to Prod. 11-06-89		Total Depth 3083'		P.B.T.D.			
Elevations (DF, RKB, RT, GR, etc.) 6240' GL	Name of Producing Formation Fruitland Coal		Top Oil/Gas Pay 2905'		Tubing Depth 3058'			
Performances 2905-3081' (predrilled liner)					Depth Casing Shoe			
TUBING, CASING AND CEMENTING RECORD								
HOLE SIZE	CASING & TUBING SIZE		DEPTH SET		SACKS CEMENT			
12 1/4"	9 5/8"		227'		177 cu. ft.			
8 3/4"	7"		2918'		887 cu. ft.			
6 1/4"	5 1/2"		3082'		did not cmt			
	2 3/8"		3058'					

V. TEST DATA AND REQUEST FOR ALLOWABLE

OIL WELL (Test must be after recovery of total volume of load oil and must be equal to or exceed top allowable for this depth or be for full 24 hours.)

Date First New Oil Run To Tank	Date of Test	Producing Method (Flow, pump, gas lift, etc.)	
Length of Test	Tubing Pressure	Casing Pressure	Choke Size
Actual Prod. During Test	Oil - Bbls.	Water - Bbls.	Gas - MCF

GAS WELL

Actual Prod. Test - MCF/D	Length of Test	Bbls. Condensate/MMCF	Gravity of Condensate
Testing Method (pilot, back pr.) Backpressure	Tubing Pressure (Shut-in) SI 1252	Casing Pressure (Shut-in) SI 1559'	Choke Size

VI. OPERATOR CERTIFICATE OF COMPLIANCE.

I hereby certify that the rules and regulations of the Oil Conservation Division have been complied with and that the information given above is true and complete to the best of my knowledge and belief.

Peggy Bradfield
Signature
Peggy Bradfield
Printed Name
12-8-89
Date
326-9700
Telephone No.

Req. Affairs

Title

Telephone No.

OIL CONSERVATION DIVISION

Date Approved JAN 08 1990

By [Signature]

Title SUPERVISOR DISTRICT 3

INSTRUCTIONS: This form is to be filed in compliance with Rule 1104

- 1) Request for allowable for newly drilled or deepened well must be accompanied by tabulation of deviation tests taken in accordance with Rule 111.
- 2) All sections of this form must be filled out for allowable on new and recompleted wells.
- 3) Fill out only Sections I, II, III, and VI for changes of operator, well name or number, transporter, or other such changes.
- 4) Section Form C-104 must be filed for each well in multiply completed wells.

UNITED STATES
DEPARTMENT OF THE INTERIOR
BUREAU OF LAND MANAGEMENT

(Other instructions on
reverse side)

Budget Bureau No. 1004-0136
Expires August 31, 1985

APPLICATION FOR PERMIT TO DRILL, DEEPEN, OR PLUG BACK

1a. TYPE OF WORK

DRILL ☒

DEEPEN ☐

PLUG BACK ☐

b. TYPE OF WELL

OIL
WELL ☐

GAS
WELL ☒

OTHER

SINGLE
ZONE ☒

MULTIPLE
ZONE ☐

2. NAME OF OPERATOR

Northwest Pipeline Corporation

3. ADDRESS OF OPERATOR

3539 E. 30th Street - Farmington, NM 87401

4. LOCATION OF WELL (Report location clearly and in accordance with any State requirements.)*

At surface

1230' ENL & 1330' FEL NW/4 NE/4

At proposed prod. zone

Same

14. DISTANCE IN MILES AND DIRECTION FROM NEAREST TOWN OR POST OFFICE*

Approximately 20 miles to Gobernador

15. DISTANCE FROM PROPOSED*

LOCATION TO NEAREST
PROPERTY OR LEASE LINE, FT.
(Also to nearest drilg. unit line, if any)

1230'

16. NO. OF ACRES IN LEASE

NW 2 35 2.71

17. NO. OF ACRES ASSIGNED
TO THIS WELL

320

18. DISTANCE FROM PROPOSED LOCATION*

TO NEAREST WELL, DRILLING, COMPLETED,
OR APPLIED FOR, ON THIS LEASE, FT.

+ 4000'

19. PROPOSED DEPTH

3069'

20. ROTARY OR CABLE TOOL

Rotary

21. ELEVATIONS (Show whether DE, RT, GR, etc.)

6240' GR

This action is subject to technical and
procedural review pursuant to 43 CFR 3105.1

22. APPROX. DATE WORK WILL START*

March 1, 1989

23. AND appeal pursuant to PROPOSALING AND CEMENTING PROGRAM

DRILLING OPERATIONS AUTHORIZED ARE
SUBJECT TO THE ATTACHED
"GENERAL QUANTITY OF CEMENT"

SIZE OF HOLE	SIZE OF CASING	WEIGHT PER FOOT	SETTING DEPTH	GENERAL QUANTITY OF CEMENT
12-1/4"	9-5/8"	32#	200'	125 cu. ft.
8-3/4"	7"	20#	2909'	156 cu. ft.
6-1/4"	5-1/2"	23#	3069'	Open hole completion

The E/2 of Section 22 is dedicated to this well.

RECEIVED
BLM MAIL ROOM

88 DEC 20 AM 11:42

FARMINGTON RESOURCE AREA
FARMINGTON, NEW MEXICO

NORTHWEST PIPELINE
CORPORATION

APR 17 1989

PRODUCTION AND DRILLING

IN ABOVE SPACE DESCRIBE PROPOSED PROGRAM: If proposal is to deepen or plug back, give data on present productive zone and proposed new productive zone. If proposal is to drill or deepen directionally, give pertinent data on subsurface locations and measured and true vertical depths. Give blowout preventer program, if any.

24.

SIGNED

Mike Turnbaugh

TITLE

Senior Engineer

DATE

12-19-88

(This space for Federal or State office use)

PERMIT NO.

APPROVAL DATE

APPROVED BY

TITLE

CONDITIONS OF APPROVAL, IF ANY:

ch-1

OPERATOR

API 30-039-24392

*See Instructions On Reverse Side

Title 18 U.S.C. Section 1001, makes it a crime for any person knowingly and willfully to make to any department or agency of the United States any false, fictitious or fraudulent statements or representations as to any matter within its jurisdiction.

All distances must be from the outer boundaries of the Section.

Operator Northwest Pipeline Corporation			Lease Rosa Unit		Well No. 201
Unit Letter B	Section 22	Township 31 North	Range 6 West	County RIO ARriba	
Actual Footage Location of Well:					
1230 feet from the North		line and 1330 feet from the East		line	
Ground Level Elev. 6240	Producing Formation Fruitland		Pool Basin Fruitland Pool		Dedicated Acreage: 320 Acre

1. Outline the acreage dedicated to the subject well by colored pencil or hachure marks on the plat below.
2. If more than one lease is dedicated to the well, outline each and identify the ownership thereof (both as to working interest and royalty).
3. If more than one lease of different ownership is dedicated to the well, have the interests of all owners been consolidated by communitization, unitization, force-pooling, etc?

☒ Yes ☐ No If answer is "yes," type of consolidation unitization

If answer is "no," list the owners and tract descriptions which have actually been consolidated. (Use reverse side of this form if necessary.)

No allowable will be assigned to the well until all interests have been consolidated (by communitization, unitization, forced-pooling, or otherwise) or until a non-standard unit, eliminating such interests, has been approved by the Division

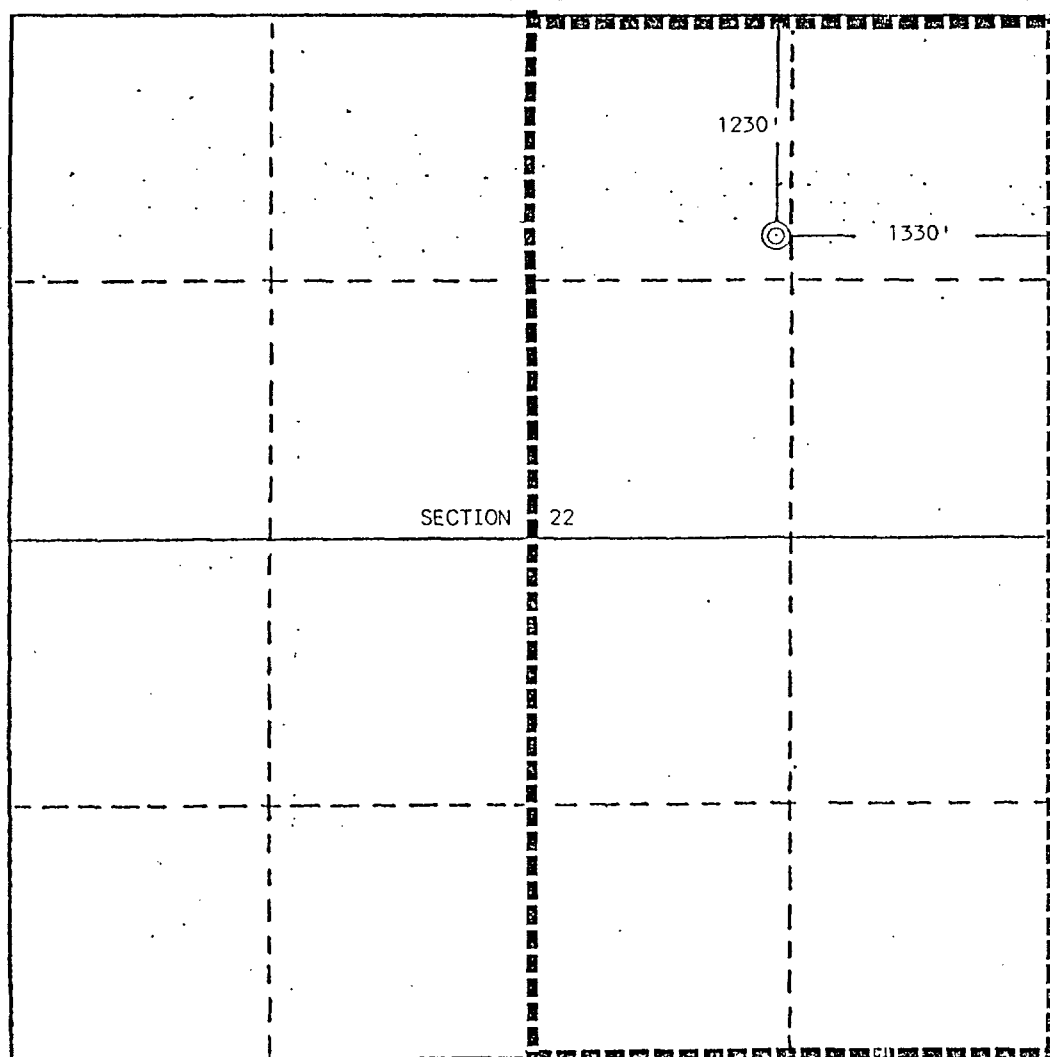

CERTIFICATION

I hereby certify that the information contained herein is true and complete to the best of my knowledge and belief.

Mike Turnbaugh
Name

Mike Turnbaugh
Position

Senior Engineer
Company

Northwest Pipeline Corp.
Company

10-31-88
Date

I hereby certify that the well location shown on this plat was placed from field notes of actual EGG made by me or under my supervision, and that the same is true and correct to the best of my knowledge and belief.

October 10, 1988
Date Surveyed

Edgar L. Risenhoover, I.S.
Registered Professional Engineer and/or Land Surveyor

Edgar L. Risenhoover, I.S.
Certificate No. 5979

Edgar L. Risenhoover, I.S.