

## OIL CONSERVATION DIVISION

**DISTRICT I**  
P.O. Box 1900, Hobbs, NM 88240

**P.O. Box 2088**

**Santa Fe, New Mexico 87504-2088**

**DISTRICT II**  
P.O. Drawer DD, Artesia, NM 88210

**DISTRICT III**  
1000 Rio Emmon Rd., Aztec, NM 87410

# WELL LOCATION AND ACREAGE DEDICATION PLAT

**All Distances must be from the outer boundaries of the section**

Operator CHEVRON USA INC.		Lease A. B. Reeves		Well No. 4
Unit Letter J	Section 29	Township 20 South	Range 37 East	County Lea
Actual Footage Location of Well: 1880 feet from the South line and 1980 feet from the East line				
Ground level Elev. 3519.9	Producing Formation Queen/Penrose	Pool Eumont Gas	Dedicated Acreage: 320 Acres	

1. Outline the acreage dedicated to the subject well by colored pencil or machine marks on the plat below.
2. If more than one lease is dedicated to the well, outline each and identify the ownership thereof (both as to working interest and royalty).
3. If more than one lease of different ownership is dedicated to the well, have the interest of all owners been consolidated by communitization, unitization, force-pooling, etc.?
- ☐ Yes      ☐ No      If answer is "yes" type of consolidation \_\_\_\_\_
- If answer is "no" list the owners and tract descriptions which have actually been consolidated. (Use reverse side of this form if necessary.) \_\_\_\_\_
- No allowable will be assigned to the well until all interests have been consolidated (by communitization, unitization, forced-pooling, or otherwise) or until a non-standard unit, eliminating such interest, has been approved by the Division.

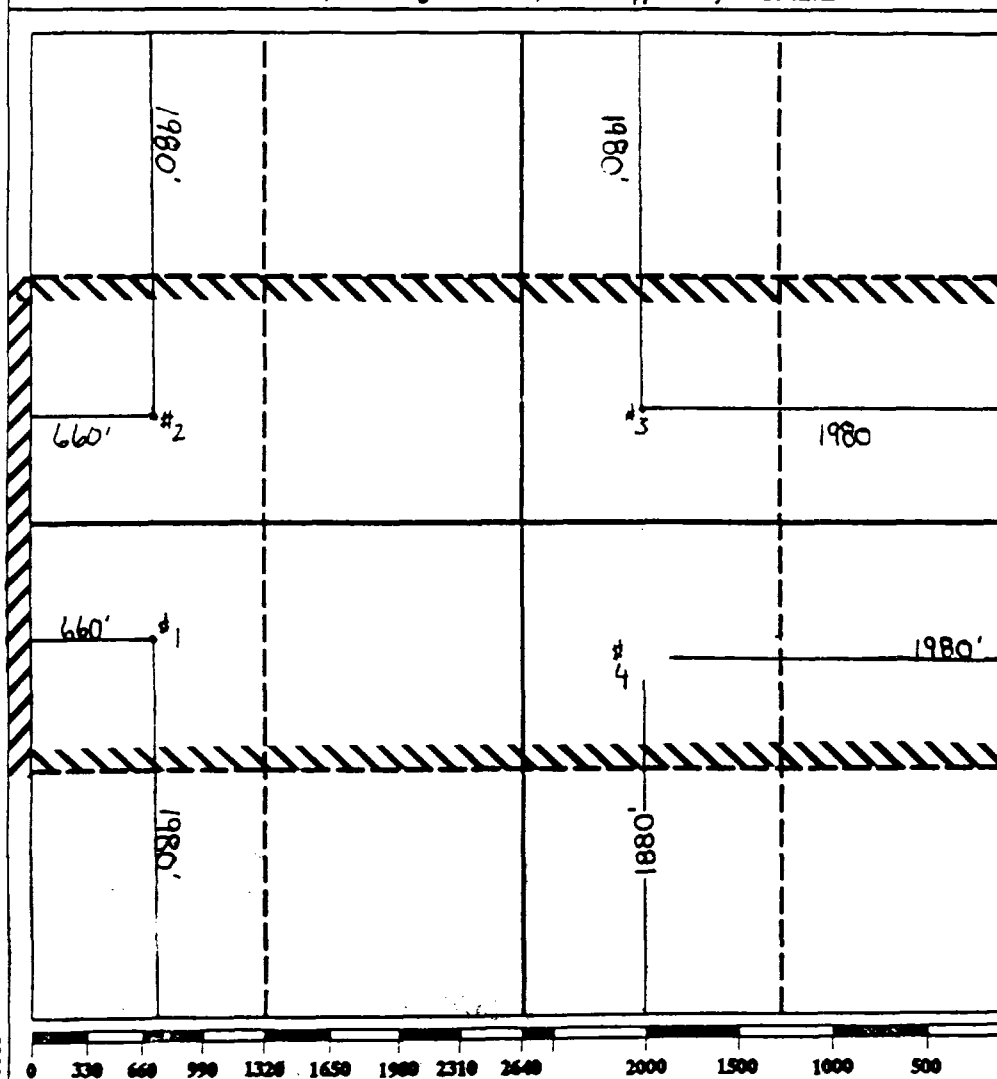

### OPERATOR CERTIFICATION

I hereby certify that the information contained herein is true and complete to the best of my knowledge and belief.

**Summary**

E. O. Doherty  
Printed Name

Printed Name \_\_\_\_\_

T.A. Delg

**Position**

CHEURON U.S.A. Inc  
Company

**D**

10/1/90

### SURVEYOR CERTIFICATION

I hereby certify that the well location shown on this plat was plotted from field notes of actual surveys made by me or under my supervision, and that the same is true and correct to the best of my knowledge and belief.

Data Surveyed

August 15, 1990

**Signature & Seal of  
Professional Surveyor**

PROFESSIONAL SURVEYOR  
Certificate No. JOHN W. WEST  
RONALD E. EIDSON

078

3239

**BEFORE EXAMINER CATANACH**  
**OIL CONSERVATION DIVISION**

CHEJEZON EXHIBIT NO. 3

CASE NO. 10153