

Quintero
BEFORE EXAMINER STOGNER
OIL CONSERVATION DIVISION
Amoco EXHIBIT NO. 1
 CASE NO. B204

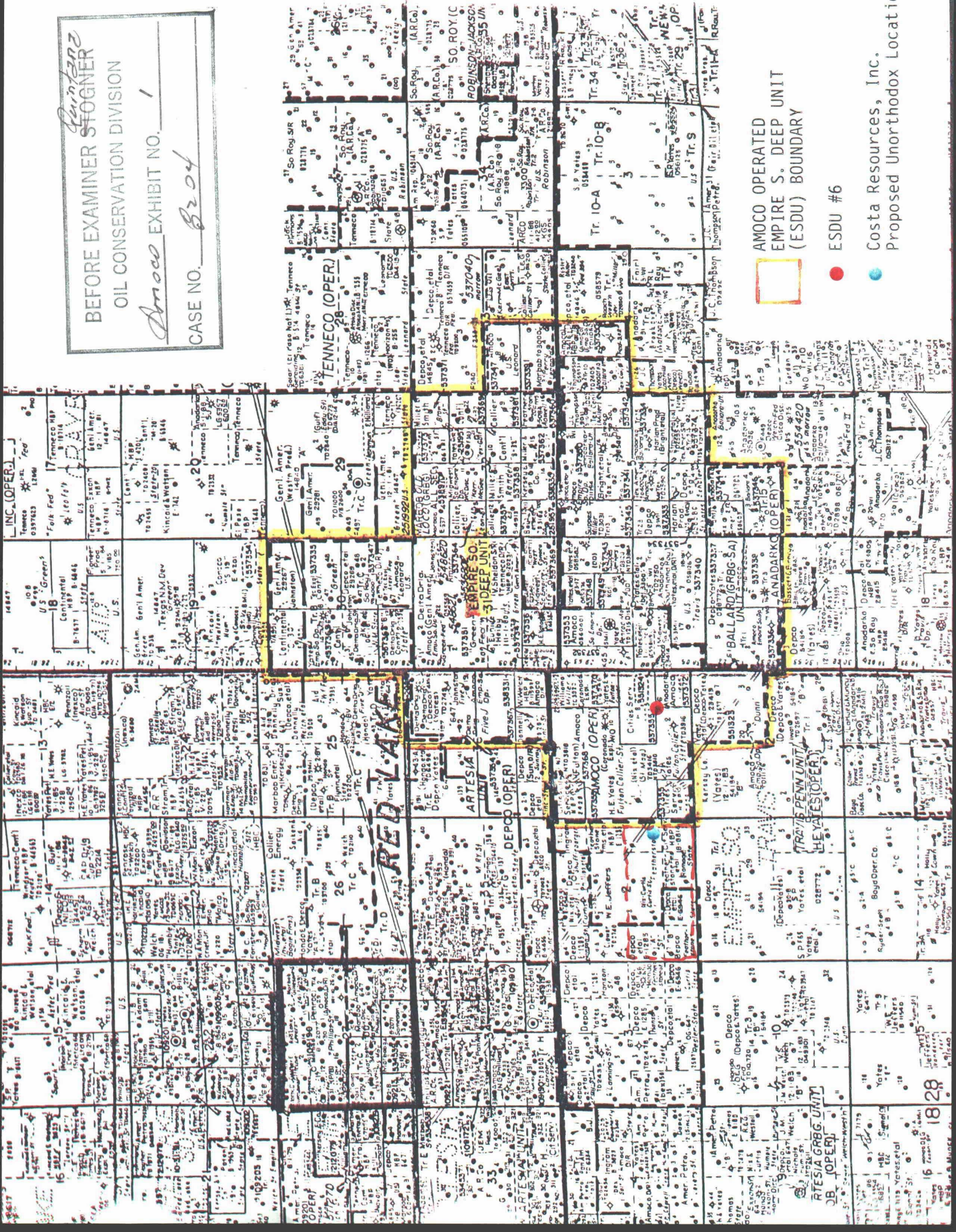

AMOCO OPERATED
 EMPIRE S. DEEP UNIT
 (ESDU) BOUNDARY



ESDU #6

Costa Resources, Inc.
 Proposed Unorthodox Locati

18 28

18 28

18 28