

MONTGOMERY & ANDREWS
PROFESSIONAL ASSOCIATION
ATTORNEYS AND COUNSELORS AT LAW

J. O. Seth (1883-1963)
Frank Andrews (1914-1981)

A. K. Montgomery
Seth D. Montgomery
Frank Andrews III
Victor R. Ortega
John E. Conway
Jeffrey R. Brannen
John B. Pound
Gary R. Kilpatric
Thomas W. Olson
William C. Madison
Walter J. Melendres
Bruce L. Herr
Michael W. Brennan
Robert P. Worcester
John B. Draper
Nancy M. Anderson
Janet McL. McKay

Jean-Nikole Wells
Mark F. Sheridan
Joseph E. Earnest
Stephen S. Hamilton
Phyllis A. Dow
Wm. Alan Wright
Brad V. Coryell
Wesley B. Howard, Jr.
Thurman W. Moore III
Michael H. Harbour
John M. Hickey
Timothy L. Butler
Mack E. With
Galen M. Builer
Katherine A. Weeks
Edmund H. Kendrick

June 19, 1984

HAND DELIVERED

SANTA FE OFFICE
325 Paseo de Peralta
Post Office Box 2307
Santa Fe, New Mexico 87504-2307

Telephone (505) 982-3873
Telecopy (505) 982-4289

ALBUQUERQUE OFFICE
Suite 200
500 Copper Avenue, N.W.
Post Office Box 2048
Albuquerque, New Mexico 87103-2048

Telephone (505) 242-9677

REPLY TO SANTA FE OFFICE

Mr. Perry Pearce
General Counsel
Oil Conservation Commission
Energy & Minerals Department
State Land Office
Santa Fe, New Mexico 87504

Re: Application of Shell Western E & P Inc.
Before the OCC

Dear Perry:

Per our discussion today, I am attaching information forming the basis for a verbal application under Rule 1203 of OCD Rules and Regulations. Mr. Fredette or I will be in touch with you tomorrow to inform you whether Shell wishes to place the newspaper notices required for a July 11, 1984 hearing.

Thank you for your consideration in this matter.

Sincerely,

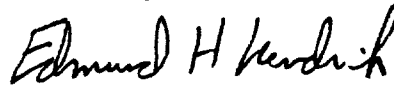

Edmund H. Kendrick

EHK:gar
Enclosure
#2355-84-01
cc: Mr. Mike Fredette

Applicant: Shell Western E&P Inc.

Unit (or Lease): North Hobbs (Grayburg-San Andres) Unit

Pool: Hobbs (Grayburg-San Andres) Pool,
Lea County, New Mexico

Wells: Proposed locations listed on attachment

Application: 38 Infill Wells

(A) For each well:

- (1) Well is necessary to effectively and efficiently drain a portion of the reservoir covered by the proration unit which cannot be so drained by any existing well within that unit.
- (2) Approval of unorthodox location.

(B) For wells indicated by asterisk:
permission to directionally drill.

OFFSET OPERATORS: Amoco Production Company (USA)
P.O. Box 3092
Houston, TX 77253

Moramco
P.O. Box 1860
Hobbs, NM 88240

GAS PURCHASER: Phillips Petroleum Co.
Attn: Laws and Regulations
336 H.S. & L. Building
Bartlesville, OK 74004

STAKING LOCATIONS
NORTH HOBBS (G/SA UNIT INFILL)
Lea County, NM

<u>Well No.</u>	<u>Location</u>	<u>Sec.</u>	<u>TWP</u>	<u>RNG</u>
13-342	1200' FSL, 2500' FEL	13	18S	37E
13-442	1200' FSL, 220' FEL	13	18S	37E
24-312	10' FNL, 2630' FEL	24	18S	37E
24-414	10' FNL, 1280' FEL	24	18S	37E
19-212	1460' FWL, 160' FNL	19	18S	38E
24-432	1280' FEL, 2480' FSL	24	18S	37E
19-232	1390' FWL, 2795' FNL	19	18S	38E
20-132	180' FWL, 2490' FSL	20	18S	38E
24-442	200' FEL, 1260' FSL	24	18S	37E
19-332	2680' FWL, 1430' FSL	19	18S	38E
24-213	2620' FWL, 1280' FNL	24	18S	37E
29-442	170' FEL, 1230' FSL	29	18S	38E
* 28-242	Suf 2014' FWL, 1163' FSL Bhl 2400' FWL, 1100' FSL	28	18S	38E
30-242	1400' FWL, 200' FSL	30	18S	38E
30-444	215' FSL, 1255' FEL	30	18S	38E
32-312	1400' FEL, 210' FNL	32	18S	38E
* 33-312	Suf 1830' FEL, 110' FNL Bhl 1330' FEL, 10' FNL	33	18S	38E
32-422	110' FEL, 1385' FNL	32	18S	38E

<u>Well No.</u>	<u>Location</u>	<u>Sec.</u>	<u>TWP</u>	<u>RNG</u>
33-212	1420' FWL, 205' FNL	33	18S	38E
31-422	2259' FNL, 600' FEL	31	18S	38E
32-223	1410' FWL, 2630' FNL	32	18S	38E
32-423	1280' FEL, 2540' FNL	32	18S	38E
33-323	1420' FEL, 2495' FNL	33	18S	38E
32-143	300' FWL, 1185' FSL	32	18S	38E
32-332	2350' FEL, 1550' FSL	32	18S	38E
33-242	2530' FWL, 1280' FSL	33	18S	38E
19-442	380' FEL, 1100' FSL	19	18S	38E
24-342	145' FSL, 1435' FEL	24	18S	38E
30-112	200' FNL, 1310' FWL	30	18S	38E
* 30-312	Suf 500' FNL, 1448' FEL Bhl 20' FNL, 1268' FEL	30	18S	38E
30-113	1310' FNL, 195' FWL	30	18S	38E
29-322	2350' FEL, 1430' FNL	29	18S	38E
28-122	200' FWL, 1592' FNL	28	18S	38E
30-233	1480' FWL, 2455' FSL	30	18S	38E
30-332	1600' FEL, 2470' FSL	30	18S	38E
30-432	180' FEL, 2260' FSL	30	18S	38E
29-323	2500' FEL, 2540' FNL	29	18S	38E
29-122	180' FWL, 1600' FNL	29	18S	38E

* Directional

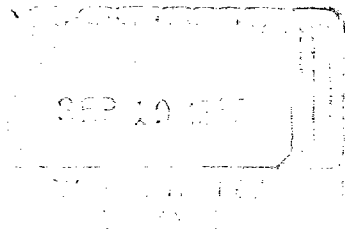

Shell Western E&P Inc.

A Subsidiary of Shell Oil Company



September 17, 1985

P.O. Box 576
Houston, TX 77001

State of New Mexico
Energy and Minerals Department
Oil Conservation Division
ATTN Mr. Michael E. Stogner
P. O. Box 2088
Santa Fe, NM 87501

Gentlemen:

SUBJECT: SUPPLEMENTAL INFORMATION
SHELL WESTERN E&P INC. -
N. HOBBS (G/SA) UNIT #213-C
33-18S-38E, LEA COUNTY, NM
SECTION APPLIED FOR - 103
DATE RECEIVED - APRIL 19, 1985

Per our telephone conversation this date regarding the subject well, attached please find the letter we discussed, whereby we requested that the proposed injector, Sec. 33, Well No. 212 be omitted from Exhibit "A" and the subject well be added.

If additional information is required, please contact Debbie Upson (713) 870-3811.

Yours very truly,

Debbie Upson
Senior Clerk

DMU

Attachments

BNBG8526004

Shell Western E&P Inc.

A Subsidiary of Shell Oil Company



P.O. Box 991
Houston, TX 77001

September 7, 1984

State of New Mexico
Energy and Minerals Department
Oil Conservation Division
P. O. Box 2088
Santa Fe, NM 87501

Gentlemen:

SUBJECT: UNORTHODOX WELL LOCATIONS
ORDER NO. R-7628
SHELL WESTERN E&P INC. - NORTH HOBBS (G/SA) UNIT
T-18-S, R-38-E, NMPM
LEA COUNTY, NEW MEXICO

Shell Western E&P Inc., as operator of the North Hobbs Unit, respectfully requests approval of the following revisions to Exhibit "A" of Order No. R-7628, entered in Case No. 8263:

<u>Original Location</u>	<u>Amended Location</u>	<u>Reason for Change</u>
Sec. 19, Well No. 232 Unit Letter K 2795' FNL & 1390' FWL	2501' FSL & 1390' FWL	Moved 16' north due to safety and topographic considerations.
Sec. 28, Well No. 122 Unit Letter E 1592' FNL & 200' FWL	1579' FNL & 211' FWL	Moved 13' north and 11' east due to safety and topographic considerations.
Sec. 33, Well No. 212 Unit Letter C 205' FNL & 1420' FWL	N/A	Proposed injector - should be omitted from Exhibit "A".
Sec. 33, Well No. 213 Unit Letter C 1300' FNL & 2455' FWL	N/A	Proposed producer - should be added to Exhibit "A".
Sec. 33, Well No. 323 Unit Letter G 2495' FNL & 1420' FEL	2525' FNL & 1453' FEL	Moved 30' south and 33' west due to safety and topographic considerations.

SL-1952
M. Hooper
MOVED 12-8-84

Please find the attached plat indicating the locations of the subject wells. If additional information is required, please advise.

Yours very truly,

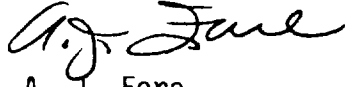

A. J. Fore
Supervisor Regulatory and Permitting
Mid-Continent Division

JMW

Attachment

cc: New Mexico Oil Conservation Division - Hobbs, NM



STATE OF NEW MEXICO
ENERGY AND MINERALS DEPARTMENT
OIL CONSERVATION DIVISION

December 6, 1984

TONEY ANAYA
GOVERNOR

POST OFFICE BOX 2088
STATE LAND OFFICE BUILDING
SANTA FE, NEW MEXICO 87501
(505) 827-5800

Shell Western E & P Inc.
P. O. Box 991
Houston, Texas 77001

Attention: A. J. Fore

Administrative Order NSL-1952

Gentlemen:

Reference is made to your application for a non-standard location for your North Hobbs (G/SA) Unit Well No. 213 to be located 1300 feet from the North line and 2455 feet from the West line of Section 33, Township 18 South, Range 38 East, NMPM, Lea County, New Mexico.

By authority granted me under the provisions of Rule 7 of Division Order No. R-6199, the above-described unorthodox location is hereby approved.

Sincerely,

R. L. STAMETS, DIRECTOR

RLS/MS/dp

cc: Oil Conservation Division - Hobbs
Oil & Gas Engineering Committee - Hobbs



STATE OF NEW MEXICO
ENERGY AND MINERALS DEPARTMENT
OIL CONSERVATION DIVISION

TONEY ANAYA
GOVERNOR

February 28, 1985

POST OFFICE BOX 2088
STATE LAND OFFICE BUILDING
SANTA FE, NEW MEXICO 87501
(505) 827-5800

Shell Western E & P Inc.
P. O. Box 991
Houston, Texas 77001

Attention: A. J. Fore, Supervisor

Subject: Order No. R-7628
Unorthodox Well Location Change
North Hobbs (G/SA) Unit
T18S, R38E, NMPM
Lea County, New Mexico

Dear Mr. Fore:

Your request to move Section 33 Well No. 242 to a new unorthodox location because of surface use restrictions has been reviewed. Since this well is at a less unorthodox location, approval will be granted for the amended location noted below. This change requires a renumbering of the well.

Original Location

Sec. 33 Well No. 242
1280' FSL & 2530' FWL

Amended Location

Sec. 33 Well No. 234
1372' FSL & 2563' FWL

Sincerely,

R. L. STAMETS
Director

RLS/fd

cc: Case File 8263
Hobbs District Office

Shell Western E&P Inc.

A Subsidiary of Shell Oil Company



P.O. Box 991
Houston, TX 77001

February 25, 1985

*Case 8263
Stamets*

State of New Mexico
Energy and Minerals Department
Oil Conservation Division
P.O. Box 2088
Santa Fe, NM 87501

Gentlemen:

SUBJECT: UNORTHODOX WELL LOCATIONS
ORDER NO. R-7628
SHELL WESTERN E&P INC. - NORTH HOBBS (G/SA) UNIT
T-18-S, R-38-E, NMPM
LEA COUNTY, NEW MEXICO

Shell Western E&P Inc., as operator of the North Hobbs Unit, hereby advises you that due to surface use restrictions, it has become necessary to move well number 33-242 to a new location. To be consistent with our numbering system, this new location will require a revised well number. The previously approved and proposed locations are shown below.

<u>Original Location</u>	<u>Amended Location</u>
Sec. 33, Well No. 242	Sec. 33, Well No. 234
Unit Letter N	Unit Letter K
1280' FSL & 2530' FWL	1372' FSL & 2563' FWL

The certified plat submitted with this request indicates the revised location.

NMOCD Order No. R-7628 granted approval of our application to drill 35 wells at unorthodox locations. As stated in our original application, these producers will be located less than the minimum 330 feet from 40-acre proration unit boundaries, but are orthodox in all other respects.

Inasmuch as the basis of our original application remains unchanged, we recommend your approval of Shell's proposal to drill this infill producer at the amended, more unorthodox location as shown above.

We apologize for any inconvenience caused by this change.

Yours very truly,

A. J. Fore
Supervisor Regulatory
and Permitting
Production Administration
Mid-Continent Division

JMW

Attachment

cc: New Mexico Oil Conservation Division - Hobbs, NM

NEW MEXICO OIL CONSERVATION COMMISSION
WELL LOCATION AND ACREAGE DEDICATION PLAT

Form C-102
Supersedes C-128
Effective 1-1-65

All distances must be from the outer boundaries of the Section.

Operator SHELL WESTERN E. & P., INC.		Lease NORTH HOBBS UNIT SECTION 33		Well No. 234
Unit Letter K	Section 33	Township 18 SOUTH	Range 38 EAST	County LEA
Actual Footage Location of Well: 1372 feet from the SOUTH line and 2563 feet from the WEST line				
Ground Level Elev. 3633.0	Producing Formation GRAYBURG/SAN ANDRES	Pool HOBBS (GRAYBURG/SAN ANDRES)	Dedicated Acreage: 40 Acres	

1. Outline the acreage dedicated to the subject well by colored pencil or hachure marks on the plat below.
2. If more than one lease is dedicated to the well, outline each and identify the ownership thereof (both as to working interest and royalty).
3. If more than one lease of different ownership is dedicated to the well, have the interests of all owners been consolidated by communitization, unitization, force-pooling, etc?

Yes No If answer is "yes," type of consolidation UNITIZATION

If answer is "no," list the owners and tract descriptions which have actually been consolidated. (Use reverse side of this form if necessary.) _____

No allowable will be assigned to the well until all interests have been consolidated (by communitization, unitization, forced-pooling, or otherwise) or until a non-standard unit, eliminating such interests, has been approved by the Commission.

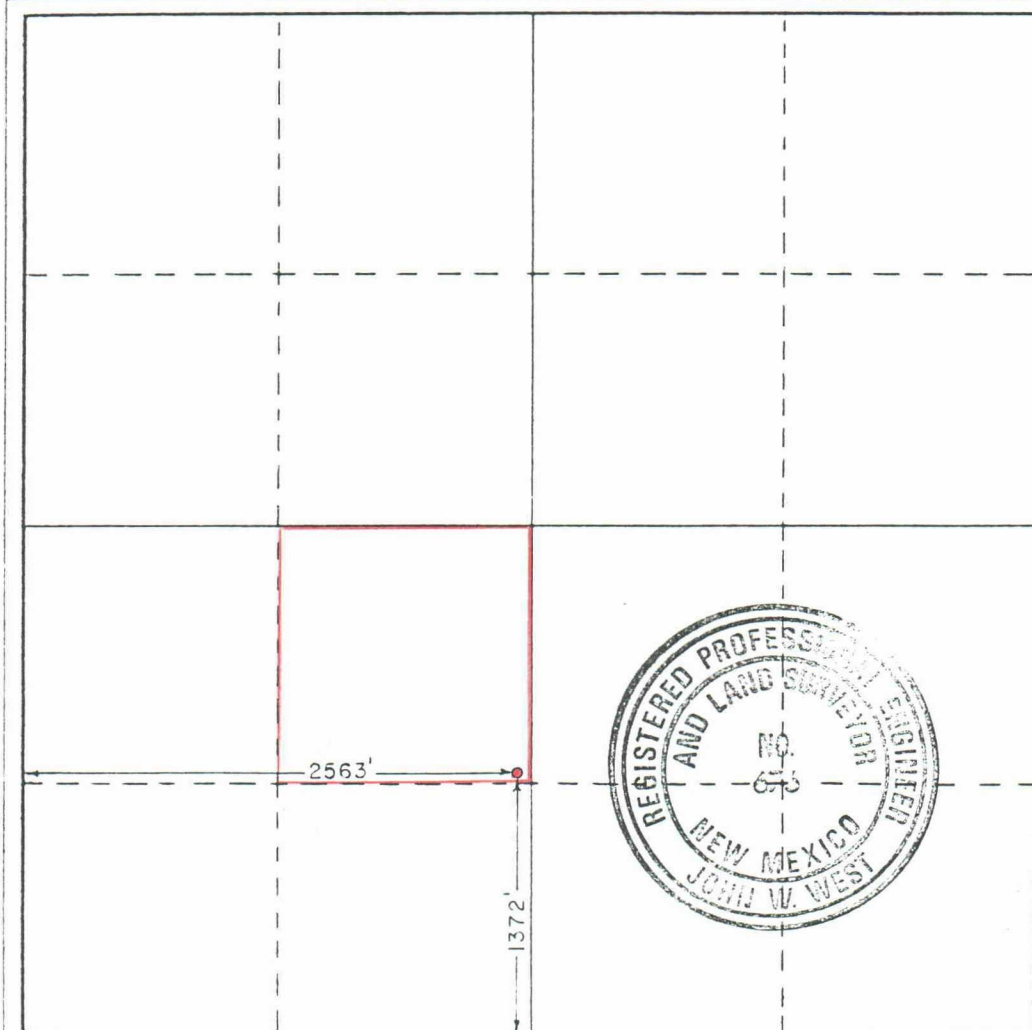

CERTIFICATION

I hereby certify that the information contained herein is true and complete to the best of my knowledge and belief.

Name: A. J. FORE
Position: SUPERVISOR REG. & PERMITTING
Company: SHELL WESTERN E&P INC.
Date: FEBRUARY 25, 1985

I hereby certify that the well location shown on this plat was plotted from field notes of actual surveys made by me or under my supervision, and that the same is true and correct to the best of my knowledge and belief.

Date Surveyed: JANUARY 30, 1985

Registered Professional Engineer and/or Land Surveyor

John W. West

Certificate No. JOHN W. WEST, 676
RONALD J. EIDSON, 3239





STATE OF NEW MEXICO
ENERGY AND MINERALS DEPARTMENT
OIL CONSERVATION DIVISION

TONEY ANAYA
GOVERNOR

POST OFFICE BOX 2088
STATE LAND OFFICE BUILDING
SANTA FE, NEW MEXICO 87501
(505) 827-5800

February 7, 1985

Shell Western E & P Inc.
P. O. Box 991
Houston, Texas 77001

Attention: A. J. Fore, Supervisor

Subject: Order No. R-7628
Unorthodox Well Location Change
North Hobbs (G/SA) Unit
T18S, R38E, & 37E, NMPM
Lea County, New Mexico

Dear Mr. Fore:

Your request to move well Nos. 24-212, and 32-223 to new unorthodox locations because of surface use restrictions has been reviewed. Since these wells are at less unorthodox locations, approval will be granted for the amended locations noted below.

Original Location	Amended Location
* Well No. 24-212 1280 FNL & 2620 FWL Section 24, T18S, R37E Lea County, NM	Well No. 24-212 1263 FNL & 2605 FWL Section 24, T18S, R37E Lea County, NM
Well No. 32-223 2630 FNL & 1410 FWL Section 32, T18S, R38E Lea County, NM	Well No. 32-223 2630 FNL & 1420 FWL Section 32, T18S, R38E Lea County, NM

Sincerely,

R. L. Stamets
Director

cc: Case File 8263
Hobbs District Office

RLE /bak



STATE OF NEW MEXICO
ENERGY AND MINERALS DEPARTMENT
OIL CONSERVATION DIVISION

TONEY ANAYA
GOVERNOR

POST OFFICE BOX 2088
STATE LAND OFFICE BUILDING
SANTA FE, NEW MEXICO 87501
(505) 827-5800

February 7, 1985

Shell Western E & P Inc.
P. O. Box 991
Houston, Texas 77001

Attention: A. J. Fore, Supervisor

Subject: Order No. R-7628
Unorthodox Well Location Change
North Hobbs (G/SA) Unit
T18S, R38E, & 37E, NMPM
Lea County, New Mexico

Dear Mr. Fore:

Your request to move well Nos. 24-212, and 32-223 to new unorthodox locations because of surface use restrictions has been reviewed. Since these wells are at less unorthodox locations, approval will be granted for the amended locations noted below.

Original Location	Amended Location
Well No. 24-212 1280 FNL & 2620 FWL Section 24, T18S, R37E Lea County, NM	Well No. 24-212 1263 FNL & 2605 FWL Section 24, T18S, R37E Lea County, NM
* Well No. 32-223 2630 FNL & 1410 FWL Section 32, T18S, R38E Lea County, NM	Well No. 32-223 2630 FNL & 1420 FWL Section 32, T18S, R38E Lea County, NM

Sincerely,

R. L. Stamets
Director

cc: Case File 8263
Hobbs District Office

RLS:JC/hok



STATE OF NEW MEXICO
ENERGY AND MINERALS DEPARTMENT
OIL CONSERVATION DIVISION

TONY ANAYA
GOVERNOR

POST OFFICE BOX 2088
STATE LAND OFFICE BUILDING
SANTA FE, NEW MEXICO 87501
(505) 827-5800

May 10, 1985

Shell Western E & P Inc.
P. O. Box 991
Houston, Tx 77001

Attention: A. J. Fore, Supervisor

RE: Order No. R-7629 Unorthodox
Well Location Change
North Hobbs (G/SA) Unit
T-18S, R38E, NMPM Lea Co., NM

Dear Mr. Fore,

Your request to move well No. 28-242 to a new unorthodox location because of surface use restrictions has been reviewed. Since the bottomhole location approval by Order No. R-7629 will remain unchanged, approval will be granted for the amended location noted below.

Original Location

Well No. 28-242
1163 FSL & 2014 FWL
Section 28, T18S, R38E
Lea County, NM

Amended Location

Well No. 28-242
1166 FSL & 1823 FWL
Section 28, T18S, R38E
Lea County, NM

Bottomhole Location

Well No. 28-242
1100 FSL & 2400 FWL
Section 28, T18S, R38E
Lea County, NM

Sincerely,

R. L. Stamets
Director

cc:: Case file 8264
Hobbs District Office
Engineering Committee

RLS/DC/bok



STATE OF NEW MEXICO
ENERGY AND MINERALS DEPARTMENT
OIL CONSERVATION DIVISION

February 28, 1985

TONEY ANAYA
GOVERNOR

POST OFFICE BOX 2088
STATE LAND OFFICE BUILDING
SANTA FE, NEW MEXICO 87501
(505) 827-5800

Shell Western E & P, Inc.
P. O. Box 991
Houston, Texas 77001

Attention: A. J. Fore

AMENDED
Administrative Order NSL-1891

Gentlemen:

Reference is made to your application for a non-standard location for your North Hobbs (G/SA) Unit Well No. 232 to be located 2501 feet from the South line and 1410 feet from the West line of Section 19, Township 18 South, Range 38 East, NMPM, Lea County, New Mexico.

By authority granted me under the provisions of Rule 7 of Division Order No. R-6199, the above-described unorthodox location is hereby approved.

Sincerely,

R. L. STAMETS, DIRECTOR

REMARKS: This amended order authorizes the well location to be changed due to surface use restrictions.

RLS/DC/dr

cc: Oil Conservation Division - Hobbs
Oil & Gas Engineering Committee - Hobbs
Case File 8263
Case File 6653

Authorized by R.L. Staments
Sept. 13, 1984



Shell Western E&P Inc.
A Subsidiary of Shell Oil Company

September 7, 1984

P.O. Box 991
Houston, TX 77001

NSL-1892
RULE 7 ORDER NO. R-7628
Rebair Immediately

RECEIVED

SEP 12 1984

OIL CONSERVATION DIVISION

Staments

Rule 7
R-7628

State of New Mexico
Energy and Minerals Department
Oil Conservation Division
P. O. Box 2088
Santa Fe, NM 87501

Gentlemen:

SUBJECT: UNORTHODOX WELL LOCATIONS
ORDER NO. R-7628

SHELL WESTERN E&P INC. - NORTH HOBBS (G/SA) UNIT
T-18-S, R-38-E, NMPM
LEA COUNTY, NEW MEXICO

Shell Western E&P Inc., as operator of the North Hobbs Unit, respectfully requests approval of the following revisions to Exhibit "A" of Order No. R-7628, entered in Case No. 8263:

<u>Original Location</u>	<u>Amended Location</u>	<u>Reason for Change</u>
Sec. 19, Well No. 232 Unit Letter K 2795' FNL & 1390' FWL	2501' FSL & 1390' FWL	Moved 16' north due to safety and topographic considerations.
Sec. 28, Well No. 122 Unit Letter B 1592' FNL & 200' FWL	1579' FNL & 211' FWL	Moved 13' north and 11' east due to safety and topographic considerations.
Sec. 33, Well No. 212 Unit Letter C 205' FNL & 1420' FWL	N/A	Proposed injector - should be omitted from Exhibit "A".
Sec. 33, Well No. 213 Unit Letter C 1300' FNL & 2455' FWL	N/A	Proposed producer - should be added to Exhibit "A".
Sec. 33, Well No. 323 Unit Letter G 2495' FNL & 1420' FEL	2525' FNL & 1453' FEL	Moved 30' south and 33' west due to safety and topographic considerations.

Send copies to case file 8263
File 6653

Please find the attached plat indicating the locations of the subject wells. If additional information is required, please advise.

Yours very truly,



A. J. Fore
Supervisor Regulatory and Permitting
Mid-Continent Division

JMW

Attachment

cc: New Mexico Oil Conservation Division - Hobbs, NM

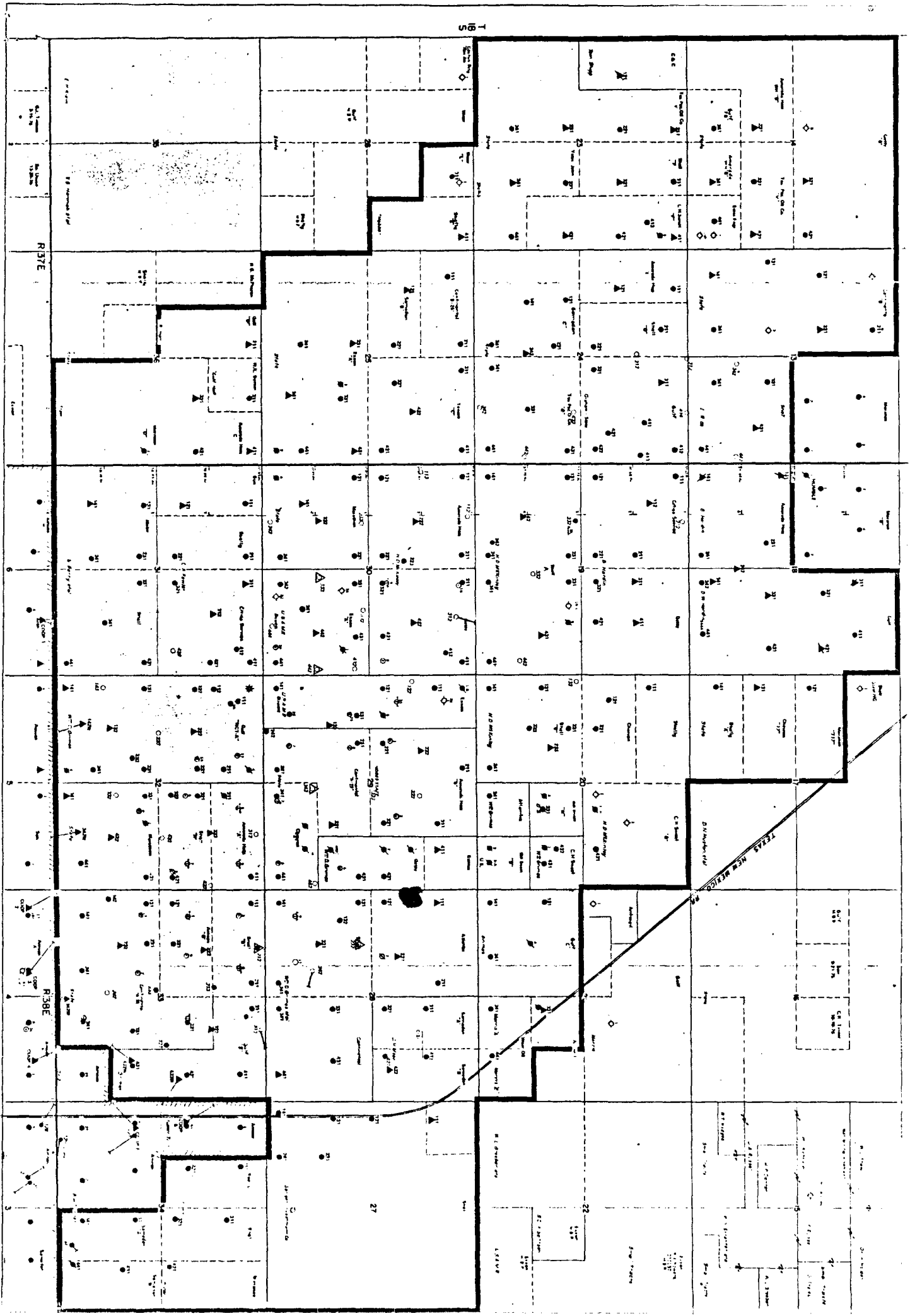



STATE OF NEW MEXICO
ENERGY AND MINERALS DEPARTMENT
OIL CONSERVATION DIVISION

TONY ANAYA
GOVERNOR

POST OFFICE BOX 2088
STATE LAND OFFICE BUILDING
SANTA FE, NEW MEXICO 87501
(505) 827-5800

February 7, 1985

Shell Western E & P Inc.
P. O. Box 991
Houston, Texas 77001

Attention: A. J. Fore, Supervisor

Subject: Order No. R-7628
Unorthodox Well Location Change
North Hobbs (G/SA) Unit
T18S, R38E, & 37E, NMPM
Lea County, New Mexico

Dear Mr. Fore:

Your request to move well Nos. 24-212, and 32-223 to new unorthodox locations because of surface use restrictions has been reviewed. Since these wells are at less unorthodox locations, approval will be granted for the amended locations noted below.

Original Location	Amended Location
Well No. 24-212 1280 FNL & 2620 FWL Section 24, T18S, R37E Lea County, NM	Well No. 24-212 1263 FNL & 2605 FWL Section 24, T18S, R37E Lea County, NM
Well No. 32-223 2630 FNL & 1410 FWL Section 32, T18S, R38E Lea County, NM	Well No. 32-223 2630 FNL & 1420 FWL Section 32, T18S, R38E Lea County, NM

Sincerely,

R. L. Stamets
Director

cc: Case File 8263
Hobbs District Office

RIS: [unclear]/bok

*David
Catanach*

Shell Western E&P Inc.
A Subsidiary of Shell Oil Company



P. O. Box 991
Houston, TX 77001

January 25, 1985

State of New Mexico
Energy and Minerals Department
Oil Conservation Division
P. O. Box 2088
Santa Fe, NM 87501

Gentlemen:

SUBJECT: UNORTHODOX WELL LOCATIONS
ORDER NO. R-7628
SHELL WESTERN E&P INC. - NORTH HOBBS (G/SA) UNIT
T-18-S, R-38-E, NMPM
LEA COUNTY, NEW MEXICO

Shell Western E&P Inc., as operator of the North Hobbs Unit, hereby advises you that due to surface use restrictions, it has become necessary to move well numbers 24-212 and 32-223 to new locations. Previously approved and proposed locations for each well are shown below:

<u>Original Location</u>	<u>Amended Location</u>
Sec. 24, Well No. 212 Unit Letter C 1280' FNL & 2620' FWL	1263' FNL & 2605' FWL
Sec. 32, Well No. 223 Unit Letter F 2630' FNL & 1410' FWL	2630' FNL & 1420' FWL

The certified plats submitted with this request indicates the amended locations.

NMOCDD Order No. R-7628 granted approval of our application to drill 35 wells at unorthodox locations. As stated in our original application, these producers will be located less than the minimum 330 feet from 40-acre proration unit boundaries, but are orthodox in all other respects.

Inasmuch as the basis of our original application remains unchanged, we recommend your approval of Shell's proposal to drill these infill producers at the amended unorthodox locations as shown above.

We apologize for any inconvenience caused by these changes.

Yours very truly,

A. J. Fore

A. J. Fore
Supervisor Regulatory
and Permitting
Mid-Continent Division

ILLEGIBLE

JMW:TS

Attachment

BNBC852501

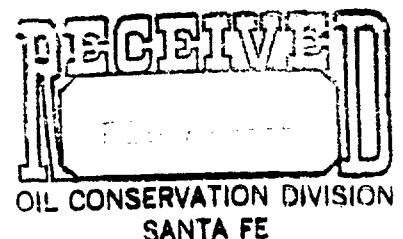

cc: New Mexico Oil Conservation Division - Hobbs, NM

BNBC352501

NEW MEXICO OIL CONSERVATION COMMISSION
WELL LOCATION AND ACREAGE DEDICATION PLAT

Form O-102
Supersedes C-128
Effective 1-1-65

All distances must be from the outer boundaries of the Section

Operator SHELL WESTERN E. & P., INC.		Lease NORTH HOBBS UNIT SECTION 24			Well No. 212
Well Letter C	Section 24	Township 18 SOUTH	Range 37 EAST	County LEA	

Actual Footage Location of Well: 1263 feet from the NORTH line and 2605 feet from the WEST line					
Ground Level Elev. 3671.3	Producing Formation GRAYBURG/SAN ANDRES	Pool HOBBS (GRAYBURG/SAN ANDRES)	Dedicated Acreage: 40 Acres		

- Outline the acreage dedicated to the subject well by colored pencil or hachure marks on the plat below.
- If more than one lease is dedicated to the well, outline each and identify the ownership thereof (both as to working interest and royalty).
- If more than one lease of different ownership is dedicated to the well, have the interests of all owners been consolidated by communitization, unitization, force-pooling, etc?

Yes No If answer is "yes:" type of consolidation UNITIZATION

If answer is "no:" list the owners and tract descriptions which have actually been consolidated. (Use reverse side of this form if necessary.) _____

No allowable will be assigned to the well until all interests have been consolidated (by communitization, unitization, forced-pooling, or otherwise) or until a non-standard unit, eliminating such interests, has been approved by the Commission.

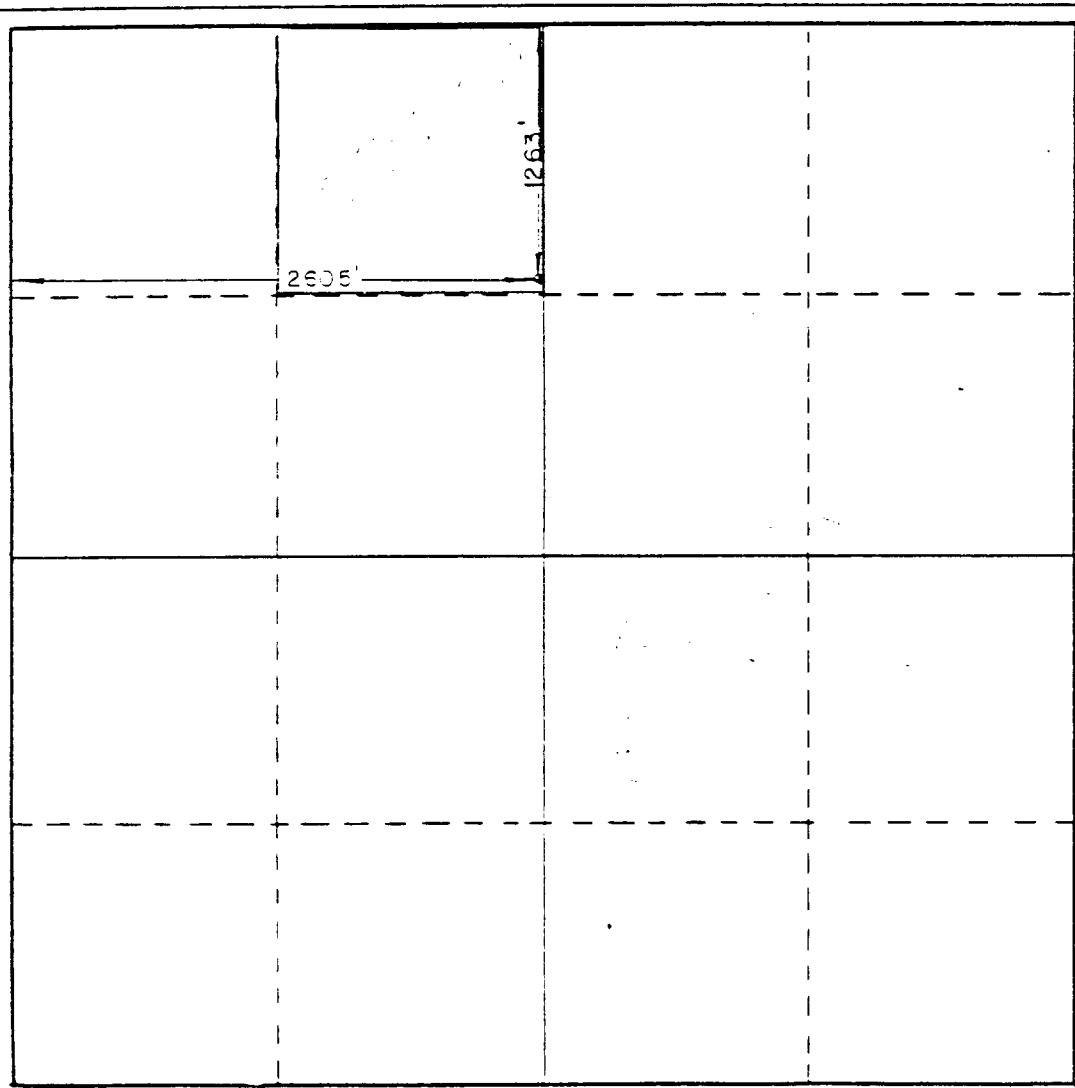

CERTIFICATION

I hereby certify that the information contained herein is true and complete to the best of my knowledge and belief.

Name A. J. Fore A. J. FORE
 Position SUPERVISOR REG. & PERMITTING
 Company SHELL WESTERN E&P INC.
 Date JANUARY 25, 1985

I hereby certify that the well location shown on this plat was plotted from field notes of actual surveys made by me or under my supervision, and that the same is true and correct to the best of my knowledge and belief.

Date Surveyed JANUARY 10, 1985
 Registered Professional Engineer and/or Land Surveyor
John W. West
 Certificate No. JOHN W. WEST, 676
RONALD J. EDSON, 3259

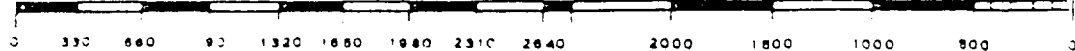

NEW MEXICO OIL CONSERVATION COMMISSION
WELL LOCATION AND ACREAGE DEDICATION PLAT

Form C-132
Supersedes C-128
Effective 1-1-65

All distances must be from the outer boundaries of the Section

Operator SHELL WESTERN E&P INC.		Lease SHELL HOBBS UNIT SECTION 32		Well No. 223
Unit Letter #	Section 32	Township 17S	Range 14E	County LEA
Actual Footage Location of Well: 230 feet from the NORTH line and 1420 feet from the WEST line				
Ground Level Elev. 3631.3'	Producing Formation GRAYBURG/SAN ANDRES	Pool HOBBS (GRAYBURG/SAN ANDRES)	Dedicated Acreage: 40 Acres	

1. Outline the acreage dedicated to the subject well by colored pencil or hachure marks on the plat below.
2. If more than one lease is dedicated to the well, outline each and identify the ownership thereof (both as to working interest and royalty).
3. If more than one lease of different ownership is dedicated to the well, have the interests of all owners been consolidated by communitization, unitization, force-pooling, etc?

Yes No If answer is "yes," type of consolidation UNITIZATION

If answer is "no," list the owners and tract descriptions which have actually been consolidated. (Use reverse side of this form if necessary.) _____

No allowable will be assigned to the well until all interests have been consolidated (by communitization, unitization, forced-pooling, or otherwise) or until a non-standard unit, eliminating such interests, has been approved by the Commission.

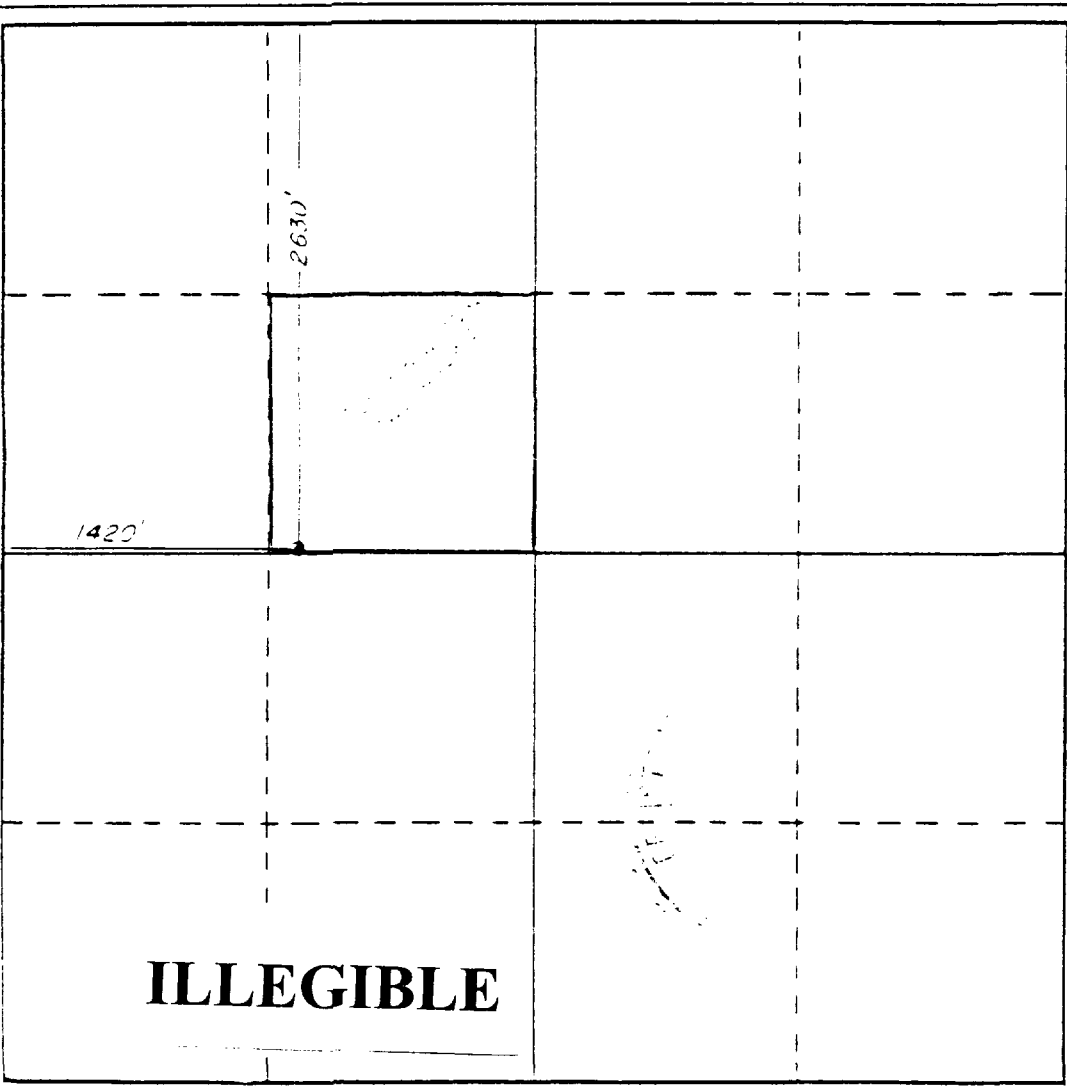

CERTIFICATION

I hereby certify that the information contained herein is true and complete to the best of my knowledge and belief.

Name
A. J. Fore A. J. FORE

Position
SUPERVISOR REG. & PERMITTING

Company
SHELL WESTERN E&P INC.

Date
JANUARY 25, 1985

I hereby certify that the well location shown on this plat was plotted from field notes of actual surveys made by me or under my supervision, and that the same is true and correct to the best of my knowledge and belief.

Date Surveyed
1-25-85

Registered Professional Engineer and/or Land Surveyor
John W. West

Certificate No. JOHN W. WEST, 576
RONALD J. EASON, 3239

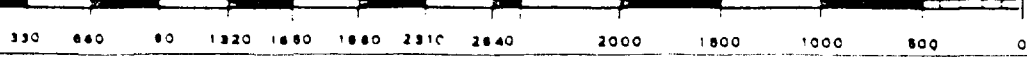



STATE OF NEW MEXICO
ENERGY AND MINERALS DEPARTMENT
OIL CONSERVATION DIVISION

TONY ANAYA
GOVERNOR

POST OFFICE BOX 2088
STATE LAND OFFICE BUILDING
SANTA FE, NEW MEXICO 87501
(505) 827-5800

October 24, 1984

Shell Western E & P Inc.
P. O. Box 991
Houston, Texas 77001

Attention: A. J. Fore, Supervisor

Subject: Order No. R-7628
Unorthodox Well Location Change
North Hobbs (G/SA) Unit
T-18-S,R-38-E, NMPM, Lea Co., N.M.

Dear Mr. Fore;

Your request to move well No. 29-442 to a new unorthodox location because of surface use restrictions has been reviewed. The well is at a less unorthodox location and approval will therefore be granted for the amended location noted below.

Original Location

Well No. 29-442
1230' FSL & 170' FEL,
T18S,R38E, Lea Co., N.M.

Amended Location

Well No. 29-442
1230' FSL & 220' FEL,
T18S,R38E, Lea Co., N.M.

Sincerely,

R. L. Stamets
Acting Director

cc: Case File 8263 ✓
Gilbert Quintana
Hobbs District Office

Shell Western E&P Inc.

A Subsidiary of Shell Oil Company



P.O. Box 991
Houston, TX 77001

September 25, 1984

State of New Mexico
Energy and Minerals Department
Oil Conservation Division
P. O. Box 2088
Santa Fe, NM 87501

Gentlemen:

SUBJECT: UNORTHODOX WELL LOCATIONS
ORDER NO. R-7628
SHELL WESTERN E&P INC. - NORTH HOBBS (G/SA) UNIT
T-18-S, R-38-E, NMPM
LEA COUNTY, NEW MEXICO

Shell Western E&P Inc., as operator of the North Hobbs Unit, hereby advises you that due to surface use restrictions, it has become necessary to move well number 29-442 to a new location. The present location for the well is shown below.

Original Location

Sec. 29, Well No. 442
Unit Letter P
1230' FSL & 170' FEL

Amended Location

1230' FSL & 220' FEL

NMOCD Order No. R-7628 granted approval of our application to drill 35 wells at unorthodox locations. As stated in our original application, these producers will be located less than the minimum 330 feet from 40-acre proration unit boundaries, but are orthodox in all other respects.

Inasmuch as the basis of our original application remains unchanged, we recommend your approval of Shell's proposal to drill this infill producer at the amended unorthodox location as shown above.

We apologize for any inconvenience caused by this change.

Yours very truly,

A handwritten signature in cursive script, reading "A. J. Fore", is placed above the typed name.

A. J. Fore
Supervisor Regulatory and Permitting
Mid-Continent Division

JMW

Attachment

cc: New Mexico Oil Conservation Division - Hobbs, NM

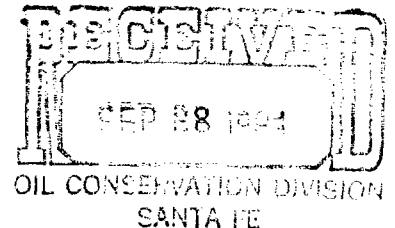

**NEW MEXICO OIL CONSERVATION COMMISSION
WELL LOCATION AND ACREAGE DEDICATION PLAT**

Form C-102
Supersedes C-128
Effective 1-1-85

All distances must be from the outer boundaries of the Section.

Operator Shell Western E. & P. Inc.		Lease North Hobbs Unit			Well No. 29-442
Unit Letter P	Section 29	Township 18 South	Range 38 East	County Lea	
Actual Footage Location of Well: 1230 feet from the south line and 220 feet from the east line					
Ground Level Elev. 3642.2'	Producing Formation GRAYBURG/SAN ANDRES		Pool HOBBS (GRAYBURG/SAN ANDRES)		Dedicated Acreage: 40 Acres

1. Outline the acreage dedicated to the subject well by colored pencil or hachure marks on the plat below.
2. If more than one lease is dedicated to the well, outline each and identify the ownership thereof (both as to working interest and royalty).
3. If more than one lease of different ownership is dedicated to the well, have the interests of all owners been consolidated by communitization, unitization, force-pooling, etc?

Yes No If answer is "yes," type of consolidation UNITIZATION

If answer is "no," list the owners and tract descriptions which have actually been consolidated. (Use reverse side of this form if necessary.) _____

No allowable will be assigned to the well until all interests have been consolidated (by communitization, unitization, forced-pooling, or otherwise) or until a non-standard unit, eliminating such interests, has been approved by the Commission.

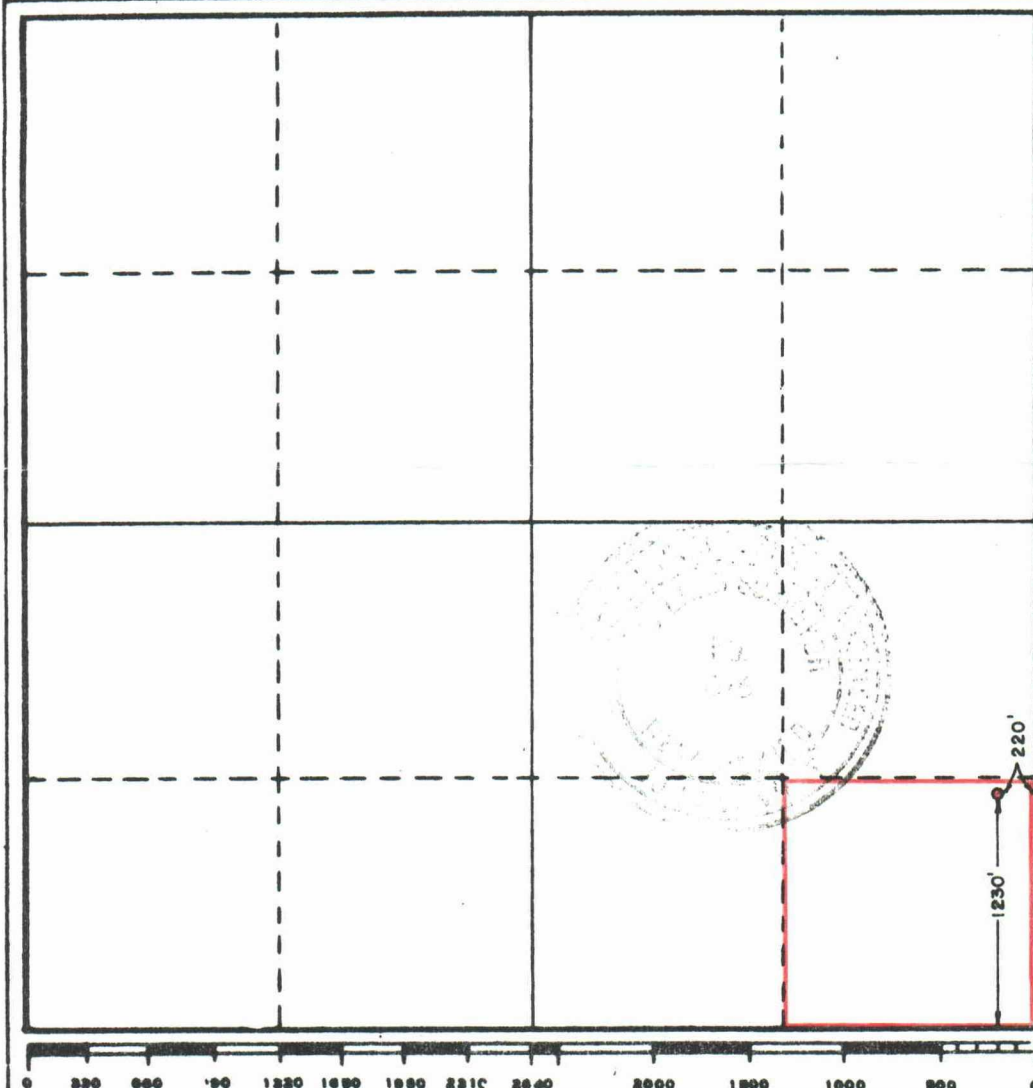

CERTIFICATION

I hereby certify that the information contained herein is true and complete to the best of my knowledge and belief.

Name	A. J. FORE
Position	SUPERVISOR REG. & PERMITTING
Company	SHELL WESTERN E&P INC.
Date	SEPTEMBER 25, 1984

I hereby certify that the well location shown on this plat was plotted from field notes of actual surveys made by me or under my supervision, and that the same is true and correct to the best of my knowledge and belief.

Date Surveyed	September 22, 1984
Registered Professional Engineer and/or Land Surveyor	
Certificate No.	JOHN W. WEST, 676
	RONALD J. EIDSON, 3239





STATE OF NEW MEXICO
ENERGY AND MINERALS DEPARTMENT
OIL CONSERVATION DIVISION

TONEY ANAYA
GOVERNOR

POST OFFICE BOX 2088
STATE LAND OFFICE BUILDING
SANTA FE, NEW MEXICO 87501
(505) 827-5800

September 14, 1984

Shell Western E & P, Inc.
P.O. Box 991
Houston, Texas 77001

Attention: A. J. Fore

Administrative Order NSL-1893

Gentlemen:

Reference is made to your application for a non-standard location for your North Hobbs (G/SA) Unit Well No. 323 to be located 2525 feet from the North line and 1453 feet from the East line of Section 33, Township 18 South, Range 38 East, Lea County, New Mexico.

By authority granted me under the provisions of Rule 7 of Division Order R-6199, the above-described unorthodox location is hereby approved.

Sincerely,

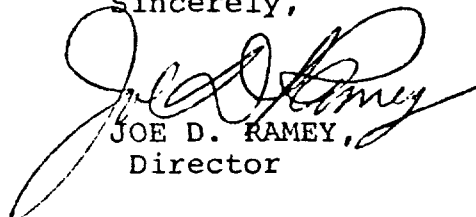

JOE D. RAMEY,
Director

JDR/RLS/dp

cc: Oil Conservation Division - Hobbs
Oil & Gas Engineering Committee - Hobbs

MONTGOMERY & ANDREWS

PROFESSIONAL ASSOCIATION
ATTORNEYS AND COUNSELORS AT LAW

J. O. Seth (1883-1963)
Frank Andrews (1914-1981)

A. K. Montgomery
Seth D. Montgomery
Frank Andrews III
Victor R. Ortega
John E. Conway
Jeffrey R. Brannen
John B. Pound
Gary R. Kilpatrick
Thomas W. Olson
William C. Madison
Walter J. Melendres
Bruce L. Herr
Michael W. Brennan
Robert P. Worcester
John B. Draper
Nancy M. Anderson
Janet McL. McKay

Jean-Nikole Wells
Mark F. Sheridan
Joseph E. Earnest
Stephen S. Hamilton
Phyllis A. Dow
Wm. Alan Wright
Brad V. Coryell
Wesley B. Howard, Jr.
Thurman W. Moore III
Michael H. Harbour
John M. Hickey
Timothy L. Butler
Mack E. With
Galen M. Buller
Katherine A. Weeks
Edmund H. Kendrick

June 29, 1984

SANTA FE OFFICE
325 Paseo de Peralta
Post Office Box 2307
Santa Fe, New Mexico 87504-2307

Telephone (505) 982-3873
Telecopy (505) 982-4289

ALBUQUERQUE OFFICE
Suite 200
500 Copper Avenue, N.W.
Post Office Box 2048
Albuquerque, New Mexico 87103-2048

Telephone (505) 242-9677

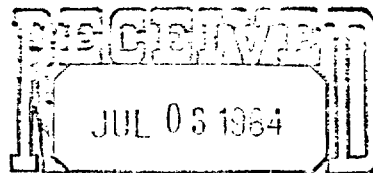

OIL CONSERVATION DIVISION
SANTA FE

REPLY TO SANTA FE OFFICE

New Mexico Energy and
Minerals Department
Oil Conservation Division
State Land Office Building
Santa Fe, New Mexico 87503

Re: OCC Cases 8262, 8263 and 8264

Gentlemen:

Please be advised that Michael Fredette of the office of General Counsel of Shell Western E & P, Inc., Houston, Texas, is associated with our firm for the presentation of evidence and argument in the above-referenced cases.

Sincerely,

Edmund H. Kendrick

EHK:gar
#2355-84-01

cc: Mr. Mike Fredette