

Prepared by
 UNITED STATES DEPARTMENT OF THE INTERIOR
 GEOLOGICAL SURVEY
 In cooperation with
 NEW MEXICO STATE ENGINEER

MINERAL RESOURCES
 MAPPING AND TECHNOLOGY

Chloride Ion Concentration in Ground Water
 in Permian Guadalupian Rocks of Southeastern
 New Mexico and West Texas

RESOURCE MAP 4

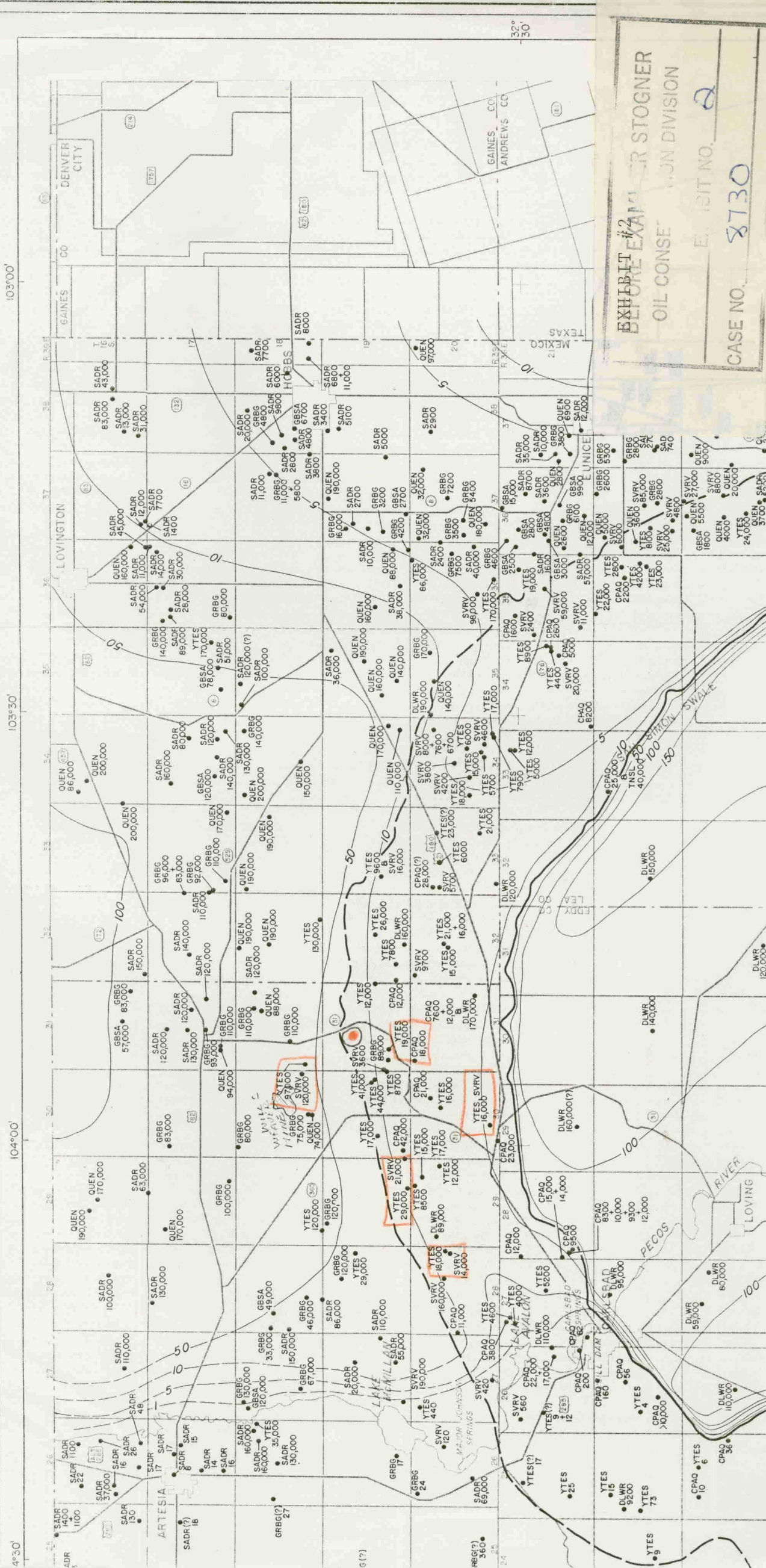

EXHIBIT #2
 STOGENER
 OIL CONSERVATION DIVISION
 CASE NO. 8730
 EXHIBIT NO. 2