

EI Paso Expl
6-1-87
36392
Mannan

PanAmar
Champlin
30192 87

Long Box Unit
Yates
0-1-84
22617

Tesoro
Huber-Fed
TD 2462
07/10/2273

Kenneth
Husotake
B-1-88
33662

Conoco
HBP
043015
Armour

Conoco
HBP
045275
Armour

Conoco
HBP
043625
Armour

Conoco
HBP
045275
Armour

Conoco
HBP
045276
Armour

Conoco
HBP
045276
Armour

Phillips
HBP
E10083
HBC N12

Phillips
HBP
E10083
HBC N12

Phillips
HBP
E10083
HBC N12

LAND PLAT NO. 1

CASE NO. 8758
DOCKET NO. 12-86

BHP PETROLEUM COMPANY INC.

Unorthodox Well Location
Monsanto Low State Well No. 2

330' FSL & 330' FWL
Section 36, T-21-S, R-23-E
Eddy County, New Mexico

EXHIBIT

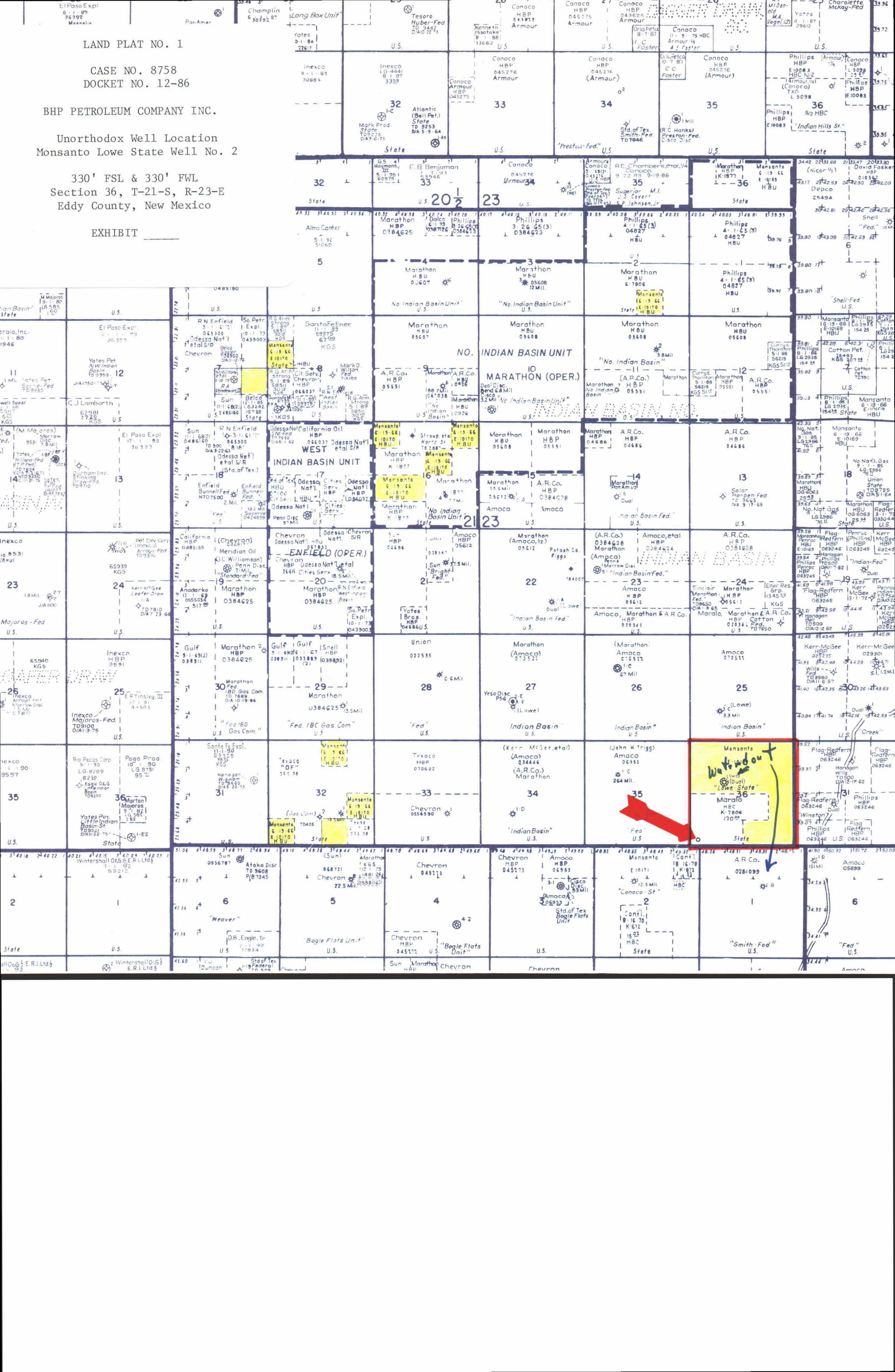

BEFORE THE
OIL CONSERVATION COMMISSION
Santa Fe, New Mexico

Case No. 8758 Exhibit No. 1
Submitted by Monsanto (BHP)
Hearing Date 4-9-86