

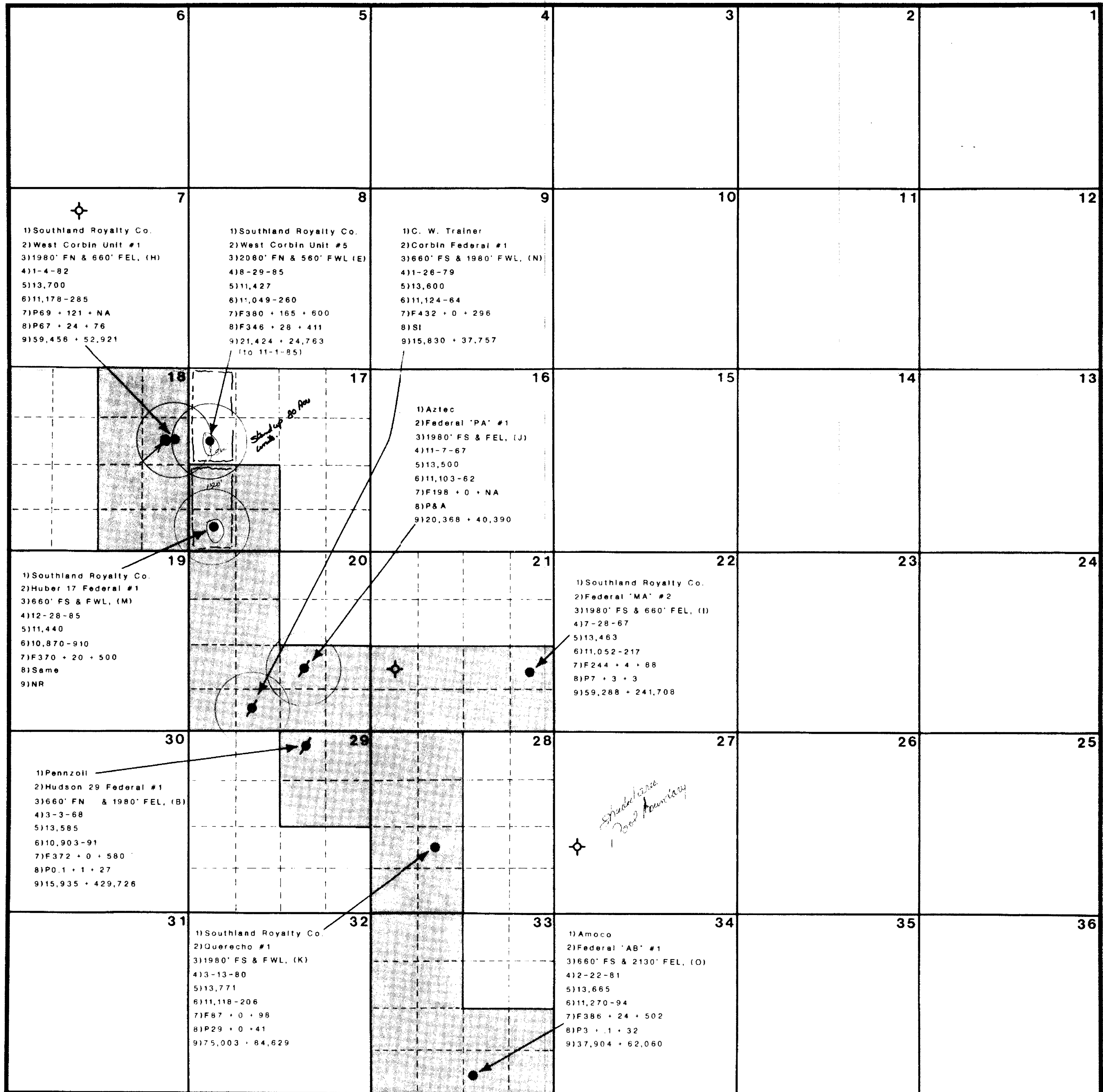

Southland Royalty Company
SOUTHWESTERN DISTRICT

MIDLAND TEXAS



T-18-S R-33-E
LEA COUNTY, NEW MEXICO
SOUTH CORBIN WOLFCAMP POOL

BEFORE EXAMINER CATANACH
OIL CONSERVATION DIVISION
SRC EXHIBIT NO. 1
CASE NO. 8802

South Corbin (Wolfcamp) Field Lea County, New Mexico Well Data:

- 1) Operator Name
- 2) Well Name
- 3) Location
- 4) Completion Date
- 5) Total Depth
- 6) Perforations
- 7) Initial Potential (BO + BW + MCF/D)
- 8) 8/85 Rate (BO + BW + MCF/D)
- 9) Cumulative to 9-1-85 (BO + MCF)